

Brown, Patti

From: Doug McVey <dmcvey@charter.net>
Sent: Wednesday, September 13, 2017 9:29 PM
To: Brown, Patti; Trussoni, Dan
Subject: Requesting the Park Board to permit additional landscaping around the Crowley Park sign
Attachments: Crowley Park landscape design.jpg

Dear Patti and Dan

On behalf of the Grandview-Emerson neighborhood association (GENA), I am requesting permission to enhance the landscaping in the planting bed where the sign for Crowley Park sits. This bed is at the eastern end of the park, outside of the fenced area. It is at the intersection of Campbell Road and 22nd Street, with 22nd actually curving (on its way to La Crosse Street) to accommodate the shape of the bed. The current landscaping consists of 2 mature ornamental trees flanking the sign and

3 boulders spread along the length of the bed. The bed is fairly large and GENA would like to fill in some of the empty space with shrubs, an evergreen, and perennials. The attached landscape plan shows planting locations for the evergreen, shrubs and some, but not all, of the perennials.

GENA will pay for the plants, do the planting, and be responsible for future maintenance of the planting bed. From the City, we ask permission to use the water faucet in Crowley Park for watering the plants (whenever necessary) and request the continued delivery of mulch when needed.

GENA (Charlie Weeth, in particular) has a history of improving the appearance of public spots along Campbell Road. Our biggest project has been the flower garden at the Campbell cul-de-sac but we have also made improvements to the Pine Street cul-de-sac as well as the "triangle"

where Vine and 20th Streets intersect the road. Adding to the landscaping around the Crowley Park sign will continue our efforts to make Campbell Road a nice avenue to drive down, bike down, or walk down.

Thank you. Please email or call (769-0386) with any questions or concerns.

Sincerely

Doug McVey

CROWLEY PARK LANDSCAPING PLAN

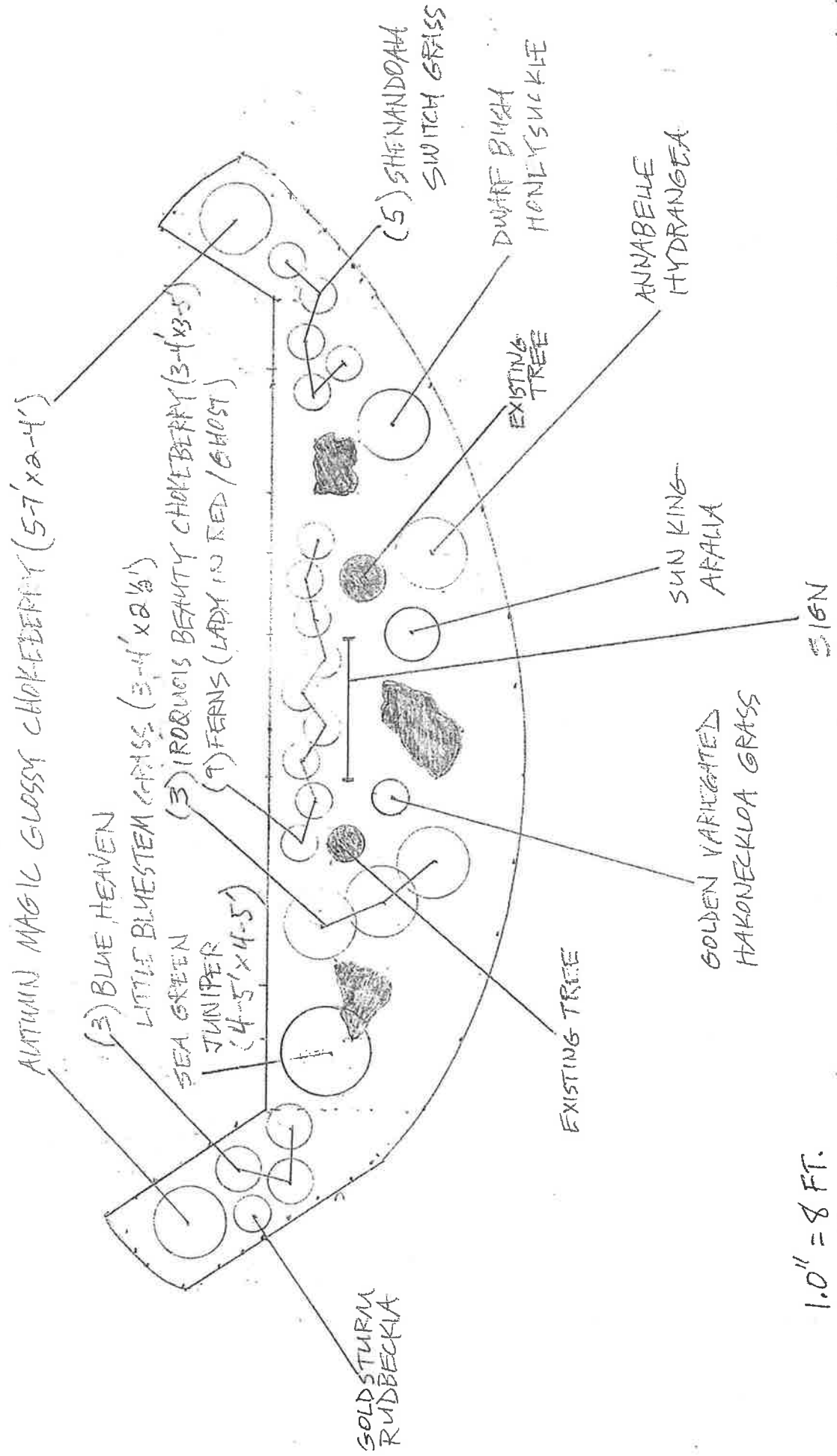

DRAWN BY: DOUG McVEY
McVEY'S PLANT
MAINTENANCE