

COPELAND AVENUE

ASPHALT PAVEMENT

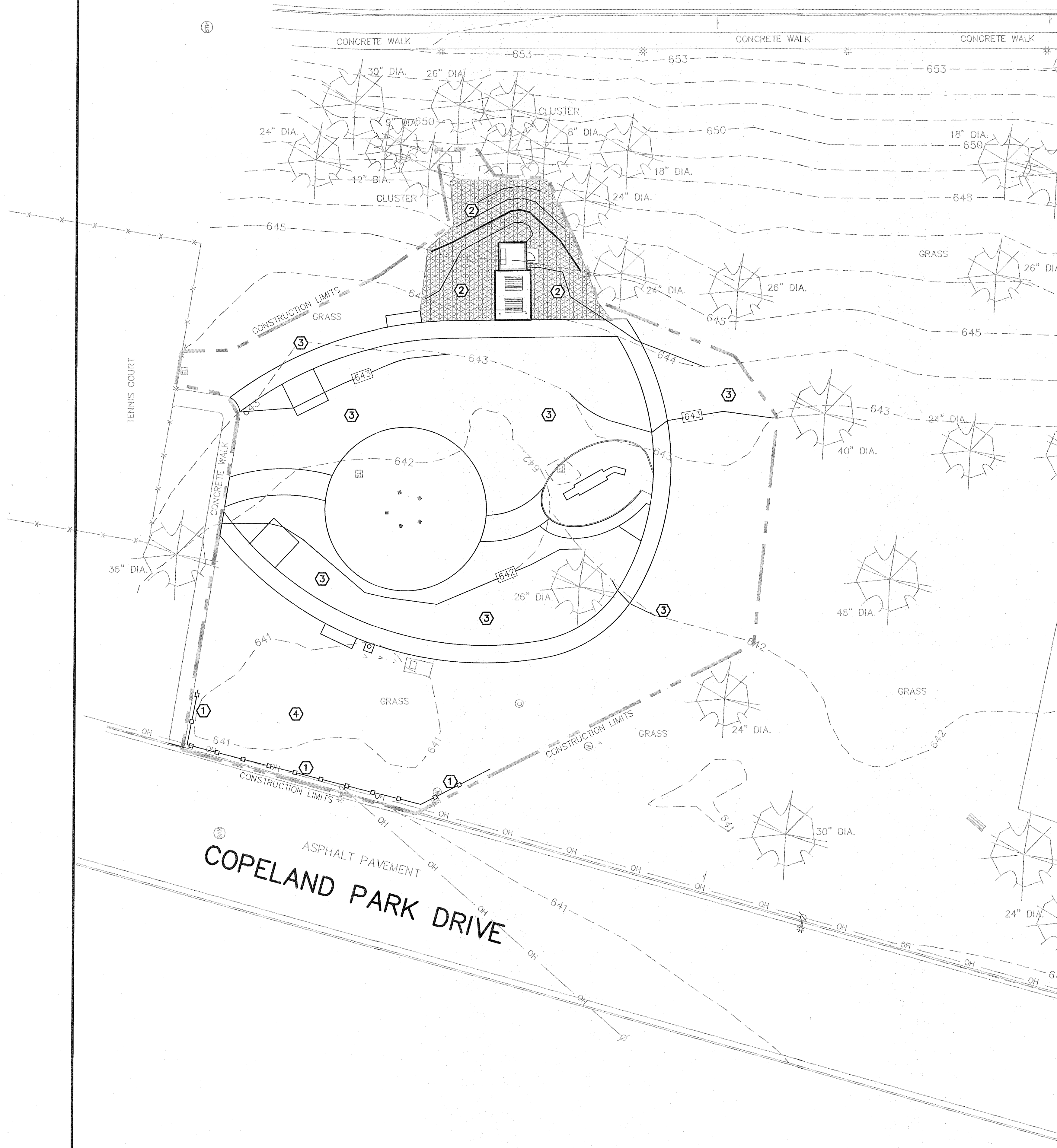

NOTES

- SEE DETAIL (A) FOR SILT FENCE
- EROSION CONTROL MATTING SHALL BE CURLEX BY AMERICAN EXCELSIOR OR APPROVED EQUAL. INSTALL TO MANUFACTURER RECOMMENDATION.
- ALL DISTURBED AREAS NOT PROTECTED WITH EROSION CONTROL MATTING SHALL BE SEEDED AND MULCHED.
- PROVIDE CONCRETE WASHOUT PER DETAIL (B)

NOTE:

- REFER TO: WISCONSIN DEPARTMENT OF NATURAL RESOURCES CONSTRUCTION SITE EROSION & SEDIMENT CONTROL STANDARD SILT FENCE (1056)
- INSTALL PER MANUFACTURER SPECIFICATIONS

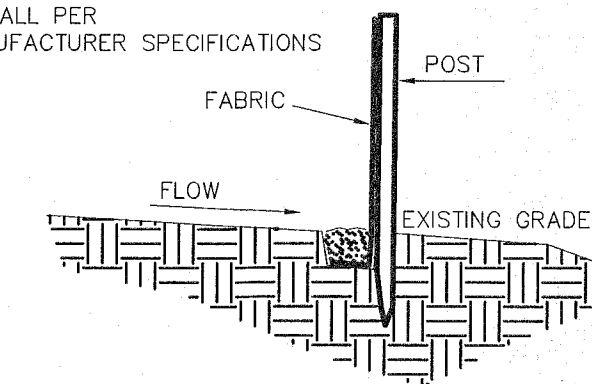

(A) TYPICAL SILT FENCE INSTALLATION
NO SCALE

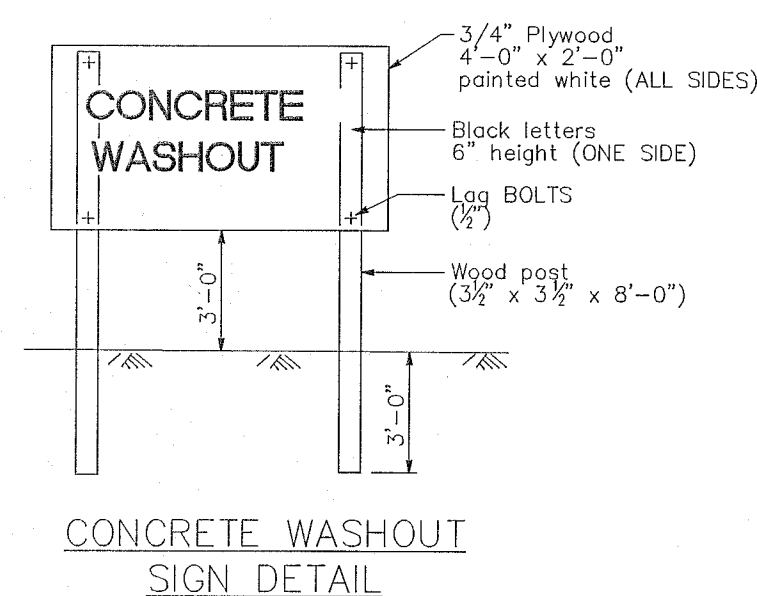
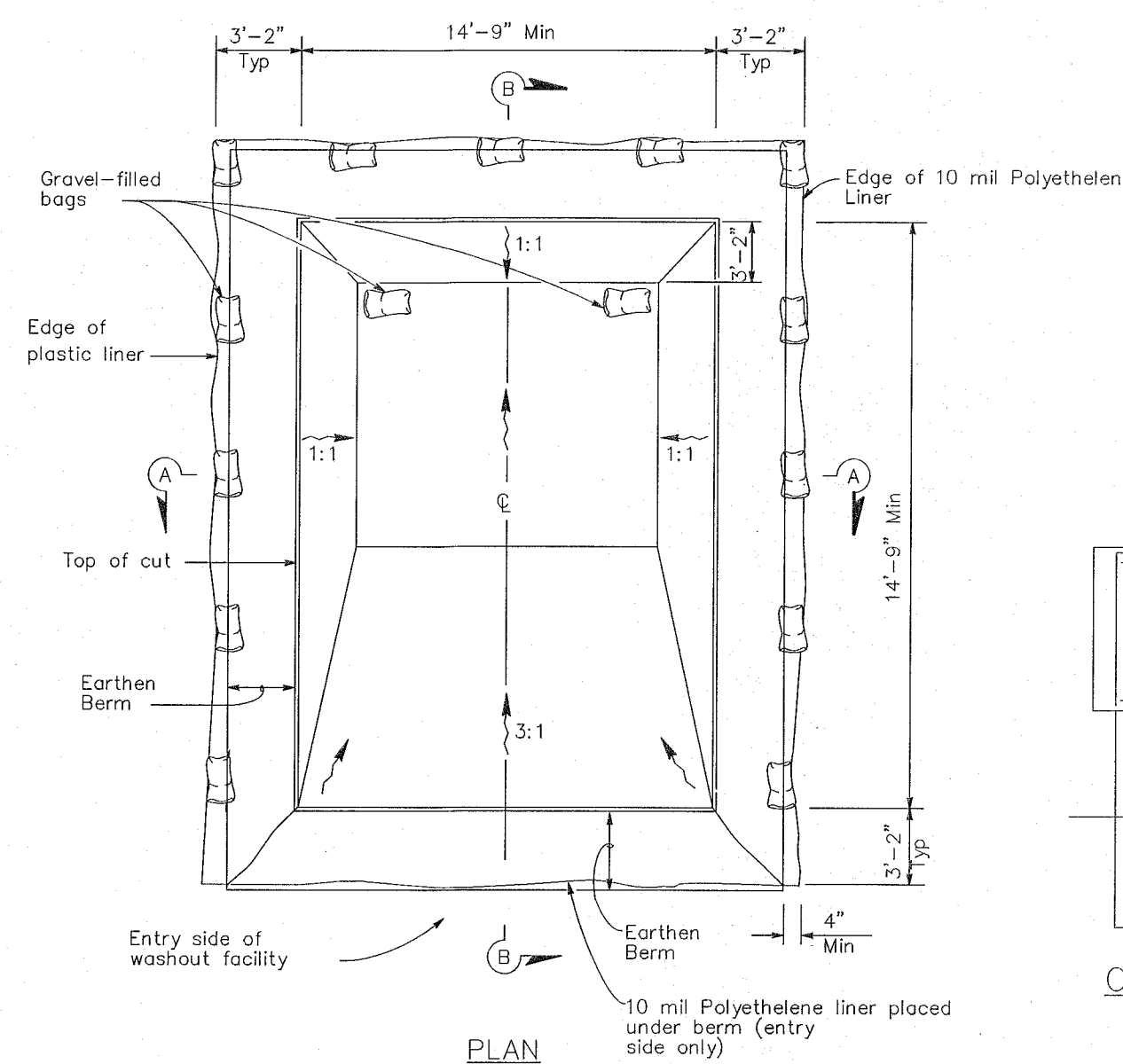
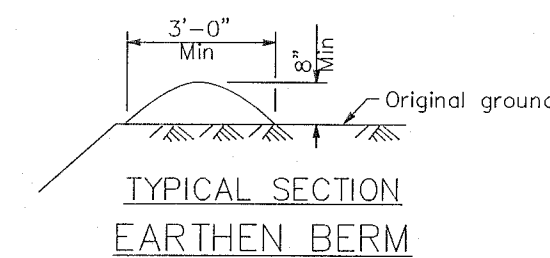
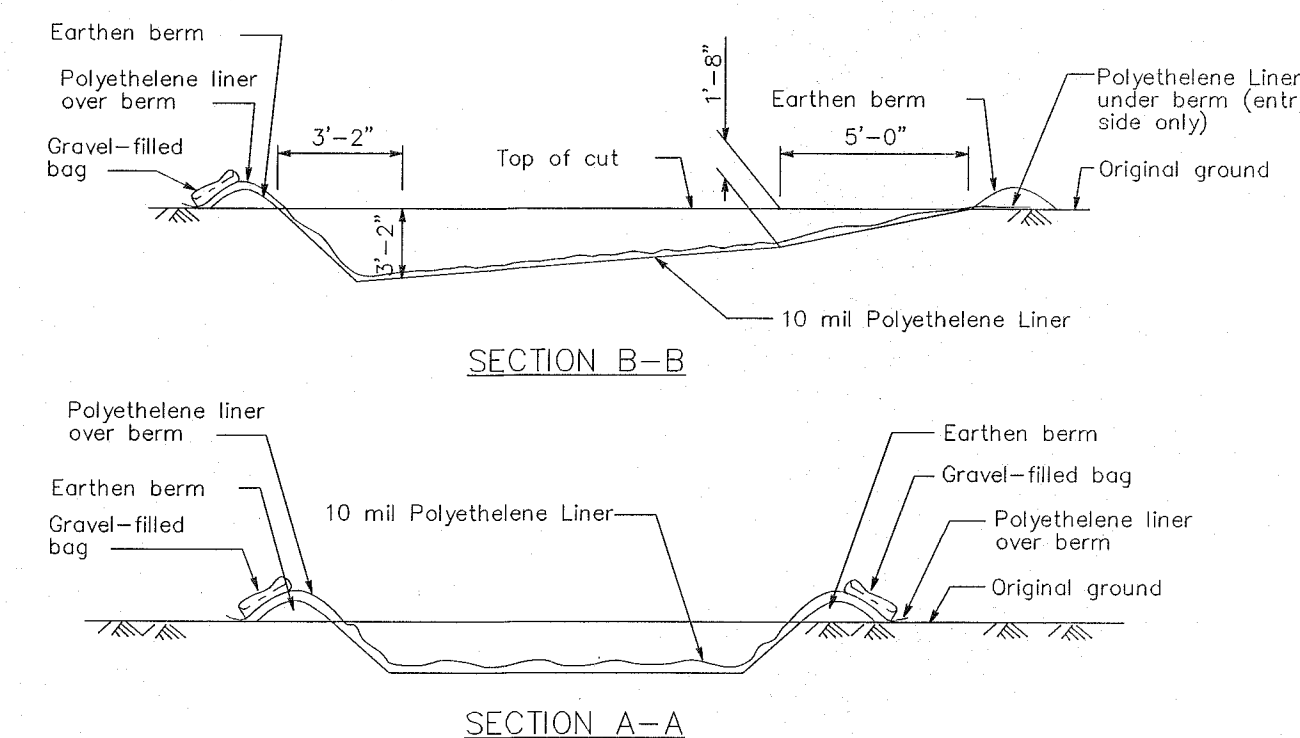

(B) TEMPORARY CONCRETE WASHOUT FACILITY
NO SCALE

STORM WATER CONSTRUCTION POLLUTION PREVENTION NOTES

SITE CLEARING SHALL APPLY TO ALL AREAS INSIDE LIMITS AS SHOWN ON THE PLANS. REMOVE ALL TREES COMPLETELY AS DIRECTED BY THE OWNER. ANY STRIPPED TOPSOIL SHALL BE STOCKPILED INSIDE THE LIMITS OR PLACED IMMEDIATELY ON SLOPES BEING RESTORED.

SEDIMENT CONTROL STRUCTURES BELOW SEEDED AREAS MUST REMAIN IN PLACE UNTIL THE ENTIRE AREA HAS ESTABLISHED A MATURE COVERING OF HEALTHY VEGETATION.

ALL DISTURBED AREAS SCHEDULED FOR PERMANENT COVER SHALL HAVE TOPSOIL APPLIED, AND BE SEEDED AND MULCHED AS SPECIFIED WITHIN 7 DAYS OF FINAL DISTURBANCE.

MAINTENANCE OF ALL INSTALLED EROSION AND SEDIMENT CONTROL DEVICES SHALL BE THE RESPONSIBILITY OF THE CONTRACTOR AND REMOVED WHEN NO LONGER NECESSARY.

MINIMUM MAINTENANCE SHALL CONSIST OF, BUT NOT LIMITED TO:

- INSPECTING ALL EROSION AND SEDIMENT CONTROL DEVICES AFTER EACH RAINFALL.
- FINISHED AREAS THAT HAVE BEEN DAMAGED OR ERODED SHALL BE RESTORED WITHIN THREE DAYS OF THE DAMAGE.
- UNFINISHED AREAS THAT HAVE BEEN DAMAGED OR ERODED SHALL HAVE THE PREVIOUS MEASURE REAPPLIED WITHIN SEVEN DAYS.
- VEHICLE TRACKING CONTROL APRON SHALL BE PROVIDED IF NECESSARY. SWEEP STREET AT THE END OF EACH DAY.
- SILT FENCES SHALL BE MAINTAINED IN A FUNCTIONING MANNER. FENCES SHALL NOT BE ALLOWED TO SAG, FALL DOWN, OR BECOME FILLED WITH SILT ON THE BACK SIDE. IF SILT BUILDS UP BEHIND A SILT FENCE, IT SHALL BE REMOVED IMMEDIATELY. UNDER NO CIRCUMSTANCES SHALL SILT DEPOSITS BE ALLOWED TO REACH MORE THAN 1/3 THE HEIGHT OF THE FENCE.

SILT FENCE SHALL BE PLACED DOWN SLOPE OF ALL SOIL STOCK PILES DURING CONSTRUCTION IF LEFT MORE THAN SEVEN DAYS. STOCK PILES SHALL BE SEEDED AND MULCHED IF LEFT FOR MORE THAN 14 DAYS.

ADDITIONAL EROSION CONTROL FACILITIES MAY BE REQUIRED DUE TO UNFORESEEN PROBLEMS.

SEDIMENT CONTROL STRUCTURES BELOW LAWN AREAS MAY BE REMOVED ONCE SOD AND FINAL LANDSCAPING IS IN PLACE. SEDIMENT CONTROL STRUCTURES BELOW SEEDED AREAS MUST REMAIN IN PLACE UNTIL THE ENTIRE AREA HAS ESTABLISHED A MATURE COVERING OF HEALTHY VEGETATION. SEDIMENT CONTROL STRUCTURES IN PAVED AREAS SHALL REMAIN IN PLACE UNTIL PAVING IS COMPLETE.

SEDIMENT DEPOSITED IN ROADS OR RIGHT OF WAY DITCHES ADJACENT TO THIS SITE AS A RESULT OF THIS WORK SHALL BE REMOVED. VEGETATION SHALL BE ESTABLISHED WHEN SEDIMENT REMOVAL DESTROYS THE EXISTING VEGETATION. THE ESTABLISHMENT OF VEGETATION SHALL BE IN THE SAME MANNER AS SPECIFIED FOR SEEDING SPECIFIED ELSEWHERE ON THIS PLAN.

SEDIMENT CONTROL DURING CONSTRUCTION:

- A SILT FENCE SHALL BE INSTALLED ALONG ALL DOWN SLOPE EARTHWORK.
- ALL MAINTENANCE PROCEDURES OUTLINED ABOVE SHALL APPLY.

SLOPES STEEPER THAN 5:1 SHALL BE PROTECTED WITH EROSION MATTING OR MULCHED WITH STRAW AND COVERED WITH JUTE NETTING.

PROVIDE CONCRETE WASHOUT AREA PER DETAIL (B). UNDER NO CIRCUMSTANCES SHALL CONCRETE WASHOUT BE ALLOWED IN ANY OTHER LOCATION ON THE SITE.

HSR ASSOCIATES INC.
100 MILWAUKEE STREET
LA CROSSE, WISCONSIN
PHONE: 608.784.1830
FAX: 608.782.5844

WEB SITE: www.hsrassociates.com

Consultant:

PARAGON ASSOCIATES
Environmental Design & Consulting
CIVIL ENGINEERING - LANDSCAPE ARCHITECTURE - SURVEYING
632 COPELAND AVENUE - LA CROSSE, WI 54603
Tel: 608.781.3110 Fax: 608.781.3197 Paragon-Associates

CITY OF LA CROSSE
COPELAND PARK UPDATE

1020 COPELAND PARK DRIVE
LA CROSSE, WISCONSIN

EROSION CONTROL PLAN

Project Title:

HSR Project Number:

17032

Project Date:

AUGUST 2017

Drawn By:

C.G.

Key Plan:

Revisions:

No.	Description	Date

Graphic Scale:

1"=20'

Last Update:

08/11/2017

C300

