

COPELAND AVENUE

ASPHALT PAVEMENT

STORM MANHOLE
RIM = 652.83
I.E.S. =

STORM MANHOLE
RIM = 653.52
I.E.N. = 645.72
I.E.W. = 634.12
I.E.E. = 634.12

NOTES

--THIS DOCUMENT HAS BEEN PREPARED FOR A SPECIFIC APPLICATION AND SOLELY FOR THE USE OF CITY OF LA CROSSE AND NOT FOR GENERAL USE. IT MAY NOT BE USED WITHOUT THE EXPRESSED WRITTEN CONSENT OF PARAGON ASSOCIATES, INC. UNAPPROVED USE IS THE SOLE RESPONSIBILITY OF THE UNAUTHORIZED USER.

--THIS DOCUMENT IS BEING FURNISHED TO CITY OF LA CROSSE IN THE FORM OF AN AUTOCAD DRAWING. THE PURPOSE OF THE AUTOCAD DRAWING IS FOR USE WITHIN THE AUTOCAD SOFTWARE PROGRAM WITH THE UNDERSTANDING THAT THE CAPABILITY OF AUTOCAD TO DIMENSION AN ELEMENT OF A DRAWING EXCEEDS THE DEGREE OF PRECISION TO WHICH THAT ELEMENT MAY HAVE BEEN LOCATED. FIELD VERIFICATION MAY BE NECESSARY BEFORE DESIGN IS FINALIZED.

--THE UNDERGROUND LOCATION OF PUBLIC UTILITIES WERE MARKED BY REPRESENTATIVES OF THOSE COMPANIES. THE LOCATION OF CLIENT OWNED UNDERGROUND UTILITIES WERE NOT MARKED. THE LOCATION OF EXISTING UTILITIES, BOTH UNDERGROUND AND OVERHEAD, ARE APPROXIMATE ONLY AND HAVE NOT BEEN INDEPENDENTLY VERIFIED BY THE OWNER OR THE REPRESENTATIVES. THE CONTRACTOR SHALL BE RESPONSIBLE FOR DETERMINING THE EXACT LOCATION OF ALL EXISTING UTILITIES, WHETHER SHOWN ON THESE PLANS OR NOT, BEFORE COMMENCING WORK. THE CONTRACTOR SHALL BE FULLY RESPONSIBLE FOR ALL DAMAGE WHICH MIGHT BE CAUSED BY THE CONTRACTOR'S FAILURE TO LOCATE AND PRESERVE ALL UTILITIES. THERE MAY BE MORE UNDERGROUND UTILITY INSTALLATIONS WITHIN THE PROJECT AREA THAT ARE NOT SHOWN.

CALL DIGGERS HOT LINE (800) 242-8511

--UTILITY COMPANIES NOTIFIED

ARCHITECTURE
ENGINEERING
INTERIOR DESIGN

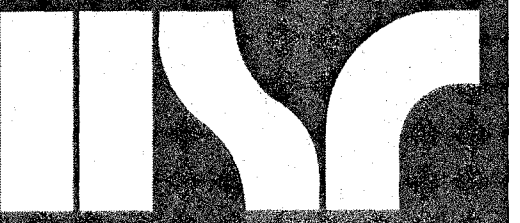

HSR ASSOCIATES INC.
100 MILWAUKEE STREET
LA CROSSE, WISCONSIN
PHONE: 608.784.1830
FAX: 608.782.5844

WEB SITE: www.hsrassociates.com

Consultant:

PARAGON
ASSOCIATES

Environmental Design & Consulting
CIVIL ENGINEERING - LANDSCAPE ARCHITECTURE - SURVEYING
632 COPELAND AVENUE - LA CROSSE, WI 54603
Tel: 608.781.3110 Fax: 608.781.3187 Paragon-Associates

CITY OF LA CROSSE
COPELAND PARK UPDATE

1020 COPELAND PARK DRIVE
LA CROSSE, WISCONSIN
EXISTING CONDITIONS MAP

Project Title:
Project Location:
Sheet Title:

HSR Project Number:
17032

Project Date:
AUGUST 2017

Drawn By:
D.G.

Key Plan:

No.	Description	Date

Graphic Scale:
1"=20'

Last Update:
08/11/2017

C001

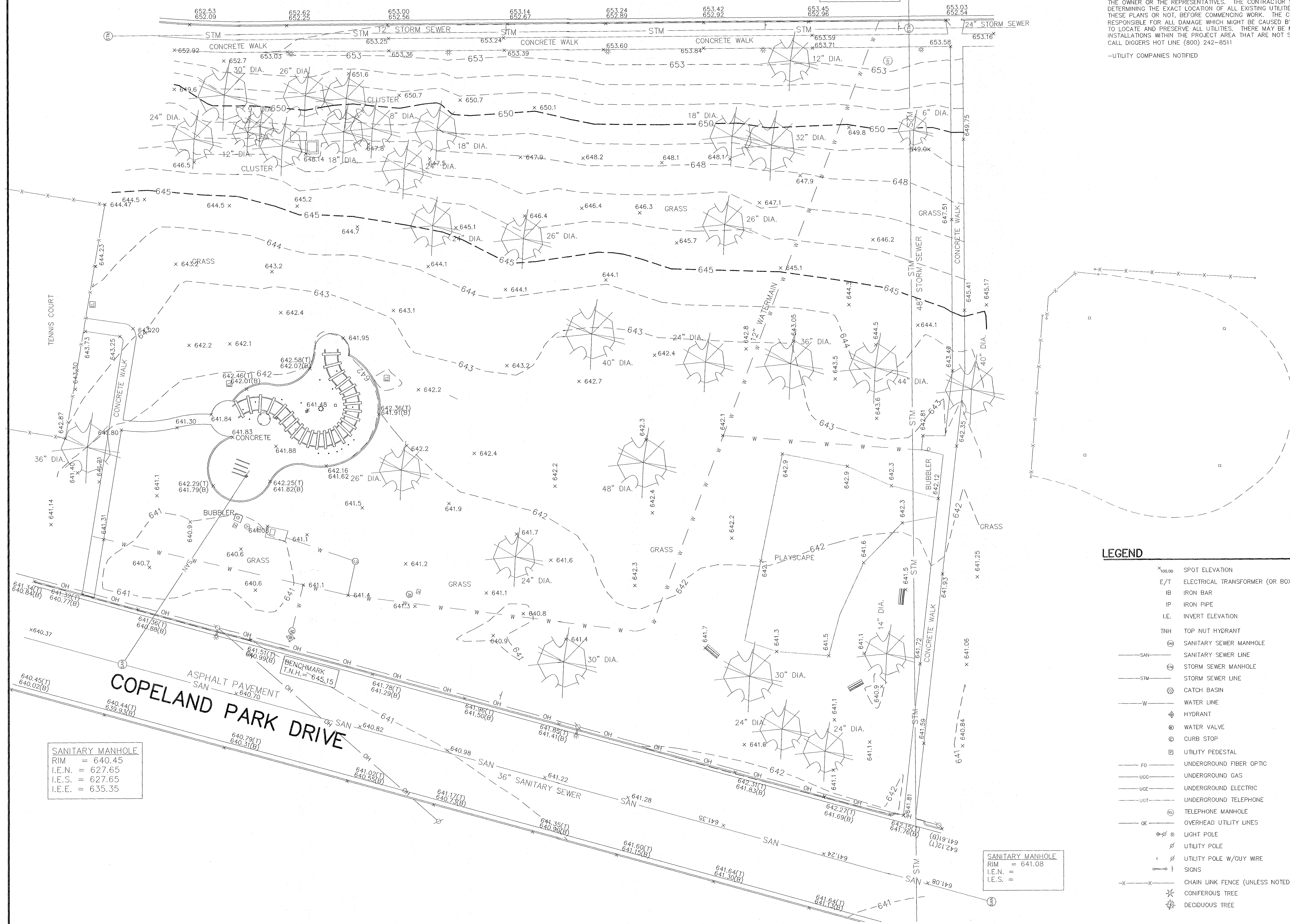

LEGEND

- SPOT ELEVATION
- E/T ELECTRICAL TRANSFORMER (OR BOX)
- IB IRON BAR
- IP IRON PIPE
- I.E. INVERT ELEVATION
- TNH TOP NUT HYDRANT
- SM SANITARY SEWER MANHOLE
- SSM STORM SEWER MANHOLE
- SSM STORM SEWER LINE
- CB CATCH BASIN
- W WATER LINE
- H HYDRANT
- WV WATER VALVE
- CS CURB STOP
- UP UTILITY PEDESTAL
- FO UNDERGROUND FIBER OPTIC
- UGG UNDERGROUND GAS
- UGE UNDERGROUND ELECTRIC
- UGT UNDERGROUND TELEPHONE
- TM TELEPHONE MANHOLE
- OE OVERHEAD UTILITY LINES
- LP LIGHT POLE
- UP UTILITY POLE
- UPW UTILITY POLE W/GUY WIRE
- S SIGNS
- CLF CHAIN LINK FENCE (UNLESS NOTED)
- CT CONIFEROUS TREE
- DT DECIDUOUS TREE

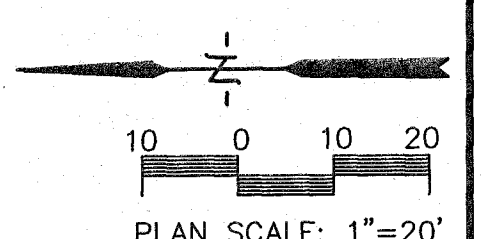

SANITARY MANHOLE
RIM = 640.45
I.E.N. = 627.65
I.E.S. = 627.65
I.E.E. = 635.35

SANITARY MANHOLE
RIM = 641.08
I.E.N. =
I.E.S. =