

License Fee: \$25.00

Invoice No.: 155283 Cust. # 164949

**APPLICATION TO OWN, KEEP AND/OR HARBOR CHICKENS
IN THE CITY OF LA CROSSE**

COPY

License Period: January 1, 2018 to December 31, 2018

Use Conditions:

- One property is limited to the keeping or harboring of up to five (5) chickens.
- A person may only own, keep or harbor chickens on property being used as a one-family dwelling (single family) or two-family dwelling (duplex).
- No person shall keep any rooster.
- No person shall slaughter any chickens.
- Chickens shall be provided with a covered enclosure and kept in covered enclosure or a fenced enclosure within the backyard of the property at all times.
- No enclosure shall be located closer than 25 feet to any residential structure on an adjacent lot.

APPLICANT:

MARGY & ERIK GUNDERSEN

PROPERTY ADDRESS WHERE CHICKENS WILL BE KEPT:

1532 MADISON ST, LA CROSSE WI 54601

PROPERTY OWNER(S):

ERIK & MARGUERITE GUNDERSEN

*If applicant is not the owner, please provide written documentation from the owner that they have been notified.
Not applicable for renewal.*

Is the property X ONE-FAMILY dwelling or TWO-FAMILY dwelling? (Check One)

*If duplex, provide written documentation from other occupant that they have been notified.
Not applicable for renewal.*

25.00

Payment Amount:

Attach a scale drawing showing property lot lines, dimensions of coop/enclosure and distance from adjoining lot lines and residential structures.

Applying for and obtaining this chicken permit DOES NOT provide any authority to violate any restrictive covenants that govern the property where you reside or intend to keep chickens. Please review any Declaration of Restrictions or Restrictive Covenants that apply to the property prior to applying for a chicken permit. No permit fees will be refunded once they are paid.

I hereby certify that I have read and understand the content of this application and that the above statements are true and correct to the best of my knowledge. I further certify that I understand that any such license is subject to revocation in accordance with Municipal Code of Ordinances Sec. 6-16.

Marguerite Gundersen
(Signature)

(Signature)

(Telephone)

608 797 0772

3-18-18
(Date)

COPY

CITY OF LA CROSSE, WI
General Billing - 142471 - 2016
003273-0052 Amber W. 11/18/2016 04:05PM
164949 - GUNDERSEN, MARGUERITE

Payment Amount: 25.00

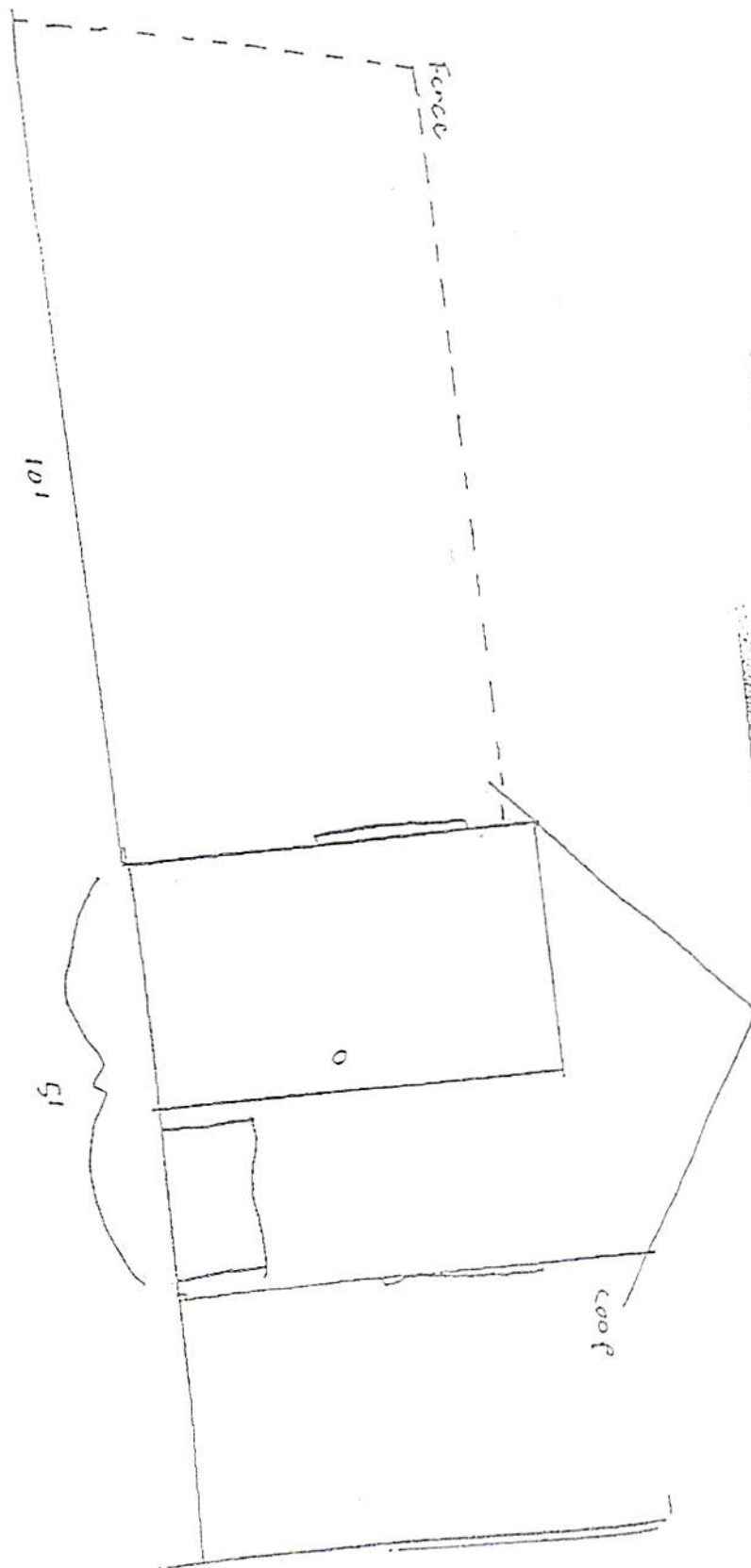

1/2
1/2
1/2

Gundersen