

Original ☒
 *50% approval from neighboring property owners
 J&A and Council Approval

Renewal _____
 J&A Approval

License Fee: \$5⁰⁰

Invoice No.: 155375

**APPLICATION TO OWN, KEEP AND/OR HONEYBEES
IN THE CITY OF LA CROSSE**

License Period: January 1, 18 to December 31, 18 (fifth year of the licensure period)

APPLICANT:

Dave Schatzley

PROPERTY ADDRESS WHERE HONEYBEES WILL BE KEPT:

2820 Leonard Street

PROPERTY OWNER(S):

applicant
If applicant is not the owner, please provide written documentation from the owner that they have been notified.
Not applicable for renewal.

Is the property ☒ **ONE-FAMILY** dwelling or _____ **TWO-FAMILY** dwelling? (Check One)

If two-family, provide written documentation from other occupant that they have been notified.
Not applicable for renewal.

Attach a scale drawing showing property lot lines, location of apiary and distance from any primary buildings on abutting lots and distance from any public sidewalk(s).

If colony is kept less than twenty-five (25) feet from a property line of the lot upon which the apiary is located, and any entrance to the hive faces that lot line; include location, height and description of flyway barrier required pursuant to Sec. 6-18(c)(1).

Applying for and obtaining a beekeeping license **DOES NOT** provide any authority to violate any restrictive covenants that govern the property where you reside or intend to keep honeybees. Please review any Declaration of Restrictions or Restrictive Covenants that apply to the property prior to applying for a beekeeping license. No permit fees will be refunded once they are paid.

The above applicant(s) hereby makes application for a license to own, harbor and/or keep honeybees at the above property address within the City of La Crosse pursuant to provisions of Section 6-18 of the Code of Ordinances for the City of La Crosse.

(signature)

(signature)

608 792 5884
(telephone)

3-15-18
(date)

**WRITTEN APPROVALS
ALLOWING FOR BEEKEEPING IN THE CITY OF LA CROSSE**

We the undersigned, representing at least 50% of the owner-occupied neighboring property owners of the following property address in which the applicant is applying for a Beekeeping License, do hereby approve said license being granted in accordance with City of La Crosse Sec. 6-18.

Applicant: Dave Schatzley Property Address: 2870 Leonard St.

-
- > NAME (Print) SEBASTIAN CASH ADDRESS 3402 29TH St SOUTH
SIGNATURE [Signature] DATE 3-10-18
 - > NAME (Print) Jennifer Cash ADDRESS 3402 29th St South
SIGNATURE [Signature] DATE 03-12-18
 - > NAME (Print) Cyndy Nichols ADDRESS 2817 Leonard St.
SIGNATURE [Signature] DATE 3-13-18
 - > NAME (Print) Anita Olson ADDRESS 2815 Leonard St
SIGNATURE Anita Olson DATE 3-13-18
 - > NAME (Print) Howard Olson ADDRESS 2815 Leonard St
SIGNATURE [Signature] DATE 3-13-18
 - > NAME (Print) Greg Oldenburg ADDRESS 2809 Leonard
SIGNATURE [Signature] DATE 3-14-17
 - > NAME (Print) CAROL HASTINGS ADDRESS 3422 S. 29TH ST
SIGNATURE [Signature] DATE 3-14-18
 - > NAME (Print) Robert Simpson ADDRESS 3422 S. 29TH ST
SIGNATURE [Signature] DATE 3-14-18
 - > NAME (Print) John Gartner ADDRESS 2821 Leonard
SIGNATURE _____ DATE 3-15-18

Note: As each tax parcel counts as one (1) towards the requisite number needed, all owners must sign. For example, if only the husband signs for a property that both husband and wife own, only one-half (1/2) of the parcel is counted.

Customer #: _____

WRITTEN APPROVALS FOR
OWN, KEEP AND/OR HARBOR BEES IN THE CITY OF LA CROSSE

We the undersigned, representing ____% of the owner-occupied neighboring property owners of the following property address in which the property owner is applying for a License to Own, Keep and/or Harbor Bees, do hereby approve said license being granted to said applicant in accordance with City of La Crosse Ordinance 20.22(GG).

Applicant: Dave Schatzley Property Address: 2820

- NAME (Print): Mary Ann Dreves ADDRESS: 2803 Birch St. LaCrosse, WI
SIGNATURE: Mary Ann Dreves
- NAME (Print): GORDON DREVES ADDRESS: 2803 BIRCH ST LACROSSE, WI
SIGNATURE: Gordon Dreves
- NAME (Print): _____ ADDRESS: _____
SIGNATURE: _____
- NAME (Print): _____ ADDRESS: _____
SIGNATURE: _____
- NAME (Print): _____ ADDRESS: _____
SIGNATURE: _____
- NAME (Print): _____ ADDRESS: _____
SIGNATURE: _____
- NAME (Print): _____ ADDRESS: _____
SIGNATURE: _____
- NAME (Print): _____ ADDRESS: _____
SIGNATURE: _____
- NAME (Print): _____ ADDRESS: _____
SIGNATURE: _____
- NAME (Print): _____ ADDRESS: _____
SIGNATURE: _____
- NAME (Print): _____ ADDRESS: _____
SIGNATURE: _____
- NAME (Print): _____ ADDRESS: _____
SIGNATURE: _____
- NAME (Print): _____ ADDRESS: _____
SIGNATURE: _____

ATTACH ADDITIONAL SHEETS AS NEEDED.

**NOTICE OF HEARING ON
APPLICATION TO OWN, KEEP AND/OR HARBOR HONEYBEES**

TO WHOM IT MAY CONCERN:

Notice is hereby given that the Common Council of the City of La Crosse, by its Judiciary & Administration Committee, will consider the application of **Dave Schatzley** for a license pursuant to Sec. 6-18 of the La Crosse Municipal Code **to own, keep and/or harbor honeybees at 2820 Leonard St., La Crosse, WI for the license period April 13th, 2018 to December 31st, 2022.**

Said meeting will be held at 6:00 p.m. on **Tuesday, April 3rd, 2018**, in the Council Chambers in City Hall in the City of La Crosse, La Crosse County, Wisconsin.

Final action will be determined by the Common Council on **Thursday, April 12th, 2018** at 6:00 p.m. also in the Council Chamber of City Hall.

You are further notified that any person affected may be heard, and may appear in person or by attorney, or may file a letter of objection in the office of the City Clerk.

This notice is given pursuant to the order of the Common Council of the City of La Crosse.

Dated this 26th day of March, 2018.



Teri Lehrke, City Clerk
City of La Crosse, Wisconsin

Tax Parcel Number	OwnerName
17-50188-80	➤ GREGORY P OLDENBURG
17-50188-90	➤ ET AL, TODD A, MARK T OLSON, KATHLEEN A LABEAUSE (LE) HOWARD J, ANITA M OLSON
17-50188-100	➤ JOHN D GARTNER
17-50188-110	MAY YE YANG
17-50188-50	KRISTINA L CRANDALL
17-50188-40	➤ CYNTHIA L NICHOLS

17-50188-20✓	➤ STEVEN E, JENNIFER M CASH
17-50187-110	KRAIG A KLEDEHN
17-50187-130	LAURIE R LACHMAN DANIEL R PETERSEN
17-50187-140	LESLIE J HELGERSON, LANA M LANG (LE) MARIE A HELGERSON
17-50188-10	➤ ROBERT G SIMPSON CAROL M STOCKFORD HASTINGS
17-50187-120	➤ GORDON E, MARY ANN DREVES

For Bees kept at:

17-50188-30	SCHATZLEY FAMILY TRUST
-------------	------------------------

Property Address	MailingLine4	MailingLine5
2809 LEONARD ST	2809 LEONARD ST	LA CROSSE WI 54601-7973
2815 LEONARD ST	2815 LEONARD ST	LA CROSSE WI 54601-7973
2821 LEONARD ST	2821 LEONARD ST	LA CROSSE WI 54601-7973
3322 29TH ST S	3322 29TH ST S	LA CROSSE WI 54601-7914
2808 LEONARD ST	2808 LEONARD ST	LA CROSSE WI 54601-7941
2814 LEONARD ST	2814 LEONARD ST	LA CROSSE WI 54601

3402 29TH ST S	3402 29TH ST S	LA CROSSE WI 54601-7915
3419 28TH ST S	3419 28TH ST S	LA CROSSE WI 54601-7929
2815 BIRCH ST	2815 BIRCH ST	LA CROSSE WI 54601-7920
2821 BIRCH ST	2821 BIRCH ST	LA CROSSE WI 54601
3422 29TH ST S	3422 29TH ST S	LA CROSSE WI 54601-7915
2803 BIRCH ST	2803 BIRCH ST	LA CROSSE WI 54601-7920

2820 LEONARD ST	2820 LEONARD ST	LA CROSSE WI 54601-7941
-----------------	-----------------	-------------------------

Google Maps 2820 Leonard St

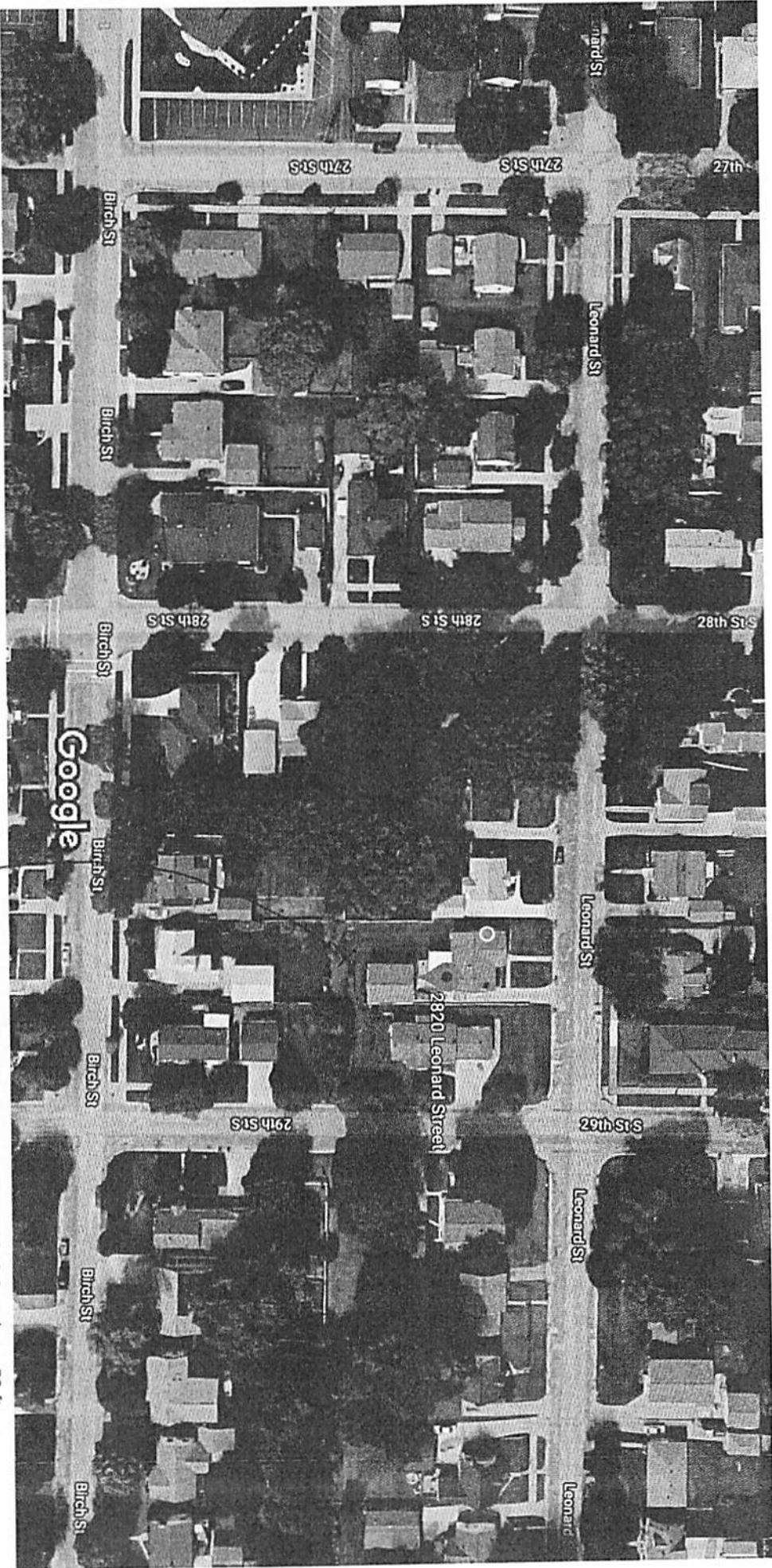

Imagery ©2018 Google, Map data ©2018 Google 50 ft

location of hive

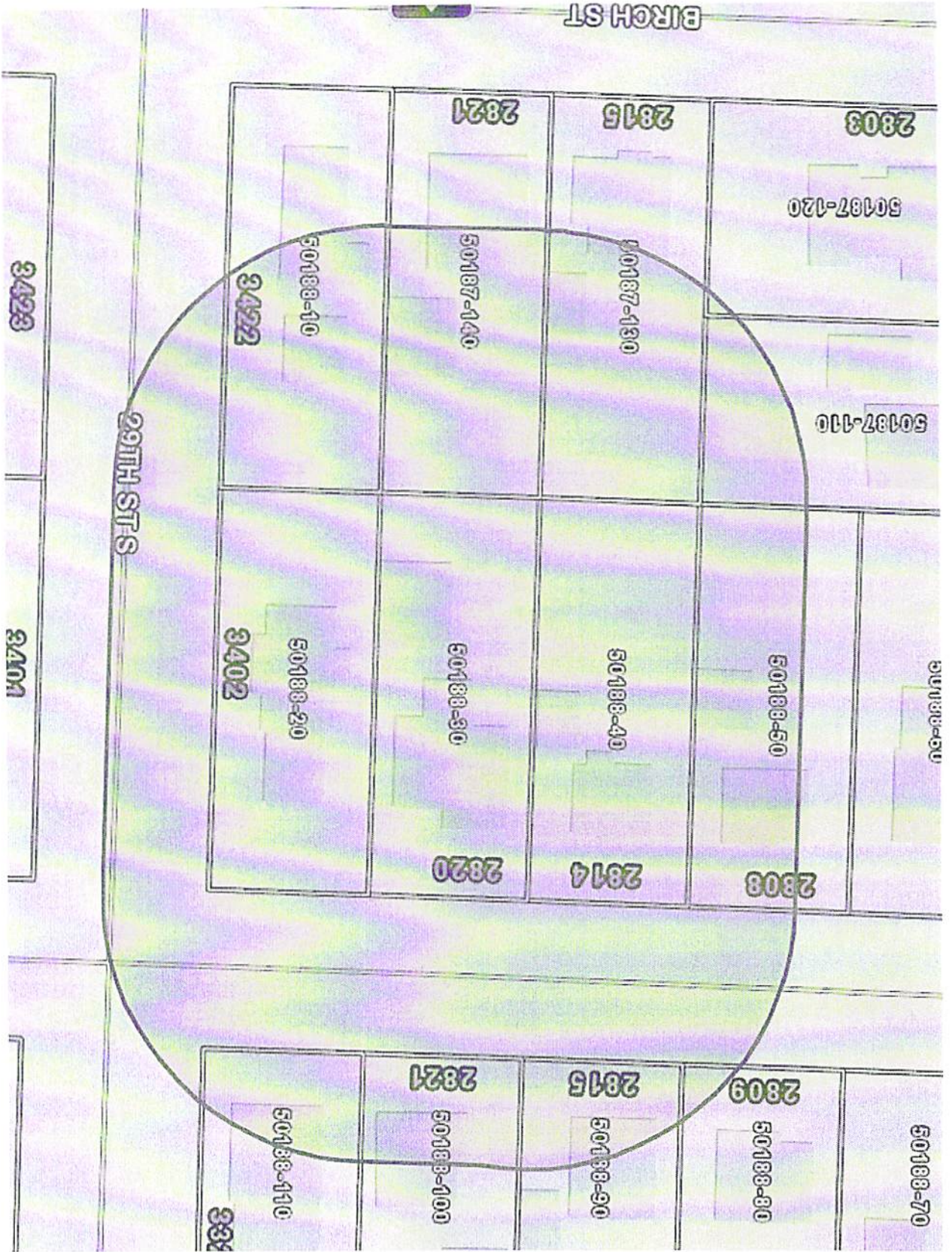

2803

50187-120

50187-110

50188-60

50188-50

2808

50188-70

2809

50188-80

2815

50187-130

50188-40

2814

2815

50188-90

2821

50187-140

50188-30

2820

2821

50188-100

50188-10

50188-20

50188-110

3422

3402

332

29TH ST S

3423

3401

OwnerName	MailingLine4	MailingLine5
GREGORY P OLDENBURG	2809 LEONARD ST	LA CROSSE WI 54601-7973
ET AL, TODD A, MARK T OLSON, KATHLEEN A LABEAUSE (LE) HOWARD J, ANITA M OLSON	2815 LEONARD ST	LA CROSSE WI 54601-7973
JOHN D GARTNER	2821 LEONARD ST	LA CROSSE WI 54601-7973
MAY YE YANG	3322 29TH ST S	LA CROSSE WI 54601-7914
KRISTINA L CRANDALL	2808 LEONARD ST	LA CROSSE WI 54601-7941
CYNTHIA L NICHOLS	2814 LEONARD ST	LA CROSSE WI 54601
SCHATZLEY FAMILY TRUST	2820 LEONARD ST	LA CROSSE WI 54601-7941
STEVEN & JENNIFER M CASH	3402 29TH ST S	LA CROSSE WI 54601-7915
KRAIG A KLEDEHN	3419 28TH ST S	LA CROSSE WI 54601-7929
LAURIE LACHMAN & DANIEL PETERSEN	2815 BIRCH ST	LA CROSSE WI 54601-7920
LESLIE J HELGERSON, LANA M LANG (LE) MARIE A HELGERSON	2821 BIRCH ST	LA CROSSE WI 54601
ROBERT G SIMPSON CAROL M STOCKFORD HASTINGS	3422 29TH ST S	LA CROSSE WI 54601-7915
GORDON E, MARY ANN DREVES	2803 BIRCH ST	LA CROSSE WI 54601-7920

MAILING

OBJECTID	Tax Parcel Number	OwnerName	MailingLine4	MailingLine5	Property Address
25242	17-50188-80	GREGORY P OLDENBURG	2809 LEONARD ST	LA CROSSE WI 54601-7973	2809 LEONARD ST
25244	17-50188-90	ET AL, TODD A, MARK T OLSON, KATHLEEN A LABEAUSE (LE) HOWARD J, ANITA M OLSON	2815 LEONARD ST	LA CROSSE WI 54601-7973	2815 LEONARD ST
25250	17-50188-100	JOHN D GARTNER	2821 LEONARD ST	LA CROSSE WI 54601-7973	2821 LEONARD ST
25252	17-50188-110	MAY YE YANG	3322 29TH ST S	LA CROSSE WI 54601-7914	3322 29TH ST S
25316	17-50188-50	KRISTINA L CRANDALL	2808 LEONARD ST	LA CROSSE WI 54601-7941	2808 LEONARD ST
25317	17-50188-40	CYNTHIA L NICHOLS	2814 LEONARD ST	LA CROSSE WI 54601	2814 LEONARD ST
25319	17-50188-30	SCHATZLEY FAMILY TRUST	2820 LEONARD ST	LA CROSSE WI 54601-7941	2820 LEONARD ST
25320	17-50188-20	STEVEN E, JENNIFER M CASH	3402 29TH ST S	LA CROSSE WI 54601-7915	3402 29TH ST S
25440	17-50187-110	KRAIG A KLEDEHN	3419 28TH ST S	LA CROSSE WI 54601-7929	3419 28TH ST S
25441	17-50187-130	LAURIE R LACHMAN DANIEL R PETERSEN	2815 BIRCH ST	LA CROSSE WI 54601-7920	2815 BIRCH ST
25442	17-50187-140	LESLIE J HELGERSON, LANA M LANG (LE) MARIE A HELGERSON	2821 BIRCH ST	LA CROSSE WI 54601	2821 BIRCH ST
25443	17-50188-10	ROBERT G SIMPSON CAROL M STOCKFORD HASTINGS	3422 29TH ST S	LA CROSSE WI 54601-7915	3422 29TH ST S
25480	17-50187-120	GORDON E, MARY ANN DREVES	2803 BIRCH ST	LA CROSSE WI 54601-7920	2803 BIRCH ST

ORIGINAL