

#### LEGEND

- REMOVE EXISTING PLANT MATERIAL FROM SITE
- CONCRETE PAVEMENT & STONE STAIR REMOVAL
- RETAINING WALL REMOVAL
- UTILITY STRUCTURE REMOVAL
- STONE CONSTRUCTION ENTRANCE
- SILT FENCE

#### GENERAL NOTES

- THE BASE SURVEY WAS PREPARED BY OTHERS. ADDITIONAL SYMBOLS AND FEATURES HAVE BEEN ADDED TO REPRESENT APPROXIMATE EXISTING CONDITIONS. ALL UNDERGROUND UTILITIES AND STRUCTURES HAVE BEEN SHOWN TO A REASONABLE DEGREE OF ACCURACY AND IT SHALL BE THE CONTRACTOR'S RESPONSIBILITY TO VERIFY THEIR EXACT LOCATION AND TO AVOID DAMAGE THERETO.
- REFER TO SURVEY FOR BENCHMARKS, DATUM, AND TOPOGRAPHIC ELEMENTS.
- CONTRACTOR SHALL VERIFY LOCATION OF WORK AND REPORT ANY DISCREPANCIES TO THE ENGINEER PRIOR TO COMMENCING WORK.

#### REMOVAL NOTES

- EXISTING CONDITIONS SHALL BE VERIFIED BY THE CONTRACTOR AND DISCREPANCIES SHALL BE REPORTED TO THE ENGINEER PRIOR TO COMMENCING WORK.
- CONTRACTOR SHALL VERIFY ALL EXISTING UTILITY LINES NOTED FOR ABANDONMENT OR REMOVAL. EXISTING UTILITIES THAT ARE TO BE ABANDONED OR REMOVED SHALL BE RESPECTIVELY ABANDONED OR REMOVED TO THE LOCATIONS INDICATED ON THIS PLAN. ALL UTILITY STRUCTURES LOCATED ALONG REMOVED UTILITY LINES SHALL BE REMOVED IN THEIR ENTIRETY.
- CONCRETE SIDEWALK NOTED FOR REMOVAL SHALL BE REMOVED AT THE NEAREST JOINT.
- ITEMS SCHEDULED FOR REMOVAL AND EXCESS EXCAVATED MATERIALS SHALL BE DISPOSED OF OFF-SITE IN ACCORDANCE WITH ANY APPLICABLE REGULATIONS.
- CONTRACTOR IS RESPONSIBLE FOR SECURING THE JOB SITE TO PROTECT THE PUBLIC.
- CONTRACTOR SHALL COMPLY WITH LOCAL, STATE, AND FEDERAL CODES, RULES AND REGULATIONS APPLICABLE TO DEMOLITION WORK INCLUDING BUT NOT LIMITED TO EROSION CONTROL, AIR POLLUTION, NOISE POLLUTION, AND WASTE DISPOSAL.
- CONTRACTOR SHALL REPLACE PAVEMENT, CURB AND GUTTER, TREES, LAWN AREA, ANY ABOVE GROUND APPURTENANCES, OR ANY OTHER ITEM THAT WAS DAMAGED AS A RESULT OF CONSTRUCTION RELATED ACTIVITIES AS DEMAED BY OWNERS REPRESENTATIVE THAT WAS NOT CALLED OUT FOR REMOVAL OR REPLACEMENT. CONTRACTOR SHALL REPLACE/REPAIR DAMAGED ITEM TO THE SATISFACTION OF OWNER'S REPRESENTATIVE AT NO ADDITIONAL COST TO THE OWNER.

#### EROSION CONTROL NOTES:

- CONSTRUCTION SITE EROSION CONTROL AND SEDIMENTATION CONTROL SHALL COMPLY WITH THE REQUIREMENTS OF THE CITY OF LA CROSSE, AND SHALL EMPLOY EROSION CONTROL METHODS AS SHOWN AND SPECIFIED IN THE MINNESOTA DEPARTMENT OF NATURAL RESOURCES (MNDNR) "CONSTRUCTION SITE EROSION AND SEDIMENT CONTROL TECHNICAL STANDARDS".
- ALL EROSION CONTROL MEASURES SHALL BE ADJUSTED TO MEET FIELD CONDITIONS AT THE TIME OF CONSTRUCTION AND SHALL BE INSTALLED PRIOR TO ANY GRADING OR DISTURBANCE OF EXISTING SURFACE MATERIAL ON THE SITE.
- ALL EROSION AND SEDIMENT CONTROL MEASURES WILL BE CHECKED FOR STABILITY AND OPERATION AFTER A RAINFALL OF 0.5 INCHES OR MORE, BUT NO LESS THAN ONCE EVERY WEEK. MAINTENANCE OF ALL EROSION CONTROL STRUCTURES SHALL BE PROVIDED TO INSURE INTENDED PURPOSE IS ACCOMPLISHED. REPAIRS AND MAINTENANCE SHALL BE COMPLETED WITHIN 24 HOURS OF INSPECTION. CONTRACTOR SHALL BE RESPONSIBLE FOR CLEANUP AND REMOVAL OF ALL SEDIMENT WHEN LEAVING PROPERTY. EROSION CONTROL MEASURES MUST BE IN WORKING CONDITION AT END OF EACH WORK DAY.
- FILTER FABRIC SHALL BE INSTALLED BENEATH INLET COVERS TO TRAP SEDIMENT AS PER INLET PROTECTION DETAIL IN THE LOCATIONS SHOWN ON THE CONSTRUCTION PLANS OR AS DIRECTED BY THE ENGINEER.
- INLET PROTECTION SHALL BE PROVIDED ON ALL EXISTING AND PROPOSED STORM INLETS WITHIN THE PROJECT LIMITS. ALL EXISTING STORM INLETS WITHIN 200 FEET DOWNSTREAM OF THE PROJECT LIMITS SHALL HAVE INLET PROTECTION.
- EROSION CONTROL MEASURES SHALL BE MAINTAINED ON A CONTINUING BASIS UNTIL SITE IS FULLY STABILIZED.
- PERIODIC STREET SWEEPING SHALL BE COMPLETED TO MAINTAIN THE PUBLIC STREET FREE OF DUST AND DIRT.
- CONSTRUCTION SEQUENCE FOR EROSION CONTROL INCLUDES:
  - INSTALL SILT FENCE AND INLET PROTECTION.
  - INSTALL UTILITIES. INSTALL INLET PROTECTION ON NEW INLETS.
  - INSTALL PAVEMENTS.
  - INSTALL LANDSCAPING ON COMPLETED SITE WITHIN 7 DAYS OF COMPLETING CONSTRUCTION.
  - REMOVE EROSION CONTROL MEASURES ONLY WHEN SITE IS FULLY STABILIZED.
- SITE DEWATERING. WATER PUMPED FROM THE SITE SHALL BE TREATED BY SEDIMENT BASINS OR OTHER APPROPRIATE BEST MANAGEMENT PRACTICES SPECIFIED IN THE WDNR "CONSTRUCTION SITE EROSION AND SEDIMENT CONTROL TECHNICAL STANDARDS". WATER SHALL NOT BE DISCHARGED IN A MANNER THAT CAUSES EROSION OF THE SITE, ADJACENT SITES, OR RECEIVING CHANNELS.
- WASTE AND MATERIAL DISPOSAL. ALL WASTE AND UNUSED BUILDING MATERIALS (INCLUDING GARBAGE, DEBRIS, CLEANING WASTES, WASTEWATER, TOXIC MATERIALS, OR HAZARDOUS MATERIALS) SHALL BE PROPERLY DISPOSED AND NOT ALLOWED TO BE CARRIED OFF-SITE BY RUNOFF OR WIND.
- TRACKING. EACH SITE SHALL HAVE GRAVELED ROADS, ACCESS DRIVES OR PARKING AREAS OF SUFFICIENT WIDTH AND LENGTH TO PREVENT SEDIMENT FROM BEING TRACKED ONTO PUBLIC OR PRIVATE ROADWAYS. ANY SEDIMENT REACHING A PUBLIC OR PRIVATE ROAD SHALL BE REMOVED BY STREET CLEANING, TO THE SATISFACTION OF THE CITY, BEFORE THE END OF EACH WORKDAY. FLUSHING MAY NOT BE USED UNLESS SEDIMENT WILL BE CONTROLLED BY A SEDIMENT BASIN OR OTHER APPROPRIATE BEST MANAGEMENT PRACTICE SPECIFIED IN THE WDNR "CONSTRUCTION SITE EROSION AND SEDIMENT CONTROL TECHNICAL STANDARDS". NOTIFY CITY OF LA CROSSE FOR CHANGES IN CONSTRUCTION ENTRANCE LOCATION.
- SEDIMENT CLEANUP. ALL OFF-SITE SEDIMENT DEPOSITS OCCURRING AS A RESULT OF A STORM EVENT SHALL BE CLEANED UP BY THE END OF THE NEXT WORK DAY. ALL OTHER OFF-SITE SEDIMENT DEPOSITS OCCURRING AS A RESULT OF CONSTRUCTION ACTIVITIES SHALL BE CLEANED UP BY THE END OF THE WORK DAY.
- ALL DISTURBED GROUND LEFT INACTIVE FOR SEVEN OR MORE DAYS SHALL BE STABILIZED BY TEMPORARY OR PERMANENT SEEDING, AND MULCHING SODDING, COVERING WITH TARPS, OR EQUIVALENT BEST MANAGEMENT PRACTICES. IF TEMPORARY SEEDING IS USED, A PERMANENT COVER SHALL ALSO BE REQUIRED AS PART OF THE FINAL SITE STABILIZATION. SEEDING OR SODDING SHALL BE REQUIRED AS PART OF THE FINAL SITE STABILIZATION.
- PERMANENT SEEDING SHALL BE ESTABLISHED NO LATER THAN SEPTEMBER 15TH. IF PERMANENT SEEDING IS NOT ESTABLISHED, TEMPORARY SEEDING SHALL BE ESTABLISHED NO LATER THAN OCTOBER 15TH. ALL SEEDED AREAS MUST BE MULCHED AT A RATE OF 1.5 TO 2 TONS PER ACRE AND ANCHORED BY EITHER CRIMPING OR BY APPLYING A TACKIFIER.
- PERMANENT SEED MIX SHALL BE WISDOT SEED MIX NO. 40 (OR MNDOT EQUIVALENT) AT 7 POUNDS PER 1000 SQUARE FEET.
- SOIL OR DIRT STORAGE PILES SHALL BE LOCATED A MINIMUM OF TWENTY-FIVE FEET FROM ANY DOWNSLOPE ROAD, LAKE, STREAM, WETLAND, OR DRAINAGE CHANNEL. STRAW BALE OR FILTER FABRIC FENCES SHALL BE PLACED ON THE DOWN SLOPE SIDE OF THE PILE. IF REMAINING FOR MORE THAN THIRTY DAYS. PILES SHALL BE STABILIZED BY MULCHING, VEGETATIVE COVER, TARPS, OR OTHER MEANS.
- WHEN THE DISTURBED AREA HAS BEEN STABILIZED BY PERMANENT VEGETATION OR OTHER MEANS, TEMPORARY BEST MANAGEMENT PRACTICES SHALL BE REMOVED.
- NOTIFY THE CITY WITHIN TWO WORKING DAYS OF COMMENCING ANY LAND DEVELOPMENT OR LAND DISTURBING ACTIVITY.
- NOTIFY THE CITY OF COMPLETION OF ANY BEST MANAGEMENT PRACTICES WITHIN THE NEXT WORKING DAY AFTER THEIR INSTALLATION.
- OBTAIN PERMISSION IN WRITING FROM THE CITY OF LA CROSSE ENGINEERING DEPARTMENT PRIOR TO MODIFYING THE EROSION CONTROL PLAN. NOTIFY MNDNR AT LEAST FIVE WORKING DAYS PRIOR TO IMPLEMENTING CHANGES TO THE EROSION CONTROL PLAN.
- REPAIR ANY SILTATION OR EROSION DAMAGE TO ADJOINING SURFACES AND DRAINAGE WAYS RESULTING FROM LAND DEVELOPMENT OR LAND DISTURBING ACTIVITIES.
- KEEP A COPY OF THE EROSION CONTROL PLAN ON SITE.

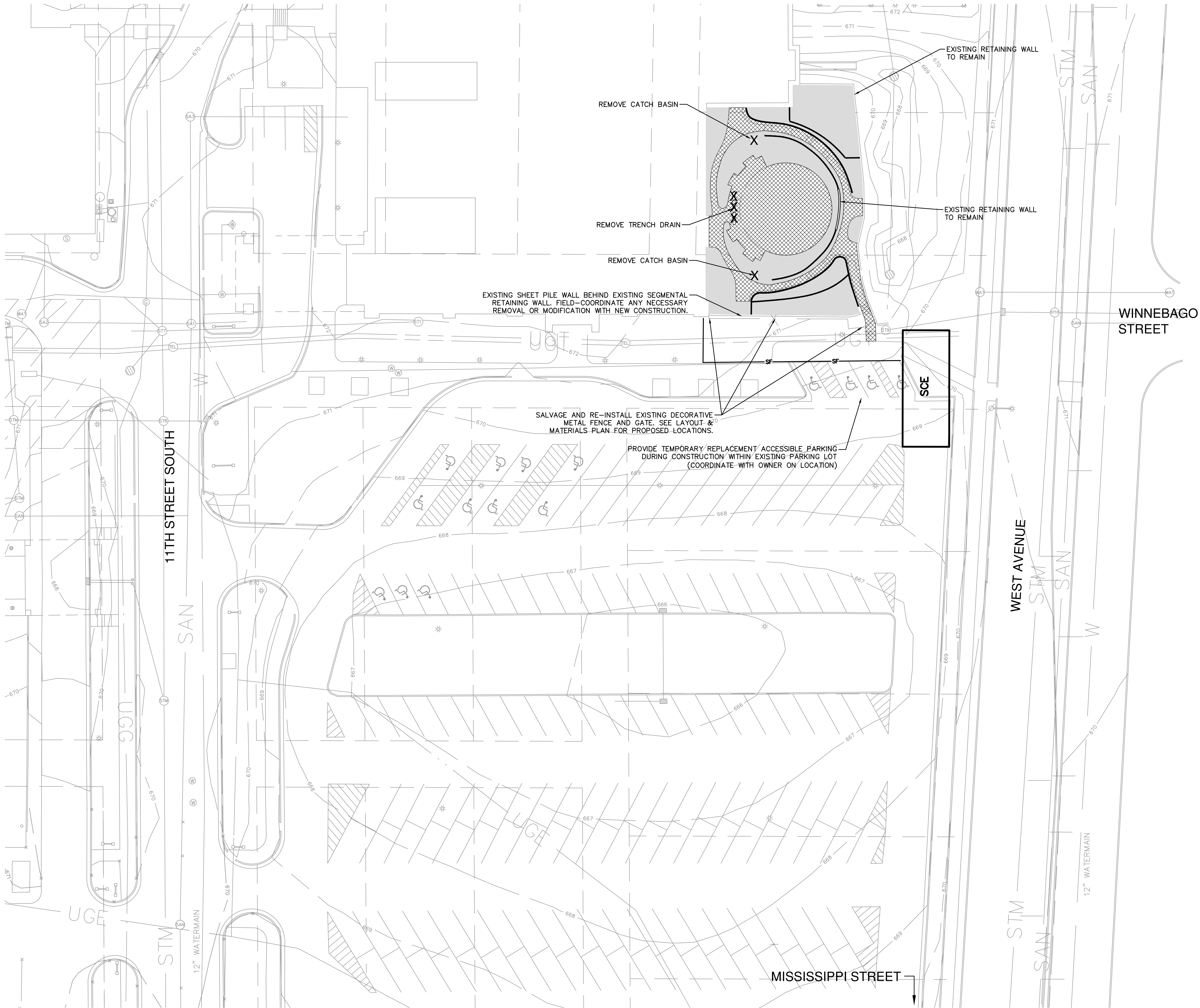

NOTICE:  
In accordance with Wisconsin statute 182.0175, damage to transmission facilities, excavator shall be solely responsible to provide advance notice to the designated "ONE CALL SYSTEM" not less than three working days prior to commencement of any excavation required to perform work contained on this drawing, and further, excavator shall comply with all other requirements of this statute relative to excavator's work.

DISCLAIMER:  
The underground utilities shown have been located from field survey information and existing drawings. GRAEF makes no guarantees that the underground utilities shown comprise all such utilities in the area, either in service or abandoned. GRAEF further does not warrant that the underground utilities shown are in the exact location indicated. GRAEF has not physically located the underground utilities.

#### Revisions

#### CONSTRUCTION DOCUMENTS

Drawing Date

07/10/2018

## MAYO CLINIC HEALTH SYSTEM CENTER FOR ADVANCED MEDICINE & SURGERY BUILDING ADDITION AND ALTERATIONS

700 West Avenue South, La Crosse, WI 54601

Project No.

MCHS

217050

Sheet Title

## SITE DEMOLITION & EROSION CONTROL PLAN

Copyright © 2018 Kahler Slater, Inc. All rights reserved.

111 West Wisconsin Avenue, Milwaukee, Wisconsin 53203

Telephone 414.272.2000 Fax 414.272.2001

44 East Mifflin Street, Suite 700, Madison, Wisconsin 53703

Telephone 608.263.6300 Fax 608.263.6317

Sheet No.

C100



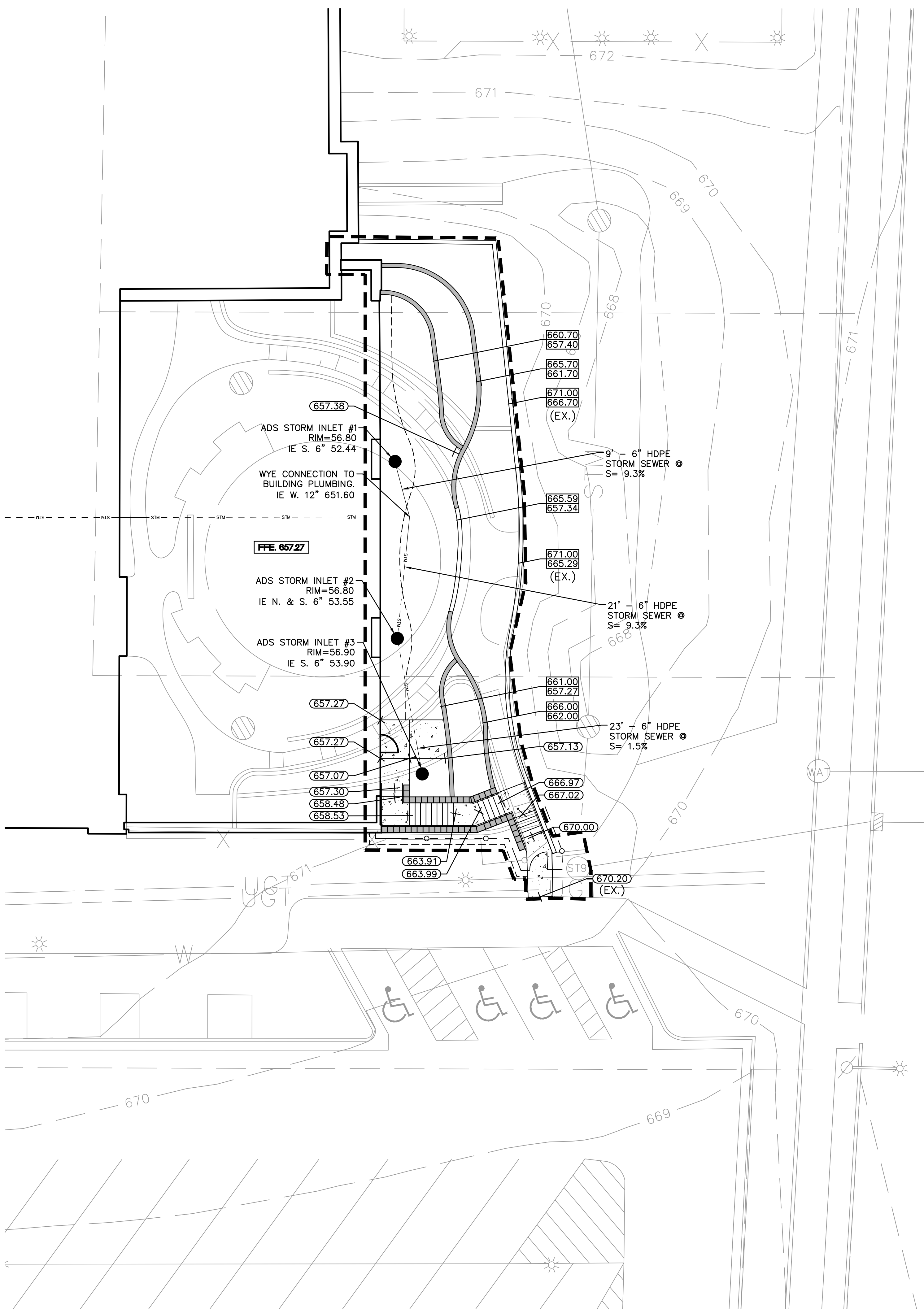
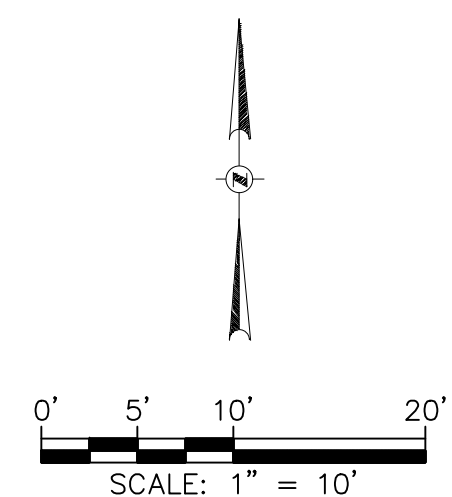

## LEGEND

- 
- LIMIT OF CONSTRUCTION
  - STM— PROPOSED STORM SEWER
  - PROPOSED CATCH BASIN
  - 100— EXISTING CONTOUR
  - .....100..... PROPOSED CONTOUR
  - PROPOSED TOP OF WALL/BOTTOM OF WALL
  - PROPOSED SPOT ELEVATION

## GENERAL NOTES

1. THE BASE SURVEY WAS PREPARED BY OTHERS. ALL UNDERGROUND UTILITIES AND STRUCTURES HAVE BEEN SHOWN TO A REASONABLE DEGREE OF ACCURACY AND IT SHALL BE THE CONTRACTOR'S RESPONSIBILITY TO VERIFY THEIR EXACT LOCATION AND TO AVOID DAMAGE THERETO.
2. BUILDING LATERALS SHALL BE CONSTRUCTED IN ACCORDANCE WITH LOCAL AND STATE PLUMBING CODES. SITE UTILITY CONTRACTOR SHALL LOCATE LATERALS AT LEAST 5 FEET OUTSIDE BUILDING. SEE INTERIOR PLUMBING PLANS FOR CONTINUATION OF PIPING INTO BUILDING BY BUILDING PLUMBING CONTRACTOR
3. GENERAL CONTRACTOR SHALL COORDINATE WITH LOCAL GAS, TELEPHONE, AND ELECTRICAL UTILITIES FOR EXACT LOCATION, SIZE AND DEPTH OF NEW SERVICE.
4. STORM SEWER SHALL BE HDPE, ASTM F2648, TYPE S UNLESS INDICATED OTHERWISE.
5. INLETS SHALL BE ADS NYOPLAST PART 7001-110-396 DRAIN BASIN WITH DOME GRATE, OR APPROVED EQUAL.
6. PIPE LENGTHS AND INVERTS ARE TO CENTER OF STRUCTURES.

## GRADING NOTES

1. ADA REGULATIONS REQUIRE A MAXIMUM SLOPE OF 1:20 (5%) ALONG THE LENGTH OF THE ACCESSIBLE ROUTE AND A MAXIMUM SLOPE OF 1:50 (2%) ACROSS THE WIDTH OF THE ACCESSIBLE ROUTE. ADA REGULATIONS REQUIRE A MAXIMUM SLOPE OF 1:50 (2%) IN ALL DIRECTIONS WITHIN AN ADA PARKING STALL AND ADJACENT UNLOADING ZONE.

## Revisions

CONSTRUCTION DOCUMENTS

Drawing Date  
07/10/2018

MAYO CLINIC HEALTH  
SYSTEM CENTER FOR  
ADVANCED MEDICINE  
& SURGERY BUILDING  
ADDITION AND  
ALTERATIONS

700 West Avenue South, La Crosse, WI 54601

Project No.	MCHS
217050	

Sheet Title

## GRADING AND DRAINAGE PLAN

Copyright © 2018 Kahler Slater, Inc. All rights reserved.

111 West Wisconsin Avenue, Milwaukee, Wisconsin 53203  
Telephone 414.272.2000 Fax 414.272.2001

44 East Mifflin Street, Suite 700, Madison, Wisconsin 53703  
Telephone 608.283.6300 Fax 608.283.6317

Sheet No. \_\_\_\_\_









C200

NOTICE:  
In accordance with Wisconsin statute 182.0175, damage to transmission facilities, excavator shall be solely responsible to provide advance notice to the designated "ONE CALL SYSTEM" not less than three working days prior to commencement of any excavation required to perform work contained on this drawing, and further, excavator shall comply with all other requirements of this statute relative to excavator's work.

**DISCLAIMER:**  
The underground utilities shown have been located from field survey information and existing drawings. GRAEF makes no guarantees that the underground utilities shown comprise all such utilities in the area, either in service or abandoned. GRAEF further does not warrant that the underground utilities shown are in the exact location indicated. GRAEF has not physically located the underground utilities.





-  -LIMIT OF CONSTRUCTION  
 -CONCRETE SIDEWALK   
 -DRY-LAID STONE RETAINING WALL   
 -SEGMENTAL BLOCK RETAINING WALL   

## LAYOUT NOTES

1. THE BUILDING OUTLINES SHOWN ARE FOR REFERENCE PURPOSES ONLY AND SHALL NOT BE USED FOR STAKING PURPOSES. THE CONTRACTOR SHALL COORDINATE WITH THE ARCHITECT AND STRUCTURAL ENGINEER ON THE STAKING OF THE BUILDING.
2. ALL DIMENSIONS SHOWN ARE TO THE EDGE OF PAVEMENT, FACE OF BUILDING, OR FACE OF RETAINING WALL.
3. REFER TO LANDSCAPING PLANS FOR SITE RESTORATION INFORMATION AND DETAILS.
4. CONTRACTOR SHALL SUBMIT A CONCRETE JOINTING PLAN TO THE ENGINEER FOR REVIEW AND APPROVAL PRIOR TO COMMENCING CONSTRUCTION. JOINTING PLAN SHALL INDICATE: POSITION, LENGTH, LOCATION OF CONSTRUCTION ISOLATION, CONTRACTION JOINTS, AND TYPE OF REINFORCEMENT.
5. CONTRACTOR TO CONFIRM RETAINING WALL REINFORCEMENT REQUIREMENTS BASED UPON STRUCTURAL ENGINEER'S RECOMMENDATIONS.

## RETAINING WALL MATERIAL AND ALTERNATES

1. BASE BID - OUTCROPPING LIMESTONE WITH WEATHERED FRONT FACE AND BED FACED TOP. COLOR RANGE TO BE GRAY, BUFF AND GOLDEN HUES.
2. ALTERNATE #1 - LIMESTONE WEATHERED EDGE CUT WALL STONE WITH SPLIT FACE, SNAPPED ENDS, AND BED FACED TOP. COLOR RANGE TO BE GRAY, BUFF AND GOLDEN HUES.
3. ALTERNATE #2 - VERSA-LOK STANDARD 6" SEGMENTAL RETAINING WALL. COLOR TO MATCH EXISTING.

## Revisions

CONSTRUCTION DOCUMENTS

Drawing Date  
07/10/2018

MAYO CLINIC HEALTH  
SYSTEM CENTER FOR  
ADVANCED MEDICINE  
& SURGERY BUILDING  
ADDITION AND  
ALTERATIONS

700 West Avenue South, La Crosse, WI 54601

Project No.	MCHS
217050	

Sheet Title

## LAYOUT AND MATERIALS PLAN

Copyright © 2018 Kahler Slater, Inc. All rights reserved.  
111 West Wisconsin Avenue, Milwaukee, Wisconsin 53203  
Telephone 414.272.2000 Fax 414.272.2001  
  
44 East Mifflin Street, Suite 700, Madison, Wisconsin 53703  
Telephone 608.283.6300 Fax 608.283.6317

Sheet No. \_\_\_\_\_

C300

NOTICE:  
In accordance with Wisconsin statute 182.0175, damage to transmission facilities, excavator shall be solely responsible to provide advance notice to the designated "ONE CALL SYSTEM" not less than three working days prior to commencement of any excavation required to perform work contained on this drawing, and further, excavator shall comply with all other requirements of this statute relative to excavator's work.

**DISCLAIMER:**  
The underground utilities shown have been located from field survey information and existing drawings. GRAEF makes no guarantees that the underground utilities shown comprise all such utilities in the area, either in service or abandoned. GRAEF further does not warrant that the underground utilities shown are in the exact location indicated. GRAEF has not physically located the underground utilities.

AREA DRAIN - SEE GRADING  
AND DRAINAGE PLAN - C200

EXISTING  
BUILDING



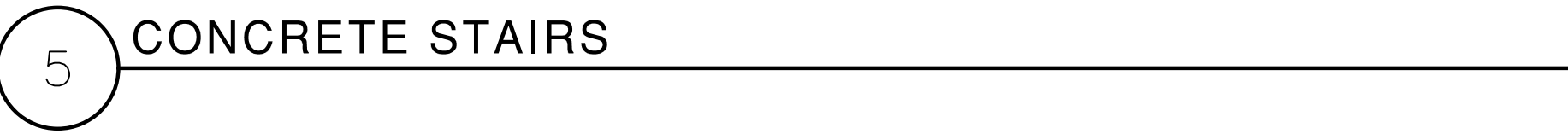

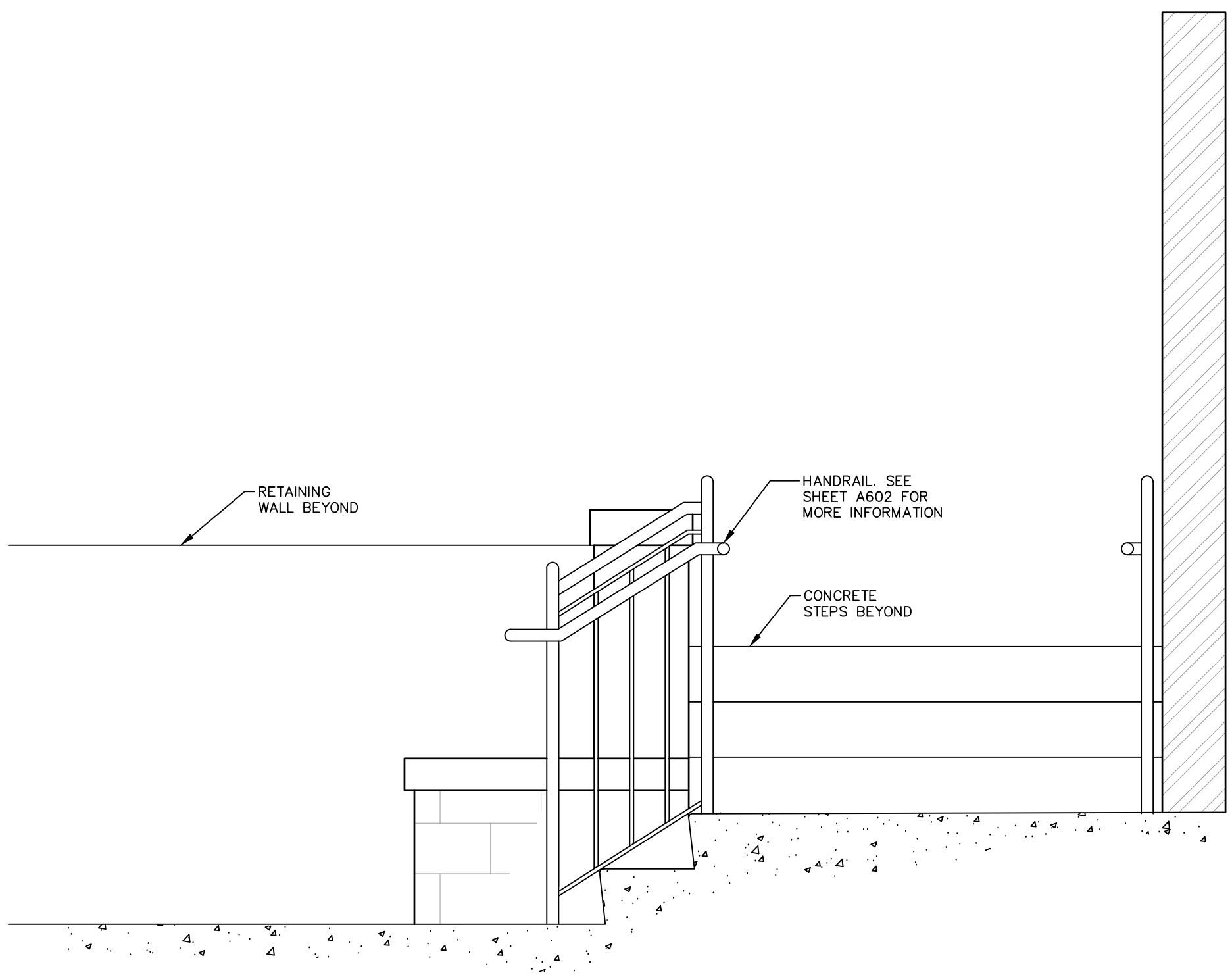

2 STAIR AND RAILING SECTION

REFER TO SITE PLAN FOR LOCATIONS

1/8"=1'-0"

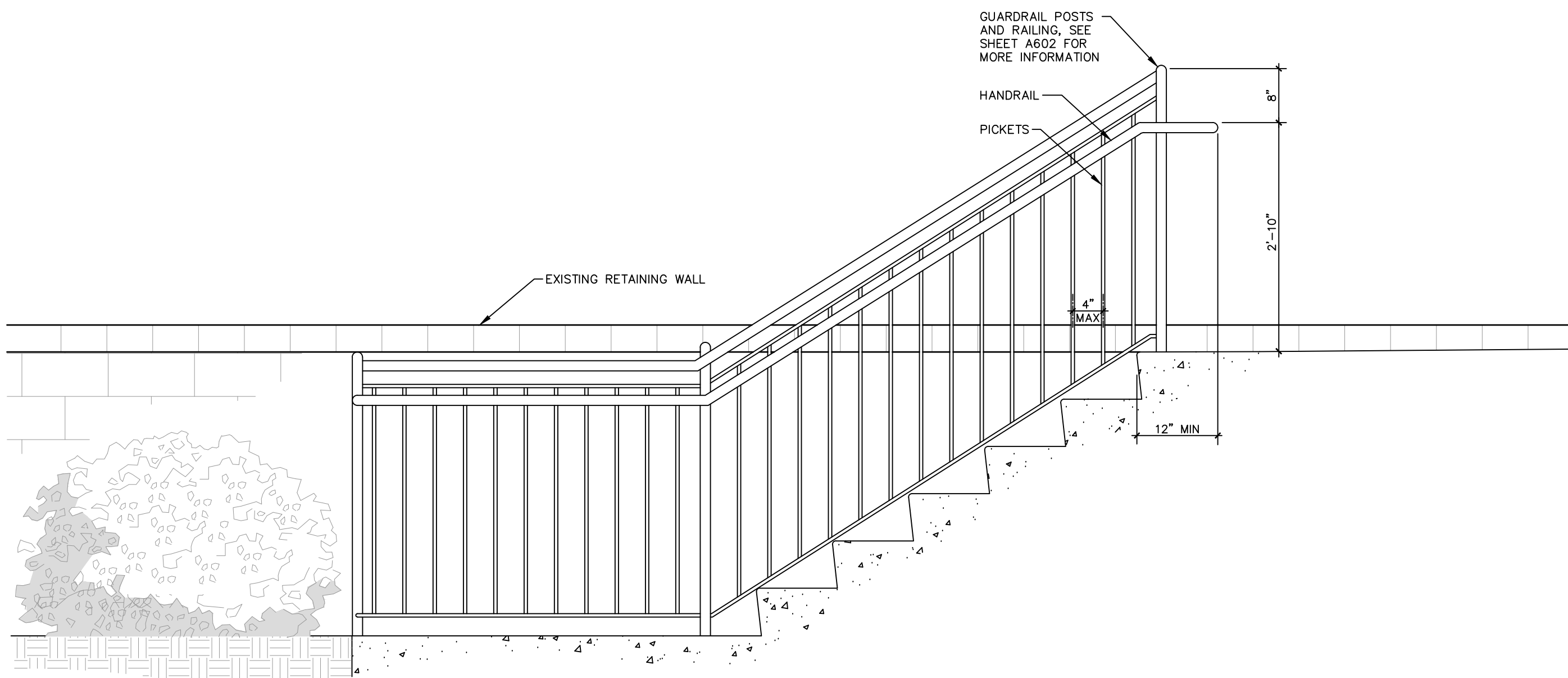

1 STAIR AND RAILING SECTION

REFER TO SITE PLAN FOR LOCATIONS

1/8"=1'-0"

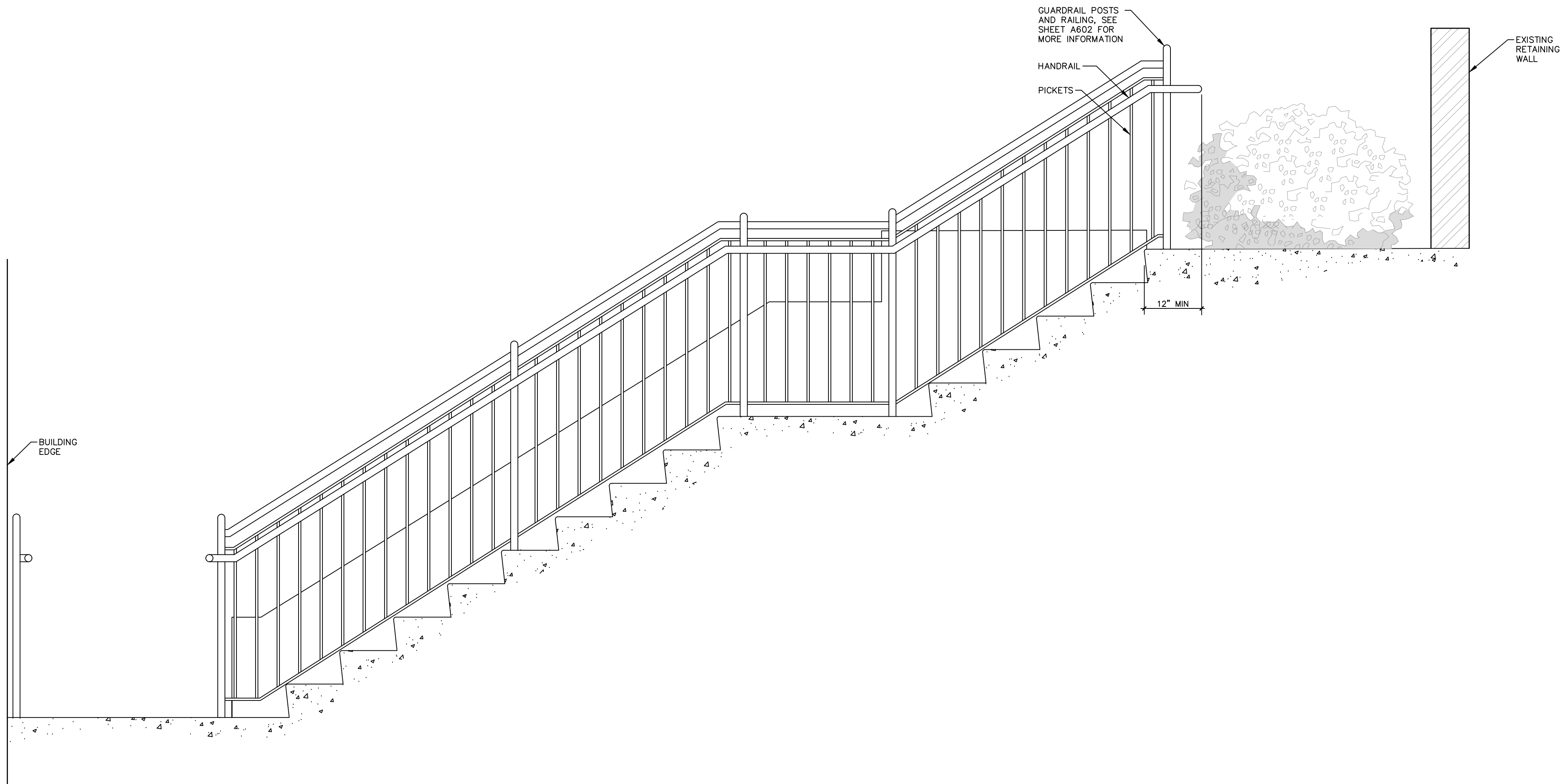

3 STAIR AND RAILING SECTION

REFER TO SITE PLAN FOR LOCATIONS

1/8"=1'-0"

NOTICE:  
In accordance with Wisconsin statute 182.0175, damage to transmission facilities, excavator shall be solely responsible to provide advance notice to the designated "ONE CALL SYSTEM" not less than three working days prior to commencement of any excavation required to perform work contained on this drawing, and further, excavator shall comply with all other requirements of this statute relative to excavator's work.

DISCLAIMER:  
The underground utilities shown have been located from field survey information and existing drawings. GRAEF makes no guarantees that the underground utilities shown comprise all such utilities in the area, either in service or abandoned. GRAEF further does not warrant that the underground utilities shown are in the exact location indicated. GRAEF has not physically located the underground utilities.

Revisions

CONSTRUCTION DOCUMENTS

Drawing Date  
07/10/2018

MAYO CLINIC HEALTH  
SYSTEM CENTER FOR  
ADVANCED MEDICINE  
& SURGERY BUILDING  
ADDITION AND  
ALTERATIONS

700 West Avenue South, La Crosse, WI 54601

Project No. MCHS  
217050

Sheet Title

CONSTRUCTION  
DETAILS

Copyright © 2018 Kahler Slater, Inc. All rights reserved.  
111 West Wisconsin Avenue, Milwaukee, Wisconsin 53203  
Telephone 414.272.2000 Fax 414.272.2001  
44 East Milton Street, Suite 700, Madison, Wisconsin 53703  
Telephone 608.263.6300 Fax 608.263.6317

Sheet No.  
C901



- PLANT NAMES ARE ABREVIATED ON THE DRAWINGS. SEE PLANT LIST FOR SYMBOLS, ABBREVIATIONS, BOTANICAL/COMMON NAMES, SIZES, ESTIMATED QUANTITIES (IF GIVEN) AND OTHER REMARKS.
2. PLANT MATERIALS ARE TO BE FURNISHED FREE OF PESTS OR PLANT DISEASES. PLANTS ARE SUBJECT TO OWNER'S ACCEPTANCE PRIOR TO INSTALLATION.
3. ALL PLANT BEDS ARE TO RECEIVE 3" DEEP LAYER OF SHREDDED HARDWOOD BARK MULCH (NATURAL COLOR) WHERE INDICATED ON THE DRAWINGS.
4. FOR ALL TOPSOIL TO BE USED IN PLANT BED AREAS, SUBMIT MINIMUM OF 2 SAMPLES TO INDEPENDENT TESTING FIRM FOR ANALYSIS AND RECOMMENDATIONS ON SPECIFIC AMENDMENTS TO BE ADDED IN ORDER TO ACHIEVE OPTIMUM PLANT GROWTH. AMEND TOPSOIL AS RECOMMENDED BY SOILS TEST ANALYSIS PRIOR TO PLACEMENT ON SITE AND PREPARATION AS DESCRIBED BELOW.
5. PREPARATION OF PLANTING BEDS FOR SHRUBS, PERENNIALS, AND ORNAMENTAL GRASSES:
  - 5.1. INSTALL FULLY-AMENDED TOPSOIL PER SOILS TEST ANALYSIS TO 18" MIN. DEPTH. INSTALL USING 8" MAX. LIFTS.
  - 5.2. REMOVE STONES OVER 1" IN ANY DIMENSION. REMOVE STICKS, RUBBISH AND OTHER EXTRANEOUS MATTER.
  - 5.3. EVENLY SPREAD 2" OF ORGANIC COMPOST OVER ENTIRE PLANT BED AREA. APPLY FERTILIZER SUITABLE FOR PLANT BEDS AT RATE RECOMMENDED BY MANUFACTURER.
  - 5.4. THOROUGHLY BLEND ORGANIC COMPOST AND FERTILIZER INTO TOP 8" OF TOPSOIL USING ROTOTILLER OR SIMILAR EQUIPMENT. SOW FINISHED GRASSES TO REIN IN OR HIGHER THAN FINAL GRADES SHOWN ON THE DRAWINGS TO ANTICIPATE SETTLEMENT OVER THE FIRST YEAR. AT END OF WARRANTY PERIOD, ADJUST THE GRADES IN PLANT BEDS, IF REQUIRED, TO THE FINAL GRADES SHOWN ON THE DRAWINGS.
  - 5.5. SPACE PLANTS AS INDICATED ON THE DRAWINGS.
6. SEPARATE PLANTING BEDS FROM ADJACENT DECORATIVE CRUSHED STONE WITH 3/16" x 4" BLACK ALUMINUM EDGING WHERE SHOWN ON THE LANDSCAPE PLAN. ANCHOR WITH MIN. 15" LONG STAKES AT 5' ON CENTER.
7. LANDSCAPE CONTRACTOR TO PROVIDE TREE STAKES AND GUYS WITH FLEXIBLE TREE TIE WEBBING STRAPS IF REQUIRED. SEE DETAILS FOR MORE INFORMATION.
8. REPAIR AND RESTORE ANY EXISTING LAWN AREAS DISTURBED BY CONSTRUCTION ACTIVITIES WITH MANICURED TURF SEED. SEE BELOW FOR MORE INFORMATION AND SEED SPECIFICATION.
9. MAINTAIN PLANT LIFE IMMEDIATELY AFTER PLANTING TO ESTABLISH HEALTHY, VIGOROUS GROWING CONDITIONS. PROVIDE MAINTENANCE SERVICES FOR A MINIMUM PERIOD OF 60 DAYS. DURING "MAINTENANCE PERIOD" PROVIDE AN ONGOING, PLEASANT VISUAL ENVIRONMENT WHERE ANY PLANT WHICH IS NOT RESPONDING TO TRANSPLANTING IS IMMEDIATELY REPLACED, DAMAGED LAWNS ARE REPAIRED, AND WEEDS ARE CONSTANTLY REMOVED WITHOUT EXCEPTION. MAINTAIN PLANTS BY PRUNING, CULTIVATING AND WEEDING AS REQUIRED FOR HEALTHY GROWTH FOR THE FULL MAINTENANCE PERIOD AND DURING THE PERIOD BEFORE FINAL ACCEPTANCE OF THE FULL PROJECT. LANDSCAPE MAINTENANCE SHALL ALSO INCLUDE:
  - 9.1. PROVIDE WATERING, AS NECESSARY, TO SUPPLEMENT SEASONAL RAINFALL AND TO MAINTAIN PROPER MOISTURE DEPTH SUITABLE FOR VIGOROUS PLANT GROWTH.
  - 9.2. TRIMMING AND PRUNING, INCLUDING REMOVAL OF CLIPPINGS AND DEAD OR BROKEN BRANCHES.
  - 9.3. APPLICATION OF PESTICIDES IN ACCORDANCE WITH MANUFACTURER'S INSTRUCTIONS. REMEDY DAMAGE RESULTING FROM USE OF PESTICIDES.
  - 9.4. DISEASE CONTROL.
  - 9.5. PROVIDING WINTER PLANT PROTECTION.
12. PROVIDE (2) FERTILIZATION APPLICATIONS TO PLANT BEDS WITHIN THE FIRST GROWING SEASON.
13. PROVIDE MIN. WARRANTY OF ONE YEAR FOR ALL LANDSCAPE MATERIALS, WARRANT PLANTS, TURF AND ALL OTHER INSTALLATIONS FOR A MINIMUM PERIOD OF ONE YEAR AFTER DATE IDENTIFIED ON CERTIFICATE OF SUBSTANTIAL COMPLETION, AGAINST DEFECTS INCLUDING DEATH AND UNSATISFACTORY GROWTH, EXCEPT FOR DEFECTS RESULTING FROM NEGLIGENCE BY OWNER, ABUSE OR DAMAGE BY OTHERS, OR UNUSUAL PHENOMENA OR INCIDENTS WHICH ARE BEYOND LANDSCAPE CONTRACTOR'S CONTROL. WARRANTY SHALL INCLUDE ONE ENTIRE CONTINUOUS GROWING SEASON. TEMPERATURE FLUCTUATIONS IN THE WEATHER, NATURAL HAZARDS, OR OTHER CLIMATIC CONDITIONS ARE NOT CONSIDERED UNUSUAL PHENOMENA AND WILL NOT WAIVE THE CONTRACTOR'S WARRANTY REQUIREMENTS. WARRANTY SHALL INCLUDE THE REMOVAL AND REPLACEMENT OF PLANTS FOUND DEAD OR IN UNHEALTHY CONDITION DURING WARRANTY PERIOD. WARRANTY SHALL INCLUDE REPLACEMENTS DURING THE GROWTH SEASON FOLLOWING THE END OF THE WARRANTY PERIOD. WARRANTY SHALL INCLUDE REPLACEMENT OF PLANTS WHICH ARE IN DOUBTFUL CONDITION AT THE END OF THE WARRANTY PERIOD; UNLESS, IN OPINION OF OWNER'S REPRESENTATIVE, IT IS ADVISABLE TO EXTEND WARRANTY PERIOD FOR A FULL GROWING SEASON. WARRANTY SHALL INCLUDE ENSURING PLANTS REMAIN IN A HEALTHY, TROPICAL CONDITION AND RENEW, TREAT, OR REPLACE ANY UNSIGHTLY PLANTS IN A TIMELY MANNER DURING WARRANTY PERIOD. AT END OF WARRANTY PERIOD, OWNER AND LANDSCAPE CONTRACTOR SHALL MAKE A JOINT INSPECTION. RENEW, TREAT, OR REPLACE PLANTS AND LAWN AREAS NOT IN HEALTHY GROWING CONDITIONS. REPLACEMENT OF NURSERY PLANTS SHALL BE TO ORIGINAL SIZE AND SPECIES. TURF SHALL BE REPLACED WITHIN INITIAL GROWING SEASON WITH A NEW ONE-YEAR WARRANTY COMMENCING ON THE DATE OF REPLACEMENT. ALL REPLACEMENT STOCK IS SUBJECT TO THE SAME WARRANTY REQUIREMENTS AS ORIGINAL STOCK. REPAIR ANY DAMAGE TO ADJACENT SITE FEATURES DUE TO REPLACEMENT OPERATIONS.
14. MANICURED TURF SEED SPECIFICATION: PROVIDE FRESH, CLEAN, NEW-CROP SEED COMPLYING WITH REQUIREMENTS ESTABLISHED BY OFFICIAL SEED ANALYSIS OF NORTH AMERICA. SEED MIXTURE SHALL BE COMPOSED OF THE FOLLOWING SPECIES AND PERCENTAGES: 40% BLUEGRASS, 40% FESCUE GRASSES, AND 20% RYE GRASSES. COARSE BLADE GRASSES, CROP, CLOVER, OR WEED SEED SHALL NOT EXCEED 2% OF SEED BLEND. PRIOR TO SEEDING, SPREAD STRATIFIER FERTILIZER AT MANUFACTURER'S RECOMMENDED RATE. INSTALL SEED EVENLY IN TWO INTERSECTING DIRECTIONS AT SUPPLIER'S RECOMMENDED RATE. RAKE LIGHTLY TO COVER SEEDS 1/2" - 1" DEPTH. UNLESS DIRECTED OTHERWISE, COVER ALL SEEDED SLOPES 3:1 OR GREATER WITH EROSION CONTROL FABRIC, OR REFER TO SITE RESTORATION DRAWINGS FOR EXTENTS OF EROSION CONTROL FABRIC. UNIFORMLY COVER SEEDED AREAS WITH 1/2" - 1" LOOSE DEPTH OF CHOPPED, WEED-FREE STRAW IMMEDIATELY AFTER SOWING, UNLESS EROSION CONTROL MAT IS BEING USED. DO NOT SEED AREA IN EXCESS OF THAT WHICH IS BEING SEED SAME DAY. DO NOT SOW IMMEDIATELY FOLLOWING RAIN, WHEN GRASS IS TOO WET OR DURING WINDY PERIODS. IRRIGATE WITH A FINE SPRAY IMMEDIATELY AFTER MULCHING AND BEYOND AS NECESSARY TO ESTABLISH ACCEPTABLE LAWN. TO BE ACCEPTABLE, GRASS MUST BE FIRMLY ROOTED, FULL, VIABLE, AND FREE OF BARE SPOTS IN EXCESS OF FOUR SQUARE INCHES IN SIZE.
15. DECORATIVE STONE MULCH SPECIFICATION: "MISSISSIPPI, MEDIUM SIZE" AS PRODUCED BY HALQUIST STONE COMPANY, 3" THICK. CONTACT JOSH KAYSAR @ 262-246-9000.
16. ALL EXISTING LANDSCAPE MATERIALS AND PLANTINGS OUTSIDE LIMIT OF CONSTRUCTION SHALL REMAIN. FIELD-COORDINATE ANY NECESSARY REMOVALS WITH OWNER'S REPRESENTATIVE AND CONSTRUCTION SEQUENCING.

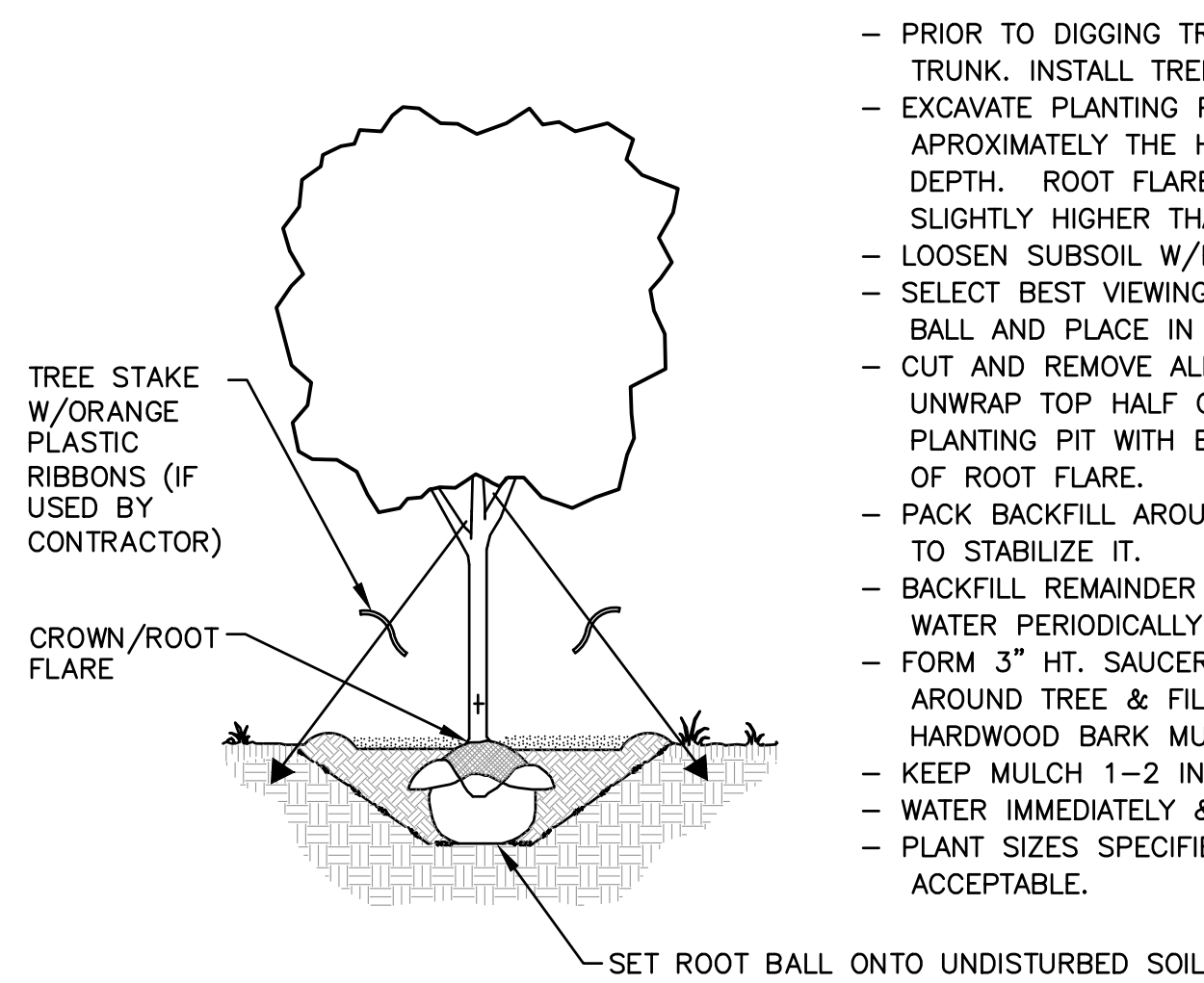

- EXCAVATE PLANTING PIT TWICE THE DIAMETER OF BALL & EQUAL IN DEPTH
- LOOSEN SUBSOIL W/PICK TO ENSURE POROSITY
- PLACE PLANTING SOIL IN PLANTING PIT & FOOT TAMP
- SELECT BEST VIEWING ANGLE, LIFT STOCK BY BALL & PLACE IN PLANTING PIT
- UNWRAP TOP HALF OF ROOT BALL
- BACKFILL TO FINISHED GRADE WITH AMENDED TOPSOIL & TAMP
- FORM 3" SAUCER TO ENCIRCLE STOCK & FILL WITH 3" SHREDDED BARK MULCH
- WATER IMMEDIATELY & FREQUENTLY.
- PLANT SIZES SPECIFIED ARE MINIMUM ACCEPTABLE

AMENDED TOPSOIL TO DEPTH AND COMPOSITION AS SPECIFIED, IN NOTES

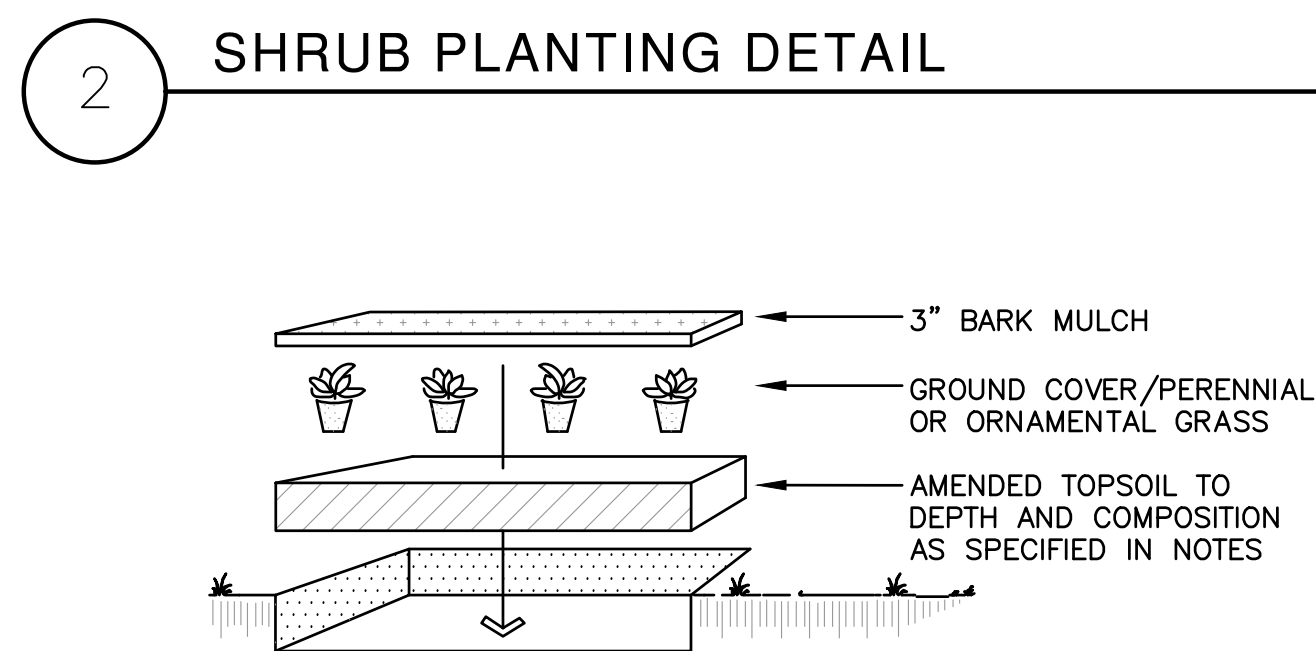

A cross-section diagram illustrating the construction of a planting bed. The diagram shows a vertical line representing the edge of the bed. To the left of this line is the area labeled "STONE MULCH". To the right is the "PLANTING BED". A horizontal line with arrows at both ends indicates the "FINISH GRADE OF LAWN". Below this line, the construction layers are shown in cross-section. From top to bottom, these layers are: a layer of "SHREDDED HARDWOOD BARK MULCH 3\" MIN. DEPTH", a layer of "AMENDED TOPSOIL TO DEPTH AND COMPOSITION AS SPECIFIED, IN NOTES.", and the "UNDISTURBED SUBGRADE". A "4\" ALUMINUM EDGING" is shown as a curved line separating the mulch from the soil. A note indicates to "HOLD MULCH 1\" MAX BELOW FINISH GRADE OF LAWN".

STONE MULCH

PLANTING BED

FINISH GRADE OF LAWN

HOLD MULCH 1" MAX BELOW FINISH GRADE OF LAWN

4" ALUMINUM EDGING

SHREDDED HARDWOOD BARK MULCH 3" MIN. DEPTH

AMENDED TOPSOIL TO DEPTH AND COMPOSITION AS SPECIFIED, IN NOTES.

UNDISTURBED SUBGRADE

4

PLANT LIST					
SYMBOL	BOTANICAL NAME	COMMON NAME	SIZE	SPACING	MA'TURE SIZE
<b>ORNAMENTAL TREES</b>					
COA SPM	Cornus alternifolia Syringa pekinensis 'Morton'	Pagoda Dogwood China Snow Peking Lilac	5'-6' clump 6'-10'clump BB	as shown as shown	20h x 20w 25h x 20w
<b>DECIDUOUS SHRUBS</b>					
FGB HAG	Fothergilla gardenii 'Beaver Creek' Hydrangea arborescens 'Grandiflora'	Beaver Creek Fothergilla Snowhill Hydrangea	24" ht 30" ht	4' 5'	30'h x 4'w 5'h x 5'w
<b>EVERGREEN SHRUBS</b>					
TMT TOD	Taxus x media 'Tauntonii' Thuja occidentalis 'Degroot's Spire'	Tauntton Spreading Yew Degroot's Spire Arborvitae	24" ht. 5' ht.	5' 5'	3'-4h x 4'-6'w 18h x 4'-5'w
<b>PERENNIALS</b>					
ACA ADP ALM AMP ARD HGM GVL PVP	Asarum canadense Adiantum pedatum Alchemilla mollis Aster macrophyllus Arunceus dioicus Hosta 'Guacamole' Nepeta x faassoni 'Walker's Low' Phlox paniculata 'Volcano Purple'	Canada Wild Ginger Maidenhair Fern Lady's Mantle Bigleaf Aster Goat's Beard Guacamole Hosta Walker's Low Catmint Volcano Purple Phlox	1 gal. 1 gal. 24" 1 gal. 1 gal. 1 gal. 36" 1 gal.	18" 18" 15" x 24" 24" 24" 36" 36" 24"	6"-12'h x 18" w 18-24" h x 24" w 15" x 24" 12"-36" h x 12" x 36" w 60" h x 24" w 18" h x 30" w 24" h x 24-36" w 24"-26" h x 24" w
<b>ORNAMENTAL GRASSES &amp; SEDGES</b>					
CAE CAK CPN CMZ MGZ	Carex eburnea Calamagrostis acutiflora 'Karl Foerster' Carex pennsylvanica Chasmanthium latifolium Miscanthus sinensis 'Graziella'	Bristleleaf Sedge Feather Reed Grass Pennsylvania Sedge Chinese Snow Oats Graziella Maiden Grass	4" pot 1 gal. 4" pot 1 gal. 1 gal.	6" 36" 18" 30" 36"	6"-8" h x 6"-8" w 5" h x 30" w 10" h x 18" + w 4" h x 30" w 5" h x 4" w

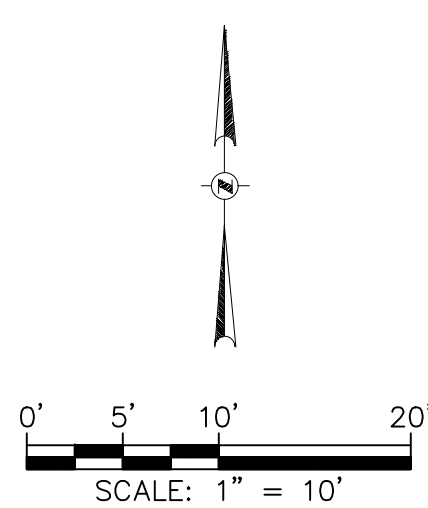
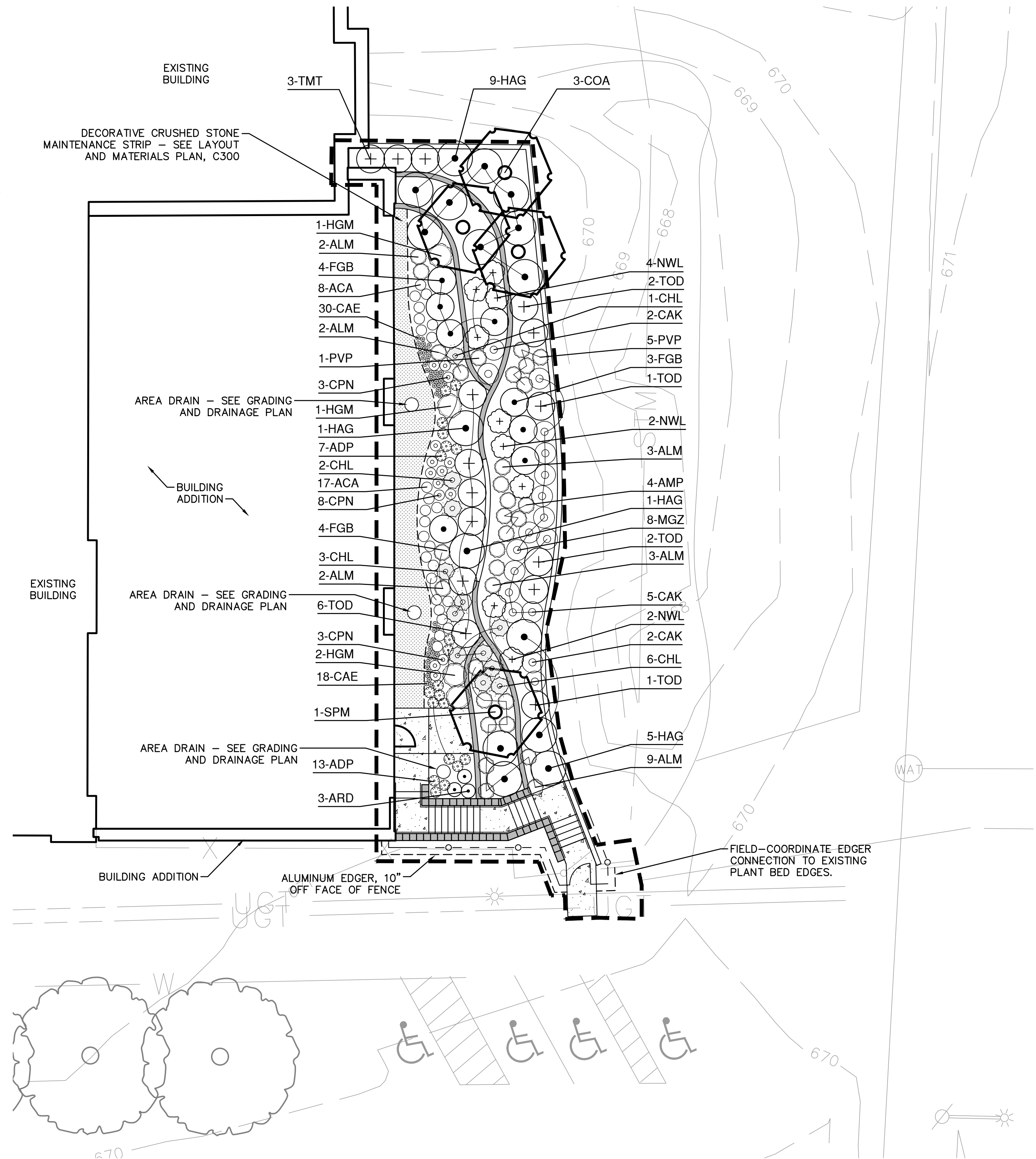

**LIMIT OF LANDSCAPE CONSTRUCTION**

--- ALUMINUM EDGER - SEE LANDSCAPE NOTES

EXISTING TREES TO REMAIN

ORNAMENTAL TREE

DECIDUOUS SHRUB

EVERGREEN SHRUB

ORNAMENTAL GRASS

PERENNIALS