

SAINT JAMES CHURCH  
BUILDING ADDITION  
1032 CALEDONIA STREET  
LA CROSSE, WI 54603

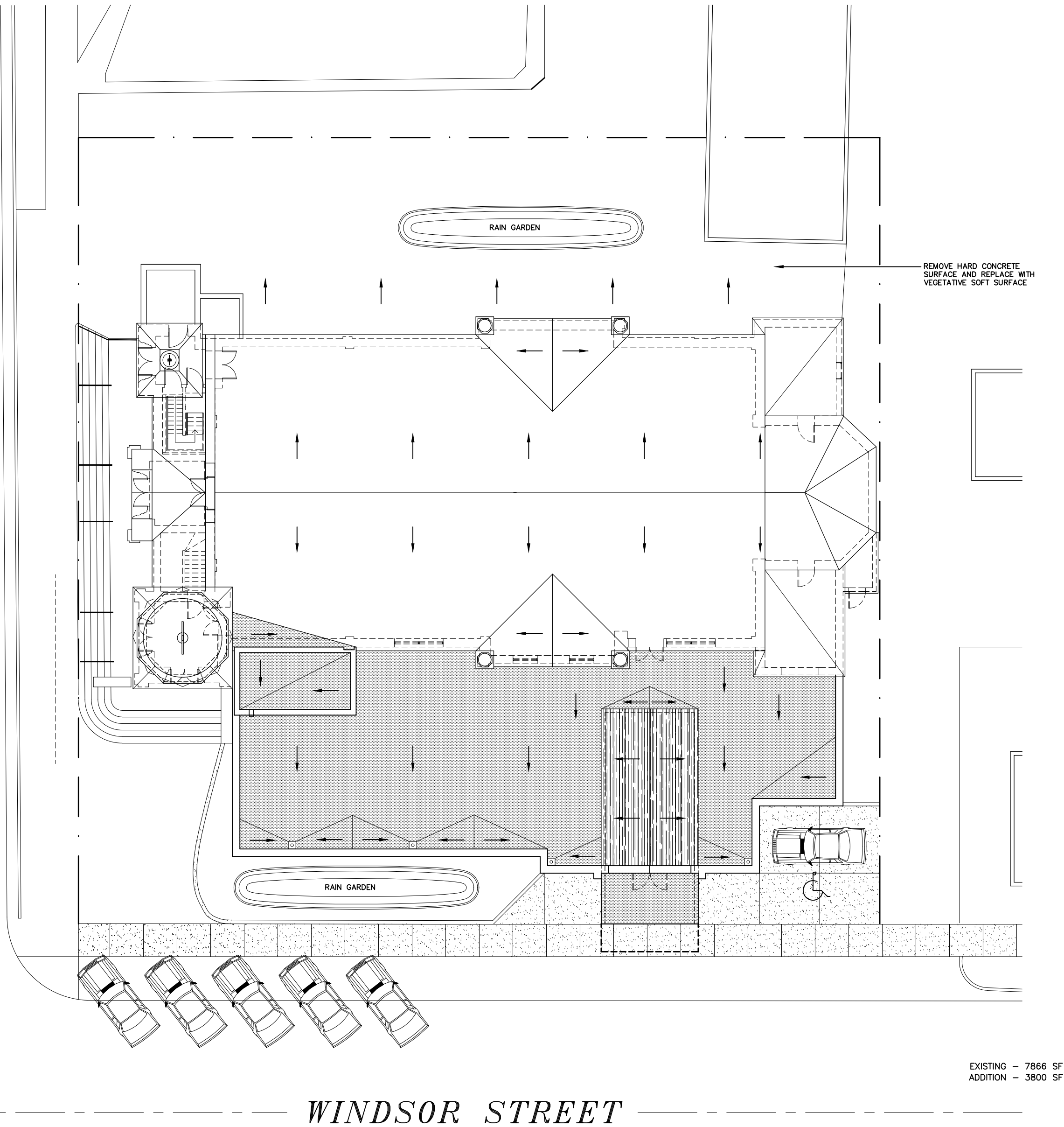

1 SITE | LOCATION PLAN | ROOF PLAN  
1/16" = 1'-0"

STRUCTURAL NOTES

- DESIGN CODES - ( ALL LATEST EDITIONS )
  - AMERICAN CONCRETE INSTITUTE ( ACI )
  - CONCRETE REINFORCING STEEL INSTITUTE ( CRSI )
  - AMERICAN INSTITUTE OF STEEL CONSTRUCTION ( AISC )
  - NATIONAL CONCRETE MASONRY ASSOCIATION ( NCMA )
  - 2015 INTERNATIONAL BUILDING CODE
  - 2015 WISCONSIN BUILDING CODE
- DESIGN LIVE LOADS
  - ROOF = 33.8 PSF + APPLICABLE DRIFT LOADS (SEE SHT A102)
  - WIND = 20.2 PSF @ ROOF & WALLS
  - FLOOR = 100 PSF LOBBIES & FIRST FLOOR CORRIDORS
  - FLOOR = 80 PSF CORRIDORS ABOVE FIRST FLOOR
  - FLOOR = 50 PSF (OFFICES)
  - FLOOR = 40 PSF (CLASSROOMS)
  - FLOOR = 100 PSF (DINING & ASSEMBLY SPACES)
- SOIL
  - 2000 PSF - [ASSUMED]
  - 2000 PSF SAFE BEARING USED FOR DESIGN
  - FOOTINGS SHALL BEAR ON UNDISTURBED NATURAL SOIL OR COMPACTED ENGINEERED FILL. ENGINEERED FILL SHALL BE A WELL GRADED GRANULAR MATERIAL COMPACTED TO 96% STANDARD PROCTOR DENSITY.
- CAST-IN-PLACE CONCRETE
  - ARRANGEMENTS, BENDING, DETAILING AND SUPPORT OF REINFORCING STEEL SHALL BE IN ACCORDANCE WITH ACI AND CRSI STANDARDS.
  - WHERE REINFORCING BARS ARE SHOWN CONTINUOUS LAP BARS #4-20, #5-26, #6-33"
  - REINFORCEMENT STEEL BARS - ASTM A615 GRADE 60 ( 60 KSI )
  - MAXIMUM SIZE OF AGGREGATE IS 1 1/2"
  - MAXIMUM SLUMP IS 3"

COMPONENT	CONC. STRENGTH @ 28 DAYS
BLOCK/MASONRY FILL	2500 PSI
FOOTINGS & FOUNDATION WALLS	3500 PSI
INTERIOR & EXTERIOR SLABS	4000 PSI
- MASONRY
  - MASONRY BLOCK UNITS - NORMAL WEIGHT
  - MORTAR TO BE TYPE S - CONFORMING TO ASTM C270
  - INSTALL FLASHINGS AT BASE & ALL OPENINGS
  - INSTALL BLOCK ANCHORS 48"oc VERT TO COLUMNS
  - INSTALL WEEP HOLES AT 48"oc

CODE INFORMATION

2015 INTERNATIONAL COMMERCIAL BUILDING CODE

USE & OCCUPANCY CLASSIFICATION:

PRIMARY USE:  
303.4 ASSEMBLY GROUP A-3 - CHURCH | WORSHIP

BUILDING HEIGHTS & AREAS: (TABLE 504.4 & 506.2)

ASSEMBLY GROUP A-3  
MAXIMUM HEIGHT = 2 STORIES  
MAXIMUM AREA/FLOOR = 9,500 SF (NON-SPRINKLERED)

TYPE OF CONSTRUCTION: (TABLE 503)  
III-B

FIRE PROTECTION SYSTEMS: (CHAPTER 9)  
903.2.1.3 GROUP A-3  
A NFPA 13 AUTOMATIC SPRINKLER SYSTEM IS NOT REQUIRED AND WILL NOT BE INSTALLED.  
A NFPA 13 AUTOMATIC SPRINKLER SYSTEM IS REQUIRED WHERE ONE OF THE FOLLOWING CONDITIONS EXISTS:  
1. THE FIRE AREA EXCEEDS 12,000 SF.  
2. THE FIRE AREA HAS AN OCCUPANT LOAD OF 300 OR MORE.  
3. THE FIRE AREA IS LOCATED ON A FLOOR OTHER THAN A LEVEL OF EXIT DISCHARGE SERVING SUCH OCCUPANCIES.

FIRE RESISTIVE RATINGS: (TABLE 601)  
STRUCT FRAME-COLUMNS, GIRDERS, TRUSSES 0-NR HR RATING  
EXTERIOR BEARING WALLS - >30 FT (TABLE 602) 0-NR HR RATING  
INTERIOR BEARING WALLS 0-NR HR RATING  
FLOOR BEAMS & JOISTS 0-NR HR RATING  
ROOF BEAMS & JOISTS 0-NR HR RATING  
INTERIOR PARTITIONS 0-NR HR RATING  
REO'D EXIT CORRIDORS (TABLE 1018.1) 0-HR W/ SPRINKLER  
VERTICAL SHAFTS/STAIRWAYS (1022.2) 1-HR < 4 STORIES  
EXTERIOR WALLS >30 FT (TABLE 602 II-B) 0-NR HR RATING  
DOOR ASSEMBLIES (SEE TABLE 716.5)

EXIT DISTANCE: (TABLE 1017.2)  
MAXIMUM = 200 FT (WITHOUT AUTOMATIC SPRINKLER SYSTEM)

OCCUPANT LOAD: (TABLE 1004.1.2)  
(SEE SHEET A002 FOR CALCULATED OCCUPANCY LOAD)  
TOTAL OCC = 250 OCC

MEANS OF EGRESS: (1005.3)  
(SEE SHEET A002 FOR CALCULATED EXIT WIDTHS)  
2 EA 36 IN EXIT DOORS PROVIDED = 72 INCHES OF EGRESS WIDTH

SANITARY FACILITIES: (TABLE 2902.1)  
(SEE SHEET A002 FOR CALCULATED FIXTURE REQUIREMENTS)

NEW FACILITIES PROVIDED:  
UNISEX RESTROOMS - 1 TOILETS  
- 1 URINAL  
- 1 LAVATORIES  
MEN RESTROOMS - 2 TOILETS  
- 2 URINAL  
- 2 LAVATORIES  
WOMEN RESTROOMS - 2 TOILETS  
- 2 LAVATORIES  
JANITOR - 1 MOP SINK  
DRINKING WATER - 2 BOTTLED WATER DISPENSERS  
- 2 HIGH-LOW ELECTRIC WATER COOLERS

DRAWING INDEX

NO	DESCRIPTION
A001	SITE PLAN, CODE & STRUCT INFO
A002	CODE ANALYSIS
A100	EXISTING & ADDITION FIRST FLOOR PLAN
A101	BASEMENT & ADDITION FOUNDATION PLAN
A102	ROOF & ROOF FRAMING PLAN
A200	BUILDING ELEVATIONS
A300	BUILDING   WALL SECTIONS
A400	LARGE SCALE PLANS
A500	SECTION DETAILS

CONSTRUCTION  
EXPRESS INC

411 LA CROSSE STREET  
LA CROSSE, WI 54601  
(608) 784-9290

SAINT JAMES CHURCH  
BUILDING ADDITION  
1032 CALEDONIA ST  
LACROSSE, WI 54603

I HEREBY CERTIFY THAT THIS PLAN  
SPECIFICATION, OR REPORT WAS PREPARED BY  
ME OR UNDER MY DIRECT SUPERVISION AND  
THAT I AM A DULY REGISTERED PROFESSIONAL  
UNDER THE LAWS OF THE STATE OF WI.

SIGNED \_\_\_\_\_  
DATE \_\_\_\_\_  
NUMBER \_\_\_\_\_

THIS DRAWING IS AND WILL REMAIN THE  
PROPERTY OF THE DESIGNER AND ANY  
REPRODUCTION OR USE FOR ANYTHING BUT THE  
SPECIFICALLY AGREED UPON PURPOSES,  
WITHOUT THE PRIOR WRITTEN CONSENT OF THE  
DESIGNER, IS STRICTLY PROHIBITED.

JOB # 18026

MAR 28, 2019

REVISIONS

PLOT 1/16"=1'-0"

SITE PLAN  
STRUCTURAL INFO  
CODE INFO

A001