

trimless mud-in



trim flange



grid



end detail



corner detail



regress lens



wall to ceiling companion



perimeter companion



suspended & wall mount companions

## DIMENSIONAL DATA

trimless mud-in

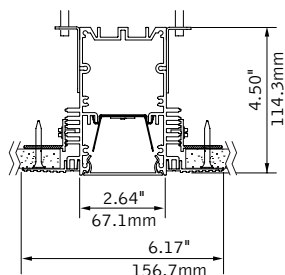

note: 0.375"min - 2.125"max ceiling thickness

trimless hard surface

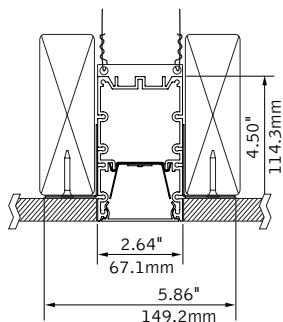

note: 0.375"min - 2.125"max ceiling thickness

trim flange

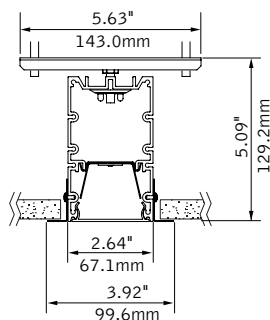

grid - regress lens shown

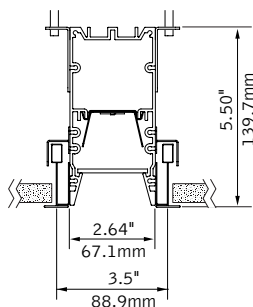

## FEATURES

Narrow extruded aluminum 2.5" aperture recessed slot LED.

Integrates with ceiling or wall in a variety of mounting styles for a clean, unobtrusive aesthetic.

Individual units and continuous runs in 1" increments.

Frosted acrylic lens provides uninterrupted illumination, without pixels or shadows.

LED position and lens material optimized to provide the perfect blend of high performance and visual comfort.

Connected Solutions: Integrates with wired and wireless building lighting control systems.

Preferred Light: Lighting for better color rendition and human preference.

## PERFORMANCE

### PRODUCT OVERVIEW

Lumen Output:	500-2500lm
Wattage:	5-43W
LPW:	71-89
SDCM:	3

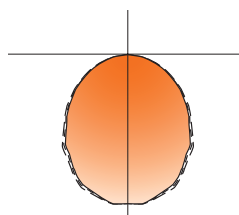

4' Flush Lens  
Nominal output:  
250 Lumens per foot

**Delivered Lumens: 1000lm**  
**Total System Watts: 14W**

Photometric performance is measured in accordance with IESNA LM-79.  
Visit [focalpointlights.com](http://focalpointlights.com) for complete photometric data.

fixture:

project:

## DETAILS

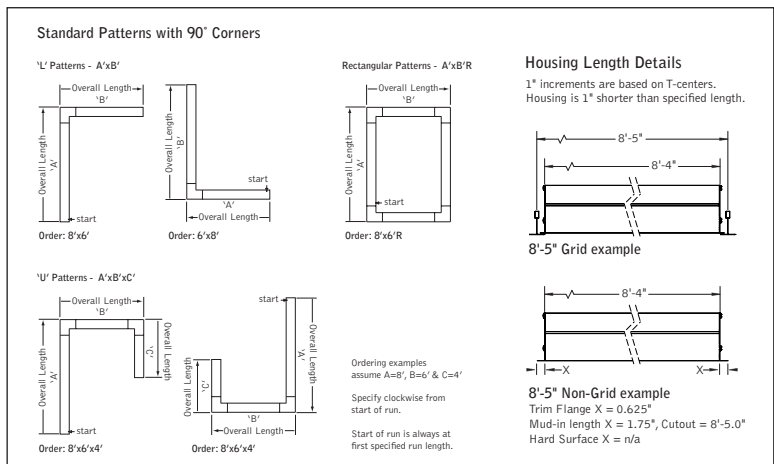

## SPECIFICATIONS

### LED System

Proprietary linear LED module incorporates premium LEDs on a robust platform to achieve excellent thermal management. LEDs are placed to promote a uniform appearance. Available in 2700K, 3000K, 3500K or 4000K with CRI>80 or CRI>90, 3SDCM. LED modules and drivers are replaceable from below.

### Construction

One piece extruded aluminum housing. 20 Ga. steel end caps. Housing for new construction applications. 2' unit: 5.1 lbs., 3' unit: 7.6 lbs., 4' unit: 10.1 lbs., 5' unit: 12.6 lbs.

### Optic

Reflectors fabricated of 22 Ga. steel finished in High Reflectance White powder coat. Extruded acrylic lens .07" thick with satin finish, up to 8' continuous.

### Electrical

Luminaires are pre-wired with factory installed branch circuit wiring and over-molded quick connects. Standard 120-277V constant current driver includes 0-10V analog dimming. Power factor > .9.

### Emergency

Emergency Battery output - 10 watts for 90 minutes. Maximum mounting height: 17.9ft. Emergency Circuit with Connected Solutions (NLT1, ENL1, CLM1, CLMZ1, DLM1) shipped standard with leads to connect UL924 compliant device, by others. See EM/EC Guide for default locations and ordering details.

### Labels

UL and cUL listed. Suitable for Dry or Damp Locations, indoor use only.

### Finish

Polyester powder coat applied over a multi-stage pre-treatment.

### Lumen Maintenance

Reported: L70 at >61,000 hours      Calculated: L70 at 270,000 hours  
L90 at >61,000 hours      L90 at 73,000 hours  
(Derived from EPA TM-21 calculator. Based on typical conditions, consult factory for additional data.)

### Reliability

At Focal Point, our products are designed to stand the test of time. Each luminaire is engineered using superior components, manufactured with the utmost care and rigorously tested. Contact us for reliability data.

### Warranty

LED system rated for operation in ambient environments up to 25°C. 5-year limited warranty.

## 4' PERFORMANCE CHART

Shielding	Lumens per Foot	Delivered Lumens	Tested System Watts	LPW
Flush Lens	125LF	500	5	89
	250LF	1000	14	88
	375LF	1500	18	88
	625LF	2500	31	87
Regress Lens	125LF	500	7	72
	250LF	1000	16	72
	375LF	1500	26	71
	625LF	2500	43	72
Regress High Performance Lens	125LF	500	6	84
	250LF	1000	13	83
	375LF	1500	19	84
	625LF	2500	33	83

Based on 3500K, 80 CRI, 4' lengths. Lumen multipliers: Preferred Light = 0.65, 90+ CRI = 0.87. Lumen output may vary +/- 5%. Actual wattage may vary +/- 5%.

Focal Point LLC reserves the right to change specifications for product improvement without notification.

## ORDERING

### Luminaire Series

Seem 2 LED

Shielding

Flush Satin Lens

Regress Lens

(Housing height 5.5". Ceiling applications only)

Regress High Performance Lens

(Housing height 5.5". Ceiling applications only)

### Lumen Output

125 Lumens per foot

(LD1, L11 & D11 only. 4' minimum.)

250 Lumens per foot

(Not available with LU5 & LH1.

4' minimum with D11 & FL lens.)

375 Lumens per foot

(4' minimum with LU5 & LH1 or

D11 with FL lens.)

625 Lumens per foot

(3' minimum with LU5 & LH1)

### Color Temperature

2700K, 80+ CRI or 90+ CRI

3000K, 80+ CRI or 90+ CRI

3500K, 80+ CRI or 90+ CRI

4000K, 80+ CRI or 90+ CRI

3500K, Preferred Light

(Flush Lens only. 6" increments.

Not available with Emergency Battery or patterns.)

### Circuit

Single Circuit

### Voltage

UNV 120/277 Volt

### Control System & Dimming Level

0-10V - 10% Dimming

0-10V - 1% Dimming

Lutron Hi-Lume EcoSystem (LDE1) -

1% Dimming

Lutron 5-Series EcoSystem (LDE5) -

5% Dimming

DALI 1% Dimming

Acuity nLight - 1% Dimming

(3' minimum length. Not available with CP. Grid only.)

Enlighted Smart Sensor - 1% Dimming

(3' minimum length. Grid only.)

Osram Connected Lighting Module for

ENCELIUM systems - 1% Dimming

(3' minimum length. Grid only. Compatible with Osram

ENCELIUM and ENCELIUM EDGE systems only.)

Osram Connected Lighting Module for

ZigBee Wireless Networks - 1% Dimming

(3' minimum length. Grid only.

Not compatible with Osram ENCELIUM systems.)

Wattstopper® DLM - 1% Dimming

(3' minimum length. Grid only.)

### Ceiling Configuration

Std. 15/16" Lay-in

Std. 15/16" Tegular

Std. 9/16" Lay-in

Std. 9/16" Tegular

9/16" Slot-tee Tegular

Tall 15/16" Lay-in

Tall 15/16" Tegular

Tall 9/16" Lay-in

Tall 9/16" Tegular

Node 9/16" Tegular

Trim Flange Drywall

Trim Flange Wood

Mud-in Trimless, pre-set for 1/2" Drywall

Mud-in Trimless, pre-set for 5/8" Drywall

Mud-in Trimless, set thickness in field

(Mounting equipment assembled in field)

Non-Drywall Hard Surface

Hard Surface, Wood

### Factory Options

Chicago Plenum

Emergency Circuit\*

(4' minimum. 7' minimum with CLM1, CLMZ1, DLM1, ENL1 & NLT1.)

Emergency Battery Pack\*

(4' minimum. 7' minimum with CLM1, CLMZ1, DLM1,

ENL1 & NLT1. Not available at corners.

See EM/EC Guide for default locations and ordering details.)

6' New York City Flex Whip (120V)

6' New York City Flex Whip (277V)

6' Flex Whip

### Finish

Matte White Housing

### Luminaire Length

Specify luminaire/row length in 1" increments

(2' minimum, lengths are nominal 1" increments based on

T-centers. Housing length is 1" shorter than specified. Leave

blank for patterns. Smaller increments available, consult factory.)

### Pattern Options

(3' minimum length)

'L' pattern

'U' pattern

Rectangular pattern

(Consult factory for other pattern options)

## FSM2L

## 1C

## UNV

## LD1

## L11

## LH1

## LU5

## D11

## NLT1

## ENL1

## CLM1

## CLMZ1

## DLM1

## G1

## T1

## G2

## T2

## G3

## G4

## T4

## G5

## T5

## T6

## TF

## TFW

## XF1

## XF2

## XFF

## XFN

## XFW

## CP

## \_EC

## \_EM

## FNY1

## FNY2

## FW

## WH

## ft in

## \_ft \_in



Options in orange qualify for the Quickship program. 400' total. Refer to Quickship Guide for complete details including EM/EC options.

For more information visit focalpointlights.com/reference or consult factory.

Focal Point provides flexibility in meeting the needs of each project by integrating with several building lighting control systems. A variety of sensors, drivers and other components can be specified that allow the luminaires to communicate with wired and wireless networks. All zoning can be digitally reconfigured through the application software. Daylight harvesting, occupancy sensing, integration with HVAC systems, and individual controls enable the monitoring and modulating of light levels and temperature in order to save energy, reduce costs and maximize occupants' comfort. All Connected Solutions luminaires require a compatible building control system.†

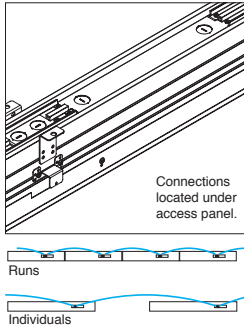

nLight<sup>®</sup> provides a two-way wired digital lighting system allowing for on/off and dimming functionality, occupancy sensing, and multi-zone daylight harvesting.

Acuity nLight - 1% Dimming (NLT1)  
Acuity Model #nEPS-60-IO

CAT-5 Cable provided by others. Serial labels will be provided on outside of luminaires and control unit.

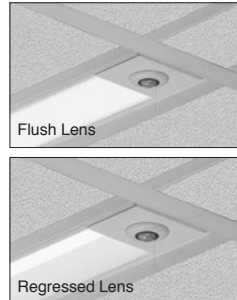

Enlighted smart sensor allows for occupancy sensing, daylight harvesting, energy usage, temperature and light level control. Communicates wirelessly with the Enlighted network.

Enlighted Smart Sensor - 1% Dimming (ENL1)  
Enlighted Model SU-5E-IOT

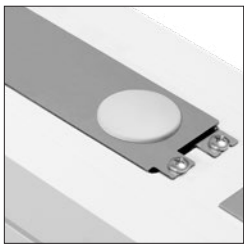

Connected Lighting Module (CLM) enables each luminaire to be independently controlled and configured. Communicates wirelessly with Daintree Networks<sup>®</sup>, Osram ENCELIUM<sup>®</sup>, Osram ENCELIUM EDGE<sup>™</sup>, and other networks using the ZigBee<sup>®</sup> HA communication protocol to allow for on/off and dimming functionality, occupancy sensing and multi-zone daylight harvesting.

Osram CLM - 1% Dimming (CLM1 & CLMZ1)  
Osram Model #ZBHA-CLM DIM

Serial labels will be provided on outside of luminaires and control unit.

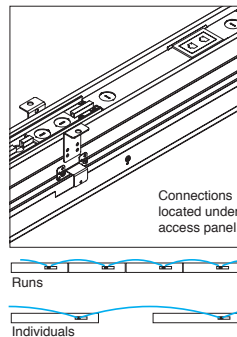

A Digital Lighting Management (DLM) system that provides two-way wired communication between networked luminaires and control system to allow for on/off and dimming functionality, occupancy sensing and multi-zone daylight harvesting.

Wattstopper DLM - 1% Dimming (DLM1)  
Wattstopper Model #LMFC-011

CAT-5 Cable provided by others. Serial labels will be provided on outside of luminaires and control unit.

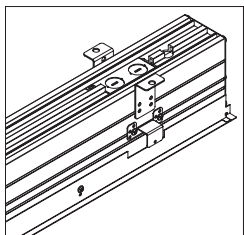

A two-way digital network that enables on/off and dimming functionality, occupancy sensing, and multi-zone daylight harvesting working with Quantum<sup>®</sup>, Energi Savr Node<sup>™</sup>, and Energi TriPak<sup>®</sup> using EcoSystem<sup>®</sup> communication protocol.

Lutron Hi-Lume EcoSystem - 1% Dimming (LH1)  
Lutron Model #LDE1  
Lutron 5-Series EcoSystem - 5% Dimming (LU5)  
Lutron Model #LDE5

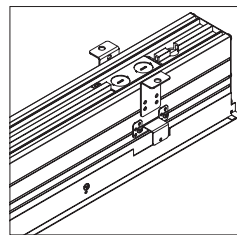

A two-way digital network that enables on/off and dimming functionality, occupancy sensing, and multi-zone daylight harvesting. Communicates with Züm wireless and SpaceBuilder working with Züm hub scheduling or FUSION management.

DALI - 1% Dimming (D11)  
0-10V - 1% Dimming (L11)

Note: 0-10V is not a digital network but is compatible with Creston Züm<sup>™</sup> system.

## CONNECTED SOLUTIONS DETAILS

Connected Solution	Model #	Protocol	Compatible Networks*	Occupancy	Daylight	Temperature Reporting	Communication to Luminaire	Drivers
Acuity nLight (NLT1)	nEPS-60-IO**	nLight	nLight	Enabled	Enabled	No	Wired	<b>eldoLED ECOdrive</b> , eldoLED SOLOdrive
Crestron (D11, L11)	Specified Driver	DALI 0-10V	Crestron Züm Wireless & SpaceBuilder	Enabled	Enabled	No	Wired	<b>eldoLED ECOdrive (DALI)</b> , <b>Advance by Signify</b>
Enlighted Smart Sensor (ENL1)	SU-5E-IOT**	Enlighted RF	Enlighted	Integrated	Integrated	Yes	Wireless	<b>Advance by Signify</b> , Osram Optotronic
Legrand Wattstopper DLM (DLM1)	LMFC-011**	DLM	DLM	Enabled	Enabled	No	Wired	<b>Advance by Signify</b> , Osram Optotronic
Lutron EcoSystem (LH1 & LU5)	LDE1**, LDE5**	EcoSystem	Quantum, Energi Savr Node, Energi TriPak	Enabled	Enabled	No	Wired	<b>Lutron Hi-Lume</b> <b>Lutron 5-Series</b>
Osram CLM for ENCELIUM systems (CLM1)	ZBHA-CLM**	ZigBee HA	Osram ENCELIUM & ENCELIUM EDGE	Enabled	Enabled	No	Wireless	<b>Osram Optotronic</b>
Osram CLM for ZigBee Wireless Networks (CLMZ1)	ZBHA-CLM**	ZigBee HA	Daintree Networks & open ZigBee Networks	Enabled	Enabled	No	Wireless	<b>Osram Optotronic</b>

\*Not all compatible networks may be listed. \*\*For performance data and additional control system details please visit the connected solutions manufacturer websites. Primary drivers are listed in **bold**. To specify a particular driver please consult factory. †Controls systems supplied by others.