

Proposed Operation Plan for People's Food Cooperative, Inc.

Total alcohol sales for on and off premise consumption are projected to be 4% (\$470,000) of the total goods sold at the store.

Gross Sales will be achieved by:

- The sale of wine, beer and spirit sales for off-site consumption.
- The sale of on-site consumption alcoholic beverages available in our community/event space.
 - o Private events
 - o PFC sponsored public events
 - o PFC classes: (wine, beer, spirit tasting classes, pairing alcoholic beverages with meals, etc.)

All alcohol products will be held on the retail sales floor, and back stock will be held in a secured storage room on the first floor. See store drawings.

FIRST FLOOR GROCERY STORE GBA 16,101

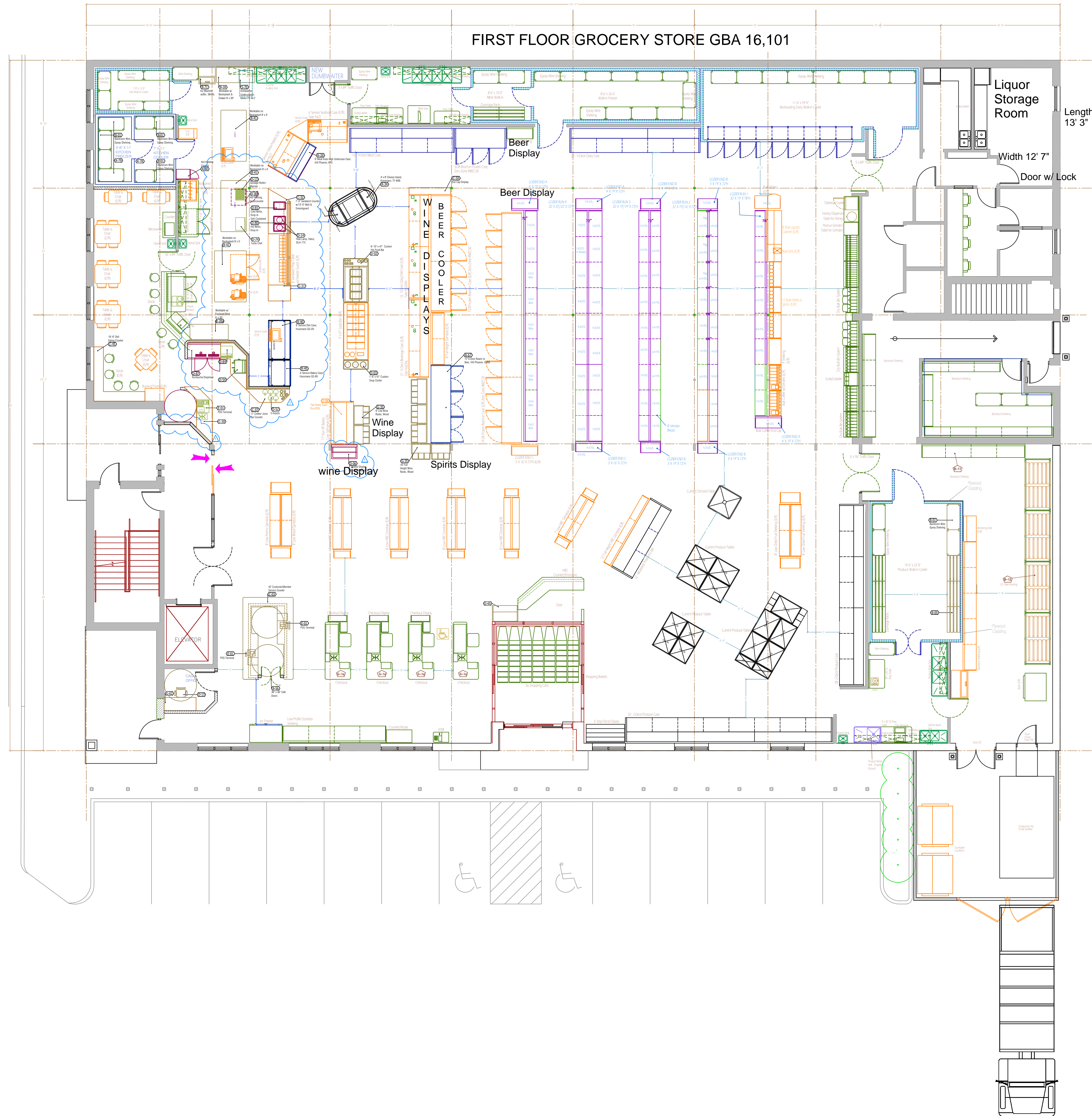

**People's Food
Co-op
La Crosse, WI**

**NOT TO BE USED IN
CONSTRUCTION**

This Fixture Plan is submitted for design intent only. It is not to be used in lieu of necessary architectural and engineering plans nor should it be used or filed for construction permits.
Dimensions are based on information provided by others and should be field-verified.
This drawing is and remains the sole property of the NCG Development Co-op. Unauthorized reuse or reproduction is prohibited.

© 2016 NCG DEVELOPMENT CO-OP
ALL RIGHTS RESERVED

NCG Development Cooperative
National Cooperative Grocers
2610 University Avenue West, Suite 210
Saint Paul, Minnesota 55114
866.709.2667, Ext. 2406

No.	Date	Revision
1	5/30/2018	Detail line-up to show new 4' service bakery case and back support and beverage bar moved accordingly. Warmer moved to end of bakery case and glazing at register removed.

**FINAL
FIXTURE
PLAN**

Date: 05/4/2018
Drawn By: LJP
Scale: 1/8" = 1'-0"