

DIOCESE OF LACROSSE
 TAX PARCEL ID: 17-50323-310

CURRENT ZONING: C1
 PROPOSED USE: LOCAL BUSINESS
 TOTAL EXISTING BUILDING AREA: 4,247 SF
 TOTAL PROPOSED BUILDING AREA: 2,258 SF
 TOTAL AREA: 6,505 SF

OWNER
 CHILEDIA INSTITUTE INC
 1825 VICTORY ST
 LA CROSSE, WI
 54601-7201

CONTRACTOR
 WEISER BROTHERS
 200 TWILITE STREET
 LA CROSSE, MN 55497
 608.661.6810

DESIGNER
 MAKEPEACE ENGINEERING
 LLC
 200 MASON ST #15
 ONALASKA, WI 54650
 608.881.6030

LEGAL DESCRIPTION
 NEW ADDITION CHILEDIA TRAINING
 CENTER

PROJECT ADDRESS
 3617 MORMON COULEE ROAD
 CITY OF LA CROSSE
 LA CROSSE, WI 54601

BENCHMARK
 TBD

CONDITION	PERVIOUS	IMPERVIOUS	TOTAL
EXISTING	3,158 SF	23,560 SF	26,718 SF
PROPOSED	2,394 SF	24,324 SF	26,718 SF

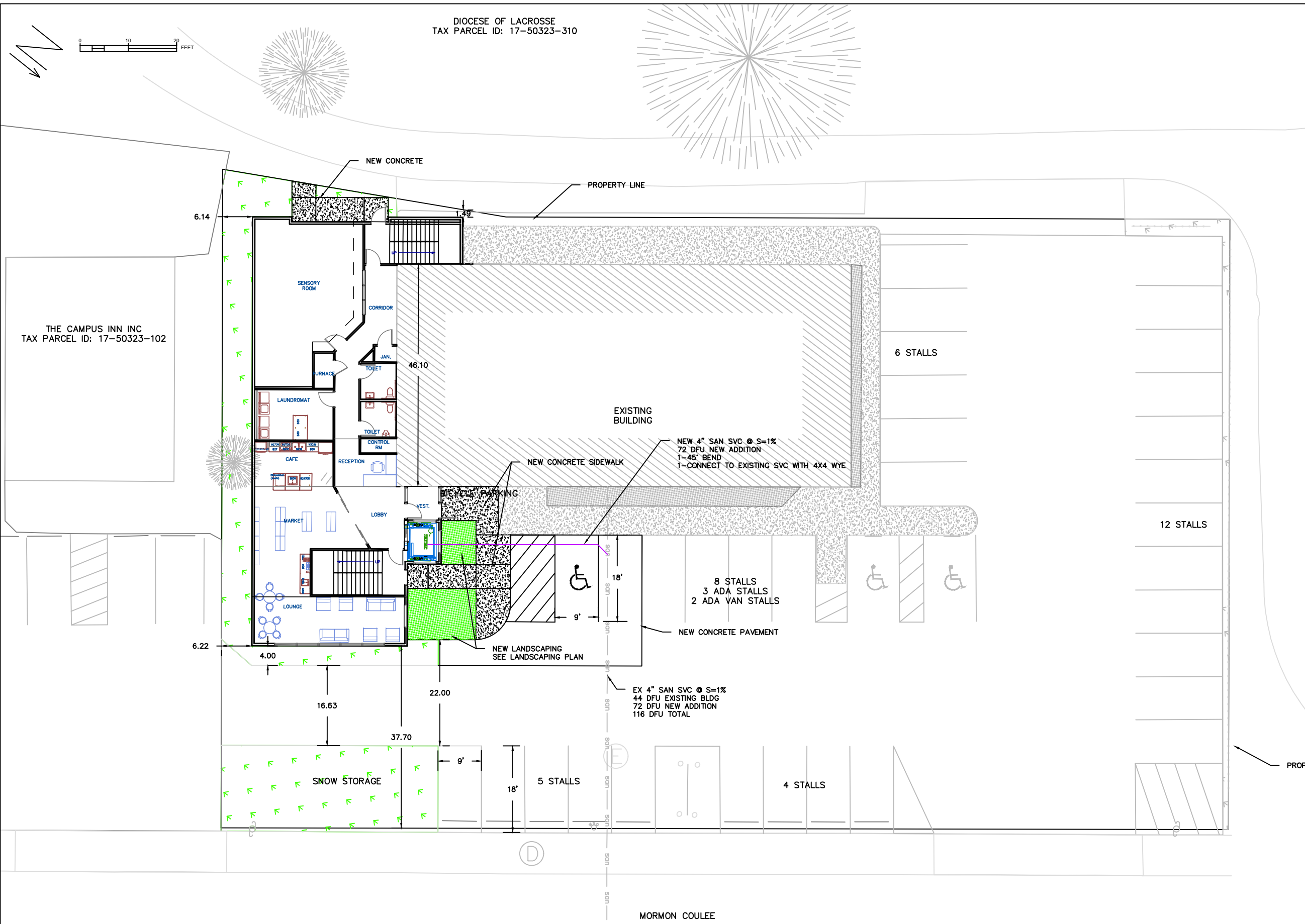

THE CAMPUS INN INC
 TAX PARCEL ID: 17-50323-102



200 MASON STREET #15
 ONALASKA, WI 54650
 608.881.6030



2022 CHILEDIA INSTITUTE ADDITION
 3716 MORMON COULEE ROAD
 LA CROSSE, WI 54601

08/11/2022

SITE & UTILITY PLAN

DATE	REVISION	
		1
		2

