

**CONSTRUCTION NOTE:**  
 BURY CABLE AT A MINIMUM OF 36" DEPTH  
 UNLESS OTHERWISE NOTED ON PRINTS.

**CONSTRUCTION NOTE:**  
 CHARTER COMMUNICATIONS WILL PLACE  
 PROPOSED CABLES IN CORRIDOR AS CLOSE TO  
 THE BACK OF RIGHT-OF-WAY AS POSSIBLE,  
 PENDING LOCATES.

**LEGEND**

TB	: TREE BORE(DIRECTIONAL BORE)
RB	: ROAD BORE (DIRECTIONAL BORE)
T	: TRENCH
HD	: HAND DIG
P	: PLOW

**CHARTER COMMUNICATIONS PROPOSES  
 TO BURY FIBER COMMUNICATION CABLE  
 IN A 2" CONDUIT**

---	FIBER CABLE
⊕	POTHOLE UTILITIES

**CONSTRUCTION NOTE:**  
 POTHOLE WHERE  
 NECESSARY AND ADJUST  
 DEPTH ACCORDINGLY

THE UTILITIES SHOWN ON THIS PLAN ARE  
 INDICATED IN ACCORDANCE WITH AVAILABLE  
 RECORDS. THE CONTRACTOR SHALL BE  
 RESPONSIBLE FOR OBTAINING EXACT  
 LOCATIONS AND ELEVATIONS OF ALL UTILITIES  
 FROM THE OWNERS OF THE RESPECTIVE  
 UTILITIES AND FROM FIELD VERIFICATION.

CONTACT THE STREET DEPARTMENT FOR  
 ANY CONCRETE OR ASPHALT REMOVAL  
 1-608-789-7340 (TROY SCHMUTZER)



**LEGEND**

⊕ JOINT POLE	ANCHOR	MANHOLE	GROUND
⊕ NEW JOINT POLE	NEW ANCHOR	EXISTING FIBER COIL	NEW GROUND
× POWER POLE	JOINT ANCHOR	100' NEW FIBER COIL	PROPERTY LINE
× NEW POWER POLE	NEW JOINT ANCHOR	100' EXISTING HAND HOLE	ROADWAY CENTERLINE
○ TELEPHONE POLE	FOREIGN ANCHOR	NEW HAND HOLE	● FIBER WARNING SIGN
○ NEW TELEPHONE POLE	DOWNGUY	SHRUBS	+D TRAFFIC LIGHT
⊕ EXISTING PEDESTAL	NEW DOWNGUY	DECIDUOUS TREE	◇ HYDRANT
⊕ NEW PEDESTAL	UTILITY VALVE		◇ SIGNS
			◇ STREET LIGHT
			◇ CONIFEROUS TREE

**LINETYPES**

PROPOSED FIBER	---
PROPOSED STRAND	---
GAS	---
WATER	---
ELECTRICAL	---
STORM	---
SANITARY	---
CABLE TV	---
TELEPHONE	---

PROJECT #3610480  
 PERMIT ID #3610480CITY

1228 12TH AVE S  
 ONALASKA, WI 54650



ADDRESS		LOCATION	
11TH ST S		LA CROSSE ,WI	
FIELD BY:	DATE:		
DRAFTED BY:	DATE:		
DESIGNED BY:	DATE:	1	
ASBUILTS BY:	DATE:	2	

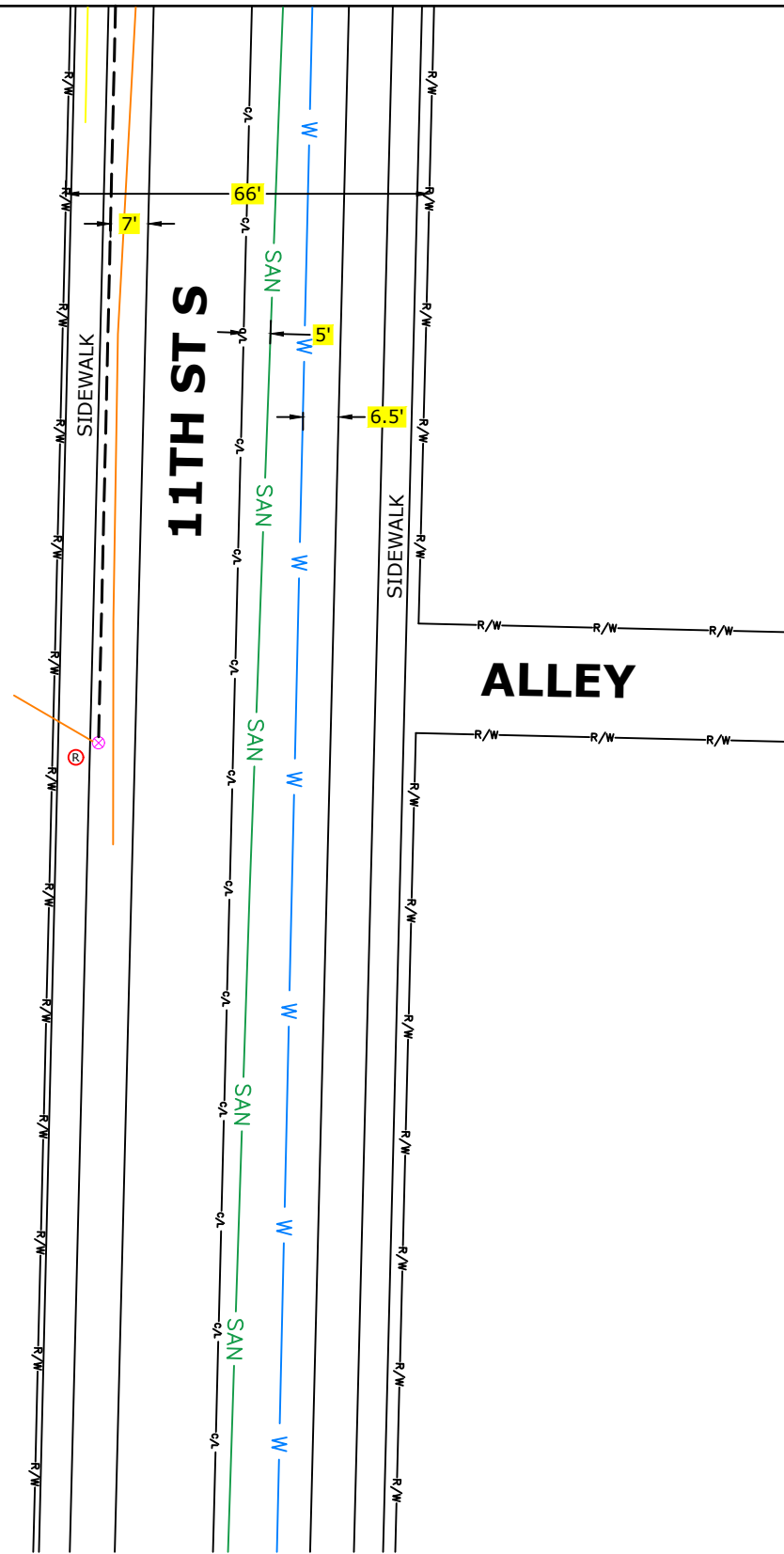

**CONSTRUCTION NOTE:**  
 BURY CABLE AT A MINIMUM OF 36" DEPTH  
 UNLESS OTHERWISE NOTED ON PRINTS.

**CONSTRUCTION NOTE:**  
 CHARTER COMMUNICATIONS WILL PLACE  
 PROPOSED CABLES IN CORRIDOR AS CLOSE TO  
 THE BACK OF RIGHT-OF-WAY AS POSSIBLE,  
 PENDING LOCATES.

**LEGEND**

- TB : TREE BORE(DIRECTIONAL BORE)
- RB : ROAD BORE (DIRECTIONAL BORE)
- T : TRENCH
- HD : HAND DIG
- P : PLOW

**CHARTER COMMUNICATIONS PROPOSES  
 TO BURY FIBER COMMUNICATION CABLE  
 IN A 2" CONDUIT**

- = FIBER CABLE
- ⊕ = POTHOLE UTILITIES

**CONSTRUCTION NOTE:**  
 POTHOLE WHERE  
 NECESSARY AND ADJUST  
 DEPTH ACCORDINGLY

THE UTILITIES SHOWN ON THIS PLAN ARE  
 INDICATED IN ACCORDANCE WITH AVAILABLE  
 RECORDS. THE CONTRACTOR SHALL BE  
 RESPONSIBLE FOR OBTAINING EXACT  
 LOCATIONS AND ELEVATIONS OF ALL UTILITIES  
 FROM THE OWNERS OF THE RESPECTIVE  
 UTILITIES AND FROM FIELD VERIFICATION.

CONTACT THE STREET DEPARTMENT FOR  
 ANY CONCRETE OR ASPHALT REMOVAL  
 1-608-789-7340 (TROY SCHMUTZER)



LEGEND			
⊕ JOINT POLE	ANCHOR	MANHOLE	GROUND
⊕ NEW JOINT POLE	NEW ANCHOR	EXISTING FIBER COIL	NEW GROUND
× POWER POLE	JOINT ANCHOR	100 EXISTING FIBER COIL	PROPERTY LINE
× NEW POWER POLE	NEW JOINT ANCHOR	100 NEW FIBER COIL	ROADWAY CENTERLINE
○ TELEPHONE POLE	FOREIGN ANCHOR	EXISTING HAND HOLE	● FIBER WARNING SIGN
○ NEW TELEPHONE POLE	DOWNGUY	NEW HAND HOLE	+D TRAFFIC LIGHT
⊕ EXISTING PEDESTAL	NEW DOWNGUY	SHRUBS	⊕ HYDRANT
⊕ NEW PEDESTAL	UTILITY VALVE	DECIDUOUS TREE	⊕ SIGNS
			⊕ STREET LIGHT
			⊕ CONIFEROUS TREE

LINETYPES	
PROPOSED FIBER	---
PROPOSED STRAND	---
GAS	---
WATER	---
ELECTRICAL	---
STORM	---
SANITARY	---
CABLE TV	---
TELEPHONE	---

PROJECT #3610480  
 PERMIT ID #3610480CITY

1228 12TH AVE S  
 ONALASKA, WI 54650



ADDRESS		LOCATION	
11TH ST S		LA CROSSE ,WI	
FILED BY:	DATE:	1	
DRAFTED BY:	DATE:	2	
DESIGNED BY:	DATE:		
ASBUILTS BY:	DATE:		