

Original:

Renewal:

License Fee: \$125.⁰⁰

Invoice #: 145491

COPY

APPLICATION FOR INDOOR CABARET LICENSE

Legal/Real Name: Ora's, Inc.

Address of above: 318 Pearl St. La Crosse WI 54601

Trade name of business: Jack's

Address of premises to be licensed: 318 Pearl St. La Crosse WI 54601

Business phone number: 608-784-4793

Detailed description of cabaret area to be licensed: First and Second Floors

Premises are owned by: Lyle & Stephen Kundy

Address of owner: 533 Main St La Crescent ; 1296 10th Ave N Apt. B, Onalaska

Name of Cabaret Manager (FIRST, MIDDLE & LAST): Stephen Robert Kundy

Home address of Cabaret Manager: 1296 10th Ave N. Apt. B, Onalaska WI

Home phone number of Cabaret Manager: 608-780-4885

Daytime phone number of Cabaret Manager: _____

Date of Birth of Cabaret Manager: _____

Was the above person listed as manager on last year's application? Yes _____ No

Other business to be conducted upon the premises: Tavern

Nature of entertainment: DJ's & Live Music

License Period: March 10 - June 30, 2017

The above hereby makes application for a license to operate an Indoor Cabaret at the above address within the City of La Crosse pursuant to provisions of Chapter 10, Article IV of the Code of Ordinances for the City of La Crosse.

[Signature]
(Signature of applicant & date)

OFFICE USE ONLY: _____ Munis Customer #: _____

For original applications: Are there lands zoned conservancy, residential or multiple dwelling within 100 feet of premises? Y / N If yes, attach a list of those lands.

Signature and date _____

Granted: _____ License #: _____



TERI LEHRKE, WCPC, City Clerk
400 LA CROSSE STREET
LA CROSSE, WISCONSIN 54601
PHONE (608) 789-7510
FAX (608) 789-7552
www.cityoflacrosse.org

COPY

**NOTICE OF APPLICATION FOR INDOOR CABARET LICENSE
IN THE CITY OF LA CROSSE**

TO WHOM IT MAY CONCERN:

This is to notify you that the following business has applied for an **Indoor Cabaret** license under Sec. 10-140(c) of the Code of Ordinances of the City of La Crosse to provide live entertainment in a designated indoor area.

**Ora's, Inc. d/b/a Jack's
at 318 Pearl St., La Crosse, WI 54601**

This application will be considered at the following meetings:

**Judiciary and Administration Committee – Tuesday, February 28th, 2017 at 7:30 p.m.
Common Council Meeting – Thursday, March 9th, 2017 at 7:30 p.m.**

All the above meetings are held in the Council Chambers in the City Hall at 400 La Crosse Street, La Crosse, WI.

You are further notified that any person affected may be heard, and may appear in person or by attorney, or may file a letter of objection in the office of the City Clerk.

This notice is given pursuant to the order of the Common Council of the City of La Crosse.

Dated this 22nd day of February, 2017.

Teri Lehrke, WCPC, City Clerk
City of La Crosse

Jay A. Christianson
Assistant Clerk

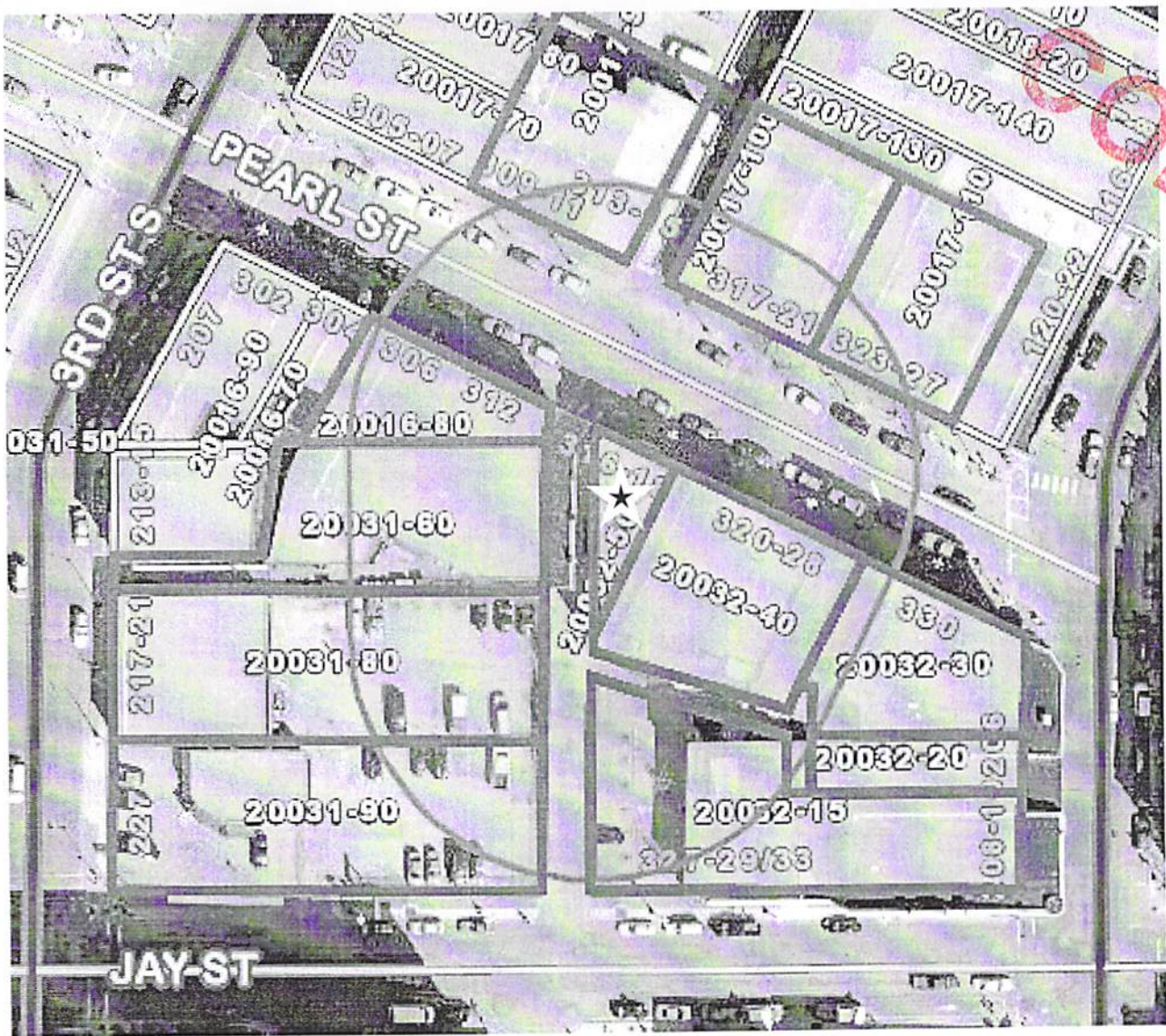

Ora's, Inc. d/b/a Jack's
318 Pearl St.
Indoor Cabaret – 100' buffer
March 9th, 2017 Council Meeting

OwnerName
FORTNEY FORTNEY & FORTNEY LLP
ADAM KRONER CO
CHRISTINE A KAHLLOW
RONALD, ERIC M, MARC R, PATRICIA FORTNEY
ORAS INC
STEPHEN D HARM
JEAN E WIGGERT
JAE ENTERPRISES LLC
JEAN E WIGGERT
JACK'S C/O STEPHEN KUNDY

MailingLine4
PO BOX 1621
319 PEARL ST
717 CASS ST
306 PEARL ST
316 PEARL ST
PO BOX 2044
W5851 CEDAR RD
901 ROSE ST
W5851 CEDAR RD
318 PEARL ST

MailingLine5
LA CROSSE WI 54602-1621
LA CROSSE WI 54601-3249
LA CROSSE WI 54601-4651
LA CROSSE WI 54601-3202
LA CROSSE WI 54601-3202
LA CROSSE WI 54602-2044
LA CROSSE WI 54601
LA CROSSE WI 54603
LA CROSSE WI 54601
LA CROSSE WI 54601

COPY

MAILING

OwnerName	MailingLine4	MailingLine5	Property Address
FORTNEY FORTNEY & FORTNEY LLP	PO BOX 1621	LA CROSSE WI 54602-1621	309 PEARL ST
FORTNEY FORTNEY & FORTNEY LLP	PO BOX 1621	LA CROSSE WI 54602-1621	311 PEARL ST
FORTNEY FORTNEY & FORTNEY LLP	PO BOX 1621	LA CROSSE WI 54602-1621	313 PEARL ST
FORTNEY FORTNEY & FORTNEY LLP	PO BOX 1621	LA CROSSE WI 54602-1621	315 PEARL ST
ADAM KRONER CO	319 PEARL ST	LA CROSSE WI 54601-3249	317 PEARL ST
ADAM KRONER CO	319 PEARL ST	LA CROSSE WI 54601-3249	319 PEARL ST
ADAM KRONER CO	319 PEARL ST	LA CROSSE WI 54601-3249	321 PEARL ST
CHRISTINE A KAHLOW	717 CASS ST	LA CROSSE WI 54601-4651	323 PEARL ST
CHRISTINE A KAHLOW	717 CASS ST	LA CROSSE WI 54601-4651	325 PEARL ST
CHRISTINE A KAHLOW	717 CASS ST	LA CROSSE WI 54601-4651	327 PEARL ST
RONALD, ERIC M, MARC R, PATRICIA FORTNEY	306 PEARL ST	LA CROSSE WI 54601-3202	306 PEARL ST
RONALD, ERIC M, MARC R, PATRICIA FORTNEY	306 PEARL ST	LA CROSSE WI 54601-3202	306 PEARL ST APT 1
RONALD, ERIC M, MARC R, PATRICIA FORTNEY	306 PEARL ST	LA CROSSE WI 54601-3202	306 PEARL ST APT 10
RONALD, ERIC M, MARC R, PATRICIA FORTNEY	306 PEARL ST	LA CROSSE WI 54601-3202	306 PEARL ST APT 2
RONALD, ERIC M, MARC R, PATRICIA FORTNEY	306 PEARL ST	LA CROSSE WI 54601-3202	306 PEARL ST APT 3
RONALD, ERIC M, MARC R, PATRICIA FORTNEY	306 PEARL ST	LA CROSSE WI 54601-3202	306 PEARL ST APT 4
RONALD, ERIC M, MARC R, PATRICIA FORTNEY	306 PEARL ST	LA CROSSE WI 54601-3202	306 PEARL ST APT 5
RONALD, ERIC M, MARC R, PATRICIA FORTNEY	306 PEARL ST	LA CROSSE WI 54601-3202	306 PEARL ST APT 6
RONALD, ERIC M, MARC R, PATRICIA FORTNEY	306 PEARL ST	LA CROSSE WI 54601-3202	306 PEARL ST APT 7
RONALD, ERIC M, MARC R, PATRICIA FORTNEY	306 PEARL ST	LA CROSSE WI 54601-3202	306 PEARL ST APT 8
RONALD, ERIC M, MARC R, PATRICIA FORTNEY	306 PEARL ST	LA CROSSE WI 54601-3202	306 PEARL ST APT 9
ORAS INC	316 PEARL ST	LA CROSSE WI 54601-3202	316 PEARL ST
ORAS INC	316 PEARL ST	LA CROSSE WI 54601-3202	318 PEARL ST
RONALD, ERIC M, MARC R, PATRICIA FORTNEY	306 PEARL ST	LA CROSSE WI 54601-3202	306 PEARL ST
RONALD, ERIC M, MARC R, PATRICIA FORTNEY	306 PEARL ST	LA CROSSE WI 54601-3202	312 PEARL ST
STEPHEN D HARM	PO BOX 2044	LA CROSSE WI 54602-2044	320 PEARL ST
STEPHEN D HARM	PO BOX 2044	LA CROSSE WI 54602-2044	322 PEARL ST
STEPHEN D HARM	PO BOX 2044	LA CROSSE WI 54602-2044	324 PEARL ST
STEPHEN D HARM	PO BOX 2044	LA CROSSE WI 54602-2044	326 PEARL ST
STEPHEN D HARM	PO BOX 2044	LA CROSSE WI 54602-2044	328 PEARL ST
STEPHEN D HARM	806 STARLIGHT DR	HOLMEN WI 54636	330 PEARL ST
JEAN E WIGGERT	W5851 CEDAR RD	LA CROSSE WI 54601	217 3RD ST S
JEAN E WIGGERT	W5851 CEDAR RD	LA CROSSE WI 54601	219 3RD ST S
JEAN E WIGGERT	W5851 CEDAR RD	LA CROSSE WI 54601	221 3RD ST S
JEAN E WIGGERT	W5851 CEDAR RD	LA CROSSE WI 54601	208 4TH ST S
JEAN E WIGGERT	W5851 CEDAR RD	LA CROSSE WI 54601	210 4TH ST S
JEAN E WIGGERT	W5851 CEDAR RD	LA CROSSE WI 54601	327 JAY ST
JEAN E WIGGERT	W5851 CEDAR RD	LA CROSSE WI 54601	329 JAY ST

ORIGINAL
1 of 2

COPY

COPY

329 JAV ST APT 201
329 JAV ST APT 202
329 JAV ST APT 203
329 JAV ST APT 204
329 JAV ST APT 205
329 JAV ST APT 206
329 JAV ST STE 301
333 JAV ST
206 4TH ST S
206 4TH ST S APT 1
206 4TH ST S APT 2
206 4TH ST S APT 3
206 4TH ST S APT 4
227 3RD ST S

LA CROSSE WI 54601
LA CROSSE WI 54601
LA CROSSE WI 54601
LA CROSSE WI 54601
LA CROSSE WI 54601
LA CROSSE WI 54601
LA CROSSE WI 54601
LA CROSSE WI 54601
LA CROSSE WI 54601
LA CROSSE WI 54601
LA CROSSE WI 54601
LA CROSSE WI 54601
LA CROSSE WI 54601
LA CROSSE WI 54601
LA CROSSE WI 54601
LA CROSSE WI 54601
LA CROSSE WI 54601
LA CROSSE WI 54601
LA CROSSE WI 54601
LA CROSSE WI 54601

W5851 CEDAR RD
W5851 CEDAR RD
W5851 CEDAR RD
W5851 CEDAR RD
W5851 CEDAR RD
W5851 CEDAR RD
W5851 CEDAR RD
W5851 CEDAR RD
W5851 CEDAR RD
901 ROSE ST
901 ROSE ST
901 ROSE ST
901 ROSE ST
901 ROSE ST
901 ROSE ST
W5851 CEDAR RD
W5851 CEDAR RD
W5851 CEDAR RD
W5851 CEDAR RD
W5851 CEDAR RD
W5851 CEDAR RD
W5851 CEDAR RD
901 ROSE ST
901 ROSE ST
901 ROSE ST
W5851 CEDAR RD

JEAN E WIGGERT
JEAN E WIGGERT
JEAN E WIGGERT
JEAN E WIGGERT
JEAN E WIGGERT
JEAN E WIGGERT
JEAN E WIGGERT
JEAN E WIGGERT
JEAN E WIGGERT
JEAN E WIGGERT
JEAN E WIGGERT
JEAN E WIGGERT
JEAN E WIGGERT
JEAN E WIGGERT
JEAN E WIGGERT
JEAN E WIGGERT
JEAN E WIGGERT
JEAN E WIGGERT
JEAN E WIGGERT
JEAN E WIGGERT
JAE ENTERPRISES LLC
JAE ENTERPRISES LLC
JAE ENTERPRISES LLC
JAE ENTERPRISES LLC
JAE ENTERPRISES LLC
JAE ENTERPRISES LLC
JAE ENTERPRISES LLC
JEAN E WIGGERT
JEAN E WIGGERT
JEAN E WIGGERT
JEAN E WIGGERT
JEAN E WIGGERT
JAE ENTERPRISES LLC

ORIGINAL
2/12