

License Fee: _____

Invoice No.: _____

**APPLICATION TO OWN, KEEP AND/OR HARBOR CHICKENS
IN THE CITY OF LA CROSSE**

License Period: January 1, ____ to December 31, ____

Use Conditions:

- One property is limited to the keeping or harboring of up to five (5) chickens.
- A person may only own, keep or harbor chickens on property being used as a one-family dwelling (single family) or two-family dwelling (duplex).
- No person shall keep any rooster.
- No person shall slaughter any chickens.
- Chickens shall be provided with a covered enclosure and kept in covered enclosure or a fenced enclosure within the backyard of the property at all times.
- No enclosure shall be located closer than 25 feet to any residential structure on an adjacent lot.

APPLICANT:

JESSIE THORSEN

PROPERTY ADDRESS WHERE CHICKENS WILL BE KEPT:

2213 15TH PLACE SOUTH

PROPERTY OWNER(S):

JESSIE T

*If applicant is not the owner, please provide written documentation from the owner that they have been notified.
Not applicable for renewal.*

Is the property X ONE-FAMILY dwelling or ____ TWO-FAMILY dwelling? (Check One)

*If duplex, provide written documentation from other occupant that they have been notified.
Not applicable for renewal.*

Attach a scale drawing showing property lot lines, dimensions of coop/enclosure and distance from adjoining lot lines and residential structures.

Applying for and obtaining this chicken permit DOES NOT provide any authority to violate any restrictive covenants that govern the property where you reside or intend to keep chickens. Please review any Declaration of Restrictions or Restrictive Covenants that apply to the property prior to applying for a chicken permit. No permit fees will be refunded once they are paid.

I hereby certify that I have read and understand the content of this application and that the above statements are true and correct to the best of my knowledge. I further certify that I understand that any such license is subject to revocation in accordance with Municipal Code of Ordinances Sec. 6-16.

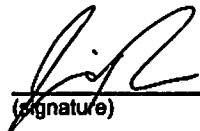
(signature)

608-385-4368
(signature)
(telephone)

6-20-22
(date)



TYLER A MAGNUS
VIRGINIA ANN TAYLOR
17-50013-40

Measurement

Feet

Measurement Result

33.6 Feet

Clear

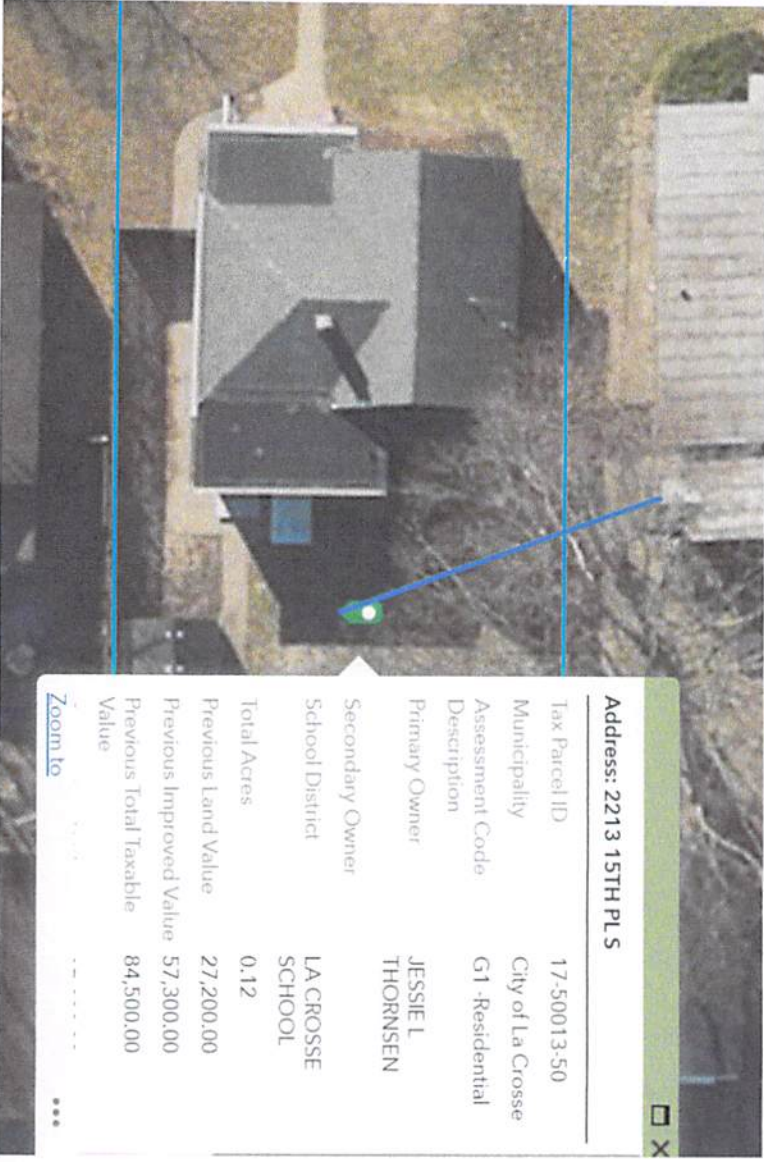

Address: 2213 15TH PLS

Tax Parcel ID	17-50013-50
Municipality	City of La Crosse
Assessment Code Description	G1 -Residential
Primary Owner	JESSIE L THORNSEN
Secondary Owner	
School District	LA CROSSE SCHOOL
Total Acres	0.12
Previous Land Value	27,200.00
Previous Improved Value	57,300.00
Previous Total Taxable Value	84,500.00

[Zoom to](#)

i Last purchased Jun 16, 2022.

[View order](#)



Roll over image to zoom in





Best Choice Products 80in Outdoor Wooden Chicken Coop Multi-Level Hen House, Poultry Cage w/Ramps, Run, Nesting Box, Wire Fence, 3 Access Areas

Visit the Best Choice Products Store

★★★★☆ 1,918 ratings

Best Seller

\$279⁹⁹

prime

Save \$107

Get \$125 off: Pay \$154.99 upon approval for the **Amazon Business Prime Card**. Terms apply.

Enhance your purchase

Payment plans

From \$46.67/mo (6 mo) with 0% APR

Brand Best Choice Products

Color Brown

Item Dimensions LxWxH 79.5 x 26.5 x 51.5 inches

Material Wood Metal

Item Weight 36 Pounds

\$279⁹⁹

prime

FREE delivery **Friday, Jun 10**
Order within 13 hrs 52 min
[Details](#)

Deliver to Jessie - La Crc 54601

In Stock.

Qty: 1

Secure transaction

Ships from BestChoiceproc
Sold by BestChoiceproc

Return policy: Eligible for Return, Refund or Replacement within 30 days of receipt

Have one to sell?

