

Original Alcohol Beverage Retail License Application

Submit to municipal clerk.

For the license period beginning December 14 20 18 ;
 ending June 30 20 19

TO THE GOVERNING BODY of the: Town of
 Village of } LA CROSSE
 City of

County of LA CROSSE Aldermanic Dist. No. _____ (if required by ordinance)

Applicant's WI Seller's Permit No.:		FEIN Number:	
		83-2650869	
LICENSE REQUESTED			
TYPE		FEE	
<input type="checkbox"/>	Class A beer	\$	
<input type="checkbox"/>	Class B beer	\$	
<input type="checkbox"/>	Class C wine	\$	
<input type="checkbox"/>	Class A liquor	\$	
<input type="checkbox"/>	Class A liquor (cider only)	\$	N/A
<input type="checkbox"/>	Class B liquor	\$	
<input type="checkbox"/>	Reserve Class B liquor	\$	
<input type="checkbox"/>	Class B (wine only) winery	\$	
	Publication fee	\$	<u>20.00</u>
TOTAL FEE		\$	

1. The named Individual Partnership Limited Liability Company
 Corporation / Nonprofit Organization

hereby makes application for the alcohol beverage license(s) checked above.

2. Name (individual/partners give last name, first, middle; corporations/limited liability companies give registered name): TRACK II, LLC

An "Auxiliary Questionnaire," Form AT-103, must be completed and attached to this application by each individual applicant, by each member of a partnership, and by each officer, director and agent of a corporation or nonprofit organization, and by each member/manager and agent of a limited liability company. List the name, title, and place of residence of each person.

Title	Name (Last, First, M.I.)	Home Address	Post Office & Zip Code
President/Member	<u>MANGAGING MEMBER DOLEZEL, STEVEN J.</u>	<u>3220 EMERALD VALLEY DR.</u>	<u>ONALASKA 54650</u>
Vice President/Member			
Secretary/Member			
Treasurer/Member			
Agent	<u>Steven J. DOLEZEL (see Above)</u>		
Directors/Managers			

3. Trade Name TRACK II Business Phone Number 608-782-4988

4. Address of Premises 716 GILLETTE STREET LA CROSSE WI Post Office & Zip Code 54603

5. Is individual, partners or agent of corporation/limited liability company subject to completion of the responsible beverage server training course for this license period? Yes No
6. Is the applicant an employe or agent of, or acting on behalf of anyone except the named applicant? Yes No
7. Does any other alcohol beverage retail licensee or wholesale permittee have any interest in or control of this business? Yes No
8. (a) Corporate/limited liability company applicants only: Insert state WI and date 11/28/18 of registration.
- (b) Is applicant corporation/limited liability company a subsidiary of any other corporation or limited liability company? Yes No
- (c) Does the corporation, or any officer, director, stockholder or agent or limited liability company, or any member/manager or agent hold any interest in any other alcohol beverage license or permit in Wisconsin? Yes No
- (NOTE: All applicants explain fully on reverse side of this form every YES answer in sections 5, 6, 7 and 8 above.)

9. Premises description: Describe building or buildings where alcohol beverages are to be sold and stored. The applicant must include all rooms including living quarters, if used, for the sales, service, consumption, and/or storage of alcohol beverages and records. (Alcohol beverages may be sold and stored only on the premises described.) ENTIRE 1ST FLOOR OF THE BUILDING ON THE PREMISES

10. Legal description (omit if street address is given above): NOT SALES/SERVICE & STORAGE

11. (a) Was this premises licensed for the sale of liquor or beer during the past license year? Yes No

- (b) If yes, under what name was license issued? GEARY INVESTMENTS, LLC D/B/A TRACK II

12. Does the applicant understand they must register as a Retail Beverage Alcohol Dealer with the federal government, Alcohol and Tobacco Tax and Trade Bureau (TTB) by filing (TTB form 5630.5d) before beginning business? [phone 1-877-882-3277]. Yes No

13. Does the applicant understand they must hold a Wisconsin Seller's Permit? [phone (608) 266-2776]. Yes No

14. Does the applicant understand that they must purchase alcohol beverages only from Wisconsin wholesalers, breweries and brewpubs? Yes No

READ CAREFULLY BEFORE SIGNING: Under penalty provided by law, the applicant states that each of the above questions has been truthfully answered to the best of the knowledge of the signer. Any person who knowingly provides materially false information on this application may be required to forfeit not more than \$1,000. Signer agrees to operate this business according to law and that the rights and responsibilities conferred by the license(s), if granted, will not be assigned to another. (Individual applicants, or one member of a partnership applicant must sign; one corporate officer, one member/manager of Limited Liability Companies must sign.) Any lack of access to any portion of a licensed premises during inspection will be deemed a refusal to permit inspection. Such refusal is a misdemeanor and grounds for revocation of this license.

 (Officer of Corporation / Member / Manager of Limited Liability Company / Partner / Individual)

TO BE COMPLETED BY CLERK

Date received and filed with municipal clerk <u>11/28/18</u>	Date reported to council / board	Date provisional license issued	Signature of Clerk / Deputy Clerk
Date license granted	Date license issued	License number issued	

SCHEDULE FOR APPOINTMENT OF AGENT BY CORPORATION/NONPROFIT ORGANIZATION OR LIMITED LIABILITY COMPANY

Submit to municipal clerk.

All corporations/organizations or limited liability companies applying for a license to sell fermented malt beverages and/or intoxicating liquor must appoint an agent. The following questions must be answered by the agent. The appointment must be signed by the officer(s) of the corporation/organization or members/managers of a limited liability company and the recommendation made by the proper local official.

To the governing body of: Town
 Village of LA CROSSE County of LA CROSSE
 City

The undersigned duly authorized officer(s)/members/managers of TRACK II, LLC
(registered name of corporation/organization or limited liability company)

a corporation/organization or limited liability company making application for an alcohol beverage license for a premises known as TRACK II
(trade name)

located at 716 GILLETTE STREET LA CROSSE, WI 54603

appoints STEVEN J. DOLEZEL
(name of appointed agent)
3220 EMERALD VALLEY DRIVE ONALASKA, WI 54650
(home address of appointed agent)

to act for the corporation/organization/limited liability company with full authority and control of the premises and of all business relative to alcohol beverages conducted therein. Is applicant agent presently acting in that capacity or requesting approval for any corporation/organization/limited liability company having or applying for a beer and/or liquor license for any other location in Wisconsin?

Yes No If so, indicate the corporate name(s)/limited liability company(ies) and municipality(ies).
COULEE GOLF BOWL, INC., CITY OF ONALASKA, WISCONSIN

Is applicant agent subject to completion of the responsible beverage server training course? Yes No

How long immediately prior to making this application has the applicant agent resided continuously in Wisconsin? 56

Place of residence last year 3220 EMERALD VALLEY DRIVE, ONALASKA WI 54650

For: TRACK II, LLC
(name of corporation/organization/limited liability company)

By: 
(signature of Officer/Member/Manager)

And: _____
(signature of Officer/Member/Manager)

ACCEPTANCE BY AGENT

I, STEVEN J. DOLEZEL, hereby accept this appointment as agent for the
(print/type agent's name)

corporation/organization/limited liability company and assume full responsibility for the conduct of all business relative to alcohol beverages conducted on the premises for the corporation/organization/limited liability company.

 11/28/2018 Agent's age _____
(signature of agent) (date)
3220 EMERALD VALLEY DRIVE, ONALASKA WI 54650 Date of birth _____
(home address of agent)

**APPROVAL OF AGENT BY MUNICIPAL AUTHORITY
(Clerk cannot sign on behalf of Municipal Official)**

I hereby certify that I have checked municipal and state criminal records. To the best of my knowledge, with the available information, the character, record and reputation are satisfactory and I have no objection to the agent appointed.

Approved on _____ by _____ Title _____
(date) (signature of proper local official) (town chair, village president, police chief)

Original:

License Fee: 135⁰⁰

Renewal:

Invoice #:

APPLICATION FOR INDOOR CABARET LICENSE

Legal/Real Name: Track II, LLC

Address of above: 1052 Oak Forest Drive OWAHASKA WI

Trade name of business: Track II

Address of premises to be licensed: 716 GILLETTE STREET, LaCrosse WI

Business phone number: (608) 782-4988

Detailed description of cabaret area to be licensed: Entire First Floor of the Building on the Premises

Premises are owned by: Steve Dolezal

Address of owner: 3220 Emerald Valley Drive OWAHASKA WI

Name of Cabaret Manager (FIRST, MIDDLE & LAST): Steve John Dolezal

Home address of Cabaret Manager: 3220 Emerald Valley Drive OWAHASKA WI

Home phone number of Cabaret Manager: (608) 781-3047

Daytime phone number of Cabaret Manager: (608) 519-1940

Date of Birth of Cabaret Manager: _____

Was the above person listed as manager on last year's application? Yes ___ No X

Other business to be conducted upon the premises: Alcohol Sales

Nature of entertainment: Live Music

License Period: _____

The above hereby makes application for a license to operate an Indoor Cabaret at the above address within the City of La Crosse pursuant to provisions of Sec. 10-100 of the Code of Ordinances for the City of La Crosse.

[Signature]
(Signature of applicant & date)

OFFICE USE ONLY: _____ **Munis Customer #:** _____

For original applications: Are there lands zoned conservancy, residential or multiple dwelling within 100 feet of premises? Y/N If yes, attach a list of those lands.

Signature and date _____

Granted: _____ License #: _____

SURRENDER OF LICENSE
 Part I

Legal/Real Name of Current Licensee: GEARY INVESTMENTS, LLC D/B/A TRACK II
 Premises Address: 714 GILLETTE STREET, LA CROSSE WI 54603
 Trade Name: TRACK II

This is to advise that the undersigned is surrendering the following license(s)

- ✓ Combination "Class B" Beer & Liquor
- Class "B" Beer
- Class "A" Beer and/or "Class A" Liquor (circle which apply)
- Wholesale Beer
- "Class C" Wine

to: TRACK II, LLC dba Track II
(Insert Legal/Real Name of Proposed Licensee and Trade Name)

and understand that said license(s) will be cancelled upon the Common Council's granting of a license to the applicant named herein.

New Applicant

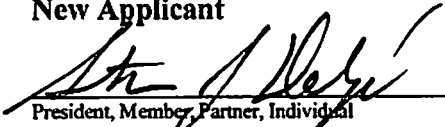

 President, Member, Partner, Individual

Current Licensee



 President, Member, Partner, Individual

Secretary, Member, Partner

Secretary, Member, Partner

(Notarized on Reverse)

State of Wisconsin)
) ss.
 County of La Crosse)

On the 28 day of NOVEMBER, 2018, personally came before me JAMES GEARY, known to me to be the person(s) who executed the foregoing Surrender of License, and known to me to be the Current Licensee and acknowledged that s/he executed the foregoing document.



 Notary Public
LaCrosse County, Wisconsin
 My Commission expires: permanent

State of Wisconsin)
) ss.
 County of La Crosse)

On the 28 day of NOVEMBER, 2018, personally came before me STEVEN J. DOLEZEL, known to me to be the person(s) who executed the foregoing Surrender of License, and known to me to be the Proposed New Applicant and acknowledged that s/he executed the foregoing document.

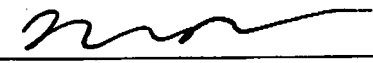

 Notary Public
LaCrosse County, Wisconsin
 My Commission expires: permanent



TERI LEHRKE, WCPC, City Clerk
400 LA CROSSE STREET
LA CROSSE, WISCONSIN 54601
PHONE (608) 789-7510
FAX (608) 789-7552
www.cityoflacrosse.org

**NOTICE OF APPLICATION FOR INDOOR CABARET LICENSE
IN THE CITY OF LA CROSSE**

TO WHOM IT MAY CONCERN:

This is to notify you that the following business has applied for an **Indoor Cabaret** license under Sec. 10-140(c) of the Code of Ordinances of the City of La Crosse to provide live entertainment in a designated indoor area.

Track II LLC d/b/a Track II
at 716 Gillette St., La Crosse, WI 54603

This application will be considered at the following meetings:

Judiciary and Administration Committee – Tuesday, December 4th, 2018 at 6:00 p.m.
Common Council Meeting – Thursday, December 13th, 2018 at 6:00 p.m.

All the above meetings are held in the Council Chambers in the City Hall at 400 La Crosse Street, La Crosse, WI.

You are further notified that any person affected may be heard, and may appear in person or by attorney, or may file a letter of objection in the office of the City Clerk.

This notice is given pursuant to the order of the Common Council of the City of La Crosse.

Dated this 29th day of November, 2018.

A handwritten signature in cursive script that reads "Teri Lehrke".

Teri Lehrke, WCPC, City Clerk
City of La Crosse

A handwritten signature in cursive script that reads "Jay A. Christianson".

Jay A. Christianson
Assistant Clerk

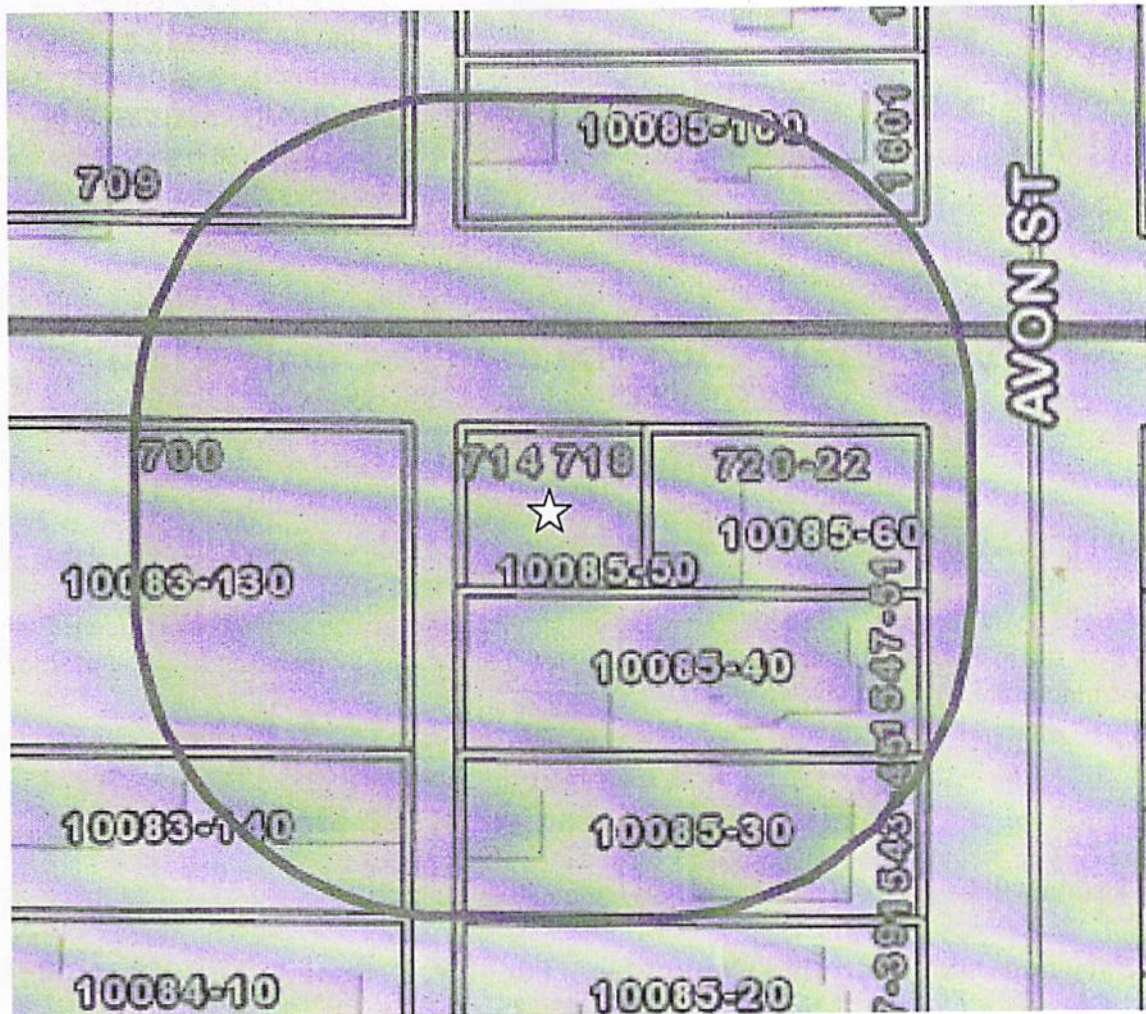

Track II LLC d/b/a Track II
716 Gillette St.
100' Buffer for Indoor Cabaret
December 13th, 2018 Council Meeting

OwnerName	MailingLine4	MailingLine5	Property Address
NEIGHBORHOOD RENTALS LLC	340 S LEMON AVE #8508	WALNUT CA 91789-2706	718 GOHRES ST
OLSON RENTAL PROPERTIES LLC	1720 GEORGE ST	LA CROSSE WI 54603-2150	1718 GEORGE ST
GEARY INVESTMENTS LLC	2408 LOOMIS ST	LA CROSSE WI 54603	718 GILLETTE ST
GEARY INVESTMENTS LLC	2408 LOOMIS ST	LA CROSSE WI 54603	718 GILLETTE ST APT 1
GEARY INVESTMENTS LLC	2408 LOOMIS ST	LA CROSSE WI 54603	718 GILLETTE ST APT 2
GEARY INVESTMENTS LLC	2408 LOOMIS ST	LA CROSSE WI 54603	718 GILLETTE ST APT 3
GEARY INVESTMENTS LLC	2408 LOOMIS ST	LA CROSSE WI 54603	718 GILLETTE ST APT 4
GEARY INVESTMENTS LLC	2408 LOOMIS ST	LA CROSSE WI 54603	718 GILLETTE ST APT 5
GEARY INVESTMENTS LLC	2408 LOOMIS ST	LA CROSSE WI 54603	718 GILLETTE ST APT 6
GEARY INVESTMENTS LLC	2408 LOOMIS ST	LA CROSSE WI 54603	718 GILLETTE ST APT 7