

WINNEBAGO STREET

MARKET STREET

SALZER TERRACE ADDITION

SCALE: H 1"=20' / V 1"=2'
ELEVATIONS SHOWN ARE NAVD 88

BENCHMARKS
TOP NUT OF HYDRANT
21ST STREET & WINNEBAGO ST 673.29
21ST STREET & MARKET ST 671.87

GENERAL NOTES
• CONTRACTOR TO VERIFY ALL PIPE SIZES AND MATERIAL IN FIELD
• CONTRACTOR SHALL PROTECT ALL STM INFRASTRUCTURE UNLESS NOTED ON PLAN AS REPLACE

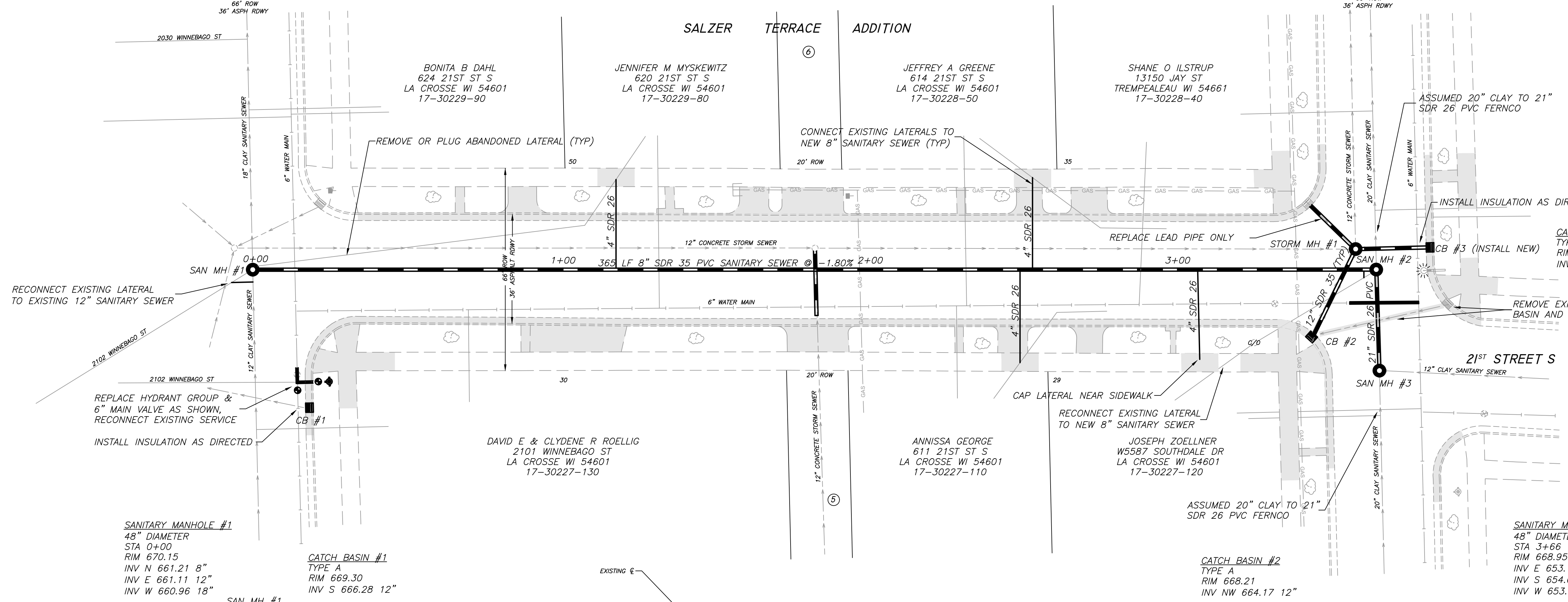

SANITARY MANHOLE #1
48" DIAMETER
STA 0+00
RIM 670.15
INV N 661.21 8"
INV E 661.11 12"
INV W 660.96 18"

CATCH BASIN #1
TYPE A
RIM 669.30
INV S 666.28 12"

STORM MANHOLE #1
48" DIAMETER
STA 3+59
RIM 668.95
INV N 664.30 12"
INV SE 663.95 12"
INV S 663.95 12"
INV SW 665.00 12"
INV W 663.66 12"

SANITARY MANHOLE #2
48" DIAMETER
STA 3+66
RIM 668.95
INV E 653.15 21"
INV S 654.65 8"
INV W 653.15 21"

SANITARY MANHOLE #3
48" DIAMETER, OUTSIDE DROP
RIM 669.00
INV N 656.04 12"
INV SE 653.23 10" OUTSIDE DROP
INV E 653.23 21"
INV W 653.23 21"

CATCH BASIN #2
TYPE A
RIM 668.21
INV NW 664.17 12"

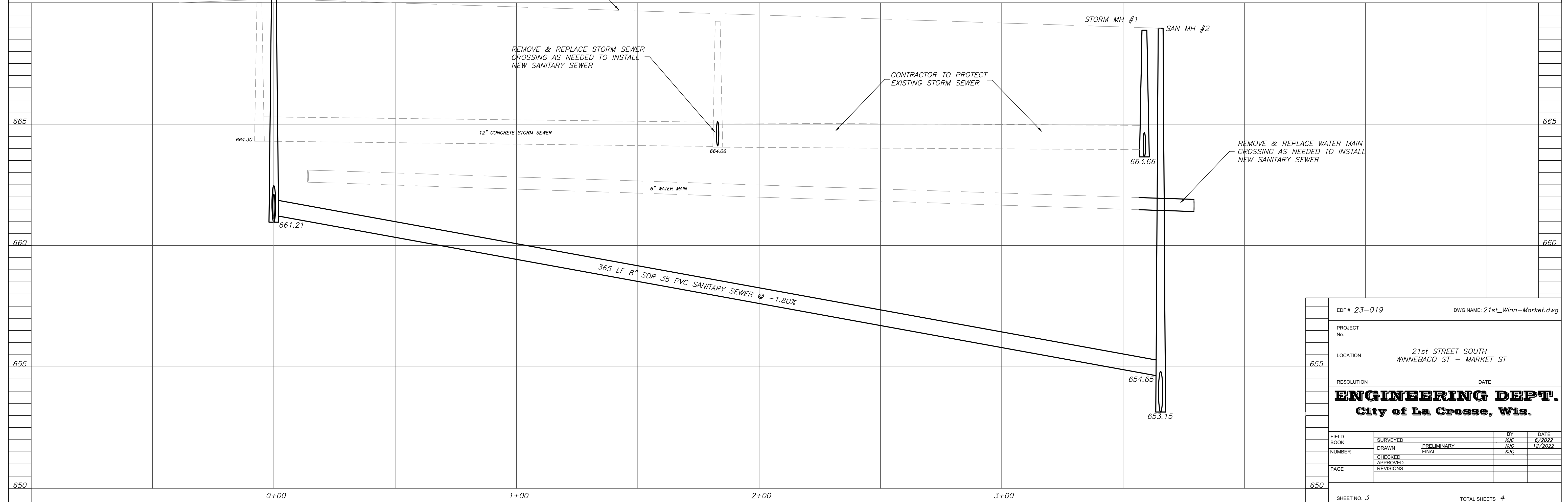

EDF # 23-019	DWG NAME: 21st_Winn-Market.dwg		
PROJECT No.			
LOCATION	21st STREET SOUTH WINNEBAGO ST - MARKET ST		
RESOLUTION	DATE		
ENGINEERING DEPT. City of La Crosse, Wis.			
FIELD BOOK	SURVEYED	BY	DATE
NUMBER	DRAWN	KJC	6/2022
	CHECKED	KJC	12/2022
	APPROVED		
	REVISIONS		
PAGE			
650			
SHEET NO. 3	TOTAL SHEETS 4		