

# ArcGIS Web Map



February 24, 2016

### Zoning

- |                           |                                     |                             |                   |
|---------------------------|-------------------------------------|-----------------------------|-------------------|
| R1 - SINGLE FAMILY        | R5 - MULTIPLE DWELLING              | C3 - COMMUNITY BUSINESS     | CON - CONSERVANCY |
| R2 - RESIDENCE            | R6 - SPECIAL MULTIPLE               | M1 - LIGHT INDUSTRIAL       | FW - FLOODWAY     |
| WR - WASHBURN RESIDENTIAL | PD - PLANNED DEVELOPMENT            | M2 - HEAVY INDUSTRIAL       | A1 - AGRICULTURAL |
| R3 - SPECIAL RESIDENCE    | TND - TRADITIONAL NEIGHBORHOOD DEV. | PS - PUBLIC AND SEMI-PUBLIC | EA                |
| R4 - LOW DENSITY MULTIPLE | C1 - LOCAL BUSINESS                 | PL - PARKING LOT            |                   |
|                           | C2 - COMMERCIAL                     | UT - PUBLIC UTILITY         |                   |

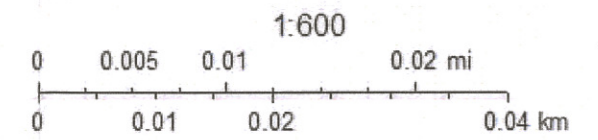

La Crosse County, City of La Crosse

City of La Crosse

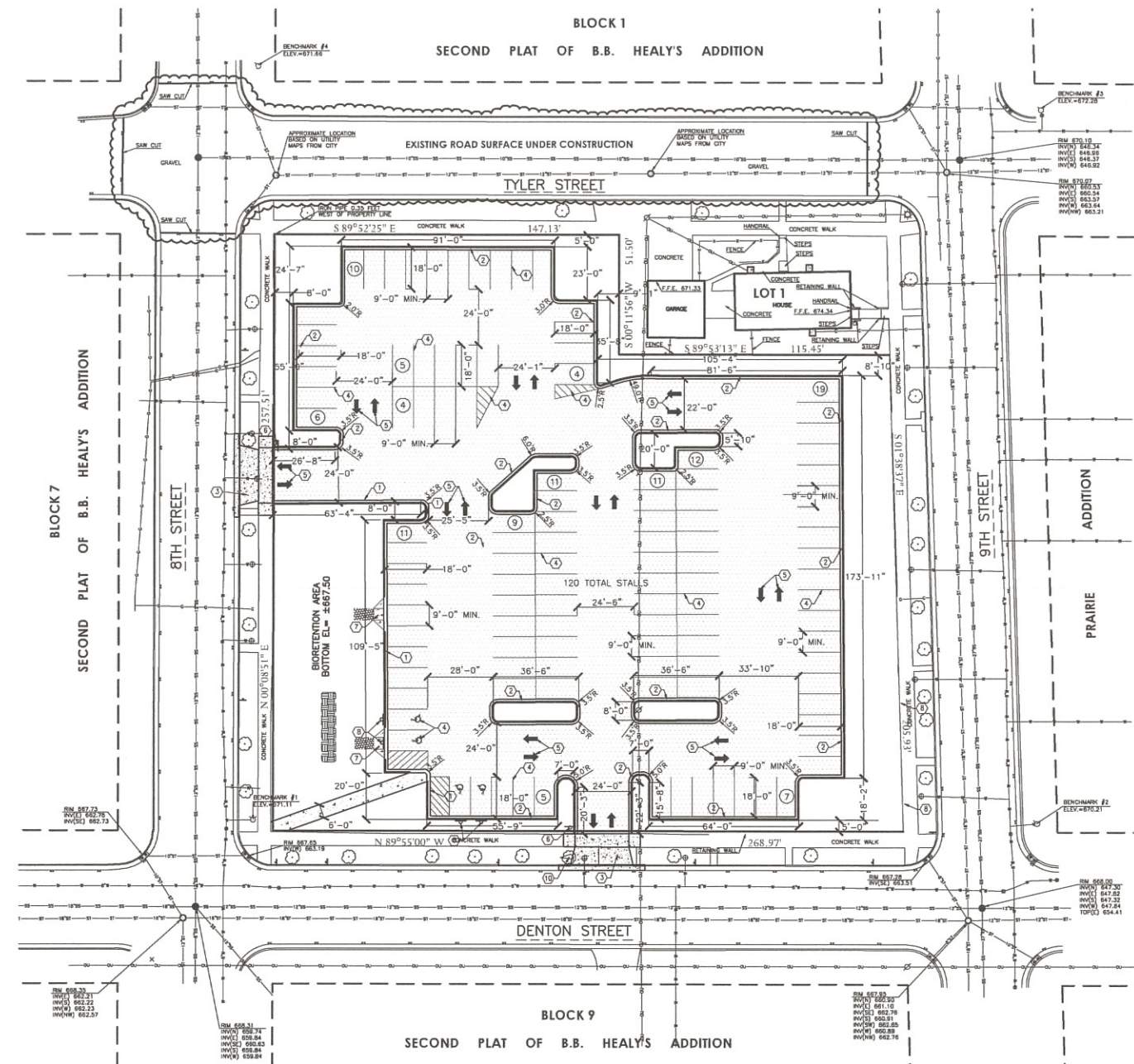

**GENERAL NOTES:**

- CONTACT DIGGER'S HOTLINE 5 WORKING DAYS PRIOR TO THE START OF DEMOLITION/CONSTRUCTION.
- GRADE, LINE, AND LEVEL TO BE REVIEWED IN THE FIELD BY THE CONSTRUCTION MANAGER.
- ALL REQUIRED EROSION CONTROL MEASURES ARE TO BE INSTALLED IN ACCORDANCE WITH LOCAL MUNICIPAL AND DEPARTMENT OF NATURAL RESOURCES REGULATIONS.
- ALL EROSION CONTROL MEASURES SHALL BE MAINTAINED IN ACCORDANCE WITH THE DEPARTMENT OF NATURAL RESOURCES AND LOCAL AUTHORITIES.
- SEE SHEET 3 FOR ALL REQUIRED EROSION CONTROL ELEMENTS.
- ANY EXISTING UTILITIES NOT SHOWN ON THIS DOCUMENT WHICH NEED TO BE REMOVED, RELOCATED AND OR ADJUSTED SHALL BE THE RESPONSIBILITY OF THE SITE GRADING CONTRACTOR AND INCLUDED IN THE BASE BID CONTRACT.
- VERIFY THE LOCATION OF ALL EXISTING UTILITIES PRIOR TO THE START OF DEMOLITION/CONSTRUCTION.
- ALL BIDDERS PLANNING ON SUBMITTING A BID SHALL VISIT THE SITE AND REVIEW THE EXISTING CONDITIONS PRIOR TO THE BID DATE.
- PRIOR TO THE START OF WORK VERIFY WITH THE LOCAL AUTHORITIES THAT ALL REQUIRED PERMITS HAVE BEEN ACQUIRED.
- COORDINATE CONSTRUCTION IN THE RIGHT OF WAY WITH THE LOCAL AUTHORITIES.
- THE CONTRACTOR SHALL KEEP ALL CONSTRUCTION EQUIPMENT AND MATERIAL STORAGE OUTSIDE OF THE BUFFER AREA AS SHOWN.
- PROVIDE PROPER BARRICADES, SIGNS AND TRAFFIC CONTROL TO MAINTAIN THRU TRAFFIC ALONG ADJACENT STREETS IN ACCORDANCE WITH LOCAL MUNICIPAL REQUIREMENTS.
- SIDEWALK JOINTS TO BE AS INDICATED OR AS APPROVED BY CONSTRUCTION MANAGER.
- ALL SAWCUTS SHALL BE AT AN EXISTING JOINT IN THE CURB AND PAVEMENT.
- ALL NEW CONCRETE PAVEMENT AND CURB ON ADJACENT STREET SHALL BE TIED IN ACCORDANCE WITH DETAIL 5 ON SHEET 5.
- ALL GENERAL LANDSCAPE AREAS SHALL BE SEEDED/FERTILIZED/ AND EROSION MATTED IN ACCORDANCE WITH THE PROJECT SPECIFICATIONS.

**KEYNOTES:**

- |                                       |   |                                 |   |
|---------------------------------------|---|---------------------------------|---|
| ① 18" CONCRETE CURB & GUTTER          | ② | ⑧ HANDICAP SIGN                 | ⑤ |
| ② 18" CONCRETE CURB & GUTTER (REJECT) | ③ | ⑨ REMOVE RETAINING WALL & STEPS | ⑩ |
| ③ DRIVE APRON                         | ④ | ⑩ REMOVE TREE                   |   |
| ④ PARKING LOT STRIPING                | ⑤ |                                 |   |
| ⑤ DIRECTIONAL ARROW                   | ⑥ |                                 |   |
| ⑥ STOP SIGN                           | ⑦ |                                 |   |
| ⑦ CONCRETE FLUME W/ RIPRAP            |   |                                 |   |

**PAVEMENT HATCH PATTERNS:**

- PROPOSED 3" ASPHALTIC CONCRETE PAVEMENT W/ 9" BASE COURSE
- PROPOSED 6" REINFORCED CONCRETE PAVEMENT
- PROPOSED 4" CONCRETE SIDEWALK

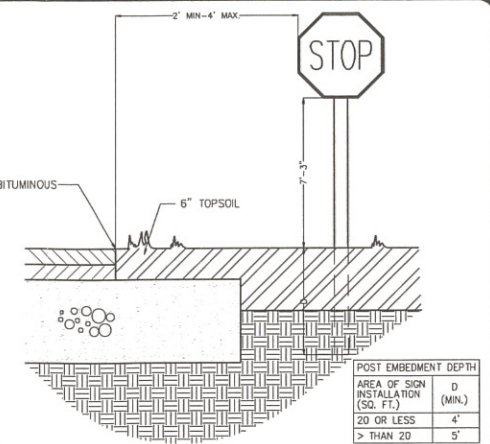
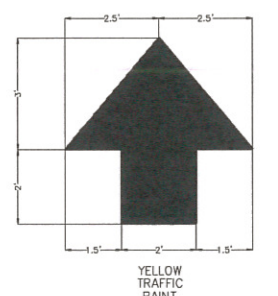
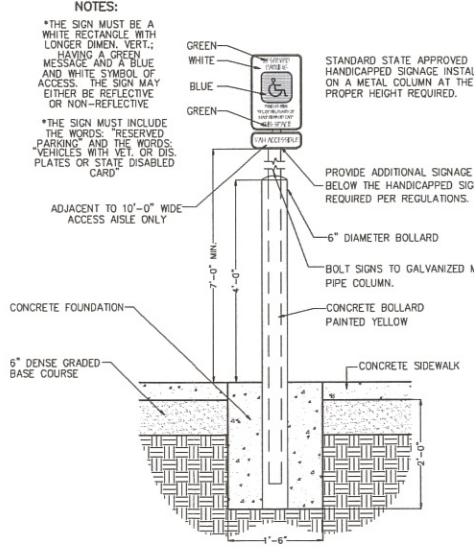
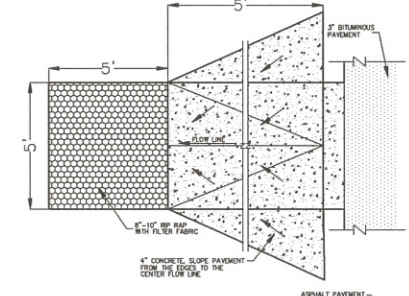
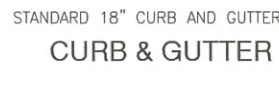

**DESCRIPTION**

LOTS 2-10, BLOCK 8, OF SECOND PLAT OF B.B. HEALY'S ADDITION; LOCATED IN THE NORTHEAST 1/4 OF THE NORTHWEST 1/4 OF SECTION 8, TOWNSHIP 15 NORTH, RANGE 7 WEST, CITY OF LA CROSSE, LA CROSSE COUNTY, WISCONSIN.

**BENCH MARK**

- ELEVATIONS ARE REFERENCED TO NAVD 88 DATUM.
- BENCHMARK #1 NORTHWEST FLANGE BOLT ON HYDRANT AT NORTHEAST CORNER OF DENTON STREET AND 8TH STREET. ELEVATION = 671.11
  - BENCHMARK #2 BURY BOLT ON HYDRANT NORTHEAST CORNER OF DENTON STREET AND 9TH STREET. ELEVATION = 670.21
  - BENCHMARK #3 NORTHWEST FLANGE BOLT ON HYDRANT LOCATED AT NORTHEAST CORNER OF TYLER STREET AND 9TH STREET. ELEVATION = 672.28
  - BENCHMARK #4 BURY BOLT ON HYDRANT LOCATED AT NORTHEAST CORNER OF TYLER STREET AND 8TH STREET. ELEVATION = 671.66

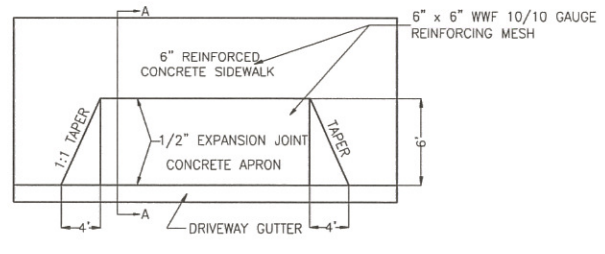
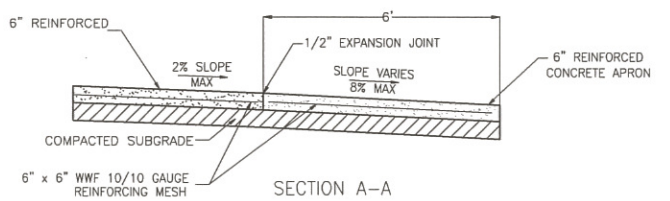

4" PAINTED STRIPES - YELLOW COLOR @ 24" O.C. AT 45 DEGREES.

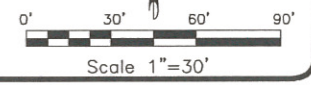
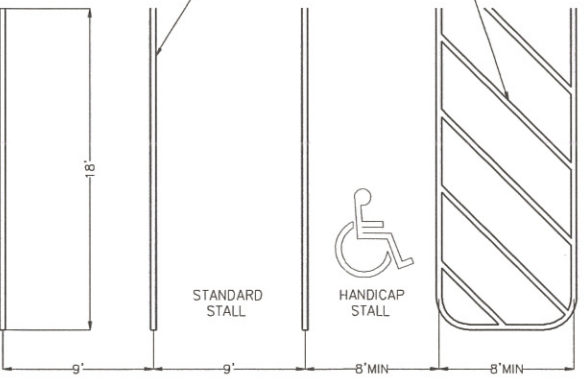

REVISIONS

CHECKED:	JL
DRAWN:	NP
DATE:	07-11-2016
PROJECT NO.:	16.067

**LAYOUT PLAN**

**GUNDERSON HEALTH CLINIC  
PARKING LOT DEVELOPMENT  
CITY OF LACROSSE  
LACROSSE COUNTY, WISCONSIN**

Land Surveying  
Engineering  
Landscape Architecture  
5709 Windy Drive, Suite D  
Stevens Point, WI 54482  
715.344.9999 (Ph) 715.344.9922 (Fax)

