

License Fee: \$ 225
(*additional \$50.00 tent fee, if applicable)

Invoice #: 126377

APPLICATION FOR SPECIAL EVENT OUTDOOR CABARET LICENSE
(MUST HAVE LICENSE POSTED ON PREMISE BEFORE BEGINNING EVENT)

Legal/Real Name: La Crosse's Finest LLC

Address of above: 103 3rd Street N., La Crosse, WI 54601

Trade name of business: Dublin Square Irish Pub & Eatery

Address of premises to be licensed: 103 3rd Street N., La Crosse, WI 54601

Business phone number: 608-519-2509

Date of Event: Sunday, August 30th, 2015

Time of Event: 1 PM - 8 PM

Description (Location) of Event Area: Corner of 3rd and Main St. to Main Street Alley

*Will there be a tent in excess of 400 sq. ft.(20' X 20')? Yes ___ No X If yes, add \$50.00 to fee. (If in combination with a Special Event Expansion, this fee not applicable.)

Premises are owned by: Paul and Rita Durhman

Address of owner: 2162 Grand View Blvd. Onalaska, WI 54650

Name of manager (FIRST, MIDDLE & LAST): Garrett Justin Stolt

Home address of manager: 1335 Market Street La Crosse, WI

Phone number: Daytime 608-780-2209

Date of Birth: _____ Payment Amount: 375.00

Other business to be conducted upon the premises: N/A

Nature of entertainment: Welcome Back Students Block Party, Live Music

The above hereby makes application for a license to operate a Special Event Outdoor Cabaret at the above address within the City of La Crosse pursuant to provisions of Chapter 10, Article IV of the Code of Ordinances for the City of La Crosse.

Garrett Stolt 6/9/15
(Signature of applicant & date)

INSURANCE REQUIRED ... MUST BE SUBMITTED WITH THE APPLICATION

Prior to the issuance of the Special Event Outdoor Cabaret License, the applicant shall furnish evidence of a liability insurance policy in amounts of not less than \$1,000,000 aggregate coverage, and shall be in force and effect at the time such event is to take place. Said evidence of insurance shall include a certificate of insurance naming the City of La Crosse as additional insured in connection with said event. If an entity is self-insured, it must provide evidence of alternative proof of coverage, in a form acceptable to the City Clerk.

OFFICE USE ONLY:

Munis Customer #:

Attach list of all property owners within 1000 feet of the proposed licensed premises.

Granted: _____ License #: _____

Main Street Alley

The Breakfast Club

The Old Crow

Barricade

Main Street

Lindy's

Portable Toilet

Exit Only

Main Street

Exit Only

Portable Toilet

Exit Only

Fenced Alcohol Area

Entrance

Outdoor Patio

Dublin Square

60' x 60'

Barricade

Outdoor Patio

3rd Street

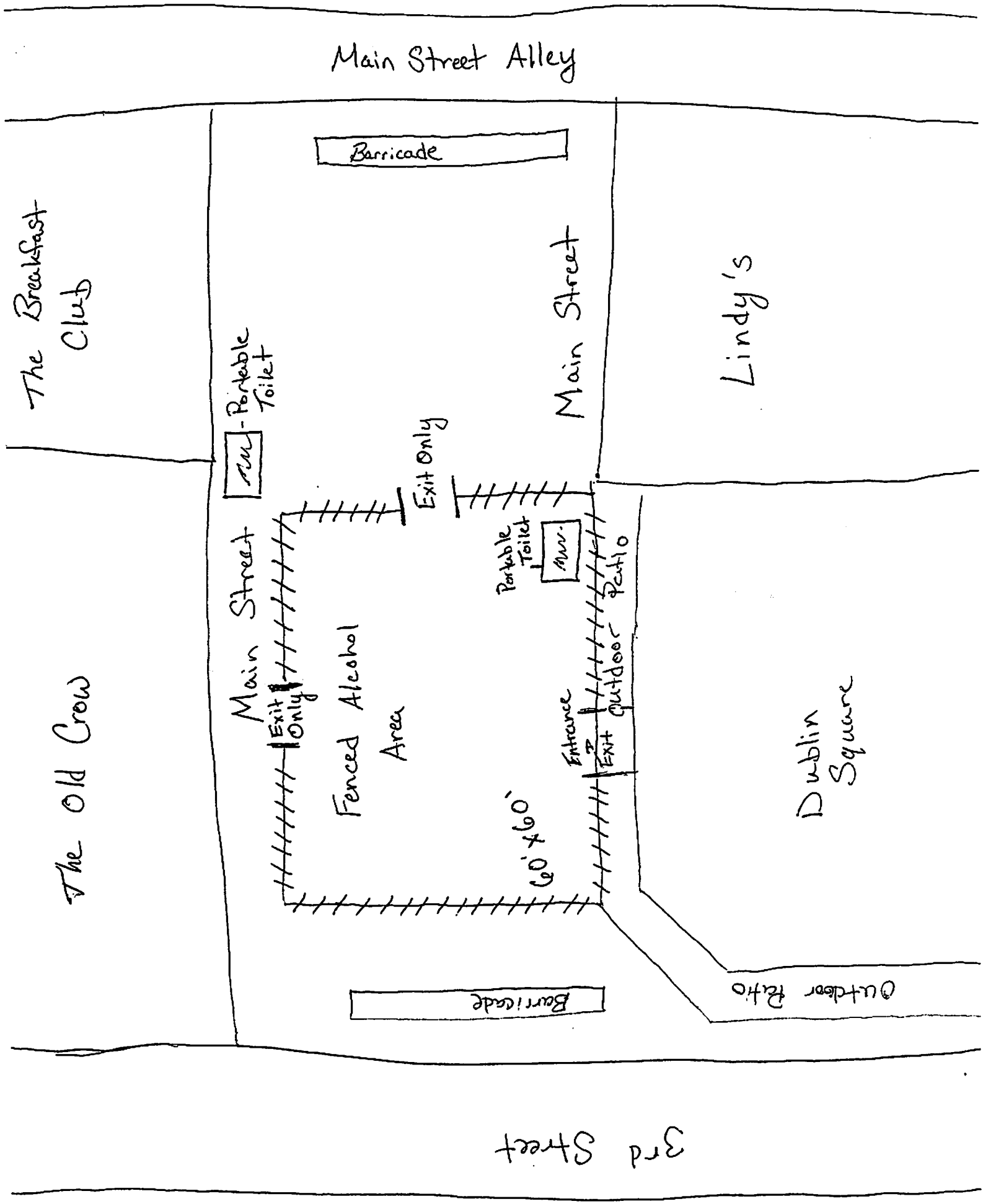



TERI LEHRKE, WCPC, City Clerk
400 LA CROSSE STREET
LA CROSSE, WISCONSIN 54601
PHONE (608) 789-7510
FAX (608) 789-7552
www.cityoflacrosse.org

**NOTICE OF APPLICATION FOR
SPECIAL EVENT OUTDOOR CABARET LICENSE
IN THE CITY OF LA CROSSE**

TO WHOM IT MAY CONCERN:

This is to notify you that the following business has applied for a **Special Event Outdoor Cabaret** license under Sec. 10-140(e) of the Code of Ordinances of the City of La Crosse to provide live entertainment in a designated outdoor area on **Sunday, August 30th, 2015**.

**La Crosse's Finest LLC d/b/a Dublin Square Irish Pub & Eatery
at 103 3rd St. N., La Crosse, WI 54601**

This application will be considered at the following meetings:

Judiciary and Administration Committee – Tuesday, June 30th, 2015 at 7:30 p.m.
Common Council Meeting – Thursday, July 9th, 2015 at 7:30 p.m.

Both meetings are held in the Council Chambers in the City Hall at 400 La Crosse Street, La Crosse, WI.

You are further notified that any person affected may be heard, and may appear in person or by attorney, or may file a letter of objection in the office of the City Clerk.

This notice is given pursuant to the order of the Common Council of the City of La Crosse.

Dated this 17th day of June, 2015.

Teri Lehrke, WCPC, City Clerk
City of La Crosse

Jay Christianson
License & Election Clerk III

Owner Name	Billing Address	Billing City/State/Zip
BRONCOS OF LACROSSE LLC	105 3RD ST S	LA CROSSE WI 54601
LAYNE LLC	108 3RD ST N	LA CROSSE WI 54601
K & N PRENTICE LLP	108 3RD ST N	LA CROSSE WI 54601-3207
WESTERN PACIFIC PARTNERS C/O ANTIQUE CENTER OF LACROSSE LTD	110 3RD ST S	LA CROSSE WI 54601
VISKER PROPERTIES LLC	111 2ND ST S	LA CROSSE WI 54601
(LE) CLARA B WIEBKE JOHN R WIEBKE	111 4TH ST N	LA CROSSE WI 54601-3262
BALDRIC LLC	112 4TH ST S	LA CROSSE WI 54601
CHUCK & CARLA CALLIES	113 2ND ST S	LA CROSSE WI 54601-3206
THOMAS & SANDRA KAPELLAS	114 4TH ST S	LA CROSSE WI 54601-3201
WOLF RENTALS LLC	115 11TH ST N	LA CROSSE WI 54601
GREAT DANE THIRD STREET PROPERTIES LLC	115 3RD ST S	LA CROSSE WI 54601
LEITHOLD PIANO CO INC	116 4TH ST S	LA CROSSE WI 54601-3201
DOERFLINGERS SECOND CENTURY INC	116 5TH AVE S APT A	LA CROSSE WI 54601-4453
MICHAEL & KAREN KEIL	116 5TH AVE S APT A	LA CROSSE WI 54601-4453
CUDAHYS GATEWAY REAL ESTATE LLC C/O MICHAEL R KEIL	116 5TH AVE S APT A	LA CROSSE WI 54601-4453
THE BATAVIAN LLC	116A 5TH AVE S	LA CROSSE WI 54601-4008
STATE & WEST LLC, 1ST & MAIN LLC, 2ND & MAIN LLC	119 19TH ST N	LA CROSSE WI 54601
DAVID J RUDRUD	120 3RD ST S	LA CROSSE WI 54601-3211
JEFFREY W HOTSON	120 4TH ST S	LA CROSSE WI 54601-3201
DALE B BERG	121 4TH ST S	LA CROSSE WI 54601-3257
TLS OF LACROSSE LLC	126 3RD ST N	LA CROSSE WI 54601
RICHARD & GREGORY MARKOS	129 3RD ST S	LA CROSSE WI 54601
PENNY L FASSLER	129 4TH ST S	LA CROSSE WI 54601
WILLIAM & JEANETTE HOWES	13004 STATE HIGHWAY 26	BROWNSVILLE MN 55919
WAKEEN FAMILY PARTNERSHIP LLP FRED THOMAS, DEBRA WAKEEN	135 4TH ST S	LA CROSSE WI 54601-3257
PEARL STREET ENTERPRISE INC	200 PEARL ST	LA CROSSE WI 54601
I & B OF LACROSSE LLC	2000 N HILLCREST PKY	ALTOONA WI 54720
REINHART REAL ESTATE GROUP INC	201 MAIN ST STE 800	LA CROSSE WI 54601
JOHN SATORY JR	201 PEARL ST	LA CROSSE WI 54601-3250
AIRAM GROUP LLC	2102 31ST ST S	LA CROSSE WI 54601
STEPHEN & KATHERINE SCHEUCH	212 MAIN ST	LA CROSSE WI 54601-3214
JRD LTD	215 3RD ST N	LA CROSSE WI 54601-3208
PEARL STREET WEST LLC C/O TJ'S	215 PEARL ST	LA CROSSE WI 54601-3250
L & D INVESTMENTS LLC	215 STATE ST STE B	LA CROSSE WI 54601-3210
DAVID & KIMBERLY PRETASKY	220 17TH ST S	LA CROSSE WI 54601
JIMMY'S INC	2206 KRAUSE RD	ONALASKA WI 54650-8939
THE AMERICAN HOUSE LLC	222 PEARL ST	LA CROSSE WI 54601
DURHMAN PROPERTIES LLC	224 CREEKVIEW DR E	FREDERICKSBURG TX 78624
DOCS HIDEOUT LLC C/O BRADLEY N FRAHM	227 8TH ST S	LA CROSSE WI 54601-4147
THOMAS A YOUNG	229 3RD ST N	LA CROSSE WI 54601-3208
WEBER HOLDINGS LLC	230 FRONT ST N	LA CROSSE WI 54601
CINDY C COCHRAN	2316 NW DIAMOND CREEK WAY	JENSEN BEACH FL 34957
KELLOGG INVESTMENTS LLC	300 4TH ST S	LA CROSSE WI 54601
100 HARBORVIEW PARTNERS LLC	301 SKY HARBOUR DR	LA CROSSE WI 54603-1385
FORTNEY FORTNEY & FORTNEY	306 PEARL ST	LA CROSSE WI 54601-3202
RONALD J KIND	3061 EDGEWATER LN	LA CROSSE WI 54603
F & F OF THIRD STREET LLC	308 3RD ST S	LA CROSSE WI 54601
SCOTT A KUNDY	316 PEARL ST	LA CROSSE WI 54601-3202
ADAM KRONER CO	319 PEARL ST	LA CROSSE WI 54601-3249
WILLIAM A STORY	327 MAIN ST	LA CROSSE WI 54601
THE CHARMANT HOTEL LLC	328 FRONT ST S	LA CROSSE WI 54601
DLL PROPERTIES LLC	3400 FLORAL LN	LA CROSSE WI 54601

ET AL, MARY JEAN KLISMITH REVOCABLE TRUST THOMAS M MOULD, SUSAN ANN MCINTYRE I SCHILLING PROPERTIES LLP	3638 RAINTREE PL	LA CROSSE WI 54601-2301
NEW STATE BANK OF LA CROSSE	401 MAIN ST	LA CROSSE WI 54601
MEDDAUGH HOLDINGS LLC	419 MAIN ST	LA CROSSE WI 54601
FIRST BANK LACROSSE BUILDING CORP C/O FIRST LACROSSE PROPERTIES	4210 OLD SHAKOPEE RD W	BLOOMINGTON MN 55437
CROSSFIRE INCORPORATED	422 MAIN ST	LA CROSSE WI 54601-4015
CARRIAGE HOUSE PROPERTIES LLC	447 COUNTRY CLUB LN	ONALASKA WI 54650
MAIN STREET RENAISSANCE INC	504 MAIN ST STE 200	LA CROSSE WI 54601
ROTTINGHAUS REAL ESTATE LLC	510 GILLETTE ST	LA CROSSE WI 54603
JAMES T CHERF	511 MAIN ST	LA CROSSE WI 54601-4022
CASINO LAX INC DANIEL J SCHMITZ	523 SANBORN ST	LA CROSSE WI 54603
313MAINSTREET LLC	600 3RD ST 200	LA CROSSE WI 54601
CHRISTINE A KAHLW	719 CASS ST	LA CROSSE WI 54601-4651
STATE ROOM PROPERTIES LLC	731 SHELLY LN	ONALASKA WI 54650
RRJ HOLDINGS LLC	731 SHELLY LN	ONALASKA WI 54650
STEPHEN D HARM	806 STARLIGHT DR	HOLMEN WI 54636
D & E SKEMP TRUST	820 CLIFFWOOD LN	LA CROSSE WI 54601-6047
JAE ENTERPRISES LLC	901 ROSE ST	LA CROSSE WI 54603
USA	FORT SNELLING	ST PAUL MN 55111-4000
4 SISTERS CATERING LLC	N3156 LOSEY CT	LA CROSSE WI 54601
RYAN PROPERTIES LLC	N6260 BERGUM COULEE RD	WEST SALEM WI 54669
A & L MCCORMICK LLC	PO BOX 135	LA CRESCENT MN 55947-0135
FORTNEY FORTNEY & FORTNEY LLP	PO BOX 1621	LA CROSSE WI 54602-1621
STEPHEN D HARM	PO BOX 2044	LA CROSSE WI 54602-2044
REINHART REAL ESTATE GROUP INC	PO BOX 2228	LA CROSSE WI 54602-2228
LACROSSE THEATRES CO	PO BOX 2702	LA CROSSE WI 54602-2702
GRAND RIVER STATION APARTMENTS LLC	PO BOX 2829	LA CROSSE WI 54602-2829
JRD LTD	PO BOX 3159	LA CROSSE WI 54602-3159
RALPHS LLC	PO BOX 32	LA CROSSE WI 54602-0032
COMMUNITY CREDIT UNION	PO BOX 39	LA CROSSE WI 54602-0039
NORTH CENTRAL TRUST COMPANY C/O TRUST POINT INC	PO BOX 489	LA CROSSE WI 54602-0489
FAMILY RADIO INC	PO BOX 99	LA CROSSE WI 54602-0099
ESPERSON PARTNERS	W3595 LARSON RD	MINDORO WI 54644-9556
RRW INVESTMENTS LTD	W5220 KNOBLOCH RD	LA CROSSE WI 54601-2461
JEAN E WIGGERT	W5851 CEDAR RD	LA CROSSE WI 54601