

- LEGEND**
- = Electric Manhole
 - = Sanitary Sewer Manhole
 - = Storm Sewer Manhole
 - = Hydrant
 - = Water Valve
 - = Gas Valve
 - = Sign
 - = Light Pole
 - = Storm Water Inlet
 - = Pedestal
 - = Right-of-way line
 - = Centerline
 - = Electric
 - = Proposed Fiber Optic Line
 - = Gas Line
 - = Communication
 - = Sanitary Sewer
 - = Storm Sewer
 - = Water Line
 - = Overhead Wires
 - = Utility Pole
 - = Guy Anchor
 - = Concrete Curb & Gutter
 - = Boulevard Tree
 - = Proposed Hand Hole

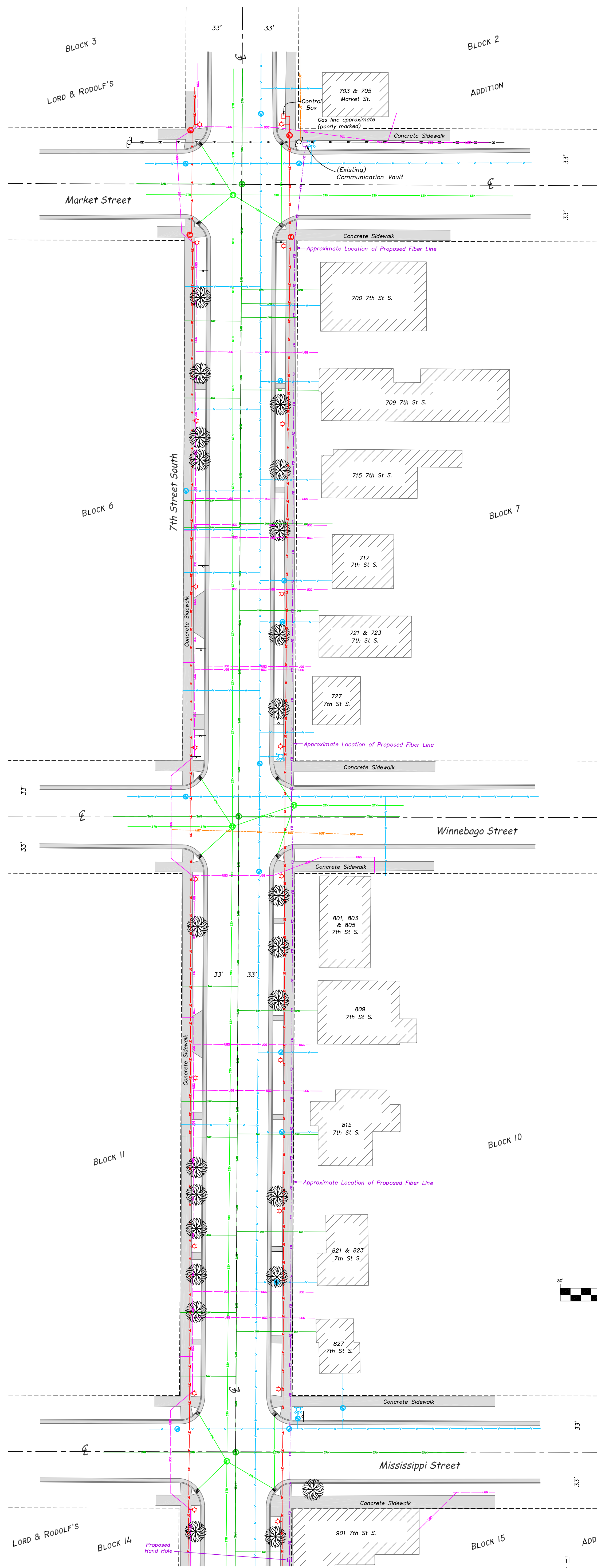

Bearing Basis: The La Crosse County Coordinate System.
 Referenced to the (MCCS) NAD 83 (2011) Adjustment.

NW-SW
 Section 5
 T15N-R7W

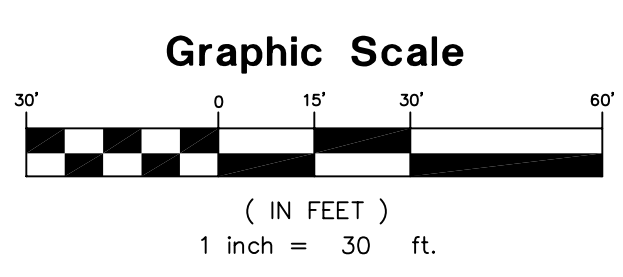

SURVEYOR'S CERTIFICATE
 I, Christopher W. Fechner, Professional Land Surveyor, hereby certify that the survey shown and represented above is accurate and true to the best of my knowledge and belief and that there are no visible encroachments other than those shown.
 Christopher W. Fechner PLS 2448

SURVEY FOR	
School District of La Crosse	
7th Street S. & Johnson Street; lying between Blocks 6, 7, 10, 11, 14 & 15, Lord & Rodolf's Add.; Blocks 2, 3 & 7, E.S. Smith's Add.; City of La Crosse, La Crosse Co., WI 1111 7th Street South	
DRAWN BY: DATE:	CF TS 10/30/2019
REVISED BY: DATE:	
SCALE:	1" = 30'
PROJECT NO.:	S-7612
FIELD CREW:	TS CF
SHEET 2 OF 2	

*Existing Conditions & Utility Survey
 for the School District of La Crosse*

CR Coulee Region
LS Land Surveyors

917 SOUTH 4TH STREET - P.O. BOX 1954
 LA CROSSE, WISCONSIN 54601
 PHONE (608) 784-1614 FAX (608) 784-1408
 www.couleeregionlandsurveyors.com