

## Lenz, Bernard

---

**From:** Greeno, Jared  
**Sent:** Monday, June 24, 2019 12:22 PM  
**To:** Lenz, Bernard  
**Subject:** FW: Sewer Lateral Connection at Memorial Pool

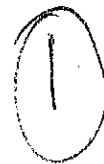

---

**From:** Greeno, Jared  
**Sent:** Thursday, April 18, 2019 11:18 AM  
**To:** Bob Haines (hainesr@cityoflacrosse.org) <hainesr@cityoflacrosse.org>  
**Cc:** Lenz, Bernard <LenzB@cityoflacrosse.org>; Asp, Steve <asps@cityoflacrosse.org>; Jason Riley - City of LaCrosse (rileyj@cityoflacrosse.org) <rileyj@cityoflacrosse.org>; Odegaard, Jason <Odegaardj@cityoflacrosse.org>  
**Subject:** Sewer Lateral Connection at Memorial Pool

Hi Bob,

Can you make sure when the new Sewer Lateral is installed for Memorial Pool that they DO NOT install an inside drop. An inside drop makes it difficult to access the manhole for maintenance. Andy with Wiinona Mechanical called me asking if they could do that and I told him no.

Thank You  
Jared Greeno  
WWTP Superintendent  
City of LaCrosse  
[greenoja@cityoflacrosse.org](mailto:greenoja@cityoflacrosse.org)  
Office 608-789-7322  
Cell 608-780-3554

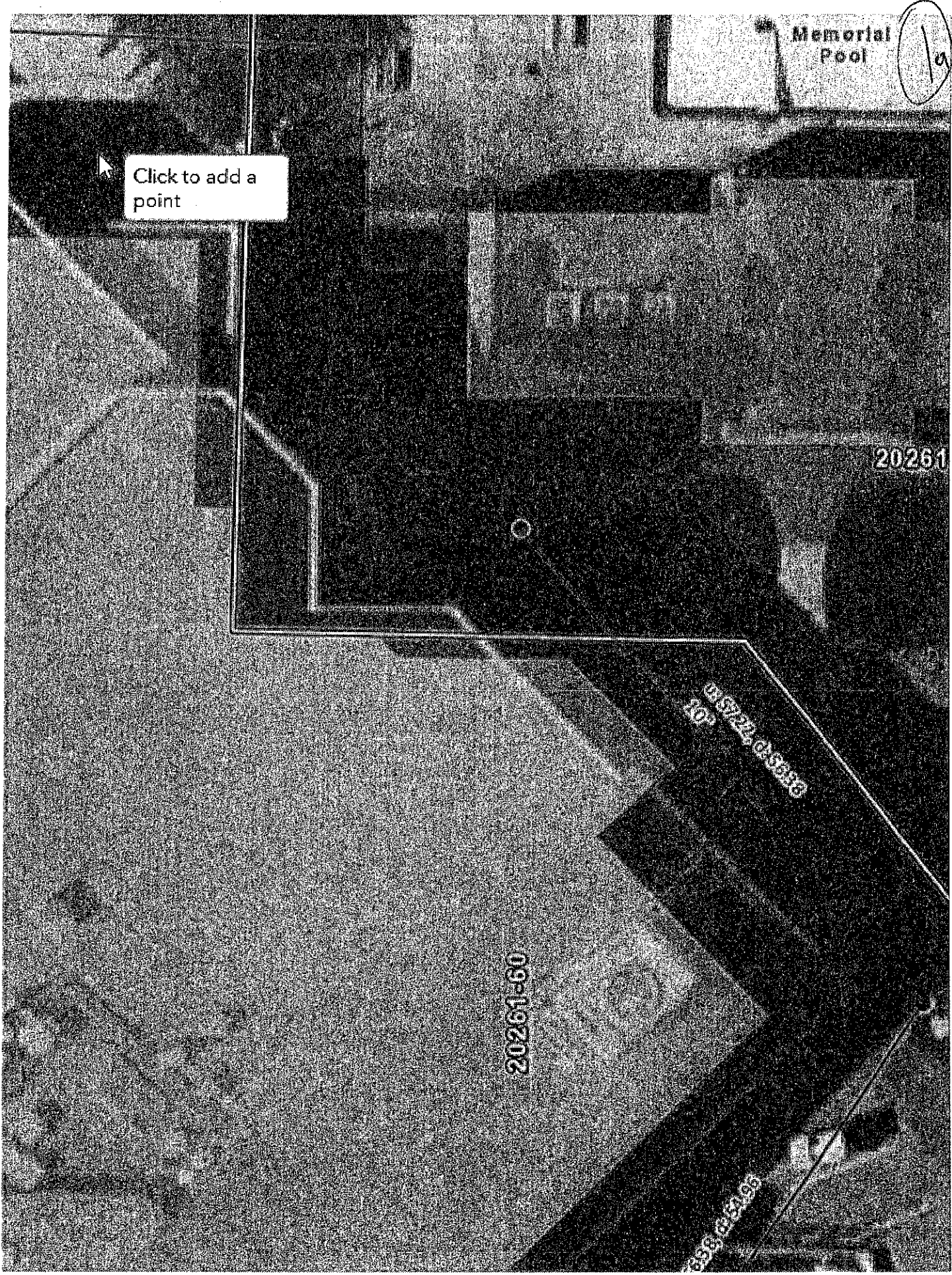

2

**Lenz, Bernard**

---

**From:** Lenz, Bernard  
**Sent:** Monday, June 24, 2019 1:20 PM  
**To:** Turtenwald, Randy; Gallager, Matthew; Trussoni, Dan; Burns, Leah  
**Cc:** Odegaard, Jason; Greeno, Jared; Lenz, Bernard  
**Subject:** FW: Sewer Lateral Connection at Memorial Pool

Per our discussions today, this went in as an inside drop after telling both the project manager and the contractor not to do that.

Please address, fix, and let me know the results.

Thanks.

Bernie

---

**From:** Greeno, Jared  
**Sent:** Monday, June 24, 2019 12:22 PM  
**To:** Lenz, Bernard <LenzB@cityoflacrosse.org>  
**Subject:** FW: Sewer Lateral Connection at Memorial Pool

---

**From:** Greeno, Jared  
**Sent:** Thursday, April 18, 2019 11:18 AM  
**To:** Bob Haines ([hainesr@cityoflacrosse.org](mailto:hainesr@cityoflacrosse.org)) <[hainesr@cityoflacrosse.org](mailto:hainesr@cityoflacrosse.org)>  
**Cc:** Lenz, Bernard <[LenzB@cityoflacrosse.org](mailto:LenzB@cityoflacrosse.org)>; Asp, Steve <[asps@cityoflacrosse.org](mailto:asps@cityoflacrosse.org)>; Jason Riley - City of LaCrosse ([rileyj@cityoflacrosse.org](mailto:rileyj@cityoflacrosse.org)) <[rileyj@cityoflacrosse.org](mailto:rileyj@cityoflacrosse.org)>; Odegaard, Jason <[Odegaardj@cityoflacrosse.org](mailto:Odegaardj@cityoflacrosse.org)>  
**Subject:** Sewer Lateral Connection at Memorial Pool

Hi Bob,

Can you make sure when the new Sewer Lateral is installed for Memorial Pool that they **DO NOT** install an inside drop. An inside drop makes it difficult to access the manhole for maintenance. Andy with Wiinona Mechanical called me asking if they could do that and I told him no.

Thank You  
Jared Greeno  
WWTP Superintendent  
City of LaCrosse  
[greenoja@cityoflacrosse.org](mailto:greenoja@cityoflacrosse.org)  
Office 608-789-7322  
Cell 608-780-3554

**Lenz, Bernard**

---

**From:** Haines, Robert  
**Sent:** Monday, June 24, 2019 1:35 PM  
**To:** Fran Modjeski (fran@winonamechanical.com); Brian Buelow (brian@wapashaconstruction.com)  
**Cc:** Tom Peplinski (tom@wapashaconstruction.com); Lenz, Bernard  
**Subject:** manhole inside drop

3

I hear that you connected to a manhole using an inside drop structure, which you were told was not allowable. If that is in fact correct then you need to remove it & make the connection at the manhole invert. On or about April 18 our sewer dept told Andy from Winona Mechanical that this was not allowed, and I know I mentioned it at one of our progress meetings when discussing the possible undermining of the UW-L light pole. We can certainly talk about it at our Wednesday meeting but the inside drop will not be allowed to remain.

**Lenz, Bernard**

---

**From:** Lenz, Bernard  
**Sent:** Friday, April 12, 2019 2:07 PM  
**To:** Riley, Jason  
**Cc:** Asp, Steve  
**Subject:** FW: Dead end MH on Winnabago st that they want to connect to  
**Attachments:** Stubbed Attachments.htm

(4)

This message's contents have been archived by the Barracuda Message Archiver.  
20190412 15:28:50: resized.jpg (863.8K)

Steve/Jason,

I told Will Hilton if 612 Winnebago wants to tie into the manhole we'd want him to core it at the invert and tie straight into that invert with a small section of straight pipe-then tie the lateral to that small section of pipe. We will not allow an inside drop. The manhole is brick and only 9.7ft deep. (see picture from Steve)

Will is talking about doing a pothole at the manhole and a pothole in the blvd and having Steiger directional boring the lateral. They would place the straight stub and tie into the straight stub all inside that trench box pothole. That's fine with the Utility.

Bernie

PS - The alternate is to put in a full sewer main in Winnebago and assess him, or get a private easement from 801 6<sup>th</sup> street and put in a new lateral thru 801 that is just for 612 Winnebago alone. He doesn't like either.