

New:

License Fee: \$150<sup>00</sup>

Renewal:

Invoice No. 147939

CITY OF LA CROSSE  
APPLICATION FOR BEER GARDEN LICENSE

Class "A"  Class "B"  Class "C"  Class "D"  
(ZONING RESTRICTION)

To the Common Council of the City of La Crosse:

Legal/Real Name: KLEHM LLC

Address of above: 317 4<sup>TH</sup> ST S STE 302 LA CROSSE 54601

Trade name of business: STRASSERS (CLASS OF 68)

Address of premises to be licenses: 1310 DENTON ST

Description of proposed beer garden: (MUST BE SPECIFIC: square feet, physical location, material made out of, etc.) 610 SQ FT USING THE 6.5 FT WALKWAY BETWEEN 1310 & 1306 DENTON ST TO 11 FT BEYOND BACKSIDE OF 1310 DENTON, TRIMAX VINYL POLY FENCING WITH TWO GATES

Name of manager (FIRST, MIDDLE & LAST:): KORLAN ANDREW BESSINGER

Home address: S3502B ASBURY RD VIROQUA, WI 54605

Home phone number: 608-792-7806

Daytime phone number: 608-792-7806

Date of Birth: [REDACTED]

License Period: July 1<sup>st</sup>, 2017 to June 30<sup>th</sup>, 2018

The above hereby makes application for a license to operate a Beer Garden at the above address within the City of La Crosse pursuant to provisions of Sec. 10-47 of the Code of Ordinances for the City of La Crosse.

[Signature]  
(Signature of Applicant)

4.26.2017  
(Date)

\*\*\*\*A PLAN MUST ACCOMPANY THIS APPLICATION\*\*\*\*

CUST:186649

**OFFICE USE ONLY:**

For original applications: Attach a list of all property owners within 200 feet of the proposed licensed premises.

Signature and date: \_\_\_\_\_

Granted: \_\_\_\_\_ License #: \_\_\_\_\_

**Base Bid: 6' High Polyvinyl Fence System/ Trimax / Flat Caps / White**

**Note: Not located on any property lines. Owns both properties.**

S  
E W  
N

<b>Total Lineal</b> 63'	<b>Lot Dimensions</b> Depth: Width:
----------------------------	---

- \* Haul dirt.
- \* Stainless steel gate hardware, gate stop & handles.
- \* Gate & gate posts receive aluminum reinforcements.
- \* Some posts to be concreted with ready mix concrete/ 3' deep. Some mounted to concrete slab.
- \* Install 2-4" off ground.

- (7) 8' Sections
- (1) Set of slide channel
- (5) LP's
- (6) EP's
- (1) CP's
- (1) Blank
- (13) Caps
- (1) Gate

**Drawing is not to scale.**

**Drawing is property of Phillips Fencing, INC. and is to be used exclusively by them. Use other than by PFI is prohibited by law.**

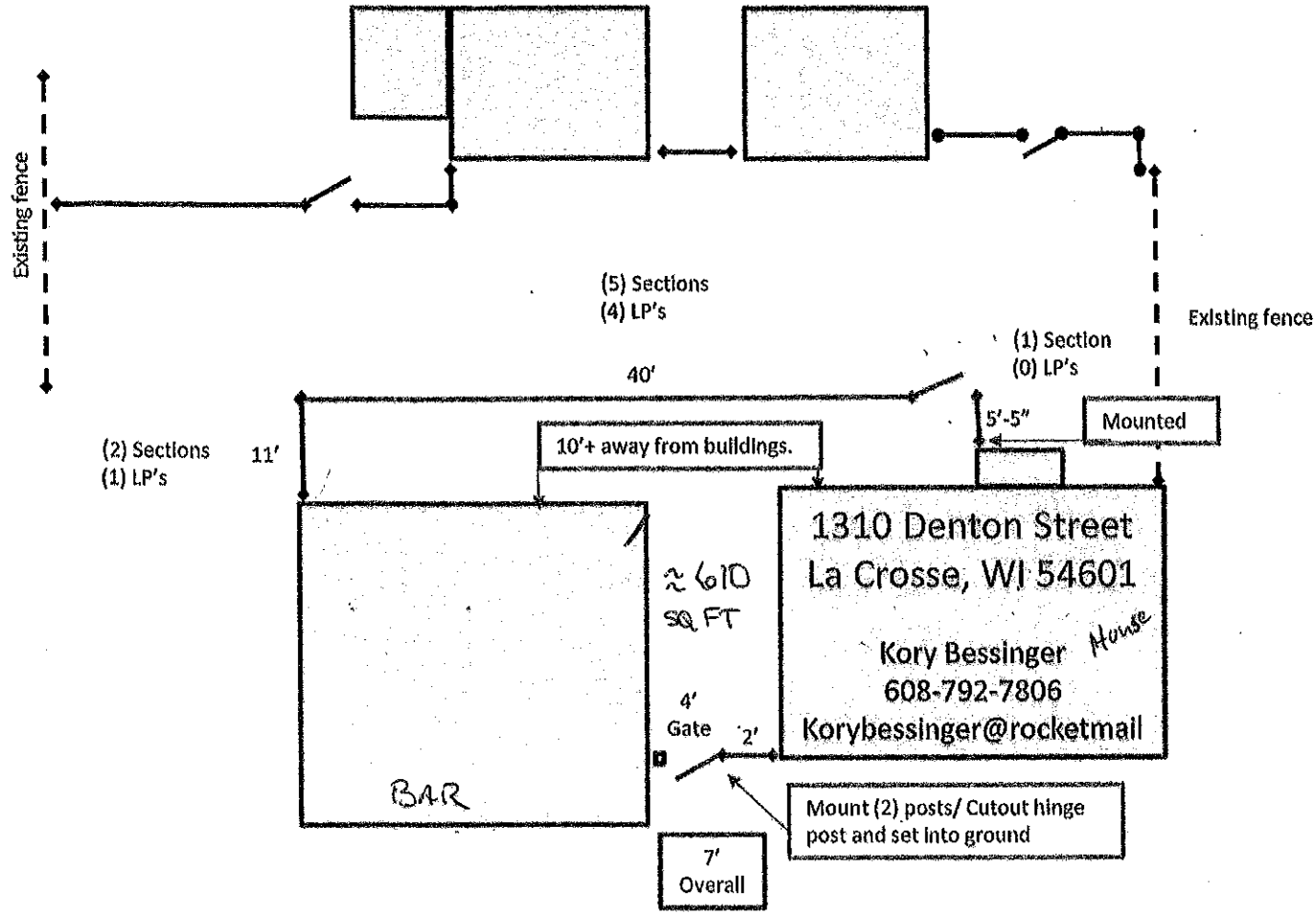

**Directions:**

Across from Red Balloon Daycare  
Denton Street-La Crosse  
11/18/2016

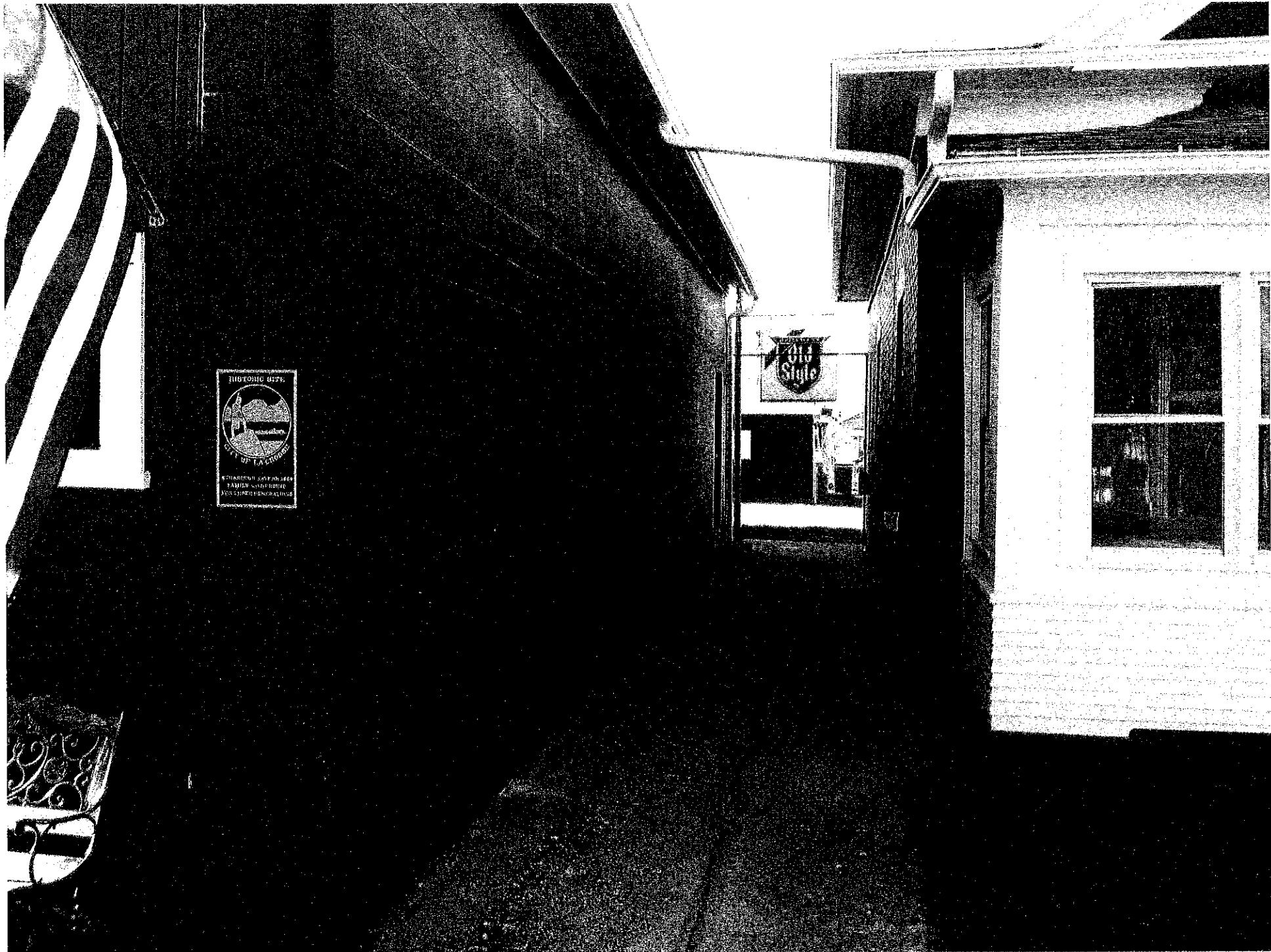

HISTORIC 1878  
CITY OF LA HABRA  
ESTABLISHED 1878  
LA HABRA, CALIFORNIA  
1125 SOUTH BROADWAY

Old Style



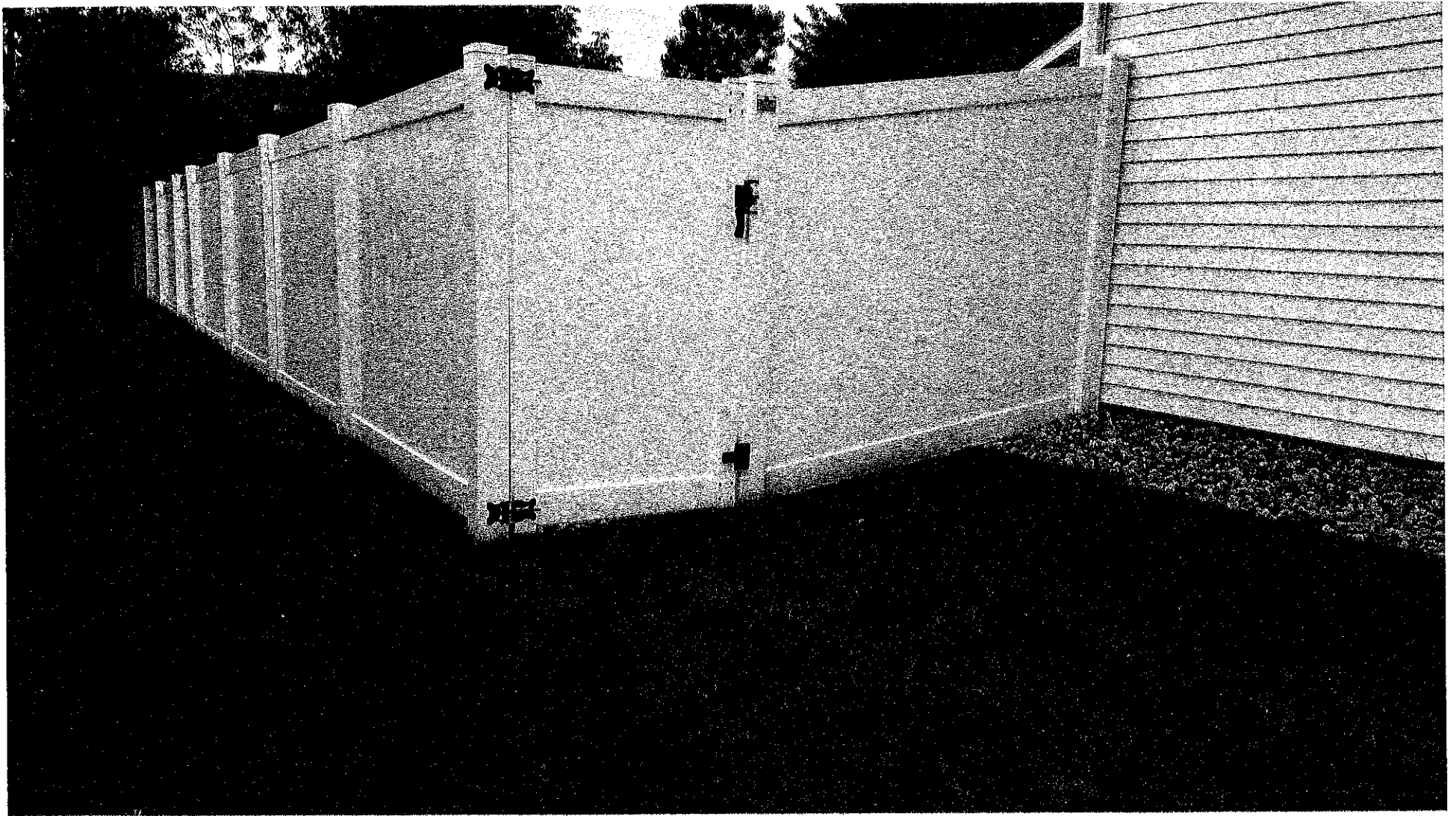

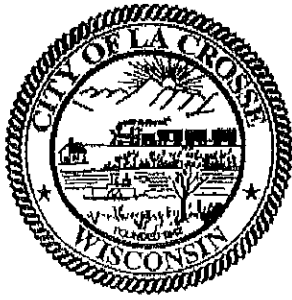

**TERI LEHRKE, WCPC, City Clerk**

**400 LA CROSSE STREET  
LA CROSSE, WISCONSIN 54601  
PHONE (608) 789-7510  
FAX (608) 789-7552  
[www.cityoflacrosse.org](http://www.cityoflacrosse.org)**

**NOTICE OF APPLICATION FOR BEER GARDEN LICENSE  
IN THE CITY OF LA CROSSE**

To Whom It May Concern:

This is to notify you that the following business has applied for a **Class "A" Beer Garden** license under Sec. 10-77(b) of the Code of Ordinances of the City of La Crosse to allow consumption of alcoholic beverages in a designated outdoor area.

**Klehm LLC d/b/a Strassers  
at 1310 Denton St., La Crosse, WI 54601**

This application will be considered at the following meetings:

**Judiciary and Administration Committee – Tuesday, May 30<sup>th</sup>, 2017 at 7:30 p.m.  
Common Council Meeting – Thursday, June 8<sup>th</sup>, 2017 at 7:30 p.m.**

All the above meetings are held in the Council Chambers in the City Hall at 400 La Crosse Street, La Crosse, WI.

You are further notified that any person affected may be heard, and may appear in person or by attorney, or may file a letter of objection in the office of the City Clerk.

This notice is given pursuant to the order of the Common Council of the City of La Crosse.

Dated this May 12<sup>th</sup> day of August, 2017.

Teri Lehrke, WCPC, City Clerk  
City of La Crosse

Jay A. Christianson  
Assistant Clerk



Klehm LLC d/b/a Strassers  
 200' Buffer for Class "A" Beer Garden  
 June 8<sup>th</sup>, 2017 Council Meeting

OwnerName	MailingLine4	MailingLine5	Property Address
ALLYN O, FERN E ISENMANN KNAAK REVOCABLE TRUST	1245 REDFIELD ST	LA CROSSE WI 54601	1245 REDFIELD ST
CASEY M BRUEGGEN	1240 DENTON ST	LA CROSSE WI 54601-5659	1240 DENTON ST
CHIA LEE	1327 REDFIELD ST	LA CROSSE WI 54601-5637	1327 REDFIELD ST
DENTON & 13 LLC	317 4TH ST S STE 302	LA CROSSE WI 54601	1306 DENTON ST
DENTON & 13 LLC	317 4TH ST S STE 302	LA CROSSE WI 54601	1310 DENTON ST
DOUGLAS BUCHNER	2704 7TH ST S	LA CROSSE WI 54601	1307 REDFIELD ST
EDWARD C FLOOD	1424 13TH ST S	LA CROSSE WI 54601-5620	1424 13TH ST S
GREGORY J MCCABE	2915 WARD AVE	LA CROSSE WI 54601-7468	1247 REDFIELD ST
GREGORY J MCCABE	2915 WARD AVE	LA CROSSE WI 54601-7468	1249 REDFIELD ST
GREGORY J MCCABE	2915 WARD AVE	LA CROSSE WI 54601-7468	1522 13TH ST S
HOLY TRINITY PARISH	1417 13TH ST S	LA CROSSE WI 54601	1417 13TH ST S
INEZ M LARSON TRUST	1333 REDFIELD ST	LA CROSSE WI 54601-5637	1333 REDFIELD ST
INEZ M LARSON TRUST	1333 REDFIELD ST	LA CROSSE WI 54601-5637	1520 14TH ST S
JAMES D SCHAMS	2726 7TH ST S	LA CROSSE WI 54601	1300 DENTON ST
JEROME J KWOSEK	1516 14TH ST S	LA CROSSE WI 54601-5622	1516 14TH ST S
MARY J CLEMENTS	1326 DENTON ST	LA CROSSE WI 54601-5660	1326 DENTON ST
MATTHEW P, KELLY M DIEHL	1244 DENTON ST	LA CROSSE WI 54601-5659	1244 DENTON ST
MICHAEL C, JENNIFER J NAGY	1318 DENTON ST	LA CROSSE WI 54601-5660	1318 DENTON ST
RANDALL K PAGE	1242 PARK AVE	LA CROSSE WI 54601-5627	1410 13TH ST S
RANDALL K PAGE	1242 PARK AVE	LA CROSSE WI 54601-5627	1245 DENTON ST
RANDALL K PAGE	1242 PARK AVE	LA CROSSE WI 54601-5627	1247 DENTON ST
REDFIELD BRICKS LLC	317 4TH ST S STE 302	LA CROSSE WI 54601	1314 DENTON ST
SERENA M BURKE	1416 13TH ST S	LA CROSSE WI 54601-5620	1416 13TH ST S
STEVEN T EIDE	2520 LOSEY CT	LA CROSSE WI 54601-3938	1515 13TH ST S
STEVEN T EIDE	2520 LOSEY CT	LA CROSSE WI 54601-3938	1313 REDFIELD ST
STEVEN T EIDE	2520 LOSEY CT	LA CROSSE WI 54601-3938	1315 REDFIELD ST
STEVEN T EIDE	2520 LOSEY CT	LA CROSSE WI 54601-3938	1317 REDFIELD ST
SUSAN L GUTTMANN	1510 14TH ST S	LA CROSSE WI 54601	1510 14TH ST S
TREVOR R DUPEY	1228 WEST AVE S	LA CROSSE WI 54601-5534	1330 DENTON ST
TREVOR R DUPEY	1228 WEST AVE S	LA CROSSE WI 54601-5534	1332 DENTON ST
VINCENT, LUVINE HUDSON	2323 PROSPECT ST	LA CROSSE WI 54603-1955	1309 REDFIELD ST

ORIGINAL



OwnerName	MailingLine4	MailingLine5
ALLYN & FERN ISENMANN KNAAK REVOCABLE TRUST	1245 REDFIELD ST	LA CROSSE WI 54601
CASEY M BRUEGGEN	1240 DENTON ST	LA CROSSE WI 54601-5659
CHIA LEE	1327 REDFIELD ST	LA CROSSE WI 54601-5637
DENTON & 13 LLC	317 4TH ST S STE 302	LA CROSSE WI 54601
DOUGLAS BUCHNER	2704 7TH ST S	LA CROSSE WI 54601
EDWARD C FLOOD	1424 13TH ST S	LA CROSSE WI 54601-5620
GREGORY J MCCABE	2915 WARD AVE	LA CROSSE WI 54601-7468
HOLY TRINITY PARISH	1417 13TH ST S	LA CROSSE WI 54601
INEZ M LARSON TRUST	1333 REDFIELD ST	LA CROSSE WI 54601-5637
JAMES D SCHAMS	2726 7TH ST S	LA CROSSE WI 54601
JEROME J KWOSEK	1516 14TH ST S	LA CROSSE WI 54601-5622
MARY J CLEMENTS	1326 DENTON ST	LA CROSSE WI 54601-5660
MATTHEW & KELLY DIEHL	1244 DENTON ST	LA CROSSE WI 54601-5659
MICHAEL & JENNIFER NAGY	1318 DENTON ST	LA CROSSE WI 54601-5660
RANDY PAGE	1242 PARK AVE	LA CROSSE WI 54601-5627
REDFIELD BRICKS LLC	317 4TH ST S STE 302	LA CROSSE WI 54601
SERENA M BURKE	1416 13TH ST S	LA CROSSE WI 54601-5620
STEVEN T EIDE	2520 LOSEY CT	LA CROSSE WI 54601-3938
SUSAN L GUTTMANN	1510 14TH ST S	LA CROSSE WI 54601
TREVOR R DUPEY	1228 WEST AVE S	LA CROSSE WI 54601-5534
VINCENT & LUVINE HUDSON	2323 PROSPECT ST	LA CROSSE WI 54603-1955

MAILING