

Original
 *50% approval from neighboring property owners
 J&A and Council Approval

License Fee: \$5⁰⁰

Invoice No.: 155373

Renewal
 J&A Approval

**APPLICATION TO OWN, KEEP AND/OR HONEYBEES
 IN THE CITY OF LA CROSSE**

License Period: January 1, 2018 to December 31, 2022 (fifth year of the licensure period)

APPLICANT:

Mathias Harter

PROPERTY ADDRESS WHERE HONEYBEES WILL BE KEPT:

1338 Caledonia Street

PROPERTY OWNER(S):

Mathias Harter

*If applicant is not the owner, please provide written documentation from the owner that they have been notified.
 Not applicable for renewal.*

Is the property ONE-FAMILY dwelling or TWO-FAMILY dwelling? (Check One)

*If two-family, provide written documentation from other occupant that they have been notified.
 Not applicable for renewal.*

**Attach a scale drawing showing property lot lines, location of apiary and distance from any
 primary buildings on abutting lots and distance from any public sidewalk(s).**

**If colony is kept less than twenty-five (25) feet from a property line of the lot upon which the apiary
 is located, and any entrance to the hive faces that lot line; include location, height and description
 of flyway barrier required pursuant to Sec. 6-18(c)(1).**

**Applying for and obtaining a beekeeping license DOES NOT provide any authority to violate any
 restrictive covenants that govern the property where you reside or intend to keep honeybees. Please
 review any Declaration of Restrictions or Restrictive Covenants that apply to the property prior to applying
 for a beekeeping license. No permit fees will be refunded once they are paid.**

**The above applicant(s) hereby makes application for a license to own, harbor and/or keep
 honeybees at the above property address within the City of La Crosse pursuant to provisions of
 Section 6-18 of the Code of Ordinances for the City of La Crosse.**

Mathias Harter
(signature)

(signature)

608-304-0845
(telephone)

3-12-18
(date)

30 30 30 30

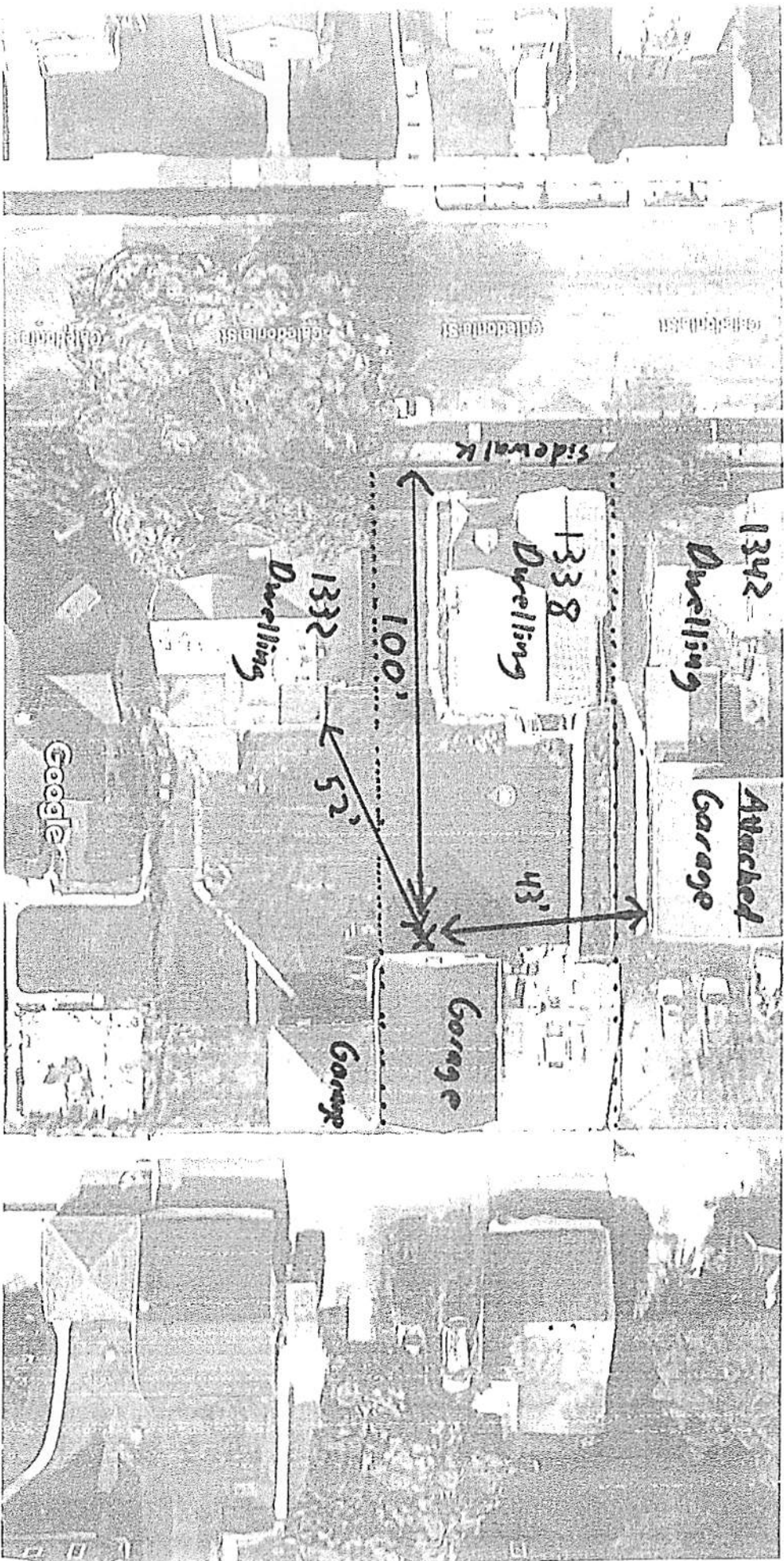

Imagery ©2018 Google, Map data ©2018 Google 20 ft

X = Hive

..... = Lot Line

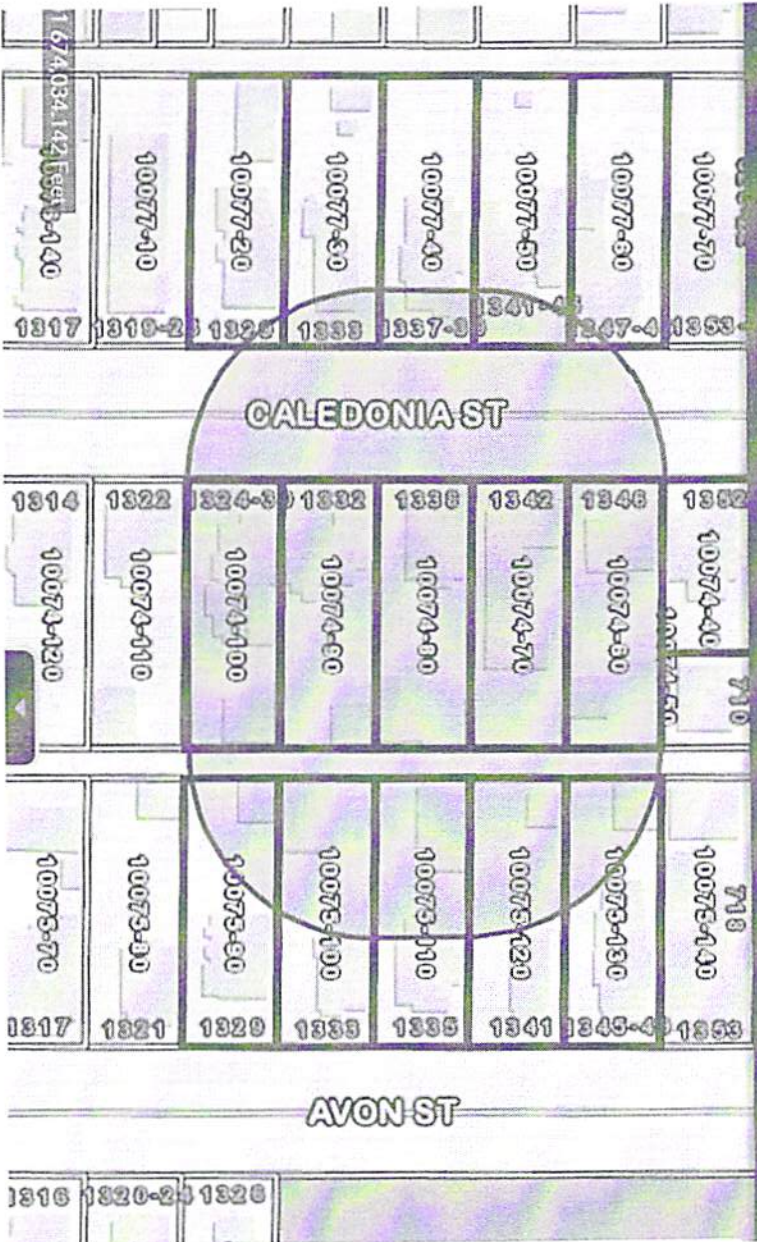

	Tax Parcel Number	Mailing Address	Mailing Address?	Owner Name	Property Address
owner occupied	17-10074-40	1352 CALEDONIA ST	LA CROSSE WI 54603-2414	NORMA B, MICHAEL S WISTE	1352 CALEDONIA ST
rental	17-10077-60	2520 LOSEY CT	LA CROSSE WI 54601-3938	STEVEN T EIDE	1347-1349 CALEDONIA ST
owner occupied	17-10074-60	1346 CALEDONIA ST	LA CROSSE WI 54603-2414	RICHARD HENTHORN	1346 CALEDONIA ST
rental	17-10075-130	702 11TH ST S	LA CRESCENT MN 55947	WITHROW PROPERTIES LLC	1345-1347-1349 AVON ST
rental	17-10077-50	310 IRENE PL	HOLMEN WI 54636-9773	MICHAEL P MOEN	1341-1343-1345 CALEDONIA ST
owner occupied	17-10074-70	614 OAK CT	LA CROSSE WI 54603	GARY F HARTER	1342 CALEDONIA ST
owner occupied	17-10075-120	1341 AVON ST	LA CROSSE WI 54603-2413	MARY C DEVNEY	1341 AVON ST
rental	17-10077-40	310 IRENE PL	HOLMEN WI 54636	NICOLE LUNDE	1337-1339 CALEDONIA ST
APPLICANT	17-10074-80	1338 CALEDONIA ST	LA CROSSE WI 54603-2414	MATHIAS W HARTER	1338 CALEDONIA ST
owner occupied	17-10075-110	1335 AVON ST	LA CROSSE WI 54603-2413	DER XIONG CHUE PETER THAO	1335 AVON ST
owner occupied	17-10077-30	1333 CALEDONIA ST	LA CROSSE WI 54603-2412	TROY D HESSE	1333 CALEDONIA ST
rental	17-10074-90	1338 CALEDONIA ST	LA CROSSE WI 54603-2414	MATHIAS W HARTER	1332 CALEDONIA ST
owner occupied	17-10075-100	1333 AVON ST	LA CROSSE WI 54603-2413	PATRICK C PREW	1333 AVON ST
rental	17-10077-20	2023 MILLER ST	LA CROSSE WI 54601	KRISTINA VIRNIG ROGER CURTIS	1329 CALEDONIA ST
rental	17-10074-100	W5331 NORSEMAN DR	LA CROSSE WI 54601	A TOUCH OF TILE LLC	1324-1326-1328-1330 CALEDONIA ST
owner occupied	17-10075-90	1329 AVON ST	LA CROSSE WI 54603	ROGER A LATSHAW	1329 AVON ST

7 Owner Occupied Properties
Need min of 4 to sign giving approval

**NOTICE OF HEARING ON
APPLICATION TO OWN, KEEP AND/OR HARBOR HONEYBEES**

TO WHOM IT MAY CONCERN:

Notice is hereby given that the Common Council of the City of La Crosse, by its Judiciary & Administration Committee, will consider the application of **Mathias Harter** for a license pursuant to Sec. 6-18 of the La Crosse Municipal Code to **own, keep and/or harbor honeybees at 1338 Caledonia St., La Crosse, WI for the license period April 13th, 2018 to December 31st, 2022.**

Said meeting will be held at 6:00 p.m. on **Tuesday, April 3rd, 2018**, in the Council Chambers in City Hall in the City of La Crosse, La Crosse County, Wisconsin.

Final action will be determined by the Common Council on **Thursday, April 12th, 2018** at 6:00 p.m. also in the Council Chamber of City Hall.

You are further notified that any person affected may be heard, and may appear in person or by attorney, or may file a letter of objection in the office of the City Clerk.

This notice is given pursuant to the order of the Common Council of the City of La Crosse.

Dated this 26th day of March, 2018.



Teri Lehrke, City Clerk
City of La Crosse, Wisconsin

OBJECTID	Tax Parcel Number	OwnerName	MailingLine4	MailingLine5	Property Address
3623	17-10074-40	NORMA & MICHAEL WISTE	1352 CALEDONIA ST	LA CROSSE WI 54603-2414	1352 CALEDONIA ST
3647	17-10077-60	STEVEN T EIDE	2520 LOSEY CT	LA CROSSE WI 54601-3938	1347 CALEDONIA ST
3648	17-10077-60	STEVEN T EIDE	2520 LOSEY CT	LA CROSSE WI 54601-3938	1349 CALEDONIA ST
3650	17-10074-60	RICHARD HENTHORN	1346 CALEDONIA ST	LA CROSSE WI 54603-2414	1346 CALEDONIA ST
3651	17-10075-130	WITHROW PROPERTIES LLC	702 11TH ST S	LA CRESCENT MN 55947	1345 AVON ST
3652	17-10075-130	WITHROW PROPERTIES LLC	702 11TH ST S	LA CRESCENT MN 55947	1347 AVON ST
3653	17-10075-130	WITHROW PROPERTIES LLC	702 11TH ST S	LA CRESCENT MN 55947	1349 AVON ST
3667	17-10077-50	MICHAEL P MOEN	310 IRENE PL	HOLMEN WI 54636-9773	1341 CALEDONIA ST
3668	17-10077-50	MICHAEL P MOEN	310 IRENE PL	HOLMEN WI 54636-9773	1343 CALEDONIA ST
3669	17-10077-50	MICHAEL P MOEN	310 IRENE PL	HOLMEN WI 54636-9773	1345 CALEDONIA ST
3670	17-10074-70	GARY F HARTER	614 OAK CT	LA CROSSE WI 54603	1342 CALEDONIA ST
3671	17-10075-120	MARY C DEVNEY	1341 AVON ST	LA CROSSE WI 54603-2413	1341 AVON ST
3687	17-10077-40	NICOLE LUNDE	310 IRENE PL	HOLMEN WI 54636	1337 CALEDONIA ST
3688	17-10077-40	NICOLE LUNDE	310 IRENE PL	HOLMEN WI 54636	1339 CALEDONIA ST
3689	17-10074-80	MATHIAS W HARTER	1338 CALEDONIA ST	LA CROSSE WI 54603-2414	1338 CALEDONIA ST
3690	17-10075-110	DER XIONG CHUE PETER THAO	1335 AVON ST	LA CROSSE WI 54603-2413	1335 AVON ST
3705	17-10077-30	TROY D HESSE	1333 CALEDONIA ST	LA CROSSE WI 54603-2412	1333 CALEDONIA ST
3706	17-10074-90	MATHIAS W HARTER	1338 CALEDONIA ST	LA CROSSE WI 54603-2414	1332 CALEDONIA ST
3707	17-10075-100	PATRICK C PREW	1333 AVON ST	LA CROSSE WI 54603-2413	1333 AVON ST
3718	17-10077-20	KRISTINA VIRNIG ROGER CURTIS	2023 MILLER ST	LA CROSSE WI 54601	1329 CALEDONIA ST
3719	17-10074-100	A TOUCH OF TILE LLC	W5331 NORSEMAN DR	LA CROSSE WI 54601	1324 CALEDONIA ST
3720	17-10074-100	A TOUCH OF TILE LLC	W5331 NORSEMAN DR	LA CROSSE WI 54601	1326 CALEDONIA ST
3721	17-10074-100	A TOUCH OF TILE LLC	W5331 NORSEMAN DR	LA CROSSE WI 54601	1328 CALEDONIA ST
3722	17-10074-100	A TOUCH OF TILE LLC	W5331 NORSEMAN DR	LA CROSSE WI 54601	1330 CALEDONIA ST
3723	17-10075-90	ROGER A LATSHAW	1329 AVON ST	LA CROSSE WI 54603	1329 AVON ST

ORIGINAL

OwnerName	MailingLine4	MailingLine5
A TOUCH OF TILE LLC	W5331 NORSEMAN DR	LA CROSSE WI 54601
DER XIONG CHUE PETER THAO	1335 AVON ST	LA CROSSE WI 54603-2413
GARY F HARTER	614 OAK CT	LA CROSSE WI 54603
KRISTINA VIRNIG ROGER CURTIS	2023 MILLER ST	LA CROSSE WI 54601
MARY C DEVNEY	1341 AVON ST	LA CROSSE WI 54603-2413
MATHIAS W HARTER	1338 CALEDONIA ST	LA CROSSE WI 54603-2414
MICHAEL P MOEN	310 IRENE PL	HOLMEN WI 54636-9773
NICOLE LUNDE	310 IRENE PL	HOLMEN WI 54636
NORMA & MICHAEL WISTE	1352 CALEDONIA ST	LA CROSSE WI 54603-2414
PATRICK C PREW	1333 AVON ST	LA CROSSE WI 54603-2413
RICHARD HENTHORN	1346 CALEDONIA ST	LA CROSSE WI 54603-2414
ROGER A LATSHAW	1329 AVON ST	LA CROSSE WI 54603
STEVEN T EIDE	2520 LOSEY CT	LA CROSSE WI 54601-3938
TROY D HESSE	1333 CALEDONIA ST	LA CROSSE WI 54603-2412
WITHROW PROPERTIES LLC	702 11TH ST S	LA CRESCENT MN 55947

MAILING