

Inv # 200148 Cust # 197911

Original Alcohol Beverage Retail License Application

(Submit to municipal clerk.)

For the license period beginning: 10/11/2019 ending: 06/30/2020
(mm dd yyyy) (mm dd yyyy)

To the Governing Body of the: Town of } La Crosse, Wisconsin
 Village of }
 City of }

County of La Crosse County Aldermanic Dist. No. _____
 (if required by ordinance)

Check one: Individual Limited Liability Company
 Partnership Corporation/Nonprofit Organization

Applicant's Wisconsin Seller's Permit Number	
FEIN Number	
TYPE OF LICENSE REQUESTED	FEE
<input type="checkbox"/> Class A beer	\$
<input checked="" type="checkbox"/> Class B beer	\$ <u>75.06</u>
<input type="checkbox"/> Class C wine	\$
<input type="checkbox"/> Class A liquor	\$
<input type="checkbox"/> Class A liquor (cider only)	\$ N/A
<input checked="" type="checkbox"/> Class B liquor	\$ <u>375.03</u>
<input type="checkbox"/> Reserve Class B liquor	\$
<input type="checkbox"/> Class B (wine only) winery	\$
Publication fee	\$ <u>20.00</u>
TOTAL FEE	\$ <u>470.09</u>

Name (individual / partners give last name, first, middle; corporations / limited liability companies give registered name)
Redtail Enterprises, Inc (220 Carlson Pkwy, Plymouth MN 55447)

An "Auxiliary Questionnaire," Form AT-103, must be completed and attached to this application by each individual applicant, by each member of a partnership, and by each officer, director and agent of a corporation or nonprofit organization, and by each member/manager and agent of a limited liability company. List the full name and place of residence of each person.

President / Member Last Name	(First)	(Middle Name)	Home Address (Street, City or Post Office, & Zip Code)
<u>Letnes</u>	<u>Curtis</u>	<u>Jens</u>	<u>12808 Frost Point Way, Apple Valley, MN 55124</u>
Vice President / Member Last Name	(First)	(Middle Name)	Home Address (Street, City or Post Office, & Zip Code)
<u>Letnes</u>	<u>Kent</u>	<u>Robert</u>	<u>3508 Ivy Place, Wayzata, MN 55391</u>
Secretary / Member Last Name	(First)	(Middle Name)	Home Address (Street, City or Post Office, & Zip Code)
<u>Letnes</u>	<u>Matthew</u>	<u>Curtis</u>	<u>5029 Nob Hill Drive, Edina MN 55439</u>
Treasurer / Member Last Name	(First)	(Middle Name)	Home Address (Street, City or Post Office, & Zip Code)
<u>Letnes</u>	<u>Kevin</u>	<u>John</u>	<u>6828 Minnehaha Ct., Minnetrista, MN 55331</u>
Agent Last Name	(First)	(Middle Name)	Home Address (Street, City or Post Office, & Zip Code)
<u>Wigdahl</u>	<u>Randall</u>	<u>Knute</u>	<u>N 7015 County Rd W, Holmen WI 54636</u>
Directors / Managers Last Name	(First)	(Middle Name)	Home Address (Street, City or Post Office, & Zip Code)

1. Trade Name Milwaukee Burger Company Business Phone Number 608-781-6630
 2. Address of Premises 3039 Medco Ct. Post Office & Zip Code La Crosse, WI 54601

3. Premises description: Describe building or buildings where alcohol beverages are to be sold and stored. The applicant must include all rooms including living quarters, if used, for the sales, service, consumption, and/or storage of alcohol beverages and records. (Alcohol beverages may be sold and stored only on the premises described.)
→ Beer garden
Dining Room, Bar, Patio, Liquor Closet, Cooler, Office

4. Legal description (omit if street address is given above): _____
 5. (a) Was this premises licensed for the sale of liquor or beer during the past license year? Yes No
 (b) If yes, under what name was license issued? York Factory Enterprises, Inc

dba Grizzly's Wood Fired Grill

6. Is individual, partners or agent of corporation/limited liability company subject to completion of the responsible beverage server training course for this license period? If yes, explain Yes No

7. Is the applicant an employe or agent of, or acting on behalf of anyone except the named applicant? Yes No
 If yes, explain.

8. Does any other alcohol beverage retail licensee or wholesale permittee have any interest in or control of this business? If yes, explain Yes No

9. (a) Corporate/limited liability company applicants only: Insert state _____ and date _____ of registration.

(b) Is applicant corporation/limited liability company a subsidiary of any other corporation or limited liability company? If yes, explain Yes No

(c) Does the corporation, or any officer, director, stockholder or agent or limited liability company, or any member/manager or agent hold any interest in any other alcohol beverage license or permit in Wisconsin? Yes No
 If yes, explain.

Redtail Enterprises holds liquor licenses in Eau Claire, WI, Hudson, WI
and Pleasant Prairie, WI

10. Does the applicant understand they must register as a Retail Beverage Alcohol Dealer with the federal government, Alcohol and Tobacco Tax and Trade Bureau (TTB) by filing (TTB form 5630.5d) before beginning business? [phone 1-877-882-3277] Yes No

11. Does the applicant understand they must hold a Wisconsin Seller's Permit? [phone (608) 266-2776] Yes No

12. Does the applicant understand that they must purchase alcohol beverages only from Wisconsin wholesalers, breweries and brewpubs? Yes No

READ CAREFULLY BEFORE SIGNING: Under penalty provided by law, the applicant states that each of the above questions has been truthfully answered to the best of the knowledge of the signer. Any person who knowingly provides materially false information on this application may be required to forfeit not more than \$1,000. Signer agrees to operate this business according to law and that the rights and responsibilities conferred by the license(s), if granted, will not be assigned to another. (Individual applicants, or one member of a partnership applicant must sign; one corporate officer, one member/manager of Limited Liability Companies must sign.) Any lack of access to any portion of a licensed premises during inspection will be deemed a refusal to permit inspection. Such refusal is a misdemeanor and grounds for revocation of this license.

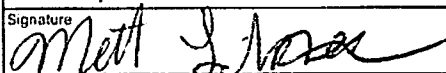
Contact Person's Name (Last, First, M I.) Letnes, Matt C	Title/Member Partner	Date 08/27/19
Signature 	Phone Number 651-210-8175	Email Address matt@lhgrestartaurants.com

TO BE COMPLETED BY CLERK

Date received and filed with municipal clerk	Date reported to council / board	Date provisional license issued	Signature of Clerk / Deputy Clerk
Date license granted	Date license issued	License number issued	

Schedule for Appointment of Agent by Corporation / Nonprofit Organization or Limited Liability Company

Submit to municipal clerk.

All corporations/organizations or limited liability companies applying for a license to sell fermented malt beverages and/or intoxicating liquor must appoint an agent. The following questions must be answered by the agent. The appointment must be signed by an officer of the corporation/organization or one member/manager of a limited liability company and the recommendation made by the proper local official.

To the governing body of: Town
 Village of LACROSSE County of LA CROSSE
 City

The undersigned duly authorized officer/member/manager of RETAIL ENTERPRISES, INC
(Registered Name of Corporation / Organization or Limited Liability Company)

a corporation/organization or limited liability company making application for an alcohol beverage license for a premises known as MILWAUKEE BURGER Co
(Trade Name)

located at 3039 MEDCO COURT LACROSSE, WI 54601

appoints RANDALL KNUTE WIGDAL
(Name of Appointed Agent)

N 7015 City Rd W HOLMEN, WI 54636
(Home Address of Appointed Agent)

to act for the corporation/organization/limited liability company with full authority and control of the premises and of all business relative to alcohol beverages conducted therein. Is applicant agent presently acting in that capacity or requesting approval for any corporation/organization/limited liability company having or applying for a beer and/or liquor license for any other location in Wisconsin?

Yes No If so, indicate the corporate name(s)/limited liability company(ies) and municipality(ies).

Is applicant agent subject to completion of the responsible beverage server training course? Yes No
How long immediately prior to making this application has the applicant agent resided continuously in Wisconsin? 51 YEARS

Place of residence last year N 7015 City Rd W Holmen WI 54636

For: RETAIL ENTERPRISES, INC.
(Name of Corporation / Organization / Limited Liability Company)

By: [Signature]
(Signature of Officer / Member / Manager)

Any person who knowingly provides materially false information in an application for a license may be required to forfeit not more than \$1,000.

ACCEPTANCE BY AGENT

I, Randall K. Wigdal, hereby accept this appointment as agent for the
(Print / Type Agent's Name)

corporation/organization/limited liability company and assume full responsibility for the conduct of all business relative to alcohol beverages conducted on the premises for the corporation/organization/limited liability company.

[Signature] 9-6-19 Agent's age 51
(Signature of Agent) (Date)

N 7015 City Rd W Holmen WI 54636 Date of birth _____
(Home Address of Agent)

APPROVAL OF AGENT BY MUNICIPAL AUTHORITY (Clerk cannot sign on behalf of Municipal Official)

I hereby certify that I have checked municipal and state criminal records. To the best of my knowledge, with the available information, the character, record and reputation are satisfactory and I have no objection to the agent appointed.

Approved on 9-18-19 by [Signature] Title Chief of Police
(Date) (Signature of Proper Local Official) (Town Chair, Village President, Police Chief)

Original:

License Fee: 135.00

Renewal:

Invoice #:

APPLICATION FOR INDOOR CABARET LICENSE

Legal/Real Name: Redtail Enterprises

Address of above: 220 Carlson Parkway, Plymouth, MN 55447

Trade name of business: Milwaukee Burger Company

Address of premises to be licensed: 3039 Medco Court, La Crosse WI 54601

Business phone number: 608-781-6630

Detailed description of cabaret area to be licensed: in Bar Area

Premises are owned by: Pinetree Enterprises

Address of owner: 137 S. 2nd Ave, Waite Park, MN 56387

Name of Cabaret Manager (FIRST, MIDDLE & LAST): Randall Knute Wigdal

Home address of Cabaret Manager: N 7015 Cty Rd W Holmen WI 54636
~~620 Wagon Dr, West Salem WI 54669~~

Home phone number of Cabaret Manager: ~~608-786-1755~~ 608 792 6027

Daytime phone number of Cabaret Manager: 608 781 6630

Date of Birth of Cabaret Manager: _____

Was the above person listed as manager on last year's application? Yes No

Other business to be conducted upon the premises: Restaurant/Bar

Nature of entertainment: Small Band or Singers

License Period: 10/11/2019 to 06/30/2020

The above hereby makes application for a license to operate an Indoor Cabaret at the above address within the City of La Crosse pursuant to provisions of Sec. 10-100 of the Code of Ordinances for the City of La Crosse.

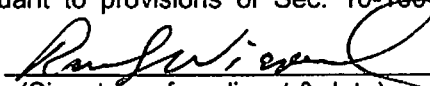
(Signature of applicant & date)

OFFICE USE ONLY:

Munis Customer #:

For original applications: Are there lands zoned conservancy, residential or multiple dwelling within 100 feet of premises? Y / N If yes, attach a list of those lands.

Signature and date _____

Granted: _____ License #: _____

Original: ~~X~~
Renewal:

License Fee: 160.00
Invoice #:

APPLICATION FOR OUTDOOR CABARET LICENSE

Legal/Real Name: Redtail Enterprises

Address of above: 220 Carlson Parkway, Plymouth, MN 55447

Trade name of business: Milwaukee Burger Company

Address of premises to be licensed: 3039 Medco CT, La Crosse WI 54601

Business phone number: 608-781-6630

Detailed description of cabaret area to be licensed: Beer Garden Area

Premises are owned by: Pinetree Enterprises, Inc.

Address of owner: 137 S. 2nd Ave, Waite Park, MN 56387

Name of Cabaret Manager (FIRST, MIDDLE & LAST): Randall Knute Wigdal

Home address of Cabaret Manager: ~~620 Wagon Dr, West Salem, WI 54689~~ N7015 Cty Rd W, Holmen, WI 54636

Home phone number of Cabaret Manager: ~~608-786-1755~~ 608 792 6027

Daytime phone number of Cabaret Manager: 608 781 6630

Date of Birth of Cabaret Manager: _____

Was the above person listed as manager on last year's application? Yes No

Other business to be conducted upon the premises: Restaurant/Bar

Nature of entertainment: Small Band or Singers

License Period: 10/11/2019-06/30/2020

The above hereby makes application for a license to operate an Outdoor Cabaret at the above address within the City of La Crosse pursuant to provisions of Chapter 10, Article IV of the Code of Ordinances for the City of La Crosse.

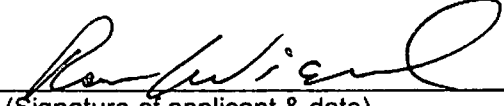
X 
(Signature of applicant & date)

OFFICE USE ONLY: _____ Munis Customer #: _____

For original applications: Attach a list of all property owners within 200 feet of the proposed licensed premises.

Signature and date _____

Granted: _____ License #: _____

New: X

License Fee: \$160.

Renewal: _____

Receipt #: _____

APPLICATION FOR BEER GARDEN LICENSE
____ Class "A" X Class "B" _____ Class "C" _____ Class "D"
(ZONING RESTRICTION)

To the Common Council of the City of La Crosse:

Legal/Real Name: Redtail Enterprises

Address of above: 220 Carlson Parkway, Plymouth MN 55447

Trade name of business: Milwaukee Burger Company

Address of premises to be licenses: 3039 Medco Court

Description of proposed beer garden: (MUST BE SPECIFIC: square feet, physical location, material made out of, etc.) _____

Concrete base, approx. 1100 square feet. Metal posts to surround the patio with cable
system as barrier to outside patio. Patio located on south side of building.

Name of Agent (First, Middle, Last:): Randy Knute Wigdal

Home address: ~~620 Wagon Dr., West Salem, WI 54660~~ ^{N 7015 City Rd W Holmen WI 54636}

Home phone number: 608-792-6027

Daytime phone number: 608 781 6630

Date of Birth: _____

License Period: 10/11/2019-06/30/2020

The above hereby makes application for a license to operate a Beer Garden at the above address within the City of La Crosse pursuant to provisions of Sec. 10-47 of the Code of Ordinances for the City of La Crosse.

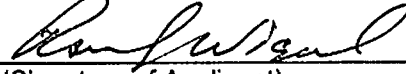
(Signature of Applicant)

9-6-19
(Date)

******A PLAN MUST ACCOMPANY THIS APPLICATION******

OFFICE USE ONLY:

For original applications: Attach a list of all property owners within 200 feet of the proposed licensed premises.

Signature and date: _____

Granted: _____ License #: _____

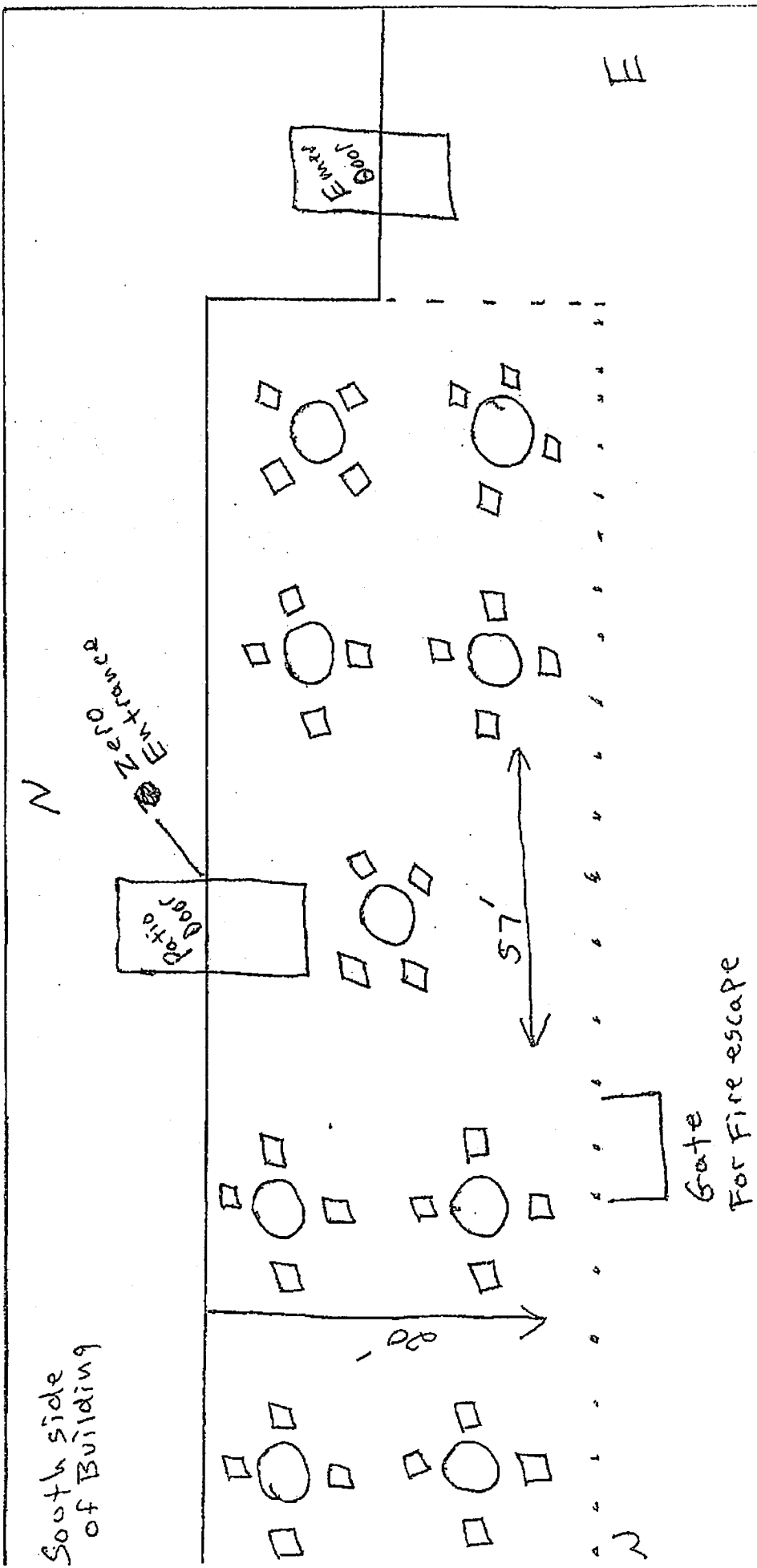

South side
of Building

MILWAUKEE
BUTLER COMPANY
3039 Medco Court

S

SURRENDER OF LICENSE
Part I

Legal/Real Name of Current Licensee: YORK FACTORY ENTERPRISES, INC
Premises Address: 3039 MEDCO COURT LACROSSE, WI 54601
Trade Name: GRIZZLY'S WOOD-FIRED GRILL

This is to advise that the undersigned is surrendering the following license(s)
Combination "Class B" Beer & Liquor
Class "B" Beer
Class "A" Beer and/or "Class A" Liquor (circle which apply)
Wholesale Beer
"Class C" Wine

to: RETAIL ENTERPRISES, INC dba MILWAUKEE BURGER Co.
(Insert Legal/Real Name of Proposed Licensee and Trade Name)

and understand that said license(s) will be cancelled upon the Common Council's granting of a license to the applicant named herein.

New Applicant

CURTIS LETNES
President, Member, Partner, Individual

Curtis Letnes

MATTHEW LETNES
Secretary, Member, Partner

Matt Letnes

State of Wisconsin)
) ss.
County of La Crosse)

Current Licensee

CURTIS LETNES
President, Member, Partner, Individual

Secretary, Member, Partner

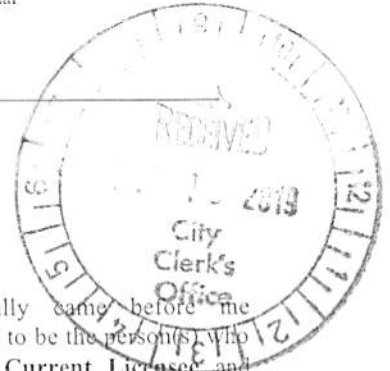

On the 10th day of September, 2019, personally came before me Curtis Letnes, known to me to be the person(s) who executed the foregoing Surrender of License, and known to me to be the **Current Licensee** and acknowledged that s/he executed the foregoing document.

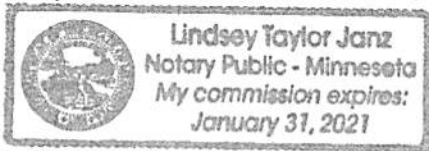

State of Wisconsin)
) ss.
County of La Crosse)

[Signature]
Notary Public
Wright County, Wisconsin
My Commission expires: January 31, 2021

On the 10th day of September, 2019, personally came before me Matthew Letnes, known to me to be the person(s) who executed the foregoing Surrender of License, and known to me to be the **Proposed New Applicant** and acknowledged that s/he executed the foregoing document.

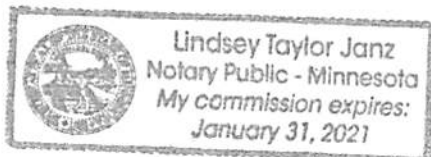

[Signature]
Notary Public
Wright County, Wisconsin
My Commission expires: January 31, 2021

*owner of building is Pinetree Enterprises, which is part of newly licensing entity.



TERI LEHRKE, WCPC, City Clerk

400 LA CROSSE STREET
LA CROSSE, WISCONSIN 54601
PHONE (608) 789-7510
FAX (608) 789-7552
www.cityoflacrosse.org

REDTAIL ENTERPRISES INC
dba MILWAUKEE BURGER COMPANY
220 CARLSON PARKWAY
PLYMOUTH MN 55447

NOTICE OF APPLICATION FOR INDOOR CABARET LICENSE IN THE CITY OF LA CROSSE

TO WHOM IT MAY CONCERN:

This is to notify you that the following business has applied for an **Indoor Cabaret** license under Sec. 10-140(c) of the Code of Ordinances of the City of La Crosse to provide live entertainment in a designated indoor area.

Redtail Enterprises, Inc. dba Milwaukee Burger Company
3039 Medco Ct.

This application will be considered at the following meetings which are held in the Council Chambers at City Hall (400 La Crosse Street):

Judiciary and Administration Committee – Tuesday, October 1, 2019 at 6:00 p.m.
Common Council – Thursday, October 10, 2019 at 6:00 p.m.

You are further notified that any person affected may be heard, and may appear in person or by attorney, or may file a letter of objection in the office of the City Clerk.

This notice is given pursuant to the order of the Common Council of the City of La Crosse.

Dated this 16th day of September, 2019.

Teri Lehrke, WCPC, City Clerk
City of La Crosse

Sondra Craig
Assistant Clerk



Redtail Enterprises, Inc. dba Milwaukee Burger Company
3039 Medco Ct.
Original Indoor Cabaret

<u>Tax Parcel Number</u>	<u>OwnerName</u>	<u>PROPADDCOMP</u>	<u>CompleteAddress</u>	<u>MailCityStateZip</u>
17-10315-15	US REALTY 87 LACROSSE ASSOCIATES LP	3131, 3133, 3201 STATE ROAD 16	820 MORRIS TPKE	SHORT HILLS, NJ 07078
17-10315-50	PRINCESS BBQ LLC	3055 STATE ROAD 16	3055 STATE ROAD 16	LA CROSSE, WI 54601
17-10315-620	PINETREE ENTERPRISES LLC	3039 MEDCO CT	137 2ND AVE S	WAITE PARK, MN 56387
17-10315-625	COULEE ROCK COMMUNITY CHURCH	3059 MEDCO CT	3059 MEDCO CT	LA CROSSE, WI 54603
17-10315-611	EBNER JOINT REVOCABLE TRUST	2830 DARLING CT	4131 STATE RD	LA CROSSE, WI 54601
17-10315-15	US REALTY 87 LACROSSE ASSOCIATES LP	3131, 3133, 3201 STATE ROAD 16 3320 STATE ROAD 157	820 MORRIS TPKE	SHORT HILLS, NJ 07078
For:	REDTAIL ENTERPRISES INC	dba MILWAUKEE BURGER COMPAN'	220 CARLSON PARKWA	PLYMOUTH MN 55447

100-ft buffer - Indoor Cabaret



TERI LEHRKE, WCPC, City Clerk

400 LA CROSSE STREET
LA CROSSE, WISCONSIN 54601
PHONE (608) 789-7510
FAX (608) 789-7552
www.cityoflacrosse.org

REDTAIL ENTERPRISES INC
dba MILWAUKEE BURGER COMPANY
220 CARLSON PARKWAY
PLYMOUTH MN 55447

**NOTICE OF APPLICATION FOR BEER GARDEN LICENSE &
OUTDOOR CABARET LICENSE
IN THE CITY OF LA CROSSE**

This is to notify you that the following business has applied for a **Class "B" Beer Garden** license under Sec. 10-47 of the Code of Ordinances of the City of La Crosse to allow consumption of alcoholic beverages in a designated outdoor area, and an **Outdoor Cabaret** license under Sec. 10-140(d) to provide live entertainment in a designated outdoor area.

**Redtail Enterprises, Inc. dba Milwaukee Burger Company
3039 Medco Ct.**

This application will be considered at the following meetings which are held in the Council Chambers at City Hall (400 La Crosse Street, La Crosse, Wisconsin):

**Judiciary and Administration Committee – Tuesday, October 1, 2019 at 6:00 p.m.
Common Council – Thursday, October 10, 2019 at 6:00 p.m.**

You are further notified that any person affected may be heard, and may appear in person or by attorney, or may file a letter of objection in the office of the City Clerk.

This notice is given pursuant to the order of the Common Council of the City of La Crosse.

Dated this 16th day of September, 2019.

Teri Lehrke, WCPC, City Clerk
City of La Crosse

Sondra Craig
Assistant Clerk

Redtail Enterprises, Inc. dba Milwaukee Burger Company
3039 Medco Ct.
200 foot Buffer Map

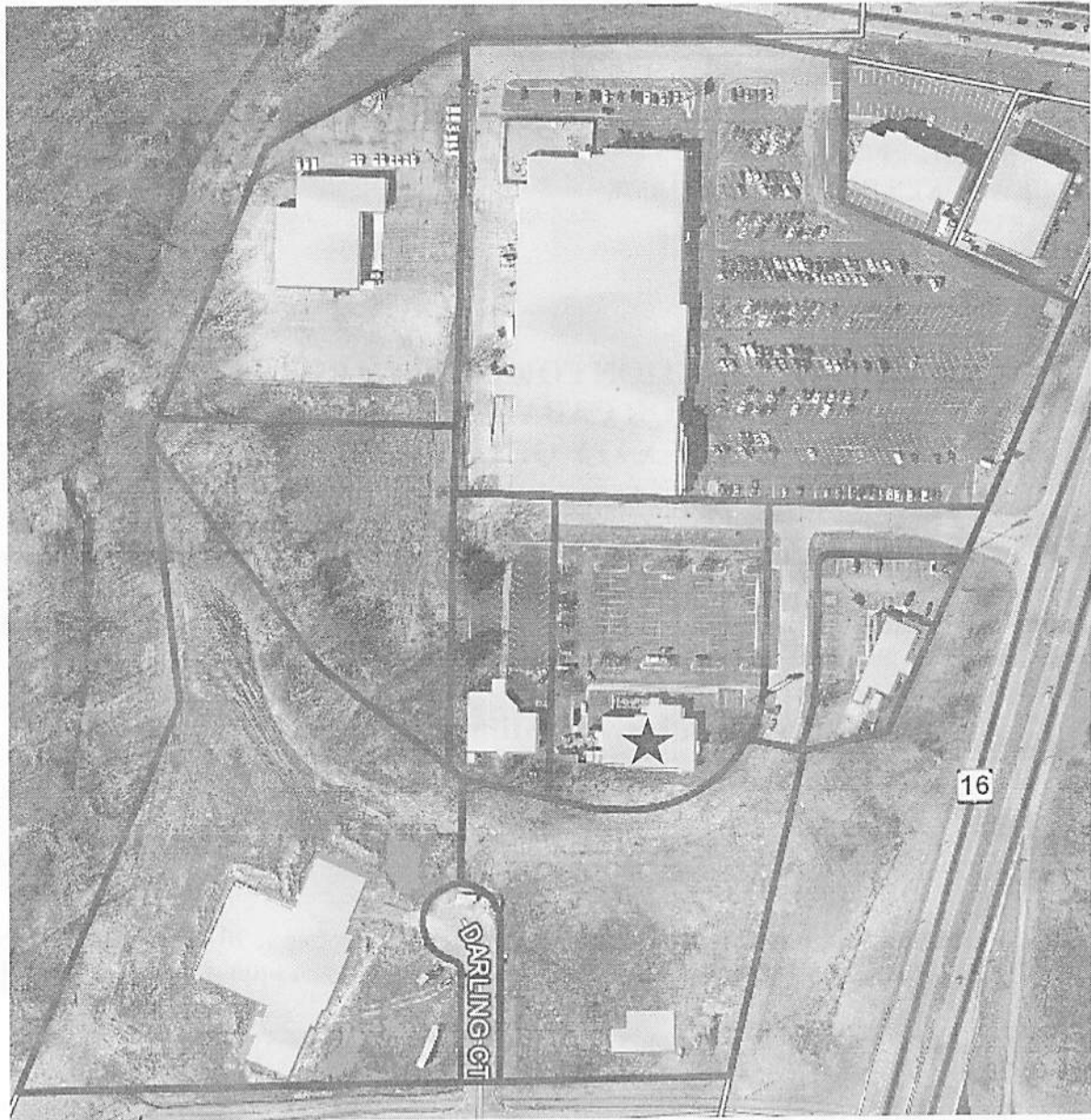

Beer Garden: Approximately 1,100 square feet on the south side of the building; concrete base with metal posts surrounding the patio with cable system as a barrier to outside of patio.
Outdoor Cabaret: small band or singers in beer garden area.

Tax Parcel Number	OwnerName	PROPADDCOMP	CompleteAddress	MailCityStateZip
17-10315-10	JHJ RENTALS LLC	3310 STATE ROAD 157	3310 STATE ROAD 157	LA CROSSE, WI 54603
17-10315-11	JHJ RENTALS LLC	3316 STATE ROAD 157	3310 STATE ROAD 157	LA CROSSE, WI 54603
17-10315-15	US REALTY 87 LACROSSE ASSOCIATES LP	3131, 3133, 3201 STATE ROAD 16	820 MORRIS TPKE	SHORT HILLS, NJ 07078
17-10315-50	PRINCESS BBQ LLC	3055 STATE ROAD 16	3055 STATE ROAD 16	LA CROSSE, WI 54601
17-10315-620	PINETREE ENTERPRISES LLC	3039 MEDCO CT	137 2ND AVE S	WAITE PARK, MN 56387
17-10315-625	COULEE ROCK COMMUNITY CHURCH	3059 MEDCO CT	3059 MEDCO CT	LA CROSSE, WI 54603
17-10315-612	G2G LLC	2835, 2837, 2839, 2841 DARLING CT	2839 DARLING CT	LA CROSSE, WI 54603
17-10315-611	EBNER JOINT REVOCABLE TRUST	2830 DARLING CT	4131 STATE RD	LA CROSSE, WI 54601
17-10315-614	MAPLEWOOD DENTAL BUILDING LLC	2830 DARLING CT	4607 ROYAL DR	EAU CLAIRE, WI 54701
17-10315-15	US REALTY 87 LACROSSE ASSOCIATES LP	3131, 3133, 3201 STATE ROAD 16 3320 STATE ROAD 157	820 MORRIS TPKE	SHORT HILLS, NJ 07078

For: REDTAIL ENTERPRISES INC dba MILWAUKEE BURGER COMPANY 220 CARLSON PARKWAY PLYMOUTH MN 55447

200-ft buffer - Beer Garden & Outdoor Cabaret