

**ENLARGED VIEW, TYP  
 NOT TO SCALE**

**LEGEND:**

	CONCRETE PAVEMENT	(C/C401)
	5" CONCRETE WALK	(D/C401)
	HEAVY DUTY ASPHALT SURFACE	(B/C401)
	ASPHALT SURFACE	(A/C401)
	CONCRETE LOADING DOCK	(K/C401)
	ASPHALT PAVEMENT RESTORATION	(M/C401)
	CURB & GUTTER (ACCEPT)	(G/C401)
	CURB & GUTTER (REJECT)	(G/C401)

**GENERAL NOTES:**

1. THE UNDERGROUND UTILITY INFORMATION SHOWN ON THIS DRAWING IS BASED ON FIELD LOCATIONS AND/OR RECORDS FURNISHED BY MUNICIPALITIES AND UTILITY COMPANIES. THE LOCATION AND ACCURACY OF WHICH CANNOT BE GUARANTEED. THERE MAY BE ADDITIONAL UNDERGROUND UTILITY INSTALLATIONS WITHIN THE PROJECT AREA THAT ARE NOT SHOWN.
2. VERIFY ACTUAL LOCATIONS AND INVERTS IN THE FIELD. ANY POTENTIAL ERRORS, OMISSIONS, OR DISCREPANCIES SHALL BE BROUGHT TO THE ATTENTION OF THE ENGINEER PRIOR TO PROCEEDING WITH CONSTRUCTION.
3. WORK TO BE COMPLETED IS INDICATED IN BOLD TYPE LINES AND EXISTING CONDITIONS ARE INDICATED BY LIGHT TYPE LINES.
4. ELECTRONIC CIVIL FILES ARE AVAILABLE UPON WRITTEN REQUEST. DO NOT USE ELECTRONIC CIVIL FILES TO LAYOUT FOUNDATIONS, COLUMN LINES, LIGHT POLES, OR OTHER NON CIVIL SITE WORK. REFER TO ARCHITECTURAL DRAWINGS FOR DIMENSIONS OF BUILDING AND ARCHITECTURAL FEATURES.
5. DIMENSIONS ARE FROM FACE OF CURB OR EDGE OF PAVEMENT.
6. WORK WITHIN THE PUBLIC RIGHT OF WAY, INCLUDING BUT NOT LIMITED TO DRIVEWAY OPENINGS, SIDEWALK AND RAMPS, PAVING, AND CURB AND GUTTER SHALL BE COMPLETED IN ACCORDANCE WITH APPLICABLE CITY OF LACROSSE STANDARD SPECIFICATIONS AND DETAILS.

**La Crosse Plow Building**

525 North 2nd Street  
 La Crosse, WI 54601

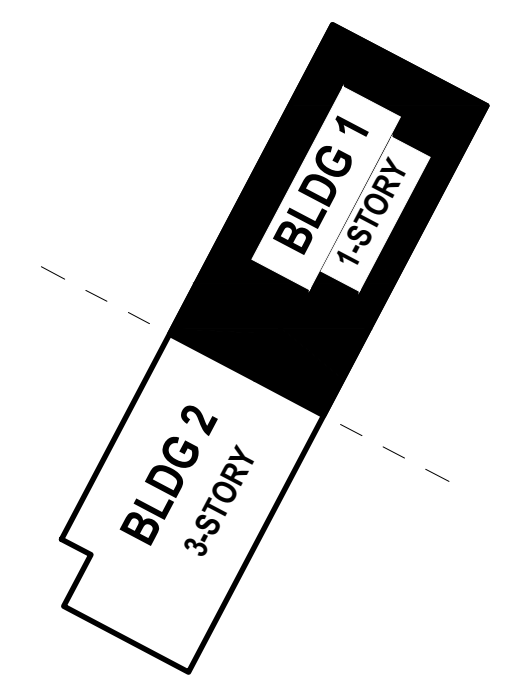

DATE OF ISSUE: ##/##/####

**REVISIONS:**

DD SET	05/12/17

PROJECT # 15275

**PROPOSED  
 ALTERNATE  
 BUMPOUT  
 EXHIBIT**

**PRELIMINARY**

**EX**



CALL DIGGERS HOTLINE  
 1-800-242-8511  
 TOLL FREE  
 MS STATUTE (48.076(1)(a))  
 REQUIRES MIN. 3 WORK DAYS  
 NOTICE BEFORE YOU DIG  
 MILW. AREA 259-1181

THE UNDERGROUND UTILITY INFORMATION SHOWN ON THIS MAP IS BASED ON FIELD MARKINGS AND INFORMATION FURNISHED BY UTILITY COMPANIES AND THE LOCAL MUNICIPALITY. WHILE THIS INFORMATION IS BELIEVED TO BE RELIABLE, ITS ACCURACY AND COMPLETENESS CANNOT BE GUARANTEED.