

These documents in this form, electronic media, are being provided for your review. The information contained is proprietary in nature and may only be utilized for the current project. All documents information contained herein including, but not limited to, general business, books, details, etc. may not be reproduced, sold, distributed or utilized in any form on other projects without the express written permission of JTB Architects. Due to the unsecured nature of these documents, electronic media and the inability of the originator to establish controls over the use thereof, JTB Architects assumes no responsibility for any consequences arising out of the use of the data. It is the sole responsibility of the user to meet the reliability of all information contained herein. The user shall at all times refer to the signed and sealed construction drawings for the project during all phases of the project. The user shall assume all risks and liabilities resulting from the use of this data. By accessing and/or extracting the information from the attached file, the recipient acknowledges and agrees to the above terms regarding the use of the information contained within the attached file.

- LIGHTING NOTES**
1. PROVIDE CROWN ON TOP OF CONCRETE BASE TO COMPLETELY SHED WATER.
 2. 2" (MIN) AIRGAP SPACE BETWEEN TOP OF CONCRETE CROWN AND BOTTOM OF POLE BASE PLATE FOR VENTILATION.
 3. LOCATE LUMINAIRE ON THE DRAWING; AND VERIFY LUMINAIRE CATALOG NUMBER, POSITION OF LAMP SOCKET AND DIRECTION.
 4. PRIOR TO LUMINAIRE INSTALLATION, VERIFY THAT THE LUMINAIRE CATALOG NUMBER MATCHES THE CATALOG NUMBER SHOWN ON THE CIVIL DRAWINGS.
 5. CONTRACTOR SHALL CONFIRM THE MANUFACTURER STANDARD COLOR FOR THE POLE AND FIXTURE WITH THE ARCHITECT.
 6. CONTRACTOR SHALL CONFIRM THE LIGHT POLE BASE BOLT PATTERN/ LAYOUT PRIOR TO INSTALLATION OF THE CONCRETE BASE.

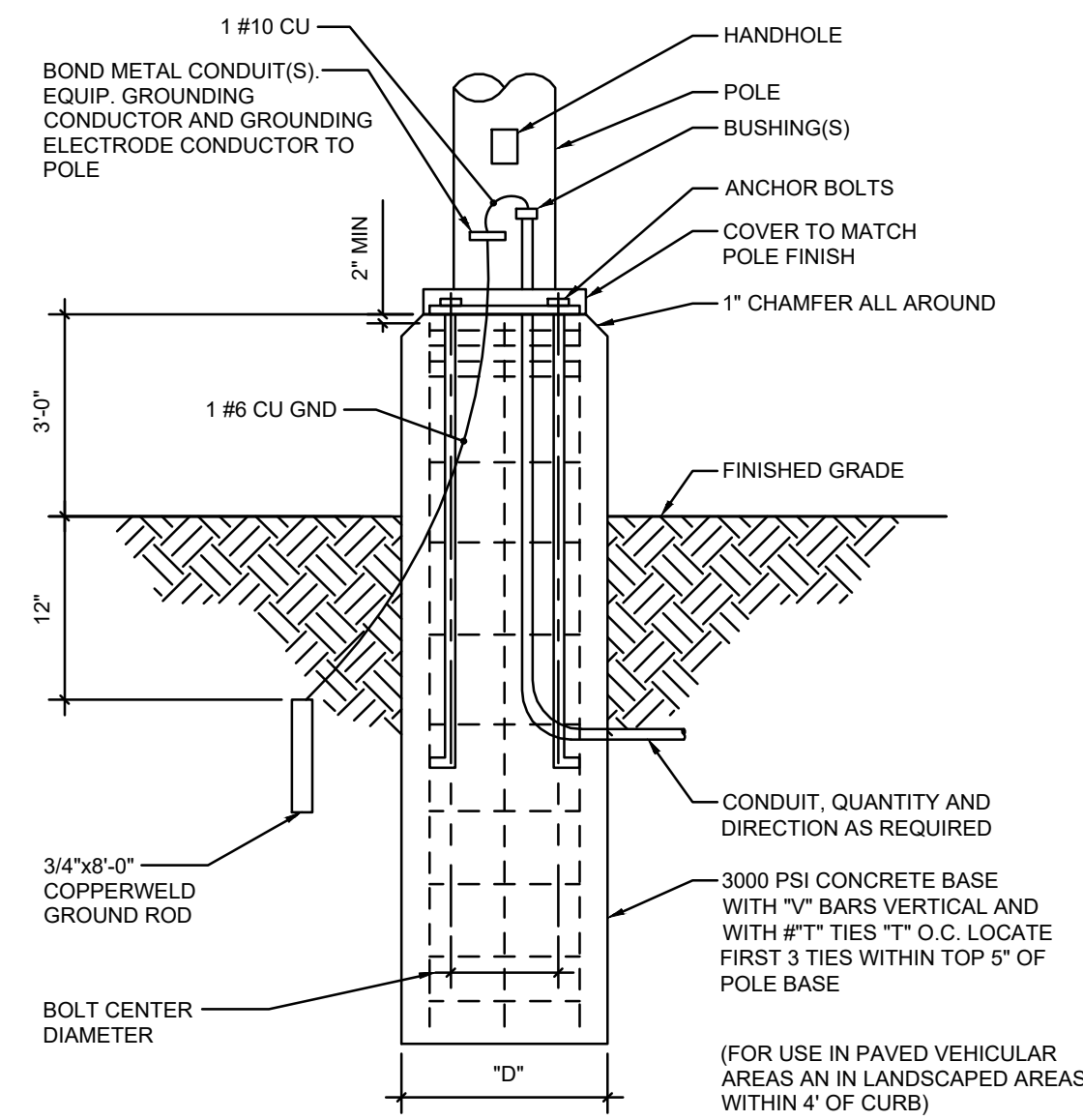

EXTENDED POLE BASE

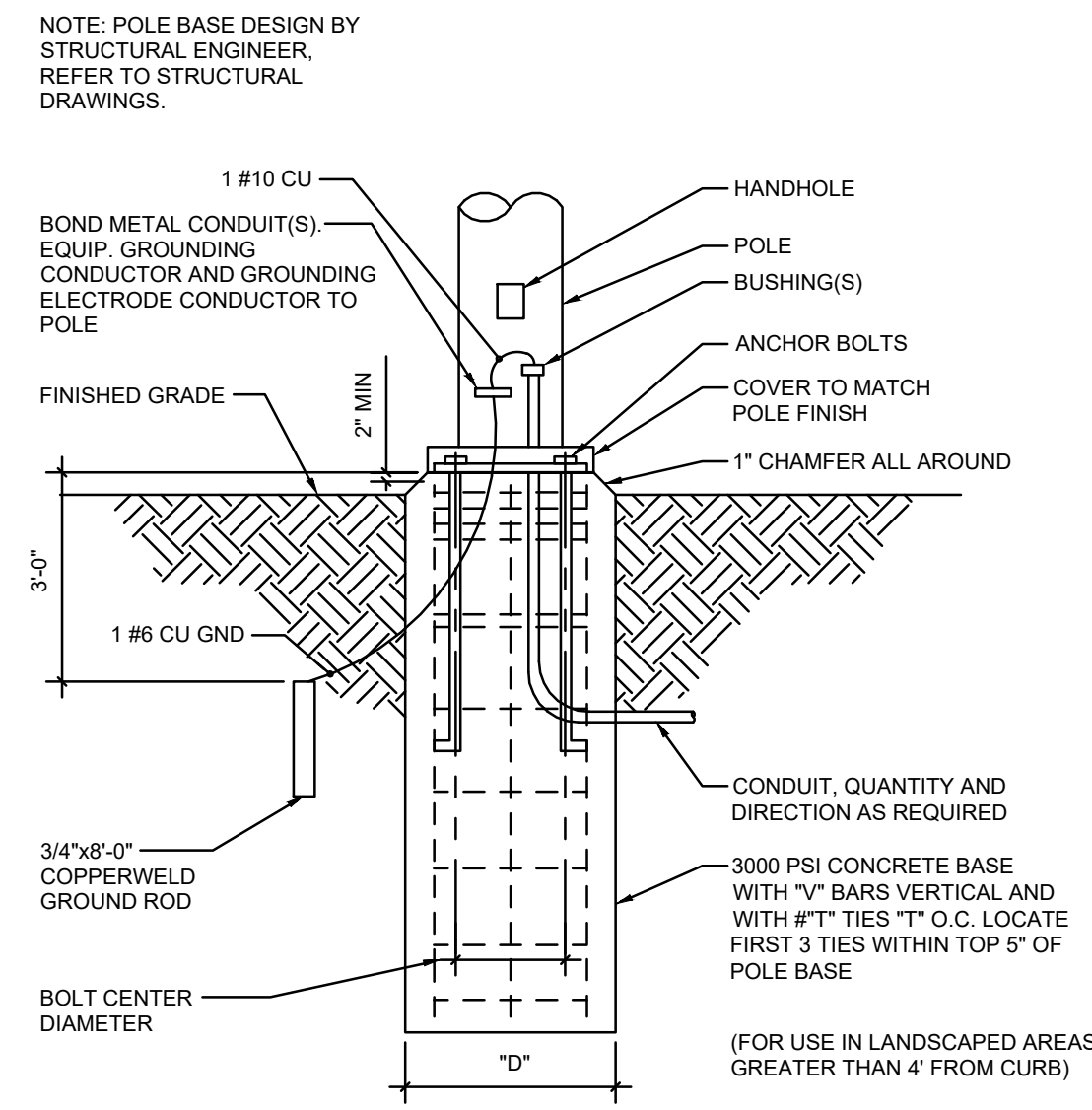

FLUSH POLE BASE

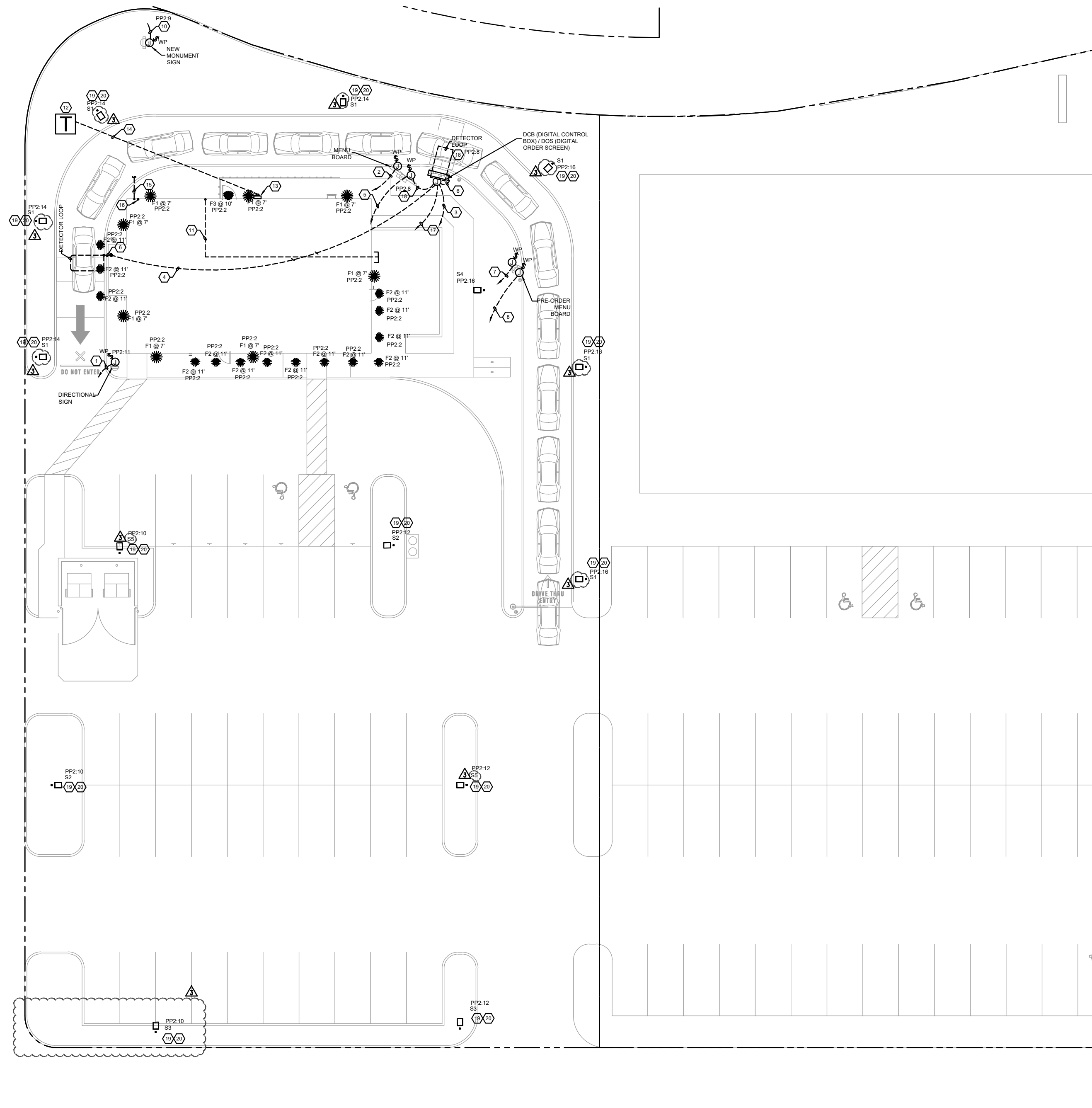

1 ELECTRICAL SITE PLAN
 1" = 20'-0"
 ELECTRICAL

- GENERAL NOTES**
1. REFER TO GENERAL NOTES ON SHEET E0.0.
 2. REFER TO SPECIFICATIONS ON SHEET E0.1.
 3. UTILITIES ARE NOT INDICATED. PRIOR TO EQUIPMENT AND CONDUIT INSTALLATION, THE CONTRACTOR SHALL COORDINATE EXACT INSTALLATION DETAILS AND MODIFY WORK PLAN ACCORDINGLY TO MEET UTILITY REQUIREMENTS. CORRESPOND WITH UTILITY COMPANY PRIOR TO ANY SITE DEVELOPMENT THAT MAY IMPACT THE INSTALLATION, SUCH AS IRRIGATION INSTALLATION, CONCRETE OR ASPHALT INSTALLATION, LANDSCAPING, ETC.
 4. REFER TO PHOTOMETRIC SITE PLAN FOR PARKING LIGHTING FIXTURE SCHEDULE.

- KEY NOTES**
1. PROVIDE (2) #10 THWN, (1) #10 GND IN 1" CONDUIT FOR DIRECTIONAL SIGN AND CONNECT TO CIRCUIT SHOWN VIA TIME CLOCK. DISCONNECT SWITCH SUPPLIED BY MANUFACTURER AND INSTALLED BY ELECTRICIAN. TENANT ELECTRICAL CONTRACTOR TO PROVIDE WIRING AND MAKE FINAL CONNECTION AS REQUIRED. COORDINATE ROUTING OF LANDLORD PROVIDED CONDUIT IN FIELD.
 2. PROVIDE ONE (1) 1" CONDUIT FROM MENU BOARD TO PP1 WITH PULL STRING FOR FUTURE.
 3. PROVIDE ONE (1) 1" CONDUIT FROM DIGITAL ORDER SCREEN TO PP1 WITH PULL STRING. PROVIDE FINAL CONNECTION TO DOS CONTROL BOX AS REQUIRED.
 4. PROVIDE TWO (2) 1" CONDUITS FROM DIGITAL ORDER SCREEN TO DRIVE-THRU WINDOW WITH PULL STRING. ONE CONDUIT FOR SPEAKER, MICROPHONE, DETECTOR LOOP DATA, AND ONE CONDUIT FOR CAMERA DATA. RUN OUTSIDE OF BUILDING FOOTPRINT. TENANT ELECTRICAL CONTRACTOR TO PROVIDE WIRING AND MAKE FINAL CONNECTION AS REQUIRED. VERIFY ALL REQUIREMENTS WITH EQUIPMENT MANUFACTURER PRIOR TO COMMENCING WORK. COORDINATE ROUTING OF LANDLORD PROVIDED CONDUIT IN FIELD.
 5. PROVIDE ONE (1) 1" CONDUIT FROM MENU BOARD TO PP1 WITH PULL STRING. TENANT ELECTRICAL CONTRACTOR TO PROVIDE WIRING AND MAKE FINAL CONNECTION AS REQUIRED. VERIFY ALL REQUIREMENTS WITH EQUIPMENT MANUFACTURER PRIOR TO COMMENCING WORK. COORDINATE ROUTING OF LANDLORD PROVIDED CONDUIT IN FIELD. COORDINATE WITH OWNER AND STARBUCKS REPRESENTATIVE PRIOR TO COMMENCING WORK.
 6. PROVIDE ONE (1) 1" CONDUIT FOR TENANT - FURNISHED DETECTOR LOOP TO OSC/ SPEAKER IN COORDINATION WITH TENANT'S REPRESENTATIVE. TENANT ELECTRICAL CONTRACTOR TO PROVIDE WIRING AND MAKE FINAL CONNECTION AS REQUIRED.
 7. PROVIDE ONE (1) 1" CONDUIT FROM PRE-ORDER MENU BOARD TO PP1 WITH PULL STRING. TENANT ELECTRICAL CONTRACTOR TO PROVIDE WIRING AND MAKE FINAL CONNECTION AS REQUIRED. VERIFY ALL REQUIREMENTS WITH EQUIPMENT MANUFACTURER PRIOR TO COMMENCING WORK. COORDINATE ROUTING OF LANDLORD PROVIDED CONDUIT IN FIELD. COORDINATE WITH OWNER AND STARBUCKS REPRESENTATIVE PRIOR TO COMMENCING WORK.
 8. PROVIDE ONE (1) 1" CONDUIT FROM PRE-MENU BOARD TO PP1 WITH PULL STRING FOR FUTURE.
 9. NOT USED.
 10. PROVIDE (2) #10 THWN, (1) #10 GND IN 1" CONDUIT FOR MONUMENT SIGN AND CONNECT TO CIRCUIT SHOWN VIA TIME CLOCK. DISCONNECT SWITCH SUPPLIED BY MANUFACTURER AND INSTALLED BY ELECTRICIAN. TENANT ELECTRICAL CONTRACTOR TO PROVIDE WIRING AND MAKE FINAL CONNECTION AS REQUIRED.
 11. PROVIDE TWO (2) 1" CONDUIT TO PATIO AREA FROM ELECTRICAL PANEL PP1 WITH PULL STRING. CONDUIT SHOWN FOR REFERENCE ONLY.
 12. COORDINATE LOCATION OF UTILITY TRANSFORMER WITH LOCAL UTILITY COMPANY AND CIVIL DRAWINGS. PROVIDE CONCRETE PAD, AND COORDINATE PAD REQUIREMENTS WITH LOCAL UTILITY COMPANY.
 13. APPROXIMATE LOCATION OF METER WITH MAIN DISCONNECT AND CT CABINET. REFER TO SINGLE LINE DIAGRAM ON SHEET E2.0 FOR INFORMATION.
 14. UNDERGROUND SECONDARY ELECTRICAL SERVICE. CONDUIT SHOWN FOR REFERENCE ONLY. COORDINATE WITH CIVIL DRAWINGS AND LOCAL UTILITY COMPANY. SEE SINGLE LINE ON SHEET E2.0 FOR CONDUIT AND CONDUCTOR REQUIREMENTS.
 15. PROVIDE TWO (2) 4" UNDERGROUND CONDUITS WITH PULL STRING FOR TELEPHONE AND INTERNET. PROVIDE LABELED, END-TO-END PULL STRINGS IN ALL CONDUITS FOR FUTURE USE. REFER TO SHEET E1.0 FOR INFORMATION.
 16. PROVIDE (1) SPARE CONDUIT TO BE RUN THROUGH FOUNDATION WALL OUT REAR OF BUILDING. REFER TO SHEET E1.0 FOR ADDITIONAL INFORMATION.
 17. PROVIDE ONE (1) 1" CONDUIT EMBED IN DRIVE THRU LANE FOR VEHICLE DETECTOR LOOP. CENTER CONDUIT ON SPEAKER POST.
 18. LANDLORD TO PROVIDE (2) #10 THWN, (1) #10 GND IN 1" CONDUIT AND CONNECT TO CIRCUIT SHOWN VIA TIME CLOCK FOR POWER TO LED LIGHT ON DOS CANOPY AND MENU BOARD. SEE ARCHITECTURAL SHEETS FOR CONDUIT STUB-UP DETAILS AND ADDITIONAL INFORMATION. LANDLORD TO PROVIDE WIRING AND MAKE FINAL CONNECTION AS REQUIRED.
 19. PROVIDE 2#10 AWG + 1# 10AWG GND IN 1" CONDUIT AND CONNECT TO CIRCUIT SHOWN. CIRCUIT SHALL BE ROUTED THROUGHT TIMECLOCK AND PHOTOCELL FOR CONTROL. SEE DETAIL ON THIS SHEET TO PROVIDE COPPER GROUND ROD AND USE # 6 GROUND CONDUCTOR FROM GROUND ROD TO POLE BASE.
 20. PROVIDE INLINE FUSE HOLDER FUSED TO MEET BALLAST/DRIVER REQUIREMENTS. INLINE FUSE HOLDER SHALL BE RATED FOR 600VAC, 200KA AND SHALL BE UL LISTED TO MEET BREAKAWAY AND SUBMERSIBILITY REQUIREMENTS.
 21. PROVIDE 2#8 AWG + 1# 10AWG GND IN 1" CONDUIT AND CONNECT TO CIRCUIT SHOWN. CIRCUIT SHALL BE ROUTED THROUGHT TIMECLOCK AND PHOTOCELL FOR CONTROL. SEE DETAIL ON THIS SHEET TO PROVIDE COPPER GROUND ROD AND USE # 6 GROUND CONDUCTOR FROM GROUND ROD TO POLE BASE.

- SITE INTERNET & VOICE SYSTEM NOTES**
1. LANDLORD INITIATED CONNECTIVITY: TELECOMMUNICATION SERVICES WILL BE ORDERED BY STARBUCKS FOR THE SPACE LEASED HOWEVER TO PROVIDE STARBUCKS WITH POINT OF FEED EXHIBITS AND LANDLORD TO COORDINATE INITIAL INSTALLATION OF COMMUNICATION INFRASTRUCTURE WITH LOCAL TELCO OR BROADBAND PROVIDER, INCLUDING THE TERMINATION OF ONT (OPTICAL NETWORK TERMINATION) FIBER AND/OR BROADBAND NODE AT THE MINIMUM POINT OF ENTRY. LANDLORD TO PROVIDE ELECTRICAL CONNECTIVITY FOR POTENTIAL LEC (LOCAL EXCHANGE CARRIER) FIBER NODE OR BROADBAND ROUTER AS WELL AS A BACKBOARD PER LOCAL SPECIFICATION FOR SERVICE TERMINATION AND DEMARCATON POINT PLACEMENT. STARBUCKS WILL REQUIRE AT LEAST FIBER OR BROADBAND SERVICES WITH MINIMUM SPEEDS OF 50X10 MBPS. IN EXCEPTIONAL SITUATIONS, STARBUCKS MIGHT NEED ACCESS TO MOUNT ROOF ANTENNAS.

DATE	SUBMITTED FOR
10/3/23	TENANT REVIEW
05/08/24	TENANT COMMENTS
06/18/24	TENANT COMMENTS
07/30/24	TENANT COMMENTS

SHEET TITLE	
ELECTRICAL SITE PLAN	
DRAWN BY:	
AB/VM	
JOB NO.	
3140.a	
SHEET	
ES1.0	

GMX REAL ESTATE GROUP, LLC
 NEW CONSTRUCTION
 3900 STATE HWY 16 - LOT 2, LA CROSSE, WI 54601

rtm engineering consultants
 650 E. Algonquin Road, Suite 250, Schaumburg, IL 60173
 rtmc.com | 847.756.4180

These documents in this form, electronic media, are being provided as your request. The information contained is proprietary to the architect and may only be used for the project for which it is provided. It is the sole responsibility of the user to check the reliability of all information contained herein. The user shall at all times refer to the signed and sealed construction drawings for the project during all phases of the project. The user shall assume all risks and liabilities resulting from the use of this data. By accessing and/or extracting the information from the attached file, the recipient acknowledges and agrees to the above terms regarding the use of the information contained within the attached file.

Lamp Symbol	Label	Quantity	Manufacturer	Catalog Number	Description	Number Lamps	File Name	Lumens Per Lamp	Light Loss Factor	Wattage
S1	7	Lithonia Lighting	DSX2 LED P2 35K 80CRI T3M HS	D-Series Size 2 Area Luminaire P2 Performance Package 3500K CCT 80 CRI Type 3 Medium HouseSide Shield	1	DSX2_LED_P2_35K_80CRI_T3M_HS.ies	19434	0.95	179.2228	
S2	2	Lithonia Lighting	DSX2 LED P1 35K 80CRI T3M HS	D-Series Size 2 Area Luminaire P1 Performance Package 3500K CCT 80 CRI Type 3 Wide HouseSide Shield	1	DSX2_LED_P1_35K_80CRI_T3M_HS.ies	12630	0.95	134.5029	
S3	2	Lithonia Lighting	DSX2 LED P1 35K 80CRI T3M EG5	D-Series Size 2 Area Luminaire P1 Performance Package 3500K CCT 80 CRI Type 3 Medium External Glare Shield	1	DSX2_LED_P1_35K_80CRI_T3M_EG5.ies	11479	0.95	134.5029	
S4	1	Lithonia Lighting	DSX2 LED P1 35K 80CRI BLCA	D-Series Size 2 Area Luminaire P1 Performance Package 3500K CCT 80 CRI Type 4 Extreme Backlight Control	1	DSX2_LED_P1_35K_80CRI_BLCA.ies	13164	0.95	134.5	
S5	2	Lithonia Lighting	DSX2 LED P1 35K 80CRI T3M	D-Series Size 2 Area Luminaire P1 Performance Package 3500K CCT 80 CRI Type 5 Wide	1	DSX2_LED_P1_35K_80CRI_T3M.ies	18594	0.95	134.5	
F1	8	KICHLER	208377-1 MOOR-11251/CP13537	LED WALL CYLINDER	1	11251-photometric-report.ies	574	0.95	14.7	
F2	14	Indy	LA 28LM 27K MVOLT G4 90CRI 2T WID CSS	INDY 4" DIA. 1-LED 4000LM, 90CRI, GENE DOUBLE WALL WASH WITH CLEAR SEMI-SPECULAR (CSS) PARABOLIC REFLECTOR, OFF-USE KICKERS AND FROSTED CONVEX GLASS LENS	1	LA_28LM_27K_MVOLT_G4_90CRI_2T_WID_CSS.ies	1590	0.95	28.46	
F3	1	Lithonia Lighting	WDG61 LED P1 30K 90CRI VW	WDG61 LED WITH P1 - PERFORMANCE PACKAGE 3000K, 90CRI, VISUAL COMFORT WIDE OPTIC	1	WDG61_LED_P1_30K_90CRI_VW.ies	1030	0.95	10.0002	

Description	Symbol	Avg	Max	Min	Max/Min	Avg/Min
BLDG ENTRY 2	+	17.4 fc	19.3 fc	13.6 fc	1.4:1	1.3:1
DRIVE THRU ENTRY	x	15.4 fc	26.5 fc	8.9 fc	3.0:1	1.7:1
DRIVE THRU WINDOW	x	30.0 fc	30.0 fc	30.0 fc	1.0:1	1.0:1
PARKING & SIDEWALKS	x	4.1 fc	15.0 fc	1.5 fc	10.0:1	2.7:1
PAVING	x	14.3 fc	21.0 fc	10.0 fc	1.9:1	1.3:1
PROPERTY LINE	+	0.2 fc	0.6 fc	0.0 fc	N/A	N/A
SERVICE DOOR	x	9.4 fc	9.4 fc	9.4 fc	1.0:1	1.0:1
STARBUCKS	x	6.3 fc	30.0 fc	1.0 fc	30.0:1	6.2:1
BLDG ENTRY 1	x	21.0 fc	21.0 fc	21.0 fc	1.0:1	1.0:1

- ### GENERAL NOTES
- ALL EXTERIOR LIGHTING, WHETHER FREE-STANDING OR MOUNTED ON A STRUCTURE, SHALL BE FULL-CUTOFF.
 - THE TOWNSHIP RESERVES THE RIGHT TO CONDUCT A POST-INSTALLATION NIGHT TIME INSPECTION TO VERIFY COMPLIANCE WITH TOWNSHIP LIGHTING STANDARDS. IF SAID INSPECTION REVEALS A VIOLATION OF SAID STANDARDS, THE TOWNSHIP SHALL DIRECT CORRECTIVE ACTION, WHICH SHALL BE EXECUTED BY THE PROPERTY OWNER AT NO EXPENSE TO THE TOWNSHIP.
 - POST-APPROVAL ALTERATIONS TO LIGHTING PLANS OR SUBSTITUTIONS FOR APPROVED LIGHTING EQUIPMENT SHALL BE SUBMITTED TO THE TOWNSHIP FOR REVIEW AND APPROVAL PRIOR TO CONSTRUCTION OR INSTALLATION.
 - LIGHTING SHALL BE CONTROLLED BY TIME CLOCK / PHOTOCELL THAT TURN OFF LIGHTS ONE HOUR AFTER CLOSE OF BUSINESS (10 P.M.)
 - CALCULATIONS ARE BASED ON FIXTURE TYPE SCHEDULED. IF FIXTURE OTHER THAN THOSE SPECIFIED IS PROVIDED THE MANUFACTURER SHALL PROVIDE A DETAILED POINT BY POINT CALCULATION TO VERIFY COMPLIANCE WITH LOCAL STREET LIGHTING GUIDELINES.

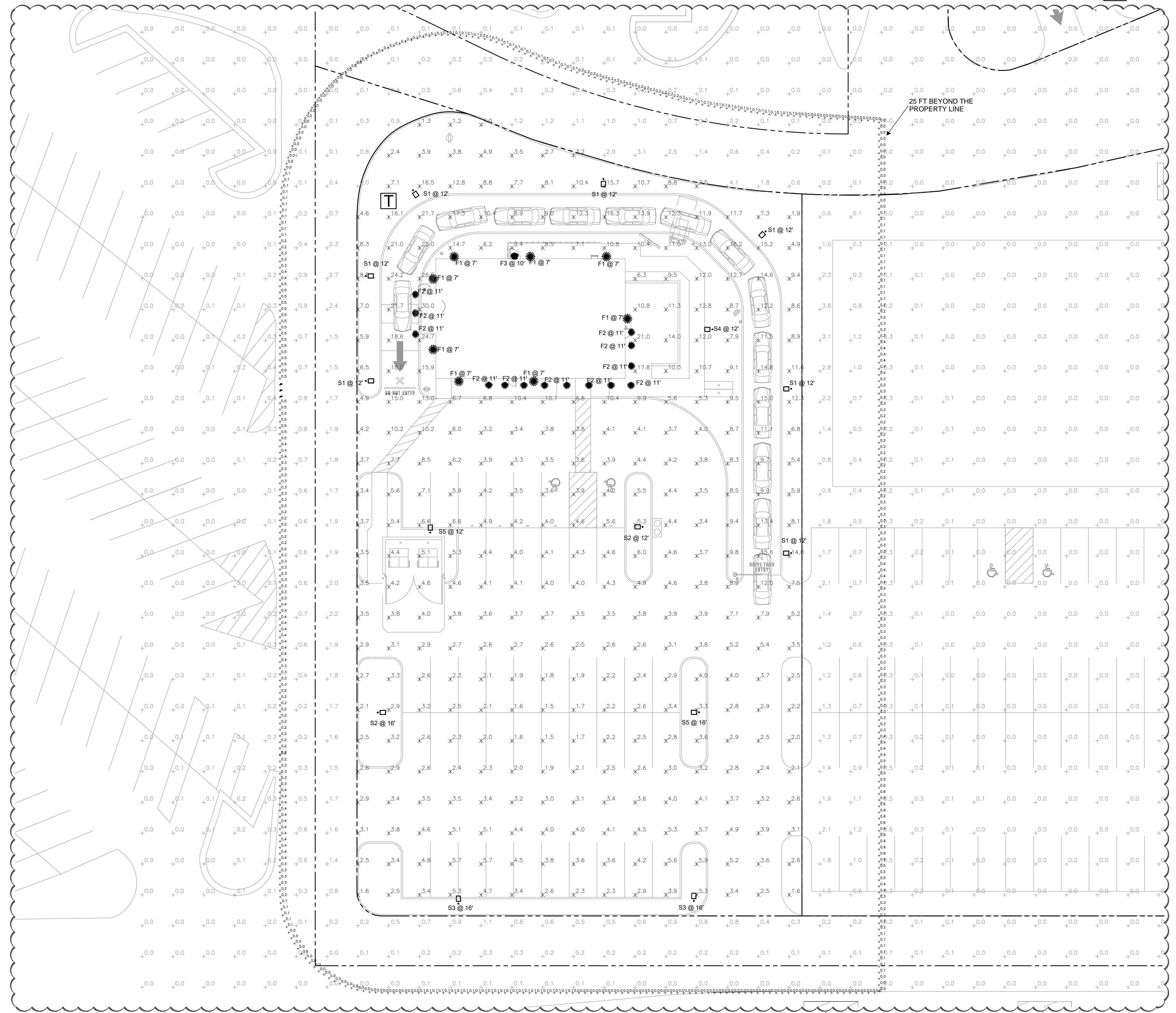

1 ELECTRICAL SITE PLAN
 1" = 20'-0"
 ELECTRICAL

GMX REAL ESTATE GROUP, LLC
 NEW CONSTRUCTION
 3900 STATE HWY 16 - LOT 2, LA CROSSE, WI 54601

DATE	SUBMITTED FOR
10/3/23	TENANT REVIEW
05/08/24	TENANT COMMENTS
06/18/24	TENANT COMMENTS
07/30/24	TENANT COMMENTS

SHEET TITLE
PHOTOMETRIC SITE PLAN

DRAWN BY:
AB/MM
JOB NO.
3140.a

SHEET
ES1.1

rtm engineering consultants
 850 E. Algonquin Road, Suite 250, Schaumburg, IL 60173
 rtmec.com | 847.756.4180