

**REQUEST TO AMEND PREMISES DESCRIPTION**

License Fee: \$100.00

Invoice No.: \_\_\_\_\_

TYPE OF LICENSE (check all that apply):

Combination "Class B" Beer & Liquor  
 Class "B" Beer  
 "Class C" Wine

Class "A" Beer  
 Class "A" Beer & "Class A" Liquor

To the Common Council of the City of La Crosse:

The undersigned licensee requests to amend its premises description at the address described below pursuant to Secs. 4-51 and 4-115 of the Code of Ordinances for the City of La Crosse.

Licensee Legal/Real Name: People's Food Cooperative INC

Trade Name (DBA): People's Food Co-op/Hackberry's

Address of Licensed Premises: 315 5th Ave S La Crosse WI 54601

Name of Agent: Carly Jacqueline Petrusky

Agent Daytime Phone Number: 608-784-5798

Name of Contact Person (if someone other than Agent): \_\_\_\_\_

Contact Person Daytime Phone Number: \_\_\_\_\_

Description of Proposed Change (include detailed floor plan): Adding two designated parking stalls to function as a curbside delivery of alcohol beverages and grocery items. See attached drawing of entire premises with areas designated for the pickup program.

**Proposed Premise Description**

Sales/Service: The furthest two northwest parking stalls

Storage: Storage is on retail shelves on first floor and secure locked area on the first floor of the retail store, and on the shelves behind the bar on second floor.

Lisa White  
(Authorized Signature)

4/16/2020  
(Date)

**\*\*\*\*A DETAILED FLOOR PLAN MUST ACCOMPANY THIS APPLICATION\*\*\*\***

Note: Before sales, service or consumption can occur in any new area, the premise must be inspected and a new license issued with the new premise description.

**FOR OFFICE USE ONLY**

Date Filed with Clerk: \_\_\_\_\_ Date Routed: \_\_\_\_\_ Date Granted: \_\_\_\_\_



## People's Food Co-op

### Curbside Pick Up of Wine, Beer, and Spirits Department

#### Placing the order:

Orders will be placed on-line through People's Food Co-op's Curbside Pick Up site.

Online grocery orders will be paid and processed in a separate transaction before the customer arrives at the store.

Beer, Wine, and Spirits Department orders will be paid at the time of pick up using a handheld device. After adding a Wine, Beer, and Spirits order, customers will be asked the following questions: Name, DOB, Photo ID Type/ # / exp. Date, car type (make/model), License plate #.

#### Pick up, verification, and payment:

Wine, Beer, and Spirits payment and delivery will take place at the customer's car in one of the two designated Curbside parking spaces located in the People's Food Co-op Parking Lot.

#### At the designated time of pick up, a licensed beverage operator will:

- Bring the order out to the car
- check the photo ID
- verify the customer information entered at time of purchase through the Google Form (name, age, photo Id type/#/exp, car type, license plate #)
- take a picture of the vehicle with the license plate
- accept payment from the customer via handheld card reader with a Square App.
- Load product into the car
- Staple detailed register receipt with detailed description of Wine, Beer, and Spirits order will be stapled directly to the order sheet
- If the person who placed and is picking up the order is not the driver of the vehicle. The driver of the vehicle will also be carded and if they are not at least 21 years of age, the sale will be denied.
- If the driver of the vehicle is underage or appears intoxicated, the sale will be denied, and police will be notified.

Documentation will be saved for at least 30 days.

People's Food Co-op Curbside Pick Up is not same day service (currently next day or the day after)- orders will not be filled until at least one day after they are placed.

Curbside Pick Up for alcohol will only be allowed between the hours of 9 am and 6 pm.

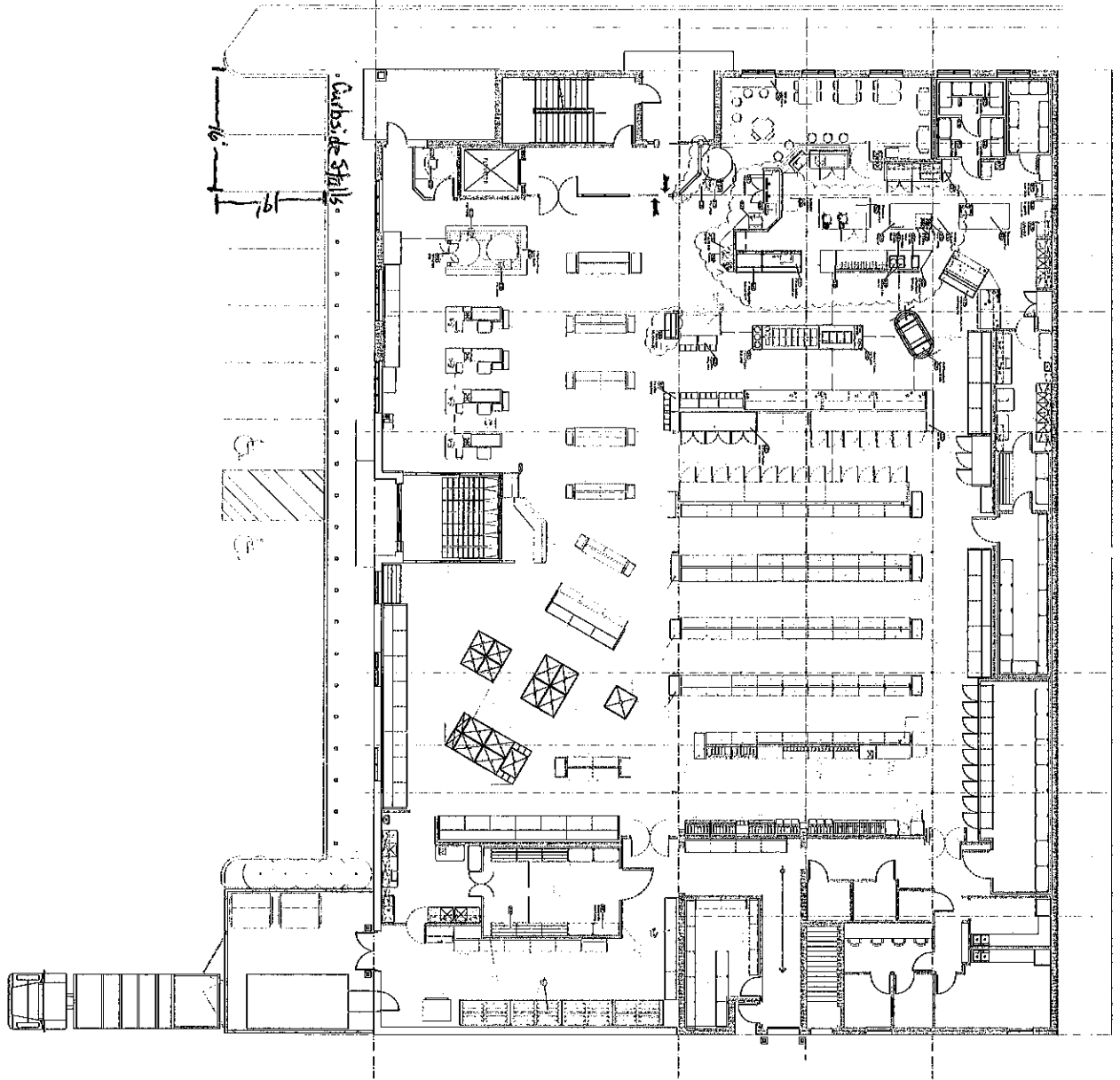

**People's Food  
Co-op  
La Crosse, WI**

**NOT TO BE USED IN  
CONSTRUCTION**

This document is a preliminary drawing and is not to be used for construction. It is subject to change without notice. The client is responsible for providing accurate information and for obtaining all necessary permits. The architect is not responsible for any errors or omissions in this drawing. The client is responsible for obtaining all necessary permits. The architect is not responsible for any errors or omissions in this drawing.

**NEC Development Corporation**  
2615 Liberty Avenue, Suite 210  
La Crosse, WI 54601  
Tel: 608/785-1111

**ARCHITECT: JAMES H. HANCOCK, INC.**  
2000 Wisconsin Avenue, Suite 200  
La Crosse, WI 54601  
Tel: 608/785-1111

**FINAL  
FIXTURE  
PLAN**

Date: 04/20/18  
Drawn By: LJP  
Scale: 1/8" = 1'-0"

**FP1.0**

People's  
FOOD CO-OP

OVERFLOW  
PARKING →

THIS SPOT  
RESERVED FOR  
CURBSIDE  
PICK UP

THIS SPOT  
RESERVED FOR  
CURBSIDE  
PICK UP

OPEN

