

**CONSTRUCTION NOTE:**  
BURY CABLE AT A MINIMUM OF 36" DEPTH  
UNLESS OTHERWISE NOTED ON PRINTS.

**CONSTRUCTION NOTE:**  
CHARTER COMMUNICATIONS WILL PLACE  
PROPOSED CABLES IN CORRIDOR AS CLOSE TO  
THE BACK OF RIGHT-OF-WAY AS POSSIBLE,  
PENDING LOCATES.

**LEGEND**

TB : TREE BORE(DIRECTIONAL BORE)  
RB : ROAD BORE (DIRECTIONAL BORE)  
T : TRENCH  
HD : HAND DIG  
P : PLOW

**CHARTER COMMUNICATIONS PROPOSES  
TO BURY FIBER COMMUNICATION CABLE  
IN A 2" CONDUIT**

--- FIBER CABLE

⊕ = **POTHOLE  
UTILITIES**

**CONSTRUCTION NOTE:**  
**POTHOLE WHERE  
NECESSARY AND ADJUST  
DEPTH ACCORDINGLY**

THE UTILITIES SHOWN ON THIS PLAN ARE  
INDICATED IN ACCORDANCE WITH AVAILABLE  
RECORDS. THE CONTRACTOR SHALL BE  
RESPONSIBLE FOR OBTAINING EXACT  
LOCATIONS AND ELEVATIONS OF ALL UTILITIES  
FROM THE OWNERS OF THE RESPECTIVE  
UTILITIES AND FROM FIELD VERIFICATION.

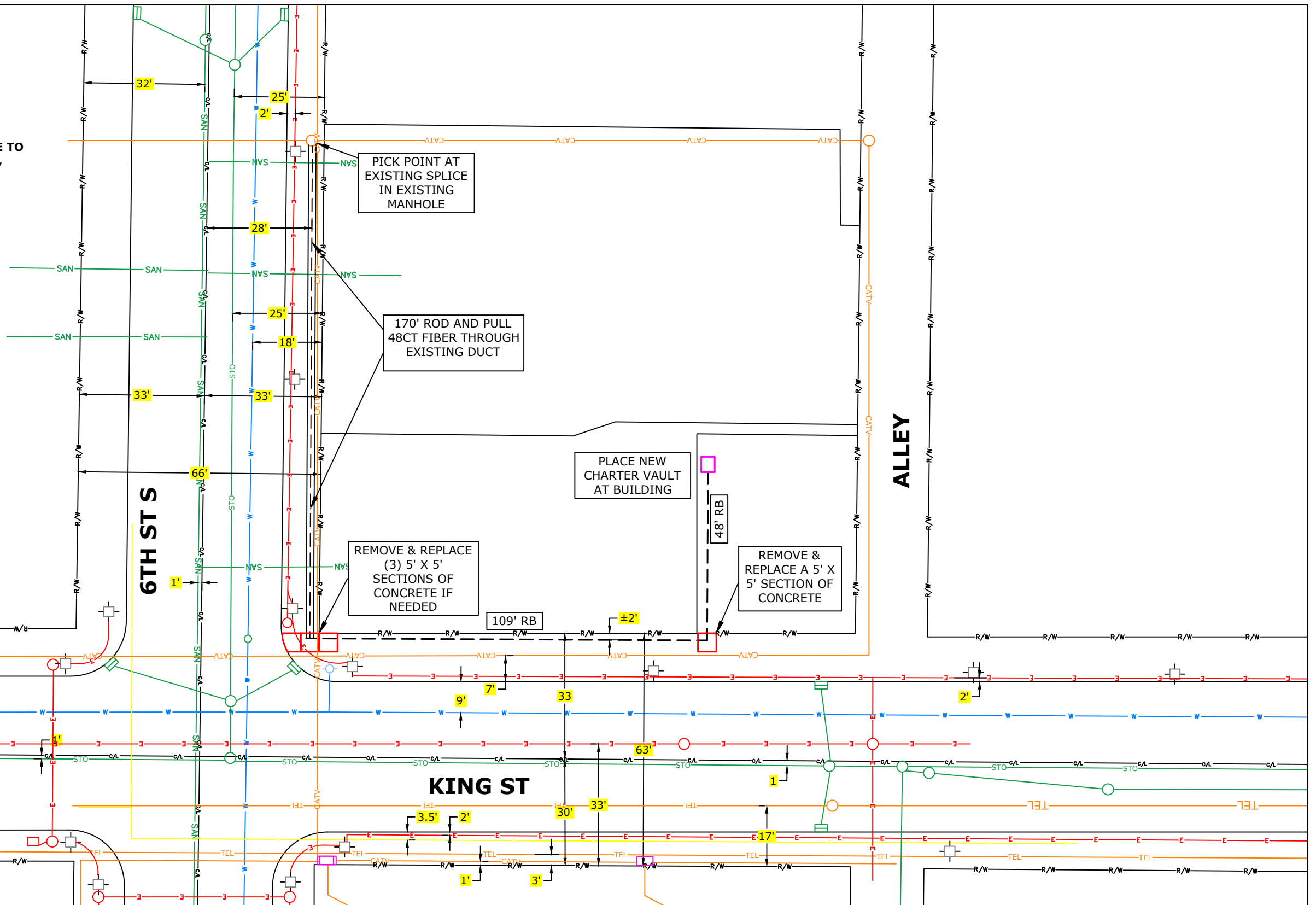

(920)465-8018  
GREEN BAY, BROWNSVILLE,  
NEW BERLIN & MINNEAPOLIS

**LEGEND**

- |                      |                  |                     |                    |
|----------------------|------------------|---------------------|--------------------|
| ⊕ JOINT POLE         | ANCHOR           | MANHOLE             | GROUND             |
| ⊕ NEW JOINT POLE     | NEW ANCHOR       | EXISTING FIBER COIL | NEW GROUND         |
| ⊕ POWER POLE         | JOINT ANCHOR     | 100' NEW FIBER COIL | PROPERTY LINE      |
| ⊕ NEW POWER POLE     | NEW JOINT ANCHOR | EXISTING HAND HOLE  | ROADWAY CENTERLINE |
| ⊕ TELEPHONE POLE     | FOREIGN ANCHOR   | NEW HAND HOLE       | FIBER WARNING SIGN |
| ⊕ NEW TELEPHONE POLE | DOWNGUY          | SHRUBS              | TRAFFIC LIGHT      |
| ⊕ EXISTING PEDESTAL  | NEW DOWNGUY      | DECIDUOUS TREE      | HYDRANT            |
| ⊕ NEW PEDESTAL       | UTILITY VALVE    |                     | SIGNS              |
|                      |                  |                     | STREET LIGHT       |
|                      |                  |                     | CONIFEROUS TREE    |

**LINETYPES**

- |                 |     |
|-----------------|-----|
| PROPOSED FIBER  | --- |
| PROPOSED STRAND | --- |
| GAS             | --- |
| WATER           | --- |
| ELECTRICAL      | --- |
| STORM           | --- |
| SANITARY        | --- |
| CABLE TV        | --- |
| TELEPHONE       | --- |

PROJECT #2923993  
PERMIT ID #2923993CITY



1228 12TH AVE S  
ONALASKA, WI 54650



**ADDRESS**

149 6TH ST S

FIELD BY: \_\_\_\_\_

DATE: \_\_\_\_\_

DRAFTED BY: \_\_\_\_\_

DATE: 9/21/2021

DESIGNED BY: \_\_\_\_\_

DATE: \_\_\_\_\_

ASBUILTS BY: \_\_\_\_\_

DATE: \_\_\_\_\_

**LOCATION**

LA CROSSE, WI