

# WM GOHRES ADDITION BLOCK 8

N  
↑  
↓  
N

SCALE: 1"=20' H  
1"= 2' V

ELEVATIONS SHOWN  
ARE NAVD 1988

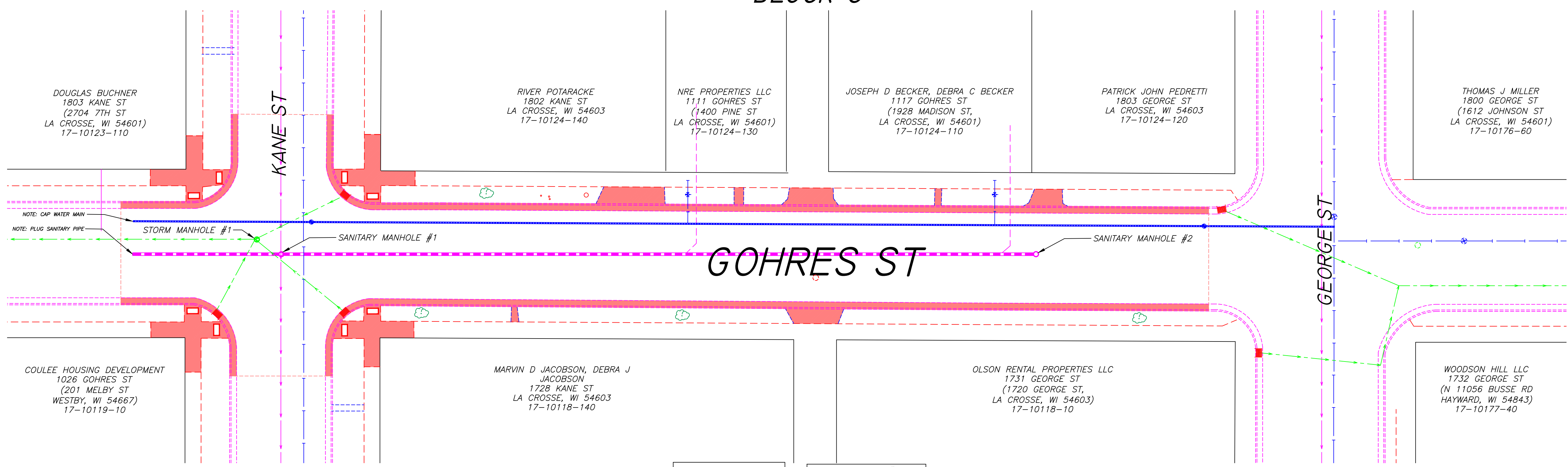

**NOTE**  
CONTRACTOR IS TO VERIFY LOCATION OF ALL UTILITIES PRIOR TO ANY CONSTRUCTION

**SANITARY MANHOLE #1**  
NOTE: REPLACE EXISTING  
48" DIAMETER  
STA. 1+06  
RIM 652.118  
INV. N 642.87  
INV. E 642.97  
INV. S 642.92  
INV. W 642.97

**STORM MANHOLE #1**  
NOTE: REPLACE EXISTING  
48" DIAMETER  
STA. 0+98  
RIM 652.05  
INV. E 646.97  
INV. W 646.96  
INV. S 646.94  
INV. SE 647.07

**SANITARY MANHOLE #2**  
NOTE: NEW  
48" DIAMETER  
STA. 3+72  
RIM 652.3  
INV. W 644.03

**BENCHMARKS**  
TOP NUT OF HYDRANT  
GOHRES ST & GEORGE ST 655.12  
GOHRES ST & KANE ST 655.52

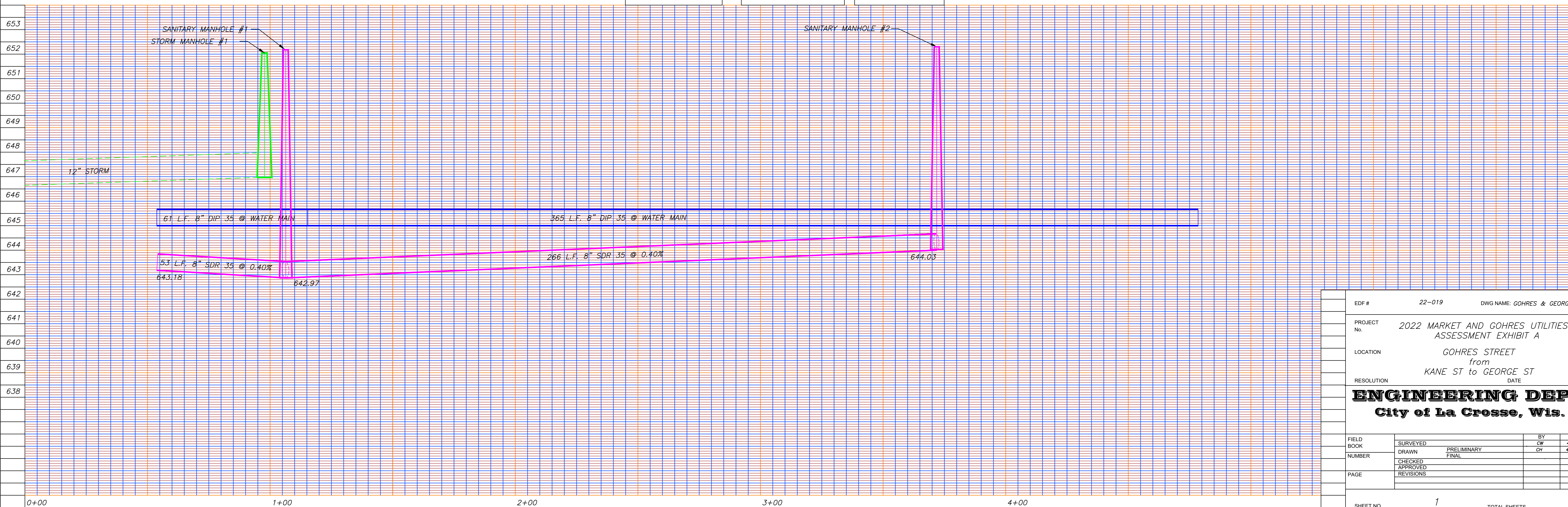

EDF #	22-019	DWG NAME:	GOHRES & GEORGE ST.dwg
PROJECT No.	2022 MARKET AND GOHRES UTILITIES ASSESSMENT EXHIBIT A		
LOCATION	GOHRES STREET from KANE ST to GEORGE ST		
RESOLUTION	DATE		
<b>ENGINEERING DEPT.</b> City of La Crosse, Wis.			
FIELD BOOK	SURVEYED	BY	DATE
NUMBER	DRAWN	CW	4/14/2022
PAGE	CHECKED	CH	4/14/2022
	APPROVED		
	REVISIONS		
SHEET NO.	1	TOTAL SHEETS	1