

# DURATECH INDUSTRIES BUILDING ADDITION

LA CROSSE, WISCONSIN

ISG PROJECT # 16-18735



2 NORTHEAST AERIAL PERSPECTIVE

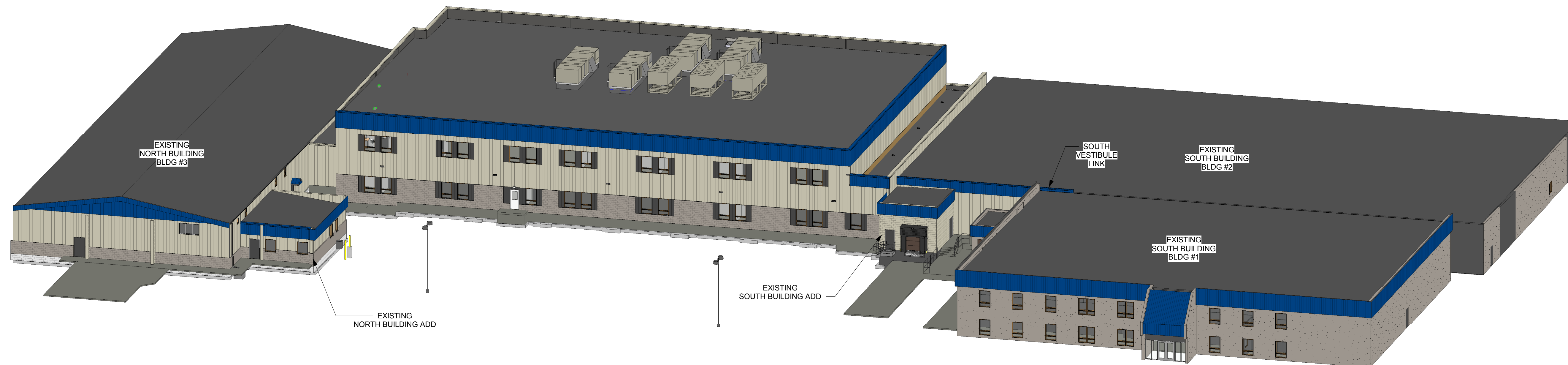

1 SOUTHWEST AERIAL PERSPECTIVE

### PROJECT GENERAL NOTES

- ALL WORK SHALL CONFORM TO THE CONTRACT DOCUMENTS, WHICH INCLUDE, BUT ARE NOT LIMITED TO, THE OWNER-CONTRACTOR AGREEMENT, THE PROJECT MANUAL (WHICH INCLUDES GENERAL AND SUPPLEMENTARY CONDITIONS AND SPECIFICATIONS), DRAWINGS OF ALL DISCIPLINES AND ALL ADDENDA, MODIFICATIONS AND CLARIFICATIONS ISSUED BY THE ARCHITECT/ENGINEER.
- CONTRACT DOCUMENTS SHALL BE ISSUED TO ALL SUBCONTRACTORS BY THE GENERAL CONTRACTOR IN COMPLETE SETS IN ORDER TO ACHIEVE THE FULL EXTENT AND COMPLETE COORDINATION OF ALL WORK. CONTRACTOR IS RESPONSIBLE FOR COORDINATING AND CORRELATING QUANTITIES AND DIMENSIONS.
- WRITTEN DIMENSIONS TAKE PRECEDENCE OVER SCALED DIMENSIONS. NOTIFY ARCHITECT/ENGINEER OF ANY DISCREPANCIES OR CONDITIONS REQUIRING INFORMATION OR CLARIFICATION BEFORE PROCEEDING WITH THE WORK.
- FIELD VERIFY ALL EXISTING CONDITIONS AND DIMENSIONS. NOTIFY ARCHITECT/ENGINEER OF ANY DISCREPANCIES OR CONDITIONS REQUIRING INFORMATION OR CLARIFICATION BEFORE PROCEEDING WITH THE WORK.
- DETAILS SHOWN ARE INTENDED TO BE INDICATIVE OF THE PROFILES AND TYPE OF DETAILING REQUIRED THROUGHOUT THE WORK. DETAILS NOT SHOWN ARE SIMILAR IN CHARACTER TO DETAILS SHOWN, WHERE SPECIFIC DIMENSIONS, DETAILS OR DESIGN INTENT CANNOT BE DETERMINED, NOTIFY ARCHITECT/ENGINEER BEFORE PROCEEDING WITH THE WORK.
- ALL MANUFACTURED ARTICLES, MATERIALS AND EQUIPMENT SHALL BE APPLIED, INSTALLED, CONNECTED, ERECTED, CLEANED AND CONDITIONED ACCORDING TO MANUFACTURERS' INSTRUCTIONS. IN CASE OF DISCREPANCIES BETWEEN MANUFACTURERS' INSTRUCTIONS AND THE CONTRACT DOCUMENTS, NOTIFY ARCHITECT/ENGINEER BEFORE PROCEEDING WITH THE WORK.
- LARGE-SCALE, MORE SPECIFIC DETAILS TAKE PRECEDENCE OVER SMALLER-SCALE, LESS SPECIFIC DETAILS AND INFORMATION. MORE STRINGENT REQUIREMENTS FOR CODE, PRODUCTS AND INSTALLATION TAKE PRECEDENCE OVER LESS STRINGENT REQUIREMENTS. NOTIFY ARCHITECT/ENGINEER OF ANY DISCREPANCIES OR CONDITIONS REQUIRING INFORMATION OR CLARIFICATION BEFORE PROCEEDING WITH THE WORK.
- PROVIDE CONTINUOUS SEALANT AROUND ALL MATERIALS AT EXTERIOR WALL PENETRATIONS. REFER TO SPECIFICATIONS FOR APPROPRIATE SEALANT.
- ALL DISSIMILAR METALS SHALL BE EFFECTIVELY ISOLATED FROM EACH OTHER TO AVOID GALVANIC CORROSION.
- SEAL ALL OPENINGS IN WALLS, FLOORS, CEILING, AND ROOFS, AROUND DUCTS, PIPES, VENTS, TRAPS, CONDUIT AND ALL OTHER PENETRATIONS WITH FIRESTOPPING AS SPECIFIED AND REQUIRED BY CODES.
- PROVIDE TEMPORARY WALLS, ENCLOSURES, DUST SHIELDS AND WALK-OFF MATS AS REQUIRED TO SEPARATE DEMOLITION AND CONSTRUCTION FROM EXISTING BUILDING.
- PROVIDE BRACING AND SHORING AS REQUIRED TO PROTECT EXISTING STRUCTURE TO REMAIN. PROVIDE SECURE AND WEATHERPROOF ENCLOSURE OF TEMPORARY OPENINGS IN EXTERIOR WALLS. PROTECT ALL BUILDING COMPONENTS FROM DAMAGE DURING DEMOLITION AND CONSTRUCTION.
- RESTORE ALL EXISTING AREAS AFFECTED BY DEMOLITION AND RELATED NEW CONSTRUCTION TO THEIR ORIGINAL CONDITION, INCLUDING BUT NOT LIMITED TO WALLS, FLOORS, AND CEILING AND THEIR ASSOCIATED FINISHES.
- PROVIDE SOLID WALL BACKING WITH METAL OR FIRE-RETARDANT WOOD BLOCKING BEHIND DOOR HARDWARE SUCH AS WALL STOPS, BUMPERS, HOLD OPENS, ETC.

### SHEET INDEX

SHEET #	SHEET TITLE
TITLE	
T1-11	TITLE SHEET, SHEET INDEX, PROJECT GENERAL NOTES
T1-12	MOUNTING HEIGHTS AND STANDARDS, ABBREVIATIONS AND SYMBOLS
T1-21	CODE DATA AND FIRST FLOOR CODE DATA PLAN
T1-22	SECOND FLOOR CODE DATA PLAN
CIVIL	
C0-10	SPECIFICATIONS & NOTES
C0-20	SITE DETAILS
C0-21	SITE DETAILS
C0-22	SITE DETAILS
C1-10	EROSION CONTROL PLAN - EXISTING CONDITIONS
C1-20	EROSION CONTROL PLAN - PROPOSED CONDITIONS
C1-30	EROSION CONTROL PLAN NOTES & DETAILS
C2-10	EXISTING SITE REMOVAL PLAN
C3-10	PROPOSED SITE PLAN
C3-20	PROPOSED SITE UTILITY PLAN
C4-10	GRADING PLAN
C5-10	SITE RESTORATION PLAN
C6-10	SITE ELECTRICAL PLAN
ARCHITECTURAL	
A1-01	INTERIOR PARTITION WALL TYPES, PARTITION NOTES
A1-11	DEMOLITION PLANS
A1-21	FIRST FLOOR PLANS
A1-22	SECOND FLOOR PLAN, ROOF PLAN
A1-31	REFLECTED CEILING PLANS
A1-41	FLOOR AND WALL FINISH PLANS
A1-42	FINISH SCHEDULES, DOOR SCHEDULE, DOOR AND FRAME TYPES
A1-51	FURNITURE AND EQUIPMENT PLANS
A1-71	ROOF DETAILS
A1-72	ROOF DETAILS
A2-11	EXTERIOR ELEVATIONS
A2-12	EXTERIOR ELEVATIONS
A3-11	BUILDING SECTIONS
A3-21	WALL SECTIONS
A3-22	WALL SECTIONS
A3-23	WALL SECTIONS
A3-24	WALL SECTIONS
A3-25	WALL SECTIONS
A3-26	WALL SECTION DETAILS
A5-11	ENLARGED RESTROOM PLANS AND ELEVATIONS
A7-11	STAIR A PLANS, SECTIONS
A7-12	STAIR B, C, D PLANS, SECTIONS
A7-13	RAMP PLAN, STAIR DETAILS
STRUCTURAL	
S1-00	STRUCTURAL NOTES
S1-01	SCHEDULES
S1-11	FOOTING AND FOUNDATION PLAN
S1-12	FIRST FLOOR CONCRETE SLAB & JOINT PLAN, SECOND FLOOR CONCRETE SLAB & JOINT PLAN
S1-13	FOUNDATION DETAILS
S1-14	FOUNDATION DETAILS
S1-15	FOUNDATION DETAILS
S1-21	SECOND FLOOR FRAMING PLAN, ROOF FRAMING PLAN
S1-41	FRAMING ELEVATIONS
S1-42	FRAMING ELEVATIONS
S1-43	FRAMING ELEVATIONS, PARTIAL ROOF FRAMING PLAN
S1-44	FRAMING DETAILS
S1-45	FRAMING DETAILS
S1-50	STAIR FRAMING PLANS AND DETAILS

WI DSPS BUILDING REVIEW SET  
02/01/2017

THIS DOCUMENT IS THE PROPERTY OF I & S GROUP, INC. AND MAY NOT BE USED, COPIED OR DUPLICATED WITHOUT PRIOR WRITTEN CONSENT.

PROJECT

## DURATECH INDUSTRIES BUILDING ADDITION

LA CROSSE WISCONSIN

REVISION SCHEDULE		
DATE	DESCRIPTION	BY

PROJECT NO.	16-18735
FILE NAME	18735 ARCH R17.RVT
DRAWN BY	CCS
DESIGNED BY	JPW
REVIEWED BY	NJE
ORIGINAL ISSUE DATE	02/01/2017
CLIENT PROJECT NO.	

TITLE

## TITLE SHEET, SHEET INDEX, PROJECT GENERAL NOTES

SHEET  
**T1-11**

### PROJECT INDEX:

<b>OWNER:</b> DURATECH INDUSTRIES 3216 COMMERCE STREET LA CROSSE, WISCONSIN 54603 PHONE: 608-781-2570	<b>PROJECT ADDRESS:</b> DURATECH INDUSTRIES 3216 COMMERCE STREET LA CROSSE, WISCONSIN 54603	<b>MANAGING OFFICE:</b>  LA CROSSE OFFICE 201 MAIN STREET SUITE 1020 LA CROSSE, WI 54601 PHONE: 608.789.2034 PROJECT MANAGER: NICK ELLENBERGER EMAIL: NICK.ELLENBERGER@IS-GRP.COM
---	--	---

REFERENCE SCALE  
0 1/4" = 1' - 0



WI DSPS BUILDING REVIEW SET  
02/01/2017

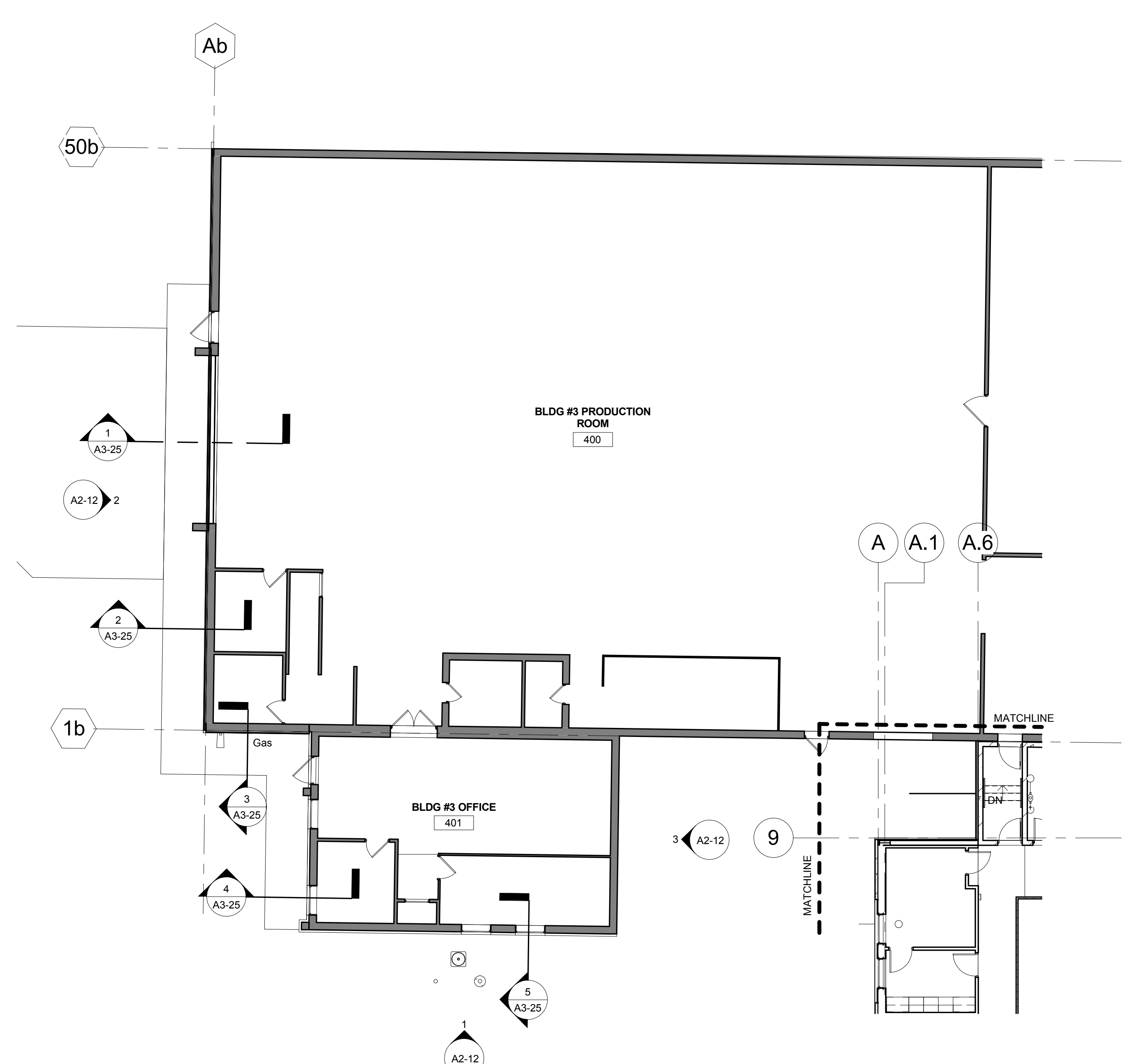

2 FLOOR PLAN - NORTH BUILDING  
3/32" = 1'-0"

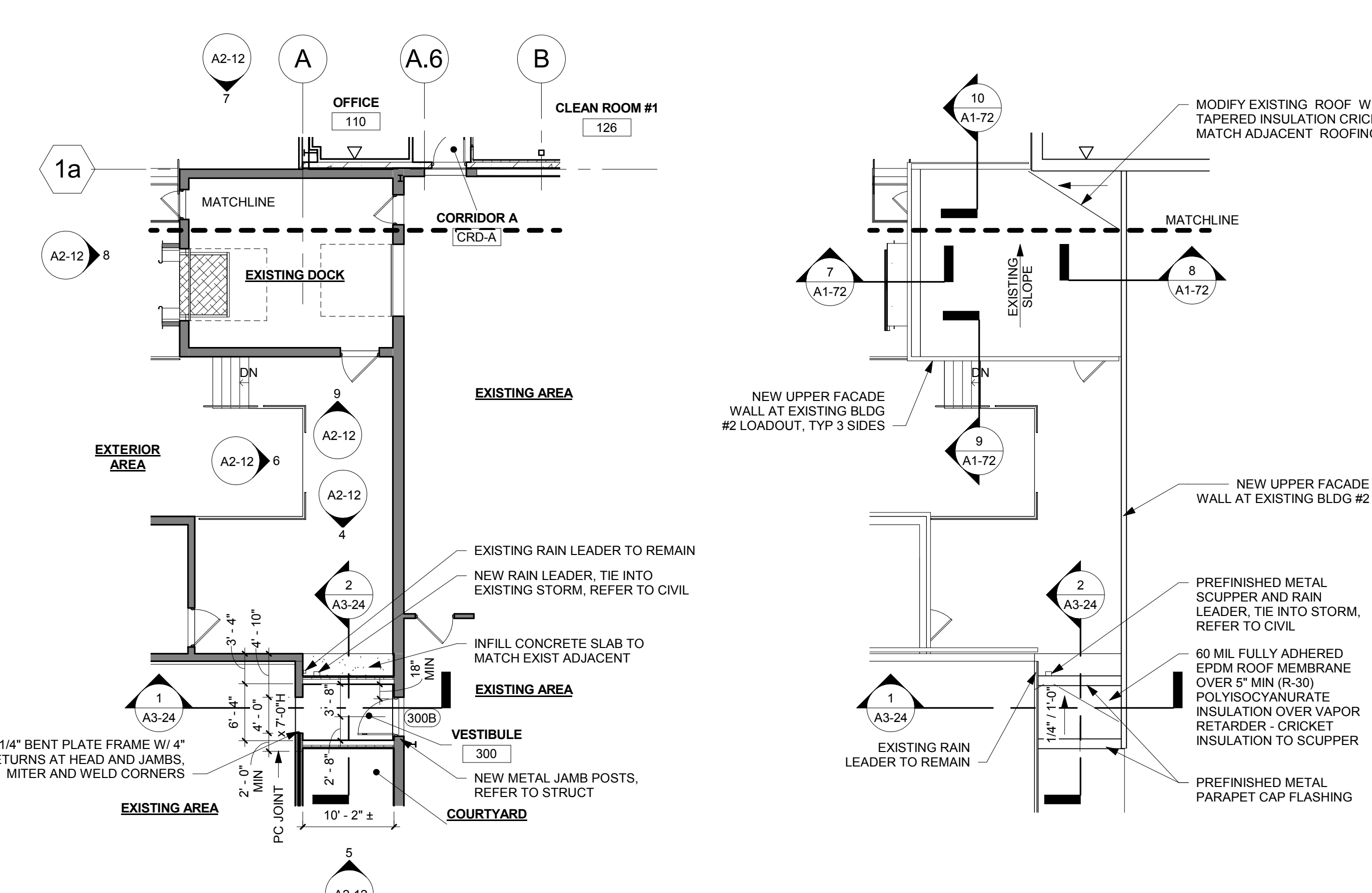

3 PARTIAL VESTIBULE FLOOR PLAN  
3/32" = 1'-0"

4 PARTIAL VESTIBULE ROOF PLAN  
3/32" = 1'-0"

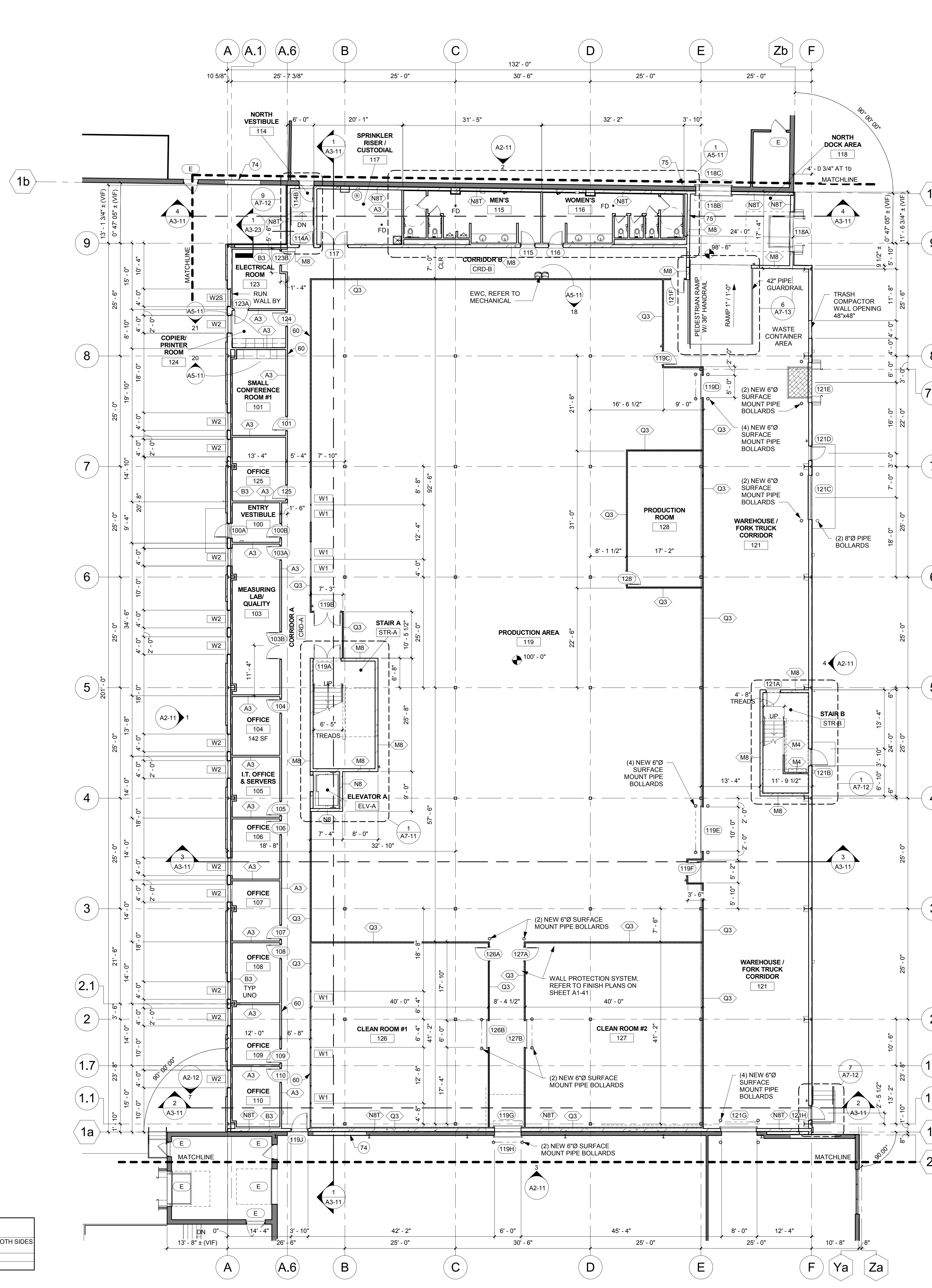

1 FIRST FLOOR PLAN  
3/32" = 1'-0"

WALL LEGEND		SHEET NOTES		KEYNOTE LEGEND	
	EXISTING CONSTRUCTION TO REMAIN	A.	ALL DIMENSIONS TO EXTERIOR WALLS ARE TO GRID LINE OR EXTERIOR FACE OF FOUNDATION WALL, TYPICAL UNO.	60	COMPOSITE WOOD CHAIR RAIL 5"x3/4" TOP OF RAIL 32" A.F.F., BOTH SIDES OF CORRIDOR A
	NEW CONSTRUCTION	B.	ALL DIMENSIONS TO CONCRETE OR NOMINAL MASONRY WALLS ARE TO FACE, TYPICAL UNO.	74	INFILL OPENING TO MATCH ADJACENT EXISTING STRUCTURE
		C.	ALL DIMENSIONS TO STUD FRAMED PARTITION WALLS ARE TO STUD CENTERLINE, TYPICAL UNO.	75	CONTROLS FOR POWER OPERATED DOOR
		D.	ALL DIMENSIONS FROM PLUMBING FIXTURES TO WALLS ARE FROM FUTURE CENTERLINE TO FINISH FACE OF ADJACENT WALL, TYPICAL UNO.		
		E.	ALL FURNITURE INDICATED IN THESE DOCUMENTS IS SHOWN FOR SPATIAL PLANNING AND REPRESENTATION ONLY. ALL FURNITURE SHALL BE PROVIDED BY OWNER, UNO.		

THIS DOCUMENT IS THE PROPERTY OF I & S GROUP, INC. AND MAY NOT BE USED, COPIED OR DUPLICATED WITHOUT PRIOR WRITTEN CONSENT.

PROJECT

### DURATECH INDUSTRIES BUILDING ADDITION

LA CROSSE WISCONSIN

REVISION SCHEDULE		
DATE	DESCRIPTION	BY

PROJECT NO. 16-18735  
 FILE NAME 18735 ARCH R17.RVT  
 DRAWN BY CCS  
 DESIGNED BY JPW  
 REVIEWED BY NJE  
 ORIGINAL ISSUE DATE 02/01/2017  
 CLIENT PROJECT NO.

TITLE

### FIRST FLOOR PLANS

SHEET  
**A1-21**

REFERENCE SCALE  
0 1/4" = 1'

- SHEET NOTES**
- A. ALL DIMENSIONS TO EXTERIOR WALLS ARE TO GRID LINE OR EXTERIOR FACE OF FOUNDATION WALL, TYPICAL UNO.
  - B. ALL DIMENSIONS TO CONCRETE OR NOMINAL MASONRY WALLS ARE TO FACE, TYPICAL UNO.
  - C. ALL DIMENSIONS TO STUD FRAMED PARTITION WALLS ARE TO STUD CENTERLINE, TYPICAL UNO.
  - D. ALL DIMENSIONS FROM PLUMBING FIXTURES TO WALLS ARE FROM FIXTURE CENTERLINE TO FINISH FACE OF ADJACENT WALL, TYPICAL UNO.
  - E. ALL FURNITURE INDICATED IN THESE DOCUMENTS IS SHOWN FOR SPATIAL PLANNING AND REPRESENTATION ONLY. ALL FURNITURE SHALL BE PROVIDED BY OWNER, UNO.



WISCONSIN BUILDING REVIEW SET  
02/01/2017

THIS DOCUMENT IS THE PROPERTY OF I & S GROUP, INC. AND MAY NOT BE USED, COPIED OR DUPLICATED WITHOUT PRIOR WRITTEN CONSENT.

PROJECT

**DURATECH INDUSTRIES BUILDING ADDITION**

LA CROSSE WISCONSIN

REVISION SCHEDULE		
DATE	DESCRIPTION	BY

PROJECT NO.	16-18735
FILE NAME	18735 ARCH R17.RVT
DRAWN BY	CCS
DESIGNED BY	JPW
REVIEWED BY	NJE
ORIGINAL ISSUE DATE	02/01/2017
CLIENT PROJECT NO.	

TITLE

**SECOND FLOOR PLAN, ROOF PLAN**

SHEET  
**A1-22**

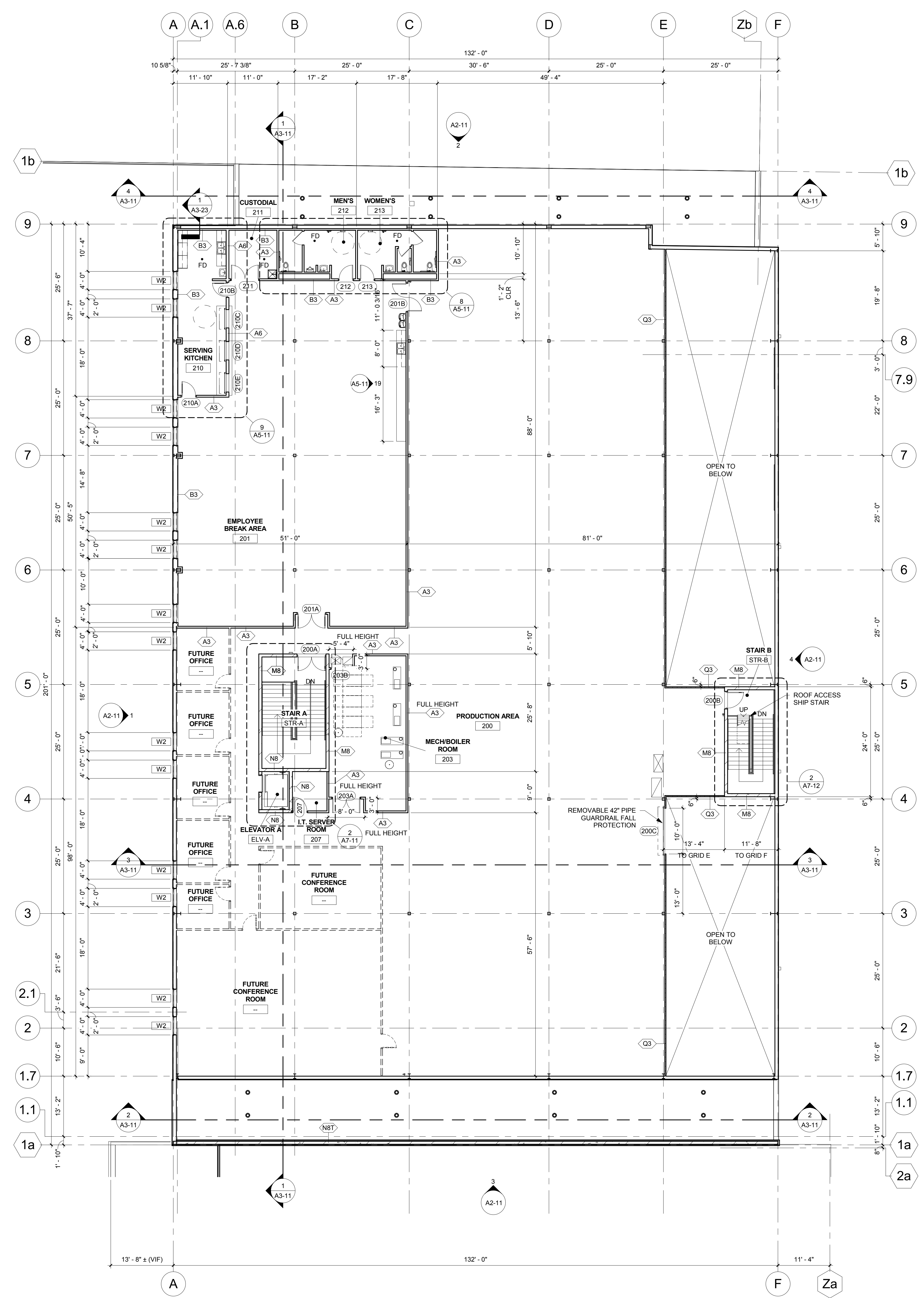

**1 SECOND FLOOR PLAN**  
3/32" = 1'-0"

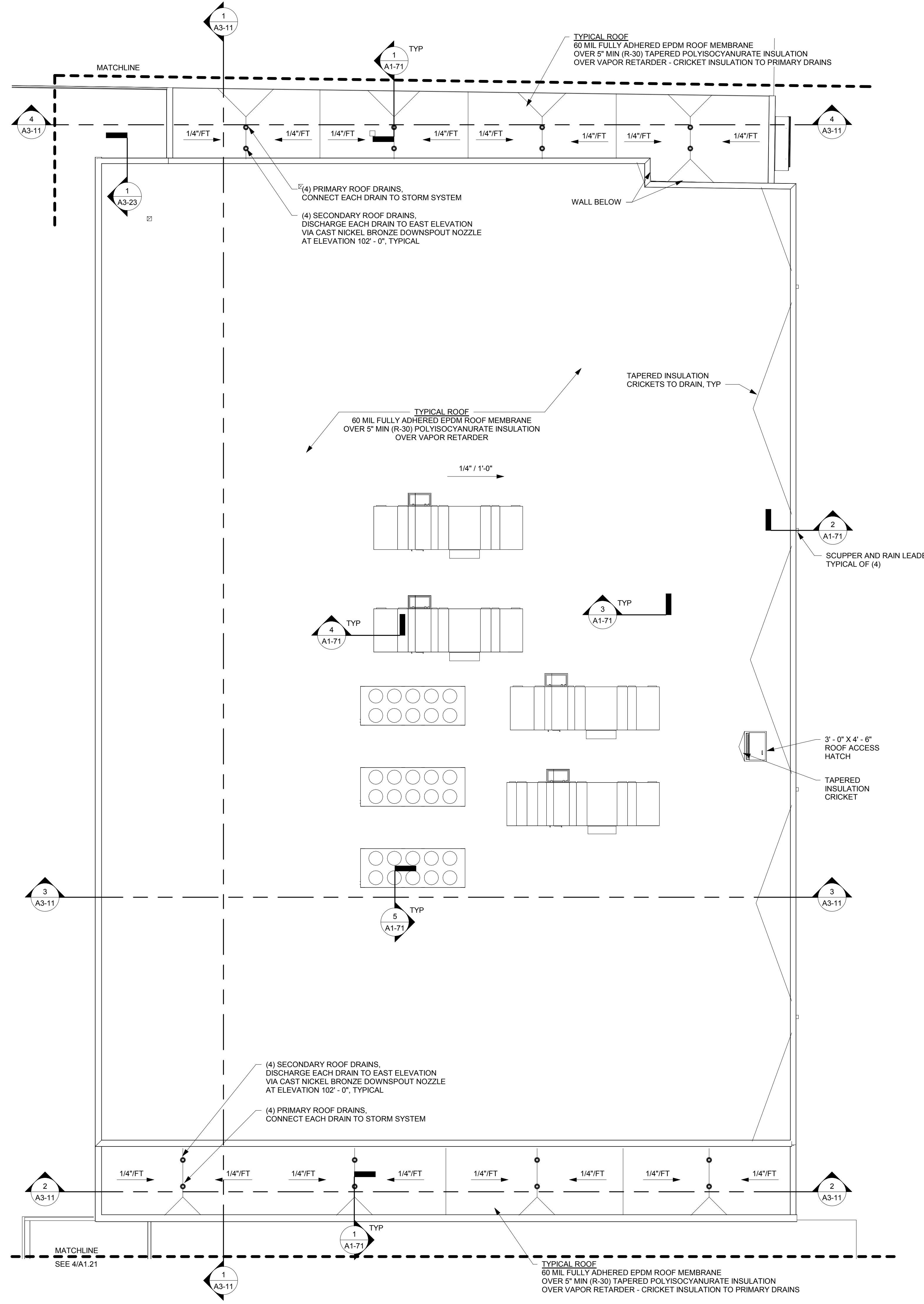

**2 ROOF PLAN**  
3/32" = 1'-0"

REFERENCE SCALE  
0 1/4" = 1'-0"



WI DSPS BUILDING REVIEW SET  
02/01/2017

EXTERIOR FINISH SCHEDULE						
MARK	MATERIAL	MFR	PRODUCT	SIZE	COLOR	COMMENTS
EF-2	CONCRETE MASONRY UNIT	TBD	TBD	4"x8"x16"	MATCH EXISTING	FLUTED FINISH
EF-3	PREFINISHED METAL WALL PANEL	CENTRIA	TR4-36	36" X 1 1/2"	TAUPE	
EF-4	PREFINISHED METAL WALL PANEL	METAL SALES	T10-D WALL	36" X 1 1/2"	REGAL BLUE	
EF-5	PREFINISHED METAL TRIM	FIRESTONE			TAUPE	
EF-6	PREFINISHED METAL TRIM	FIRESTONE			REGAL BLUE	
EF-7	PAINTED HOLLOW METAL DOOR AND FRAME	TBD	TBD	VARIES	MATCH ADJACENT	
EF-8	PREFINISHED METAL WALL PANEL	CENTRIA	TR4-36	36" X 1 1/2"	MATTE BLACK	
EF-11	PREFINISHED METAL RAIN LEADER				TAUPE	
EF-12	PREFINISHED METAL SCUPPER				TAUPE	
EF-13	PREFINISHED METAL GUTTER				TAUPE	
EF-14	SNOW GUARDS					INSTALL PER MFR RECOMMENDATIONS
EF-15	SPLASH BLOCK					
EF-17	CONCRETE FILLED STEEL PIPE BOLLARDS				SAFETY YELLOW	PRIME AND PAINT

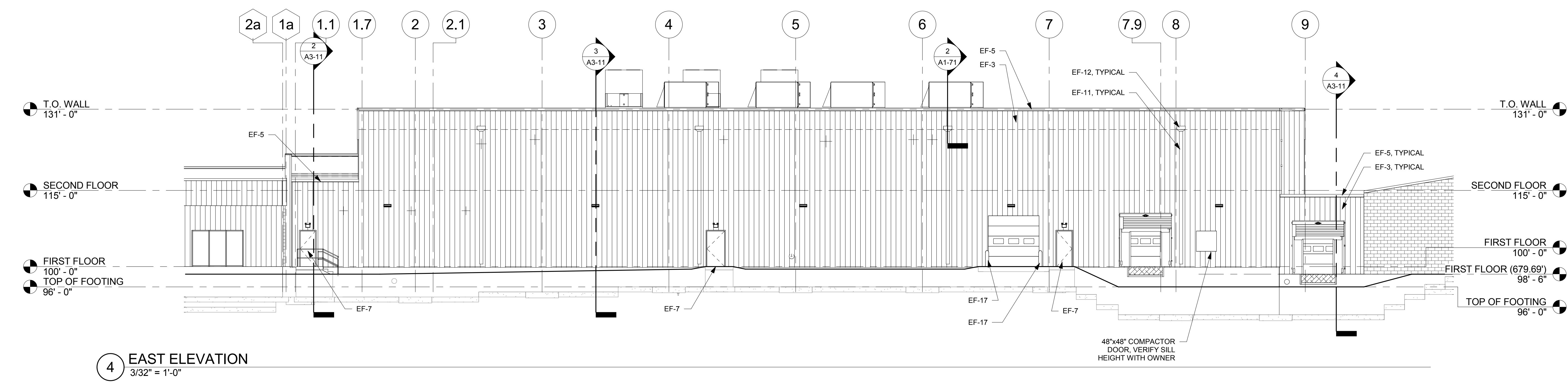
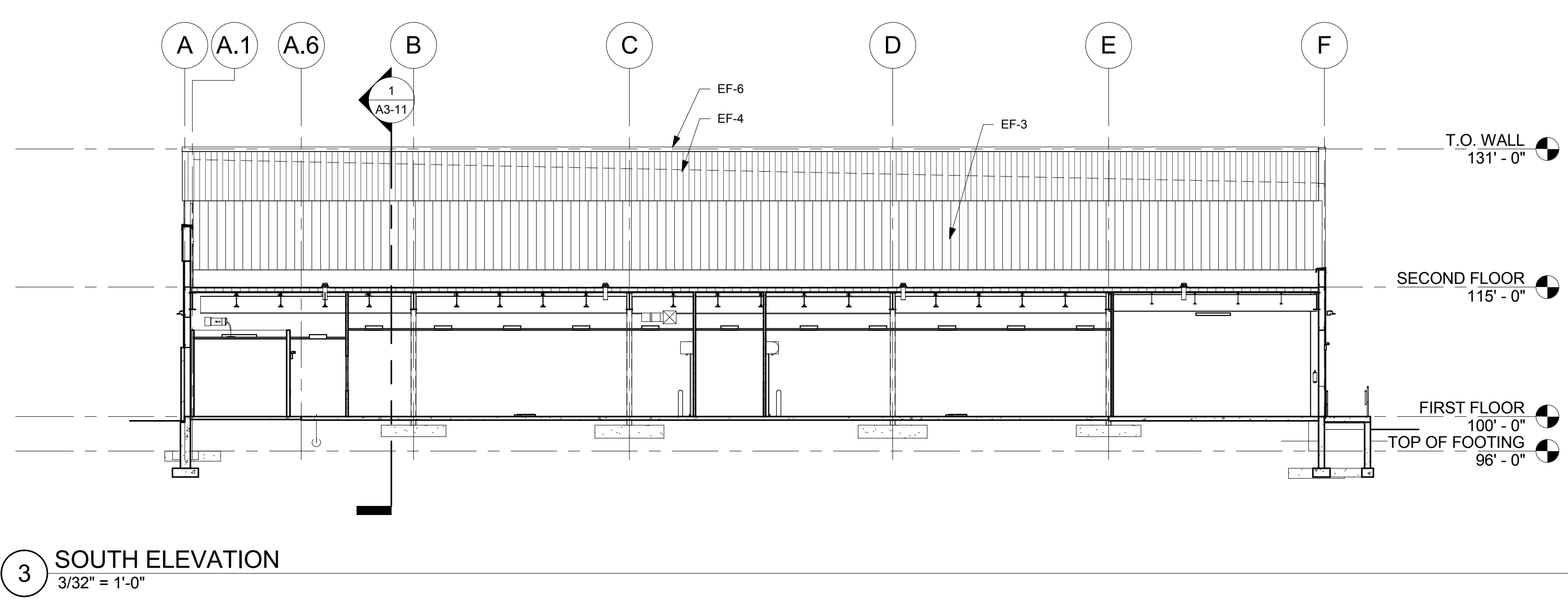
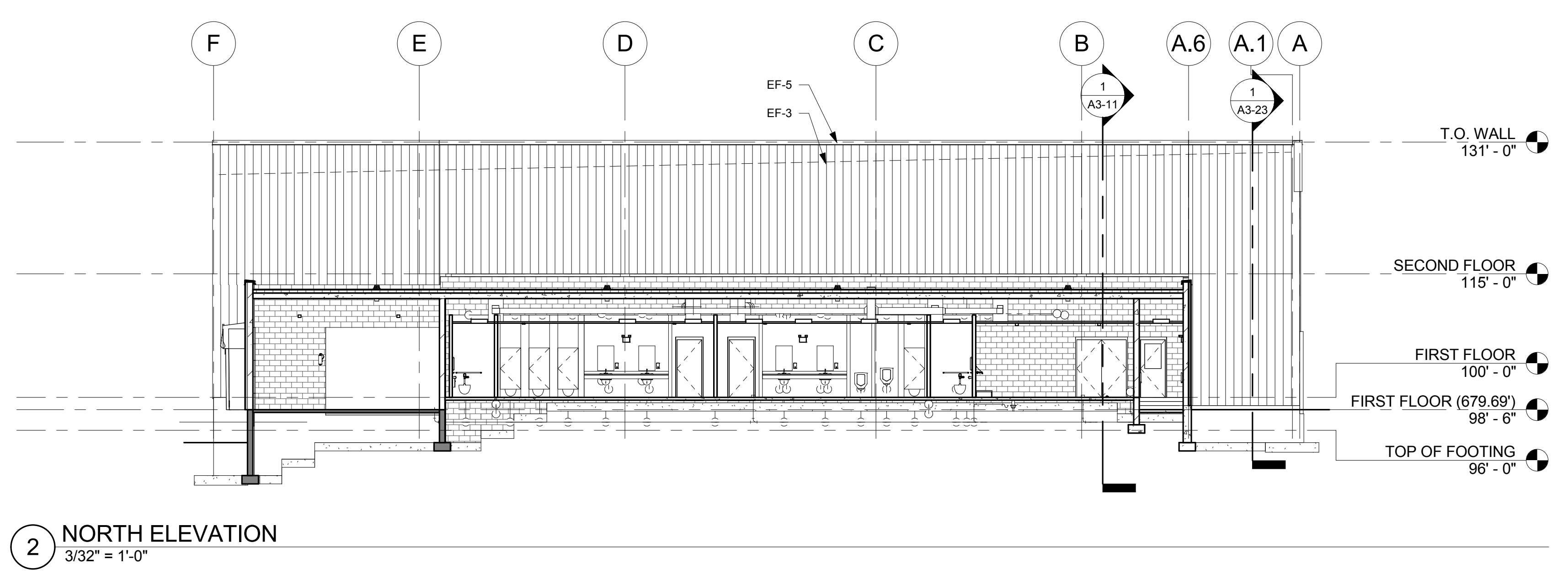
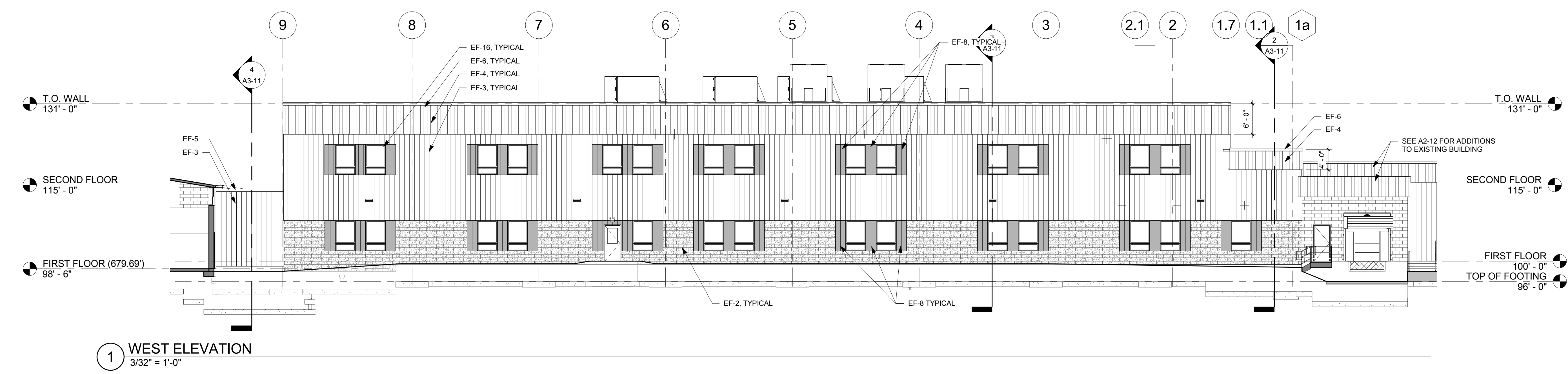

THIS DOCUMENT IS THE PROPERTY OF I & S GROUP, INC. AND MAY NOT BE USED, COPIED OR DUPLICATED WITHOUT PRIOR WRITTEN CONSENT.

REVISION SCHEDULE		
DATE	DESCRIPTION	BY

PROJECT NO.	16-18735
FILE NAME	18735 ARCH R17.RVT
DRAWN BY	CCS
DESIGNED BY	JPW
REVIEWED BY	NJE
ORIGINAL ISSUE DATE	02/01/2017
CLIENT PROJECT NO.	

TITLE

**EXTERIOR ELEVATIONS**

SHEET

**A2-11**

REFERENCE SCALE  
0 1/4" 1/2" 1"

**EXTERIOR FINISH SCHEDULE**

MARK	MATERIAL	MFR	PRODUCT	SIZE	COLOR	COMMENTS
EF-2	CONCRETE MASONRY UNIT	TBD	TBD	4"x8"x16"	MATCH EXISTING	FLUTED FINISH
EF-3	PREFINISHED METAL WALL PANEL	CENTRIA	TR4-36	36" X 1 1/2"	TAUPE	
EF-4	PREFINISHED METAL WALL PANEL	METAL SALES	T10-D WALL	36" X 1 1/2"	REGAL BLUE	
EF-5	PREFINISHED METAL TRIM	FIRESTONE			TAUPE	
EF-6	PREFINISHED METAL TRIM	FIRESTONE			REGAL BLUE	
EF-7	PAINTED HOLLOW METAL DOOR AND FRAME	TBD	TBD	VARIES	MATCH ADJACENT	
EF-8	PREFINISHED METAL WALL PANEL	CENTRIA	TR4-36	36" X 1 1/2"	MATTE BLACK	
EF-11	PREFINISHED METAL RAIN LEADER				TAUPE	
EF-12	PREFINISHED METAL SCUPPER				TAUPE	
EF-13	PREFINISHED METAL GUTTER				TAUPE	
EF-14	SNOW GUARDS					INSTALL PER MFR RECOMMENDATIONS
EF-15	SPLASH BLOCK					
EF-17	CONCRETE FILLED STEEL PIPE BOLLARDS				SAFETY YELLOW	PRIME AND PAINT



WI DSPS BUILDING REVIEW SET  
02/01/2017

THIS DOCUMENT IS THE PROPERTY OF I & S GROUP, INC. AND MAY NOT BE USED, COPIED OR DUPLICATED WITHOUT PRIOR WRITTEN CONSENT.

PROJECT

**DURATECH INDUSTRIES BUILDING ADDITION**

LA CROSSE WISCONSIN

REVISION SCHEDULE		
DATE	DESCRIPTION	BY

PROJECT NO.	16-18735
FILE NAME	18735 ARCH R17.RVT
DRAWN BY	MJT
DESIGNED BY	JPW
REVIEWED BY	NJE
ORIGINAL ISSUE DATE	02/01/2017
CLIENT PROJECT NO.	

TITLE

**EXTERIOR ELEVATIONS**

SHEET  
**A2-12**

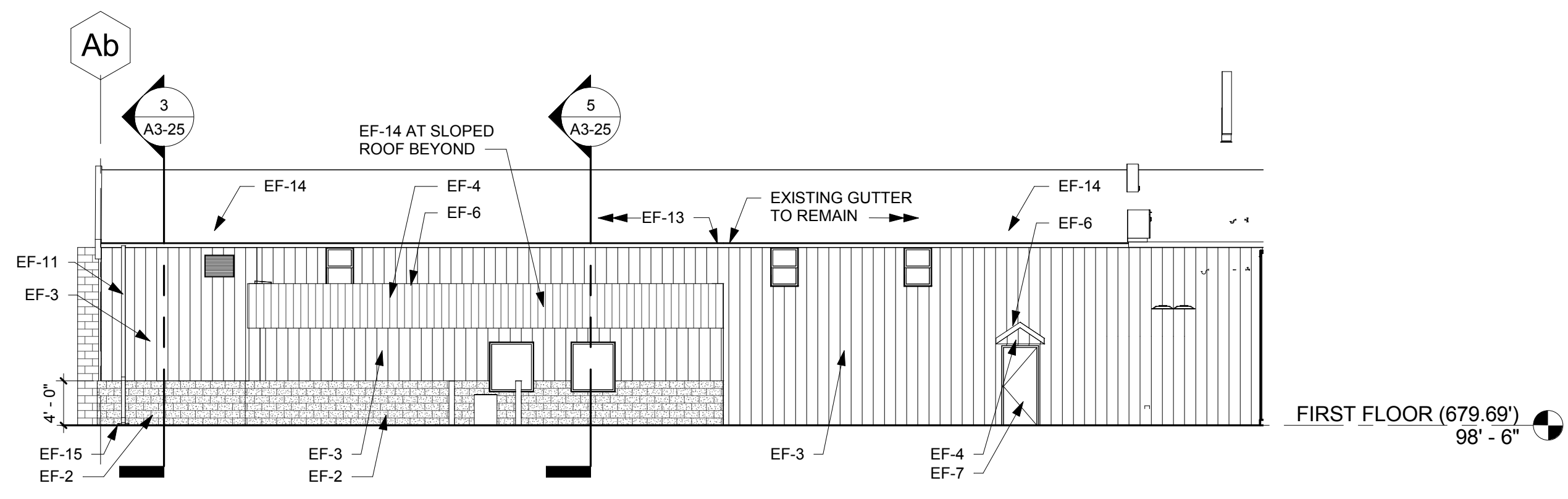

1 SOUTH ELEVATION - NORTH BUILDING  
3/32" = 1'-0"

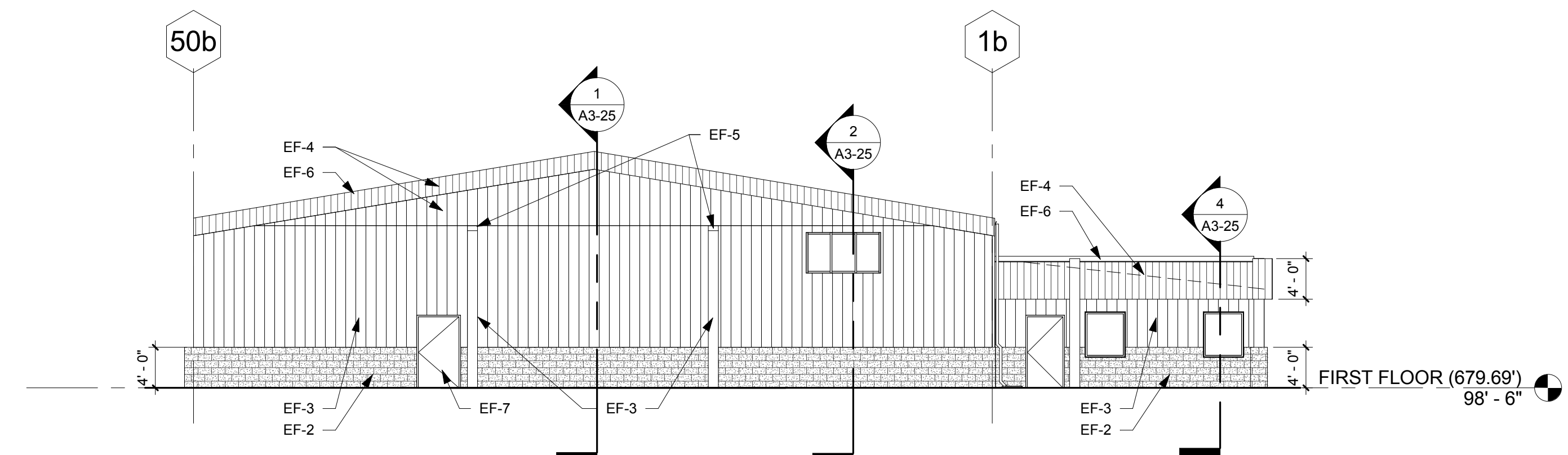

2 WEST ELEVATION - NORTH BUILDING  
3/32" = 1'-0"

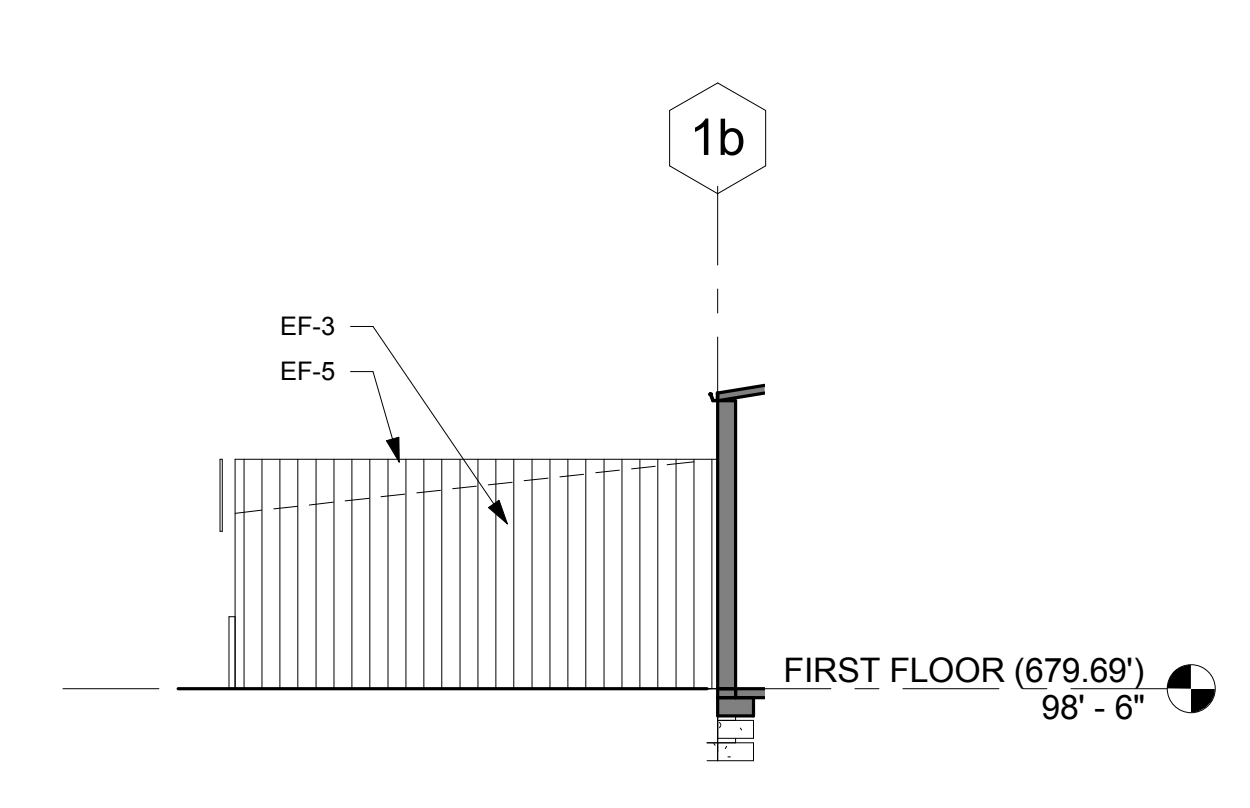

3 EAST ELEVATION - NORTH BLDG ADD  
3/32" = 1'-0"

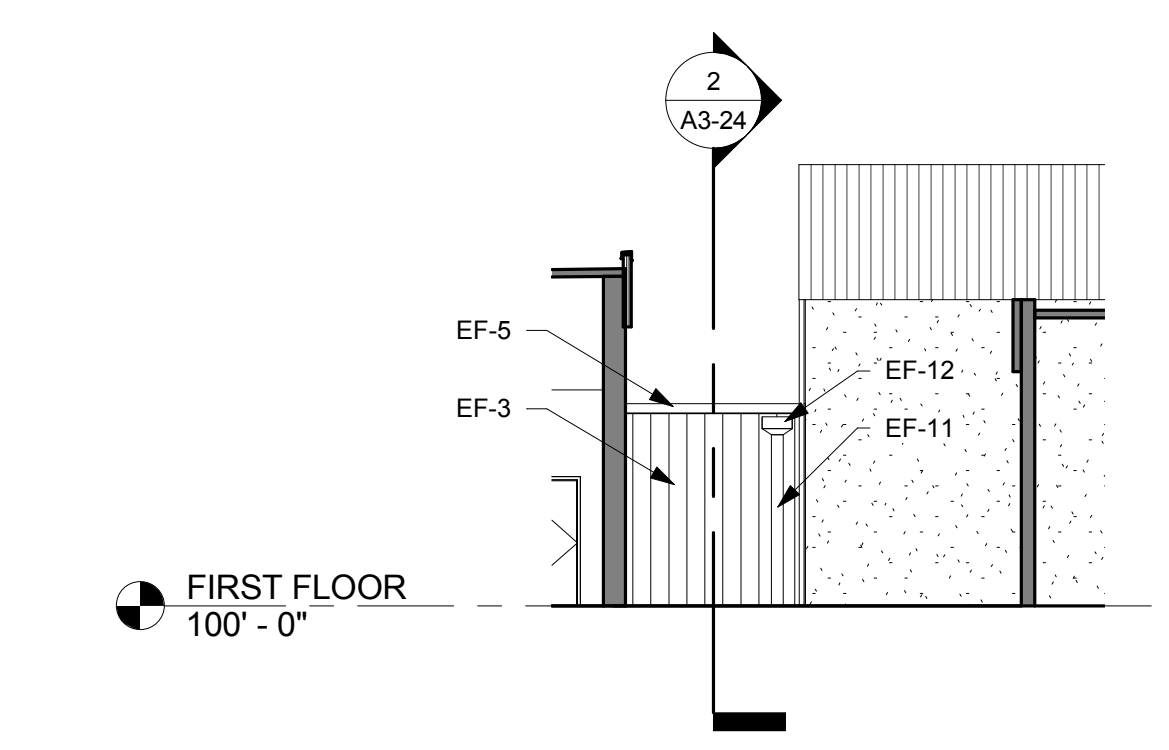

4 NORTH ELEVATION - SOUTH BLDG VEST  
3/32" = 1'-0"

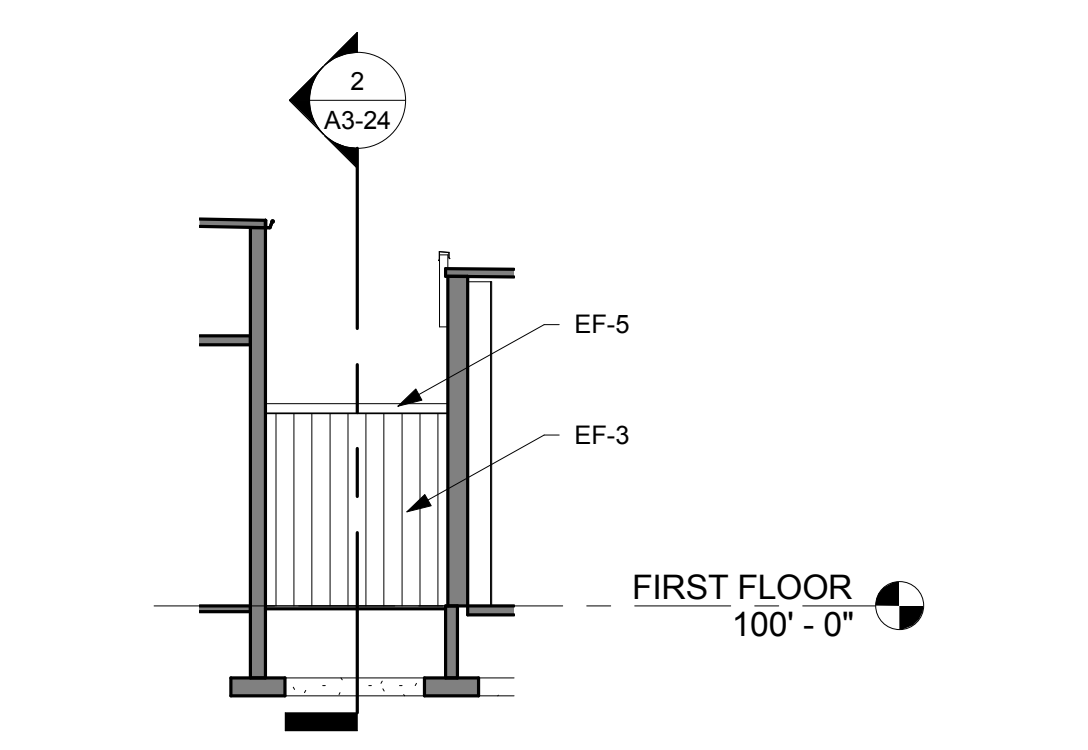

5 SOUTH ELEVATION SOUTH BLDG VEST  
3/32" = 1'-0"

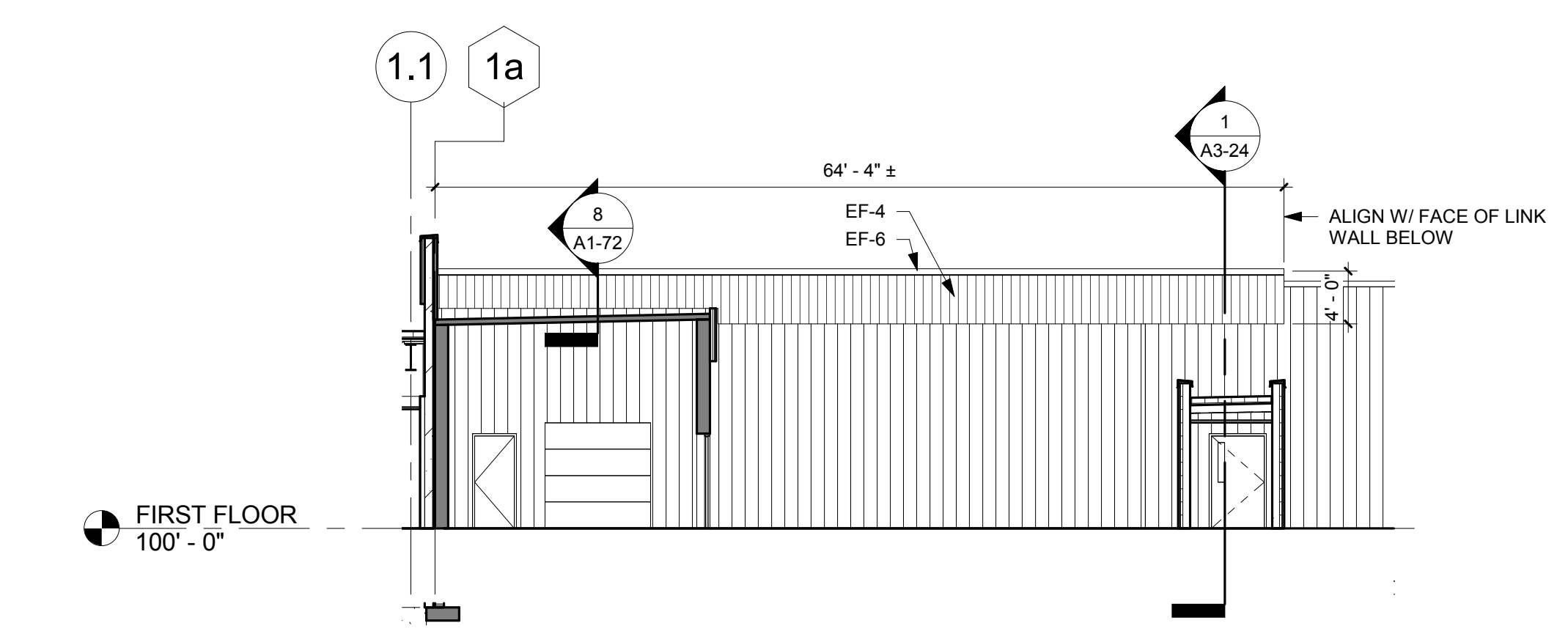

6 WEST ELEVATION - SOUTH BLDG  
3/32" = 1'-0"

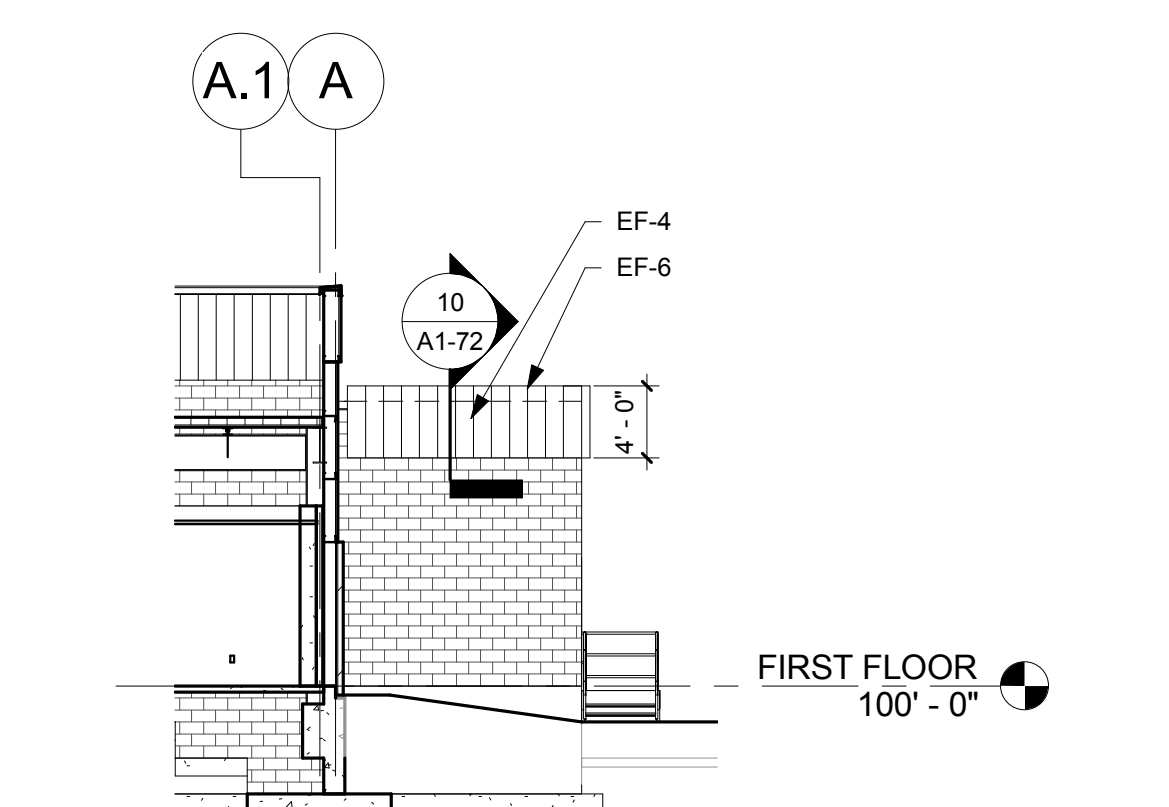

7 NORTH ELEVATION - SOUTH BLDG ADD  
3/32" = 1'-0"

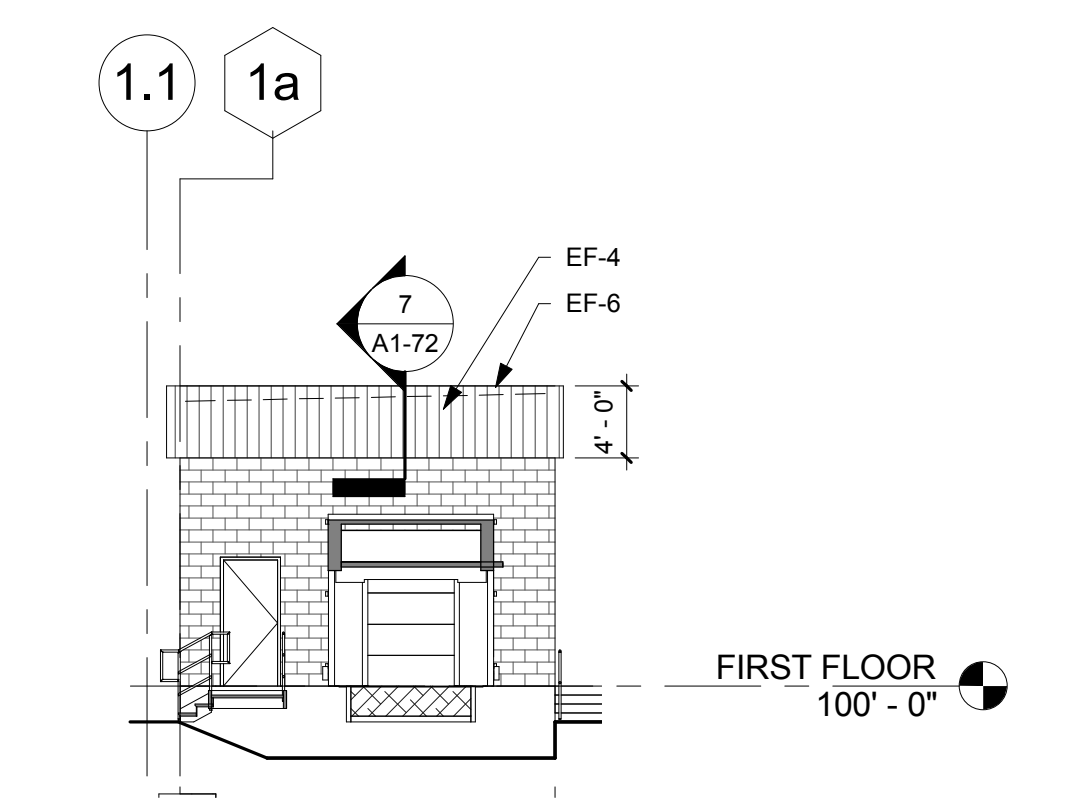

8 WEST ELEVATION - SOUTH BLDG ADD  
3/32" = 1'-0"

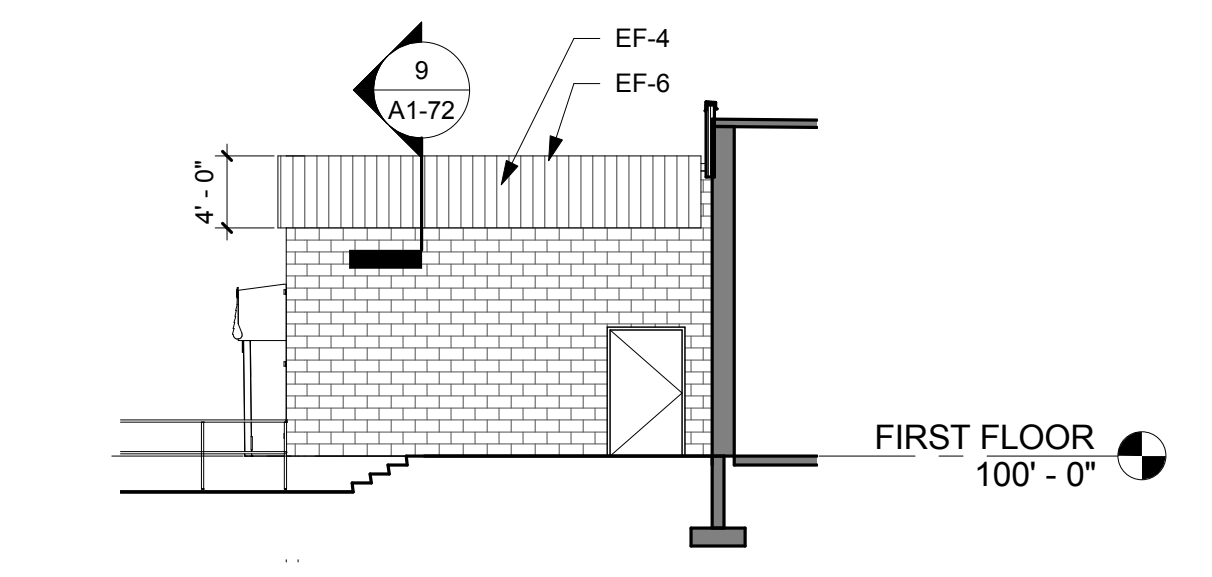

9 SOUTH ELEVATION - SOUTH BLDG ADD  
3/32" = 1'-0"

REFERENCE SCALE  
0 1/4" 1/2" 1" 2"