



City of La Crosse, Wisconsin

APPLICATION FOR BEER GARDEN LICENSE

Check One: New Renewal For the license period _____ to _____ Fee: \$ 200.00

License Class: (Check One) Class "A" Class "B" Class "C" Class "D" (ZONING RESTRICTION)

BUSINESS INFORMATION			
Legal/Real Name: <u>Neighbors Bar</u>			
Address of Above: Street <u>1703 George St.</u>		City <u>LaCrosse</u>	State <u>WI</u>
		Zip Code <u>54603</u>	
PREMISES INFORMATION			
Trade Name of Business: <u>NEW IDEAL</u>			
Address of premises to be Licensed:			
BEER GARDEN INFORMATION			
Description of proposed beer garden: (MUST BE SPECIFIC: square feet, physical location, material made out of, etc.) <u>This will be in the backyard, fenced in area is 1913.07 square feet of open space. There is vinyl fencing around all of yard except where the building and garage are. There is a back door in bar that you can enter the yard. There are also two gates one that is 3' and one that is 8'. This is on the rubber part of the bar but back from the front door on George St.</u>			
AGENT INFORMATION			
Agent Name: First <u>Tracy</u>		Middle	Last <u>McHenry</u>
Agent Home Address: Street <u>1748 Caroline St</u>		City <u>LaCrosse</u>	State <u>WI</u>
		Zip Code <u>54603</u>	
Home Phone Number: [REDACTED]		Daytime Phone Number: [REDACTED]	
Was the above person listed as agent on last year's application? <input checked="" type="checkbox"/> Yes <input type="checkbox"/> No			



The above hereby makes application for a license to operate a Beer Garden at the above address within the City of La Crosse pursuant to provisions of Sec. 10-47 of the Code of Ordinances for the City of La Crosse.

Tracy McHenry
Signature of Applicant _____ Date _____

A PLAN MUST ACCOMPANY THIS APPLICATION

OFFICE USE ONLY			
For original application: Attach a list of all property owners within 200 feet of the proposed licensed premises.			
Signature:	Date:	Granted:	License #:

Tax Parcel	OwnerName	PROPADDCOMP	Mailing Address	MailCityStateZip
17-10115-120	2233 PROPERTIES LLC	1646 KANE ST	PO BOX 3743	LA CROSSE WI 54602
17-10118-120	ALEXANDER D STEIN, AMANDA D LANGAARD	1722 KANE ST	1722 KANE ST	LA CROSSE WI 54603-2153
17-10118-50	ALLEGRO PROPERTIES LLC	1709 GEORGE ST	2110 CLEARWATER DR	ONALASKA WI 54650
17-10118-40	ANDANTE PROPERTIES LLC	1711 GEORGE ST	2110 CLEARWATER DR	ONALASKA WI 54650
17-10118-90	ANDANTE PROPERTIES LLC ATTN: JACOB STOLL	1711 GEORGE ST	2110 CLEARWATER DR	ONALASKA WI 54650
17-10183-120	ABSOLUTE RENTALS LLC	1720 & 1722 GEORGE ST	N5881 LAKEVIEW CT E	ONALASKA WI 54650
17-10177-30	BUDDIES THREE INC	1728 GEORGE ST	1728 GEORGE ST	LA CROSSE WI 54603-1645
17-10118-110	CATHERINE J WOOD, JASON P LIPPERT	1718 KANE ST	1718 KANE ST	LA CROSSE WI 54603-2153
17-10183-110	CHAD T LONGWAY	1718 GEORGE ST	2631 LOOMIS ST	LA CROSSE WI 54603
17-10118-100	DEVIN N GHENT	1712 KANE ST	1712 KANE ST	LA CROSSE WI 54601
17-10270-120	DIANNE J JERANEK	1211 RUBLEE ST	1211 RUBLEE ST	LA CROSSE WI 54603
17-10118-70	ELAINE E PITTMAN	1702 KANE ST	1702 KANE ST	LA CROSSE WI 54603
17-10183-130	GEORGE ST PUB PROPERTIES LLC	1724 GEORGE ST	1728 GEORGE ST	LA CROSSE WI 54603
17-10118-80	HERITAGE RENTALS LLC	1706 KANE ST	4344 HERITAGE DR	EAU CLAIRE WI 54703
17-10116-10	JOHN A DEVINE, LINDA M DEVINE	1642 KANE ST	1642 KANE ST	LA CROSSE WI 54603
17-10136-30	MARY LATHROP (LE), WILLIAM D LATTHROP III	1640 GEORGE ST	3038 LAKOTA PL	LA CROSSE WI 54601
17-10183-100	MIYOKO MCKIM	1710 GEORGE ST	1710 GEORGE ST	LA CROSSE WI 54603-2150
17-10270-130	NAEBOR PROPERTIES LLC	1205 & 1207 RUBLEE ST 1700, 1702, 1704, 1706, 1708 GEORGE ST	448 CORONADO CIR	ONALASKA WI 54650
Applicant	NEIGHBORS BAR LLC	1123 RUBLEE ST & 1703 GEORGE ST	1703 GEORGE ST	LA CROSSE WI 54603-2182
17-10115-110	NOBLE HOLDINGS LLC	1650 KANE ST	212 HOOD ST	LA CROSSE WI 54601
17-10117-40	NOBLE HOLDINGS LLC	1645 GEORGE ST	212 HOOD ST	LA CROSSE WI 54601
17-10117-50	NOBLE HOLDINGS LLC	1645 GEORGE ST	212 HOOD ST	LA CROSSE WI 54601
17-10118-10	OLSON RENTAL PROPERTIES LLC	1731 GEORGE ST	1720 GEORGE ST	LA CROSSE WI 54603-2150
17-10118-20	OLSON RENTAL PROPERTIES LLC	1721 GEORGE ST	1720 GEORGE ST	LA CROSSE WI 54603-2150
17-10117-30	QUINCY E SCOTT, KATIE M SCOTT	1632 KANE	1632 KANE	LA CROSSE WI 54603
17-10136-10	RONALD MALAY	1650 GEORGE ST	N2970 STATE ROAD 16	LA CROSSE WI 54601
17-10136-20	RONALD MALAY	1646 & 1648 GEORGE ST	N2970 STATE ROAD 16	LA CROSSE WI 54601
17-10118-30	WILLIAM PEDEN, MELODY PEDEN	1717 GEORGE ST	1717 GEORGE ST	LA CROSSE WI 54603-2182

Properties within 200 feet of Neighbors Bar LLC - 1703 George Street.

Rubble St.

47' 4" fence

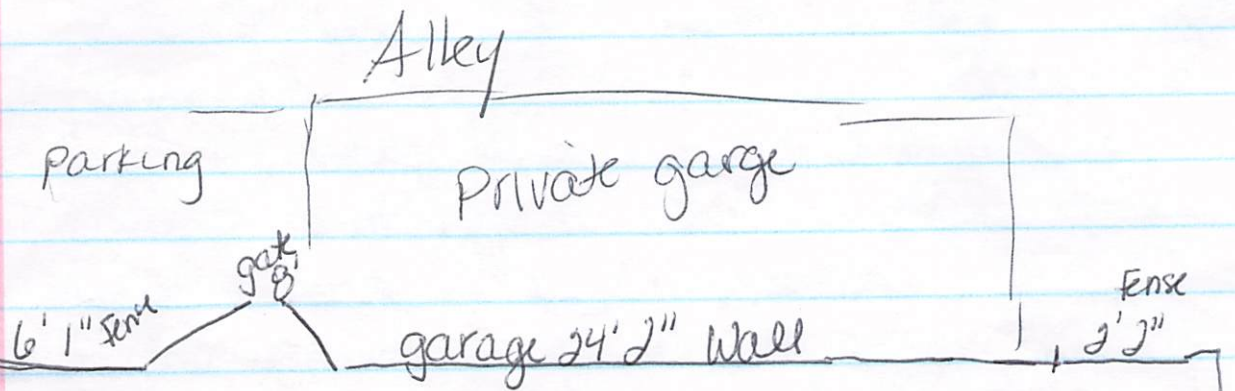

Picnic table

yard 1913.07 square feet

Picnic table

79' 7" fence

fence 3' 8"

gate 3'

apartment
5th entrance
CPN kitchen

20' 4" wall

5' 7" wall

6" door

Bar

door

door

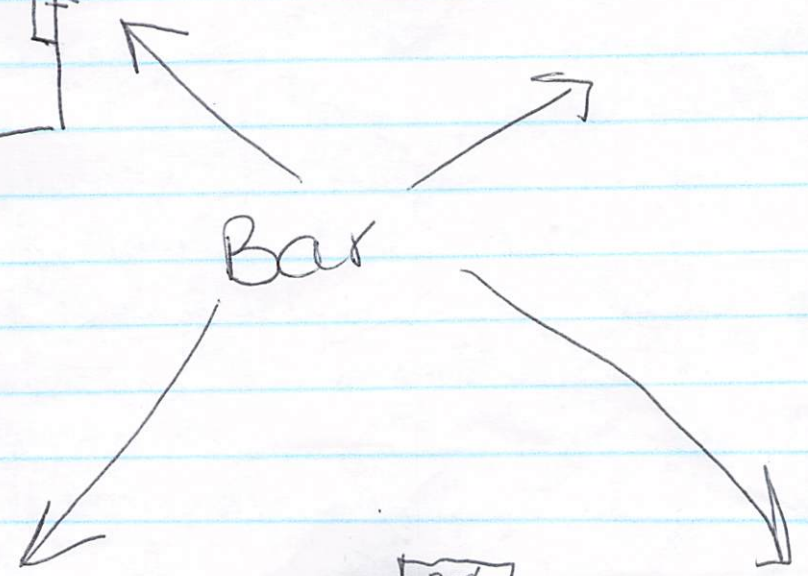



WILLIAM PEDEN, MELODY PEDEN
1717 GEORGE ST
LA CROSSE WI 54603-2182

NOTICE OF APPLICATION FOR BEER GARDEN LICENSE IN THE CITY OF LA CROSSE

This is to notify you that the following business has applied for a **Class "A" Beer Garden** license under Chapter 10, Article III of the Code of Ordinances of the City of La Crosse to allow consumption of alcoholic beverages in a designated outdoor area, as described below and on the attached drawing.

Pursuant to sec. 10-77, property owners within 200 feet of the proposed premises for a Beer Garden License shall receive notice of an original application.

Neighbors Bar LLC dba Neighbors Bar at 1703 George St, La Crosse WI 54603

Beer Garden description: Fenced-in area in back yard, approximately 1913.07 square feet.

This application will be considered at the following meetings which are held in the Council Chambers of La Crosse City Hall, 400 La Crosse Street. The applications can be viewed online at the Legislative Information Center (<https://cityoflacrosse.legistar.com/Legislation.aspx>) search for file 26-0432.

- **Judiciary and Administration Committee – Tuesday, June 2, 2026 at 6:00 p.m.**
- **Common Council – Thursday, June 11, 2026 at 6:00 p.m.**

The meeting can be viewed (no participation) by visiting the Legislative Information Center Meetings calendar (<https://cityoflacrosse.legistar.com/Calendar.aspx>) - find the scheduled meeting and click on the video link to the far right in the meeting list.

Written comments may be submitted to the City Clerk's Office by emailing cityclerk@cityoflacrosse.org, by delivery or mail to City Clerk, 400 La Crosse Street, La Crosse WI 54601 or by deposit in the green drop box on the north side of City Hall.

This notice is given pursuant to the order of the Common Council of the City of La Crosse.

Dated this 22nd day of May, 2026.

A handwritten signature in cursive script that reads "Nikki M. Elsen".

Nikki M. Elsen, WCMC
City Clerk

Tax Parcel	OwnerName	PROPADDCOMP	Mailing Address	MailCityStateZip
17-10115-120	2233 PROPERTIES LLC	1646 KANE ST	PO BOX 3743	LA CROSSE WI 54602
17-10118-120	ALEXANDER D STEIN, AMANDA D LANGAARD	1722 KANE ST	1722 KANE ST	LA CROSSE WI 54603-2153
17-10118-50	ALLEGRO PROPERTIES LLC	1709 GEORGE ST	2110 CLEARWATER DR	ONALASKA WI 54650
17-10118-40	ANDANTE PROPERTIES LLC	1711 GEORGE ST	2110 CLEARWATER DR	ONALASKA WI 54650
17-10118-90	ANDANTE PROPERTIES LLC ATTN: JACOB STOLL	1711 GEORGE ST	2110 CLEARWATER DR	ONALASKA WI 54650
17-10183-120	ABSOLUTE RENTALS LLC	1720 & 1722 GEORGE ST	N5881 LAKEVIEW CT E	ONALASKA WI 54650
17-10177-30	BUDDIES THREE INC	1728 GEORGE ST	1728 GEORGE ST	LA CROSSE WI 54603-1645
17-10118-110	CATHERINE J WOOD, JASON P LIPPERT	1718 KANE ST	1718 KANE ST	LA CROSSE WI 54603-2153
17-10183-110	CHAD T LONGWAY	1718 GEORGE ST	2631 LOOMIS ST	LA CROSSE WI 54603
17-10118-100	DEVIN N GHENT	1712 KANE ST	1712 KANE ST	LA CROSSE WI 54601
17-10270-120	DIANNE J JERANEK	1211 RUBLEE ST	1211 RUBLEE ST	LA CROSSE WI 54603
17-10118-70	ELAINE E PITTMAN	1702 KANE ST	1702 KANE ST	LA CROSSE WI 54603
17-10183-130	GEORGE ST PUB PROPERTIES LLC	1724 GEORGE ST	1728 GEORGE ST	LA CROSSE WI 54603
17-10118-80	HERITAGE RENTALS LLC	1706 KANE ST	4344 HERITAGE DR	EAU CLAIRE WI 54703
17-10116-10	JOHN A DEVINE, LINDA M DEVINE	1642 KANE ST	1642 KANE ST	LA CROSSE WI 54603
17-10136-30	MARY LATHROP (LE), WILLIAM D LATTHROP III	1640 GEORGE ST	3038 LAKOTA PL	LA CROSSE WI 54601
17-10183-100	MIYOKO MCKIM	1710 GEORGE ST	1710 GEORGE ST	LA CROSSE WI 54603-2150
17-10270-130	NAEBOR PROPERTIES LLC	1205 & 1207 RUBLEE ST 1700, 1702, 1704, 1706, 1708 GEORGE ST	448 CORONADO CIR	ONALASKA WI 54650
Applicant	NEIGHBORS BAR LLC	1123 RUBLEE ST & 1703 GEORGE ST	1703 GEORGE ST	LA CROSSE WI 54603-2182
17-10115-110	NOBLE HOLDINGS LLC	1650 KANE ST	212 HOOD ST	LA CROSSE WI 54601
17-10117-40	NOBLE HOLDINGS LLC	1645 GEORGE ST	212 HOOD ST	LA CROSSE WI 54601
17-10117-50	NOBLE HOLDINGS LLC	1645 GEORGE ST	212 HOOD ST	LA CROSSE WI 54601
17-10118-10	OLSON RENTAL PROPERTIES LLC	1731 GEORGE ST	1720 GEORGE ST	LA CROSSE WI 54603-2150
17-10118-20	OLSON RENTAL PROPERTIES LLC	1721 GEORGE ST	1720 GEORGE ST	LA CROSSE WI 54603-2150
17-10117-30	QUINCY E SCOTT, KATIE M SCOTT	1632 KANE	1632 KANE	LA CROSSE WI 54603
17-10136-10	RONALD MALAY	1650 GEORGE ST	N2970 STATE ROAD 16	LA CROSSE WI 54601
17-10136-20	RONALD MALAY	1646 & 1648 GEORGE ST	N2970 STATE ROAD 16	LA CROSSE WI 54601
17-10118-30	WILLIAM PEDEN, MELODY PEDEN	1717 GEORGE ST	1717 GEORGE ST	LA CROSSE WI 54603-2182

Properties within 200 feet of Neighbors Bar LLC - 1703 George Street.