

REPORT ON

PROPOSED SPECIAL ASSESSMENTS FOR PUBLIC IMPROVEMENTS AGAINST  
PROPERTIES LOCATED IN LA CROSSE, WISCONSIN  
(Police Power Assessments)

This report is submitted in accordance with the requirements of Sec.66.0703, Wis. Stats., and Ordinance No. 4222 of the Common Council of the City of La Crosse, Wisconsin, dated April 14, 2005 determining to levy special assessments on benefited properties for public improvements described in Schedule B of this report to be made in the assessment district described in Schedule B of this report.

The properties shown on Schedule B, against which the proposed assessments are to be made, are benefited by the proposed improvements by construction of Water Main at the following locations:

- 1600 block of Hayes Street
- 1500 block of Cunningham Street

This report consists of the following schedules attached hereto, except as otherwise provided:

SCHEDULE A – Final Plans and Specifications are on file with the Engineering Department, 4<sup>th</sup> Floor, City Hall, 400 La Crosse Street, La Crosse, WI.

SCHEDULE B – Estimated Cost of Improvements and Proposed Assessments against each benefited parcel.

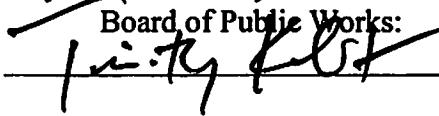
City of La Crosse by  
Board of Public Works:  
  
 \_\_\_\_\_  
 \_\_\_\_\_  
 \_\_\_\_\_  
 \_\_\_\_\_

Dated: January 16, 2020



ST PAUL 2ND ADDN  
BLK 8

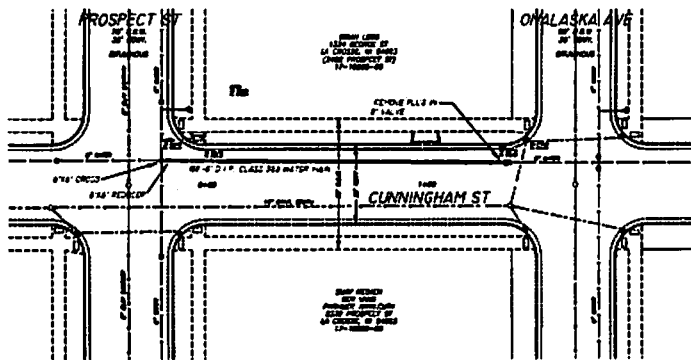

BLK 9

NOTE  
CONSTRUCTION IS TO VERIFY LOCATION OF ALL UTILITIES  
BEFORE ANY CONSTRUCTION

UTILITY QUANTITIES	
ITEM	QUANTITY
1. 12\"/>	

EXTRAORDINARY CLASS WORK  
CONSTRUCTION IS A PROPERTY OF...  
CONSTRUCTION IS A PROPERTY OF...

CONSTRUCTION IS A PROPERTY OF...  
CONSTRUCTION IS A PROPERTY OF...

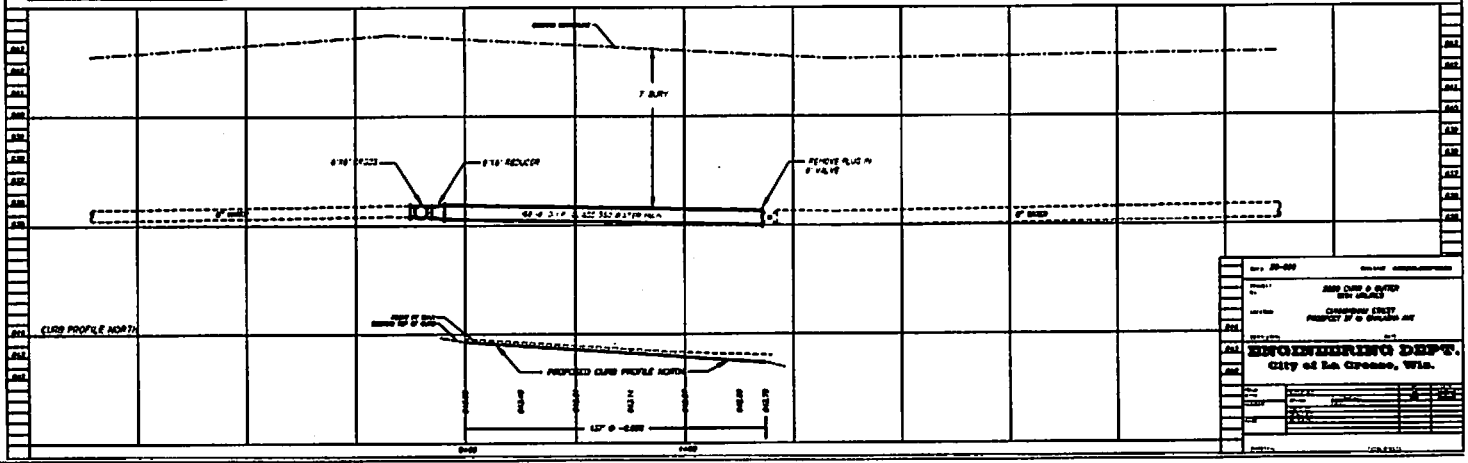

DATE	20-00	REVISION	
PROJECT	ST. PAUL 2ND ADDN BLK 8		
CLIENT	CUNNINGHAM STREET PROPERTY OF ONALASKA AVE		
DESIGNED BY	ENGINEERING DEPT. CITY OF LA CROSSE, WIS.		
CHECKED BY		DATE	
APPROVED BY		DATE	

## ORIGINAL ASSESSMENT ESTIMATE

For the construction of water main and all appurtenances on Hayes Street between Onalaska Avenue and Dead End East. Resolution #

OWNER & MAIL ADDRESS	PROPERTY ADDRESS	ADDITION & PROPERTY DESCRIPTION	PARCEL ID#	WATER MAIN		INDIVIDUAL SERVICES	TOTAL ASSESSMENT	DEFERRED?
				FRONTAGE WIDTH (FT)	COST @ \$14/FOOT			
		<u>JOHNSTON'S ADDITION</u>						
DANIEL H DORN, NANCY L DORN N5968 COUNTY ROAD XX ONALASKA WI 54650	2200 ONALASKA AVE	LOTS 7 & 8 BLOCK 5	17-10242-130	20	\$280.00		\$280.00	NO
MICHELE T COLLINS 1810 HAYES ST LA CROSSE WI 54603	1810 HAYES ST	E 1/2 LOTS 1 & 2 BLOCK 8	17-10243-60	70	\$980.00	\$ 2,200.00	\$3,180.00	YES
AMY ISBELL C/O DANIEL WILHELM 1818 HAYES ST LA CROSSE WI 54603-1824	1818 HAYES ST	LOT 11 BLOCK 8 & N 1/2 VAC ALLEY LYG 8 OF LOT 11	17-10244-10	60	\$840.00	\$ 2,200.00	\$3,040.00	YES
PATRICIA K LAFLEUR W4733 COUNTY ROAD B WEST SALEM WI 54689	1820 HAYES ST	LOT 12 BLOCK 8 & N 1/2 VAC ALLEY LYG 8 & VAC ALLEY ON E MEASURING 10 X 200 FT	17-10244-20	60	\$840.00	\$ 2,200.00	\$3,040.00	YES
KRISTINE FORTEK 1819 HAYES ST LA CROSSE WI 54603	1819 HAYES ST	3 75FT LOTS 9 & 10 BLOCK 8 & VAC ALLEY ADJ ON E & DAIRYLAND POWER ADDITION S 1/2 LOT 3 SUBJ TO EGMT IN DOC NO. 1439009	17-10243-10	90	\$1,260.00	\$ 2,200.00	\$3,460.00	YES
<b>TOTAL ASSESSMENT</b>							<b>\$13,000.00</b>	
<b>TOTAL DEFERRED ASSESSMENT</b>							<b>\$12,720.00</b>	

### ORIGINAL ASSESSMENT ESTIMATE

Resolution #

For the construction of water main and all appurtenances on Cunningham Street between Onafaska Avenue and Prospect Street.

OWNER & MAIL ADDRESS	PROPERTY ADDRESS	ADDITION & PROPERTY DESCRIPTION	PARCEL ID#	WATER MAIN		INDIVIDUAL SERVICES	TOTAL ASSESSMENT	DEFERRED?
				FRONTAGE WIDTH (ft)	COST @ \$14/FOOT			
		<b>ST PAUL SECOND ADDITION</b>						
BRIAN LEGG 1324 GEORGE ST LA CROSSE WI 54603-2457	2402 PROSPECT ST	LOT 10 BLOCK 9	17-10205-60	20	\$280.00		\$280.00	NO
SUAY KEAEN, PHOUMEE XAYALEUTH, KER VANG 2332 PROSPECT ST LA CROSSE WI 54603-1969	2332 PROSPECT ST	LOTS 1 & 2 BLOCK 9	17-10205-60	20	\$280.00		\$280.00	NO
<b>TOTAL ASSESSMENT</b>							<b>\$560.00</b>	
<b>TOTAL DEFERRED ASSESSMENT</b>							<b>\$0.00</b>	