

SCALE: 1"=20' H
1"= 2' V
ELEVATIONS SHOWN
ARE NAVD 1988

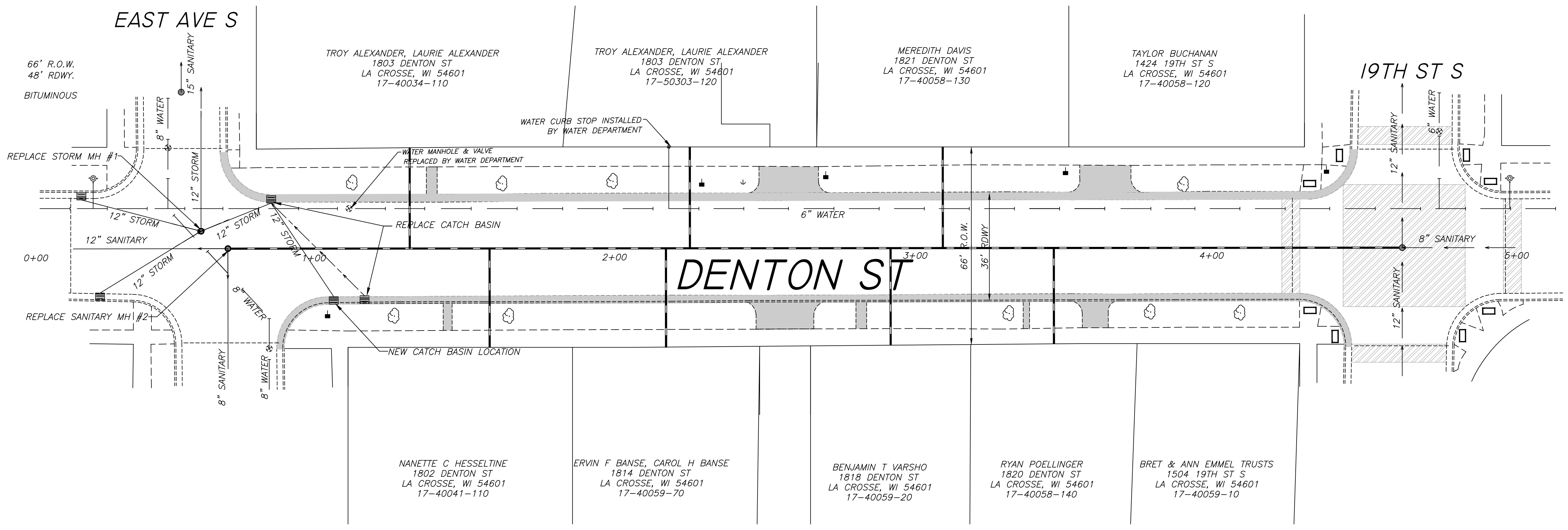

NOTE
CONTRACTOR IS TO VERIFY LOCATION OF ALL UTILITIES
PRIOR TO ANY CONSTRUCTION

SANITARY MANHOLE #1
48" DIAMETER
STA. 0+47
RIM 60.73
INV. N 658.72, 15"
INV. S 658.83, 15"

STORM MANHOLE #1
48" DIAMETER
STA. 0+54
RIM 671.06
INV. N 665.32, 15"
INV. NW 665.59, 12"
INV. SW 665.62, 12"
INV. NE 665.46, 12"
INV. E 665.60, 12"

SANITARY MANHOLE #2
48" DIAMETER
STA. 0+63
RIM 671.12
INV. N 662.96, 8"
INV. W 662.76, 10"
INV. S 662.82, 8"
INV. E 663.04, 4"
INV. E 663.04, 4"

SANITARY MANHOLE #3
48" DIAMETER
STA. 4+53
RIM 674.15
INV. N 656.62, 12"
INV. S 656.60, 12"
INV. E LOW 656.83, 8"
INV. E HIGH 664.02, 8"

*NOTE: FINAL SANITARY
GRADE/ELEVATION TO BE
VERIFIED IN FIELD

*NOTE: FINAL LATERAL
LOCATION TO BE VERIFIED
IN FIELD

BENCHMARKS
TOP NUT OF HYDRANT
EAST AVE & DENTON ST 674.20
19TH ST & DENTON ST 677.38

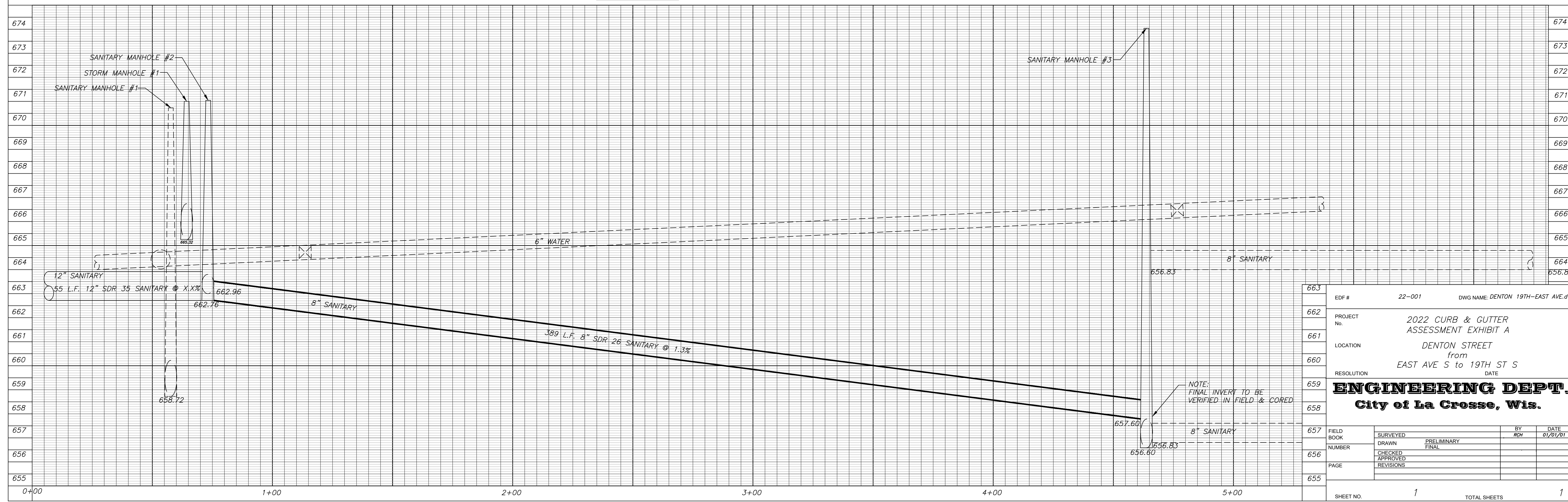

663	EDF #	22-001	DWG NAME: DENTON 19TH-EAST AVE.dwg
662	PROJECT No.	2022 CURB & GUTTER ASSESSMENT EXHIBIT A	
661	LOCATION	DENTON STREET from EAST AVE S to 19TH ST S	
660	RESOLUTION	DATE	
659	ENGINEERING DEPT.		
658	City of La Crosse, Wis.		
657	FIELD BOOK NUMBER	SURVEYED DRAWN	BY RCH
656	PAGE	PRELIMINARY	DATE 01/01/01
655	SHEET NO.	CHECKED APPROVED REVISIONS	TOTAL SHEETS 1