

License Fee: _____

Invoice No.: MUNIS INV#: 196057

**APPLICATION TO OWN, KEEP AND/OR HARBOR CHICKENS
IN THE CITY OF LA CROSSE**



License Period: January 1, ____ to December 31, ____

Use Conditions:

- One property is limited to the keeping or harboring of up to eight (8) chickens.
- A person may only own, keep or harbor chickens on property being used as a one-family dwelling (single family) or two-family dwelling (duplex).
- No person shall keep any rooster.
- No person shall slaughter any chickens.
- Chickens shall be provided with a covered enclosure that measures a minimum of three (3) square feet per bird, and all chickens must be kept in the covered enclosure or a fenced enclosure within the backyard of the property at all times.
- No enclosure shall be located closer than 25 feet to any residential structure on an adjacent lot.

APPLICANT:

JACOB MICHAELS

PROPERTY ADDRESS WHERE CHICKENS WILL BE KEPT:

3414 GENEVA LN. LA CROSSE, WI 54601

PROPERTY OWNER(S):

JACOB MICHAELS & AMBER MICHAELS

*If applicant is not the owner, please provide written documentation from the owner that they have been notified.
Not applicable for renewal.*

Is the property **ONE-FAMILY** dwelling or _____ **TWO-FAMILY** dwelling? (Check One)

*If duplex, provide written documentation from other occupant that they have been notified.
Not applicable for renewal.*

Attach a scale drawing showing property lot lines, dimensions of coop/enclosure and distance from adjoining lot lines and residential structures.

Applying for and obtaining this chicken permit DOES NOT provide any authority to violate any restrictive covenants that govern the property where you reside or intend to keep chickens. Please review any Declaration of Restrictions or Restrictive Covenants that apply to the property prior to applying for a chicken permit. No permit fees will be refunded once they are paid.

I hereby certify that I have read and understand the content of this application and that the above statements are true and correct to the best of my knowledge. I further certify that I understand that any such license is subject to revocation in accordance with Municipal Code of Ordinances Sec. 6-16.

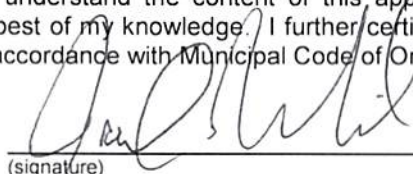

(signature)

608-317-0545

(signature)

4/23/24

(telephone)

(date)

NOTES

#25.00 - 8 chickens

 chicken enclosure

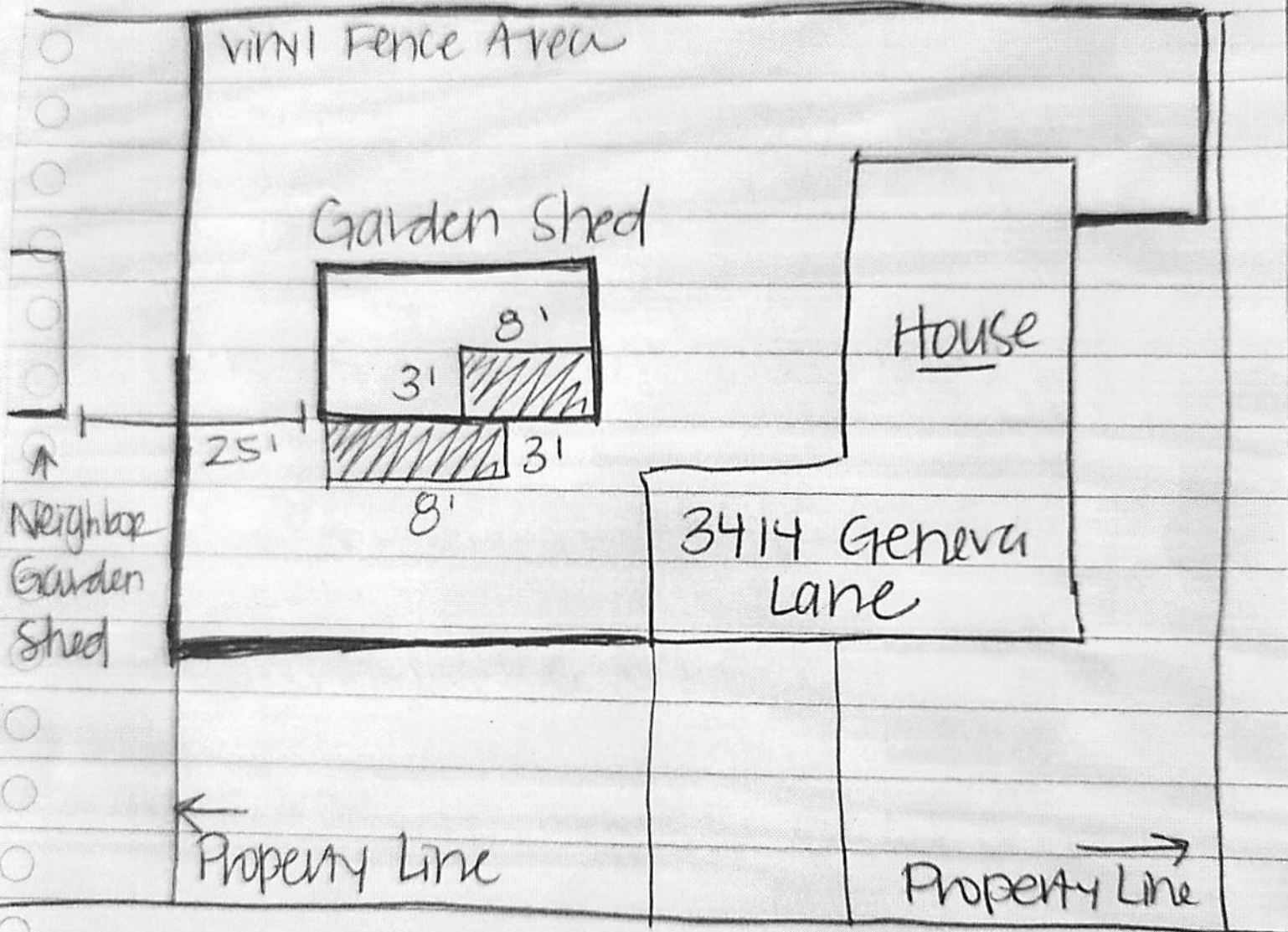

Neighbor
Garden
Shed

vinyl Fence Area

Garden Shed

House

3414 Geneva
Lane

Property Line

Property Line

Geneva Ln