

KWIK TRIP WAY IN LA CROSSE
TODD NEDAGAARD - 608-739-6062
2 NEW LOOPS LAX067 AND MAF083

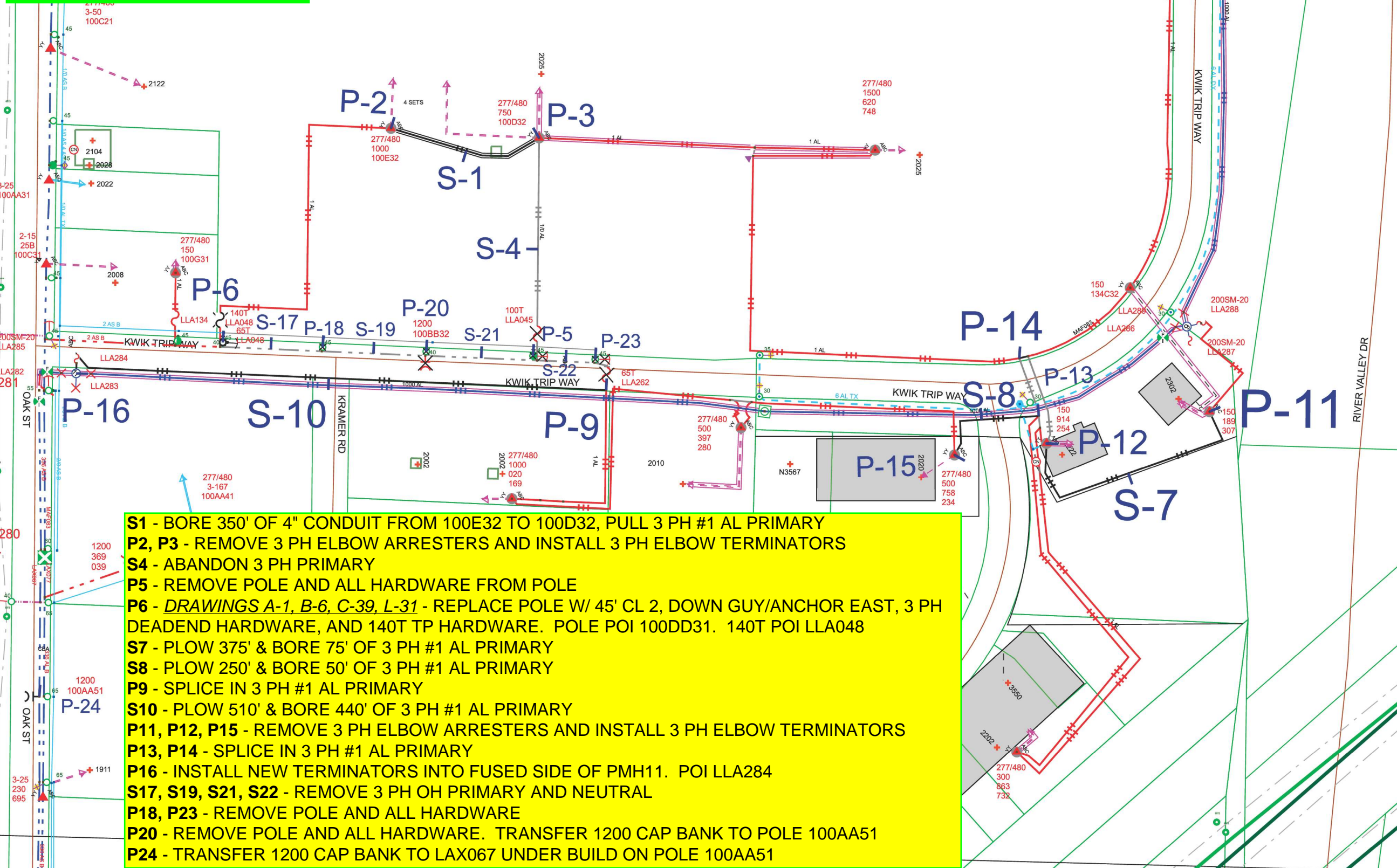

Work Order Information	
Service Request #	: 000015645958
Design Number	: 000001230678
Designer/Planner ID	: MCRJ02
Designer/Planner Name	: MCROBERTS
Designer/Planner Ph #	: 608-789-3689
Manager Approval	:

Joint Utility	
E:	G:
T:	C:

Design Location	
Division	: La Crosse
County	: La Crosse
City	: LA CROSSE
Address	: KWIK TRIP WAY
T: 16N	R: 7W S: 21
Map #	: 1644676 WIS Permit :

Electric	
Feeder: LAX067 & MAF083	Voltage: 13800 3 PH
Phase: ABC	Bkup Dev ID:

Gas	
System	: Pressure :
Size	: Material :
Dead End	:

Work Order # :
 Date: 10/13/2025
 Sketch: 1 of 1
 Scale: 1" equals 175'



- S1** - BORE 350' OF 4" CONDUIT FROM 100E32 TO 100D32, PULL 3 PH #1 AL PRIMARY
- P2, P3** - REMOVE 3 PH ELBOW ARRESTERS AND INSTALL 3 PH ELBOW TERMINATORS
- S4** - ABANDON 3 PH PRIMARY
- P5** - REMOVE POLE AND ALL HARDWARE FROM POLE
- P6** - *DRAWINGS A-1, B-6, C-39, L-31* - REPLACE POLE W/ 45' CL 2, DOWN GUY/ANCHOR EAST, 3 PH DEADEND HARDWARE, AND 140T TP HARDWARE. POLE POI 100DD31. 140T POI LLA048
- S7** - PLOW 375' & BORE 75' OF 3 PH #1 AL PRIMARY
- S8** - PLOW 250' & BORE 50' OF 3 PH #1 AL PRIMARY
- P9** - SPLICE IN 3 PH #1 AL PRIMARY
- S10** - PLOW 510' & BORE 440' OF 3 PH #1 AL PRIMARY
- P11, P12, P15** - REMOVE 3 PH ELBOW ARRESTERS AND INSTALL 3 PH ELBOW TERMINATORS
- P13, P14** - SPLICE IN 3 PH #1 AL PRIMARY
- P16** - INSTALL NEW TERMINATORS INTO FUSED SIDE OF PMH11. POI LLA284
- S17, S19, S21, S22** - REMOVE 3 PH OH PRIMARY AND NEUTRAL
- P18, P23** - REMOVE POLE AND ALL HARDWARE
- P20** - REMOVE POLE AND ALL HARDWARE. TRANSFER 1200 CAP BANK TO POLE 100AA51
- P24** - TRANSFER 1200 CAP BANK TO LAX067 UNDER BUILD ON POLE 100AA51

JASON MCROBERTS
608-789-3689

FEEDER - LAX067 & MAF083
VOLTAGE - 13800 3 PH

CONSTRUCTION USE ONLY
 NO CHANGES (BUILT AS DESIGNED)
 CHANGES MADE AS INDICATED (ALL URD MUST HAVE ACTUAL MEASUREMENTS FROM THE FIELD SITE)

RFO _____
 FOREMAN _____ DATE _____
 TEAM LEADER _____

DISCLAIMER: THERE ARE NO REPRESENTATIONS OR WARRANTIES (EXPRESS OR IMPLIED) ABOUT THE ACCURACY OF THIS PRINT. THIS PRINT IS PROVIDED WITH NO CLAIM AS TO PRINT COMPLETENESS, TIMELINESS, ACCURACY OF CONTENT OR USEFULNESS. STATE LAW REQUIRES ANYONE DIGGING, GRADING OR EXCAVATING TO OBTAIN A PRIOR FIELD LOCATE OF ALL UTILITIES; THIS PRINT DOES NOT DISCHARGE THIS REQUIREMENT OR ANY OTHER REQUIREMENT. THE COMPANY AND ITS AFFILIATES ASSUME NO LEGAL RESPONSIBILITY OR LIABILITY FOR THE RECIPIENT'S USE (OR ANY OTHER PARTIES' USE) OF THE PRINT, INCLUDING THE RECIPIENT'S INTENDED PURPOSE IN USING THE PRINT. NO COMPANY EMPLOYEE OR OTHER PARTY HAS BEEN AUTHORIZED TO PROVIDE THIS PRINT FOR PLANNING OR ESTIMATING PURPOSES; RELY ON THIS PRINT AT YOUR OWN RISK. BY ACCEPTING THIS PRINT, THE RECIPIENT & ANY OTHER PARTY RECEIVING A COPY OF THE PRINT ACKNOWLEDGES AND AGREES TO THIS DISCLAIMER. For All Field Locates Call 811

THIS DOCUMENT IS XCEL ENERGY CONFIDENTIALS AND PROPRIETARY INFORMATION AND MAY NOT BE REPRODUCED IN WHOLE, OR IN PART, NOR MAY ANY OF THE INFORMATION CONTAINED HEREIN BE DISCLOSED WITHOUT THE CONSENT OF XCEL ENERGY. CONFIDENTIALS AND PROPRIETARY INFORMATION © 2019 XCEL ENERGY INC. | XCEL ENERGY IS REGISTERED TRADEMARK OF XCEL ENERGY INC