

BRIGHTSPEED LA CROSSE

3910 MORMON COULEE RD.
MORMON COULEE RD. & LOSEY BLVD. S
LA CROSSE CITY, WI

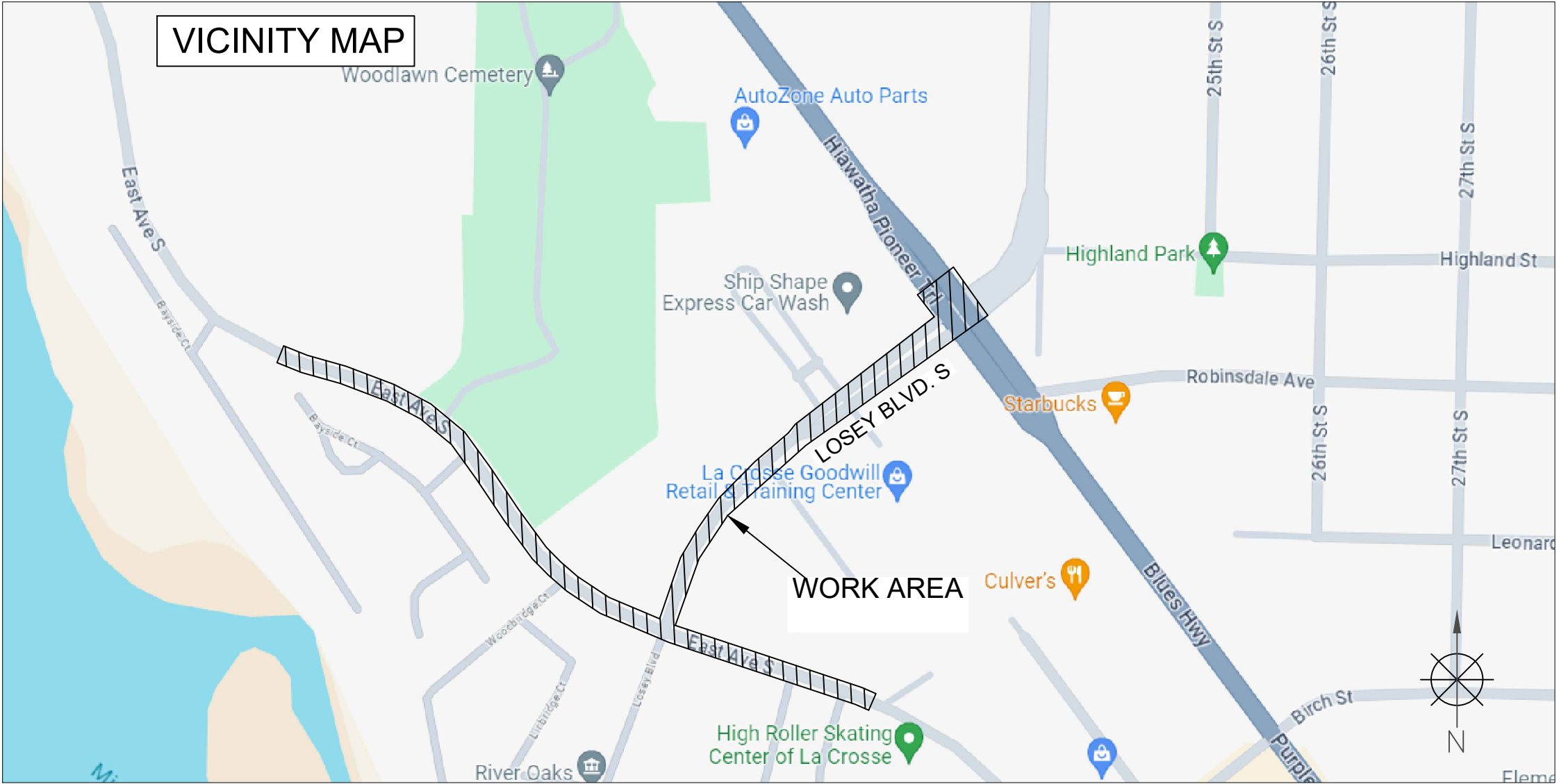

TRAFFIC CONTROL PLAN

SCOPE OF WORK	SHEET INDEX	
- BORING - HH & GROUND ROD PLACEMENT	SHEET	DESCRIPTION
	KEYMAP	VICINITY MAP & SCOPE OF WORK
	TC-1 TO TC-6	TRAFFIC CONTROL PLAN

PERMITTING AGENCY CITY OF LA CROSSE

PROPOSED PATH FOOTAGE
UG PATH = 2,957'



CHC
A CONGRUEX[®] COMPANY
9095 Rio San Diego Dr. Ste 165
San Diego, CA 92108-1694
(949)250-0004 /FAX (949)250-0006

REVISIONS			
REV.	DESCRIPTION	BY	DATE
0	INITIAL DESIGN	H.S.	5/26/24

BRIGHTSPEED

LCRSWIXB

KEYMAP
N.T.S.

3910 MORMON COULEE RD.
MORMON COULEE RD. AND LOSEY BLVD.
-BORING
WORK AREA 1 OF 1
PHASE 1 OF 5

LOSEY
BLVD. S

SPEED
LIMIT
25

FIESTA CT.

PLACE SIDEWALK CLOSED AHEAD CROSS HERE R9-11(R) AT THE NW CORNER OF LOSEY BLVD. S & EAST AVE. S

CONTACT TRANSIT AUTHORITY 5 BUSINESS DAYS PRIOR TO START OF WORK FOR TEMPORARY RELOCATION OF BUS STOP.

CONTACT PROPERTY OWNER(S) 72 HOURS PRIOR TO START OF WORK.

ACCESS TO DRIVEWAYS MUST BE MAINTAINED AT ALL TIMES.

FLAGGER TO ASSIST PEDESTRIANS THROUGH WORK AREA (SEE PED NOTES)

PEDESTRIAN CONTROL NOTES:

A DEDICATED INDIVIDUAL WILL BE ASSIGNED THE RESPONSIBILITY OF ESCORTING PEDESTRIANS THROUGH THE WORK AREA IN ACCORDANCE WITH THREE MAJOR CONSIDERATIONS:

1. PEDESTRIANS SHOULD NOT BE LED INTO DIRECT CONFLICT WITH WORK SITE VEHICLES, EQUIPMENT OR OPERATIONS
2. PEDESTRIANS SHOULD NOT BE LED INTO DIRECT CONFLICT WITH MAINLINE TRAFFIC MOVING THROUGH OR AROUND THE WORK SITE.
3. PEDESTRIANS SHOULD BE PROVIDED WITH A REASONABLY SAFE, CONVENIENT AND ACCESSIBLE PATH THAT REPLICATES AS NEARLY AS PRACTICAL THE MOST DESIRABLE CHARACTERISTICS OF THE EXISTING SIDEWALK OR FOOTPATH

MATCHLINE-A

LANE CLOSED R11-2(LANE)

LANE CLOSED R11-2(LANE)

TAKE LANE AT POCKET ORIGIN

LANE CLOSED R11-2(LANE)

FLASHING ARROW BOARD

EX. HH BORE PIT #01

FLAGGER

R3-6(R)

R3-4

R3-4

R3-4

R3-4

R3-4

R3-4

R3-4

R3-4

R3-4

R3-4

R3-4

R3-4

R3-4

R3-4

R3-4

R3-4

R3-4

R3-4

R3-4

R3-4

MORMON
COULEE RD.

MORMON
COULEE RD.

SPEED
LIMIT
35

MATCHLINE-A

LOSEY
BLVD. S

SPEED
LIMIT
25

PRIVATE
RD.

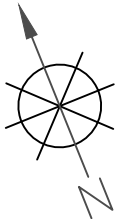

LEGEND

- * PORTABLE FLASHING BEACON (P.F.B.)
- TYPE III BARRICADE W/SIGN
- TYPE II BARRICADE W/SIGN
- CHANNELIZING DEVICE
- TRAFFIC CONE WITH CLIP ON SIGN
- TYPE I W/ SIGN
- EXISTING SIGN
- SIGNALIZED INTERSECTION
- FLASHING ARROW BOARD
- HIGH LEVEL WARNING DEVICE (FLAGTREE)
- FLAGGER
- TOW AWAY NO STOPPING ANY TIME
- EXISTING DRIVEWAY
- WORK ZONE (ACTIVITY AREA) LIMITS
- DIRECTION OF TRAFFIC (NOT PAVEMENT MARKING)

CALL 811 BEFORE YOU DIG.
WISCONSIN TOLL FREE
800-242-8511

BRIGHTSPEED

PLANS PREPARED BY:

CHC

A CONGRUEX COMPANY
9095 Rio San Diego Dr. Ste 165
San Diego, CA 92108-1694
(949) 250-0004 / FAX (949) 250-0006

REVISIONS			
REV.	DESCRIPTION	BY	DATE
0	INITIAL DESIGN	H.S.	5/26/24

BRIGHTSPEED
CONFIDENTIAL AND PROPRIETARY

LCRSWIXB

TC-1 OF TC-6

SCALE: 1:40

3837 MORMON COULEE RD.
MORMON COULEE RD. AND LOSEY BLVD.
-BORING
WORK AREA 1 OF 1
PHASE 2 OF 5

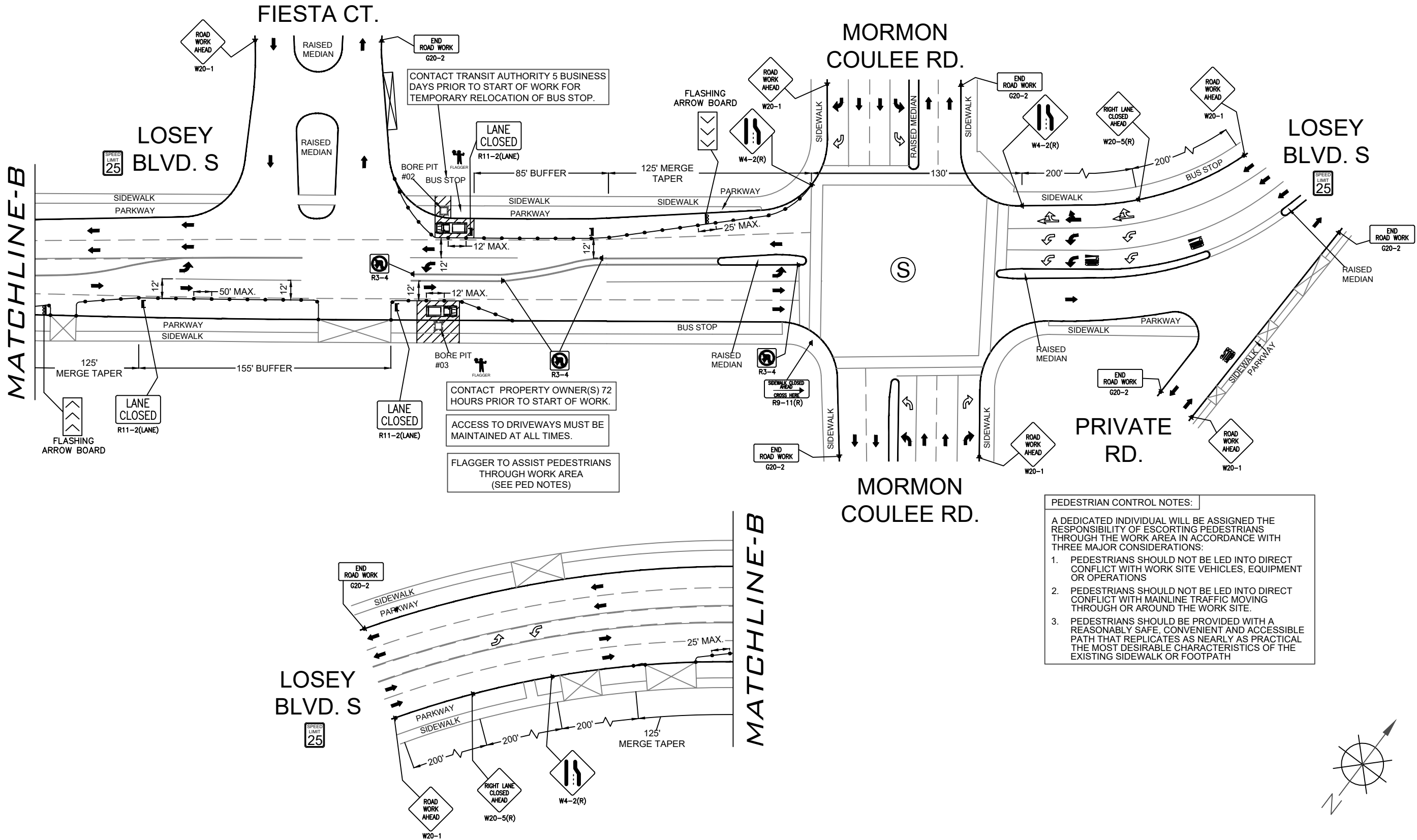

LEGEND	
	PORTABLE FLASHING BEACON (P.F.B.)
	TYPE III BARRICADE W/SIGN
	TYPE II BARRICADE W/SIGN
	CHANNELIZING DEVICE
	TRAFFIC CONE WITH CLIP ON SIGN
	TYPE I W/ SIGN
	EXISTING SIGN
	SIGNALIZED INTERSECTION
	FLASHING ARROW BOARD
	HIGH LEVEL WARNING DEVICE (FLAGTREE)
	FLAGGER
	TOW AWAY NO STOPPING ANY TIME
	EXISTING DRIVEWAY
	WORK ZONE (ACTIVITY AREA) LIMITS
	DIRECTION OF TRAFFIC (NOT PAVEMENT MARKING)

CALL 811 BEFORE YOU DIG.
WISCONSIN TOLL FREE
800-242-8511

BRIGHTSPEED

PLANS PREPARED BY:
CHC
A CONGRUEX COMPANY
9095 Rio San Diego Dr. Ste 165
San Diego, CA 92108-1694
(949) 250-0004 / FAX (949) 250-0006

REVISIONS			
REV.	DESCRIPTION	BY	DATE
0	INITIAL DESIGN	H.S.	5/26/24

BRIGHTSPEED
CONFIDENTIAL AND PROPRIETARY
LCRSWIXB

TC-2 OF TC-6

SCALE: 1:60

PEDESTRIAN CONTROL NOTES:

A DEDICATED INDIVIDUAL WILL BE ASSIGNED THE RESPONSIBILITY OF ESCORTING PEDESTRIANS THROUGH THE WORK AREA IN ACCORDANCE WITH THREE MAJOR CONSIDERATIONS:

1. PEDESTRIANS SHOULD NOT BE LED INTO DIRECT CONFLICT WITH WORK SITE VEHICLES, EQUIPMENT OR OPERATIONS
2. PEDESTRIANS SHOULD NOT BE LED INTO DIRECT CONFLICT WITH MAINLINE TRAFFIC MOVING THROUGH OR AROUND THE WORK SITE.
3. PEDESTRIANS SHOULD BE PROVIDED WITH A REASONABLY SAFE, CONVENIENT AND ACCESSIBLE PATH THAT REPLICATES AS NEARLY AS PRACTICAL THE MOST DESIRABLE CHARACTERISTICS OF THE EXISTING SIDEWALK OR FOOTPATH

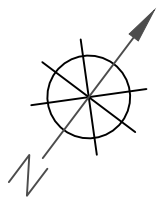

3411 LOSEY BLVD.
EAST AVE. S AND LOSEY BLVD.
-BORING, HH & GROUND ROD PL.
WORK AREA 1 OF 1
PHASE 3 OF 5

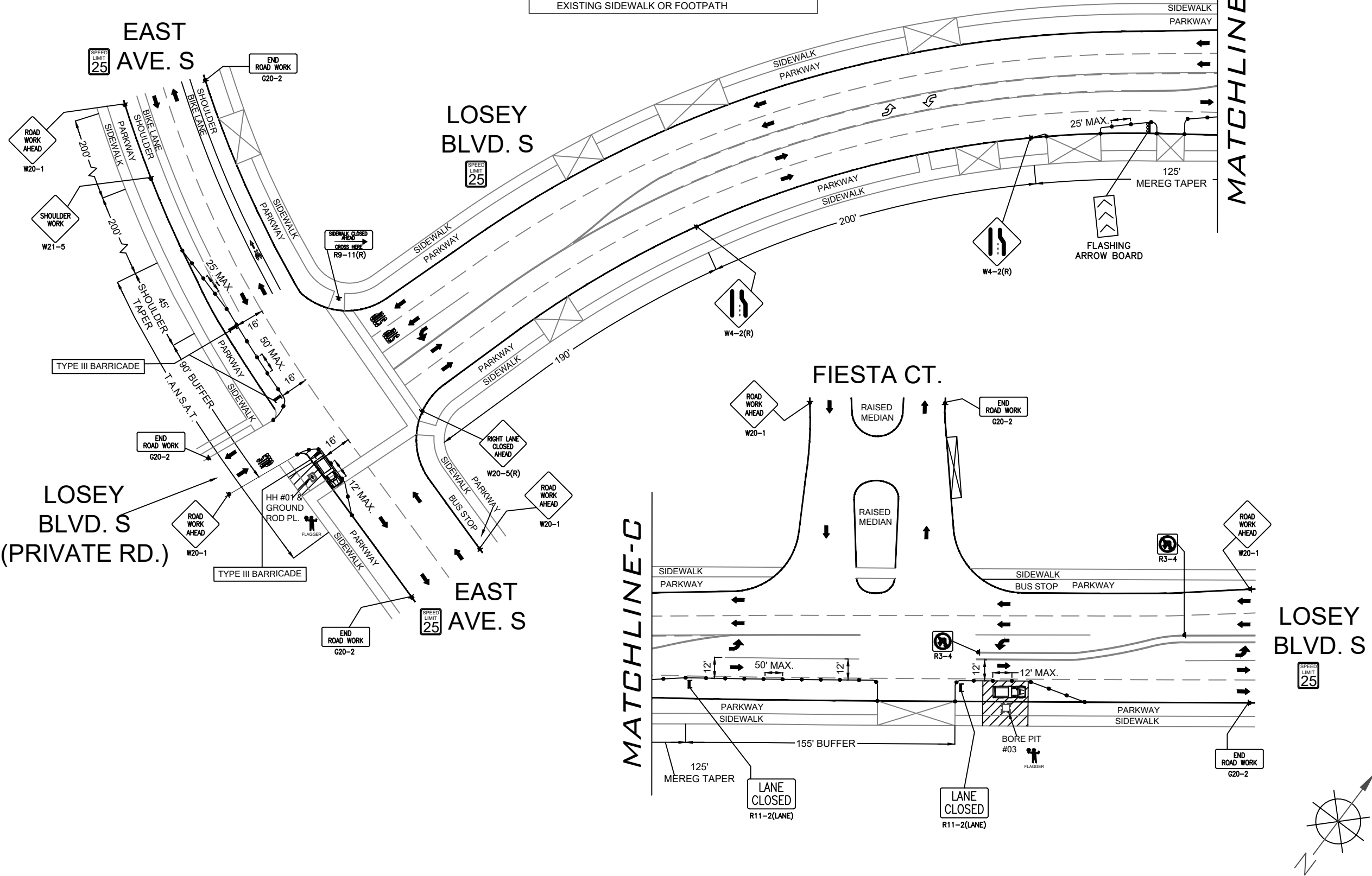

PEDESTRIAN CONTROL NOTES:

A DEDICATED INDIVIDUAL WILL BE ASSIGNED THE RESPONSIBILITY OF ESCORTING PEDESTRIANS THROUGH THE WORK AREA IN ACCORDANCE WITH THREE MAJOR CONSIDERATIONS:

1. PEDESTRIANS SHOULD NOT BE LED INTO DIRECT CONFLICT WITH WORK SITE VEHICLES, EQUIPMENT OR OPERATIONS
2. PEDESTRIANS SHOULD NOT BE LED INTO DIRECT CONFLICT WITH MAINLINE TRAFFIC MOVING THROUGH OR AROUND THE WORK SITE.
3. PEDESTRIANS SHOULD BE PROVIDED WITH A REASONABLY SAFE, CONVENIENT AND ACCESSIBLE PATH THAT REPLICATES AS NEARLY AS PRACTICAL THE MOST DESIRABLE CHARACTERISTICS OF THE EXISTING SIDEWALK OR FOOTPATH

CONTACT PROPERTY OWNER(S) 72 HOURS PRIOR TO START OF WORK.

ACCESS TO DRIVEWAYS MUST BE MAINTAINED AT ALL TIMES.

FLAGGER TO ASSIST PEDESTRIANS THROUGH WORK AREA (SEE PED NOTES)

LEGEND

✱	PORTABLE FLASHING BEACON (P.F.B.)
≡	TYPE III BARRICADE W/SIGN
⋈	TYPE II BARRICADE W/SIGN
•	CHANNELIZING DEVICE
⬮	TRAFFIC CONE WITH CLIP ON SIGN
⬮	TYPE I W/ SIGN
⬮	EXISTING SIGN
Ⓢ	SIGNALIZED INTERSECTION
⬮	FLASHING ARROW BOARD
⬮	HIGH LEVEL WARNING DEVICE (FLAGTREE)
⬮	FLAGGER
TANSAT	TOW AWAY NO STOPPING ANY TIME
⬮	EXISTING DRIVEWAY
⬮	WORK ZONE (ACTIVITY AREA) LIMITS
➡	DIRECTION OF TRAFFIC (NOT PAVEMENT MARKING)

CALL 811 BEFORE YOU DIG.
WISCONSIN TOLL FREE
800-242-8511

BRIGHTSPEED

PLANS PREPARED BY:

CHC
A CONGRUEX COMPANY
9095 Rio San Diego Dr. Ste 165
San Diego, CA 92108-1694
(949) 250-0004 / FAX (949) 250-0006

REVISIONS			
REV.	DESCRIPTION	BY	DATE
0	INITIAL DESIGN	H.S.	5/26/24

BRIGHTSPEED
CONFIDENTIAL AND PROPRIETARY

LCRSWIXB

TC-3 OF TC-6

SCALE: 1:60

3462 EAST AVE. S
EAST AVE. S AND LOSEY BLVD.
-BORING, HH & GROUND ROD PL.
WORK AREA 1 OF 1
PHASE 4 OF 5

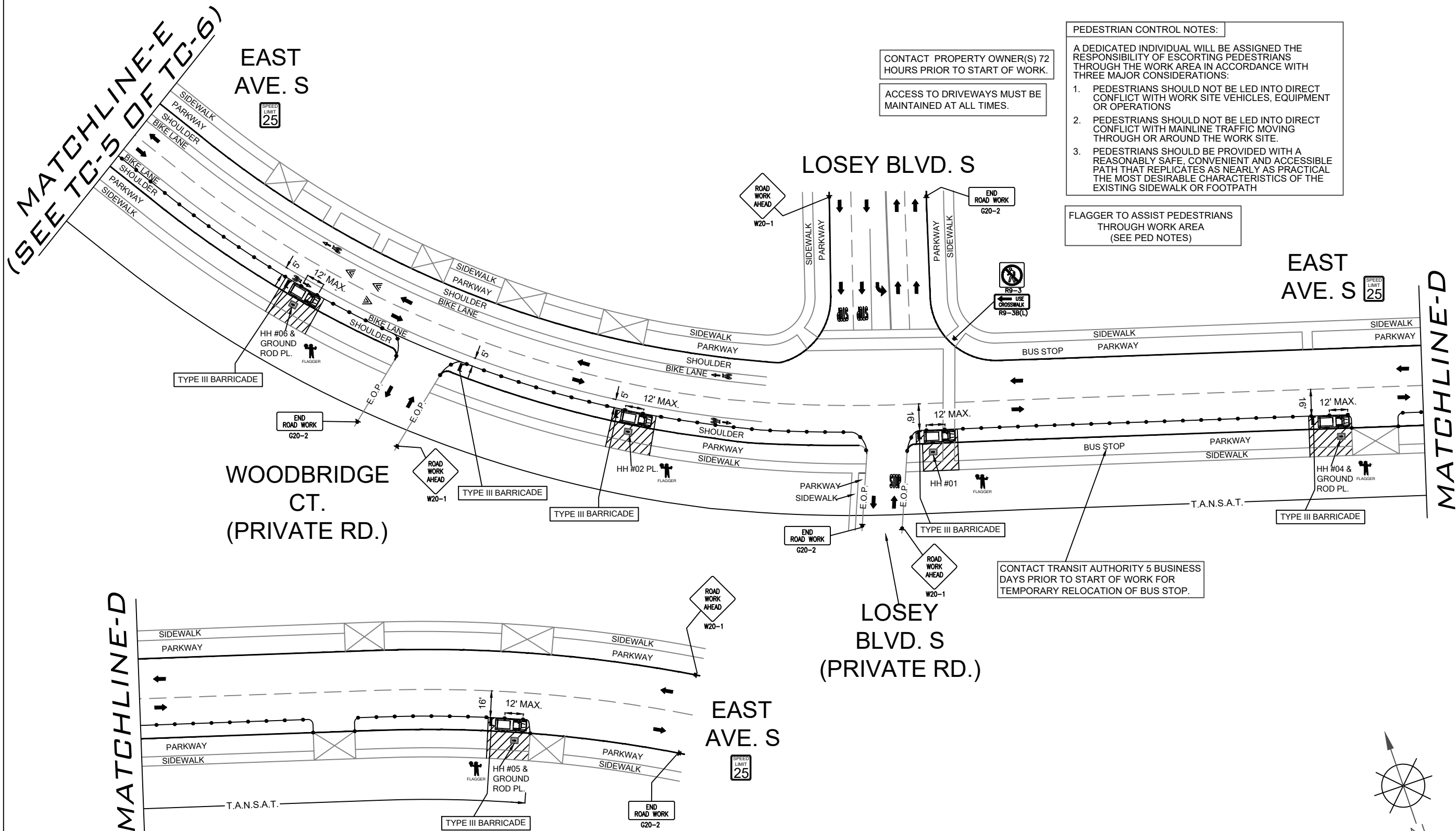

LEGEND	
	PORTABLE FLASHING BEACON (P.F.B.)
	TYPE III BARRICADE W/SIGN
	TYPE II BARRICADE W/SIGN
	CHANNELIZING DEVICE
	TRAFFIC CONE WITH CLIP ON SIGN
	TYPE I W/ SIGN
	EXISTING SIGN
	SIGNALIZED INTERSECTION
	FLASHING ARROW BOARD
	HIGH LEVEL WARNING DEVICE (FLAGTREE)
	FLAGGER
	TOW AWAY NO STOPPING ANY TIME
	EXISTING DRIVEWAY
	WORK ZONE (ACTIVITY AREA) LIMITS
	DIRECTION OF TRAFFIC (NOT PAVEMENT MARKING)

CALL 811 BEFORE YOU DIG.
WISCONSIN TOLL FREE
800-242-8511

BRIGHTSPEED

PLANS PREPARED BY:
XCHC
A CONGRUEX COMPANY
9095 Rio San Diego Dr. Ste 165
San Diego, CA 92108-1694
(949) 250-0004 / FAX (949) 250-0006

REVISIONS			
REV.	DESCRIPTION	BY	DATE
0	INITIAL DESIGN	H.S.	5/26/24

BRIGHTSPEED
CONFIDENTIAL AND PROPRIETARY
LCRSWIXB







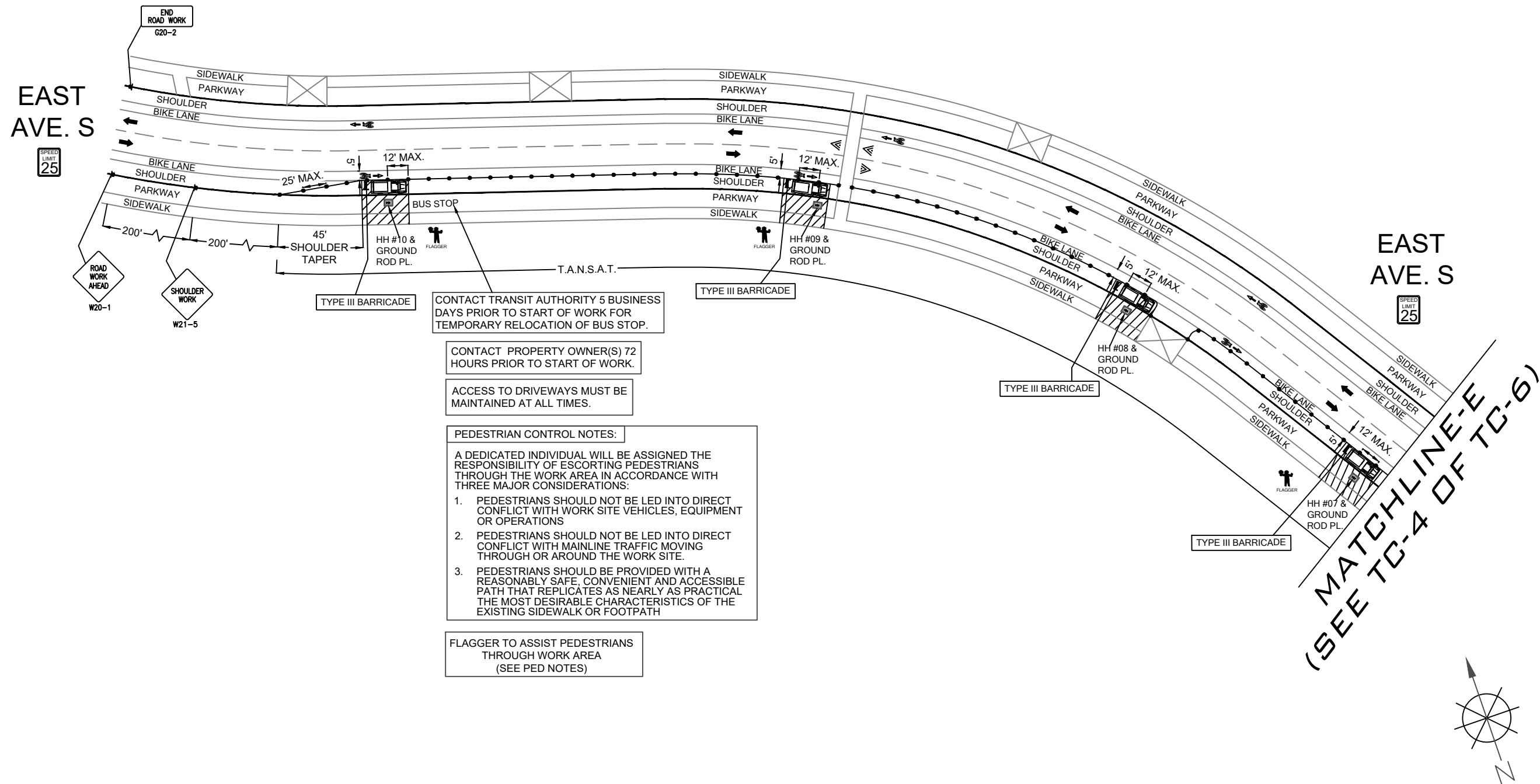







TC-4 OF TC-6

SCALE: 1:60

3462 EAST AVE. S
EAST AVE. S AND LOSEY BLVD.
-BORING, HH & GROUND ROD PL.
WORK AREA 1 OF 1
PHASE 4 OF 5



LEGEND

- | | |
|---|--|
|  | PORTABLE FLASHING BEACON
(P.F.B.) |
|  | TYPE III BARRICADE W/SIGN |
|  | TYPE II BARRICADE W/SIGN |
|  | CHANNELIZING DEVICE |
|  | TRAFFIC CONE WITH
CLIP ON SIGN |
|  | TYPE I W/ SIGN |
|  | EXISTING SIGN |
|  | SIGNALIZED INTERSECTION |
|  | FLASHING ARROW BOARD |
|  | HIGH LEVEL WARNING DEVICE
(FLAGTREE) |
|  | FLAGGER |
| TANSAT | TOW AWAY NO STOPPING
ANY TIME |
|  | EXISTING DRIVEWAY |
|  | WORK ZONE
(ACTIVITY AREA) LIMITS |
|  | DIRECTION OF TRAFFIC
(NOT PAVEMENT MARKING) |

CALL 811 BEFORE YOU DIG.
WISCONSIN TOLL FREE
800-242-8511

BRIGHTSPEED

PLANS PREPARED BY:

XCHC
A CONGRUEX® COMPANY
9095 Rio San Diego Dr. Ste 165
San Diego, CA 92108-1694
(949) 250-0004 / FAX (949) 250-0006

REVISIONS			
REV.	DESCRIPTION	BY	DATE
0	INITIAL DESIGN	H.S.	5/26/24

BRIGHTSPEED
CONFIDENTIAL AND PROPRIETARY

LCRSWIXB

TC-5 OF TC-6

SCALE: 1:60

3462 LOSEY BLVD. S
EAST AVE. S AND LOSEY BLVD.
-BORING, HH & GROUND ROD PL.
WORK AREA 1 OF 1
PHASE 5 OF 5

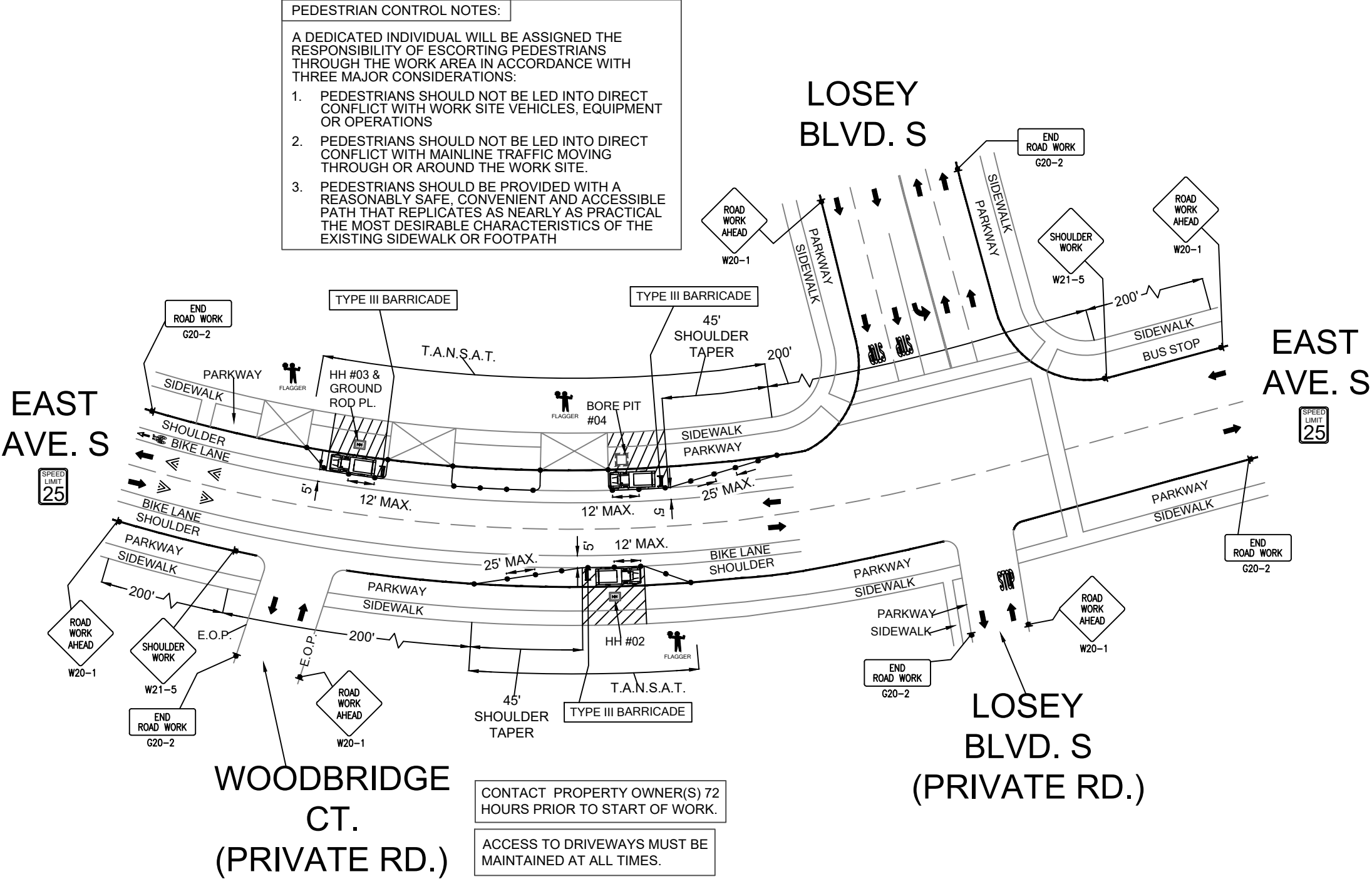

LEGEND	
✱	PORTABLE FLASHING BEACON (P.F.B.)
≡	TYPE III BARRICADE W/SIGN
✕	TYPE II BARRICADE W/SIGN
•	CHANNELIZING DEVICE
⬮	TRAFFIC CONE WITH CLIP ON SIGN
⬮	TYPE I W/ SIGN
⬮	EXISTING SIGN
Ⓢ	SIGNALIZED INTERSECTION
⬮	FLASHING ARROW BOARD
⬮	HIGH LEVEL WARNING DEVICE (FLAGTREE)
⬮	FLAGGER
TANSAT	TOW AWAY NO STOPPING ANY TIME
⬮	EXISTING DRIVEWAY
⬮	WORK ZONE (ACTIVITY AREA) LIMITS
➡	DIRECTION OF TRAFFIC (NOT PAVEMENT MARKING)

CALL 811 BEFORE YOU DIG.
WISCONSIN TOLL FREE
800-242-8511

BRIGHTSPEED

PLANS PREPARED BY:

CHC
A CONGRUEX COMPANY
9095 Rio San Diego Dr. Ste 165
San Diego, CA 92108-1694
(949) 250-0004 / FAX (949) 250-0006

REVISIONS			
REV.	DESCRIPTION	BY	DATE
0	INITIAL DESIGN	H.S.	5/26/24

BRIGHTSPEED
CONFIDENTIAL AND PROPRIETARY

LCRSWIXB

TC-6 OF TC-6

SCALE: 1:50