



EXCAVATION WITHIN RIGHT-OF-WAY PERMIT
 Engineering Dept. • Phone: (608) 789-7505 • Fax: (608) 789-7367
<http://www.cityoflacrosse.org> engineering@cityoflacrosse.org

Permit No.:
Date:
Munis #:

STATUS:

CONTRACTOR	Name: <u>Hess Excavating</u>			
	Address: <u>W 3939 CTH M</u>			
	City: <u>Coon Valley</u>		State: <u>WI</u>	Zip Code: <u>54623</u>
	Phone: <u>788 1763</u>	Cell: <u>780 1370</u>	Fax: <u>788 5257</u>	Email: <u>HessX5@Janio.com</u>

PROJECT	Location of Excavation: <u>3183 Losey Blvd. S.</u>		
	<u>Open Cut</u> (Circle One) Boring		
	Area to be excavated (check all that apply): <input checked="" type="checkbox"/> Street <input checked="" type="checkbox"/> Blvd. <input checked="" type="checkbox"/> Curb/Gutter <input checked="" type="checkbox"/> Sidewalk <input type="checkbox"/> Alley <input type="checkbox"/> Other		
	Number of Traffic Lanes that will Close: <u>3</u>		Number of Parking Lanes that will Close: <u> </u>
	Purpose of excavation (Check all that apply): <input checked="" type="checkbox"/> Water <input checked="" type="checkbox"/> San. Sewer <input type="checkbox"/> Storm Water <input type="checkbox"/> Gas <input type="checkbox"/> Electrical <input type="checkbox"/> Communication <input type="checkbox"/> Other:		
Estimated Start Date: <u>8-29-19</u>		Completion Date: <u>8-29-19</u>	

Note #1: The undersigned understands and agrees to the following: 1) The permitted work shall comply with all permit provisions and conditions listed on and attached to this form; 2) That insurance requirements shall be met prior to approval either by submitting information with application or by keeping current information on file with the Engineering Department.; 3) The applicant shall contact City Dispatch and the City Traffic Engineer 24 hours prior to the closure of any traffic lanes and shall provide an estimate of the duration of closure. Temporary traffic control shall be provided and maintained by the applicant and shall comply with Part 6 of the Manual on Uniform Traffic Control Devices (MUTCD).

Note #2: Once invoiced, application fees may not be refunded.
 Note #3: Any Excavation within an Archaeological District boundary described in Municipal Code Sec. 20-117 shall Follow City Ordinance Sections 20-119 and 20-120 Regulations.

Michael Hess VP 8-16-19
 (PRINT) AUTHORIZED REPRESENTATIVE TITLE DATE

Michael Hess
 (SIGN) AUTHORIZED REPRESENTATIVE

Office Use Only	Customer #:	Invoice #:
	Permit Issued By:	
	Permit Conditions:	

CENTRAL STATE CONSTRUCTION, LLC.

FAX 608-723-6705

TO Eng. Dept. City of La Crosse *ATTN: Matt & Jay*

FROM Jim Bierman

Number of Pages 3

Date ~~7-20-19~~ 8-16-19

North Bound Losey Blvd. Closure
& Detour Route

Traffic Control Services
608-372-4203 or 608-723-4551

CENTRAL STATE CON. 336 N JEFFERSON STREET LANCASTER, WI, 53813 608-723-4551

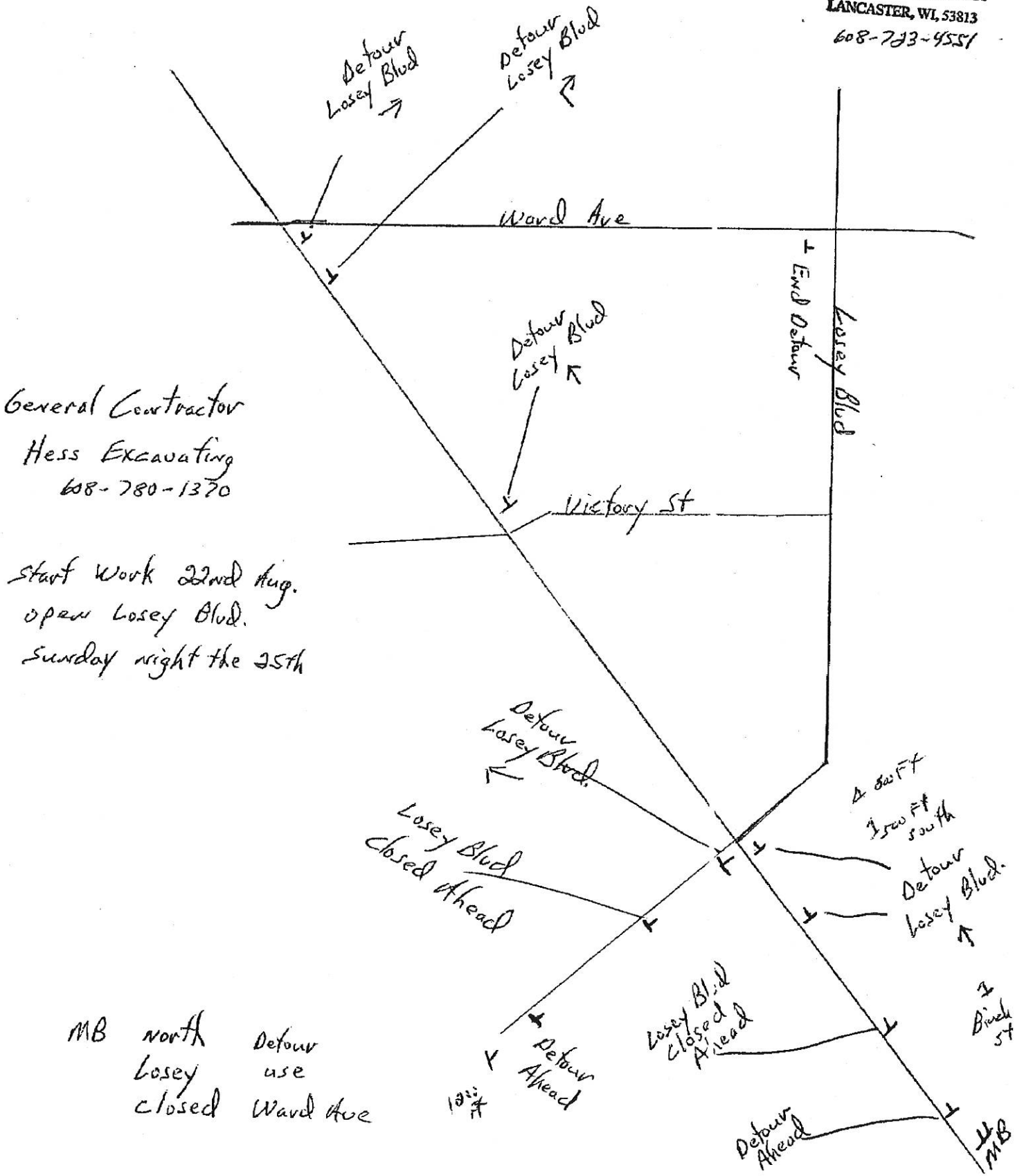

General Contractor Hess Excavating 608-780-1370

Start Work 22nd Aug. open Losey Blvd. Sunday night the 25th

MB north Detour Losey use closed Ward Ave

CENTRAL STATE Court
336 N JEFFERSON STREET
LANCASTER, WI 53813

