

APPLICATION TO OWN, KEEP AND/OR HONEYBEES   
 IN THE CITY OF LA CROSSE

License Period: <sup>July 14<sup>th</sup></sup> ~~January 1, 2017~~ to December 31, 2021 (fifth year of the licensure period)

APPLICANT:

Barrett Klein

PROPERTY ADDRESS WHERE HONEYBEES WILL BE KEPT:

1632 Park Avenue, La Crosse, WI 54601

PROPERTY OWNER(S):

Barrett Klein, Kristie Klein

*If applicant is not the owner, please provide written documentation from the owner that they have been notified.   
 Not applicable for renewal.*

Is the property  ONE-FAMILY dwelling or  TWO-FAMILY dwelling? (Check One)   
 *If two-family, provide written documentation from other occupant that they have been notified.   
 Not applicable for renewal.*

**Attach a scale drawing showing property lot lines, location of apiary and distance from any primary buildings on abutting lots and distance from any public sidewalk(s).**

**If colony is kept less than twenty-five (25) feet from a property line of the lot upon which the apiary is located, and any entrance to the hive faces that lot line; include location, height and description of flyway barrier required pursuant to Sec. 6-18(c)(1).**

**Applying for and obtaining a beekeeping license DOES NOT provide any authority to violate any restrictive covenants that govern the property where you reside or intend to keep honeybees. Please review any Declaration of Restrictions or Restrictive Covenants that apply to the property prior to applying for a beekeeping license. No permit fees will be refunded once they are paid.**

**The above applicant(s) hereby makes application for a license to own, harbor and/or keep honeybees at the above property address within the City of La Crosse pursuant to provisions of Section 6-18 of the Code of Ordinances for the City of La Crosse.**

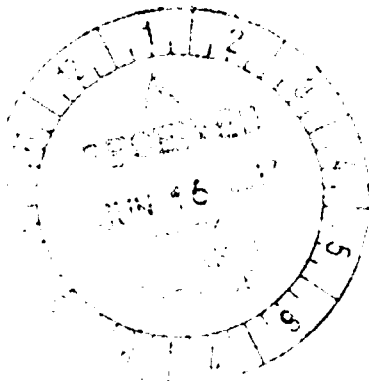

Barrett Klein   
 (signature)

\_\_\_\_\_  
(signature)

608-799-8181   
 (telephone)

6/1/2017   
 (date)

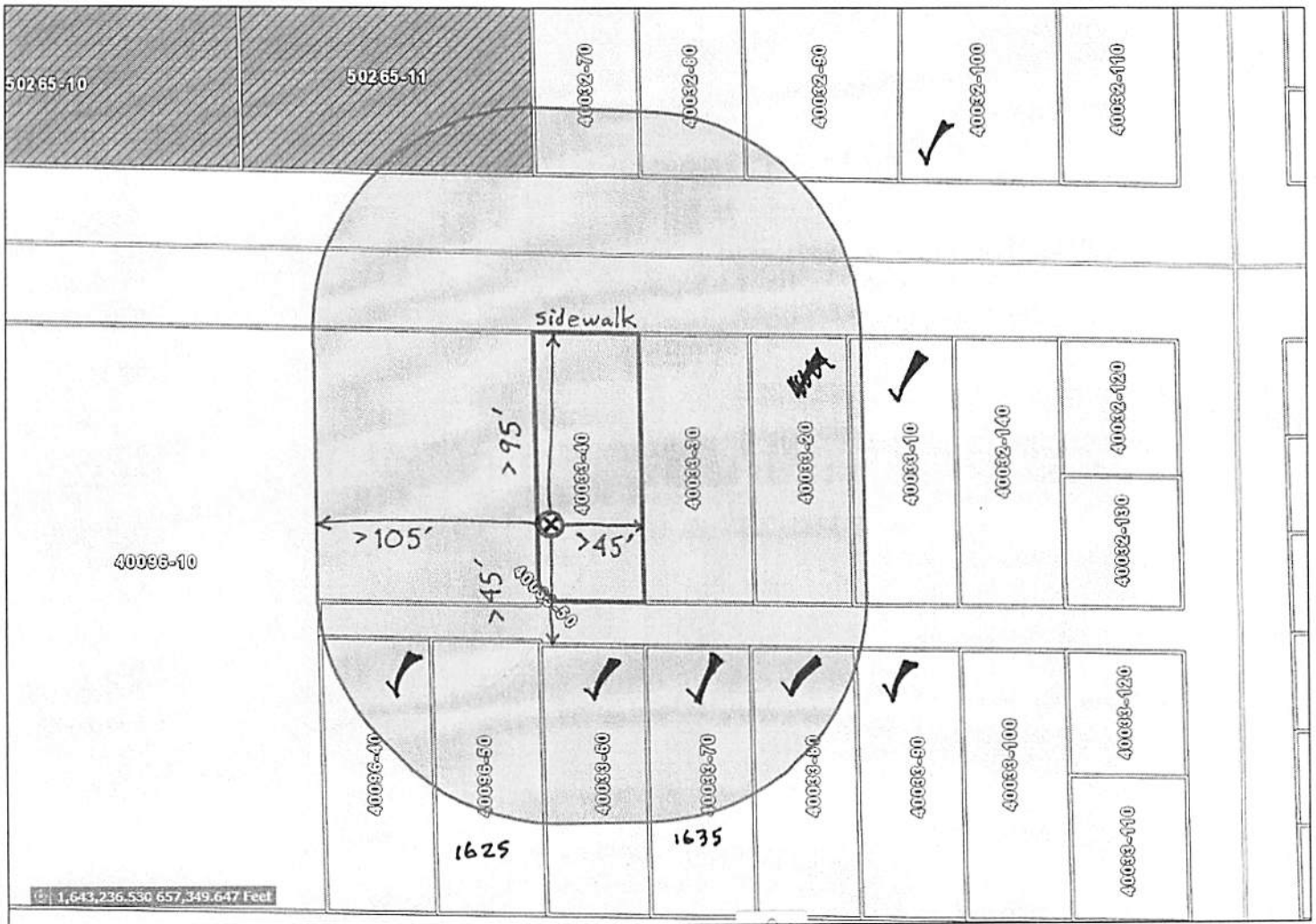

Tax Parcel Number	OwnerName	Property Address	USE
17-40033-80	✓ AARON J, EMILY L JUNEAU ✓	1641 DENTON ST	Owner Occupied
17-40032-90	ANTHONY J, MARY J DOERING	1643 PARK AVE	Owner Occupied
17-40033-30	BREEANNA BRECKEL	1636 PARK AVE	Owner Occupied
17-40033-20	HENRY K, KAREN HORSTMAN	1640 PARK AVE	Owner Occupied
17-40033-70	✓ JUDITH M SKIFTON	1635 DENTON ST	Owner Occupied
17-40032-70	KARL L, MARY K SCHUBERT	1633 PARK AVE	Owner Occupied
17-40033-10	✓ KATHRYN L D OTTOW	1644 PARK AVE	Owner Occupied
17-40033-90	✓ MAGGIE E BINA DAVID E DAVIS ✓	1647 DENTON ST	Owner Occupied
17-40096-50	MELAINE K JOHNSON	1625 DENTON ST	Owner Occupied
17-40033-60	✓ RONALD W, ELIZABETH I KINDSCHY ✓	1633 DENTON ST	Owner Occupied
17-40096-40	✓ SARAH SODKO	1621 DENTON ST	Owner Occupied
17-40032-80	THOMAS J HALASKA	1635 PARK AVE	Owner Occupied
17-40033-40	BARRETT KLEIN	1632 PARK AVE	Applicant
17-50265-11	CITY OF LACROSSE	1616 FARNAM ST	Library
17-40033-50	CITY OF LACROSSE	1630 PARK AVE	Library
17-40096-10	MOUNT CALVARY EVANGELICAL LUTHERAN CHURCH	1601 DENTON ST	Church
17-40096-10	MOUNT CALVARY EVANGELICAL LUTHERAN CHURCH	1602 PARK AVE	Church
17-40096-10	MOUNT CALVARY EVANGELICAL LUTHERAN CHURCH	1614 PARK AVE	Church

**WRITTEN APPROVALS  
ALLOWING FOR BEEKEEPING IN THE CITY OF LA CROSSE**

We the undersigned, representing at least 50% of the owner-occupied neighboring property owners of the following property address in which the applicant is applying for a Beekeeping License, do hereby approve said license being granted in accordance with City of La Crosse Sec. 6-18.

Applicant: Barrett Klein Property Address: 1632 Park Ave.

- 
- > NAME (Print) Beth Kindschy ADDRESS 1633 Denton St. LaCrosse  
SIGNATURE Beth Kindschy DATE 6/1/17
  - > NAME (Print) ~~Mark S. Kindschy~~ <sup>Ronald</sup> Ronald Kindschy ADDRESS 1633 Denton St. LaCrosse  
SIGNATURE Ronald Kindschy DATE 6/1/17
  - > NAME (Print) Aaron Jensen ADDRESS 1641 Denton St. La Crosse  
SIGNATURE [Signature] DATE 6/1/17
  - > NAME (Print) Emily Juneau ADDRESS 11041 Denton St. La Crosse  
SIGNATURE Emily Juneau DATE 6/1/17
  - > NAME (Print) Maggie Bina ADDRESS 11647 Denton St. LaCrosse  
SIGNATURE Maggie Bi DATE 6-1-17
  - > NAME (Print) David Davis ADDRESS 11647 Denton St.  
SIGNATURE David Davis DATE 6-1-17
  - > NAME (Print) Sarah Soderu ADDRESS 1621 Denton St. LaCrosse  
SIGNATURE Sarah Soderu DATE 6/1/2017
  - > NAME (Print) CATHERINE PORAFF ADDRESS 1649 Park Ave LA Crosse  
SIGNATURE Catherine Poraff DATE 6/1/2017
  - > NAME (Print) KATE OTTOW ADDRESS 1644 Park Ave  
SIGNATURE Kate Ottow DATE 6/1/17

Note: As each tax parcel counts as one (1) towards the requisite number needed, all owners must sign. For example, if only the husband signs for a property that both husband and wife own, only one-half (1/2) of the parcel is counted.

**WRITTEN APPROVALS  
ALLOWING FOR BEEKEEPING IN THE CITY OF LA CROSSE**

We the undersigned, representing at least 50% of the owner-occupied neighboring property owners of the following property address in which the applicant is applying for a Beekeeping License, do hereby approve said license being granted in accordance with City of La Crosse Sec. 6-18.

Applicant: Barrett Klein Property Address: 1632 Park Ave.

- 
- 
- > NAME (Print) Judith Skifton ADDRESS 1635 Newton St. LaCrosse, WI  
SIGNATURE Judith Skifton DATE June 15, 2017
  
  - > NAME (Print) \_\_\_\_\_ ADDRESS \_\_\_\_\_  
SIGNATURE \_\_\_\_\_ DATE \_\_\_\_\_
  
  - > NAME (Print) \_\_\_\_\_ ADDRESS \_\_\_\_\_  
SIGNATURE \_\_\_\_\_ DATE \_\_\_\_\_
  
  - > NAME (Print) \_\_\_\_\_ ADDRESS \_\_\_\_\_  
SIGNATURE \_\_\_\_\_ DATE \_\_\_\_\_
  
  - > NAME (Print) \_\_\_\_\_ ADDRESS \_\_\_\_\_  
SIGNATURE \_\_\_\_\_ DATE \_\_\_\_\_
  
  - > NAME (Print) \_\_\_\_\_ ADDRESS \_\_\_\_\_  
SIGNATURE \_\_\_\_\_ DATE \_\_\_\_\_
  
  - > NAME (Print) \_\_\_\_\_ ADDRESS \_\_\_\_\_  
SIGNATURE \_\_\_\_\_ DATE \_\_\_\_\_
  
  - > NAME (Print) \_\_\_\_\_ ADDRESS \_\_\_\_\_  
SIGNATURE \_\_\_\_\_ DATE \_\_\_\_\_
  
  - > NAME (Print) \_\_\_\_\_ ADDRESS \_\_\_\_\_  
SIGNATURE \_\_\_\_\_ DATE \_\_\_\_\_

*Note: As each tax parcel counts as one (1) towards the requisite number needed, all owners must sign. For example, if only the husband signs for a property that both husband and wife own, only one-half (1/2) of the parcel is counted.*

**NOTICE OF HEARING ON  
APPLICATION TO OWN, KEEP AND/OR HARBOR HONEYBEES**

TO WHOM IT MAY CONCERN:

Notice is hereby given that the Common Council of the City of La Crosse, by its Judiciary & Administration Committee, will consider the application of **Barrett Klein** for a license pursuant to Sec. 6-18 of the La Crosse Municipal Code to own, keep and/or harbor honeybees at 1632 Park Ave., La Crosse, WI for the license period **July 14<sup>th</sup>, 2017 to December 31<sup>st</sup>, 2021**.

Said meeting will be held at 6:00 p.m. on **Monday, July 3<sup>rd</sup>, 2017**, in the Council Chambers in City Hall in the City of La Crosse, La Crosse County, Wisconsin.

Final action will be determined by the Common Council on **Thursday, July 13<sup>th</sup>, 2017** at 6:00 p.m. also in the Council Chamber of City Hall.

You are further notified that any person affected may be heard, and may appear in person or by attorney, or may file a letter of objection in the office of the City Clerk.

This notice is given pursuant to the order of the Common Council of the City of La Crosse.

Dated this 19<sup>th</sup> day of June, 2017.



Teri Lehke, City Clerk  
City of La Crosse, Wisconsin

OwnerName

AARON J, EMILY L JUNEAU

ANTHONY J, MARY J DOERING

BARRETT KLEIN

BREANNA BRECKEL

HENRY K, KAREN HORSTMAN

JUDITH M SKIFTON

KARL L, MARY K SCHUBERT

KATHRYN L D OTTOW

MAGGIE E BINA DAVID E DAVIS

MELAINE K JOHNSON

MOUNT CALVARY EVANGELICAL LUTHERAN CHURCH

RONALD W, ELIZABETH I KINDSCHY

SARAH SODKO

THOMAS J HALASKA

MailingLine4

1641 DENTON ST

1643 PARK AVE

1632 PARK AVE

1636 PARK AVE

1640 PARK AVE

1635 DENTON ST

1633 PARK AVE

1644 PARK AVE

1647 DENTON ST

1625 DENTON ST

1602 PARK AVE

1633 DENTON ST

1621 DENTON ST

1635 PARK AVE

MailingLine5

LA CROSSE WI 54601-5770

LA CROSSE WI 54601-5745

LA CROSSE WI 54601-5754

LA CROSSE WI 54601

LA CROSSE WI 54601

LA CROSSE WI 54601

LA CROSSE WI 54601-5745

LA CROSSE WI 54601

LA CROSSE WI 54601-5770

LA CROSSE WI 54601-5770

LA CROSSE WI 54601

LA CROSSE WI 54601-5770

LA CROSSE WI 54601-5770

LA CROSSE WI 54601-5745

OwnerName	MailingLine4	MailingLine5	Property Address	OBJECTID	Tax Parcel Number
AARON J, EMILY L JUNEAU	1641 DENTON ST	LA CROSSE WI 54601-5770	1641 DENTON ST	19177	17-40033-80
ANTHONY J, MARY J DOERING	1643 PARK AVE	LA CROSSE WI 54601-5745	1643 PARK AVE	18793	17-40032-90
BARRETT KLEIN	1632 PARK AVE	LA CROSSE WI 54601-5754	1632 PARK AVE	18959	17-40033-40
BREEANNA BRECKEL	1636 PARK AVE	LA CROSSE WI 54601	1636 PARK AVE	18960	17-40033-30
CITY OF LACROSSE	400 LA CROSSE ST	LA CROSSE WI 54601	1616 FARNAM ST	18567	17-50265-11
CITY OF LACROSSE	400 LA CROSSE ST	LA CROSSE WI 54601	1630 PARK AVE	19132	17-40033-50
HENRY K, KAREN HORSTMAN	1640 PARK AVE	LA CROSSE WI 54601	1640 PARK AVE	18961	17-40033-20
JUDITH M SKIFTON	1635 DENTON ST	LA CROSSE WI 54601	1635 DENTON ST	19176	17-40033-70
KARL L, MARY K SCHUBERT	1633 PARK AVE	LA CROSSE WI 54601-5745	1633 PARK AVE	18790	17-40032-70
KATHRYN L D OTTOW	1644 PARK AVE	LA CROSSE WI 54601	1644 PARK AVE	18962	17-40033-10
MAGGIE E BINA DAVID E DAVIS	1647 DENTON ST	LA CROSSE WI 54601-5770	1647 DENTON ST	19178	17-40033-90
MELAINE K JOHNSON	1625 DENTON ST	LA CROSSE WI 54601-5770	1625 DENTON ST	19168	17-40096-50
MOUNT CALVARY EVANGELICAL LUTHERAN CHURCH	1602 PARK AVE	LA CROSSE WI 54601	1601 DENTON ST	18956	17-40096-10
MOUNT CALVARY EVANGELICAL LUTHERAN CHURCH	1602 PARK AVE	LA CROSSE WI 54601	1602 PARK AVE	18957	17-40096-10
MOUNT CALVARY EVANGELICAL LUTHERAN CHURCH	1602 PARK AVE	LA CROSSE WI 54601	1614 PARK AVE	18958	17-40096-10
RONALD W, ELIZABETH I KINDSCHY	1633 DENTON ST	LA CROSSE WI 54601-5770	1633 DENTON ST	19175	17-40033-60
SARAH SODKO	1621 DENTON ST	LA CROSSE WI 54601-5770	1621 DENTON ST	19166	17-40096-40
THOMAS J HALASKA	1635 PARK AVE	LA CROSSE WI 54601-5745	1635 PARK AVE	18792	17-40032-80