

WM GOHRES ADDITION BLOCK 8

N
↑
1"=20' H
1"= 2' V
ELEVATIONS SHOWN
ARE NAVD 1988

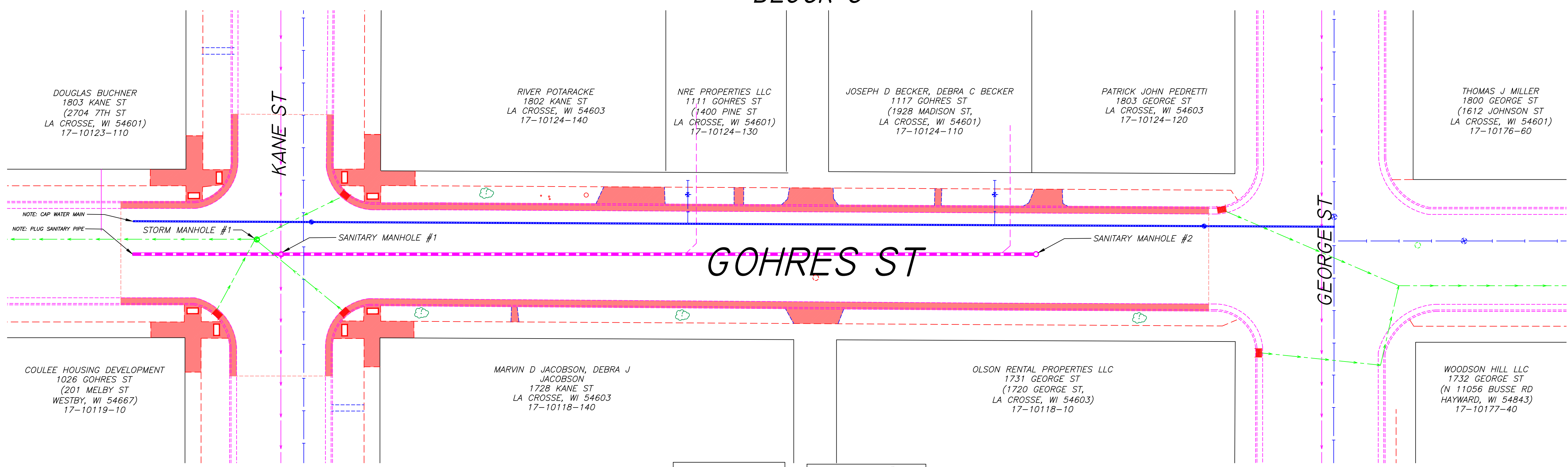

NOTE
CONTRACTOR IS TO VERIFY LOCATION OF ALL UTILITIES PRIOR TO ANY CONSTRUCTION

SANITARY MANHOLE #1
NOTE: REPLACE EXISTING
48" DIAMETER
STA. 1+06
RIM 652.118
INV. N 642.87
INV. E 642.97
INV. S 642.92
INV. W 642.97

STORM MANHOLE #1
NOTE: REPLACE EXISTING
48" DIAMETER
STA. 0+98
RIM 652.05
INV. E 646.97
INV. W 646.96
INV. S 646.94
INV. SE 647.07

SANITARY MANHOLE #2
NOTE: NEW
48" DIAMETER
STA. 3+72
RIM 652.3
INV. W 644.03

BENCHMARKS
TOP NUT OF HYDRANT
GOHRES ST & GEORGE ST 655.12
GOHRES ST & KANE ST 655.52

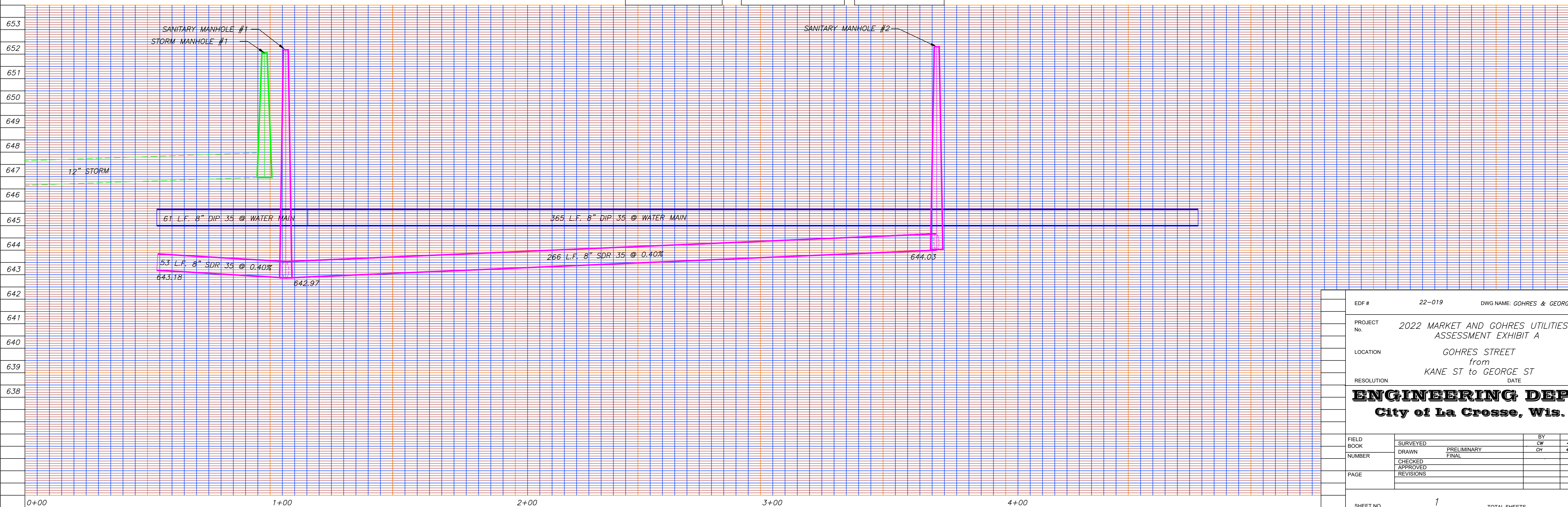

EDF #	22-019	DWG NAME:	GOHRES & GEORGE ST.dwg
PROJECT No.	2022 MARKET AND GOHRES UTILITIES ASSESSMENT EXHIBIT A		
LOCATION	GOHRES STREET from KANE ST to GEORGE ST		
RESOLUTION	DATE		
ENGINEERING DEPT. City of La Crosse, Wis.			
FIELD BOOK	SURVEYED	BY	DATE
NUMBER	DRAWN	CW	4/14/2022
PAGE	CHECKED	CH	4/14/2022
	APPROVED		
	REVISIONS		
SHEET NO.	1	TOTAL SHEETS	1