

**APPLICATION TO OWN, KEEP AND/OR HARBOR CHICKENS
IN THE CITY OF LA CROSSE**

License Period: January 1, 14 to December 31, 14
License Fee: \$10.00

Payment Amount: 10.00

Use Conditions:

- One property is limited to the keeping or harboring of up to five (5) chickens.
- A person may only own, keep or harbor chickens on property being used as a Single Family Residential Dwelling.
- No person shall keep any rooster.
- No person shall slaughter any chickens.
- Chickens shall be provided with a covered enclosure and kept in covered enclosure or a fenced enclosure within the backyard of the property at all times.
- No enclosure shall be located closer than 25 feet to any residential structure on an adjacent lot.

APPLICANT: <u>Laura Collins</u>
PROPERTY OWNER(S): <u>Tim Deegenhardt</u> <small>(If applicant is not the owner, please provide written documentation from the owner that they have been notified. Not applicable for renewal.)</small>
PROPERTY ADDRESS WHERE CHICKENS WILL BE KEPT: <u>1618 Market St. LaCrosse, WI 54601</u>

Is the property being used as a Single Family Residential Dwelling? Yes No

Attach a scale drawing showing property lot lines, dimensions of coop/enclosure and distance from adjoining lot lines and residential structures.

Applying for and obtaining this chicken permit DOES NOT provide any authority to violate any restrictive covenants that govern the property where you reside or intend to keep chickens. Please review any Declaration of Restrictions or Restrictive Covenants that apply to the property prior to applying for a chicken permit. No permit fees will be refunded once they are paid.

I hereby certify that I have read and understand the content of this application and that the above statements are true and correct to the best of my knowledge and belief. I further certify that I understand that any such license is subject to revocation in accordance with City of La Crosse Code of Ordinances Sec. 20.22(GG).

X Tim Deegenhardt
(signature)

Laura Collins
(signature)

608 317 0045
(telephone)

6/16/2014
(date)

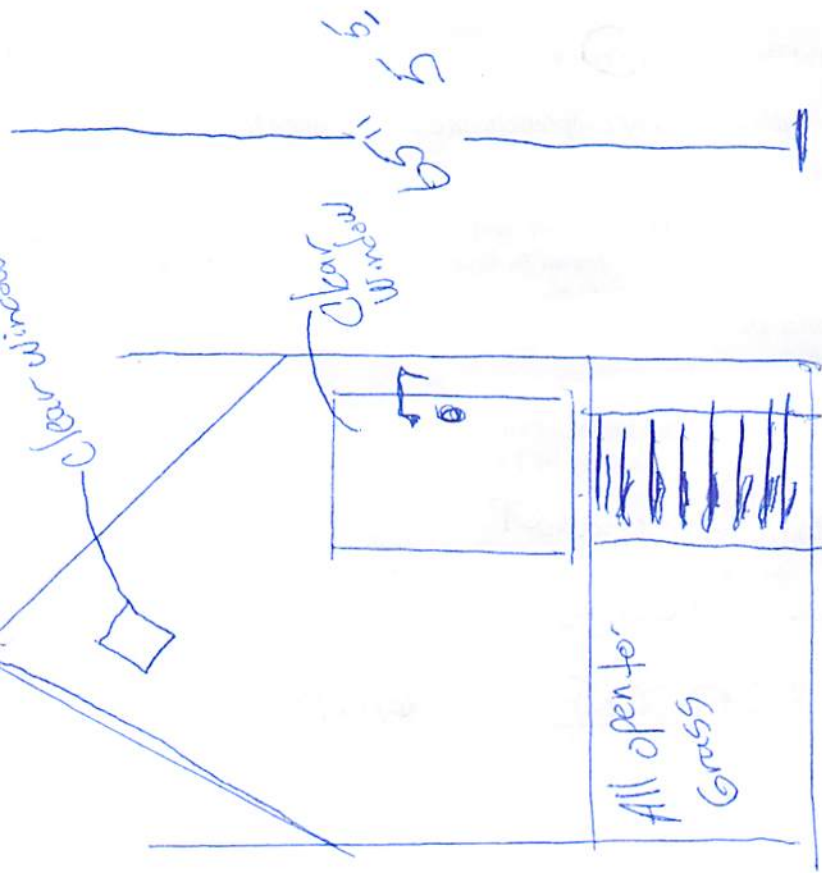

This structure can be moved everyday for fresh grass. The back yard is enclosed by fence chest high. bird proofed to ensure they don't get out. This structure is 36" wide 72" long 65" tall Back yard is 25' wide 45' long

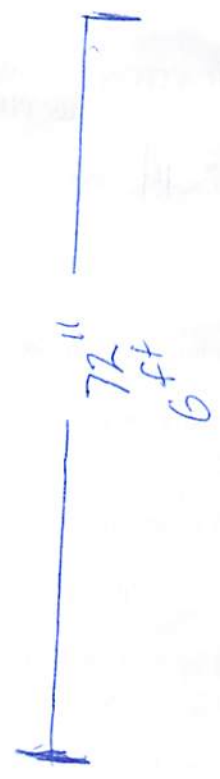
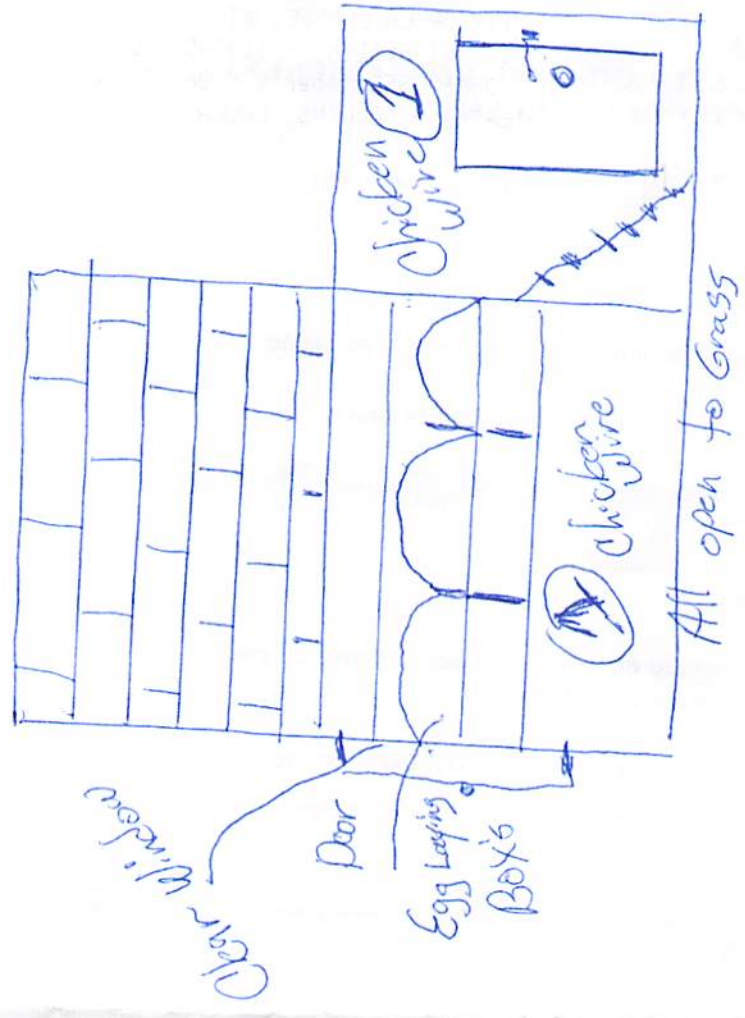

①

3/8 x 3/8 Chicken wire