

**A** SITE PLAN  
SCALE: 1" = 20'

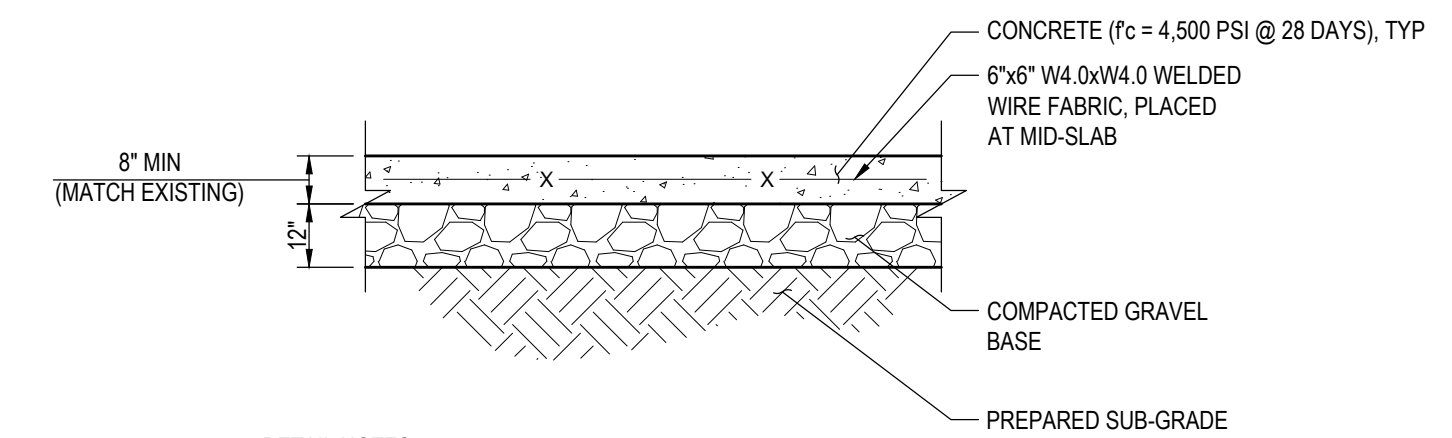

**DETAIL NOTES:**  
1. SEE GEOTECHNICAL INVESTIGATION REPORT FOR SUB-GRADE PREPARATION REQUIREMENTS.

**1 CONCRETE PAVEMENT SECTION**  
SCALE: NTS

**GENERAL SITE NOTES**

1. THE INFORMATION SHOWN HEREIN WAS TAKEN FROM BOUNDARY & TOPOGRAPHIC SURVEY PROVIDED BY: PARAGON ASSOC., 632 COPELAND AVENUE, LA CROSSE, WI 54603, PHONE 608-781-3110.
2. THE LOCATIONS OF ALL UTILITIES SHOWN ON THESE PLANS ARE BASED ON THE AVAILABLE INFORMATION. THE CONTRACTOR SHALL VERIFY THE EXACT LOCATION OF UTILITIES WITH THE UTILITY OWNERS PRIOR TO COMMENCEMENT OF CONSTRUCTION.
3. ALL HANDICAP SITE FEATURES SHALL BE CONSTRUCTED TO MEET ALL FEDERAL, STATE AND LOCAL CODES.
4. ANY DISCREPANCY IN THIS PLAN, ARCHITECTURAL PLANS, AND/OR ACTUAL FIELD CONDITIONS SHALL BE REPORTED TO THE ENGINEER PRIOR TO CONSTRUCTION. THE CONTRACTOR SHALL BE RESPONSIBLE FOR VERIFICATION OF ALL SETBACKS, EASEMENTS, AND DIMENSIONS SHOWN HEREIN BEFORE BEGINNING CONSTRUCTION.
5. THE CONTRACTOR SHALL CONTACT ALL OWNERS OF EASEMENTS, UTILITIES, AND R.O.W.'S, PUBLIC OR PRIVATE, PRIOR TO WORKING IN THESE AREAS.
6. ACCESS TO UTILITIES, FIRE HYDRANTS, STREET LIGHTING, ET, SHALL REMAIN UNDISTURBED, UNLESS COORDINATED WITH RESPECTIVE UTILITY.
7. DO NOT SCALE THIS DRAWING AS IT IS A REPRODUCTION AND SUBJECT TO DISTORTION.
8. ALL UTILITIES TO SERVE BUILDING SHALL BE UNDERGROUND ON SITE UNLESS OTHERWISE NOTED.
9. THE CONTRACTOR IS RESPONSIBLE FOR DAMAGE TO ANY EXISTING ITEM AND/OR MATERIAL DUE TO CONSTRUCTION OPERATIONS. ALL STREET SURFACES, DRIVEWAYS, CULVERTS, CURBS AND GUTTERS, ROADSIDE DRAINAGE DITCHES, AND OTHER STRUCTURES THAT ARE DISTURBED OR DAMAGED IN ANY MANNER AS A RESULT OF CONSTRUCTION SHALL BE REPLACED OR REPAIRED IN ACCORDANCE WITH THE SPECIFICATIONS.
10. COMPACTION AND MAINTENANCE OF PROPER MOISTURE CONTENT OF THE SOIL UNDER BUILDINGS AND PAVED AREAS SHALL BE AS RECOMMENDED IN THE GEOTECHNICAL REPORT.
11. THE CONTRACTOR SHALL NOTE THAT THE DRAWINGS ARE SCHEMATIC IN NATURE AND DO NOT SHOW EVERY OFFSET, TRANSITION, FITTING, ETC, THAT MAY BE REQUIRED FOR A COMPLETE WORKING SYSTEM.
12. ALL PERMITS RELATIVE TO PROJECT MUST BE OBTAINED PRIOR TO CONSTRUCTION. ALL CONSTRUCTION TO BE IN ACCORDANCE WITH PERMITS ISSUED AND APPLICABLE TO STATE, COUNTY, AND LOCAL CODES.
13. THE CONTRACTOR SHALL VERIFY LOCATION AND ELEVATION OF ALL UNDERGROUND UTILITIES. THE LOCATION OF ALL EXISTING UTILITIES IS NOT NECESSARILY SHOWN ON PLANS AND WHERE SHOWN ARE ONLY APPROXIMATE. THE CONTRACTOR ON HIS INITIATIVE AND AT NO EXTRA COST SHALL HAVE LOCATED ALL UNDERGROUND LINES AND STRUCTURES AS NECESSARY. NO CLAIMS FOR DAMAGES OR EXTRA COMPENSATION SHALL ACCRUE TO THE CONTRACTOR FROM THE PRESENCE OF ITEMS SUCH AS PIPE OR OTHER OBSTRUCTIONS OR FROM ANY DELAY DUE TO REMOVAL OR REARRANGEMENT OF THE SAME. THE CONTRACTOR SHALL BE RESPONSIBLE FOR ANY DAMAGE DUE TO UNDERGROUND STRUCTURES. CONTRACTOR SHALL BE RESPONSIBLE FOR CONTACTING ALL NON-SUBSCRIBING UTILITIES. THE CONTRACTOR(S) SHALL CONTACT DIGGERS HOTLINE AT 1-800-242-8511 FOR ASSISTANCE IN LOCATING EXISTING UTILITIES. CALL AT LEAST 48 HOURS PRIOR TO ANY DIGGING.
14. FOR BUILDING DIMENSIONS, SEE ARCHITECTURAL DRAWINGS.
15. PRIOR TO STARTING CONSTRUCTION, THE CONTRACTOR SHALL BE RESPONSIBLE TO VERIFY THAT ALL REQUIRED PERMITS AND APPROVALS HAVE BEEN OBTAINED. NO CONSTRUCTION OR FABRICATION OF ANY ITEM SHALL BEGIN UNTIL THE CONTRACTOR HAS RECEIVED ALL PLANS AND ANY OTHER DOCUMENTATION FROM ALL OF THE PERMITTING AND ANY OTHER REGULATORY AUTHORITIES. FAILURE OF THE CONTRACTOR TO FOLLOW THIS PROCEDURE SHALL CAUSE THE CONTRACTOR TO ASSUME FULL RESPONSIBILITY FOR ANY SUBSEQUENT MODIFICATION OF THE WORK MANDATED BY ANY REGULATORY AUTHORITY.
16. ANY AND ALL QUANTITIES SHOWN OR IMPLIED ON THESE PLANS ARE FOR ESTIMATION PURPOSES ONLY.

**CONTRACTOR NOTES**

- ALL DIMENSIONS AND RADII ARE OUTSIDE FACE OF BUILDING OR TO FACE OF CURB, OR TO THE CENTER OF STRUCTURES SUCH AS INLETS, SIGN POSTS, ETC, UNLESS OTHERWISE NOTED.
- CONTRACTOR TO:
1. VISIT SITE AND BRING TO THE ENGINEER'S ATTENTION IN WRITING ANY PROBLEMS OR DISCREPANCIES WITH THE SITE OR PROJECT PRIOR TO CONSTRUCTION.
  2. COORDINATE WITH THE OWNER FOR PHASING OF CONSTRUCTION. THE CONTRACTOR SHALL INSURE A HIGH LEVEL OF SAFETY DURING ALL PHASES OF CONSTRUCTION AND SHALL REFER TO THE GENERAL CONTRACT FOR SAFETY REQUIREMENTS.
  3. CHECK ALL "VERIFY" DIMENSIONS NOTED ON PLANS. REPORT ANY DISCREPANCIES TO THE ENGINEER IN WRITING PRIOR TO ANY FURTHER CONSTRUCTION.
  4. CONTACT ENGINEER FOR OBSERVATION OF CONSTRUCTION RELATED TO REQUIRED FEDERAL, STATE, OR LOCAL CERTIFICATIONS INCLUDING BUT NOT LIMITED TO PROOFROLL AND ASPHALT PLACEMENT. PROVIDE 24 HOUR NOTICE TO ENGINEER FOR REQUIRED CONSTRUCTION OBSERVATION RELATED TO CERTIFICATION OF ROADWAY, WATER SYSTEM, PAVEMENT, ETC.
  5. KEEP ALL PLANTING AND GRASS AREAS FREE OF DEBRIS, STONES, CONSTRUCTION MATERIALS, ETC. CONTRACTOR IS RESPONSIBLE FOR NOT DAMAGING EXISTING PLANTINGS WHICH ARE OUTSIDE OF THE LIMIT OF WORK AND THOSE MARKED TO REMAIN.
  6. THE CONTRACTOR IS RESPONSIBLE FOR LOCATING AND AVOIDING ALL UNDERGROUND UTILITIES WHETHER SHOWN ON THE SITE PLAN OR NOT. THOSE SHOWN ARE BASED ON THE SURVEY PROVIDED AND MAY NOT BE ALL INCLUSIVE. CONTACT UTILITY LOCATION SERVICE OR OTHER APPROPRIATE UTILITY LOCATION SERVICE FOR UTILITY IDENTIFICATION PRIOR TO ANY WORK. CONTRACTOR TO PROTECT ALL UTILITIES TO REMAIN - TYPICAL. CONTACT ALL UTILITY COMPANIES TO INSURE THE UTILITIES ARE SHUT DOWN PRIOR TO THE START OF ANY DEMOLITION AND/OR SITE WORK.
  7. PATCH / REPAIR STREETS, STRUCTURES, ETC. AS NECESSARY AFTER CONNECTION OF PROPOSED UTILITIES.
  8. USE THE ARCHITECT'S DRAWINGS FOR BUILDING DIMENSIONS.
  9. USE CITY OF LA CROSSE STANDARD CONSTRUCTION DETAILS FOR ALL SITE WORK ITEMS.

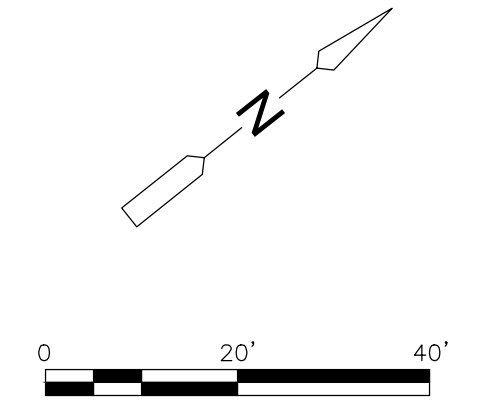

RELEASE	A	09/14/2015	DATE	BY	APP.	CAB	PERMIT	RELEASED FOR...
---------	---	------------	------	----	------	-----	--------	-----------------

**BOILER EXPANSION**  
2200 ENTERPRISE AVENUE  
LA CROSSE, WI 54603

**GREAT LAKES CHEFSE**

**SITE PLAN**

**THE DENNIS GROUP, LLC**

PLANNING • ENGINEERING • CONSTRUCTION MANAGEMENT

www.dennisgrp.com

ATLANTA | SALT LAKE CITY | SAN DIEGO | SPRINGFIELD | TORONTO

© THE DENNIS GROUP  
THIS DOCUMENT CONTAINS PROPRIETARY INFORMATION BELONGING TO THE DENNIS GROUP, OR ITS AFFILIATED COMPANIES AND SHALL BE USED ONLY FOR THE PROJECT FOR WHICH IT WAS SUPPLIED. IT SHALL NOT BE COPIED, REPRODUCED OR OTHERWISE USED, IN WHOLE OR IN PART, WITHOUT THE WRITTEN CONSENT OF THE DENNIS GROUP. ANY SUCH INFORMATION BE FURNISHED IN WHOLE OR IN PART TO OTHERS, EXCEPT IN ACCORDANCE WITH THE TERMS OF ANY AGREEMENT UNDER WHICH IT WAS SUPPLIED OR WITH THE PRIOR WRITTEN CONSENT OF THE DENNIS GROUP, AND SHALL BE RETURNED UPON REQUEST.

DRAWING NO.  
**C1.00**  
4497