

1
A2.0
BASEMENT FLOOR PLAN
1/8" = 1'-0"

14,870 gsf

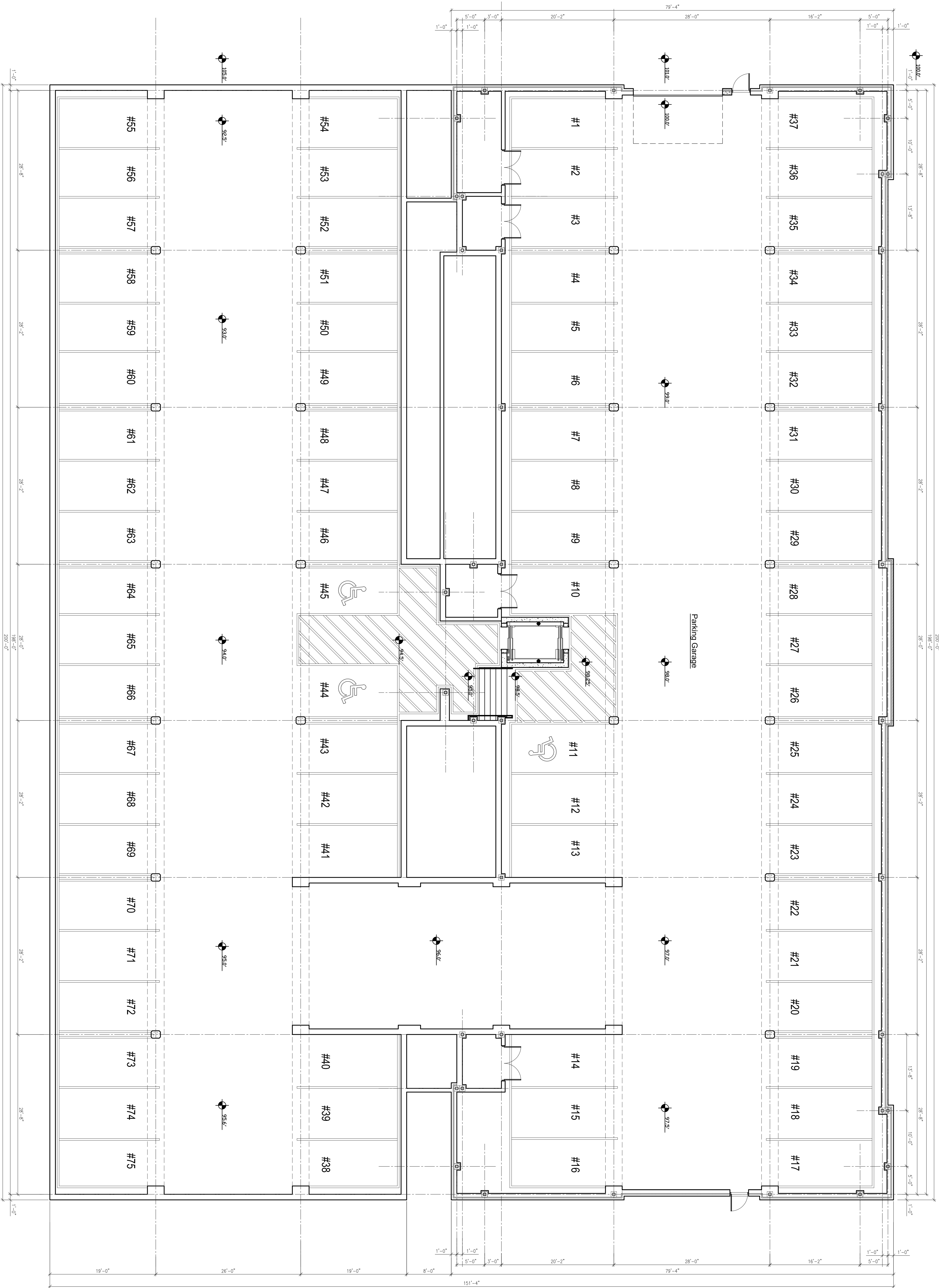

-Preliminary-
-Not For Construction-

CASHMAN ASSOCIATES, Inc.

PH: (608) 237-7443

FAX: (608) 237-7444

6734 Parkway Drive

Sun Prairie, WI 53590

Gregory M. Cashman, AIA

SHEET NUMBER:
A2.0

SHEET TITLE:
Basement Floor Plan

PROJECT:
Second Street Office
2nd & Pine La Crosse, Wisconsin 54669

LOCATION:
1550 Fairgrounds Road
West Salem, WI 54650
DATE: April 05, 2016

PROJECT OWNER:
Cliff LeClair
1629 Caledonia Street
LaCrosse, WI 54603
(608) 781-2818

| REVISIONS | | |
|-----------|-------|------|
| NO. | TITLE | DATE |
| | | |
| | | |