

LA CROSSE AREA FAMILY YMCA NORTHEAST PARKING LOT IMPROVEMENTS LA CROSSE, WISCONSIN

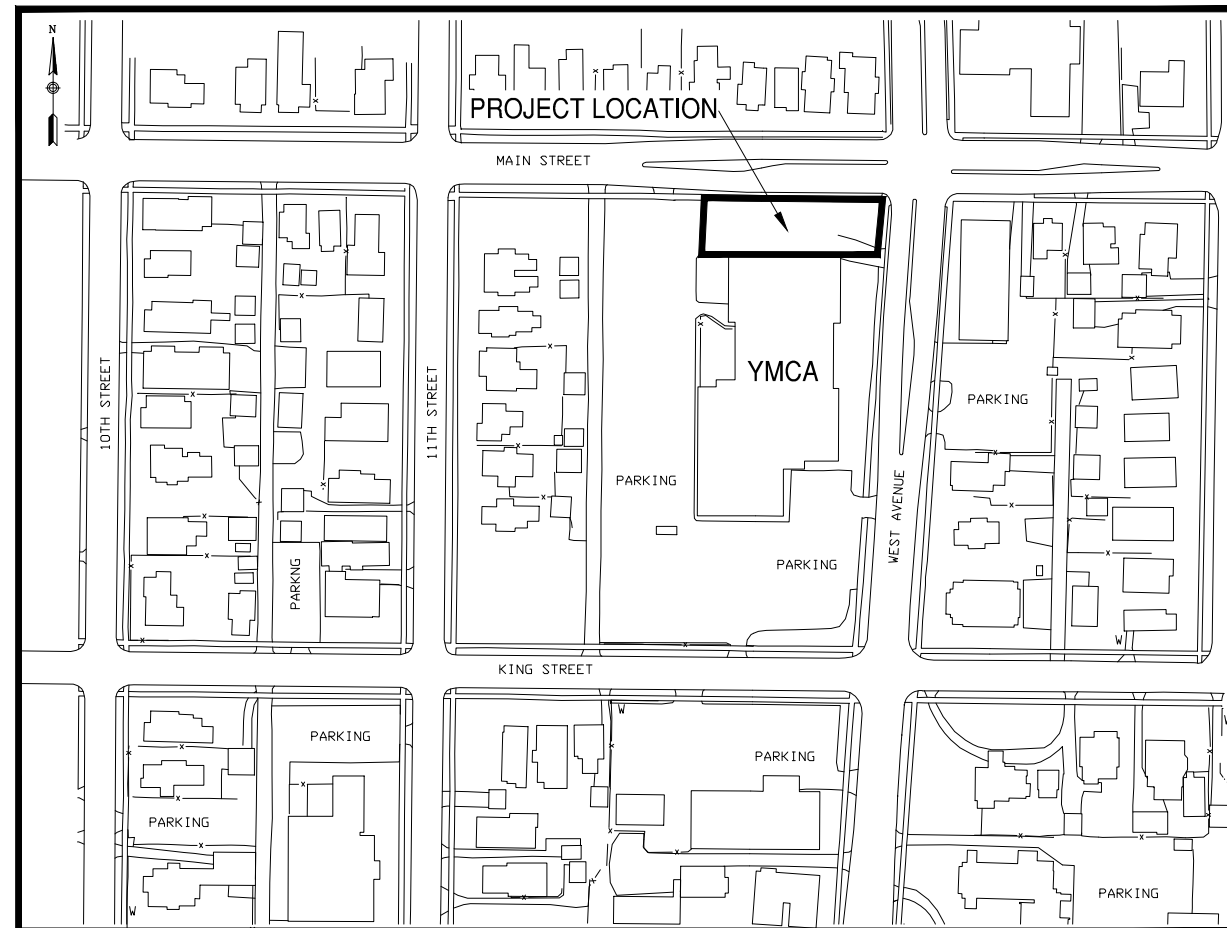

LA CROSSE, WISCONSIN
LA CROSSE COUNTY



LOCATION SKETCH
NO SCALE

INDEX OF SHEETS

1. COVER SHEET
2. SYMBOLS, ABBREVIATIONS & NOTES
3. SITE AND REMOVAL PLAN
4. GRADING PLAN
5. EROSION CONTROL DETAILS
6. PAVING & MISC. DETAILS
7. BIOFILTER DETAILS

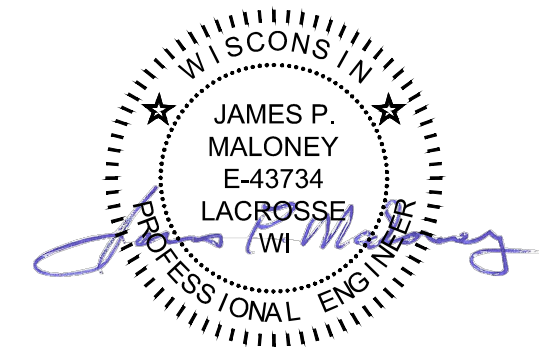

DAVY ENGINEERING CO.
LA CROSSE, WISCONSIN

PROJECT NO. 7595-014.020

SEPTEMBER 2014

TOPOGRAPHIC FEATURES

---UE---	EXISTING UNDERGROUND ELECTRIC CABLE
---UT---	EXISTING UNDERGROUND TELEPHONE CABLE
---W---	EXISTING WATERMAIN LINE
---G---	EXISTING UNDERGROUND GAS LINE
---SD---	SUMP DISCHARGE
~~~~~	VEGATATION LINE
+++++	RAILROAD TRACKS
---	NATURAL WATER FEATURE
---ST---	EXISTING STORM SEWER LINE
---SAN---	EXISTING SANITARY SEWER
---	APPROXIMATE RIGHT-OF-WAY LINE
---	RAILROAD RIGHT OF WAY
---	EXISTING PROFILE GRADE
---x---	FENCE
---	PROPOSED PROPERTY LINE
---	PAVED ROADWAY
---	UNPAVED ROADWAY
HOUSE #41	BUILDING W/HOUSE NUMBER
△	HORIZONTAL CONTROL POINT
■	EXISTING CURB INLET
⊗	EXISTING POWER POLE
⊗	VALVE (V)
○	MANHOLE (MH)
⊗ B1	SOIL BORING LOCATION & NUMBER
○	SIGN
▲	MAILBOX
☁	BRUSH
☼	DECIDUOUS TREE
☼	PINE TREE

**ABBREVIATIONS**

CL	CENTER LINE
PL	PROPERTY LINE
∅	DIAMETER
∠	ANGLE
ⓐ	AT
BM	BENCH MARK
FV	FIELD VERIFY
RCP	REINFORCED CONCRETE PIPE
CMP	CORRUGATED METAL PIPE
CCP	CONCRETE CYLINDER PIPE
DIP	DUCTILE IRON PIPE
CTRS	CENTERS
TYP	TYPICAL
MIN	MINIMUM
EL	ELEVATION
INV	INVERT
DIA	DIAMETER
CSW	CONCRETE SIDEWALK
SS	STAINLESS STEEL
LF	LINEAL FEET
ROW	RIGHT-OF-WAY

**EROSION CONTROL SYMBOLS**

	SILT FENCE
	STRAW BALES
	EROSION MAT
	TRACKING PAD
	FLOW DIRECTION

**GENERAL PROJECT NOTES:**

1. THE CONTRACTOR SHALL REPLACE OR RESET ALL PROPERTY IRONS AND MONUMENTS DISTURBED DURING CONSTRUCTION. PROPERTY IRONS AND MONUMENTS SHALL BE REPLACED OR RESET BY A REGISTERED LAND SURVEYOR ACCEPTABLE TO THE OWNER.
2. EXACT WATER AND SEWER SERVICE LOCATIONS SHALL BE DETERMINED IN THE FIELD DURING CONSTRUCTION.
3. THE CONTRACTOR SHALL MAINTAIN CONTINUOUS ACCESS TO EXISTING MERCHANTS AT VALLEY VIEW SQUARE (CHUCK E CHEESE & PLAY IT AGAIN SPORTS) DURING CONSTRUCTION PERIOD.
4. THE CONTRACTOR SHALL MAINTAIN SANITARY SEWER AND WATER SERVICES TO CHUCK E CHEESE AND PLAY IT AGAIN SPORTS THROUGH THE CONSTRUCTION PERIOD.
5. THE CONTRACTOR SHALL COORDINATE WITH PRIVATE UTILITY COMPANIES TO MAINTAIN EXISTING SERVICE AT VALLEY VIEW SQUARE AND PROVIDE NEW SERVICE TO DICK'S SPORTING GOODS.
6. THE CONTRACTOR SHALL PROVIDE CONTINUOUS ACCESS TO HOLIDAY INN, OLIVE GARDEN, ETC. AT THE ACCESS.

**UNDERGROUND UTILITIES**

THE LOCATIONS OF UNDERGROUND UTILITIES SHOWN ON THE PLAN HAVE BEEN OBTAINED BY FIELD CHECKS AND SEARCHES OF AVAILABLE RECORDS. WHILE IT IS BELIEVED THAT THEY ARE ESSENTIALLY CORRECT, DAVY ENGINEERING COMPANY DOES NOT GUARANTEE THEIR ACCURACY NOR THEIR COMPLETENESS. THE CONTRACTOR SHALL VERIFY LOCATIONS WITH UTILITY COMPANIES BEFORE MAKING ANY EXCAVATIONS.

STAY SAFE BY CALLING DIGGERS HOTLINE AT 8-1-1 OR (800) 242-8511. FOR EMERGENCIES ONLY, CALL (877) 500-9592. FOR MORE INFORMATION ON WISCONSIN'S DIGGER'S HOTLINE PROGRAM, PLEASE VISIT WWW.DIGGERSHOTLINE.COM.

REVISION DATE	REVISIONS
FIELDBOOK: SCALE: AS SHOWN DRAWN: KK/CM CHECKED: JPM DATE: 09-18-2014	REMARKS
<b>DAVY ENGINEERING CO.</b> <b>LA CROSSE, WISCONSIN</b> 	
<b>SYMBOLS, ABBREVIATIONS &amp; NOTES</b> <b>LA CROSSE AREA FAMILY YMCA</b> <b>NORTHEAST PARKING LOT IMPROVEMENTS</b> <b>LA CROSSE, WISCONSIN</b>	
PROJECT NUMBER	7595-014.020
SHEET NO.	2 OF 7

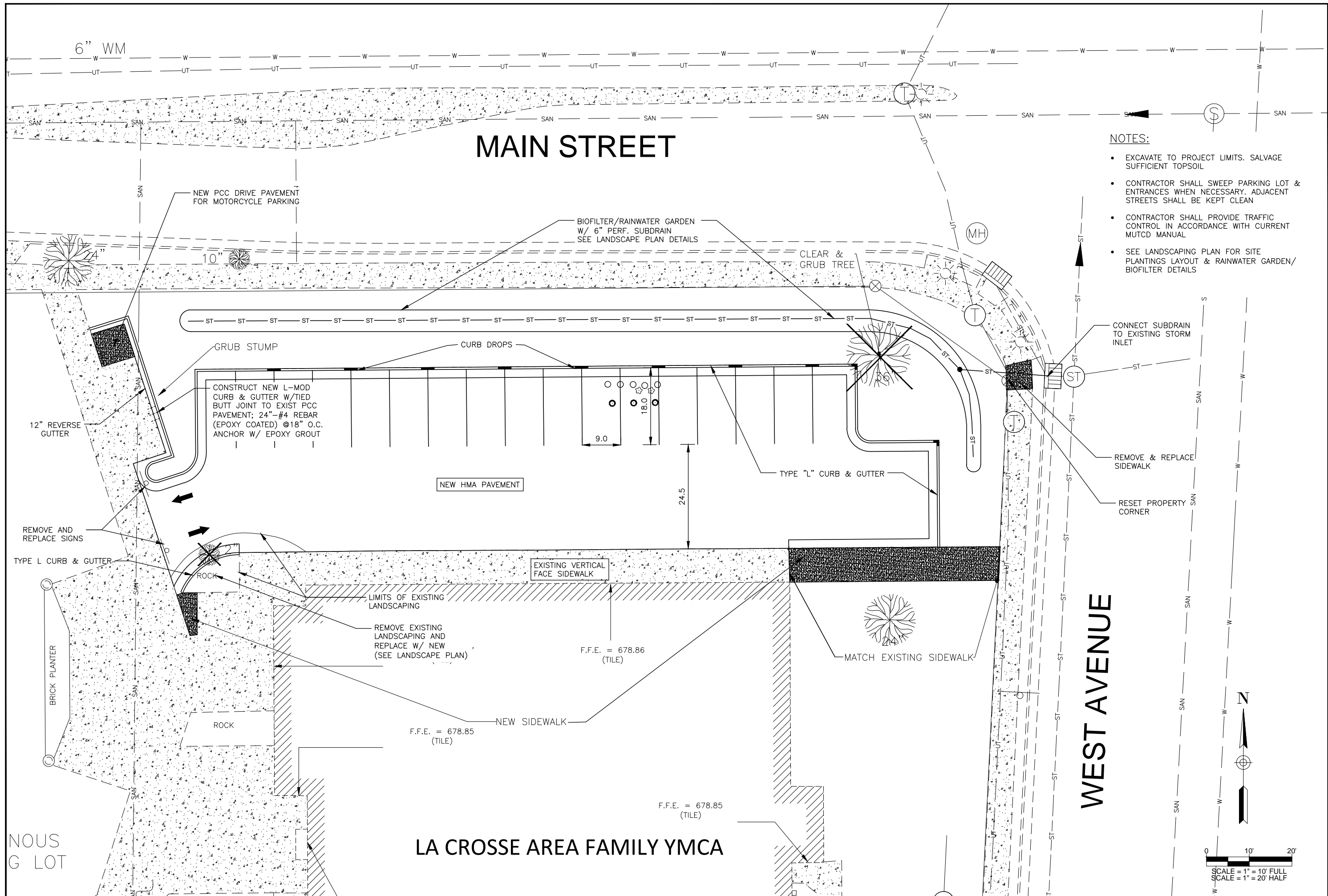

# MAIN STREET

### NOTES:

- EXCAVATE TO PROJECT LIMITS. SALVAGE SUFFICIENT TOPSOIL
- CONTRACTOR SHALL SWEEP PARKING LOT & ENTRANCES WHEN NECESSARY. ADJACENT STREETS SHALL BE KEPT CLEAN
- CONTRACTOR SHALL PROVIDE TRAFFIC CONTROL IN ACCORDANCE WITH CURRENT MUTCD MANUAL
- SEE LANDSCAPING PLAN FOR SITE PLANTINGS LAYOUT & RAINWATER GARDEN/BIOFILTER DETAILS

REVISION	DATE	REMARKS

**DAVY ENGINEERING CO.**  
LA CROSSE, WISCONSIN

**SITE AND REMOVAL PLAN**  
LA CROSSE AREA FAMILY YMCA  
LA CROSSE, WISCONSIN

PROJECT NUMBER  
7595-014.020

SHEET NO.  
3 OF 7

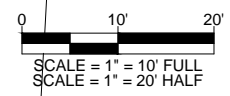

H:\AutoCad Drawings\2014\X-Y-Z\Misc. X-Y-Z\YMCA\7595-014 La Crosse Area Family YMCA - Northeast Parking Addition\CAD Drawings\Civil\7595-014 GRADING PLAN.dwg, 9/26/2014 8:53:00 AM

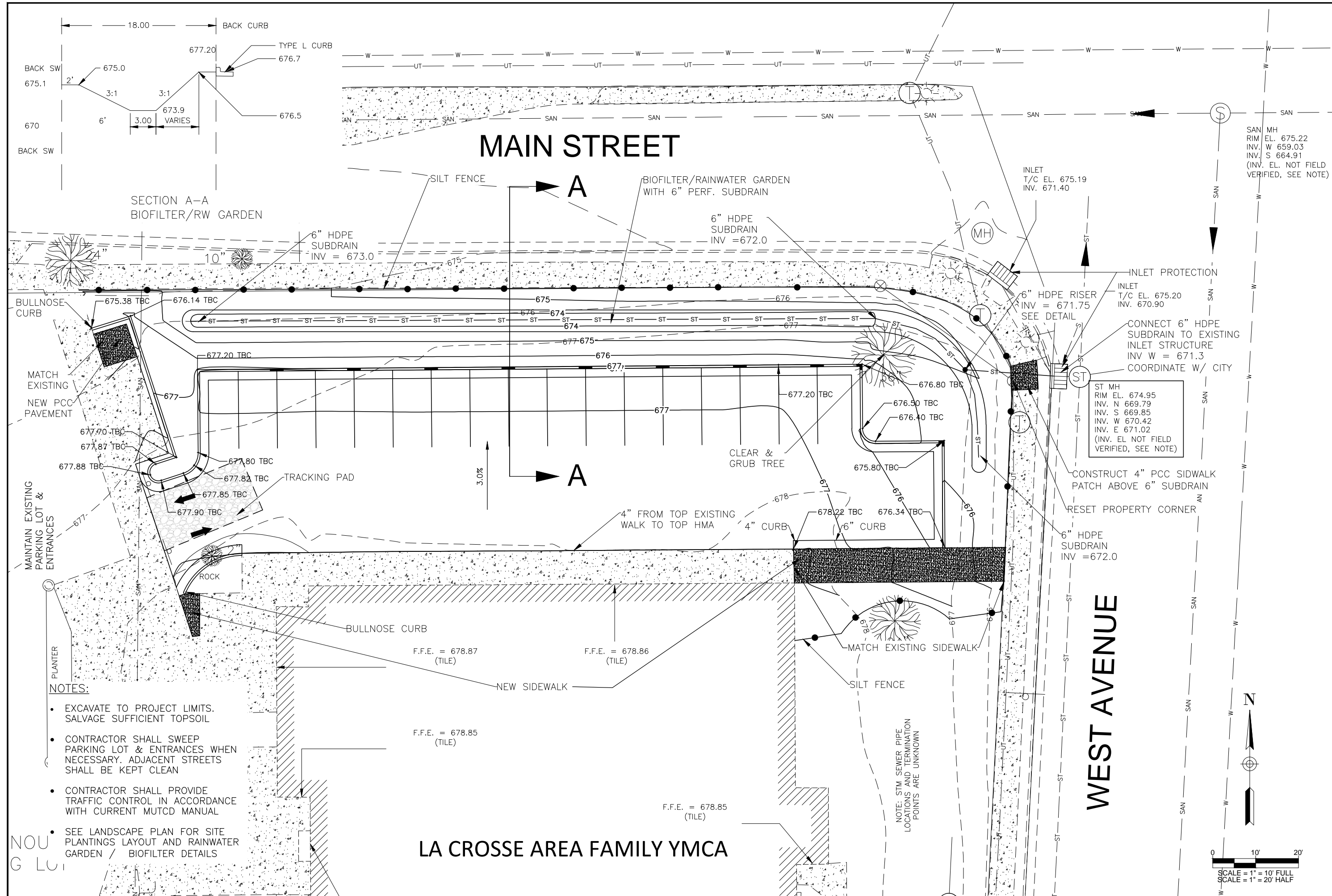

SECTION A-A  
BIOFILTER/RW GARDEN

# MAIN STREET

# WEST AVENUE

# LA CROSSE AREA FAMILY YMCA

- NOTES:**
- EXCAVATE TO PROJECT LIMITS. SALVAGE SUFFICIENT TOPSOIL
  - CONTRACTOR SHALL SWEEP PARKING LOT & ENTRANCES WHEN NECESSARY. ADJACENT STREETS SHALL BE KEPT CLEAN
  - CONTRACTOR SHALL PROVIDE TRAFFIC CONTROL IN ACCORDANCE WITH CURRENT MUTCD MANUAL
  - SEE LANDSCAPE PLAN FOR SITE PLANTINGS LAYOUT AND RAINWATER GARDEN / BIOFILTER DETAILS

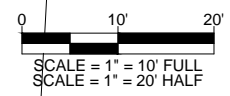

REVISION DATE	REMARKS

FIELDBOOK:	SCALE: AS SHOWN
DRAWN: KKCM/JPM	CHECKED: JPM
DATE: 09-26-2014	

PROJECT NUMBER	7595-014.020
SHEET NO.	4 OF 7

**DAVY ENGINEERING CO.**  
LA CROSSE, WISCONSIN

**GRADING PLAN**  
LA CROSSE AREA FAMILY YMCA  
LA CROSSE, WISCONSIN

SAN MH  
RIM EL. 675.22  
INV. W 659.03  
INV. S 664.91  
(INV. EL. NOT FIELD VERIFIED, SEE NOTE)

ST MH  
RIM EL. 674.95  
INV. N 669.79  
INV. S 669.85  
INV. W 670.42  
INV. E 671.02  
(INV. EL NOT FIELD VERIFIED, SEE NOTE)

CONNECT 6" HDPE SUBDRAIN TO EXISTING INLET STRUCTURE  
INV W = 671.3  
COORDINATE W/ CITY

6" HDPE SUBDRAIN  
INV = 672.0

INLET  
T/C EL. 675.19  
INV. 671.40

INLET PROTECTION  
INLET  
T/C EL. 675.20  
INV. 670.90

6" HDPE RISER  
INV = 671.75  
SEE DETAIL

CLEAR & GRUB TREE

NOTE: STM SEWER PIPE LOCATIONS AND TERMINATION POINTS ARE UNKNOWN

F.F.E. = 678.87 (TILE)

F.F.E. = 678.86 (TILE)

F.F.E. = 678.85 (TILE)

F.F.E. = 678.85 (TILE)

H:\AutoCad Drawings\2014\X-Y-Z\Misc. X-Y-Z\YMCA - Northeast Parking Addition\CAD Drawings\Civil\7595-014 DETAIL SHEETS.dwg, 9/18/2014 3:29:20 PM

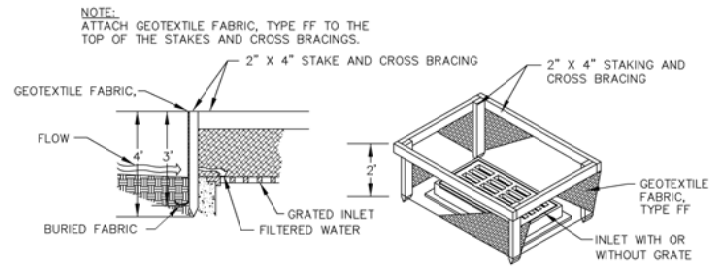

NOTES:

- FABRIC SHALL BE REPLACED AT ENGINEERS DISCRETION. MANUFACTURED ALTERNATIVES APPROVED AND LISTED ON WISDOT'S EROSION CONTROL PRODUCT ACCEPTABILITY LIST MAY BE SUBSTITUTED.
- WHEN REMOVING OR MAINTAINING INLET PROTECTION, CARE SHALL BE TAKEN SO THAT SEDIMENT TRAPPED ON THE GEOTEXTILE FABRIC DOES NOT FALL INTO THE INLET. ANY MATERIAL FALLING INTO THE INLET SHALL BE REMOVED IMMEDIATELY.

Inlet protection Type A shall be utilized around field inlets until permanent stabilization methods have been established. Inlet protection Type A shall be utilized on pavement inlets prior to installation of curb and gutter or pavement.

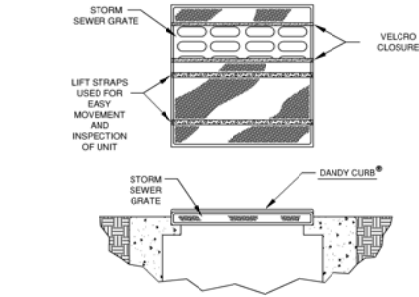

TYPE B  
Inlet protection Type B shall be utilized on street inlets without curb head, once surrounding surfaces are in place.

ACCEPTABLE PRODUCTS	MANUFACTURER
Dandy Curb	Dandy Products Inc.
Sediguard	Earth Support Systems

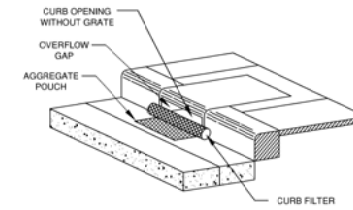

DETAIL OF CURB INLET SEDIMENT CONTROL DEVICE WITH CURB FILTER

TYPE C  
Inlet protection Type C shall be utilized on street inlets with curb heads. A 1-1/2" x 3-1/2" (37 mm by 87 mm) minimum, piece of wood shall be wrapped and secured in the fabric and placed in front of the curb head. The wood shall not block the entire opening of the curb box.

ACCEPTABLE PRODUCTS	MANUFACTURER
Slammer	Alpine Stormwater Management Co.
Beaver Dam	Dandy Products Inc.

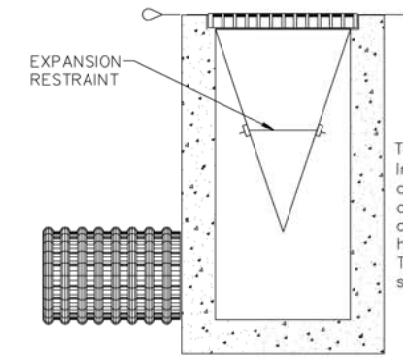

TYPE D  
Inlet protection Type D shall be utilized in areas where other types of inlet protection are identified as incompatible with roadway and traffic conditions causing possible safety hazards when ponding occurs at the inlet. The inlet protection shall conform to the standard detail drawing as shown in the plans.

DETAIL OF INLET SEDIMENT CONTROL DEVICE

ACCEPTABLE PRODUCTS	MANUFACTURER
Siltsac	ACF Environmental
The Catch-All (WisDOT Model)	Marathon Materials Inc. (Mar Mac)
The Road Drain Curb and Gutter High Flow	WIMCO
Inlet Protection	Lange Industries
FLEXSTORM (WisDOT Model)	Inlet & Pipe Protection, Inc. (IPP)

DETAIL - INLET PROTECTION, TYPE A

DETAIL - INLET PROTECTION TYPE B

DETAIL - INLET PROTECTION TYPE C

DETAIL - INLET PROTECTION, TYPE D

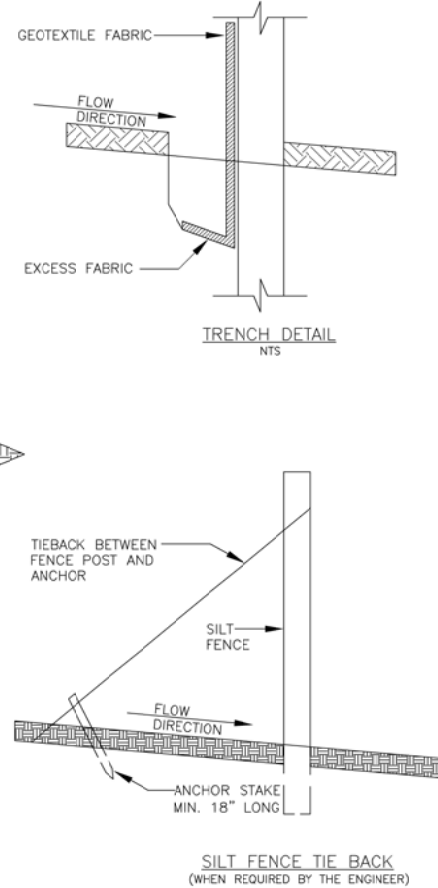
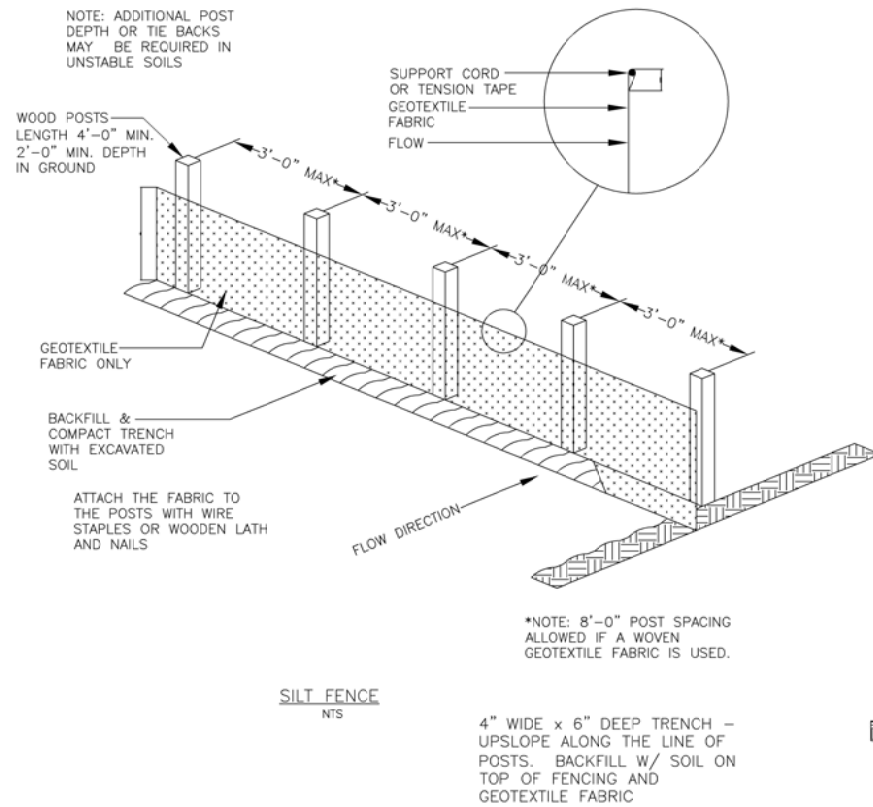

SILT FENCE EROSION CONTROL DETAIL

CONSTRUCTION SITE

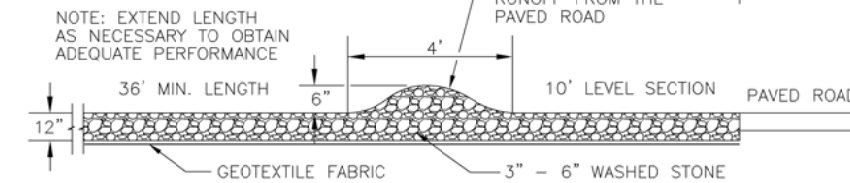

TEMPORARY GRAVEL CONSTRUCTION ENTRANCE DETAIL (TRACKING PAD)

TRACKING PAD

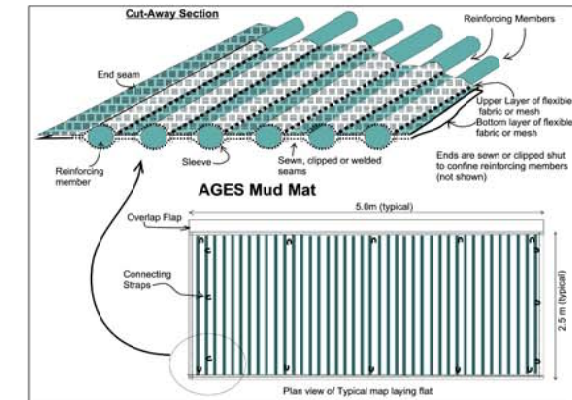

MUD MAT  
ACCEPTABLE AFTER MASS GRADING IS DONE AND SUBGRADE IS PREPARED.

EROSION CONTROL DETAILS  
LA CROSSE AREA FAMILY YMCA  
NORTHEAST PARKING LOT IMPROVEMENTS  
LA CROSSE, WISCONSIN

DAVY ENGINEERING CO.  
LA CROSSE, WISCONSIN



FIELDBOOK:  
SCALE: AS SHOWN  
DRAWN: KK/CM  
CHECKED: JPM  
DATE: 09-18-2014

REVISION DATE

PROJECT NUMBER

7595-014.020

SHEET NO.  
5 OF 7

REMARKS

H:\AutoCad Drawings\2014\X-Y-Z\Misc. X-Y-Z\YMCA\7595-014 La Crosse Area Family YMCA - Northeast Parking Addition\CAD Drawings\Civil\7595-014 DETAIL SHEETS.dwg, 9/18/2014 3:31:16 PM

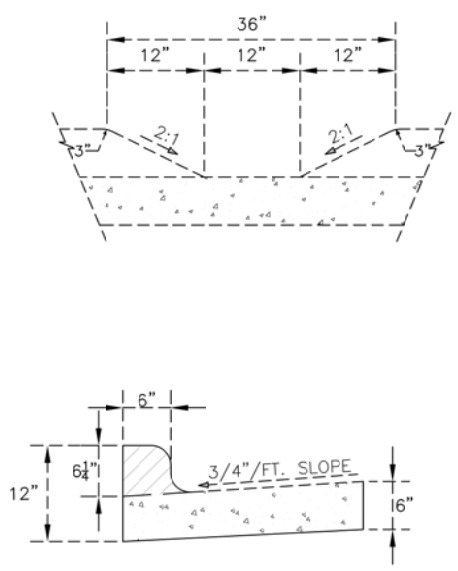

**CURB CUT DETAIL**

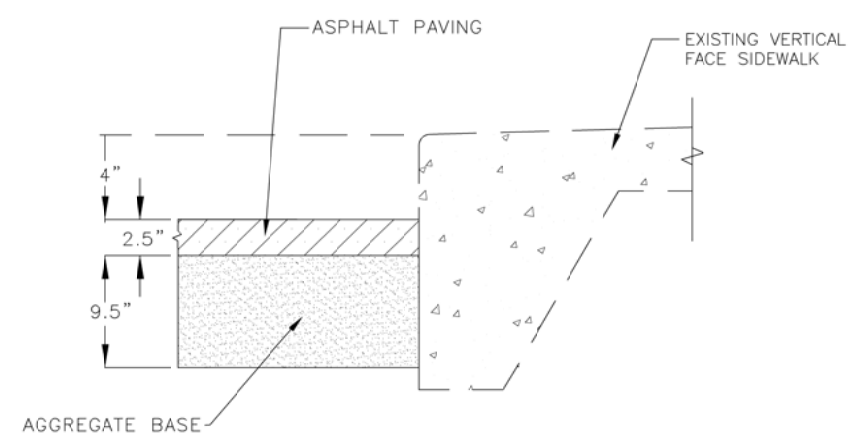

**BUTT JOINT  
HMA PAVEMENT W/  
VERTICAL FACE SIDEWALK  
DETAIL**  
NO SCALE

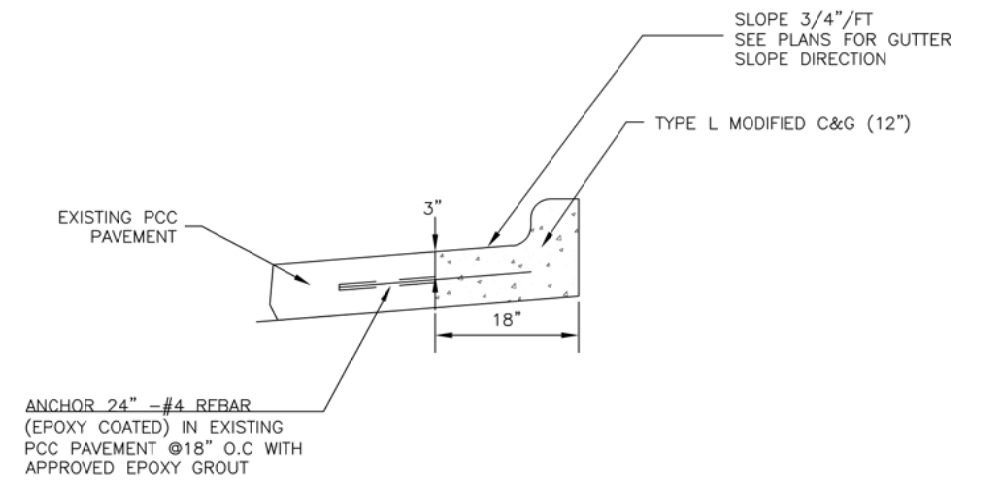

**TYPE L C&G MODIFIED**

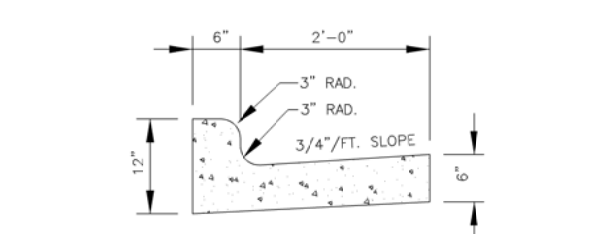

**30" CONCRETE CURB & GUTTER  
(STANDARD SLOPE) WIS. DOT TYPE L**  
NO SCALE

THE BOTTOM OF THE CURB AND GUTTER MAY BE CONSTRUCTED EITHER LEVEL OR PARALLEL TO THE SLOPE OF THE SUBGRADE OR BASE COURSE PROVIDED A 6" MINIMUM GUTTER THICKNESS IS MAINTAINED.

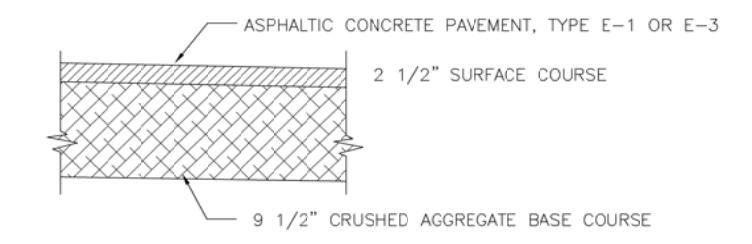

**ASPHALTIC CONCRETE PAVEMENT**  
NO SCALE

**PAVING MATERIALS**  
2-1/2" HMA PAVEMENT TYPE E-3, AGGREGATE, PG 64-28  
9-1/2" AGGREGATE BASE DENSE 1 1/4"  
7" DRIVEWAY WITH 6" AGGREGATE BASE DENSE 1 1/4"  
6' WIDE CONCRETE SIDEWALKS (4" THICK)

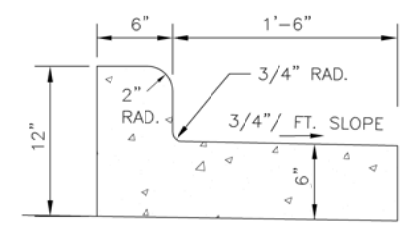

**TYPICAL 24" REJECT CURB & GUTTER**  
NO SCALE

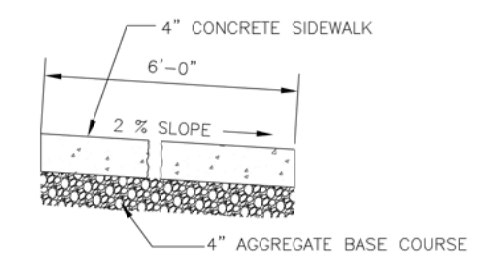

**STANDARD SIDEWALK DETAIL**  
SCALE: NTS

REVISION DATE	REVISION	REMARKS
FIELD BOOK:	SCALE: AS SHOWN	<b>DAVY ENGINEERING CO.</b> LA CROSSE, WISCONSIN 
DRAWN: KK/CM	CHECKED: JPM	
DATE: 09-18-2014		
<b>PAVING &amp; MISC. DETAILS</b> LA CROSSE AREA FAMILY YMCA NORTHEAST PARKING LOT IMPROVEMENTS LA CROSSE, WISCONSIN		
PROJECT NUMBER	7595-014.020	
SHEET NO.	6 OF 7	

H:\AutoCad Drawings\2014\X-Y-Z\Misc. X-Y-Z\YMCA - Northeast Parking Addition\CAD Drawings\Civil\7595-014 DETAIL SHEETS.dwg, 9/18/2014 3:34:47 PM

CONSTRUCT BIOFILTERS RAINWATER GARDEN AFTER SITE IS RESTORED AND STABILIZED. ENGINEER SHALL BE PRESENT TO OBSERVE CONSTRUCTION.

SCARIFY BOTTOM OF BIOFILTER EXCAVATION 12" DEEP BEFORE PLACING ENGINEERED SOIL. KEEP EQUIPMENT OFF OF SCARIFIED NATIVE SOIL AND ENGINEERED SOIL. DO NOT COMPACT!

ENGINEERED SOIL SHALL BE 70-80% CLEAN SAND WITH 15-30% COMPOST ACCORDING TO WisDNR STANDARD 1004 AND S100.

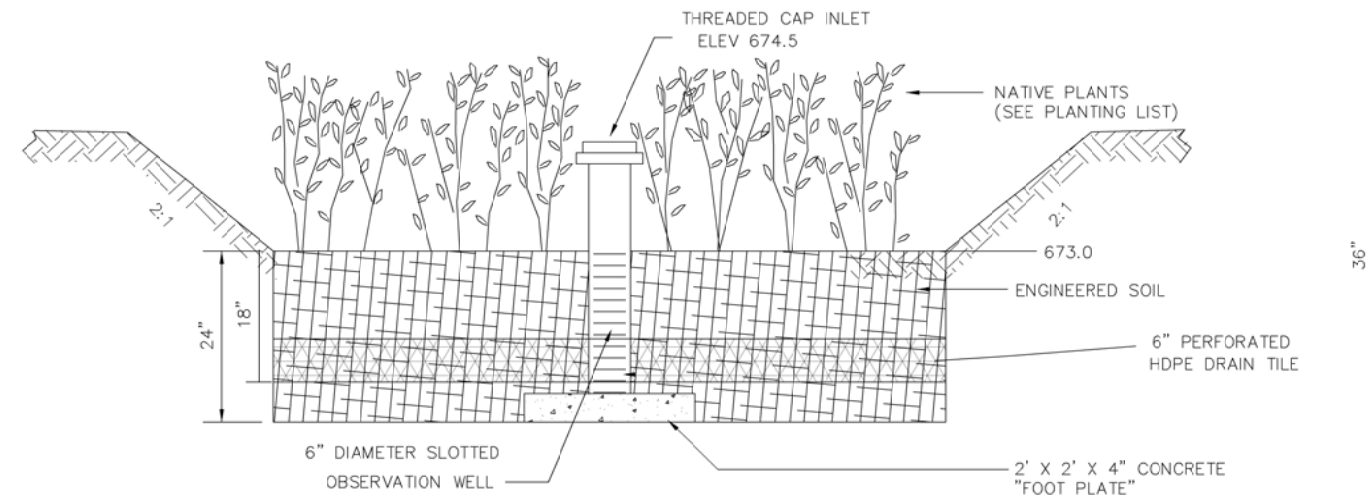
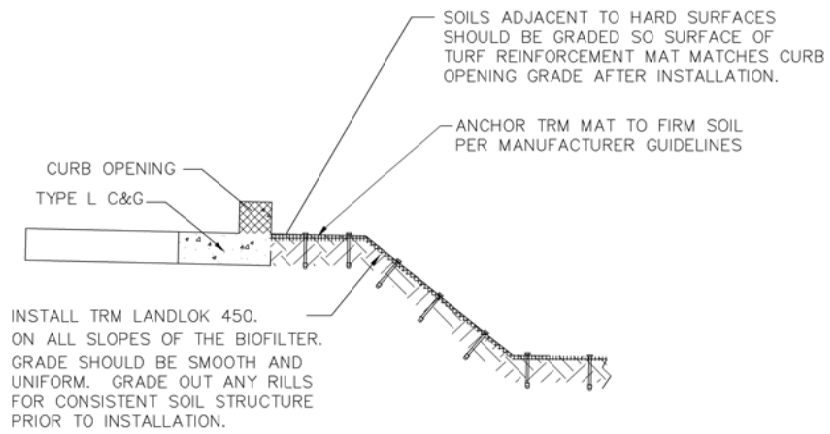

### BIOFILTER DETAIL / RAINWATER GARDEN

(NO SCALE)

REVISION DATE	REVISION DATE	REVISION DATE	REVISION DATE	REVISION DATE	REVISION DATE
FIELDBOOK:	FIELDBOOK:	FIELDBOOK:	FIELDBOOK:	FIELDBOOK:	FIELDBOOK:
SCALE: AS SHOWN	SCALE: AS SHOWN	SCALE: AS SHOWN	SCALE: AS SHOWN	SCALE: AS SHOWN	SCALE: AS SHOWN
DRAWN: KK/CM	DRAWN: KK/CM	DRAWN: KK/CM	DRAWN: KK/CM	DRAWN: KK/CM	DRAWN: KK/CM
CHECKED: JPM	CHECKED: JPM	CHECKED: JPM	CHECKED: JPM	CHECKED: JPM	CHECKED: JPM
DATE: 09-18-2014	DATE: 09-18-2014	DATE: 09-18-2014	DATE: 09-18-2014	DATE: 09-18-2014	DATE: 09-18-2014
<p><b>DAVY ENGINEERING CO.</b> LA CROSSE, WISCONSIN</p> 					
<p>BIOFILTER DETAILS / RAINWATER GARDEN LA CROSSE AREA FAMILY YMCA NORTHEAST PARKING LOT IMPROVEMENTS LA CROSSE, WISCONSIN</p>					
PROJECT NUMBER					
7595-014.020					
SHEET NO.					
7 OF 7					