

Bearing Basis: The La Crosse County Coordinate System, Referenced to the (NAD83) NAD 83 (2011) Adjustment.

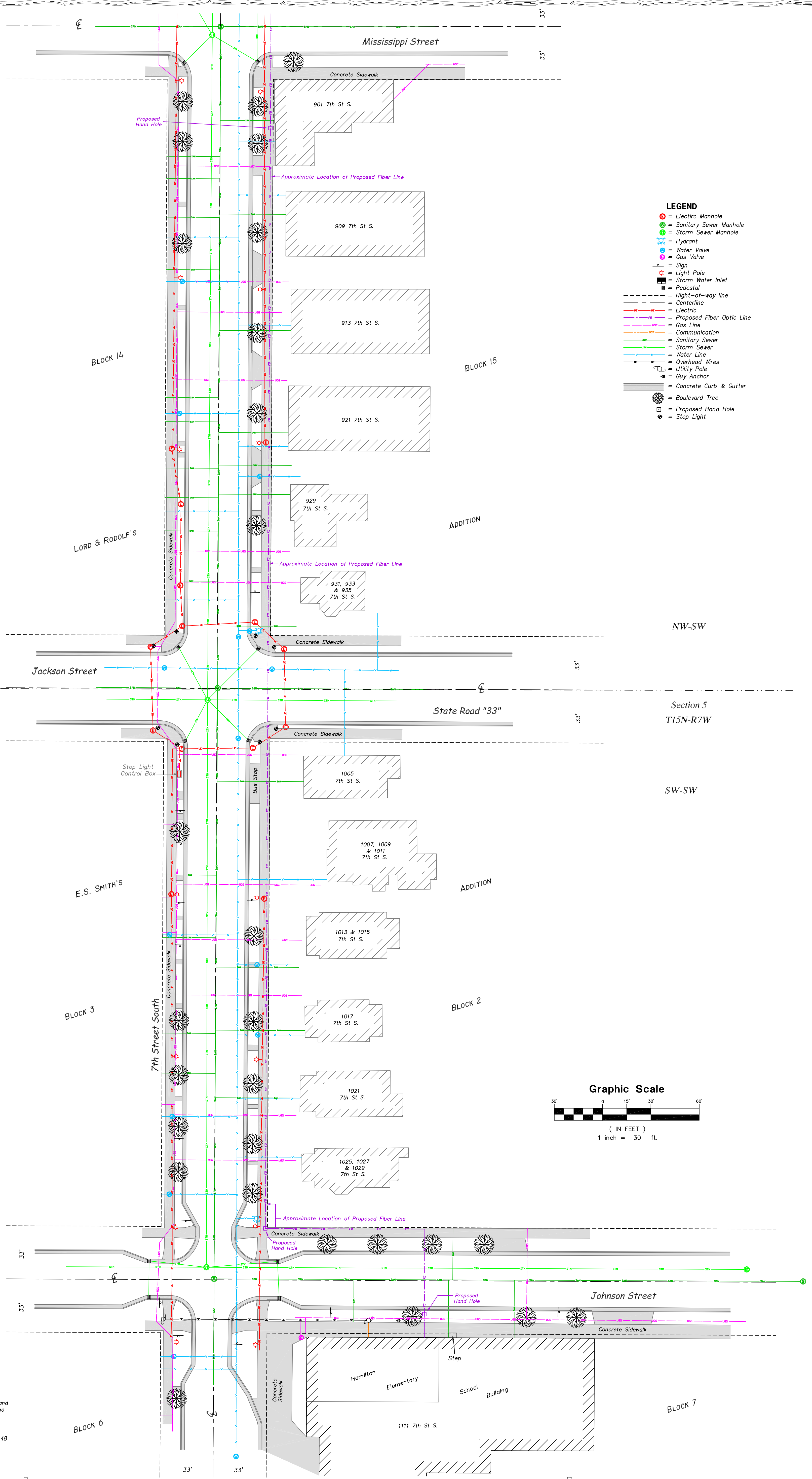

SURVEYOR'S CERTIFICATE
 I, Christopher W. Fechner, Professional Land Surveyor, hereby certify that the survey shown and represented above is accurate and true to the best of my knowledge and belief and that there are no visible encroachments other than those shown.
 Christopher W. Fechner PLS 2448

SURVEY FOR
School District of La Crosse
 7th Street S. & Johnson Street; lying between Blocks 6, 7, 10, 11, 14 & 15, Lord & Rodolf's Add.; Blocks 2, 3 & 7, E.S. Smith's Add.; City of La Crosse, La Crosse Co., WI 1111 7th Street South
 PROJECT NO.: S-7612
 SHEET 1 OF 2

DRAWN BY: CF TS	DATE: 10/30/2019
REVISED BY:	DATE:
SCALE: 1" = 30'	
FIELD CREW: TS CF	

Existing Conditions & Utility Survey for the School District of La Crosse

CR LS Coulee Region Land Surveyors
 917 SOUTH 4TH STREET - P.O. BOX 1954
 LA CROSSE, WISCONSIN 54601
 PHONE (608) 784-1614 FAX (608) 784-1408
 www.couleeregionlandsurveyors.com