

Original Alcohol Beverage Retail License Application

Submit to municipal clerk.

For the license period beginning FEBRUARY 15TH 20 19 ;
ending JUNE 30TH 20 19

TO THE GOVERNING BODY of the: Town of } LA CROSSE
 Village of }
 City of }

County of LA CROSSE Aldermanic Dist. No. 6 (if required by ordinance)

Applicant's WI Seller's Permit No.: <u>456-1030350360-02</u>		FEIN Number: <u>83-2932623</u>	
LICENSE REQUESTED ▶			
TYPE	FEE		
<input type="checkbox"/> Class A beer	\$		
<input checked="" type="checkbox"/> Class B beer	\$ <u>41.70</u>		
<input type="checkbox"/> Class C wine	\$		
<input type="checkbox"/> Class A liquor	\$		
<input type="checkbox"/> Class A liquor (cider only)	\$ N/A		
<input checked="" type="checkbox"/> Class B liquor	\$ <u>208.35</u>		
<input type="checkbox"/> Reserve Class B liquor	\$		
<input type="checkbox"/> Class B (wine only) winery	\$		
Publication fee	\$ 20		
TOTAL FEE	\$ <u>270.05</u>		

1. The named Individual Partnership Limited Liability Company
 Corporation / Nonprofit Organization

hereby makes application for the alcohol beverage license(s) checked above.

2. Name (individual/partners give last name, first, middle; corporations/limited liability companies give registered name): ▶ BIG AL'S LA CROSSE LLC

An "Auxiliary Questionnaire," Form AT-103, must be completed and attached to this application by each individual applicant, by each member of a partnership, and by each officer, director and agent of a corporation or nonprofit organization, and by each member/manager and agent of a limited liability company. List the name, title, and place of residence of each person.

Title	Name (Last, First, M.I.)	Home Address	Post Office & Zip Code
President/Member	<u>MEMBER RYAN RUSSELL JOHNSON,</u>	<u>1225 LAUDERDALE PL,</u>	<u>ONALASKA WI 54650</u>
Vice President/Member			
Secretary/Member			
Treasurer/Member			
Agent	<u>▶ JOSEPH WILLIAM ZENZ,</u>	<u>145 4th St S, LaCrosse WI</u>	<u>54601</u>
Directors/Managers			

3. Trade Name ▶ BIG AL'S Business Phone Number _____

4. Address of Premises ▶ 111/115 3RD ST S Post Office & Zip Code ▶ LA CROSSE WI 54601

5. Is individual, partners or agent of corporation/limited liability company subject to completion of the responsible beverage server training course for this license period? Yes No
6. Is the applicant an employe or agent of, or acting on behalf of anyone except the named applicant? Yes No
7. Does any other alcohol beverage retail licensee or wholesale permittee have any interest in or control of this business? Yes No
8. (a) **Corporate/limited liability company applicants only:** Insert state _____ and date _____ of registration.
(b) Is applicant corporation/limited liability company a subsidiary of any other corporation or limited liability company? Yes No
(c) Does the corporation, or any officer, director, stockholder or agent or limited liability company, or any member/manager or agent hold any interest in any other alcohol beverage license or permit in Wisconsin? Yes No
(NOTE: All applicants explain fully on reverse side of this form every YES answer in sections 5, 6, 7 and 8 above.)

9. Premises description: Describe building or buildings where alcohol beverages are to be sold and stored. The applicant must include all rooms including living quarters, if used, for the sales, service, consumption, and/or storage of alcohol beverages and records. (Alcohol beverages may be sold and stored only on the premises described.) Sales & Service: Main floor of 111/115 3rd St. S. & Beer Garden.

10. Legal description (omit if street address is given above): Storage: Basement of 111/115 3rd St. S.

11. (a) Was this premises licensed for the sale of liquor or beer during the past license year? Yes No
(b) If yes, under what name was license issued? M-V ENTERPRISES INC D/B/A BIG AL'S

12. Does the applicant understand they must register as a Retail Beverage Alcohol Dealer with the federal government, Alcohol and Tobacco Tax and Trade Bureau (TTB) by filing (TTB form 5630.5d) before beginning business? [phone 1-877-882-3277]. Yes No

13. Does the applicant understand they must hold a Wisconsin Seller's Permit? [phone (608) 266-2776]. Yes No

14. Does the applicant understand that they must purchase alcohol beverages only from Wisconsin wholesalers, breweries and brewpubs? Yes No

READ CAREFULLY BEFORE SIGNING: Under penalty provided by law, the applicant states that each of the above questions has been truthfully answered to the best of the knowledge of the signer. Any person who knowingly provides materially false information on this application may be required to forfeit not more than \$1,000. Signer agrees to operate this business according to law and that the rights and responsibilities conferred by the license(s), if granted, will not be assigned to another. (Individual applicants, or one member of a partnership applicant must sign; one corporate officer, one member/manager of Limited Liability Companies must sign.) Any lack of access to any portion of a licensed premises during inspection will be deemed a refusal to permit inspection. Such refusal is a misdemeanor and grounds for revocation of this license.

[Signature]
(Officer of Corporation / Member / Manager of Limited Liability Company / Partner / Individual)

TO BE COMPLETED BY CLERK

Date received and filed with municipal clerk <u>1-16-19</u>	Date reported to council / board	Date provisional license issued	Signature of Clerk / Deputy Clerk
Date license granted	Date license issued	License number issued	

SCHEDULE FOR APPOINTMENT OF AGENT BY CORPORATION/NONPROFIT ORGANIZATION OR LIMITED LIABILITY COMPANY

Submit to municipal clerk.

All corporations/organizations or limited liability companies applying for a license to sell fermented malt beverages and/or intoxicating liquor must appoint an agent. The following questions must be answered by the agent. The appointment must be signed by the officer(s) of the corporation/organization or members/managers of a limited liability company and the recommendation made by the proper local official.

Town

To the governing body of: Village of LA CROSSE County of LA CROSSE

City

The undersigned duly authorized officer(s)/members/managers of BIG AL'S LA CROSSE LLC
(registered name of corporation/organization or limited liability company)

a corporation/organization or limited liability company making application for an alcohol beverage license for a premises known as BIG AL'S
(trade name)

located at 111/115 3RD ST S, LA CROSSE WI 54601

appoints JOSEPH WILLIAM ZENZ
(name of appointed agent)

145 4th St S, LA CROSSE WI 54601
(home address of appointed agent)

to act for the corporation/organization/limited liability company with full authority and control of the premises and of all business relative to alcohol beverages conducted therein. Is applicant agent presently acting in that capacity or requesting approval for any corporation/organization/limited liability company having or applying for a beer and/or liquor license for any other location in Wisconsin?

Yes No If so, indicate the corporate name(s)/limited liability company(ies) and municipality(ies).

A&F BILLIARDS INC.

Is applicant agent subject to completion of the responsible beverage server training course? Yes No

How long immediately prior to making this application has the applicant agent resided continuously in Wisconsin? 39 YEARS

Place of residence last year 145 4th St S, LA CROSSE WI 54601

For: BIG AL'S LA CROSSE LLC
(name of corporation/organization/limited liability company)

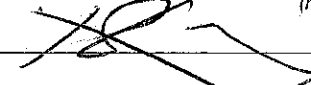
By: 
(signature of Officer/Member/Manager)

And: _____
(signature of Officer/Member/Manager)

ACCEPTANCE BY AGENT

I, JOSEPH WILLIAM ZENZ, hereby accept this appointment as agent for the
(print/type agent's name)

corporation/organization/limited liability company and assume full responsibility for the conduct of all business relative to alcohol beverages conducted on the premises for the corporation/organization/limited liability company.

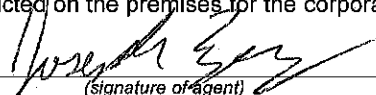
 _____
(signature of agent) _____
(date)

145 4th St S, LA CROSSE WI 54601 _____
(home address of agent) Agent's age 39
Date of birth [REDACTED]

**APPROVAL OF AGENT BY MUNICIPAL AUTHORITY
(Clerk cannot sign on behalf of Municipal Official)**

I hereby certify that I have checked municipal and state criminal records. To the best of my knowledge, with the available information, the character, record and reputation are satisfactory and I have no objection to the agent appointed.

Approved on _____ by _____ Title _____
(date) (signature of proper local official) (town chair, village president, police chief)

New: X

License Fee: \$1600⁰⁰

Renewal: _____

Receipt #: _____

APPLICATION FOR BEER GARDEN LICENSE

_____ Class "A" X Class "B" _____ Class "C" _____ Class "D"
(ZONING RESTRICTION)

To the Common Council of the City of La Crosse:

Legal/Real Name: BIG AL'S LA CROSSE LLC

Address of above: 319 MAIN S., Suite 404, LACROSSE 54601

Trade name of business: BIG AL'S

Address of premises to be licenses: 111/115 3RD ST S, LA CROSSE WI 54601

Description of proposed beer garden: (MUST BE SPECIFIC: square feet, physical location, material made out of, etc.)

Brick pillars with 42" high metal fencing and gates with wood caps on fencing. Approximately 25'x40' area.

Name of Agent (First, Middle, Last): JOSEPH WILLIAM ZENZ

Home address: 145 4th St S, LA CROSSE WI 54601

Home phone number: 608-782-6622

Daytime phone number: 608-385-9021

Date of Birth: [REDACTED]

License Period: February 15th, 2019 - June 30th, 2019

The above hereby makes application for a license to operate a Beer Garden at the above address within the City of La Crosse pursuant to provisions of Sec. 10-47 of the Code of Ordinances for the City of La Crosse.

[Signature]
(Signature of Applicant)

1.16.19
(Date)

****A PLAN MUST ACCOMPANY THIS APPLICATION****

OFFICE USE ONLY:

For original applications: Attach a list of all property owners within 200 feet of the proposed licensed premises.

Signature and date: _____

Granted: _____ License #: _____

MAIN ST

PEARL ST →

ALLEY

PARKING

See Revised Plan 2-5-19

111 3RD ST. S.
(CARLISE'S)

115 3RD ST. S.
(Big AL's)

121 3RD ST. S.

11 3RD ST. S.
(CARLISE'S)

115 3RD ST. S.
(Big AL's)

NEW DOOR
ADDED

OUTDOOR
PATIO

SIDEWALK

3RD ST

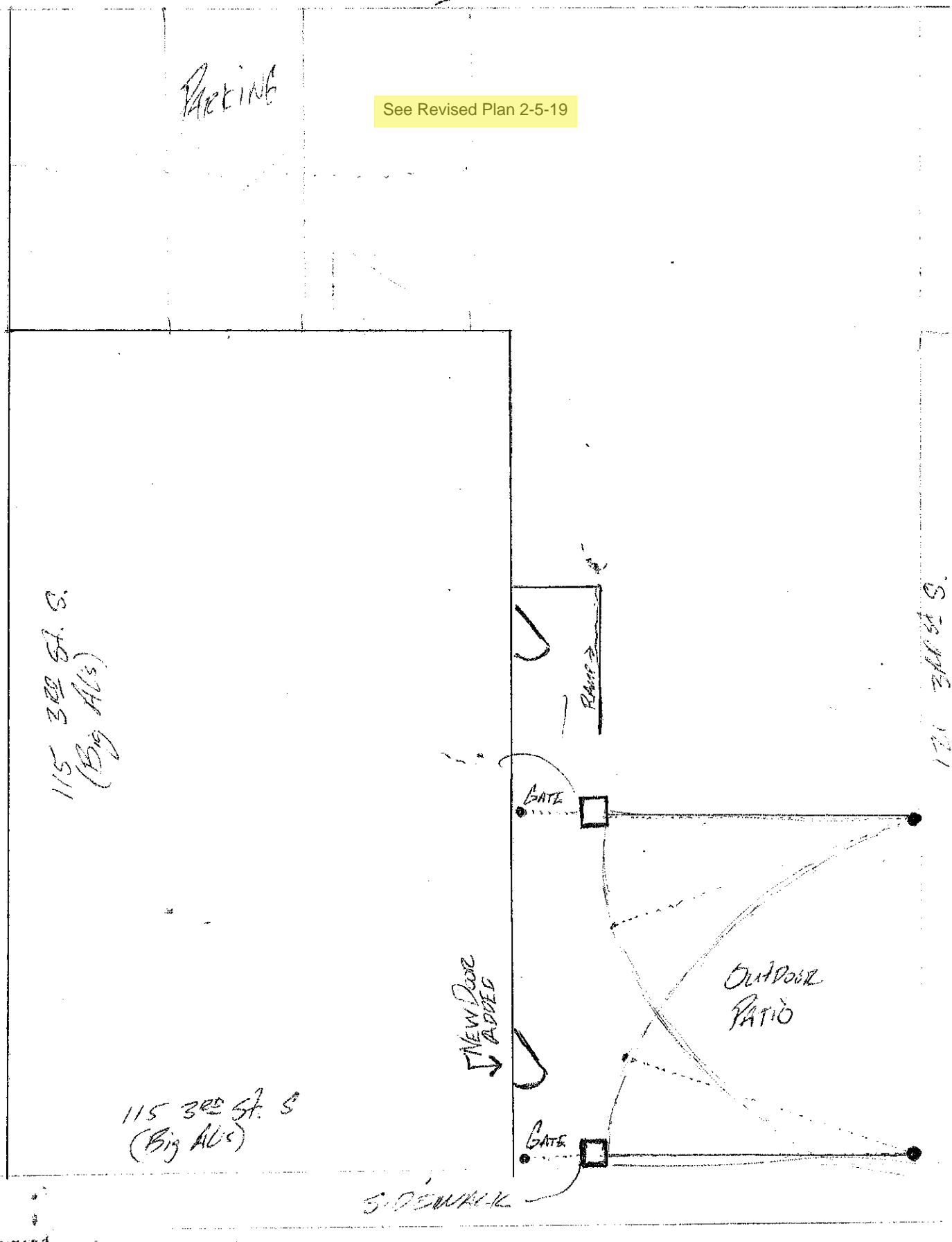

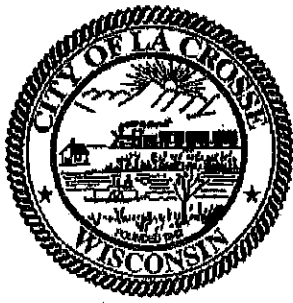

TERI LEHRKE, WCPC, City Clerk
400 LA CROSSE STREET
LA CROSSE, WISCONSIN 54601
PHONE (608) 789-7510
FAX (608) 789-7552
www.cityoflacrosse.org

**NOTICE OF APPLICATION FOR BEER GARDEN LICENSE
IN THE CITY OF LA CROSSE**

To Whom It May Concern:

This is to notify you that the following business has applied for a **Class "B" Beer Garden** license under Sec. 10-47 of the Code of Ordinances of the City of La Crosse to allow consumption of alcoholic beverages in a designated outdoor area.

**Big Al's La Crosse LLC d/b/a Big Al's
at 111/115 3rd St. S., La Crosse, WI 54601**

This application will be considered at the following meetings:

Judiciary & Administration Committee – Tuesday, February 5th, 2019 at 6:00 p.m.
Common Council Meeting – Thursday, February 14th, 2019 at 6:00 p.m.

All the above meetings are held in the Council Chambers in the City Hall at 400 La Crosse Street, La Crosse, WI.

You are further notified that any person affected may be heard, and may appear in person or by attorney, or may file a letter of objection in the office of the City Clerk.

This notice is given pursuant to the order of the Common Council of the City of La Crosse.

Dated this 24th day of January, 2019.

A handwritten signature in cursive script that reads "Teri Lehrke".

Teri Lehrke, WCPC, City Clerk
City of La Crosse

A handwritten signature in cursive script that reads "Jay A. Christianson".

Jay A. Christianson
Assistant Clerk



**Big Al's La Crosse LLC d/b/a Big Al's
at 111/115 4th St. S., La Crosse, WI 54601**

**Class "B" Beer Garden
200' Buffer Notice**

February 14th, 2019 Council Meeting

OwnerName	MailingLine4	MailingLine5
1ST & MAIN LLC C/O THREE SIXTY REAL ESTATE SOLUTIONS LLC	PO BOX 609	LA CROSSE WI 54602-0609
ADAM KRONER CO	319 PEARL ST	LA CROSSE WI 54601-3249
AIRAM GROUP LLC	2102 31ST ST S	LA CROSSE WI 54601
BALDRIC LLC	112 4TH ST S	LA CROSSE WI 54601
BRANCOS OF LACROSSE LLC	2124 MADISON ST	LA CROSSE WI 54601
DANIEL SCHMITZ C/O CASINO LAX INC	523 SANBORN ST	LA CROSSE WI 54603
DAVID & KIMBERLY PRETASKY	220 17TH ST S	LA CROSSE WI 54601
DAVID J RUDRUD	120 3RD ST S	LA CROSSE WI 54601-3211
F F & F OF THIRD STREET LLC	308 3RD ST S	LA CROSSE WI 54601
FORTNEY FORTNEY & FORTNEY	306 PEARL ST	LA CROSSE WI 54601-3202
FORTNEY FORTNEY & FORTNEY LLP	PO BOX 1621	LA CROSSE WI 54602-1621
GEORGE MARKOS JR	W3595 LARSON RD	MINDORO WI 54644
GREAT DANE THIRD STREET PROPERTIES LLC	115 3RD ST S	LA CROSSE WI 54601
JEFFREY W HOTSON	120 4TH ST S	LA CROSSE WI 54601-3201
JPV PROPERTIES LLC	PO BOX 739	DELANO MN 55328
LEITHOLD PIANO CO INC	116 4TH ST S	LA CROSSE WI 54601-3201
MAIN STREET RENAISSANCE INC	504 MAIN ST STE 200	LA CROSSE WI 54601
RICHARD & GREGORY MARKOS	129 3RD ST S	LA CROSSE WI 54601
RONALD, ERIC, MARC, PATRICIA FORTNEY	306 PEARL ST	LA CROSSE WI 54601-3202
RRJ HOLDINGS LLC	731 SHELLY LN	ONALASKA WI 54650
RYAN PROPERTIES LLC	N6260 BERGUM COULEE RD	WEST SALEM WI 54669
THIRD STREET CENTER LLC C/O TJS	215 PEARL ST	LA CROSSE WI 54601
THOMAS & SANDRA KAPELLAS	114 4TH ST S	LA CROSSE WI 54601-3201
WESTERN PACIFIC PARTNERS C/O ANTIQUE CENTER OF LACROSSE LTD	110 3RD ST S	LA CROSSE WI 54601