

EROSION CONTROL & GRADING NOTES

1. THE PROJECT IS NOT GREATER THAN ONE ACRE. AN NPDES PERMIT IS NOT REQUIRED.
2. EROSION CONTROL MUST MEET CITY OF LA CROSSE STANDARDS.
3. THIS EROSION CONTROL PLAN HAS BEEN PREPARED AS A GUIDE. ADDITIONAL EROSION CONTROL MEASURES MAY BE REQUIRED. CONTRACTOR SHALL MAINTAIN, MODIFY, AND IMPLEMENT AN ALTERNATE EROSION CONTROL PLAN BASED ON THEIR MEANS & METHODS.
4. DOWN-SLOPE SEDIMENT CONTROLS SHALL BE INSTALLED PRIOR TO ANY LAND DISTURBANCE OR GRADING, AND SHALL REMAIN AND BE MAINTAINED TO ENSURE PROPER FUNCTION UNTIL SLOPED AREAS ARE STABILIZED AND SITE IS 100% VEGETATED.
5. CONTRACTOR SHALL ADJUST THE APPROPRIATE STRUCTURAL AND NON-STRUCTURAL BMP'S BASED ON CONSTRUCTION PROGRESS. CONTRACTOR SHALL PROVIDE APPROPRIATE PLANNING AND MEASURES TO PREVENT POLLUTION FROM CONSTRUCTION SITE OPERATIONS INCLUDING BUT NOT LIMITED TO MATERIALS, STAGING, WASTE, WASHOUT AREAS, EQUIPMENT FUELING AND MAINTENANCE, AND SPILL PREVENTION AND CONTROL.
6. A COPY OF THIS EROSION CONTROL PLAN SHALL BE KEPT ON-SITE DURING ALL LAND DISTURBING CONSTRUCTION ACTIVITIES.
7. STOCKPILES SHALL BE STABILIZED WITH COVER CONTROL AND PERIMETER PROTECTION WITHIN 7 DAYS.
8. ALL EXPOSED SOILS SHALL BE STABILIZED WITHIN 7 DAYS OF GRADING COMPLETION.
9. ADJACENT STREETS AND ROADWAYS SHALL BE SWEEPED TO KEEP THEM FREE OF SEDIMENT. ANY SEDIMENT DEPOSITED ON PUBLIC STREETS, ORIGINATING FROM THE PROJECT SITE, SHALL BE REMOVED IMMEDIATELY.
10. TEMPORARY COVER ON DISTURBED AREAS SHALL INCLUDE SEED MIX COVER CROP AND MID-TERM STABILIZATION SEED FROM WISDOT STANDARD SPECIFICATIONS. ALL SLOPES >20% OR >5% SHALL INCLUDE DISK ANCHORED MULCH.
11. PIPE OUTLETS MUST INCLUDE ENERGY DISSIPATION DEVICES WITHIN 24 HOURS OF BEING PUT INTO SERVICE.
12. THE NORMAL WETTED PERIMETER OF ANY TEMPORARY OR PERMANENT DRAINAGE DITCH OR SWALE THAT DRAINS WATER FROM ANY PORTION OF THE CONSTRUCTION SITE, OR DIVERTS WATER AROUND THE SITE, MUST BE STABILIZED WITHIN 200 LINEAR FEET FROM THE PROPERTY EDGE, OR FROM THE POINT OF DISCHARGE INTO ANY SURFACE WATER WITHIN 24 HOURS AFTER CONNECTING TO A SURFACE WATER.
13. UNLESS INDICATED OTHERWISE, ALL DISTURBED AREAS WHICH ARE NOT FINISHED WITH ASPHALT, CONCRETE, BIOFILTER PLANTING, OR OTHER PLANTS AS INDICATED ON THE LANDSCAPE PLAN SHALL BE FINISHED WITH LAWN TURF. PERMANENT LAWN COVER SHALL INCLUDE MINIMUM 4" TOPSOIL, SEED MIX AND MULCH SHALL BE PER WISDOT STANDARD SPECIFICATIONS.
14. SLOPES STEEPER THAN 3:1 SHALL BE SEEDED AND PROTECTED WITH EROSION CONTROL BLANKETS. BLANKETS SHALL MEET WISCONSIN PALS LIST.
15. ALL PROPOSED SURFACE ELEVATIONS SHOWN ARE TO FINISHED GRADE UNLESS NOTED OTHERWISE. PROPOSED ELEVATIONS ARE PROVIDED TO PROMOTE POSITIVE DRAINAGE TOWARD INLETS AND BIOFILTERS. CONTRACTOR SHALL MAINTAIN POSITIVE DRAINAGE TOWARD INLETS.

GENERAL NOTES

PROJECT SITE:
 PART OF LOTS 6, 7, 10, 11, 14
 BLOCK 28, PLAT OF NORTH LA CROSSE
 SW-NW, SECTION 29, T16N-R7W
 LA CROSSE, WI

BUILDING 12,550 SF
 PAVEMENT 19,500 SF
 PERVIOUS 3,670 SF
 TOTAL 35,720 SF

ALL WORK SHALL COMPLY WITH: WISDOT 2017 STANDARD SPECIFICATIONS
 CITY OF LA CROSSE ORDINANCES

PROJECT OWNERS
 CRDN THE TEXTILE EXPERTS
 JAMES WILLE 608.784.0946
 620 CASS STREET
 LA CROSSE, WI 54601

RECEIVING STREAM
 LA CROSSE RIVER

TOTAL AREA 0.82 ACRES
 DISTURBED AREA 0.74 ACRES
 PROPOSED IMPERVIOUS 0.56 ACRES

- 1 315 SF
- 2 420 SF
- 3 550 SF
- 4 205 SF
- 5 880 SF
- 6 660 SF
- 7 200 SF
- 8 440 SF

3,670 SF TOTAL LANDSCAPING/GREEN SPACE

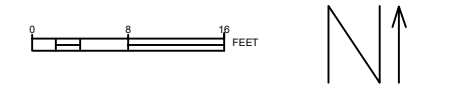
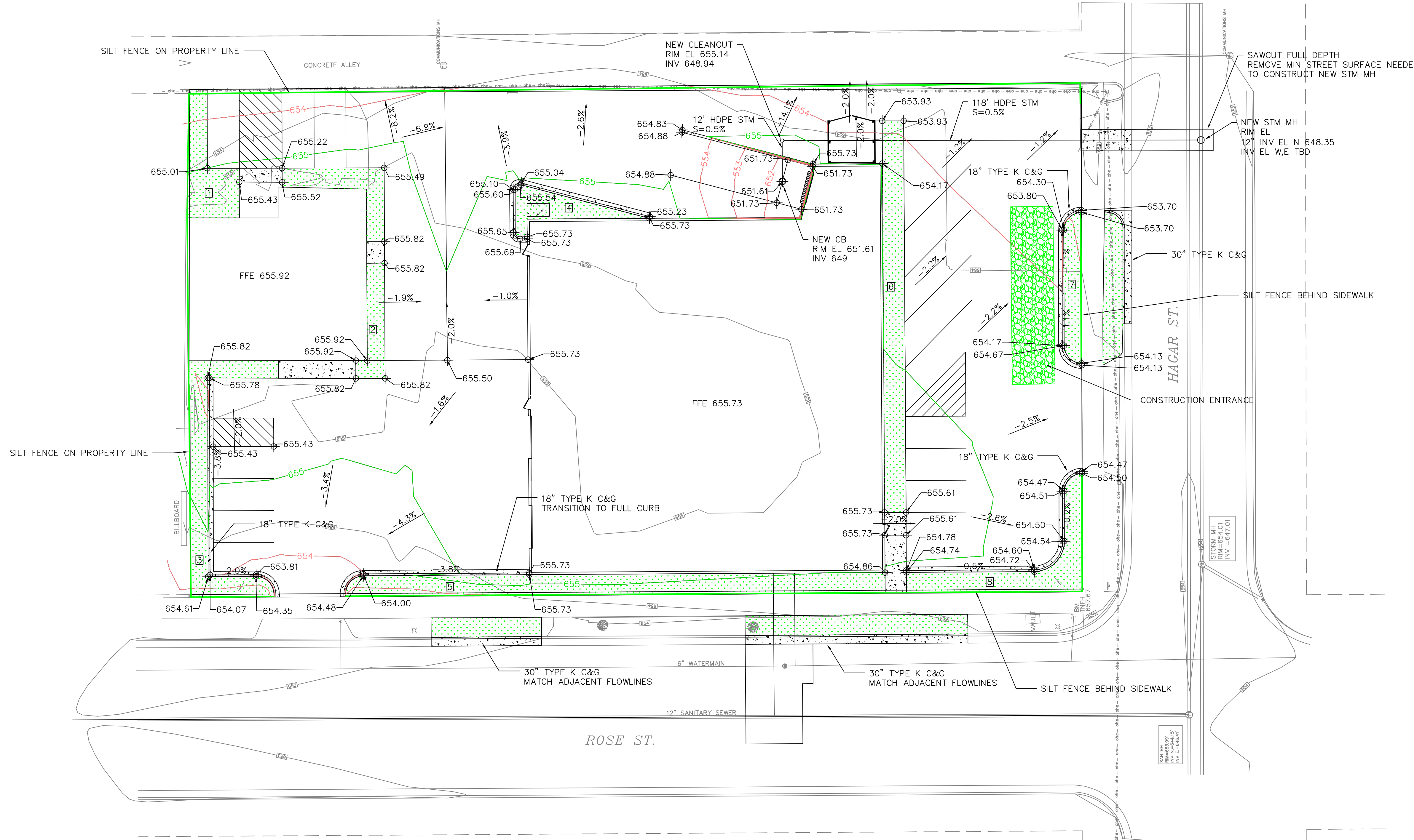

- CONSTRUCTION ENTRANCE
WISDOT STANDARD DETAIL BE14
- SILT FENCE
WISDOT STANDARD DETAIL BE9

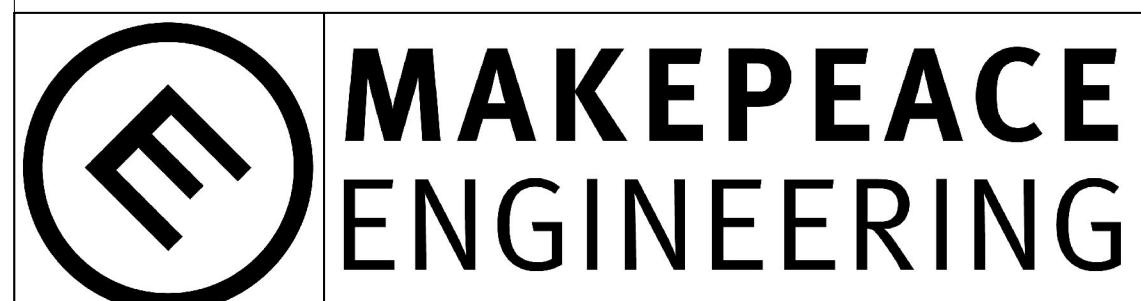

816 2ND AV S
 SUITE 800
 ONALASKA, WI 54650
 608.797.1025

CRDN ENTERPRISES
 ROSE & HAGAR STREET
 LA CROSSE, WI

08/25/2017

GRADING PLAN

DATE	REVISION	DESCR.	
			C102