



# City of La Crosse, Wisconsin

City Hall  
400 La Crosse Street  
La Crosse, WI 54601

## Meeting Agenda - Final

### Board of Public Works

---

Monday, April 14, 2025

10:00 AM

Council Chambers  
City Hall, First Floor

---

*The Board of Public Works meeting is open for in-person attendance and will also be conducted through video conferencing. The meeting can be viewed by visiting the Legislative Information Center (<https://cityoflacrosse.legistar.com/Calendar.aspx>) and clicking on the video link to the far right in the meeting list.)*

#### Call to Order

#### Roll Call

*Mitch Reynolds, Tamra Dickinson, Rebecca Schwarz, Andrea Trane, Matthew Gallagher.*

#### Approval of Minutes

*Minutes from April 7, 2025.*

#### Agenda Items:

- [25-0092](#) Bidder's Proof of Responsibility.
- [25-0401](#) Public Hearing - Application of Chippewa Concrete Services for a Limited Exemption for Construction Noise for sawing and removal of concrete and asphalt on HWY 16 from La Crosse Street to HWY 157, and request to waive application fee.
- [25-0421](#) Request to approve two radio interoperability participation plan agreements.
- [25-0433](#) Borton Construction Inc (on behalf of Badger Corrugating Company) request the use of public right of way for installment of angled parking stalls.
- [25-0434](#) Brightspeed Street Privilege Permit request for communications in right-of-way near 3611 29th Ct South.
- [25-0435](#) Brightspeed Street Privilege Permit request for communications in right-of-way near 2525 32nd St South.
- [25-0436](#) Brightspeed Street Privilege Permit request for communications in right-of-way near 3805 Elm Dr.
- [25-0437](#) Scenic Center LLC Street Privilege Permit request for mounting two air conditioners at 115 5th Ave S.

#### Adjournment

*Notice is further given that members of other governmental bodies may be present at the above scheduled meeting to gather information about a subject over which they have decision-making responsibility.*

**NOTICE TO PERSONS WITH A DISABILITY**

*Requests from persons with a disability who need assistance to participate in this meeting should call the City Clerk's office at (608) 789-7510 or send an email to [ADAcityclerk@cityoflacrosse.org](mailto:ADAcityclerk@cityoflacrosse.org), with as much advance notice as possible.*



# City of La Crosse, Wisconsin

City Hall  
400 La Crosse Street  
La Crosse, WI 54601

## Text File

File Number: 25-0092

---

**Agenda Date:** 4/14/2025

**Version:** 1

**Status:** Agenda Ready

**In Control:** Board of Public Works

**File Type:** General Item



# City of La Crosse, Wisconsin

City Hall  
400 La Crosse Street  
La Crosse, WI 54601

## Text File

File Number: 25-0401

---

**Agenda Date:** 4/14/2025

**Version:** 1

**Status:** Agenda Ready

**In Control:** Board of Public Works

**File Type:** General Item



25-0401

**CITY OF LA CROSSE  
APPLICATION FOR LIMITED EXEMPTION FOR CONSTRUCTION NOISE**

**\*\* Application and fee must be submitted by noon at least 10 days prior to the Monday preceding the construction start date. Applications are acted upon by the Board of Public Works who meet on Mondays. \*\***

Applicant Name: Chippewa Concrete Services		Today's Date: 3-25-25
Applicant Business Address: 3030 110 <sup>th</sup> St Chippewa Falls WI 54729		
Applicant Business Phone: 715-723-5004	Cell Phone: 715-210-1515	E-mail: barry@chippewaconcrete.net
Project Manager Name: Barry Rohman	Cell Phone: 715-210-1515	E-mail: barry@chippewaconcrete.net
Address and/or Specific Area of Construction/Project (include map if necessary): Sta 16 from LaCrosse St to Sta 157		
Property Owner: Wis DOT	Property Owner Phone:	
Description of work. List specific equipment, quantity, and processes: Sawing & Removal of Concrete & Asphalt		
Project Start Date: 4-7-25		
Start Date for Exemption: 4-7-25		
Project End Date: 8-25-25		
End Date for Exemption: 8-25-25		
Specific time of day for Exemption (example: 7 pm to 10 pm, daily): 7pm to 7am		
Explanation of why this work cannot be done during normal work hours: Work schedule of Specifier/Contractor		
<b>For Office Use Only</b>		
Council Member District: 2, 3, 4, 5		Invoice #: _____
Notice of Hearing sent to Property Owners of Record within 300 feet. Date: 4/4/2025 (At least 10 days prior to date of BPW hearing)		Fee: _____
Board of Public Works Meeting Date: 4/14/2025		
Action: Approved _____ Disapproved _____		
Date notice of approval is sent to Applicant/Engineering/Police Department: _____		

Craig, Sondra

**From:** Mike Novey <mike.novey@daarcorp.com>  
**Sent:** Monday, March 31, 2025 7:21 AM  
**To:** Barry Bohman; Craig, Sondra; Sward, Stephanie; Gallagher, Matthew  
**Cc:** Mead & Hunt - Ryan Franzini; Mike Novey; Bainter, John C - DOT  
**Subject:** RE: Noise Permit

**Follow Up Flag:** Follow up  
**Flag Status:** Flagged

\*\*\* **CAUTION:** This email originated from an external sender. **DO NOT** click links or open attachments unless you recognize the sender and know the content is safe. \*\*\*

Sondra

Just to provide some clarification. The state let project consists of 3 separate project IDs (3700-10-64, 7575-01-65, and 7575-01-76). Of those 3 IDs, the 3700-10-64 ID is the work at the Losey Blvd/Lacrosse St intersection. It is more or less a city project that was tied with a group of state let projects. It is for the signals upgrade and has city funds included. It is also the main source of noise for this project within the city limits that is outside of the city ordinance. This is why Chippewa is requesting the waiver. Please let me know if you have any questions. Thanks.

**Mike Novey P.E.**  
DAA Engineering, Senior Project Manager  
151 E. Cook Street, Portage, WI 53901  
Cell: 608.334.5215  
 Teams  
Proudly serving our clients since 2001  
[www.daarcorp.com](http://www.daarcorp.com)

*The information contained in this message may be privileged, confidential, and protected from disclosure. If you have received this communication in error, please notify us immediately by replying to the message and deleting it from your computer. Thank you.*

**From:** Barry Bohman <barry@chippewaconcrete.net>  
**Sent:** Sunday, March 30, 2025 8:38 PM  
**To:** Craig, Sondra <craigs@cityoflacrosse.org>; Sward, Stephanie <swards@cityoflacrosse.org>; La Crosse - Matt Gallagher <gallagerm@cityoflacrosse.org>  
**Cc:** Mike Novey <mike.novey@daarcorp.com>; Mead & Hunt - Ryan Franzini <ryan.franzini@meadhunt.com>  
**Subject:** RE: Noise Permit

**CAUTION:** This email originated from outside of the organization. Do not click links or open attachments unless you recognize the sender and know the content is safe.

Craig  
Chippewa Concrete request a waiver on the permit fee do the funding of the project is partial done with the city funds. The project scope is both State and City of LaCrosse work and therefor should be exempt as the same as a City let project.

Thank you for the response and see the attached permit request

Barry Bohman  
Chippewa Concrete Services, Inc.  
O (715) 723-5004  
C (715) -210-1515

This e-mail (including attachments) is covered by the Electronic Communications Privacy Act, 18 U.S.C. 2510-2521, is confidential and may be privileged. If you are not the intended recipient, please be aware that any retention, dissemination, distribution, or copying of this communication is prohibited. Please reply to the sender if you have received this message in error and then delete it. Thank you for helping to maintain privacy.

---

**From:** Barry Bohman

**Sent:** Tuesday, March 25, 2025 1:32 PM

**To:** 'Craig, Sondra' <[craigs@cityoflacrosse.org](mailto:craigs@cityoflacrosse.org)>; Sward, Stephanie <[swards@cityoflacrosse.org](mailto:swards@cityoflacrosse.org)>

**Cc:** DAAR Eng - Mike Novey <[mike.novey@daarcorp.com](mailto:mike.novey@daarcorp.com)>; Mead & Hunt - Ryan Franzini <[ryan.franzini@meadhunt.com](mailto:ryan.franzini@meadhunt.com)>

**Subject:** RE: Noise Permit

This is a State project which does not require city permits, this was done in cooperation to the city and is not required by specification. I will pass this on to the Department to decide what they want to do.

Barry Bohman

Chippewa Concrete Services, Inc.

O (715) 723-5004

C (715) -210-1515

This e-mail (including attachments) is covered by the Electronic Communications Privacy Act, 18 U.S.C. 2510-2521, is confidential and may be privileged. If you are not the intended recipient, please be aware that any retention, dissemination, distribution, or copying of this communication is prohibited. Please reply to the sender if you have received this message in error and then delete it. Thank you for helping to maintain privacy.

---

**From:** Craig, Sondra <[craigs@cityoflacrosse.org](mailto:craigs@cityoflacrosse.org)>

**Sent:** Tuesday, March 25, 2025 1:21 PM

**To:** Barry Bohman <[barry@chippewaconcrete.net](mailto:barry@chippewaconcrete.net)>; Sward, Stephanie <[swards@cityoflacrosse.org](mailto:swards@cityoflacrosse.org)>

**Subject:** RE: Noise Permit

Barry,

The fee would only be waived if this is a City bid project where the contract specifically states that fees for City permits are waived. It is possible that your fees were waived in the past per the City contract for that specific contract.

I just spoke to the Director of Engineering who stated that this was not a City bid project.

**SONDRA CRAIG** (she/her)

**Deputy City Clerk**

City Clerk's Office

City of La Crosse

400 La Crosse Street

La Crosse WI 54601

[craigs@cityoflacrosse.org](mailto:craigs@cityoflacrosse.org)

Direct: 608.789.7549 | Office: 608.789.7510

Visit the City Clerk webpage: <https://www.cityoflacrosse.org/your-government/departments/city-clerk>

***City Clerk's Office hours: 8:00 a.m. to 4:30 p.m., Monday through Friday***

***Public Service hours 8:00 a.m. to 4:00 p.m. Monday through Thursday in the City Hall Lobby***



**From:** Barry Bohman <[barry@chippewaconcrete.net](mailto:barry@chippewaconcrete.net)>  
**Sent:** Tuesday, March 25, 2025 1:11 PM  
**To:** Craig, Sondra <[craigs@cityoflacrosse.org](mailto:craigs@cityoflacrosse.org)>; Sward, Stephanie <[swards@cityoflacrosse.org](mailto:swards@cityoflacrosse.org)>  
**Subject:** RE: Noise Permit

You don't often get email from [barry@chippewaconcrete.net](mailto:barry@chippewaconcrete.net). [Learn why this is important](#)

\*\*\* **CAUTION:** This email originated from an external sender. **DO NOT** click links or open attachments unless you recognize the sender and know the content is safe. \*\*\*

We have not had to pay for this permit in the pass

Barry Bohman  
Chippewa Concrete Services, Inc.  
O (715) 723-5004  
C (715) -210-1515

This e-mail (including attachments) is covered by the Electronic Communications Privacy Act, 18 U.S.C. 2510-2521, is confidential and may be privileged. If you are not the intended recipient, please be aware that any retention, dissemination, distribution, or copying of this communication is prohibited. Please reply to the sender if you have received this message in error and then delete it. Thank you for helping to maintain privacy.

**From:** Craig, Sondra <[craigs@cityoflacrosse.org](mailto:craigs@cityoflacrosse.org)>  
**Sent:** Tuesday, March 25, 2025 12:48 PM  
**To:** Barry Bohman <[barry@chippewaconcrete.net](mailto:barry@chippewaconcrete.net)>; Sward, Stephanie <[swards@cityoflacrosse.org](mailto:swards@cityoflacrosse.org)>  
**Subject:** RE: Noise Permit

Barry,

We received your application. In order for the exemption request to be added to the April 7 Board of Public Works meeting agenda, the \$200 payment needs to be submitted by noon on Friday, March 28. I can send you an invoice if needed.

Then I also just want to double-check that the work will be all along HWY 16 from La Crosse Street to the intersection of HWY 157 and 16 (Valley View Mall intersection).

Please let me know if you have any questions.

**SONDRA CRAIG** (she/her)

**Deputy City Clerk**

City Clerk's Office  
City of La Crosse  
400 La Crosse Street  
La Crosse WI 54601

[craigs@cityoflacrosse.org](mailto:craigs@cityoflacrosse.org)

Direct: 608.789.7549 | Office: 608.789.7510

Visit the City Clerk webpage: <https://www.cityoflacrosse.org/your-government/departments/city-clerk>

**City Clerk's Office hours: 8:00 a.m. to 4:30 p.m., Monday through Friday**

**Public Service hours 8:00 a.m. to 4:00 p.m. Monday through Thursday in the City Hall Lobby**

**From:** Barry Bohman <[barry@chippewaconcrete.net](mailto:barry@chippewaconcrete.net)>  
**Sent:** Tuesday, March 25, 2025 12:25 PM  
**To:** Sward, Stephanie <[swards@cityoflacrosse.org](mailto:swards@cityoflacrosse.org)>  
**Cc:** Craig, Sondra <[craigs@cityoflacrosse.org](mailto:craigs@cityoflacrosse.org)>  
**Subject:** Noise Permit

\*\*\* **CAUTION:** This email originated from an external sender. **DO NOT** click links or open attachments unless you recognize the sender and know the content is safe. \*\*\*

Barry Bohman  
Chippewa Concrete Services, Inc.  
O (715) 723-5004  
C (715) -210-1515

This e-mail (including attachments) is covered by the Electronic Communications Privacy Act, 18 U.S.C. 2510-2521, is confidential and may be privileged. If you are not the intended recipient, please be aware that any retention, dissemination, distribution, or copying of this communication is prohibited. Please reply to the sender if you have received this message in error and then delete it. Thank you for helping to maintain privacy.

This e-mail (including attachments) is covered by the Electronic Communications Privacy Act, 18 U.S.C. 2510-2521, is confidential and may be privileged. If you are not the intended recipient, please be aware that any retention, dissemination, distribution, or copying of this communication is prohibited. Please reply to the sender if you have received this message in error and then delete it. Thank you for helping to maintain privacy.

This e-mail (including attachments) is covered by the Electronic Communications Privacy Act, 18 U.S.C. 2510-2521, is confidential and may be privileged. If you are not the intended recipient, please be aware that any retention, dissemination, distribution, or copying of this communication is prohibited. Please reply to the sender if you have received this message in error and then delete it. Thank you for helping to maintain privacy.

This e-mail (including attachments) is covered by the Electronic Communications Privacy Act, 18 U.S.C. 2510-2521, is confidential and may be privileged. If you are not the intended recipient, please be aware that any retention, dissemination, distribution, or copying of this communication is prohibited. Please reply to the sender if you have received this message in error and then delete it. Thank you for helping to maintain privacy.

## Properties within 300 feet of project area (HWY 16 from La Crosse Street to HWY 157)

Tax Parcel	OwnerName	Property Address	Mailing Address	MailCityStateZip
17-10286-80	A & M PROPERTIES LLC	2133 SUNSET LN	PO BOX 28	VIROQUA WI 54665
17-10480-10	A & M PROPERTIES LLC	2119 SUNSET LN	PO BOX 28	VIROQUA WI 54665
17-20244-120	ABBY E WIEDMAN	937 MILSON CT	937 MILSON CT	LA CROSSE WI 54601-3959
17-20244-110	ADAM R ZART, MELISSA A ZART	927 MILSON CT	927 MILSON CT	LA CROSSE WI 54601
17-10480-40	AMBER E HANSEN, URIAH C HANSEN	2031 SUNSET LN	2031 SUNSET LN	LA CROSSE WI 54601
17-20038-50	AMY L THOMPSON	767 LOSEY BLVD N	767 LOSEY BLVD N	LA CROSSE WI 54601
17-10480-30	ANNETTE L GENT	2039 SUNSET LN	2039 SUNSET LN	LA CROSSE WI 54601
17-10287-800	APD HOLDINGS LLC	849 & 851 VISTA CT N	323 GREEN COULEE RD	ONALASKA WI 54650
17-10287-810	APD HOLDINGS LLC	839 & 841 VISTA CT N	323 GREEN COULEE RD	ONALASKA WI 54650
17-10287-820	APD HOLDINGS LLC	831 & 833 VISTA CT N	323 GREEN COULEE RD	ONALASKA WI 54650
17-10287-830	APD HOLDINGS LLC	821 & 823 VISTA CT N	323 GREEN COULEE RD	ONALASKA WI 54650
17-10287-840	APD HOLDINGS LLC	813 & 815 VISTA CT N	323 GREEN COULEE RD	ONALASKA WI 54650
17-20039-30	ATTN: THEODORE STANKE			
	LA CROSSE LOSEY CORNER LLC	707 LOSEY BLVD N	2401 LA CROSSE ST	LA CROSSE WI 54601
17-20039-40	ATTN: THEODORE STANKE			
	LA CROSSE LOSEY CORNER LLC	2411 LA CROSSE ST	2401 LA CROSSE ST	LA CROSSE WI 54601
17-20039-50	ATTN: THEODORE STANKE			
	LA CROSSE LOSEY CORNER LLC	2401 LA CROSSE ST	2401 LA CROSSE ST	LA CROSSE WI 54601
17-10465-30	AUSTYN P CAMPBELL, BRIDGET M LAGERHAUSEN	2212 SUNSET LN	2212 SUNSET LN	LA CROSSE WI 54601-3021
17-10286-182	BARRY L CHRISTENSON	3016 GILLETTE ST	3016 GILLETTE ST	LA CROSSE WI 54601-3036
17-10286-121	BENSON PARTNERS	2006 STATE ROAD 16	W7570 VAN AELSTYN CT	HOLMEN WI 54636
17-10286-122	BENSON PARTNERS	2000 STATE ROAD 16	W7570 VAN AELSTYN CT	HOLMEN WI 54636
17-10485-20	BETH DARST	STATE ROAD 16	PO BOX 1122	BLACK RIVER FALLS WI 54615
17-20073-10	BIG DUBBS LLC	2402 LA CROSSE ST	704 COUNTRY CLUB LN	ONALASKA WI 54650
17-10460-90	BIG FISH INVESTMENTS LLC	1835 SUNSET LN	614 MAIN ST	LA CROSSE WI 54601
17-10480-20	BLUFFVIEW CORPORATION	2103 & 2105 SUNSET LN	3815 MORMON COULEE RD STE 101	LA CROSSE WI 54601
17-20083-70	BRANDON D JACOBSON, ABIGAIL L STOCKHAM	2541 EDGEWOOD PL	2541 EDGEWOOD PL	LA CROSSE WI 54601-3977
17-10470-11	BRANDON J STRATMAN	2021 SUNSET LN	2021 SUNSET LN	LA CROSSE WI 54601
17-20073-30	BURLEIGH A RANDOLPH REVOCABLE TRUST	555 LOSEY BLVD N	555 LOSEY BLVD N	LA CROSSE WI 54601
17-20305-15	BURLINGTON NORTHERN RAILROAD COMPANY	2715 MAIN ST	PO BOX 961089	FORT WORTH TX 76161-0089
17-20039-20	BUSHEL 2 LLC	717 & 719 LOSEY BLVD N	301 GREEN COULEE RD	ONALASKA WI 54650
17-10286-100	CASTLE HEADQUARTERS LLC	2212 STATE ROAD 16	2218 STATE ROAD 16	LA CROSSE WI 54601
17-10286-140	CHRIS WEISS LLC	STATE ROAD 16	228 COUNTRY CLUB CT	LA CROSSE WI 54601
17-20244-30	CHRISTOPHER WYSONG, JENNIFER BLANK	944 MILSON CT	944 MILSON CT	LA CROSSE WI 54601
17-10491-21	CHRISTOPHER J MEYER	1418 SUNSET CT	1589 MEDARY LN	ONALASKA WI 54650
17-10491-22	CHRISTOPHER JAMES MEYER	1420 SUNSET CT	1589 MEDARY LN	ONALASKA WI 54650
17-10460-100	CIA SIAB INC	1825 SUNSET LN	1825 SUNSET LN	LA CROSSE WI 54601
17-10286-174	CITY OF LACROSSE	SUNSET CT	400 LA CROSSE ST	LA CROSSE WI 54601
17-10286-175	CITY OF LACROSSE	SUNSET CT	400 LA CROSSE ST	LA CROSSE WI 54601
17-10286-30	CITY OF LACROSSE	2000 RIVER VALLEY DR	400 LA CROSSE ST	LA CROSSE WI 54601
17-10286-70	CITY OF LACROSSE	2717 GILLETTE ST	400 LA CROSSE ST	LA CROSSE WI 54601
17-10287-390	CITY OF LACROSSE	STATE ROAD 16	400 LA CROSSE ST	LA CROSSE WI 54601
17-10315-804	CITY OF LACROSSE	STATE ROAD 16	400 LA CROSSE ST	LA CROSSE WI 54601
17-10315-851	CITY OF LACROSSE	CONOCO RD	400 LA CROSSE ST	LA CROSSE WI 54601
17-10315-900	CITY OF LACROSSE		400 LA CROSSE ST	LA CROSSE WI 54601
17-10315-901	CITY OF LACROSSE	CHESTNUT PL	400 LA CROSSE ST	LA CROSSE WI 54601
17-10406-700	CITY OF LACROSSE	COUNTY ROAD B	400 LA CROSSE ST	LA CROSSE WI 54601
17-10491-200	CITY OF LACROSSE	1301 SUNSET CT	400 LA CROSSE ST	LA CROSSE WI 54601
17-10679-200	CITY OF LACROSSE	901 COUNTY ROAD FA	400 LA CROSSE ST	LA CROSSE WI 54601
17-20245-20	CITY OF LACROSSE	901 MILSON CT	400 LA CROSSE ST	LA CROSSE WI 54601
17-20260-10	CITY OF LACROSSE	2600, 2702, 2710 QUARRY RD		
		748 LOSEY BLVD N	400 LA CROSSE ST	LA CROSSE WI 54601
17-20264-520	CITY OF LACROSSE	1100 STATE ROAD 16		
		2900 & 2915 BLUFF PASS	400 LA CROSSE ST	LA CROSSE WI 54601
17-20305-9	CITY OF LACROSSE	600 LOSEY BLVD N	400 LA CROSSE ST	LA CROSSE WI 54601
17-10315-710	CITY OF ONALASKA	STATE ROAD 16	415 MAIN ST	ONALASKA WI 54650
17-20039-10	COMPASS PROPERTY MANAGEMENT LAX LLC	723 & 725 LOSEY BLVD N	N5571 SOBKOWIAK RD	ONALASKA WI 54650
17-20039-90	COMPASS PROPERTY MANAGEMENT LAX LLC	728 & 730 24TH ST N	N5571 SOBKOWIAK RD	ONALASKA WI 54650
17-10315-783	CP RAIL TAX DEPARTMENT	COUNTY ROAD B	120 6TH ST S FL 7	MINNEAPOLIS MN 55402
17-20083-120	CRAIG S ZEEB	2526 EDGEWOOD PL	2526 EDGEWOOD PL	LA CROSSE WI 54601
17-10286-173	CT REAL ESTATE INVESTMENTS LLC	1440 SUNSET CT	W5864 STATE ROAD 33	LA CROSSE WI 54601
17-10520-30	DAHM NO 75 LLC	3333 STATE ROAD 16	11700 EXIT 5 PKWY STE 100	FISHERS IN 46037
17-20041-140	DAVID A KELBER, TERESA M KELBER	2323 LA CROSSE ST	2323 LA CROSSE ST	LA CROSSE WI 54601
17-10460-30	DAVID J GANSCHOW, SUSAN J GANSCHOW	1911 SUNSET	1911 SUNSET LN	LA CROSSE WI 54601-3020
17-20038-110	DESMOND INVESTMENTS II LLC	741 LOSEY BLVD N	620 CASS ST	LA CROSSE WI 54601
17-20244-130	DIANA JOHNSON-SALVADOR, SAMUEL P PRZYWOJSKI	947 MILSON CT	947 MILSON CT	LA CROSSE WI 54601-3959
17-20084-20	DIANE STOCKHAM	2540 EDGEWOOD PL	2540 EDGEWOOD PL	LA CROSSE WI 54601
17-40376-310	DMY INTESTMENTS LLC	2102 STATE ROAD 16	2102 STATE ROAD 16	LA CROSSE WI 54601
17-20039-80	DONALD R GREENGRASS, CINDY L GREENGRASS	724 24TH ST N	724 24TH ST N	LA CROSSE WI 54601-3829
17-10315-800	EB ESTATES LLC	2306 & 2312 STATE ROAD 16	629 PETTIBONE POINTE WAY	LA CROSSE WI 54601
		2320, 2322, 2324, 2326, 2344, 2346, 2348, 2350, 2352, 2354, 2356, 2358, 2360, 2362, 2354, 2370, 2372, 2374, 2400, 2402, 2404, 2405, 2408, 2410, 2412, 2414 STATE ROAD 16		
17-10315-803	EB ESTATES LLC		629 PETTIBONE POINTE WAY	LA CROSSE WI 54601
17-40380-270	EDISON P MCDANIELS II	1322 SUNSET CT	1322 SUNSET CT	LA CROSSE WI 54601
17-20244-90	EDWARD D YOUNG, ANITA C YOUNG	913 MILSON CT	913 MILSON CT	LA CROSSE WI 54601-3959
17-40380-320	ERNEST JOHN MILLER, JO ANN MILLER	1308 SUNSET CT	3422 73RD AVE N	MOORHEAD MN 54560
17-20244-10	FRANCIS G DEVINE	964 MILSON CT	964 MILSON CT	LA CROSSE WI 54601-3902
17-20084-10	GEORGE F KROKER JOINT REVOCABLE TRUST,			
	LESLIE K PEICKERT-KROKER JOINT REVOCABLE TRUST	2532 EDGEWOOD PL	2532 EDGEWOOD PL	LA CROSSE WI 54601
17-10491-12	HARTMAN PROPERTIES LLC	1382 SUNSET CT	200 MASON ST UNIT 10	ONALASKA WI 54650
17-10491-20	HARTMAN PROPERTIES LLC	1396, 1400, 1404, 1408 SUNSET CT	200 MASON ST UNIT 10	ONALASKA WI 54650
17-20083-80	J PAUL SIMONES	2539 EDGEWOOD PL	2539 EDGEWOOD PL	LA CROSSE WI 54601-3977
17-10287-925	JACQUELINE M SWAN-COADY, WILLIAM M COADY JR	836 VISTA CT N	836 VISTA CT N	LA CROSSE WI 54601
17-20073-20	JAG REAL ESTATE INVESTMENTS LLC	561 LOSEY BLVD N	704 COUNTRY CLUB LN	ONALASKA WI 54650
17-20083-30	JAMES B RINGSTROM REVOCABLE TRUST	2545 EDGEWOOD PL	2545 EDGEWOOD PL	LA CROSSE WI 54601-3977

## Properties within 300 feet of project area (HWY 16 from La Crosse Street to HWY 157)

Tax Parcel	OwnerName	Property Address	Mailing Address	MailCityStateZip
17-10465-50	JAMES S STEWART	2142 SUNSET LN	2142 SUNSET LN	LA CROSSE WI 54601-3021
17-20083-110	JAY E LOWENSTEIN, KRISTINE KRALL-LOWENSTEIN	2520 EDGEWOOD PL	2520 EDGEWOOD PL	LA CROSSE WI 54601
17-10286-176	JCB PROPERTY INVESTMENTS LLC	1507 STATE ROAD 16	N4612 MEADOW WOOD LN	ONALASKA WI 54650
17-10688-20	JFTCO INC	1620 CAROL CT	1 FABICK DR	FENTON MO 63026
17-20073-50	JOHN G LETTNER, KRISTIN N LETTNER	541 LOSEY BLVD N	541 LOSEY BLVD N	LA CROSSE WI 54601
17-20245-50	JOSEPH W FARWELL, REBECCA L FARWELL	10 STATE ROAD 16	10 STATE ROAD 16	LA CROSSE WI 54601
17-20038-40	JOSEPH W MIZE, ERICA L MIZE	771 LOSEY BLVD N	771 LOSEY BLVD N	LA CROSSE WI 54601-3968
17-10470-30	KENNETH J CROWLEY, PATRICIA A CROWLEY	2030 STATE ROAD 16	2030 STATE ROAD 16	LA CROSSE WI 54601
17-10287-920	KEVIN D SCHALER, JESSICA M SCHALER	846 VISTA CT N	846 VISTA CT N	LA CROSSE WI 54601
17-10520-10	KWIK TRIP INC	3525 STATE ROAD 157	1626 OAK ST	LA CROSSE WI 54603
17-10475-20	LA CROSSE VETERINARY CLINIC	2128 STATE ROAD 16	2128 STATE ROAD 16	LA CROSSE WI 54601
17-10254-61	LACROSSE COUNTY	CONOCO RD	212 6TH ST N RM 2400	LA CROSSE WI 54601
17-10286-90	LACROSSE COUNTY	STATE ROAD 16	212 6TH ST N RM 2400	LA CROSSE WI 54601
17-10315-795	LACROSSE COUNTY	2401 STATE ROAD 16	212 6TH ST N RM 2400	LA CROSSE WI 54601
17-10315-619	LACROSSE PR INC	3130 CHESTNUT PL	PO BOX 282	WATERLOO WI 53594
17-40380-300	LAURA P HUBER	1312 SUNSET CT	1312 SUNSET CT	LA CROSSE WI 54601
17-20083-90	LAWRENCE PAUL WEISBROD, JILL MARIE SCHULLER-WEISBROD	2537 EDGEWOOD PL	2537 EDGEWOOD PL	LA CROSSE WI 54601
17-20244-80	LEANNE R DEBAUCHE	903 MILSON CT	903 MILSON CT	LA CROSSE WI 54601-3959
17-10430-40	LORI D PRETASKY	2240 SUNSET LN	2240 SUNSET LN	LA CROSSE WI 54601
17-20038-130	LUKE N NOFFKE	733 LOSEY BLVD N	733 LOSEY BLVD N	LA CROSSE WI 54601
17-10470-14	MAI XIONG, XONG XIONG	2007 SUNSET LN	2009 SUNSET LN	LA CROSSE WI 54601
17-10315-622	MAPLEWOOD DENTAL BUILDING LLC	2830 DARLING CT	4607 ROYAL DR	EAU CLAIRE WI 54701
17-20244-20	MARK F DEVINE, CAROL A DEVINE	954 MILSON CT	954 MILSON CT	LA CROSSE WI 54601
17-10460-60	MARK J ERICKSON, ANNORA L ERICKSON	1845 SUNSET LN	1845 SUNSET LN	LA CROSSE WI 54601-3020
17-10315-852	MATHY CONSTRUCTION COMPANY	2603 CONOCO RD	920 10TH AVE N	ONALASKA WI 54650
17-10315-697	MATTHEW D HABERL, ROBIN G CONSTANTINO	3611 COUNTY ROAD B	3611 COUNTY ROAD B	LA CROSSE WI 54601-2955
17-20073-40	MATTHEW GORDY, KRISTEN STOKELY	547 LOSEY BLVD N	547 LOSEY BLVD N	LA CROSSE WI 54601
17-10315-621	MAXIN LLC	2942, 2946, 2950 DARLING CT	1153 BRIDGER DR	HOLMEN WI 54636
17-10465-20	MCDONALD FAMILY TRUST	2220 SUNSET LN	2060 JESSUP RD	OVIDO FL 32765
17-20039-60	MICHAEL C SCHIEBER, ROGER D DAHL	718 24TH ST N	718 24TH ST N	LA CROSSE WI 54601
17-10315-30	MIDWEST BOTTLE GAS COMPANY	3600 STATE ROAD 157	PO BOX 429	LA CROSSE WI 54602-0429
17-10460-190	MMAP LAND LLC	1800 STATE ROAD 16	1718 STATE ROAD 16	LA CROSSE WI 54601
17-10470-25	NALCV001 LLC	2010 STATE ROAD 16	30 LASALLE ST N STE 4140	CHICAGO IL 60602
17-10520-20	NELSON PROPERTIES OF LACROSSE LLC	3605 STATE ROAD 157	121 CHURCH DR	LA CROSSE WI 54603
17-10460-210	NESNAH GROUP REAL ESTATE 1 LLC	1718 STATE ROAD 16	1718 STATE ROAD 16	LA CROSSE WI 54601
17-10315-790	NORTHERN STATES POWER CO	CONOCO RD	PO BOX 8	EAU CLAIRE WI 54702-0008
17-40376-320	ODOD LLC	2104 STATE ROAD 16	2104 STATE ROAD 16	LA CROSSE WI 54601
17-20038-60	PATRICK J SMITH	765 LOSEY BLVD N	3215 GEORGE ST UNIT 6	LA CROSSE WI 54601
17-20039-100	PATRICK J SMITH	736 24TH ST N	3215 GEORGE ST UNIT 6	LA CROSSE WI 54601
17-40376-300	PAFF REAL ESTATE HOLDINGS LLC	2100 STATE ROAD 16	2010 GRAND VIEW BLVD	ONALASKA WI 54650
17-10315-620	PINETREE ENTERPRISES LLC	3039 MEDCO CT	12808 FROST POINT WAY	APPLE VALLEY MN 55124
17-10315-50	PRINCESS BBQ LLC	3055 STATE ROAD 16	228 RED APPLE DR	LA CRESCENT MN 55947
17-10286-191	PROPERTY LOGIC III LLC	1415, 1417, 1421, 1423, 1425, 1427, 1429, 1431 STATE ROAD 16	PO BOX 2132	LA CROSSE WI 54602-2132
17-10286-192	PROPERTY LOGIC III LLC	STATE ROAD 16	PO BOX 2132	LA CROSSE WI 54602-2132
17-20038-100	PT INVESTMENT GROUP LLC	747 LOSEY BLVD N	747 LOSEY BLVD N	LA CROSSE WI 54601
17-20038-120	PT INVESTMENT GROUP LLC	739 LOSEY BLVD N	324 10TH ST S	LA CROSSE WI 54601-4733
17-20244-140	RANDINE L MITROVIC	959 MILSON CT	959 MILSON CT	LA CROSSE WI 54601-3959
17-10315-25	REALTY INCOME CORPORATION	3616 STATE ROAD 157	20225 SCOTTSDALE RD N	SCOTTSDALE AZ 85255
	REALTY INCOME PROPERTIES 6 LLC			
17-10375-10	C/O BMO HARRIS BANK NA	3500 STATE ROAD 16	111 MONROE ST W	CHICAGO IL 60603
17-10460-110	RICHARD F MOLZAHN IRREVOCABLE TRUST	1822 STATE ROAD 16	259 LARKSPUR LN E	ONALASKA WI 54650
17-10460-130	RICHARD F MOLZAHN IRREVOCABLE TRUST	STATE ROAD 16	259 LARKSPUR LN E	ONALASKA WI 54650
17-10460-150	RICHARD F MOLZAHN IRREVOCABLE TRUST	STATE ROAD 16	259 LARKSPUR LN E	ONALASKA WI 54650
17-10460-220	RICHARD F MOLZAHN IRREVOCABLE TRUST	STATE ROAD 16	259 LARKSPUR LN E	ONALASKA WI 54650
17-20038-80	RICKEY ZIELKE, TERESA M ZIELKE	757 LOSEY BLVD N	757 LOSEY BLVD N	LA CROSSE WI 54601-3968
17-40380-290	RICKY L TILLOTSON, JACQUELINE L TILLOTSON	1316 SUNSET CT	1316 SUNSET CT UNIT 15	LA CROSSE WI 54601
17-10286-123	ROBERT EKKER	1939 SUNSET LN	203 EAGLES BLUFF RD	LA CRESCENT MN 55947
17-20038-90	ROBERT J COOPER, CATHLEEN A COOPER	755 LOSEY BLVD N	435 24TH ST N	LA CROSSE WI 54601
17-20039-120	ROBERT M BURZINSKI	744 & 748 24TH ST N	3158 28TH ST S	LA CROSSE WI 54601-7612
17-10287-1	ROBERT NUMSEN REVOCABLE TRUST, DIAN K NUMSEN REVOCABLE TRUST	858 VISTA CT N	N3184 VISTA CT N	LA CROSSE WI 54601
17-10315-820	ROBERT W LEVENDOSKI, SUSAN E LEVENDOSKI	2436 CONOCO RD	707 KRUEGER CT	ONALASKA WI 54650
17-10315-827	ROBERT W LEVENDOSKI, SUSAN E LEVENDOSKI	2436 CONOCO RD	707 KRUEGER CT	ONALASKA WI 54650
17-20244-100	SAMUEL S CLASON, ALEXIS QUICKSELL	919 MILSON CT	919 MILSON CT	LA CROSSE WI 54601-3959
17-10470-13	SCOTT FERRIER	2013 SUNSET LN	N5854 ABNET RD	ONALASKA WI 54650
17-10287-220	SHELTER DEVELOPMENT INC	158 STATE ROAD 16	1009 4TH ST S	LA CROSSE WI 54601
17-10315-854	SSAL LIVING TRUST	3530 COUNTY ROAD B	W5973 COUNTY ROAD B	LA CROSSE WI 54601
17-10465-10	STACEY M SAGLER, CODY A SAGLER	2228 SUNSET LN	2228 SUNSET LN	LA CROSSE WI 54601
17-10315-840	STATE OF WISCONSIN DNR		PO BOX 7921	MADISON WI 53707-7921
	STATE OF WISCONSIN DNR			
17-10315-703	C/O KARL E HANSEN	COUNTY ROAD B	PO BOX 7921	MADISON WI 53707-7921
17-10287-350	STATE OF WISCONSIN DOT	STATE ROAD 16	3550 MORMON COULEE RD	LA CROSSE WI 54601
17-10315-817	STATE OF WISCONSIN DOT	CONOCO RD	3550 MORMON COULEE RD	LA CROSSE WI 54601
17-10315-910	STATE OF WISCONSIN DOT	STATE ROAD 16	3550 MORMON COULEE RD	LA CROSSE WI 54601
17-10485-10	STATE OF WISCONSIN DOT	CONOCO RD	3550 MORMON COULEE RD	LA CROSSE WI 54601
17-10490-10	STATE OF WISCONSIN DOT	1700 STATE ROAD 16	3550 MORMON COULEE RD	LA CROSSE WI 54601
17-10490-100	STATE OF WISCONSIN DOT	STATE ROAD 16	3550 MORMON COULEE RD	LA CROSSE WI 54601
17-10490-101	STATE OF WISCONSIN DOT	STATE ROAD 16	3550 MORMON COULEE RD	LA CROSSE WI 54601
17-20083-100	STATE OF WISCONSIN DOT	2516 EDGEWOOD PL	3550 MORMON COULEE RD	LA CROSSE WI 54601
17-20039-70	STEPHEN D WOODWARD, EMILY T HUGHES	720 24TH ST N	720 24TH ST N	LA CROSSE WI 54601
17-10286-211	SUNSET 16 APARTMENTS LLC	3004 & 3008 GILLETTE ST	707 LA CROSSE ST STE 102	LA CROSSE WI 54601
17-10491-13	SUNSET COURT PROPERTIES LLC	1324 SUNSET CT	N5854 ABNET RD	ONALASKA WI 54650
17-40380-280	SUNSET COURT PROPERTIES LLC	1318 SUNSET CT	N5854 ABNET RD	ONALASKA WI 54650
17-20038-140	THOMAS M MARTY	727 LOSEY BLVD N	727 LOSEY BLVD N	LA CROSSE WI 54601
17-20039-110	THOMAS R LARKIN FAMILY IRREVOCABLE TRUST	740 24TH ST N	740 24TH ST	LA CROSSE WI 54601
17-20038-70	TIMOTHY A HOLT	759 LOSEY BLVD N	759 LOSEY BLVD N	LA CROSSE WI 54601

## Properties within 300 feet of project area (HWY 16 from La Crosse Street to HWY 157)

Tax Parcel	OwnerName	Property Address	Mailing Address	MailCityStateZip
17-20073-120	TODD W OSMUNDSON, ANGELA C IMHOFF	548 24TH ST N	548 24TH ST N	LA CROSSE WI 54601
17-10315-853	TOP NOTCH AUTO LLC	3404 COUNTY ROAD B	3404 COUNTY ROAD B	LA CROSSE WI 54601
17-10491-23	TRAVIS G WELCH, STEPHANIE E WELCH	1412 SUNSET CT	310 23RD ST N	LA CROSSE WI 54601
17-40380-310	TY J VANNIEUWENHOVEN, JOANN E AMEND	1310 SUNSET CT	1310 SUNSET CT	LA CROSSE WI 54601
17-10315-15	US REALTY 87 LACROSSE ASSOCIATES LP	3131, 3133, 3201 STATE ROAD 16	820 MORRIS TPKE STE 301	SHORT HILLS NJ 07078
	C/O LINDEN RFC MANAGEMENT CORP	3320 STATE ROAD 157		
17-10315-90	VALLEY VIEW REALTY HOLDING LLC	3800 STATE ROAD 16	1010 NORTHERN BLVD STE 234	GREAT NECK NY 11021
17-10287-320	VITERBO UNIVERSITY INC	N3175 STATE ROAD 16	900 VITERBO DR	LA CROSSE WI 54601
17-10254-63	WADE J WOODS, VICKIE A WOODS	CONOCO RD	W504 SUNSHINE DR	STODDARD WI 54658
17-10315-611	WEST COAST DEVELOPMENT LLC	2830 DARLING CT	3152 33RD ST S	LA CROSSE WI 54601
	TOWN OF MEDARY CLERK	Various properties along HWY 16 are Town of Medary	N3393 SMITH VALLEY RD	LA CROSSE WI 54601
	CITY OF ONALASKA CLERK	Various properties along HWY 16 are City of Onalaska	415 MAIN ST	ONALASKA WI 54650

Applicant: CHIPPEWA CONCRETE SERVICES, INC.

3030 110TH ST

CHIPPEWA FALLS WI 54729





Areas shown outlined in red are locations within 300 feet of the locations of construction noise (along HWY 16 from La Crosse Street on the south and HWY 157 on the north).

**NOTICE OF HEARING ON  
LIMITED EXEMPTION FOR CONSTRUCTION NOISE**

TO WHOM IT MAY CONCERN:

Notice is hereby given, pursuant to Sec. 32-134 of the La Crosse Municipal Code, that the Board of Public Works of the City of La Crosse will hold a public hearing on the **Application of Chippewa Concrete Services for a Limited Exemption for Construction Noise** as follows:

**Specific area of Construction:** Highway 16 from La Crosse Street to Highway 157

**Description of work:** sawing and removal of concrete and asphalt

**Dates and time seeking exemption for construction noise:** April 14, 2025 through August 25, 2025

**Explanation of why this work cannot be done in normal working hours:** work schedule of specific times (7 pm to 7 am)

Such public hearing will be held at 10:00 a.m. on **Monday, April 14, 2025** in the Council Chambers of City Hall, 400 La Crosse Street, La Crosse, La Crosse County, Wisconsin. The meeting will also be held via video conferencing; please contact the City Clerk's office (608-789-7510 or [cityclerk@cityoflacrosse.org](mailto:cityclerk@cityoflacrosse.org)) for the meeting link.

You are further notified that any person affected may be heard, and may appear in person or by attorney, or may file a written objection in the office of the City Clerk, La Crosse City Hall, 400 La Crosse Street.

This notice is given pursuant to the order of the Common Council of the City of La Crosse.

Dated this 4<sup>th</sup> day of April, 2025.

Nikki Elsen, City Clerk  
City of La Crosse

**Per Municipal Code Sec. 32-134:** No person shall operate or permit the operation of any equipment used in construction work in such a manner as to unreasonably interfere with the peace, comfort, and quality of life of neighboring persons...between the hours of 7:00 p.m. and 7:00 a.m. of the following day, unless engaged in bona fide temporary construction work during the hours of 7:00 a.m. and 7:00 p.m., or if following a public hearing before the Board of Public Works approves temporary construction work between 7:00 p.m. and 7:00 a.m.

Such hour limitations shall not apply to emergencies where immediate action is required. Such *construction noise* on Saturday and Sunday shall be between 7:00 a.m. and 6:00 p.m. on Saturday and 9:00 a.m. to 5:00 p.m. on Sunday.

-----  
*Notice of hearing is mailed at least 10 days prior to the hearing to property owners of record situated within 300 feet of the boundaries of the properties on which the construction is to take place. You are receiving notice because you have the following property located within 300 feet of the area listed above.*

Applicant: –  
CHIPPEWA CONCRETE SERVICES, INC.

## Craig, Sondra

---

**From:** Craig, Sondra  
**Sent:** Thursday, April 3, 2025 8:54 AM  
**Subject:** FYI - Notice of Hearing for Limited Exemption for Construction Noise

Council Members Goggin, Janssen, Slezniak & Kahlow,

Chippewa Concrete Services has submitted an application for Limited Exemption for Construction Noise for sawing and removal of concrete and asphalt for a project on Highway 16 from La Crosse Street to Highway 157. They have also requested a waiver of the application fee. You are receiving this email as you are the Council Members for the areas where the construction is located (Districts 2, 3, and 4, and for 5 I've included Council President Kahlow).

Notice of the hearing is being mailed to the applicant and property owners within 300 feet of the project area today. I didn't think I would get all of the envelopes stuffed until Friday, so the notice is dated the 4<sup>th</sup>, but I figured since they're done I'd get them out a day early. The hearing has been scheduled before BPW on Monday, April 14, 2025. The application is Legistar File [25-0401](#) and includes a copy of the application, request for waiver of fee, buffer list/map, and notice of hearing.

Please let me know if you have any questions.

Thank you,

**SONDRA CRAIG** (she/her)

**Deputy City Clerk**

City Clerk's Office

City of La Crosse

400 La Crosse Street

La Crosse WI 54601

[craigs@cityoflacrosse.org](mailto:craigs@cityoflacrosse.org)

Direct: 608.789.7549 | Office: 608.789.7510

Visit the City Clerk webpage: <https://www.cityoflacrosse.org/your-government/departments/city-clerk>

***City Clerk's Office hours: 8:00 a.m. to 4:30 p.m., Monday through Friday***

***Public Service hours 8:00 a.m. to 4:00 p.m. Monday through Thursday in the City Hall Lobby***

Elected Officials and Members of Official Committees:

In order to comply with open meeting requirements, please limit any reply to only the sender of this electronic communication.

CITY CLERK  
400 LA CROSSE ST  
LA CROSSE WI 54601-3396

RETURN SERVICE REQUESTED

PATRICK J SMITH  
3215 GEORGE ST UNIT 6  
LA CROSSE WI 54601

63 BRO 144861535983 INT

Presort  
First Class Mail  
ComBasPrice



US POSTAGE  
PATNEY BOWES  
ZIP 54601 \$000.62  
02 1W  
0001399329 APR 04 2025

553 MFE 153712410004/06/25  
FORWARD TIME EXP RTN TO SEND  
3215 GEORGE ST UNIT 6  
LA CROSSE WI 54601-3396

RETURN TO SENDER



CITY CLERK

400 LA CROSSE ST

LA CROSSE WI 54601-3396

RETURN SERVICE REQUESTED

ROBERT EKKER  
203 EAGLES BLUFF RD  
LA CRESCENT MN 55947

9400922878094150

INT

50 APR 14 2025 15:37

Presort  
First Class Mail  
Comb Gas Price



US POSTAGE  
ZIP 54601 \$000.62  
0601399329 APR 04 2025

NIXIE 553 NEE 1537 2510004/06/25  
RETURN TO SENDER  
NOT DELIVERABLE AS ADDRESSED  
UNABLE TO FORWARD

BC 54601335699 2878-00305-06-21

CITY CLERK

400 LA CROSSE ST

LA CROSSE WI 54601-3396

RETURN SERVICE REQUESTED

JAMES B RINGSTROM REVOCABLE TRUST  
2545 EDGEWOOD PL  
LA CROSSE WI 54601-3977

Presort  
First Class Mail  
ComBasPrice



US POSTAGE  
EAGLE  
FIRST CLASS PERMIT NO. 1000  
LA CROSSE, WI

ZIP 54601 \$000.62  
02 1W  
001399329 APR 04 2025



\*T 553 NDE 153702412204/07/25  
RETURN TO SENDER  
RINGSTROM JAMES B  
TEMPORARILY AWAY

BC: 54601339699 \*0878-01742-07-22



74 BRO IN 136 0345106  
INT



# City of La Crosse, Wisconsin

City Hall  
400 La Crosse Street  
La Crosse, WI 54601

## Text File

File Number: 25-0421

---

**Agenda Date:** 4/14/2025

**Version:** 1

**Status:** Agenda Ready

**In Control:** Board of Public Works

**File Type:** General Item



City of La Crosse, Wisconsin and Shelby Fire Department

RADIO INTEROPERABILITY PARTICIPATION PLAN

The following mobile and portable subscriber radios are allowed access to the City of La Crosse radio network for use in the Shelby Fire Department in supporting police and fire public safety:

I.

Quantity	Equipment	Primary Assignment/Use
11	Motorola APX Series Mobiles and Portables	Daily operational communications for the Shelby Fire Department and interoperable communications with the City of La Crosse Police and Fire.

II. Radio Fleet Map for Shelby Department system access:

A. La Crosse Fire Interoperability Talkgroups:

- Shelby radios will be allowed access to La Crosse Fire Talkgroups: FD-1, FD-2

III. Designated Radio System Administrator for City of La Crosse:

The following person is designated as the City contact for any issues related to operation and maintenance of the City's subscriber equipment:

Jacky Greschner  
Director of Information and Technology  
400 La Crosse Street  
La Crosse, WI 56401  
(608) 789-3888, greschnerjcityoflacrosse.org

IV. Designation of the City of La Crosse's authorized equipment vendor:

The following communication vendor is designated as the City's contracted vendor who it is understood is the City's only qualified vendor allowed to program Shelby subscriber equipment onto the City's radio network. If the City contracts with another or different qualified vendor it will provide Shelby with notification of such change.

Baycom (an authorized Motorola P25 system dealer)  
Attn: Service Manager  
3470 Losey Blvd South  
La Crosse, WI 54601  
(608) 788-8980

V. Designation of Shelby Fire Department Radio Administrator:

Travis Proksch  
Assistant Fire Chief  
2801 Ward Ave  
La Crosse, WI 54601  
tproksch@townofshelbywi.gov



## VI. Shelby Fire Department Radio Hardware/Equipment

The City of La Crosse shall incur no costs or fees in connection with Shelby use of the radio network.

## VII. Termination and Assignment of Agreement

Either party to this agreement may revoke this agreement at any time, at will, without cause by providing 90 days' notice to the other party. The Shelby Fire Department shall not assign or transfer this agreement to any other party without the express written consent of the City of La Crosse.

## VIII. Indemnification

To the extent authorized by Wisconsin state law, the Shelby Fire Department agrees to indemnify, defend, save, and hold harmless, the City of La Crosse, its agents, officers, and employees from and against all liabilities, losses, suits, claims, judgments, fines, or demands of any kind or nature, arising from, or related to, or caused by the Shelby Fire Department - La Crosse's use of the City of La Crosse Radio Network and talk groups.

IN WITNESS WHEREOF, the parties have caused this agreement to be executed on the 26<sup>th</sup> day of March, 2025.

CITY OF LA CROSSE		SHELBY FIRE DEPARTMENT	
B Y <u>Mitch Reynolds</u> Mitch Reynolds, Mayor	B Y <u>Travis Proksch</u> Travis Proksch		
B Y <u>Nikki Elsen</u> Nikki Elsen, City Clerk	B Y _____		
B Y <u>Jeff Schott</u> Jeff Schott, Fire Chief	B Y _____		
B Y <u>Jacky Greschner</u> Jacky Greschner, Director of IT	B Y _____		

**City of La Crosse, Wisconsin and Stoddard-Bergen Volunteer Fire Department**

**RADIO INTEROPERABILITY PARTICIPATION PLAN**

The following mobile and portable subscriber radios are allowed access to the City of La Crosse radio network for use in the Stoddard-Bergen Volunteer Fire Department in supporting police and fire public safety:

I.

Quantity	Equipment	Primary Assignment/Use
3	Motorola APX Series Mobiles and Portables (20 portables and 5 Mobiles) Specific model, serial number and radio ID to be provided by addendum.	Daily operational communications for the Stoddard-Bergen Volunteer Fire Department and interoperable communications with the City of La Crosse Police and Fire.
1	Kenwood VP8000 PORTABLE S/N: C3160189	SBFD Chief
1	Kenwood VP8000 PORTABLE S/N: C3663028	SBFD OIC
1	Kenwood VM7000 MOBILE S/N: X73006226330001	SBFD E2

II. Radio Fleet Map for Stoddard-Bergen Volunteer Fire Department system access:

A. La Crosse Fire Interoperability Talk groups:

- Stoddard radios will be allowed access to La Crosse Fire Talk groups: FD-1, **FD-2**

III. Designated Radio System Administrator for City of La Crosse:

The following person is designated as the City contact for any issues related to operation and maintenance of the City's subscriber equipment:

Jacky Greschner  
Director of Information and Technology  
400 La Crosse Street  
La Crosse, WI 56401  
(608) 780-3933, [greschnecityoflacrosse.org](mailto:greschnecityoflacrosse.org)

IV. Designation of the City of La Crosse's authorized equipment vendor:

The following communication vendor is designated as the City's contracted vendor who it is understood is the City's only qualified vendor allowed to program Stoddard subscriber equipment onto the City's radio network. If the City contracts with another or different qualified vendor it will provide Stoddard with notification of such change.

Baycom (an authorized Motorola P25 system dealer)  
Attn: Service Manager  
3470 Losey Blvd South

La Crosse, WI 54601  
(608) 788-8980

V. Designation of Stoddard-Bergen Volunteer Fire Department Radio Administrator:

Joseph W. Pfaff  
Assistant Chief, Stoddard-Bergen Volunteer Fire Department  
188 N Main St.  
Stoddard, WI 54658  
Sbfd28@mwt.net

VI. Stoddard-Bergen Volunteer Fire Department Radio Hardware/Equipment

The City of La Crosse shall incur no costs or fees in connection with Stoddard-Bergen Volunteer Fire Department use of the radio network.

VII. Termination and Assignment of Agreement

Either party to this agreement may revoke this agreement at any time, at will, without cause by providing 90 days' notice to the other party. The Stoddard-Bergen Volunteer Fire Department shall not assign or transfer this agreement to any other party without the express written consent of the City of La Crosse.

VIII. Indemnification

To the extent authorized by Wisconsin state law, the Stoddard-Bergen Volunteer Fire Department agrees to indemnify, defend, save, and hold harmless, the City of La Crosse, its agents, officers, and employees from and against all liabilities, losses, suits, claims, judgments, fines, or demands of any kind or nature, arising from, or related to, or caused by the Stoddard-Bergen Volunteer Fire Department - La Crosse's use of the City of La Crosse Radio Network and talk groups.

IN WITNESS WHEREOF, the parties have caused this agreement to be executed on the 26 day of MARCH, 2025.

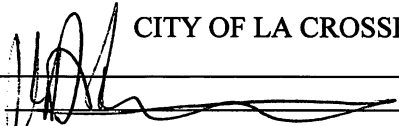
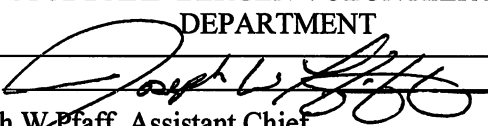
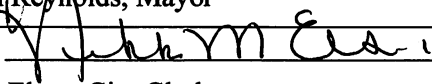
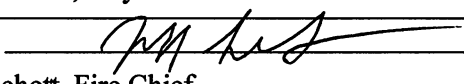
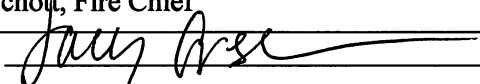
CITY OF LA CROSSE	STODDARD-BERGEN VOLUNTEER FIRE DEPARTMENT
BY  Mitch Reynolds, Mayor	BY  Joseph W. Pfaff, Assistant Chief
BY  Nikki Elsen, City Clerk	BY _____
BY  Jeff Schott, Fire Chief	BY _____
BY  Jacky Greschner, Director of IT	BY _____



# City of La Crosse, Wisconsin

City Hall  
400 La Crosse Street  
La Crosse, WI 54601

## Text File

**File Number: 25-0433**

---

**Agenda Date:** 4/14/2025

**Version:** 1

**Status:** Agenda Ready

**In Control:** Board of Public Works

**File Type:** Request





# City of La Crosse, Wisconsin

City Hall  
400 La Crosse Street  
La Crosse, WI 54601

## Text File

**File Number: 25-0434**

---

**Agenda Date:** 4/14/2025

**Version:** 1

**Status:** Agenda Ready

**In Control:** Board of Public Works

**File Type:** General Item



# REVOCABLE OCCUPANCY / STREET PRIVILEGE PERMIT APPLICATION FOR COMMUNICATIONS (FIBER OPTICS, TELEPHONE, CABLE, ETC.)

## City of La Crosse Engineering Department

Phone: 608-789-7505 Email: [engineering@cityoflacrosse.org](mailto:engineering@cityoflacrosse.org) <http://cityoflacrosse.org>

Encroachment Owner: Brightspeed of Wisconsin, LLC (work performed by CNS Networks, LLC)  
 Address: 1120 South Tryon St., Suite 700 City: Charlotte State: NC Zip: 28203  
 Phone # 980-403-3826 Email Address evan.rednour@brightspeed.com

Application Preparer (if different from above) CNS Networks, LLC  
 Relationship with Owner: Consulting Firm  
 Phone # 762-246-7989 Email Address bbruneau@congruex.com

### Description of Proposed Encroachment:

Brightspeed proposes to bore and place 1,326 ft of (1)-2" conduit; Place seven (7) 17"x30"x18" HH.

### Encroachment Addresses (List by Street and 100 blocks):

3611 29th Ct S

I certify that I have reviewed the Municipal Code and understand all that is related to this permit request. I further certify that I have the full authority to make the foregoing application; the information in the application and the required submittals are complete and correct; the Work or Use performed shall comply with all the laws of the State of Wisconsin, and all ordinances, rules, regulations, policies and special conditions of the City of La Crosse. The applicant agrees to perform the work covered by an approved permit with diligence and convenience to the public. **See Sheet 2 of 2 for Additional Conditions.**

Signature of Owner or designee: Brittany Bruneau Date: 03/24/2025  
 Print Name and Title: Brittany Bruneau - Permit Specialist

Please return this completed application along with required information and fees noted on checklist below to: City of La Crosse, Engineering Department, 400 La Crosse Street, La Crosse, WI 54601. You will then be given notice of when your request will be on the Board of Public Works agenda for consideration. **Average completion time for validation 45 days.**

### BELOW THIS LINE TO BE COMPLETED BY CITY STAFF ONLY

#### Required items to be provided by Applicant:

Scale Drawing of encroachments ☐  
 (City Utilities, Lighting and Signals must be shown on Proposed Communications Plan)

Certificate of Insurance (City as additional Insured) ☐

Initial Application Fee \$ ☐

City Utility Potential Conflict Notification and Sign-Off ☐

#### Board of Public Works Approval Date:

#### Encroachment Type:

#### Permit Number:

All Fees are Non-Refundable & Subject to change by City Council

SHEET 1 OF 2





## **REVOCABLE OCCUPANCY / STREET PRIVILEGE PERMIT APPLICATION**

### **City of La Crosse Engineering Department**

Phone: 608-789-7505 Email: [engineering@cityoflacrosse.org](mailto:engineering@cityoflacrosse.org) <http://cityoflacrosse.org>

#### **STREET PRIVILEGE PERMIT CONDITIONS FOR COMMUNICATIONS INSTALLATIONS**

1. The applicant shall be primarily liable for damages to person or property by reason of the granting of this street privilege permit.
2. The applicant shall obtain an excavation permit from the City of La Crosse Engineering Department prior to performing installation or any maintenance on the cable in the City right-of-way that requires excavation or disruption of pavement, sidewalk, curb and gutter, or other structure.
3. The applicant agrees that tracer wires shall be used and final cable location within the street right-of-way shall be approved by the City Engineer. Cable shall be installed not less than 36 inches deep, unless otherwise approved by the City Engineer.
4. Applicant agrees to provide the City of La Crosse with final "as-built" plans when installation is complete.
5. Applicant agrees that any pavement, concrete or green space disturbed during drilling activities shall be restored to its prior condition.
6. Applicant agrees that said installation shall not interfere with the City's water, sanitary sewer, or storm sewer underground infrastructure that may be in the area.
7. Applicant further agrees that they will make arrangements with the public utility companies and the City of La Crosse to clear all public underground utilities prior to initiating such work, and if necessary, applicant will make arrangements with the City of La Crosse to ensure proper traffic control.
8. Applicant waives any and all rights to contest in any way or manner the validity of Sec. 66.0425 of the Wisconsin Statutes and the amount of compensation charged.
9. Applicant agrees to become a member of Diggers Hotline for marking / locating of utility.
10. The applicant for a permit to encroach on the public right-of-way shall procure and maintain for the duration of the permit a minimum liability and contractual liability policy in the amount of \$100,000.00 each person, \$300,000.00 each accident for bodily injury and \$100,000.00 for property damage. A certificate of such insurance shall be filed with the City Attorney as part of the application. The insurance shall name the City, its officials, employees and agents as additional insureds. The Board may approve greater insurance protection on a case-by-case basis.
11. Applicant further agrees to hold harmless the City for any damage to said cable while the City, its agents or contractors are conducting construction for maintenance activities in or upon such area in which said cable lies; provided, however, the City shall make a good faith effort to notify applicant of any maintenance or work in the area of the street privilege permit which may damage applicant's cable.
12. Applicant agrees to remove the cable and return the area to its original condition upon ten (10) days' notice by the Board of Public Works. The applicant further agrees that if it does not remove the cable within ten (10) days after receiving notice, the City is authorized to remove the same and applicant agrees to pay the City for all costs of such removal.
13. Applicant further agrees that the obligations and conditions of this street privilege permit shall be binding upon all heirs, successors and assigns of applicant.
14. The person(s) signing this Permit warrant that they have the authority to sign as, or on behalf of, the party for whom they are signing.





**PLAN SHEET DISCLAIMER:**

1. EVERY REASONABLE EFFORT HAS BEEN MADE TO ASSURE THE ACCURACY OF THESE PLANS AND ASSOCIATED DATA.
2. IN AN EFFORT TO INCREASE THE CLARITY AND LEGIBILITY OF THE PLANS, EXISTING UNDERGROUND UTILITIES WILL NOT BE SHOWN UNLESS THERE IS PROPOSED WORK THAT WILL REQUIRE EXCAVATION OR ANY OTHER EARTH DISTURBING ACTIVITY. IF PROPOSED WORK WILL REQUIRE THIS TYPE OF ACTIVITY. EXISTING UNDERGROUND UTILITIES WILL BE PROPERLY INVESTIGATED AND REPRESENTED ON THE PLAN SHEET OF THE RESPECTIVE WORK LOCATION

**UTILITIES**

1. THE IDENTITY AND LOCATION OF EXISTING UNDERGROUND UTILITIES LOCATED IN AND AROUND THE CONSTRUCTION AREA HAVE BEEN SHOWN AND LABELED ON THE PLANS BY USING INFORMATION PROVIDED BY THE RESPECTIVE UTILITY OWNERS.
2. SUPPORT AND PROTECTION OF ALL UTILITIES AND APPURTENANCES SHALL BE THE RESPONSIBILITY OF THE CONTRACTOR. COSTS FOR THE REPAIR AND RESTORATION OF EXISTING UTILITIES DAMAGED BY THE CONTRACTOR SHALL BE THE RESPONSIBILITY OF THE CONTRACTOR
3. CALL 811 BEFORE YOU DIG. AT LEAST 48 HOURS PRIOR TO EXCAVATION.

**WORK LIMITS**

1. THE WORK LIMITS SHOWN ON THESE PLANS ARE FOR PHYSICAL CONSTRUCTION ONLY. THE INSTALLATION AND OPERATION OF ALL TEMPORARY TRAFFIC CONTROL AND TEMPORARY TRAFFIC CONTROL DEVICES REQUIRED BY THESE PLANS SHALL BE PROVIDED BY THE CONTRACTOR WHETHER INSIDE OR OUTSIDE OF THESE WORK LIMITS.

**MAINTAIN DRAINAGE**

1. THE CONTRACTOR AT HIS OWN EXPENSE, SHALL MAINTAIN THE FLOW IN ALL SEWERS, DRAINS, FIELD TILES, AND WATERCOURSES ENCOUNTERED IN AND AROUND THE PROJECT SITE. IF SUCH WATERCOURSES OR DRAINS ARE DISTURBED OR DESTROYED DURING THE EXECUTION OF THE PROJECT, THEY SHALL BE RESTORED BY THE CONTRACTOR AT HIS OWN EXPENSE TO A CONDITION SATISFACTORY TO THE ENGINEER.

**SECURING EXCAVATIONS & TRENCHES FOR NON-WORKING HOURS**

1. EXCAVATIONS AND TRENCHES OVER 24-INCHES DEEP SHALL BE SECURELY PLATED OR BACKFILLED DURING NON-WORKING HOURS.

**EXCAVATION OF ROADWAY AND RIGHT-OF-WAY AREAS**

1. ANY CONTRACTOR PERFORMING EXCAVATION, INCLUDING BUT NOT LIMITED TO DISTURBING THE EARTH WTH POWERED OR NON-POWERED EQUIPMENT, DRILLING AND/OR BORING, SHALL CAUSE NOTICE TO BE GIVEN BY CALLING 811 AT LEAST 48 HOURS BUT NOT MORE THAN 10 WORKING DAYS BEFORE EXCAVATING.
2. THE EXCAVATOR SHALL PROTECT AND PRESERVE THE MARKINGS UNTIL THOSE MARKINGS ARE NO LONGER NEEDED. IF AN EXCAVATION WILL COVER A LARGE AREA AND/OR PROGRESS FROM ONE AREA TO THE NEXT OVER A PERIOD OF TIME. THE EXCAVATOR SHALL COORDINATE THE MARKING OF APPROXIMATE LOCATIONS OF CITY OWNED FACILITIES WITH THE ACTUAL EXCAVATION.
3. THE CONTRACTOR IS RESPONSIBLE FOR LOCATING ALL CUSTOMER OWNED SERVICE LINES/LATERALS. THE CONTRACTOR SHALL FIELD VERIFY THE HORIZONTAL AND VERTICAL LOCATION OF ANY CITY OR CUSTOMER OWNED MAIN OR SERVICE LINE/LATERALS THAT MAY BE AFFECTED BY THE PROPOSED CONSTRUCTION ACTIVITIES. FIELD VERIFICATION SHALL TAKE PLACE PRIOR TO ANY ACTIVITY THAT MAY JEOPARDIZE THE INTEGRITY OF THE FACILITY AND AT A LOCATION NEAREST THE POINT OF POSSIBLE CONFLICT.
4. ANY DAMAGES TO CITY OR CUSTOMER OWNED FACILITIES SHOULD FIRST BE REPORTED TO THE UTILITY OWNER THEN IMMEDIATELY NOTIFY THE PROJECT ENGINEER.

**AERIAL CONSTRUCTION:**

1. CONTRACTOR TO VERIFY ALL BONDING AND GROUNDING COMPLES WITH NESC GUIDELINES.
2. CONSTRUCTION TO VERIFY ALL REQUIRED MAKE READY WORK IS COMPLETE BEFORE PLACING ON UTILITY POLES.

**SAFETY NOTE:**

1. CHECK IN WITH CONSTRUCTION SUPERVISOR WHEN ARRIVING ON-SITE.
2. HEAVY CONSTRUCTION EQUIPMENT IN USE. BEWARE OF SURROUNDINGS.
3. FOLLOW CONGRUEX SAFETY POLICIES AND GUIDELINES AT ALL TIMES WHILE WORKING.
4. CONSTRUCTION ZONE/ HARD HAT, SAFETY GLASSES, REFLECTIVE VEST/SHIRT, SAFETY TOE BOOTS REQUIRED – WORK SAFELY

<div><div><div><div></div></div><div>CHC</div><div>A CONGRUEX<sup>®</sup> COMPANY</div></div></div>		LEGENDS SHEET				<div><div><div><div></div></div><div>brightspeed</div><div>CONFIDENTIAL AND PROPRIETARY</div><div>LCRSWIXB</div></div></div>		31					
EXISTING EQUIPMENTS LEGENDS													
<div><div><div><div></div><div>R/W</div><div>R/W</div></div><div><div></div><div>C/L</div><div>CENTER LINE</div></div><div><div></div><div>EOP</div><div>EOP</div></div><div><div></div><div>BOC</div><div>BOC</div></div><div><div></div><div></div><div>PROPERTY LINE</div></div><div><div></div><div></div><div>FENCE</div></div><div><div></div><div>T</div><div>TELCO</div></div><div><div></div><div>E</div><div>ELECTRIC</div></div><div><div></div><div>G</div><div>GAS</div></div><div><div></div><div>TS</div><div>TRAFFIC SIGNAL</div></div><div><div></div><div>W</div><div>WATER</div></div><div><div></div><div>S</div><div>SEWER</div></div><div><div></div><div>SD</div><div>STORM DRAIN</div></div><div><div></div><div>U/E</div><div>UTILITY EASEMENT</div></div><div><div></div><div></div><div>RAIL TRACKS</div></div><div><div></div><div></div><div>SIDEWALK</div></div></div></div>			<div><div><div><div></div><div>CABINET</div></div><div><div></div><div>EXISTING PED</div></div><div><div></div><div>EXISTING FLOWERPOT</div></div><div><div></div><div>EXISTING HANDHOLE</div></div><div><div></div><div>TELEPHONE CABINET</div></div><div><div></div><div>TELEPHONE MANHOLE</div></div><div><div></div><div>POLE</div></div><div><div></div><div>CABLE MARKER</div></div><div><div></div><div>STREET SIGN</div></div><div><div></div><div>VERTICAL GROUND</div></div><div><div></div><div>ELECTRIC PEDESTAL/CABINET</div></div></div></div>			<div><div><div><div></div><div>ELECTRIC TRANSFORMER</div></div><div><div></div><div>ELECTRIC METER</div></div><div><div></div><div>ELECTRIC VAULT/HANDHOLE</div></div><div><div></div><div>ELECTRIC MANHOLE</div></div><div><div></div><div>EXISTING VAULT</div></div><div><div></div><div>STREETLIGHT</div></div><div><div></div><div>POWER PED</div></div><div><div></div><div>CATV PED</div></div><div><div></div><div>CATV VAULT/HANDHOLE</div></div><div><div></div><div>TREE</div></div><div><div></div><div>TRANSFORMER</div></div></div></div>			<div><div><div><div></div><div>GAS METER</div></div><div><div></div><div>GAS VALVE</div></div><div><div></div><div>SEWER MANHOLE</div></div><div><div></div><div>UNKNOWN MANHOLE</div></div><div><div></div><div>WATER METER</div></div><div><div></div><div>WATER VALVE</div></div><div><div></div><div>FIRE HYDRANT</div></div><div><div></div><div>WATER MANHOLE</div></div><div><div></div><div>STORM DRAIN CATCH BASIN</div></div><div><div></div><div>STORM DRAIN MANHOLE</div></div></div></div>			<div><div><div><div></div><div>CULVERT</div></div><div><div></div><div>C/L MONUMENT</div></div><div><div></div><div>ANCHOR &amp; DOWN GUY</div></div></div></div>	
PROPOSED EQUIPMENTS LEGENDS													
<div><div><div><div></div><div>BORE</div><div>BORE</div><div>BORE</div></div><div><div></div><div></div><div>TRENCH</div></div><div><div></div><div>A</div><div>AERIAL FIBER</div></div><div><div></div><div></div><div>AERIAL STRAND</div></div></div></div>			<div><div><div><div></div><div>12"X24"X18" HANDHOLE</div></div><div><div></div><div>17"X30"X18" HANDHOLE</div></div><div><div></div><div>24"X36"X24" HANDHOLE</div></div><div><div></div><div>36"X48"X30" HANDHOLE</div></div><div><div></div><div>ANCHOR &amp; DOWN GUY</div></div></div></div>										







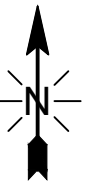
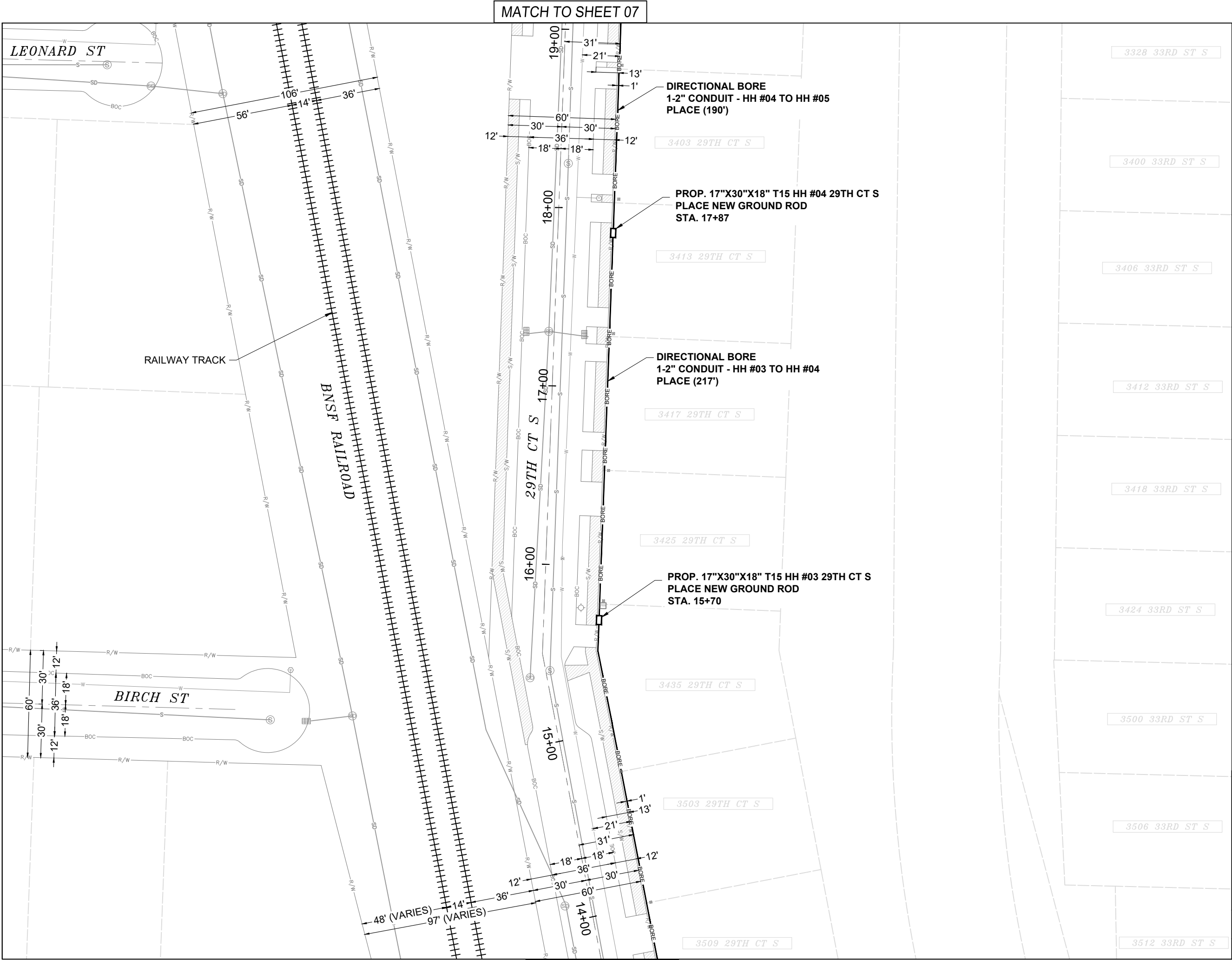

EXCAVATION DATA	
PROPOSED UTILITY	DIRT
(2) 17"X30"X18" HH	7.08 SQFT
CALL 811 BEFORE YOU DIG. WISCONSIN TOLL FREE 800-242-8511	
	
 A CONGRUEX® COMPANY	
CONFIDENTIAL AND PROPRIETARY LCRSWIXB	
06 OF 07	
SCALE: 1" = 50'	



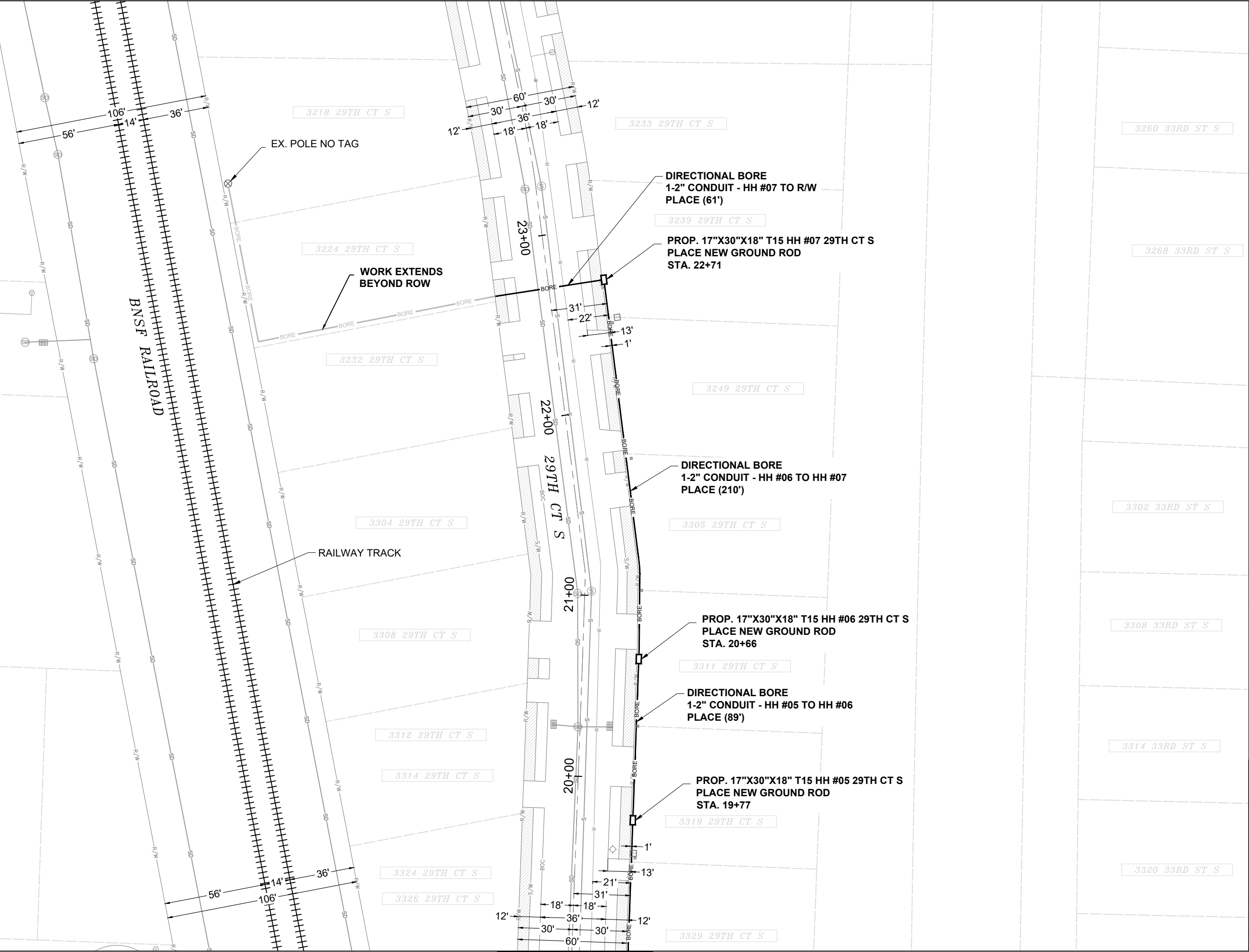

EXCAVATION DATA	
PROPOSED UTILITY	DIRT
(3) 17"X30"X18" HH	10.62 SQFT
CALL 811 BEFORE YOU DIG. WISCONSIN TOLL FREE 800-242-8511	
	
 A CONGRUEX® COMPANY	
CONFIDENTIAL AND PROPRIETARY LCRSWIXB	
07 OF 07	
SCALE: 1" = 50'	

MATCH TO SHEET 06



# City of La Crosse, Wisconsin

City Hall  
400 La Crosse Street  
La Crosse, WI 54601

## Text File

**File Number: 25-0435**

---

**Agenda Date:** 4/14/2025

**Version:** 1

**Status:** Agenda Ready

**In Control:** Board of Public Works

**File Type:** General Item

# BRIGHTSPEED LA CROSSE

2525 32ND ST. S  
32ND ST. S & GLENDALE AVE.  
CITY OF LA CROSSE, WI

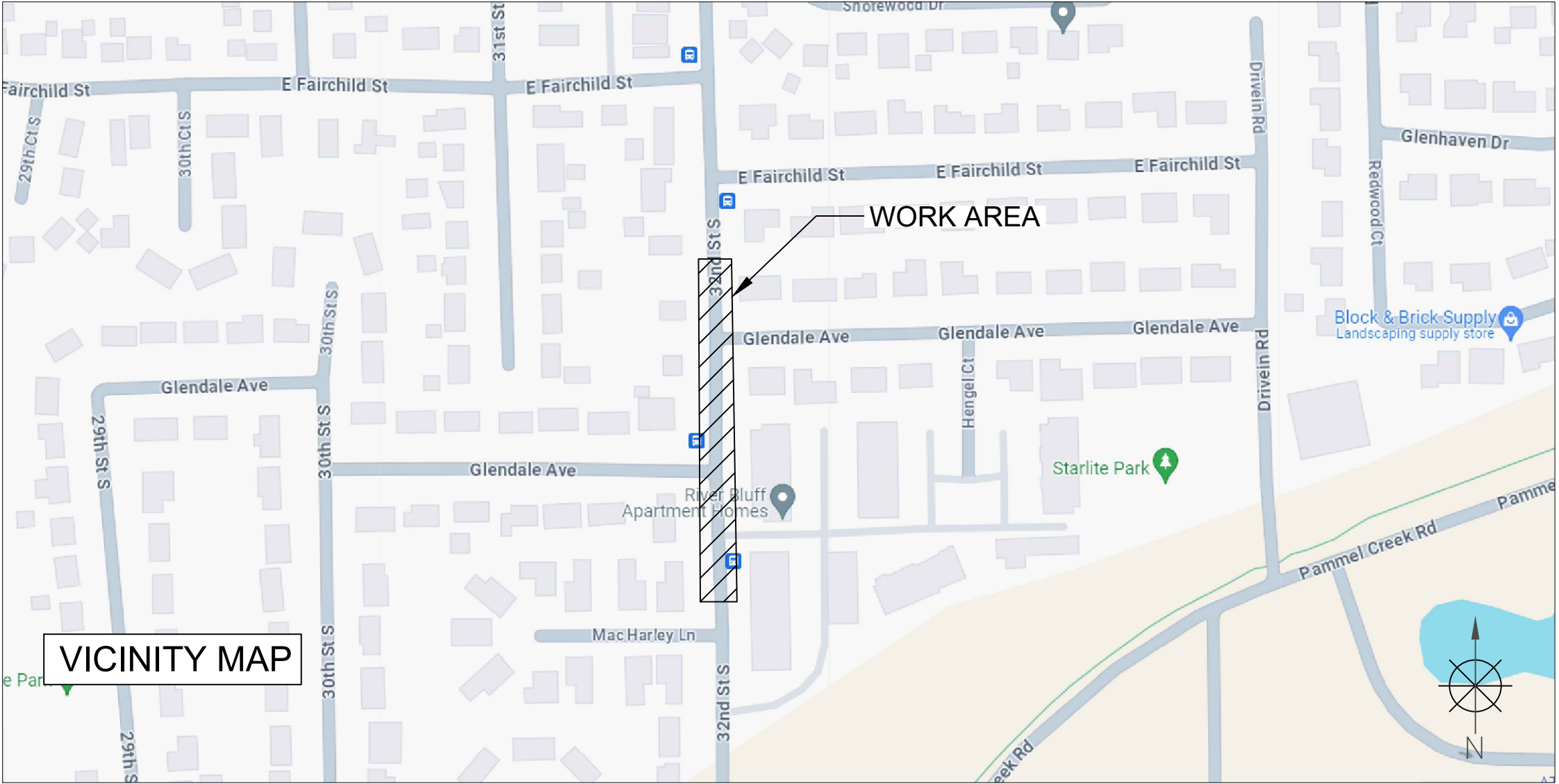

VICINITY MAP

## TRAFFIC CONTROL PLAN

SCOPE OF WORK	SHEET INDEX	
- BORING & HH PLACEMENT	SHEET	DESCRIPTION
	KEYMAP	VICINITY MAP & SCOPE OF WORK
	TC-1 TO TC-1	TRAFFIC CONTROL PLAN

## PERMITTING AGENCY CITY OF LA CROSSE

**PROPOSED PATH FOOTAGE**  
UG PATH = 538'



A CONGRUEX<sup>®</sup> COMPANY  
9095 Rio San Diego Dr. Ste 165  
San Diego, CA 92108-1694  
(949) 250-0004 / FAX (949) 250-0006

REVISIONS			
REV.	DESCRIPTION	BY	DATE
0	INITIAL DESIGN	A.T.	5/28/24

## BRIGHTSPEED

LCRSWIXB

**KEYMAP**  
N.T.S.

2525 32ND ST. S  
32ND ST. S AND GLENDALE AVE.  
-BORING & HH PLACEMENT  
WORK AREA 1 OF 1

PEDESTRIAN CONTROL NOTES:

A DEDICATED INDIVIDUAL WILL BE ASSIGNED THE RESPONSIBILITY OF ESCORTING PEDESTRIANS THROUGH THE WORK AREA IN ACCORDANCE WITH THREE MAJOR CONSIDERATIONS:

1. PEDESTRIANS SHOULD NOT BE LED INTO DIRECT CONFLICT WITH WORK SITE VEHICLES, EQUIPMENT OR OPERATIONS
2. PEDESTRIANS SHOULD NOT BE LED INTO DIRECT CONFLICT WITH MAINLINE TRAFFIC MOVING THROUGH OR AROUND THE WORK SITE.
3. PEDESTRIANS SHOULD BE PROVIDED WITH A REASONABLY SAFE, CONVENIENT AND ACCESSIBLE PATH THAT REPLICATES AS NEARLY AS PRACTICAL THE MOST DESIRABLE CHARACTERISTICS OF THE EXISTING SIDEWALK OR FOOTPATH

FLAGGER TO ASSIST PEDESTRIANS  
THROUGH WORK AREA  
(SEE PED NOTES)

CONTACT PROPERTY OWNER(S) 72 HOURS PRIOR TO START OF WORK.





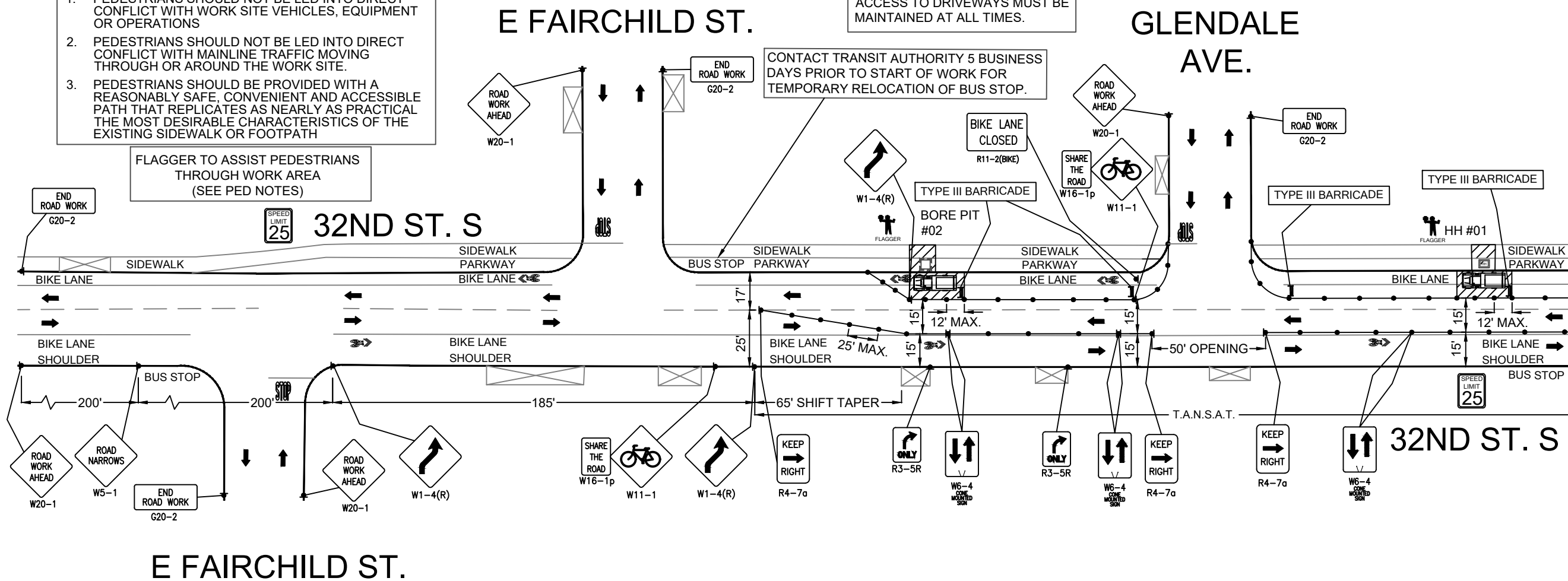









ACCESS TO DRIVEWAYS MUST BE  
MAINTAINED AT ALL TIMES.

CONTACT TRANSIT AUTHORITY 5 BUSINESS DAYS PRIOR TO START OF WORK FOR TEMPORARY RELOCATION OF BUS STOP.



MATCHLINE-A  
SEE TC-2 OF TC-2

### LEGEND

- |   |  |
|---|--|
|  | PORTABLE FLASHING BEACON<br>(P.F.B.)           |
|  | TYPE III BARRICADE W/SIGN                      |
|  | TYPE II BARRICADE W/SIGN                       |
|  | CHANNELIZING DEVICE                            |
|  | TRAFFIC CONE WITH<br>CLIP ON SIGN              |
|  | TYPE I W/ SIGN                                 |
|  | EXISTING SIGN                                  |
|  | SIGNALIZED INTERSECTION                        |
|  | FLASHING ARROW BOARD                           |
|  | HIGH LEVEL WARNING DEVICE<br>(FLAGTREE)        |
|  | FLAGGER  |
| TANSAT  | TOW AWAY NO STOPPING<br>ANY TIME               |
|  | EXISTING DRIVEWAY                              |
|  | WORK ZONE<br>(ACTIVITY AREA) LIMITS            |
|  | DIRECTION OF TRAFFIC<br>(NOT PAVEMENT MARKING) |

CALL 811 BEFORE YOU DIG.  
WISCONSIN TOLL FREE  
800-242-8511

# BRIGHTSPEED

PLANS PREPARED BY:

**CHC**  
A CONGRUEX® COMPANY  
9095 Rio San Diego Dr. Ste 165  
San Diego, CA 92108-1694  
(949) 250-0004 / FAX (949) 250-0006

REVISIONS			
REV.	DESCRIPTION	BY	DATE
0	INITIAL DESIGN	A.T.	5/28/24

**BRIGHTSPEED**  
CONFIDENTIAL AND PROPRIETARY

LCRSWIXB

**TC-1 OF TC-2**

SCALE: 1:50

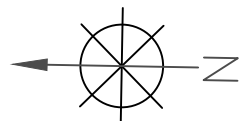

2525 32ND ST. S  
32ND ST. S AND GLENDALE AVE.  
-BORING & HH PLACEMENT  
WORK AREA 1 OF 1

MATCHLINE-A  
SEE TC-1 OF TC-2

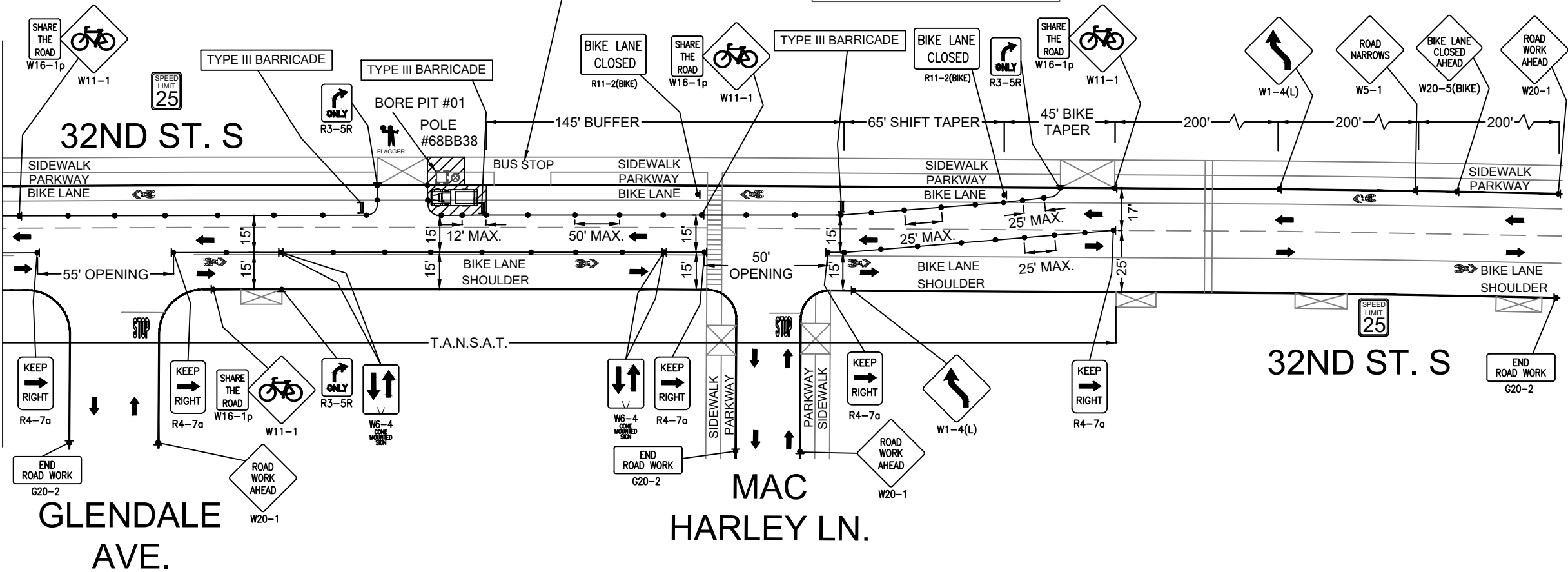

FLAGGER TO ASSIST PEDESTRIANS  
THROUGH WORK AREA  
(SEE PED NOTES)

CONTACT PROPERTY OWNER(S) 72  
HOURS PRIOR TO START OF WORK.

ACCESS TO DRIVEWAYS MUST BE  
MAINTAINED AT ALL TIMES.

CONTACT TRANSIT AUTHORITY 5 BUSINESS  
DAYS PRIOR TO START OF WORK FOR  
TEMPORARY RELOCATION OF BUS STOP.

PEDESTRIAN CONTROL NOTES:

- A DEDICATED INDIVIDUAL WILL BE ASSIGNED THE RESPONSIBILITY OF ESCORTING PEDESTRIANS THROUGH THE WORK AREA IN ACCORDANCE WITH THREE MAJOR CONSIDERATIONS:
1. PEDESTRIANS SHOULD NOT BE LED INTO DIRECT CONFLICT WITH WORK SITE VEHICLES, EQUIPMENT OR OPERATIONS
  2. PEDESTRIANS SHOULD NOT BE LED INTO DIRECT CONFLICT WITH MAINLINE TRAFFIC MOVING THROUGH OR AROUND THE WORK SITE.
  3. PEDESTRIANS SHOULD BE PROVIDED WITH A REASONABLY SAFE, CONVENIENT AND ACCESSIBLE PATH THAT REPLICATES AS NEARLY AS PRACTICAL THE MOST DESIRABLE CHARACTERISTICS OF THE EXISTING SIDEWALK OR FOOTPATH

LEGEND	
✱	PORTABLE FLASHING BEACON (P.F.B.)
≡	TYPE III BARRICADE W/SIGN
✕	TYPE II BARRICADE W/SIGN
•	CHANNELIZING DEVICE
⚓	TRAFFIC CONE WITH CLIP ON SIGN
⚓	TYPE I W/ SIGN
⚓	EXISTING SIGN
Ⓢ	SIGNALIZED INTERSECTION
⚓	FLASHING ARROW BOARD
⚓	HIGH LEVEL WARNING DEVICE (FLAGTREE)
⚓	FLAGGER
TANSAT	TOW AWAY NO STOPPING ANY TIME
ⓧ	EXISTING DRIVEWAY
▨	WORK ZONE (ACTIVITY AREA) LIMITS
➡	DIRECTION OF TRAFFIC (NOT PAVEMENT MARKING)

CALL 811 BEFORE YOU DIG.  
WISCONSIN TOLL FREE  
800-242-8511

BRIGHTSPEED

PLANS PREPARED BY:  
**CHC**  
A CONGRUEX COMPANY  
9095 Rio San Diego Dr. Ste 165  
San Diego, CA 92108-1694  
(949) 250-0004 / FAX (949) 250-0006

REVISIONS			
REV.	DESCRIPTION	BY	DATE
0	INITIAL DESIGN	A.T.	5/28/24

BRIGHTSPEED  
CONFIDENTIAL AND PROPRIETARY  
LCRSWIXB

TC-2 OF TC-2

SCALE: 1:50

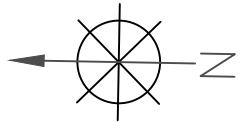



# REVOCABLE OCCUPANCY / STREET PRIVILEGE PERMIT APPLICATION FOR COMMUNICATIONS (FIBER OPTICS, TELEPHONE, CABLE, ETC.)

## City of La Crosse Engineering Department

Phone: 608-789-7505 Email: [engineering@cityoflacrosse.org](mailto:engineering@cityoflacrosse.org) <http://cityoflacrosse.org>

Encroachment Owner: Brightspeed of Wisconsin, LLC (work performed by CNS Networks, LLC)

Address: 1120 South Tryon St #700 City: Charlotte State: NC Zip: 28203

Phone # 980-376-1808 Email Address bryan.williams@brightspeed.com

Application Preparer (if different from above) CNS Networks, LLC

Relationship with Owner: Consulting Firm

Phone # 762-246-7989 Email Address bbruneau@congruex.com

### Description of Proposed Encroachment:

Brighspeed proposes to bore and place 538 FT of (1)-2"conduit; one (1) 17"x30"x18" HH.

### Encroachment Addresses (List by Street and 100 blocks):

2525 32nd St S

I certify that I have reviewed the Municipal Code and understand all that is related to this permit request. I further certify that I have the full authority to make the foregoing application; the information in the application and the required submittals are complete and correct; the Work or Use performed shall comply with all the laws of the State of Wisconsin, and all ordinances, rules, regulations, policies and special conditions of the City of La Crosse. The applicant agrees to perform the work covered by an approved permit with diligence and convenience to the public. **See Sheet 2 of 2 for Additional Conditions.**

Signature of Owner or designee: Brittany Bruneau Date: 03/24/2025

Print Name and Title: Brittany Bruneau - Permit Specialist.

Please return this completed application along with required information and fees noted on checklist below to: City of La Crosse, Engineering Department, 400 La Crosse Street, La Crosse, WI 54601. You will then be given notice of when your request will be on the Board of Public Works agenda for consideration. **Average completion time for validation 45 days.**

### BELOW THIS LINE TO BE COMPLETED BY CITY STAFF ONLY

#### Required items to be provided by Applicant:

Scale Drawing of encroachments ☐

(City Utilities, Lighting and Signals must be shown on Proposed Communications Plan)

Certificate of Insurance (City as additional Insured) ☐

Initial Application Fee \$ ☐

City Utility Potential Conflict Notification and Sign-Off ☐

#### Board of Public Works Approval Date:

#### Encroachment Type:

#### Permit Number:

All Fees are Non-Refundable & Subject to change by City Council

**SHEET 1 OF 2**





## **REVOCABLE OCCUPANCY / STREET PRIVILEGE PERMIT APPLICATION**

### **City of La Crosse Engineering Department**

Phone: 608-789-7505 Email: [engineering@cityoflacrosse.org](mailto:engineering@cityoflacrosse.org) <http://cityoflacrosse.org>

#### **STREET PRIVILEGE PERMIT CONDITIONS FOR COMMUNICATIONS INSTALLATIONS**

1. The applicant shall be primarily liable for damages to person or property by reason of the granting of this street privilege permit.
2. The applicant shall obtain an excavation permit from the City of La Crosse Engineering Department prior to performing installation or any maintenance on the cable in the City right-of-way that requires excavation or disruption of pavement, sidewalk, curb and gutter, or other structure.
3. The applicant agrees that tracer wires shall be used and final cable location within the street right-of-way shall be approved by the City Engineer. Cable shall be installed not less than 36 inches deep, unless otherwise approved by the City Engineer.
4. Applicant agrees to provide the City of La Crosse with final "as-built" plans when installation is complete.
5. Applicant agrees that any pavement, concrete or green space disturbed during drilling activities shall be restored to its prior condition.
6. Applicant agrees that said installation shall not interfere with the City's water, sanitary sewer, or storm sewer underground infrastructure that may be in the area.
7. Applicant further agrees that they will make arrangements with the public utility companies and the City of La Crosse to clear all public underground utilities prior to initiating such work, and if necessary, applicant will make arrangements with the City of La Crosse to ensure proper traffic control.
8. Applicant waives any and all rights to contest in any way or manner the validity of Sec. 66.0425 of the Wisconsin Statutes and the amount of compensation charged.
9. Applicant agrees to become a member of Diggers Hotline for marking / locating of utility.
10. The applicant for a permit to encroach on the public right-of-way shall procure and maintain for the duration of the permit a minimum liability and contractual liability policy in the amount of \$100,000.00 each person, \$300,000.00 each accident for bodily injury and \$100,000.00 for property damage. A certificate of such insurance shall be filed with the City Attorney as part of the application. The insurance shall name the City, its officials, employees and agents as additional insureds. The Board may approve greater insurance protection on a case-by-case basis.
11. Applicant further agrees to hold harmless the City for any damage to said cable while the City, its agents or contractors are conducting construction for maintenance activities in or upon such area in which said cable lies; provided, however, the City shall make a good faith effort to notify applicant of any maintenance or work in the area of the street privilege permit which may damage applicant's cable.
12. Applicant agrees to remove the cable and return the area to its original condition upon ten (10) days' notice by the Board of Public Works. The applicant further agrees that if it does not remove the cable within ten (10) days after receiving notice, the City is authorized to remove the same and applicant agrees to pay the City for all costs of such removal.
13. Applicant further agrees that the obligations and conditions of this street privilege permit shall be binding upon all heirs, successors and assigns of applicant.
14. The person(s) signing this Permit warrant that they have the authority to sign as, or on behalf of, the party for whom they are signing.



**PLAN SHEET DISCLAIMER:**

1. EVERY REASONABLE EFFORT HAS BEEN MADE TO ASSURE THE ACCURACY OF THESE PLANS AND ASSOCIATED DATA.
2. IN AN EFFORT TO INCREASE THE CLARITY AND LEGIBILITY OF THE PLANS, EXISTING UNDERGROUND UTILITIES WILL NOT BE SHOWN UNLESS THERE IS PROPOSED WORK THAT WILL REQUIRE EXCAVATION OR ANY OTHER EARTH DISTURBING ACTIVITY. IF PROPOSED WORK WILL REQUIRE THIS TYPE OF ACTIVITY. EXISTING UNDERGROUND UTILITIES WILL BE PROPERLY INVESTIGATED AND REPRESENTED ON THE PLAN SHEET OF THE RESPECTIVE WORK LOCATION

**UTILITIES**

1. THE IDENTITY AND LOCATION OF EXISTING UNDERGROUND UTILITIES LOCATED IN AND AROUND THE CONSTRUCTION AREA HAVE BEEN SHOWN AND LABELED ON THE PLANS BY USING INFORMATION PROVIDED BY THE RESPECTIVE UTILITY OWNERS.
2. SUPPORT AND PROTECTION OF ALL UTILITIES AND APPURTENANCES SHALL BE THE RESPONSIBILITY OF THE CONTRACTOR. COSTS FOR THE REPAIR AND RESTORATION OF EXISTING UTILITIES DAMAGED BY THE CONTRACTOR SHALL BE THE RESPONSIBILITY OF THE CONTRACTOR
3. CALL 811 BEFORE YOU DIG. AT LEAST 48 HOURS PRIOR TO EXCAVATION.

**WORK LIMITS**

1. THE WORK LIMITS SHOWN ON THESE PLANS ARE FOR PHYSICAL CONSTRUCTION ONLY. THE INSTALLATION AND OPERATION OF ALL TEMPORARY TRAFFIC CONTROL AND TEMPORARY TRAFFIC CONTROL DEVICES REQUIRED BY THESE PLANS SHALL BE PROVIDED BY THE CONTRACTOR WHETHER INSIDE OR OUTSIDE OF THESE WORK LIMITS.

**MAINTAIN DRAINAGE**

1. THE CONTRACTOR AT HIS OWN EXPENSE, SHALL MAINTAIN THE FLOW IN ALL SEWERS, DRAINS, FIELD TILES, AND WATERCOURSES ENCOUNTERED IN AND AROUND THE PROJECT SITE. IF SUCH WATERCOURSES OR DRAINS ARE DISTURBED OR DESTROYED DURING THE EXECUTION OF THE PROJECT, THEY SHALL BE RESTORED BY THE CONTRACTOR AT HIS OWN EXPENSE TO A CONDITION SATISFACTORY TO THE ENGINEER.

**SECURING EXCAVATIONS & TRENCHES FOR NON-WORKING HOURS**

1. EXCAVATIONS AND TRENCHES OVER 24-INCHES DEEP SHALL BE SECURELY PLATED OR BACKFILLED DURING NON-WORKING HOURS.

**EXCAVATION OF ROADWAY AND RIGHT-OF-WAY AREAS**

1. ANY CONTRACTOR PERFORMING EXCAVATION, INCLUDING BUT NOT LIMITED TO DISTURBING THE EARTH WTH POWERED OR NON-POWERED EQUIPMENT, DRILLING AND/OR BORING, SHALL CAUSE NOTICE TO BE GIVEN BY CALLING 811 AT LEAST 48 HOURS BUT NOT MORE THAN 10 WORKING DAYS BEFORE EXCAVATING.
2. THE EXCAVATOR SHALL PROTECT AND PRESERVE THE MARKINGS UNTIL THOSE MARKINGS ARE NO LONGER NEEDED. IF AN EXCAVATION WILL COVER A LARGE AREA AND/OR PROGRESS FROM ONE AREA TO THE NEXT OVER A PERIOD OF TIME. THE EXCAVATOR SHALL COORDINATE THE MARKING OF APPROXIMATE LOCATIONS OF CITY OWNED FACILITIES WITH THE ACTUAL EXCAVATION.
3. THE CONTRACTOR IS RESPONSIBLE FOR LOCATING ALL CUSTOMER OWNED SERVICE LINES/LATERALS. THE CONTRACTOR SHALL FIELD VERIFY THE HORIZONTAL AND VERTICAL LOCATION OF ANY CITY OR CUSTOMER OWNED MAIN OR SERVICE LINE/LATERALS THAT MAY BE AFFECTED BY THE PROPOSED CONSTRUCTION ACTIVITIES. FIELD VERIFICATION SHALL TAKE PLACE PRIOR TO ANY ACTIVITY THAT MAY JEOPARDIZE THE INTEGRITY OF THE FACILITY AND AT A LOCATION NEAREST THE POINT OF POSSIBLE CONFLICT.
4. ANY DAMAGES TO CITY OR CUSTOMER OWNED FACILITIES SHOULD FIRST BE REPORTED TO THE UTILITY OWNER THEN IMMEDIATELY NOTIFY THE PROJECT ENGINEER.

**AERIAL CONSTRUCTION:**

1. CONTRACTOR TO VERIFY ALL BONDING AND GROUNDING COMPLES WITH NESC GUIDELINES.
2. CONSTRUCTION TO VERIFY ALL REQUIRED MAKE READY WORK IS COMPLETE BEFORE PLACING ON UTILITY POLES.

**SAFETY NOTE:**

1. CHECK IN WITH CONSTRUCTION SUPERVISOR WHEN ARRIVING ON-SITE.
2. HEAVY CONSTRUCTION EQUIPMENT IN USE. BEWARE OF SURROUNDINGS.
3. FOLLOW CONGRUEX SAFETY POLICIES AND GUIDELINES AT ALL TIMES WHILE WORKING.
4. CONSTRUCTION ZONE/ HARD HAT, SAFETY GLASSES, REFLECTIVE VEST/SHIRT, SAFETY TOE BOOTS REQUIRED – WORK SAFELY

CHC

A CONGRUEX<sup>®</sup> COMPANY

brightspeed

CONFIDENTIAL AND PROPRIETARY

LCRSWIXB

LEGENDS SHEET

EXISTING EQUIPMENTS LEGENDS

R\W

R/W

C\L

CENTER LINE

EOP

EOP

BOC

BOC

PROPERTY LINE

FENCE

T

TELCO

E

ELECTRIC

G

GAS

TS

TRAFFIC SIGNAL

W

WATER

S

SEWER

SD

STORM DRAIN

U/E

UTILITY EASEMENT

RAIL TRACKS

SIDEWALK

CABINET

EXISTING PED

FP

EXISTING FLOWERPOT

HH

EXISTING HANDHOLE

TELEPHONE CABINET

TELEPHONE MANHOLE

POLE

CABLE MARKER

STREET SIGN

VERTICAL GROUND

E

ELECTRIC PEDESTAL/CABINET

PWR

ELECTRIC TRANSFORMER

E

ELECTRIC METER

E

ELECTRIC VAULT/HANDHOLE

ELECTRIC MANHOLE

EXISTING VAULT

STREETLIGHT

P

POWER PED

TV

CATV PED

TV

CATV VAULT/HANDHOLE

TREE

TRANSFORMER

G

GAS METER

GV

GAS VALVE

S

SEWER MANHOLE

MH

UNKNOWN MANHOLE

W

WATER METER

WV

WATER VALVE

H

FIRE HYDRANT

WHH

WATER MANHOLE

STORM DRAIN CATCH BASIN

SD

STORM DRAIN MANHOLE

CULVERT

C/L MONUMENT

ANCHOR & DOWN GUY

MINIMUM STANDARDS FOR DIRECTIONAL BORING  
STREET CROSSINGS

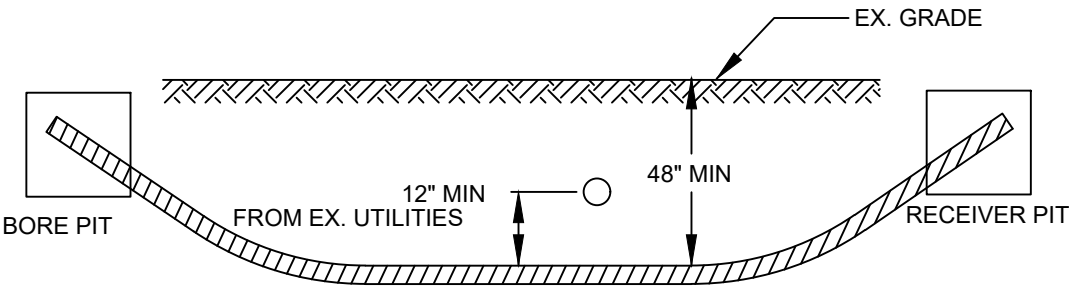

- PLACE END MARKER WITH UTILITY OWNER'S NAME DESCRIBING CONDUIT
- BORE PIT TO BE BACKFILLED AND COMPACTED IN 12" LIFTS WITH MATERIAL REMOVED
- FLOW OF DITCH MUST BE MAINTAINED AT ALL TIMES
- PROTECT ROOTS AT ALL TREE LOCATIONS, SHIFT BORE TRENCH IF NECESSARY

TYPICAL BORE DETAILS 1

MINIMUM STANDARDS FOR DIRECTIONAL BORING  
UNDER SIDEWALKS & WITHIN ROW (EXCLUDING STREET CROSSINGS)

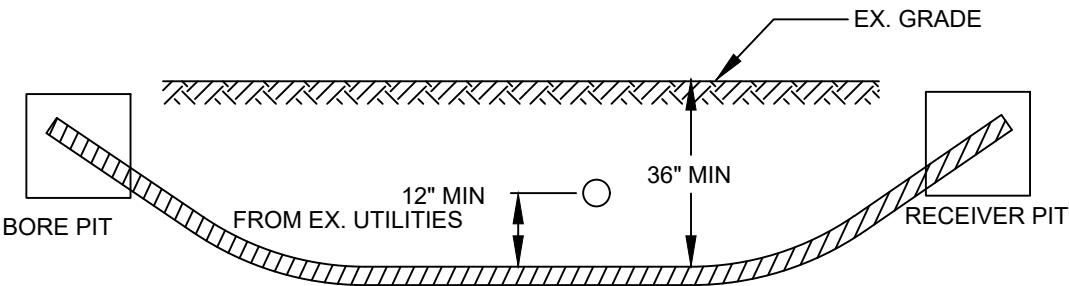

- PLACE END MARKER WITH UTILITY OWNER'S NAME DESCRIBING CONDUIT
- BORE PIT TO BE BACKFILLED AND COMPACTED IN 12" LIFTS WITH MATERIAL REMOVED
- FLOW OF DITCH MUST BE MAINTAINED AT ALL TIMES
- PROTECT ROOTS AT ALL TREE LOCATIONS, SHIFT BORE TRENCH IF NECESSARY

TYPICAL BORE DETAILS 2

PLAN VIEW

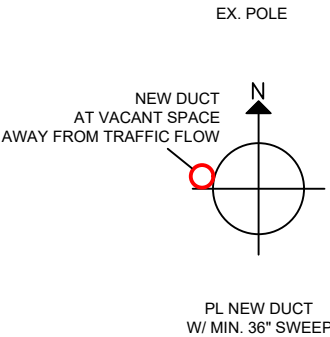

ELEVATION

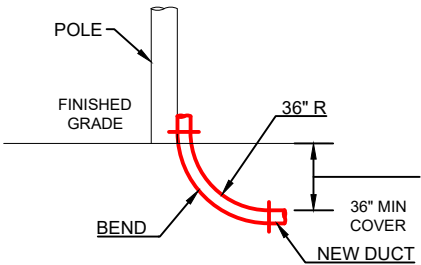

RISER DETAILS

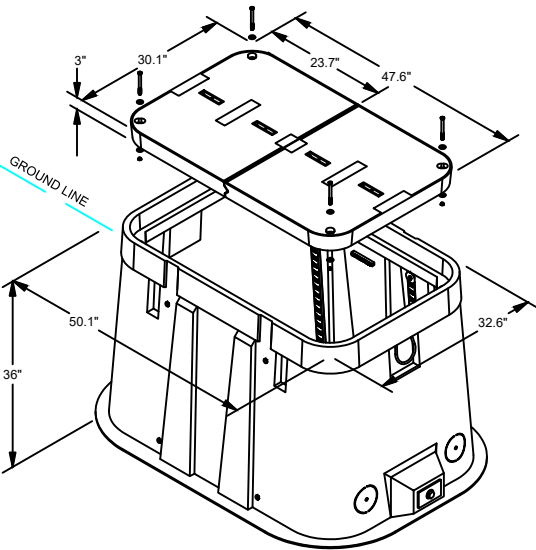
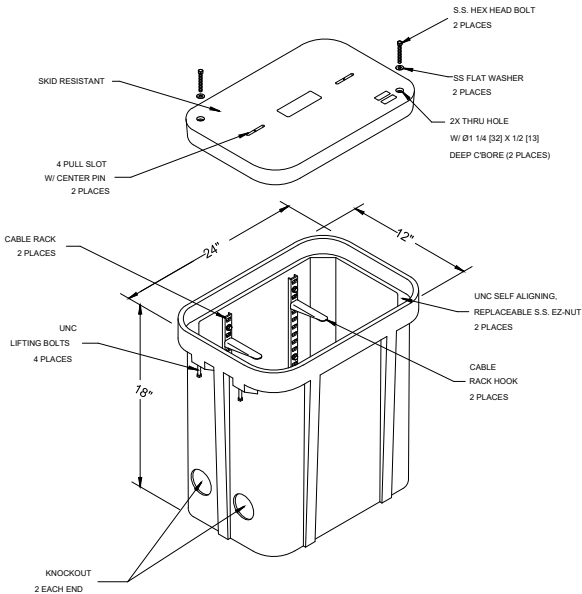
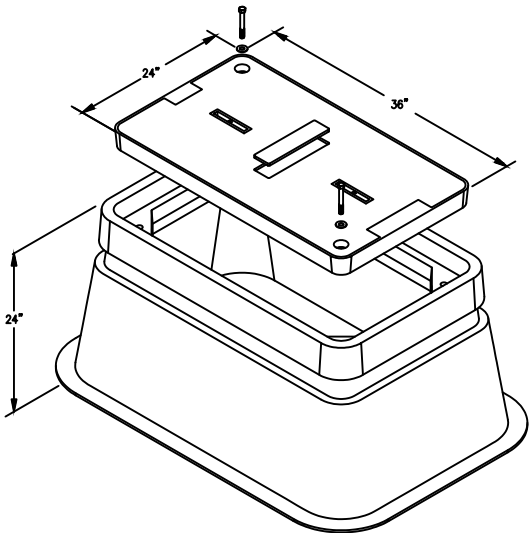
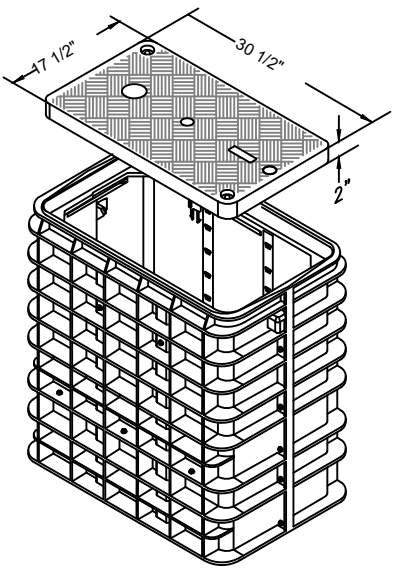



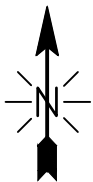
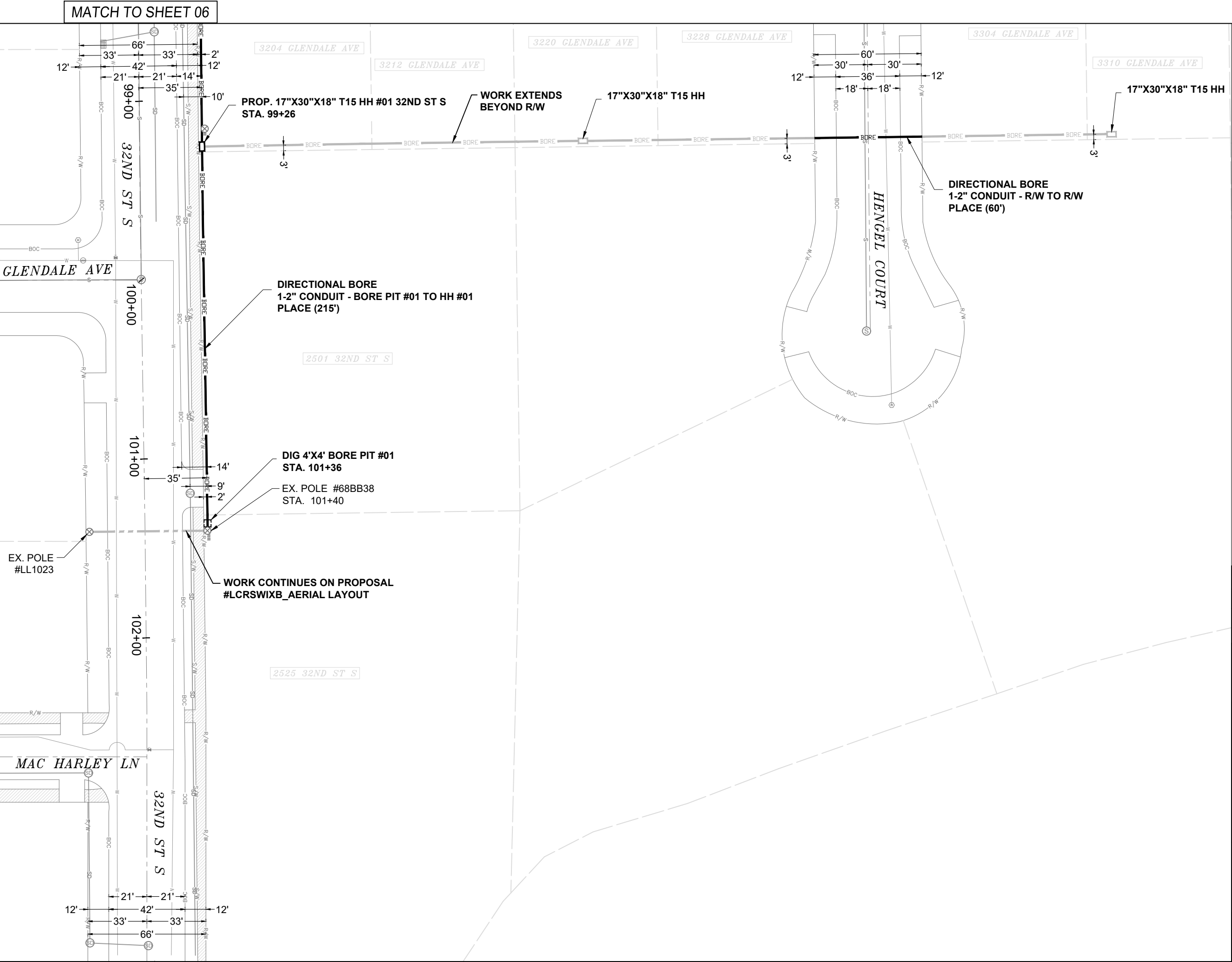

EXCAVATION DATA

PROPOSED UTILITY	DIRT
(1) 17"X30"X18" HH	3.54 SQFT
(1) 4'X4' BORE PIT	16 SQFT

CALL 811 BEFORE YOU DIG.  
WISCONSIN TOLL FREE  
800-242-8511





A **CONGRUEX** COMPANY

CONFIDENTIAL AND PROPRIETARY  
LCRSWIXB

05 OF 06

SCALE: 1" = 50'



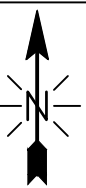
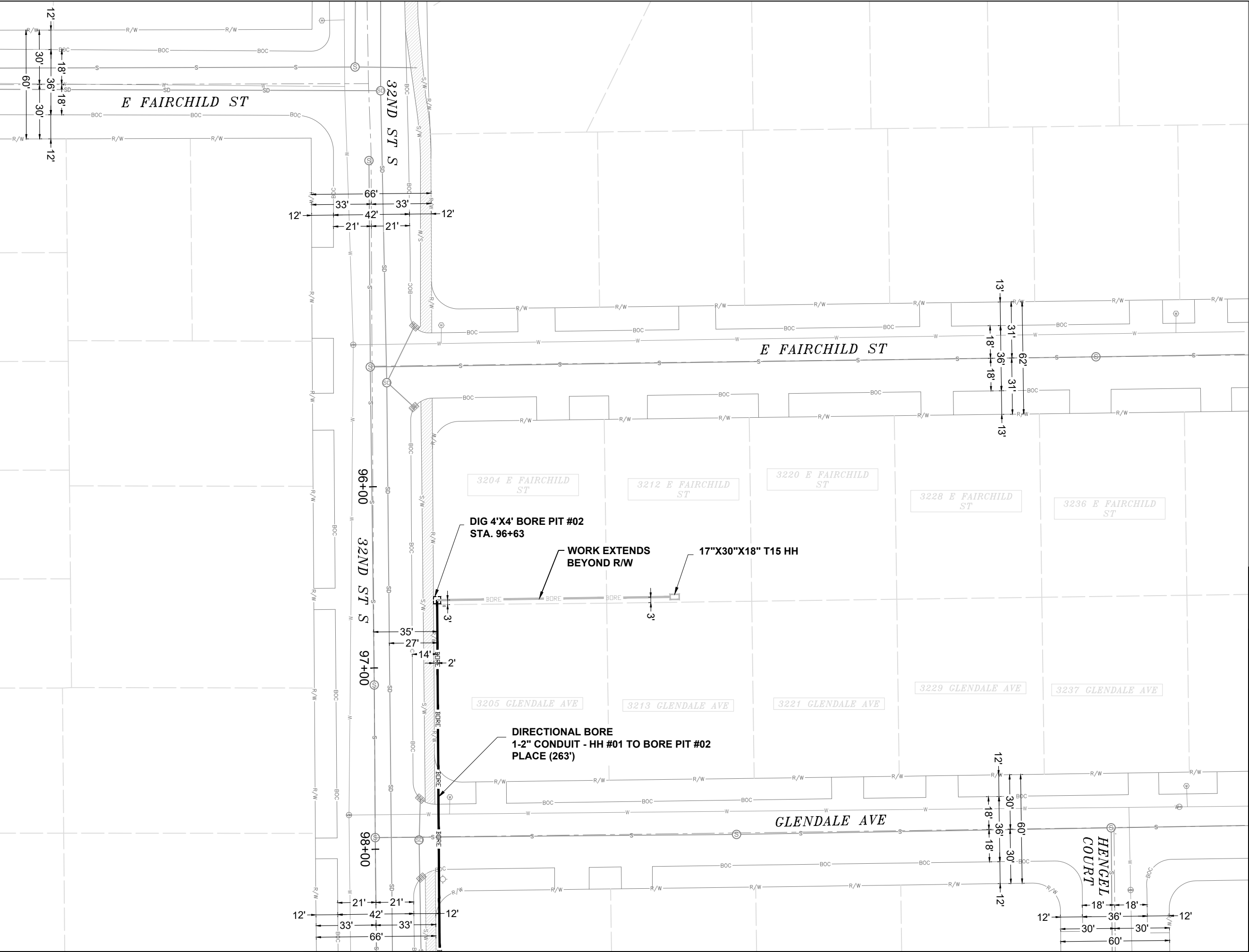

EXCAVATION DATA	
PROPOSED UTILITY	DIRT
(1) 4'X4' BORE PIT	16 SQFT
CALL 811 BEFORE YOU DIG. WISCONSIN TOLL FREE 800-242-8511	
	
 A CONGRUEX® COMPANY	
CONFIDENTIAL AND PROPRIETARY LCRSWIXB	
06 OF 06	
SCALE: 1" = 50'	

MATCH TO SHEET 05



# City of La Crosse, Wisconsin

City Hall  
400 La Crosse Street  
La Crosse, WI 54601

## Text File

File Number: 25-0436

---

**Agenda Date:** 4/14/2025

**Version:** 1

**Status:** Agenda Ready

**In Control:** Board of Public Works

**File Type:** General Item



# REVOCABLE OCCUPANCY / STREET PRIVILEGE PERMIT APPLICATION FOR COMMUNICATIONS (FIBER OPTICS, TELEPHONE, CABLE, ETC.)

## City of La Crosse Engineering Department

Phone: 608-789-7505 Email: [engineering@cityoflacrosse.org](mailto:engineering@cityoflacrosse.org) <http://cityoflacrosse.org>

Encroachment Owner: Brightspeed of Wisconsin, LLC (Work done by CNS Networks)  
Address: 1120 South Tryon St #700 City: Charlotte State: NC Zip: 28203  
Phone # 980-376-1808 Email Address holly.tindall@brightspeed.com

Application Preparer (if different from above) CNS Networks, LLC  
Relationship with Owner: Consulting Firm  
Phone # 762-246-7989 Email Address bbruneau@congruex.com

### Description of Proposed Encroachment:

Brighspeed proposes to bore and place 284 ft of (1)-2" conduit along Springbrook Way.

### Encroachment Addresses (List by Street and 100 blocks):

3805 Elm Dr

I certify that I have reviewed the Municipal Code and understand all that is related to this permit request. I further certify that I have the full authority to make the foregoing application; the information in the application and the required submittals are complete and correct; the Work or Use performed shall comply with all the laws of the State of Wisconsin, and all ordinances, rules, regulations, policies and special conditions of the City of La Crosse. The applicant agrees to perform the work covered by an approved permit with diligence and convenience to the public. **See Sheet 2 of 2 for Additional Conditions.**

Signature of Owner or designee: Brittany Bruneau Date: 03/24/2025  
Print Name and Title: Brittany Bruneau - Permit Specialist.

Please return this completed application along with required information and fees noted on checklist below to: City of La Crosse, Engineering Department, 400 La Crosse Street, La Crosse, WI 54601. You will then be given notice of when your request will be on the Board of Public Works agenda for consideration. **Average completion time for validation 45 days.**

### BELOW THIS LINE TO BE COMPLETED BY CITY STAFF ONLY

#### Required items to be provided by Applicant:

Scale Drawing of encroachments (City Utilities, Lighting and Signals must be shown on Proposed Communications Plan)	<input type="checkbox"/>
Certificate of Insurance (City as additional Insured)	<input type="checkbox"/>
Initial Application Fee \$ _____	<input type="checkbox"/>
City Utility Potential Conflict Notification and Sign-Off	<input type="checkbox"/>

#### Board of Public Works Approval Date:

#### Encroachment Type:

#### Permit Number:

All Fees are Non-Refundable & Subject to change by City Council

**SHEET 1 OF 2**



## **REVOCABLE OCCUPANCY / STREET PRIVILEGE PERMIT APPLICATION**

### **City of La Crosse Engineering Department**

Phone: 608-789-7505 Email: [engineering@cityoflacrosse.org](mailto:engineering@cityoflacrosse.org) <http://cityoflacrosse.org>

#### **STREET PRIVILEGE PERMIT CONDITIONS FOR COMMUNICATIONS INSTALLATIONS**

1. The applicant shall be primarily liable for damages to person or property by reason of the granting of this street privilege permit.
2. The applicant shall obtain an excavation permit from the City of La Crosse Engineering Department prior to performing installation or any maintenance on the cable in the City right-of-way that requires excavation or disruption of pavement, sidewalk, curb and gutter, or other structure.
3. The applicant agrees that tracer wires shall be used and final cable location within the street right-of-way shall be approved by the City Engineer. Cable shall be installed not less than 36 inches deep, unless otherwise approved by the City Engineer.
4. Applicant agrees to provide the City of La Crosse with final "as-built" plans when installation is complete.
5. Applicant agrees that any pavement, concrete or green space disturbed during drilling activities shall be restored to its prior condition.
6. Applicant agrees that said installation shall not interfere with the City's water, sanitary sewer, or storm sewer underground infrastructure that may be in the area.
7. Applicant further agrees that they will make arrangements with the public utility companies and the City of La Crosse to clear all public underground utilities prior to initiating such work, and if necessary, applicant will make arrangements with the City of La Crosse to ensure proper traffic control.
8. Applicant waives any and all rights to contest in any way or manner the validity of Sec. 66.0425 of the Wisconsin Statutes and the amount of compensation charged.
9. Applicant agrees to become a member of Diggers Hotline for marking / locating of utility.
10. The applicant for a permit to encroach on the public right-of-way shall procure and maintain for the duration of the permit a minimum liability and contractual liability policy in the amount of \$100,000.00 each person, \$300,000.00 each accident for bodily injury and \$100,000.00 for property damage. A certificate of such insurance shall be filed with the City Attorney as part of the application. The insurance shall name the City, its officials, employees and agents as additional insureds. The Board may approve greater insurance protection on a case-by-case basis.
11. Applicant further agrees to hold harmless the City for any damage to said cable while the City, its agents or contractors are conducting construction for maintenance activities in or upon such area in which said cable lies; provided, however, the City shall make a good faith effort to notify applicant of any maintenance or work in the area of the street privilege permit which may damage applicant's cable.
12. Applicant agrees to remove the cable and return the area to its original condition upon ten (10) days' notice by the Board of Public Works. The applicant further agrees that if it does not remove the cable within ten (10) days after receiving notice, the City is authorized to remove the same and applicant agrees to pay the City for all costs of such removal.
13. Applicant further agrees that the obligations and conditions of this street privilege permit shall be binding upon all heirs, successors and assigns of applicant.
14. The person(s) signing this Permit warrant that they have the authority to sign as, or on behalf of, the party for whom they are signing.



**PLAN SHEET DISCLAIMER:**

1. EVERY REASONABLE EFFORT HAS BEEN MADE TO ASSURE THE ACCURACY OF THESE PLANS AND ASSOCIATED DATA.
2. IN AN EFFORT TO INCREASE THE CLARITY AND LEGIBILITY OF THE PLANS, EXISTING UNDERGROUND UTILITIES WILL NOT BE SHOWN UNLESS THERE IS PROPOSED WORK THAT WILL REQUIRE EXCAVATION OR ANY OTHER EARTH DISTURBING ACTIVITY. IF PROPOSED WORK WILL REQUIRE THIS TYPE OF ACTIVITY. EXISTING UNDERGROUND UTILITIES WILL BE PROPERLY INVESTIGATED AND REPRESENTED ON THE PLAN SHEET OF THE RESPECTIVE WORK LOCATION

**UTILITIES**

1. THE IDENTITY AND LOCATION OF EXISTING UNDERGROUND UTILITIES LOCATED IN AND AROUND THE CONSTRUCTION AREA HAVE BEEN SHOWN AND LABELED ON THE PLANS BY USING INFORMATION PROVIDED BY THE RESPECTIVE UTILITY OWNERS.
2. SUPPORT AND PROTECTION OF ALL UTILITIES AND APPURTENANCES SHALL BE THE RESPONSIBILITY OF THE CONTRACTOR. COSTS FOR THE REPAIR AND RESTORATION OF EXISTING UTILITIES DAMAGED BY THE CONTRACTOR SHALL BE THE RESPONSIBILITY OF THE CONTRACTOR
3. CALL 811 BEFORE YOU DIG. AT LEAST 48 HOURS PRIOR TO EXCAVATION.

**WORK LIMITS**

1. THE WORK LIMITS SHOWN ON THESE PLANS ARE FOR PHYSICAL CONSTRUCTION ONLY. THE INSTALLATION AND OPERATION OF ALL TEMPORARY TRAFFIC CONTROL AND TEMPORARY TRAFFIC CONTROL DEVICES REQUIRED BY THESE PLANS SHALL BE PROVIDED BY THE CONTRACTOR WHETHER INSIDE OR OUTSIDE OF THESE WORK LIMITS.

**MAINTAIN DRAINAGE**

1. THE CONTRACTOR AT HIS OWN EXPENSE, SHALL MAINTAIN THE FLOW IN ALL SEWERS, DRAINS, FIELD TILES, AND WATERCOURSES ENCOUNTERED IN AND AROUND THE PROJECT SITE. IF SUCH WATERCOURSES OR DRAINS ARE DISTURBED OR DESTROYED DURING THE EXECUTION OF THE PROJECT, THEY SHALL BE RESTORED BY THE CONTRACTOR AT HIS OWN EXPENSE TO A CONDITION SATISFACTORY TO THE ENGINEER.

**SECURING EXCAVATIONS & TRENCHES FOR NON-WORKING HOURS**

1. EXCAVATIONS AND TRENCHES OVER 24-INCHES DEEP SHALL BE SECURELY PLATED OR BACKFILLED DURING NON-WORKING HOURS.

**EXCAVATION OF ROADWAY AND RIGHT-OF-WAY AREAS**

1. ANY CONTRACTOR PERFORMING EXCAVATION, INCLUDING BUT NOT LIMITED TO DISTURBING THE EARTH WTH POWERED OR NON-POWERED EQUIPMENT, DRILLING AND/OR BORING, SHALL CAUSE NOTICE TO BE GIVEN BY CALLING 811 AT LEAST 48 HOURS BUT NOT MORE THAN 10 WORKING DAYS BEFORE EXCAVATING.
2. THE EXCAVATOR SHALL PROTECT AND PRESERVE THE MARKINGS UNTIL THOSE MARKINGS ARE NO LONGER NEEDED. IF AN EXCAVATION WILL COVER A LARGE AREA AND/OR PROGRESS FROM ONE AREA TO THE NEXT OVER A PERIOD OF TIME. THE EXCAVATOR SHALL COORDINATE THE MARKING OF APPROXIMATE LOCATIONS OF CITY OWNED FACILITIES WITH THE ACTUAL EXCAVATION.
3. THE CONTRACTOR IS RESPONSIBLE FOR LOCATING ALL CUSTOMER OWNED SERVICE LINES/LATERALS. THE CONTRACTOR SHALL FIELD VERIFY THE HORIZONTAL AND VERTICAL LOCATION OF ANY CITY OR CUSTOMER OWNED MAIN OR SERVICE LINE/LATERALS THAT MAY BE AFFECTED BY THE PROPOSED CONSTRUCTION ACTIVITIES. FIELD VERIFICATION SHALL TAKE PLACE PRIOR TO ANY ACTIVITY THAT MAY JEOPARDIZE THE INTEGRITY OF THE FACILITY AND AT A LOCATION NEAREST THE POINT OF POSSIBLE CONFLICT.
4. ANY DAMAGES TO CITY OR CUSTOMER OWNED FACILITIES SHOULD FIRST BE REPORTED TO THE UTILITY OWNER THEN IMMEDIATELY NOTIFY THE PROJECT ENGINEER.

**AERIAL CONSTRUCTION:**

1. CONTRACTOR TO VERIFY ALL BONDING AND GROUNDING COMPLES WITH NESC GUIDELINES.
2. CONSTRUCTION TO VERIFY ALL REQUIRED MAKE READY WORK IS COMPLETE BEFORE PLACING ON UTILITY POLES.

**SAFETY NOTE:**

1. CHECK IN WITH CONSTRUCTION SUPERVISOR WHEN ARRIVING ON-SITE.
2. HEAVY CONSTRUCTION EQUIPMENT IN USE. BEWARE OF SURROUNDINGS.
3. FOLLOW CONGRUEX SAFETY POLICIES AND GUIDELINES AT ALL TIMES WHILE WORKING.
4. CONSTRUCTION ZONE/ HARD HAT, SAFETY GLASSES, REFLECTIVE VEST/SHIRT, SAFETY TOE BOOTS REQUIRED – WORK SAFELY



CHC

A CONGRUEX<sup>®</sup> COMPANY

brightspeed

CONFIDENTIAL AND PROPRIETARY

LCRSWIXB

LEGENDS SHEET

R/W

R/W

C/L

CENTER LINE

EOP

EOP

BOC

BOC

PROPERTY LINE

FENCE

T

TELCO

E

ELECTRIC

G

GAS

TS

TRAFFIC SIGNAL

W

WATER

S

SEWER

SD

STORM DRAIN

U/E

UTILITY EASEMENT

RAIL TRACKS

SIDEWALK

CABINET

EXISTING PED

EXISTING FLOWERPOT

EXISTING HANDHOLE

TELEPHONE CABINET

TELEPHONE MANHOLE

POLE

CABLE MARKER

STREET SIGN

VERTICAL GROUND

ELECTRIC PEDESTAL/CABINET

ELECTRIC TRANSFORMER

ELECTRIC METER

ELECTRIC VAULT/HANDHOLE

ELECTRIC MANHOLE

EXISTING VAULT

STREETLIGHT

POWER PED

CATV PED

CATV VAULT/HANDHOLE

TREE

TRANSFORMER

GAS METER

GAS VALVE

SEWER MANHOLE

UNKNOWN MANHOLE

WATER METER

WATER VALVE

FIRE HYDRANT

WATER MANHOLE

STORM DRAIN CATCH BASIN

STORM DRAIN MANHOLE

CULVERT

C/L MONUMENT

ANCHOR & DOWN GUY

LEGENDS SHEET

PROPOSED EQUIPMENTS LEGENDS

BORE

BORE

TRENCH

A

AERIAL FIBER

AERIAL STRAND

12"X24"X18" HANDHOLE

17"X30"X18" HANDHOLE

24"X36"X24" HANDHOLE

36"X48"X30" HANDHOLE

ANCHOR & DOWN GUY

MINIMUM STANDARDS FOR DIRECTIONAL BORING  
STREET CROSSINGS

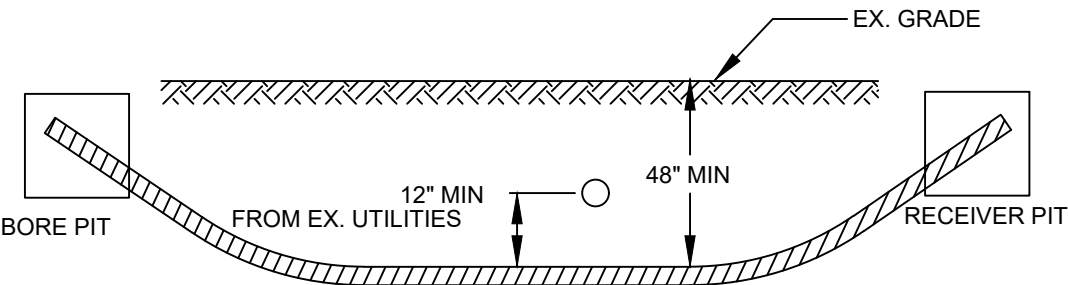

- PLACE END MARKER WITH UTILITY OWNER'S NAME DESCRIBING CONDUIT
- BORE PIT TO BE BACKFILLED AND COMPACTED IN 12" LIFTS WITH MATERIAL REMOVED
- FLOW OF DITCH MUST BE MAINTAINED AT ALL TIMES
- PROTECT ROOTS AT ALL TREE LOCATIONS, SHIFT BORE TRENCH IF NECESSARY

TYPICAL BORE DETAILS 1

MINIMUM STANDARDS FOR DIRECTIONAL BORING  
UNDER SIDEWALKS & WITHIN ROW (EXCLUDING STREET CROSSINGS)

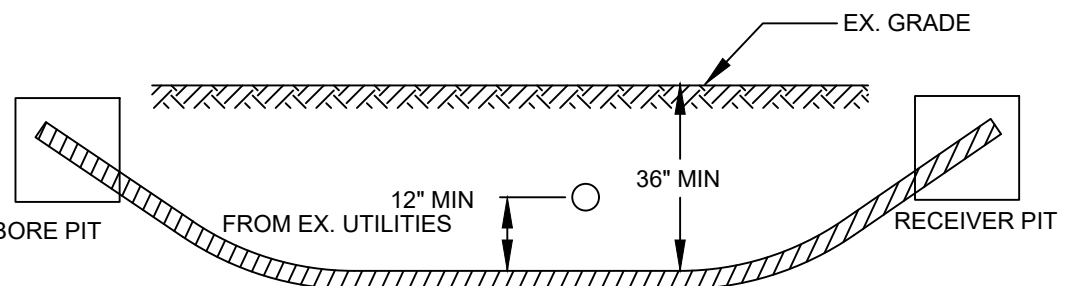

- PLACE END MARKER WITH UTILITY OWNER'S NAME DESCRIBING CONDUIT
- BORE PIT TO BE BACKFILLED AND COMPACTED IN 12" LIFTS WITH MATERIAL REMOVED
- FLOW OF DITCH MUST BE MAINTAINED AT ALL TIMES
- PROTECT ROOTS AT ALL TREE LOCATIONS, SHIFT BORE TRENCH IF NECESSARY

TYPICAL BORE DETAILS 2

PLAN VIEW

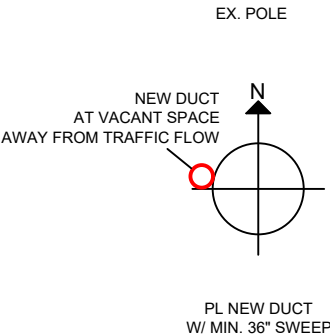

ELEVATION

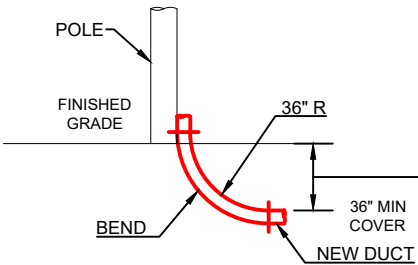

RISER DETAILS

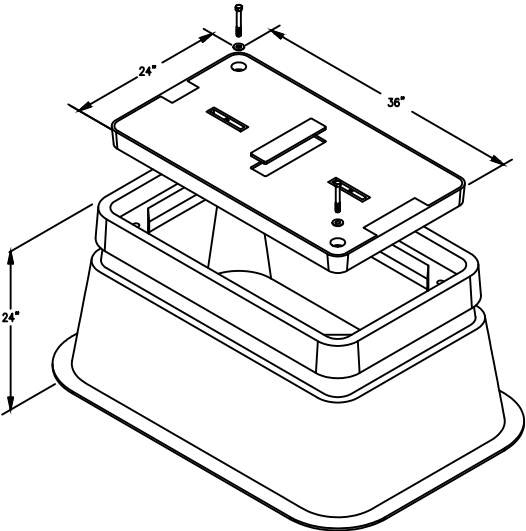

24"x36"x24"  
N.T.S.

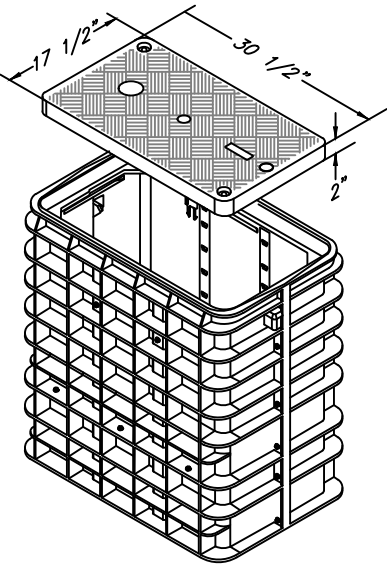

17"x30"x18"  
N.T.S.

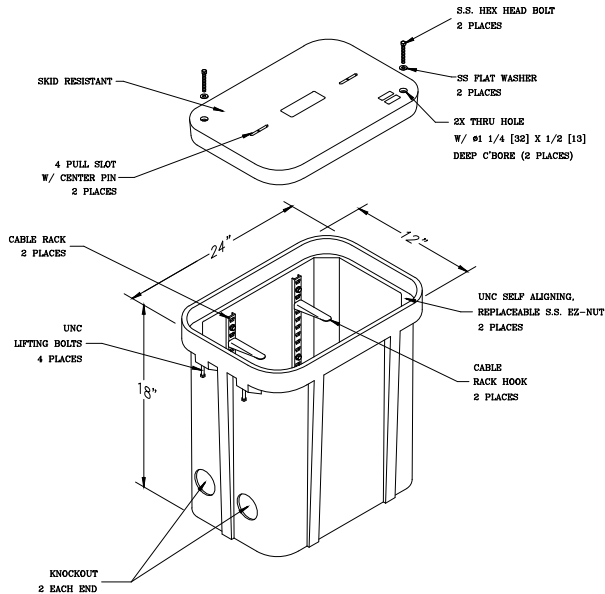

12"x24"x18"  
N.T.S.

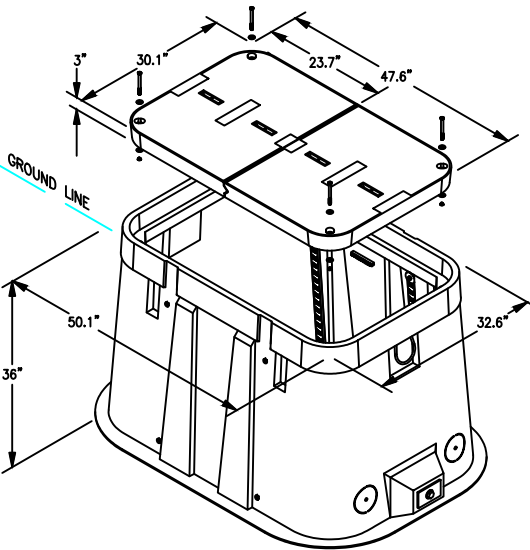

30"x48"x36"  
N.T.S.

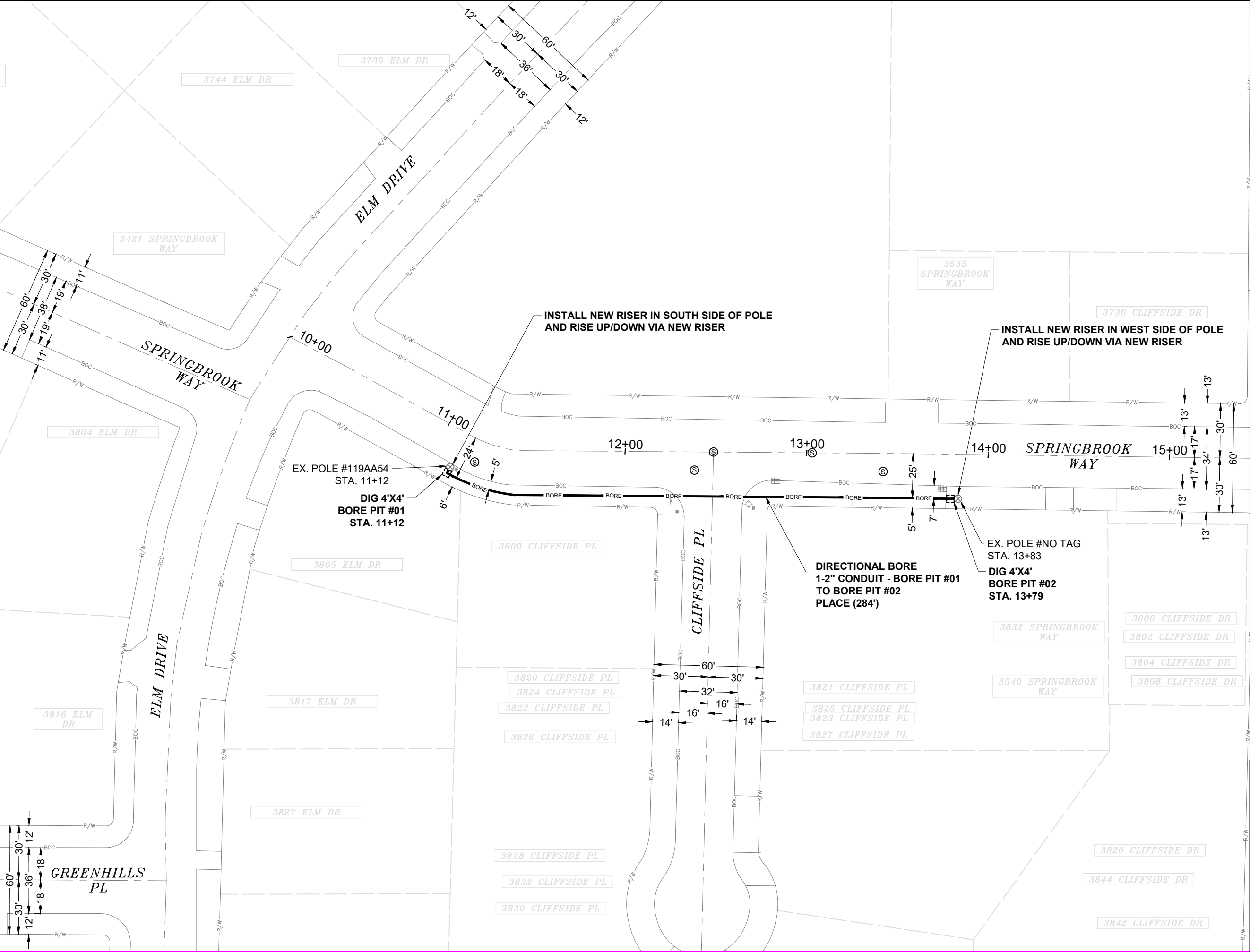

EXCAVATION DATA	
PROPOSED UTILITY	DIRT
(2) 4'X4' BORE PIT	32 SQFT
CALL 811 BEFORE YOU DIG. WISCONSIN TOLL FREE 800-242-8511	
	
 A CONGRUEX® COMPANY	
CONFIDENTIAL AND PROPRIETARY LCRSWIXB	
05 OF 05	
SCALE: 1" = 50'	



# City of La Crosse, Wisconsin

City Hall  
400 La Crosse Street  
La Crosse, WI 54601

## Text File

File Number: 25-0437

---

**Agenda Date:** 4/14/2025

**Version:** 1

**Status:** Agenda Ready

**In Control:** Board of Public Works

**File Type:** General Item



# REVOCABLE OCCUPANCY / STREET PRIVILEGE PERMIT APPLICATION

## City of La Crosse Engineering Department

Phone: 608-789-7505 Email: [engineering@cityoflacrosse.org](mailto:engineering@cityoflacrosse.org) <http://cityoflacrosse.org>

Property Owner: Scenic Center LLC.  
Address: 115 5th Ave. S. City: LaCrosse State: WI Zip: 54601  
Phone # 608 570-4248 Email Address info@sceniccenterproperties  
Application Preparer (if different from above) Netwal Dental  
Relationship with Owner: Tenant  
Phone # \_\_\_\_\_ Email Address \_\_\_\_\_

### Description of Proposed Encroachment:

mount 2 air conditioners  
on metal brackets - approx 14 ft. mounts there, just replacing units.

### Encroachment Address(es):

115 5th Ave. S.

### Benefiting Tax Parcel ID #(s):

I certify that I have reviewed the Municipal Code and understand all that is related to this permit request. I further certify that I have the full authority to make the foregoing application; the information in the application and the required submittals are complete and correct; the Work or Use performed shall comply with all the laws of the State of Wisconsin, and all ordinances, rules, regulations, policies and special conditions of the City of La Crosse. The applicant agrees to perform the work covered by an approved permit with diligence and convenience to the public.

Signature of Owner: Brad Frohn Date: 3/11/2025  
Print Name and Title: Scenic Center LLC. - owner

Please return this completed application along with required information and fees noted on checklist below to: City of La Crosse, Engineering Department, 400 La Crosse Street, La Crosse, WI 54601. You will then be given notice of when your request will be on the Board of Public Works agenda for consideration. Once approved an agreement document will be drafted by City and sent to Owner for signatures. Permit will then be valid once recorded with the County's Register of Deeds department. Applicant shall obtain all other necessary permits as required by City Departments. **Average completion time for validation 45 days.**

### BELOW THIS LINE TO BE COMPLETED BY CITY STAFF ONLY

#### Required items to be provided by Applicant:

Scale Drawing of encroachment on letter size paper(s)	<input checked="checked" type="checkbox"/>
Legal Description of benefiting parcel(s)	<input type="checkbox"/>
Certificate of Insurance (City as additional Insured)	<input type="checkbox"/>
Initial Application / Annual Fee \$ _____	<input type="checkbox"/>
City Utility Potential Conflict Notification and Sign-Off	<input type="checkbox"/>

#### Board of Public Works

##### Approval Date:

##### Encroachment Type:

##### Permit Number:

All Fees are Non-Refundable & Subject to change by City Council



# TEMPORARY STREET PRIVILEGE PERMIT

Engineering Dept. • Phone: (608) 789-7505 • Fax: (608) 789-8184  
<http://www.cityoflacrosse.org> [engineering@cityoflacrosse.org](mailto:engineering@cityoflacrosse.org)

Permit No:
Date: 3/11/25
Parcel ID:

STATUS:	Permit Type:
---------	--------------

Name: Schmit Center LLC			
Address: 115th Ave S, Hwy			
City: Lacrosse	State: WI	Zip Code: 54601	
Phone: 608 570 4248	Cell:	Fax:	Email: info@schmitcenter.com
Vehicle License Number (If Applicable):		Tag #:	

Location: Alley 115 5th Ave S			
Area to be occupied:	Traffic Lane(s)	Parking Lane(s)	Boulevard Sidewalk <u>Alley</u> X
Purpose for permit: replace 2 existing AC units			
Additional Conditions: only 2 days			
Start Date:		End Date:	

Invoice #:	Fee: \$35.00 first 5 days, \$2.00 each additional day
Permit issued by:	
Comments:	

The undersigned understands and agrees to the following: 1) The permitted work shall comply with all permit provisions and conditions listed on and attached to this form; 2) That insurance requirements shall be met prior to approval either by submitting information with application or by keeping current information on file with the Engineering Dept.; 3) The applicant shall contact City Dispatch and the City Traffic Engineer 24 hours prior to the closure of any traffic lanes and shall provide an estimate of the duration of the closure. Temporary traffic control shall be provided and maintained by the applicant and shall comply with Part 6 of the *Manual on Uniform Traffic Control Devices (MUTCD)*.

**Note:** Once invoiced, application fees may not be refunded. Details of permit, including dates, may be modified with approval of the Engineering Department.

(PRINT) AUTHORIZED REPRESENTATIVE \_\_\_\_\_ TITLE \_\_\_\_\_ DATE \_\_\_\_\_

(SIGN) AUTHORIZED REPRESENTATIVE \_\_\_\_\_ TITLE \_\_\_\_\_ DATE \_\_\_\_\_



# Ground / Alley View

