



## Engineering Department

City of La Crosse  
400 La Crosse Street  
La Crosse, WI 54601-3396  
(608) 789-7505  
Fax (608) 789-7367

August 19, 2019

### ITEMS REQUESTED TO BE ADDED OR CHANGED TO THE 2020 CIB

#### INFRASTRUCTURE

##### **Alleys:**

Add Item #? – Alley from Adams St. to Johnson St. between 13th and Grant Court  
(\$36,000 total, \$26,000 (10) Assessable, \$10,000 (4) City)

Add Item #? – Alley from Hamilton St. to Camp St. between Harvey St. and Hamilton St.  
(\$67,000 (4) Northside Flood Fund)

Add Item #? - Stormwater for Alley Hamilton, Camp, and Harvey Streets  
(38,000 Stormwater Utility)

##### **Streets**

Add Item #? – Replace Existing Wayfinding Signs \$30,000  
(\$30,000 (4))

Add Item #? – Install New Sidewalks Along Green Bay St. from 16<sup>th</sup> St to 15<sup>th</sup> St.  
(\$85,000 (4))

Add Item #? – Bridge Maintenance Copeland Ave. Bridge, and Lang Dr. Bridge.  
(\$450,000 (4) street funds)

Add Item #? – Bridge Inspection and reporting.  
(\$50,000 (4) street funds)

PRELIM	<b>ENGINEERING DEPARTMENT</b> <b>ESTIMATE</b> <b>CITY of LA CROSSE, WI</b>	PROJECT AND LOCATION	
FINAL		2020 ALLEY PAVING	
REVISED		N/S Alley from Johnson St. to Adams St. Between Grant Ct., and 13th St.	
SURVEYS: Scott D 2019		PLANS: none	
PREPARED BY: JMC		DATE: 8/19/2019	
<b>NO STORM SEWER REQUIRED</b>		20' R.O.W.	17' PAV'T.

Item	Description	Quantity	Unit Price	Total
	S.Y. 6" Concrete Pavement	564.0	\$ 49.80	\$28,087.20
	S.F. 7" Concrete Alley Approach	290.0	\$ 7.60	\$2,204.00
	S.F. " Concrete Sidewalk (Assumes 4" thickness)	72.0	\$ 6.10	\$439.20
	S.F. " Concrete Sidewalk (Assumes 5" thickness)		\$ 6.50	\$0.00
	L.F. Standard Curb & Gutter	24.0	\$ 31.50	\$756.00
	S.F. 3" Bituminous Pavement w/6" Crushed Rock Base	26.0	\$ 16.00	\$416.00
	S.F. 2" Bituminous Pavement w/4" Crushed Rock Base	12.0	\$ 13.00	\$156.00
	S.F. " Concrete Flatwork (Assumes 6" thickness)	30.0	\$ 6.75	\$202.50
	S.F. 5" H.C. Ramps and Sidewalk		\$ 7.00	\$0.00
	L.S. Erosion Control	1.0	\$ 105.00	\$105.00
	L.S. Temporary Traffic Control	1.0	\$ 120.00	\$120.00
	<u>Removal Items</u>			
	S.F. Concrete Flatwork (Any thickness)	45.0	\$ 1.30	\$58.50
	S.F. Bituminous Concrete Pavement	44.0	\$ 0.57	\$25.08
	L.F. Standard Curb & Gutter	24.0	\$ 3.35	\$80.40
	L.F. Bituminous Sawing	54.0	\$ 3.70	\$199.80
	L.F. Concrete Sawing	30.0	\$ 5.05	\$151.50
	Dia. Inch Tree Removal incl. Grubbing		\$ 22.00	\$0.00
	Lump Sum Shrub & Bush Removal/Trimming			\$0.00
	C.Y. - Unclassified Excavation			\$0.00
Total Alley Frontage - 576.7' Assessable Frontage - 576.7'		Est Construction Cost		\$33,001.18
Total Assessable Project Costs - \$25,896		Est Contingency Cost		\$1,650.06
Assessable Cost per Foot - \$44.90		Total Est - Contractural		\$34,651.24
Property Share - \$25,896		Engineering & Inspection		\$1,732.56
City Share - \$10,488		Total Estimate		\$36,383.80
Total Alley Construction Cost- \$36,384		Outside alley deducts		\$4,014.02
		x 0.80		\$25,896

Estimate Approved by: \_\_\_\_\_  
Date: \_\_\_\_\_



JOHNSON STREET

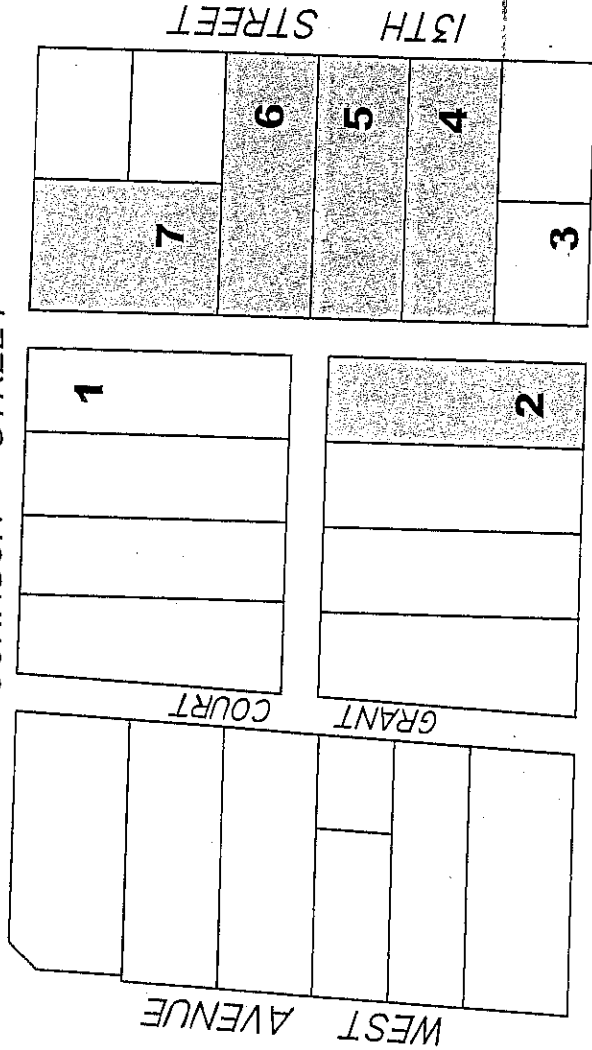

= Signed Petition in favor of Alley Paving

67 % IN FAVOR OF ALLEY PAVING

ADAMS STREET

Map ID #	Tax Parcel Number	PROPADDCOMP	OwnerName	CompleteAddress	MailCityStateZip	Alley Frontage
1	17-40007-130	1230 JOHNSON ST	CRYSTAL J OVERHOUSE	1230 JOHNSON ST	LA CROSSE, WI 54601-5615	140'
2	17-40008-110	1233 ADAMS ST	PARKER HOLLEY ENTERPRISES LLC	545 YOUILON ST N	WEST SALEM, WI 54669	138.34'
3	17-40007-120	1241 ADAMS ST	DOROTHY A JOHNSON	1241 ADAMS ST	LA CROSSE, WI 54601-5633	50'
4	17-40007-100	1122 13TH ST S	KYLE M BACKSTRAND, JENNY L BACKSTRAND	1122 13TH ST S	LA CROSSE, WI 54601-5602	49.59'
5	17-40007-90	1118 13TH ST S	BRIAN D BESSERT	1118 13TH ST S	LA CROSSE, WI 54601	49.59'
6	17-40007-80	1112 13TH ST S	JOHN WILLINGHAM, GLADYS WILLINGHAM	1112 13TH ST S	LA CROSSE, WI 54601-5602	49.59'
7	17-40007-50	1236 JOHNSON ST	JANE A LYNAUGH	43 WOOD BROOK WAY	FITCHBURG, WI 53711	99.59'

PRELIM	<b>ENGINEERING DEPARTMENT</b>		<b>PROJECT AND LOCATION</b>	
FINAL	<b>ESTIMATE</b>		<b>2020 ALLEY PAVING</b>	
REVISED	CITY of LA CROSSE, WI			
SURVEYS: none PLANS: none			Harvey Street Alley	
PREPARED BY: JMC DATE: 7/18/2019			Camp Street South to Hamilton Street	
<b>STORM SEWER REQUIRED</b>			<b>R.O.W. 20' PAV'T. 17'</b>	
Item	Description	Quantity	Unit Price	Total
	S.Y. 6" Concrete Pavement	1092.0	\$ 49.80	\$54,381.60
	S.F. 7" Concrete Alley Approach	290.0	\$ 7.60	\$2,204.00
	S.F. " Concrete Sidewalk (Assumes 4" thickness)		\$ 6.10	\$0.00
	S.F. " Concrete Sidewalk (Assumes 5" thickness)		\$ 6.50	\$0.00
	L.F. Standard Curb & Gutter	24.0	\$ 31.50	\$756.00
	S.F. 3" Bituminous Pavement w/6" Crushed Rock Base	26.0	\$ 16.00	\$416.00
	S.F. 2" Bituminous Pavement w/4" Crushed Rock Base	90.0	\$ 13.00	\$1,170.00
	S.F. " Concrete Flatwork (Assumes 6" thickness)	90.0	\$ 6.75	\$607.50
	S.F. 5" H.C. Ramps and Sidewalk		\$ 7.00	\$0.00
	L.S. Erosion Control	1.0	\$ 105.00	\$105.00
	L.S. Temporary Traffic Control	1.0	\$ 120.00	\$120.00
	<u>Removal Items</u>			
	S.F. Concrete Flatwork (Any thickness)	60.0	\$ 1.30	\$78.00
	S.F. Bituminous Concrete Pavement	86.0	\$ 0.57	\$49.02
	L.F. Standard Curb & Gutter	24.0	\$ 3.35	\$80.40
	L.F. Bituminous Sawing	88.0	\$ 3.70	\$325.60
	L.F. Concrete Sawing	60.0	\$ 5.05	\$303.00
	Dia. Inch Tree Removal incl. Grubbing		\$ 22.00	\$0.00
	Lump Sum Shrub & Bush Removal/Trimming			\$0.00
	C.Y. - Unclassified Excavation			\$0.00
	Total Alley Frontage - 1038.5' Assessable Frontage - 1038.5'		Est Construction Cost	\$60,596.12
	Total Assessable Project Costs - \$50,586		Est Contingency Cost	\$3,029.81
	Assessable Cost per Foot - \$48.71		Total Est - Contractural	\$63,625.93
	Property Share - \$50,586		Engineering & Inspection	\$3,181.30
	City Share - \$16,221		Total Estimate	\$66,807.22
	Total Alley Construction Cost- \$66,807		Outside alley deducts	\$3,574.82
			x 0.80	\$50,586

Estimate Approved by: \_\_\_\_\_

Date: \_\_\_\_\_

