

# BRIGHTSPEED LA CROSSE

2135 ENTERPRISE AVE.  
 ENTERPRISE AVE. & COMMERCE ST.  
 LA CROSSE, WI

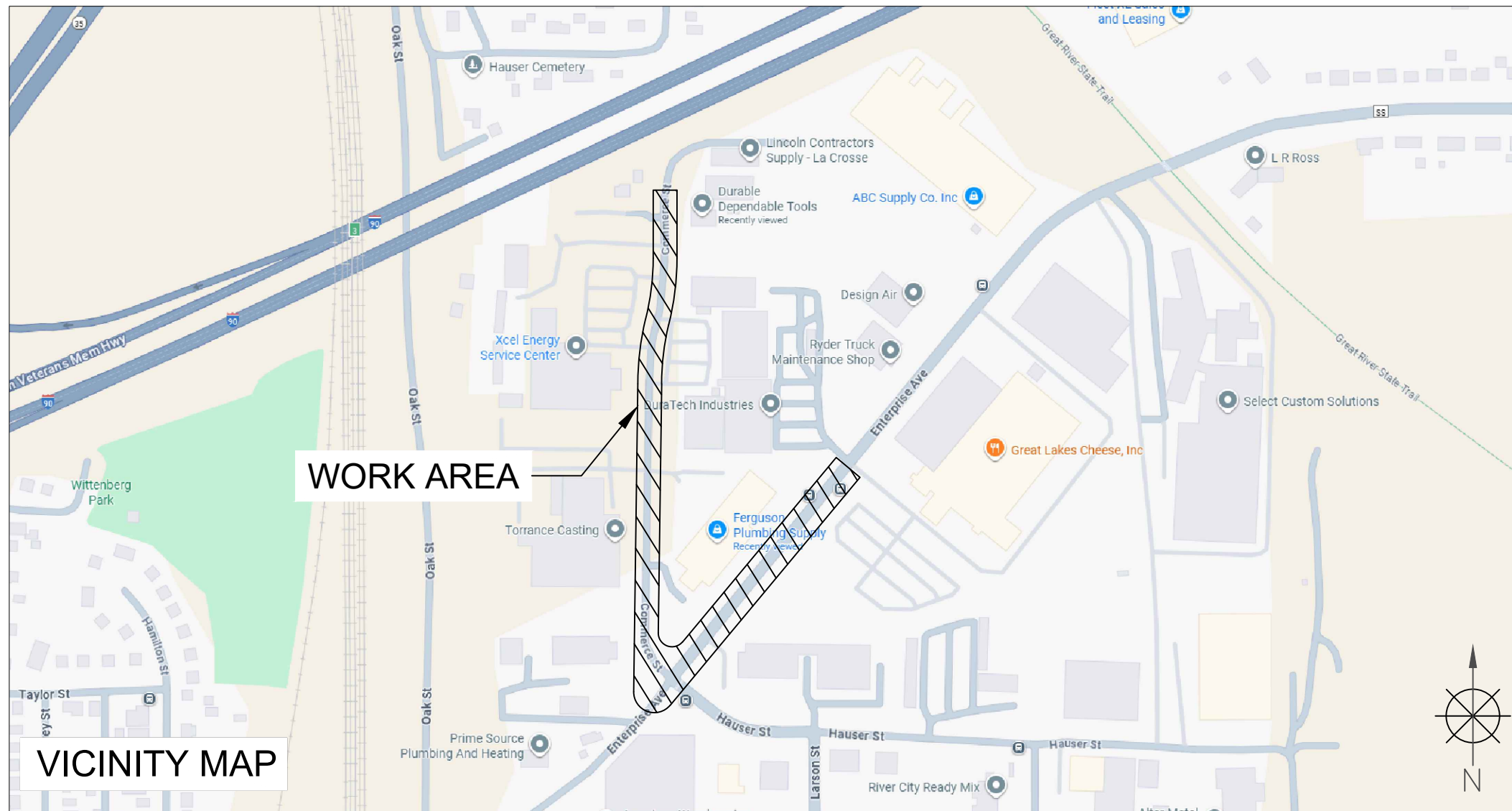

## TRAFFIC CONTROL PLAN

**PERMITTING AGENCY**  
 CITY OF LA CROSSE



**CNS**  
 A CONGRUEX COMPANY  
 1600 PEARL ST. SUITE 300 BOULDER  
 CO 80302, (702)510-5326

**BRIGHTSPEED**

**SCOPE OF WORK**

**SHEET INDEX**

- BORING - HH, GROUND ROD & RISER PLACEMENT	SHEET	DESCRIPTION
	KEYMAP	VICINITY MAP & SCOPE OF WORK
	TC-1 TO TC-6	TRAFFIC CONTROL PLAN

**PROPOSED PATH FOOTAGE**  
 UG PATH - 2,093 FT

REVISIONS			
REV.	DESCRIPTION	BY	DATE
0	INITIAL DESIGN	K.K.	8/20/25

LCRSWIXA

**KEYMAP**  
 N.T.S.

**2135 ENTERPRISE AVE.  
 ENTERPRISE AVE. AND COMMERCE ST.  
 -BORING & RISER PLACEMENT  
 WORK AREA 1 OF 1  
 PHASE 1 OF 4**

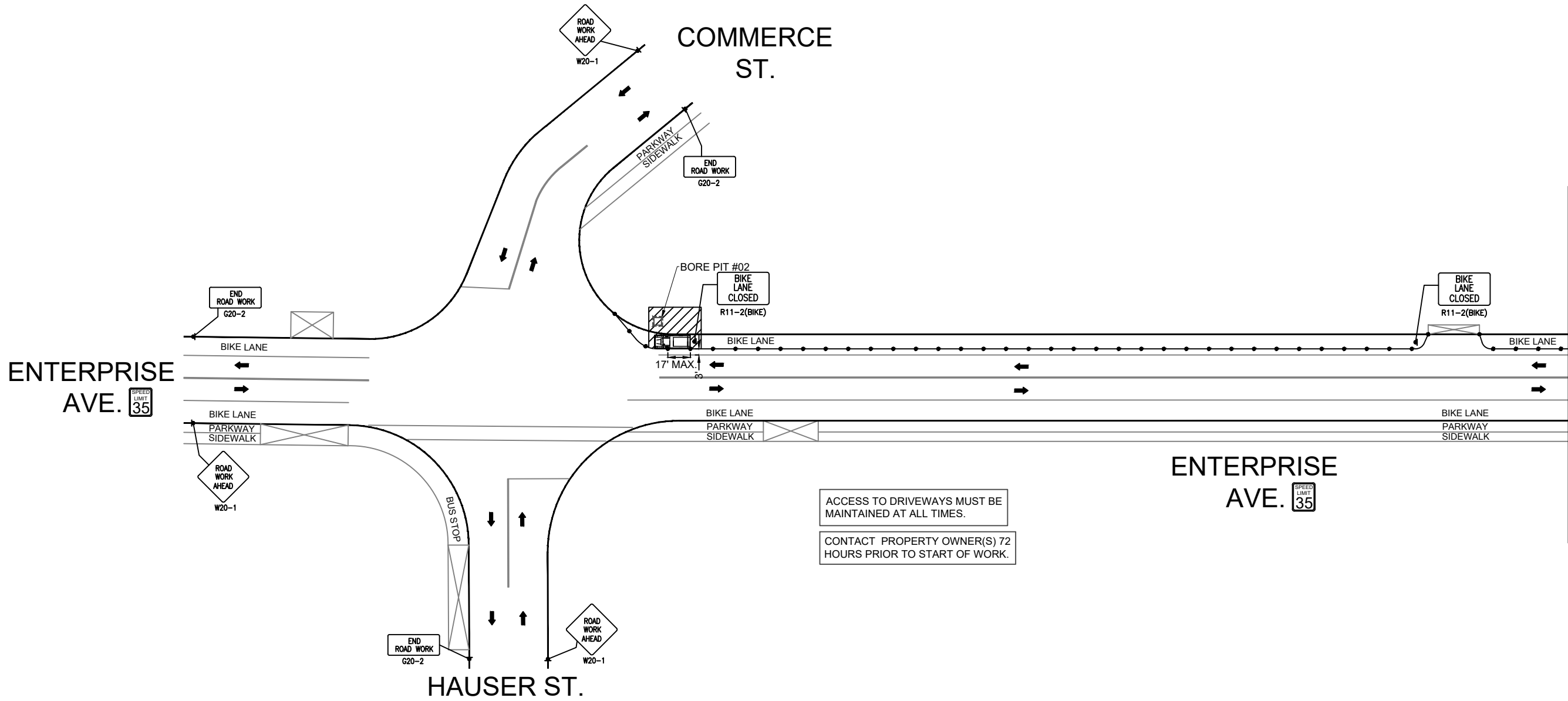

**LEGEND**

- \* PORTABLE FLASHING BEACON (P.F.B.)
- ≡ TYPE III BARRICADE W/SIGN
- ≡ TYPE II BARRICADE W/SIGN
- CHANNELIZING DEVICE
- ▼ TRAFFIC CONE WITH CLIP ON SIGN
- TYPE I W/ SIGN
- EXISTING SIGN
- ⊙ SIGNALIZED INTERSECTION
- ⚡ FLASHING ARROW BOARD
- ⚡ HIGH LEVEL WARNING DEVICE (FLAGTREE)
- ♠ FLAGGER
- TANSAT TOW AWAY NO STOPPING ANY TIME
- ⊠ EXISTING DRIVEWAY
- ▨ WORK ZONE (ACTIVITY AREA) LIMITS
- ➔ DIRECTION OF TRAFFIC (NOT PAVEMENT MARKING)

**MATCHLINE-A  
SEE TC-2 OF TC-6**

CALL 811 BEFORE YOU DIG.  
 WISCONSIN TOLL FREE  
 800-242-8511

**BRIGHTSPEED**

PLANS PREPARED BY:  
**CNS**  
 A CONGRUEX COMPANY  
 1600 PEARL ST. SUITE 300 BOULDER  
 CO 80302, (702)510-5326

REVISIONS

REV.	DESCRIPTION	BY	DATE
0	INITIAL DESIGN	K.K.	8/20/25

**BRIGHTSPEED**  
 CONFIDENTIAL AND PROPRIETARY  
 LCRSWIXA

**TC-1 OF TC-6**

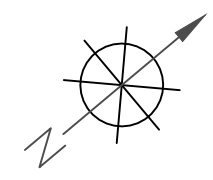

**2135 ENTERPRISE AVE.  
 ENTERPRISE AVE. AND COMMERCE ST.  
 -BORING & RISER PLACEMENT  
 WORK AREA 1 OF 1  
 PHASE 1 OF 4**

**MATCHLINE-A  
 SEE TC-1 OF TC-6**

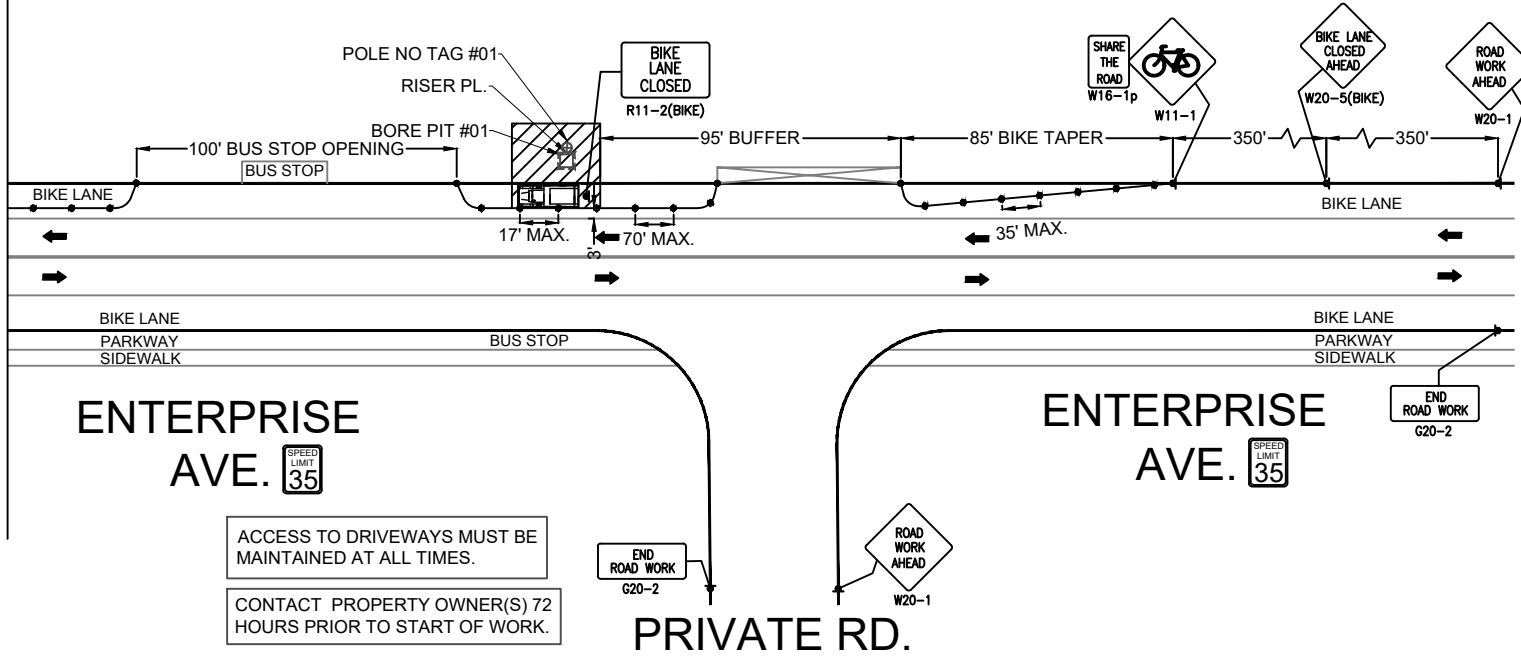

ACCESS TO DRIVEWAYS MUST BE MAINTAINED AT ALL TIMES.  
 CONTACT PROPERTY OWNER(S) 72 HOURS PRIOR TO START OF WORK.

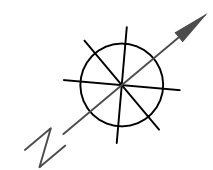

**LEGEND**

- \* PORTABLE FLASHING BEACON (P.F.B.)
- ≡ TYPE III BARRICADE W/SIGN
- ≡ TYPE II BARRICADE W/SIGN
- CHANNELIZING DEVICE
- ▼ TRAFFIC CONE WITH CLIP ON SIGN
- TYPE I W/ SIGN
- EXISTING SIGN
- Ⓢ SIGNALIZED INTERSECTION
- ⚡ FLASHING ARROW BOARD
- ⚡ HIGH LEVEL WARNING DEVICE (FLAGTREE)
- 🚧 FLAGGER
- TANSAT TOW AWAY NO STOPPING ANY TIME
- ⊠ EXISTING DRIVEWAY
- ▨ WORK ZONE (ACTIVITY AREA) LIMITS
- ➔ DIRECTION OF TRAFFIC (NOT PAVEMENT MARKING)

CALL 811 BEFORE YOU DIG.  
 WISCONSIN TOLL FREE  
 800-242-8511

**BRIGHTSPEED**

PLANS PREPARED BY:  
**CNS**  
 A CONGRUEX\* COMPANY  
 1600 PEARL ST. SUITE 300 BOULDER  
 CO 80302, (702)510-5326

REVISIONS			
REV.	DESCRIPTION	BY	DATE
0	INITIAL DESIGN	K.K.	8/20/25

**BRIGHTSPEED**  
 CONFIDENTIAL AND PROPRIETARY

LCRSWIXA

**TC-2 OF TC-6**

SCALE: 1:60



**2135 ENTERPRISE AVE.  
 ENTERPRISE AVE. AND COMMERCE ST.  
 -BORING & HH PLACEMENT  
 WORK AREA 1 OF 1  
 PHASE 2 OF 4**

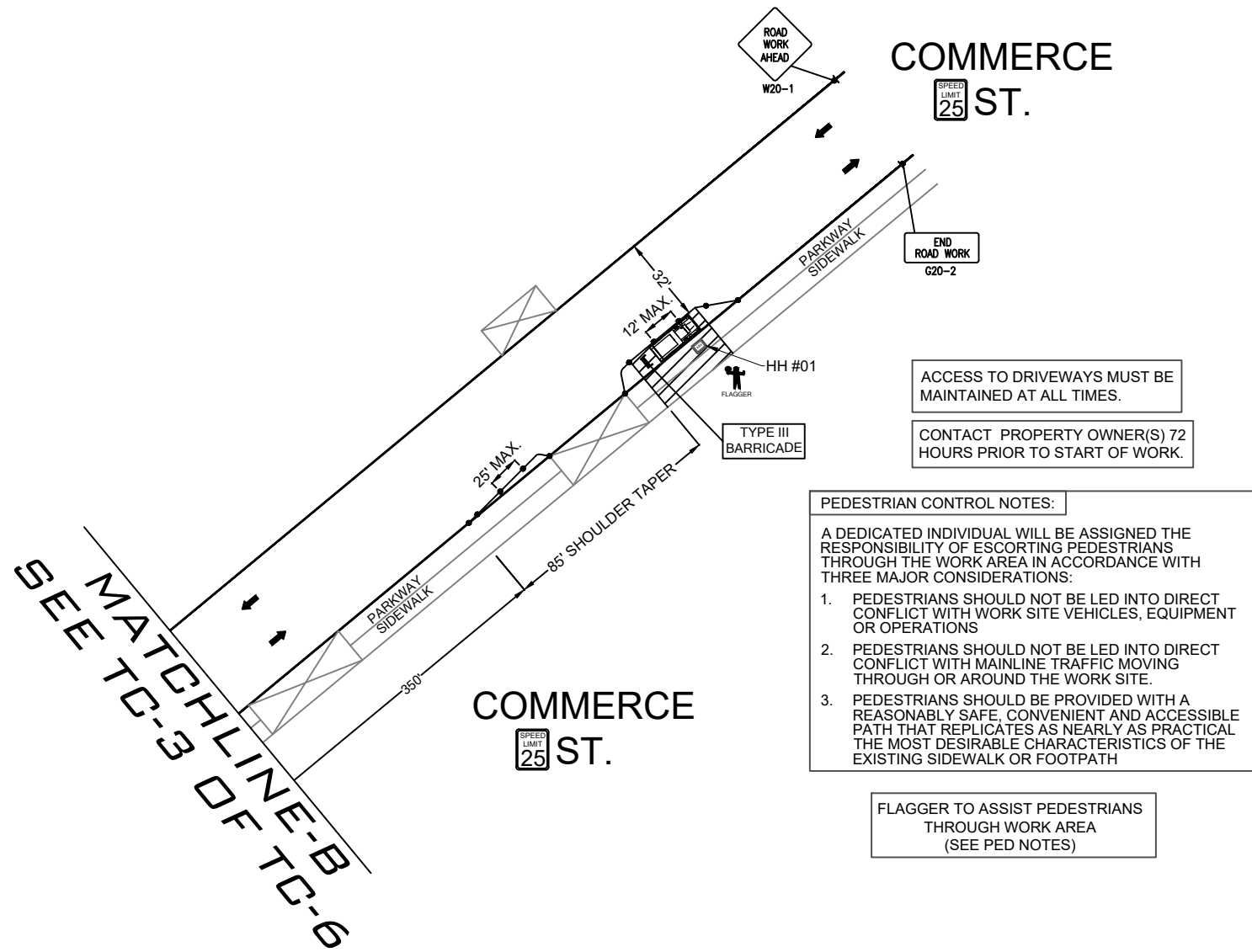

**PEDESTRIAN CONTROL NOTES:**  
 A DEDICATED INDIVIDUAL WILL BE ASSIGNED THE RESPONSIBILITY OF ESCORTING PEDESTRIANS THROUGH THE WORK AREA IN ACCORDANCE WITH THREE MAJOR CONSIDERATIONS:

1. PEDESTRIANS SHOULD NOT BE LED INTO DIRECT CONFLICT WITH WORK SITE VEHICLES, EQUIPMENT OR OPERATIONS
2. PEDESTRIANS SHOULD NOT BE LED INTO DIRECT CONFLICT WITH MAINLINE TRAFFIC MOVING THROUGH OR AROUND THE WORK SITE.
3. PEDESTRIANS SHOULD BE PROVIDED WITH A REASONABLY SAFE, CONVENIENT AND ACCESSIBLE PATH THAT REPLICATES AS NEARLY AS PRACTICAL THE MOST DESIRABLE CHARACTERISTICS OF THE EXISTING SIDEWALK OR FOOTPATH

**LEGEND**

- \* PORTABLE FLASHING BEACON (P.F.B.)
- ≡ TYPE III BARRICADE W/SIGN
- ≡ TYPE II BARRICADE W/SIGN
- CHANNELIZING DEVICE
- ▼ TRAFFIC CONE WITH CLIP ON SIGN
- TYPE I W/ SIGN
- EXISTING SIGN
- Ⓢ SIGNALIZED INTERSECTION
- ⚡ FLASHING ARROW BOARD
- ⚡ HIGH LEVEL WARNING DEVICE (FLAGTREE)
- 🚧 FLAGGER
- TANSAT TOW AWAY NO STOPPING ANY TIME
- ⊠ EXISTING DRIVEWAY
- ▨ WORK ZONE (ACTIVITY AREA) LIMITS
- ➔ DIRECTION OF TRAFFIC (NOT PAVEMENT MARKING)

CALL 811 BEFORE YOU DIG.  
 WISCONSIN TOLL FREE  
 800-242-8511

**BRIGHTSPEED**

PLANS PREPARED BY:  
**CNS**  
 A CONGRUEX COMPANY  
 1600 PEARL ST. SUITE 300 BOULDER  
 CO 80302, (702)510-5326

REVISIONS

REV.	DESCRIPTION	BY	DATE
0	INITIAL DESIGN	K.K.	8/20/25

**BRIGHTSPEED**  
 CONFIDENTIAL AND PROPRIETARY  
 LCRSWIXA

**TC-4 OF TC-6**

SCALE: 1:60

**3316 COMMERCE ST.  
COMMERCE ST. & ENTERPRISE AVE.  
-BORING, GROUND ROD & HH PLACEMENT  
WORK AREA 1 OF 1  
PHASE 3 OF 4**

**PEDESTRIAN CONTROL NOTES:**  
A DEDICATED INDIVIDUAL WILL BE ASSIGNED THE RESPONSIBILITY OF ESCORTING PEDESTRIANS THROUGH THE WORK AREA IN ACCORDANCE WITH THREE MAJOR CONSIDERATIONS:

1. PEDESTRIANS SHOULD NOT BE LED INTO DIRECT CONFLICT WITH WORK SITE VEHICLES, EQUIPMENT OR OPERATIONS
2. PEDESTRIANS SHOULD NOT BE LED INTO DIRECT CONFLICT WITH MAINLINE TRAFFIC MOVING THROUGH OR AROUND THE WORK SITE.
3. PEDESTRIANS SHOULD BE PROVIDED WITH A REASONABLY SAFE, CONVENIENT AND ACCESSIBLE PATH THAT REPLICATES AS NEARLY AS PRACTICAL THE MOST DESIRABLE CHARACTERISTICS OF THE EXISTING SIDEWALK OR FOOTPATH

FLAGGER TO ASSIST PEDESTRIANS THROUGH WORK AREA (SEE PED NOTES)

ACCESS TO DRIVEWAYS MUST BE MAINTAINED AT ALL TIMES.

CONTACT PROPERTY OWNER(S) 72 HOURS PRIOR TO START OF WORK.

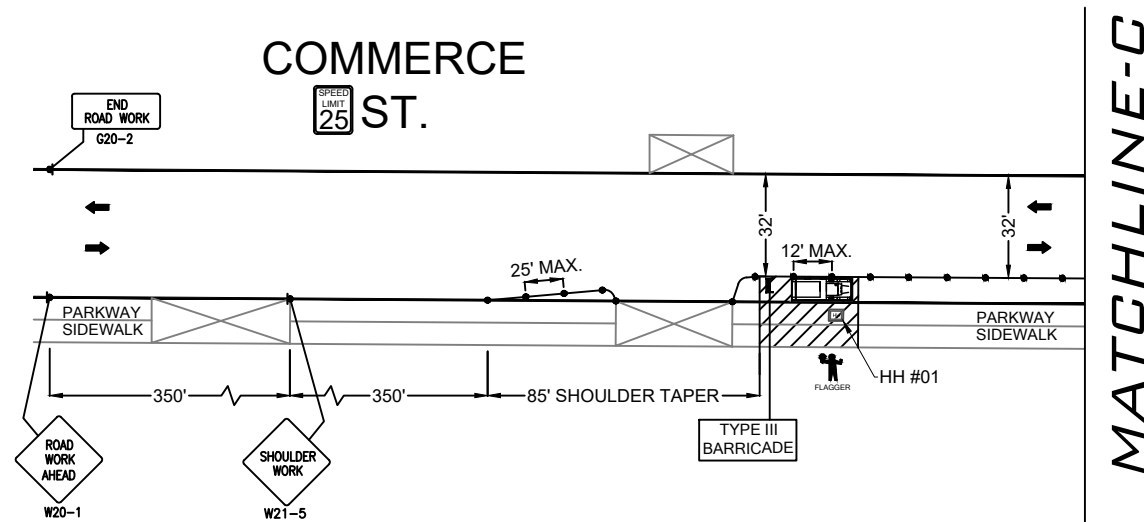
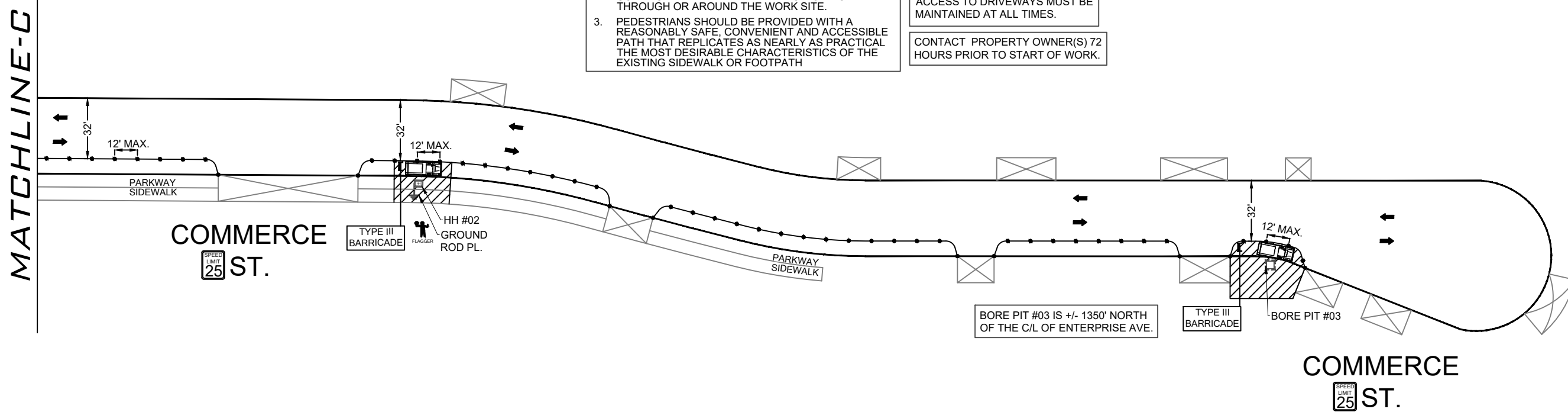

**LEGEND**

- \* PORTABLE FLASHING BEACON (P.F.B.)
- ≡ TYPE III BARRICADE W/SIGN
- ≡ TYPE II BARRICADE W/SIGN
- CHANNELIZING DEVICE
- ▼ TRAFFIC CONE WITH CLIP ON SIGN
- TYPE I W/ SIGN
- EXISTING SIGN
- ⊙ SIGNALIZED INTERSECTION
- ⚡ FLASHING ARROW BOARD
- ⚡ HIGH LEVEL WARNING DEVICE (FLAGTREE)
- ♠ FLAGGER
- TANSAT TOW AWAY NO STOPPING ANY TIME
- ⊠ EXISTING DRIVEWAY
- ▨ WORK ZONE (ACTIVITY AREA) LIMITS
- ➔ DIRECTION OF TRAFFIC (NOT PAVEMENT MARKING)

CALL 811 BEFORE YOU DIG.  
WISCONSIN TOLL FREE  
800-242-8511

**BRIGHTSPEED**

PLANS PREPARED BY:  
**CNS**  
A CONGRUEX COMPANY  
1600 PEARL ST. SUITE 300 BOULDER  
CO 80302, (702)510-5326

REVISIONS

REV.	DESCRIPTION	BY	DATE
0	INITIAL DESIGN	K.K.	8/20/25

**BRIGHTSPEED**  
CONFIDENTIAL AND PROPRIETARY  
LCRSWIXA

**TC-5 OF TC-6**

SCALE: 1:60

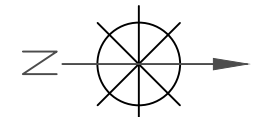

**3316 COMMERCE ST.  
COMMERCE ST. & ENTERPRISE AVE.  
-BORING & RISER PLACEMENT  
WORK AREA 1 OF 1  
PHASE 4 OF 4**

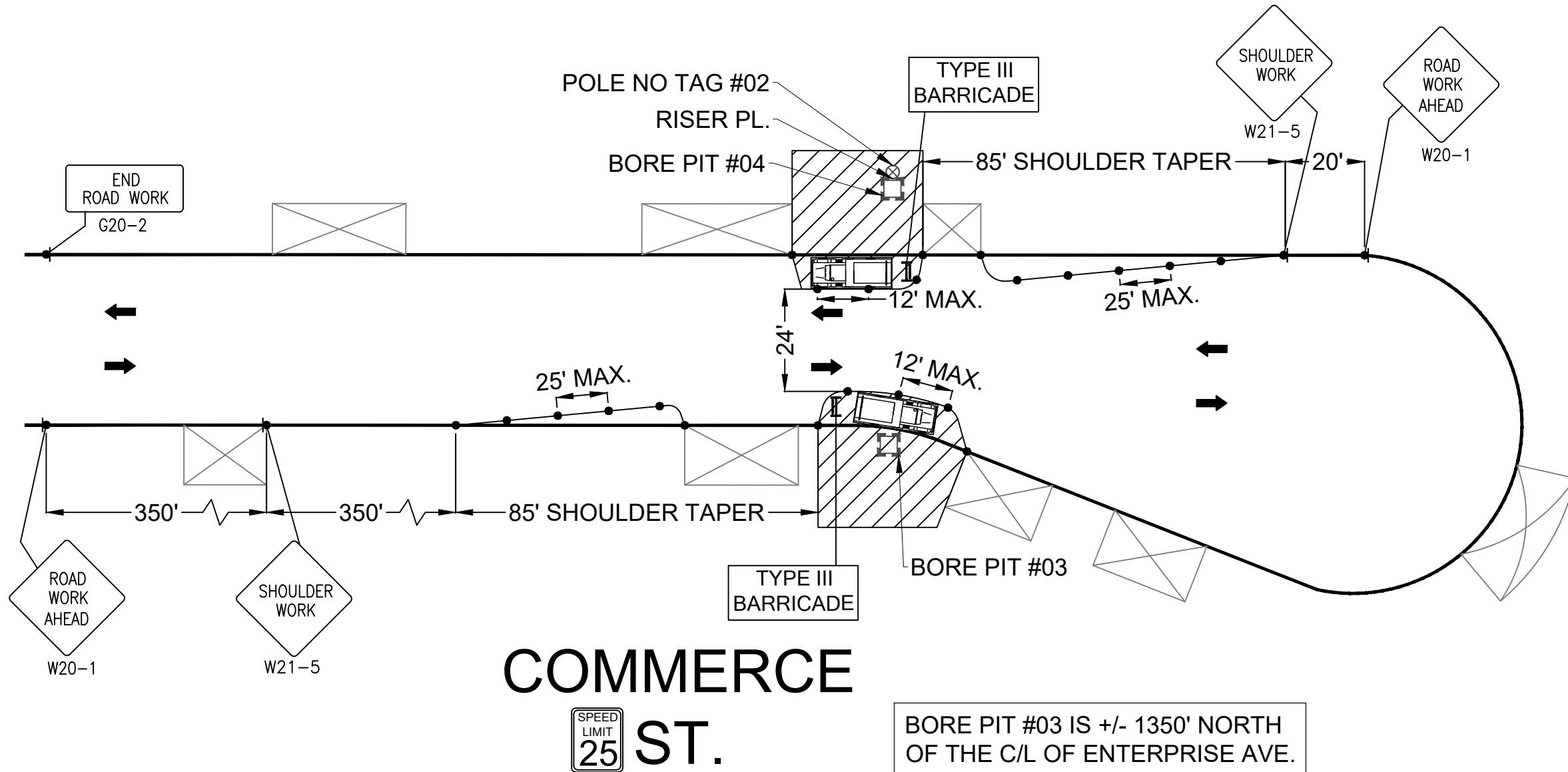

**COMMERCE  
ST.**

SPEED  
LIMIT  
**25**

BORE PIT #03 IS +/- 1350' NORTH  
OF THE C/L OF ENTERPRISE AVE.

ACCESS TO DRIVEWAYS MUST BE  
MAINTAINED AT ALL TIMES.

CONTACT PROPERTY OWNER(S) 72  
HOURS PRIOR TO START OF WORK.

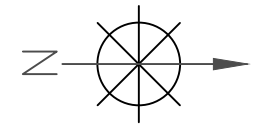

**LEGEND**

- \* PORTABLE FLASHING BEACON (P.F.B.)
- ≡ TYPE III BARRICADE W/SIGN
- ≡ TYPE II BARRICADE W/SIGN
- CHANNELIZING DEVICE
- ▼ TRAFFIC CONE WITH CLIP ON SIGN
- TYPE I W/ SIGN
- EXISTING SIGN
- ⊙ SIGNALIZED INTERSECTION
- ⚡ FLASHING ARROW BOARD
- ⚡ HIGH LEVEL WARNING DEVICE (FLAGTREE)
- ⚡ FLAGGER
- TANSAT TOW AWAY NO STOPPING ANY TIME
- ⊠ EXISTING DRIVEWAY
- ▨ WORK ZONE (ACTIVITY AREA) LIMITS
- DIRECTION OF TRAFFIC (NOT PAVEMENT MARKING)

CALL 811 BEFORE YOU DIG.  
WISCONSIN TOLL FREE  
800-242-8511

**BRIGHTSPEED**

PLANS PREPARED BY:  
**CNS**  
A CONGRUEUX COMPANY  
1600 PEARL ST. SUITE 300 BOULDER  
CO 80302, (702)510-5326

REVISIONS

REV.	DESCRIPTION	BY	DATE
0	INITIAL DESIGN	K.K.	8/20/25

**BRIGHTSPEED**  
CONFIDENTIAL AND PROPRIETARY  
LCRSWIXA

**TC-6 OF TC-6**

SCALE: 1:30