

PLAT OF SURVEY

PART OF THE SW 1/4 OF THE SW 1/4 OF SECTION 27,
TOWNSHIP 16 NORTH, RANGE 7 WEST, TOWN OF MEDARY,
AND PART OF THE NW 1/4 OF THE NW 1/4 OF SECTION 34,
TOWNSHIP 16 NORTH, RANGE 7 WEST, CITY OF LA CROSSE,
ALL IN LA CROSSE COUNTY, WISCONSIN.

LEGAL DESCRIPTION - PARCEL "A" (CITY OF LA CROSSE TO CULP):

Part of the Northwest Quarter of the Northwest Quarter of Section 34, Township 16 North, Range 7 West, City of La Crosse, La Crosse County, Wisconsin, more fully described as follows:

COMMENCING at the Northwest corner of the Northwest Quarter of the Northwest Quarter of said Section 34;
THENCE N89°25'55"E along the North line of said Northwest Quarter of the Northwest Quarter, a distance of 666.82 feet to the POINT OF BEGINNING;
THENCE continuing N89°25'55"E along said North line, a distance of 556.24 feet;
THENCE S00°34'05"E, a distance of 170.00 feet;
THENCE S89°25'55"W, a distance of 556.24 feet;
THENCE N00°34'05"W, a distance of 170.00 feet to the POINT OF BEGINNING.

Parcel contains approximately 94,561 Square Feet or approximately 2.17 Acres.

Subject to any Easements, Covenants and Restrictions of record.

LEGAL DESCRIPTION - PARCEL "B" (CULP TO CITY OF LA CROSSE):

Part of the Southwest Quarter of the Southwest Quarter of Section 27, Township 16 North, Range 7 West, Town of Medary, La Crosse County, Wisconsin, more fully described as follows:

BEGINNING at the Southwest corner of the Southwest Quarter of the Southwest Quarter of said Section 27;
THENCE N89°25'55"E along the South line of said Southwest Quarter of the Southwest Quarter, a distance of 295.51 feet;
THENCE N01°04'07"W, a distance of 320.00 feet;
THENCE S89°25'55"W, a distance of 295.51 feet to the West line of said Southwest Quarter of the Southwest Quarter;
THENCE S01°04'07"E along said West line, a distance of 320.00 feet to the POINT OF BEGINNING.

Parcel contains approximately 94,560 Square Feet or approximately 2.17 Acres.

Subject to any Easements, Covenants and Restrictions of record.

SURVEYOR'S NOTES:

- The intent of this survey is to define two parcels of equal size for the purpose of a "Parcel Swap" between adjoining land owners as labeled on Sheet 1 and in the legal descriptions above.
- The iron pipe found at the West 1/4 corner of Section 27 is leaning Northwesterly (downhill). Measurements as shown on this survey are to the base of the found iron pipe.

SURVEYOR'S CERTIFICATE:

I, Lucas V. Sonsalla, Wisconsin Professional Land Surveyor, hereby certify that this survey was performed and Plat of Survey prepared by me or under my direct supervision, that I have complied with the provisions of Chapter A-E 7 of the Wisconsin Administrative Code, and that this a correct representation of the land surveyed and mapped to the best of my knowledge and belief. The field work was completed on 02/26/2021.



Lucas V. Sonsalla
Wisconsin Professional Land Surveyor
License Number 2900
Date: 03/02/2021

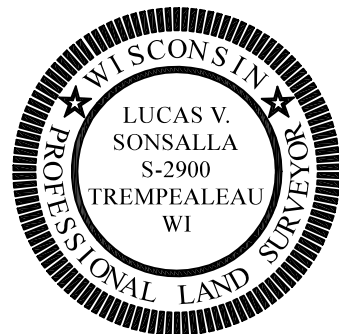

PROJECT NO. 160727.100
FIELD BOOK #600
SHEET 2 OF 2



SURVEY PERFORMED FOR:

City of La Crosse
Parks, Recreation and Forestry Department
400 La Crosse Street
La Crosse, WI 54601

N15286 Delaney Road
Trempealeau, WI 54661
(608) 780-7694
lucas@sonsallals.com
www.sonsallals.com