



# City of La Crosse, Wisconsin

## APPLICATION FOR FARMERS MARKET OR TRADE SHOW

(Ch. 10, Article XVI)



12.2024

Check One:

Farmers Market       Trade Show

For period January 1, 2025 to December 31, 2025

Check this box if this is a renewal or you have previously held this license.

Date Received: 12/30/2024 Fee: \$ 110.00 Invoice No. \_\_\_\_\_

Applications must be received in the City Clerk's Office at least fifteen (15) days in advance of license being issued. The non-refundable license fee and required documentation must accompany this application at the time of filing.

### BUSINESS INFORMATION – Person, Firm, Association or Corporation/LLC

<b>Legal/Real Name of Business:</b> La Crosse Farmers Market Association	<b>Trade Name:</b> LFMA	<b>Years in Business:</b> 20+
---	----------------------------	----------------------------------

<b>Address:</b> P.O. Box 1292	<b>Street</b>	<b>City</b> La Crosse	<b>State</b> WI	<b>Zip Code</b>
----------------------------------	---------------	--------------------------	--------------------	-----------------

<b>Telephone Number:</b> 54602	<b>Website:</b> <a href="http://www.cameronparkmarket.org/">http://www.cameronparkmarket.org/</a>
-----------------------------------	--

### APPLICANT INFORMATION – Manager/Person in Charge

<b>Name:</b> First Caleb	Full Middle Charles	Last Kvale
-----------------------------	------------------------	---------------

<b>Address:</b> 4425	<b>Street</b> 33rd St South	<b>City</b> La Crosse	<b>State</b> WI	<b>Zip Code</b> 54601
-------------------------	--------------------------------	--------------------------	--------------------	--------------------------

<b>Telephone Number:</b> 563-517-1069	<b>Email:</b> lacrossefarmersmarkets@gmail.com
--	---

**\*The attached Personal Data Sheet must be completed for each officer/member of business and manager/person in charge\***

### NATURE OF BUSINESS

**Location of sales:**  
Burns Park La Crosse, WI

**Dates of sales, if on a regular schedule:**  
Every Friday May-October

**Brief description of the goods offered or services:**  
A Market for a wide variety of vendors including but not limited to produce, beef, baked goods, sauces, seasonings, jewelry, crafted goods, pottery and more from local vendors.

**RIGHT-OF-WAY USE OR CLOSURE – Traffic lanes, parking lanes, boulevard, sidewalk, alley**

Do you need barricades or signage? Yes  No

If yes, include a site plan with this application showing barricade placement or use/closure wanted.

Do you want to pick up materials  or have delivered ? If delivered, provide detail as to when/where below. If picking up, it is up to the applicant to arrange time/date for pickup and return of materials with the Sign Shop Foreman, 608-789-7310.

At Burns Park by 1:00 on Fridays. We are working with the Parks Department who has ideas how they want to handle the street blockage.

A cost estimate based on needs will be provided with your license. The City will invoice the applicant, and payment shall be made within thirty (30) days of the invoice.

*Applicant must notify the city of any cancellation or alteration for any reason. If notice isn't given until after materials have been delivered, applicant will still be billed the cost of materials and labor.*

*The above hereby makes application for a Farmers Market or Trade Show License within the City of La Crosse pursuant to Chapter 10, Article XVI of the Code of Ordinances of the City of La Crosse.*

*I understand that as license holder, I must collect the following information from each individual seller operating under this license:*

- Name, permanent address, and telephone number and temporary address of applicant, if any.
- Name, address, and telephone number of the person, firm, association, or corporation that said person represents or is employed by, or whose merchandise, services, or donations are being taken for.
- Place where the applicant can be contacted for at least six (6) months after leaving the City of La Crosse.
- Nature of business to be conducted and a brief description of the goods offered or services, if any.
- Proposed method of delivery of goods, if applicable.
- A Wisconsin seller's permit as required by Wis. Stats. sec. 77.52.

*Under penalty provided by law, applicant certifies the above information is true, correct, and complete, and that falsification may result in denial of such license. Further, applicant understands that refunds are not allowed for any portion of the application fee paid even if denied for past and/or pending offenses and/or for any outstanding debts owed to the City. Applicant agrees that there shall be full compliance with all local, state, and federal laws in the conduct of the activities for which permit may be granted.*

Caleb Kvale  
Signature of Applicant

12/30/2024  
Date

**The issuance of a Farmers Market and Trade Show License is conditional at all times. A permit may be revoked, suspended, or not renewed for violation of any provision of this chapter, or a violation of a statute, ordinance, or regulation substantially related to the permitted activity or when necessary to protect the public health, safety, or welfare; or to prevent a nuisance from developing or continuing.**

**PHOTOCOPIES OF THE FOLLOWING MUST ACCOMPANY THE APPLICATION AT THE TIME OF FILING:**



Certificate of Insurance along with a photocopy of the endorsement naming City of La Crosse as additional insured (a statement alone on the Certificate is not sufficient).

[ ] Written authorization of the property owner(s) where business will be conducted, if applicable.

**OFFICE USE ONLY**

Date Received in the City Clerk's Office:	Issue Date:	License #:
---	-------------	------------

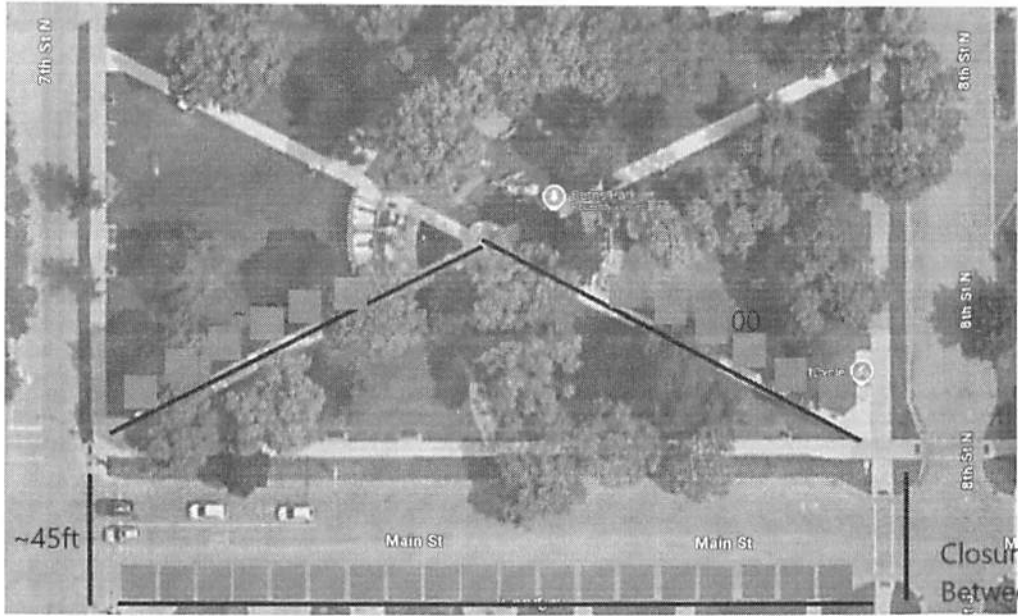

Closure of Main  
Between 7th and  
8th

~300 Ft

~45ft