



HSR ASSOCIATES INC.
100 MILWAUKEE STREET
LA CROSSE, WISCONSIN
PHONE: 608.784.1830
FAX: 608.782.5844
WEB SITE: www.hsrasociates.com

Consultant:

PARAGON ASSOCIATES
Environmental Design & Consulting
CIVIL ENGINEERING, LANDSCAPE ARCHITECTURE, SURVEYING
632 COPELAND AVENUE - LA CROSSE, WI 54603
Tel: 608.781.3110 Fax: 608.781.3187 Paragon-Associates

**COULEE REGION
RECOVERY CENTER**

**FERRY STREET
LA CROSSE, WISCONSIN
GRADING PLAN**

Project Title:
Project Location:
Sheet Title:

HSR Project Number:

AUTO PROJECT #

Project Date:

AUTO PROJECT DATE

Drawn By:

C.G.

Key Plan:

**REVIEW
NOT FOR
CONSTRUCTION**

Revisions:

No.	Description	Date

Graphic Scale:
1"=10'

Last Update:
09/01/17

C200

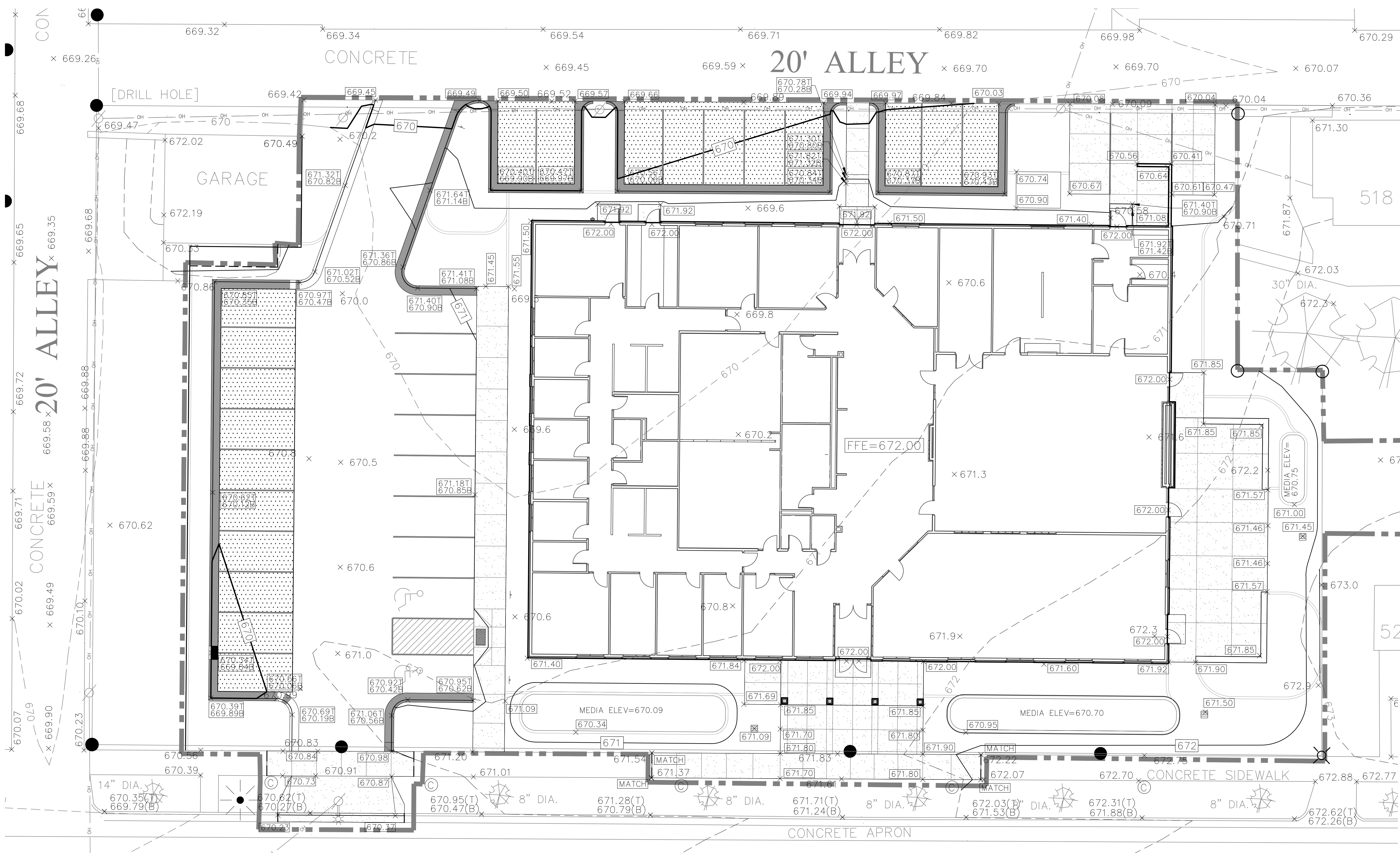

GRADING NOTES

- CONTOURS SHOWN ARE FOR FINISHED SURFACES. ANY ADJUSTMENT TO SUBGRADE IS THE CONTRACTOR'S RESPONSIBILITY.
- ALL DISTURBED AREAS THAT ARE UNPAVED ARE TO BE LANDSCAPED, SODDED, OR SEEDDED AS INDICATED ON THE LANDSCAPE PLAN.
- ALL LANDSCAPED OR LAWN AREAS SHALL HAVE A MINIMUM OF 6" OF TOPSOIL.
- SPOT ELEVATIONS SHALL TAKE PRECEDENCE OVER CONTOURS AND SLOPES SHOWN. HOWEVER, THE CONTRACTOR SHALL NOTIFY THE ENGINEER IF SPOT ELEVATIONS DO NOT APPEAR TO AGREE WITH THE CONTOURS AND SLOPES LABELED. SPOT ELEVATIONS AND SPECIFIC PROFILE INFORMATION SHALL BE USED FOR ESTABLISHING THE ELEVATION OF CURBS, DRIVEWAYS AND OTHER UTILITIES.
- ALL FINISHED GRADING SHALL PROVIDE FOR A SMOOTH TRANSITION TO UNGRADED AREAS.
- ALL PVC STORM SEWER PIPING SHALL BE MINIMUM SDR 35.
- EXISTING TREES TO REMAIN SHALL BE PROTECTED DURING CONSTRUCTION BY PLACING TEMPORARY FENCING AT THE DRIP LINE OF THE TREE CANOPY. IF IMPROVEMENTS NEED TO BE MADE WITHIN THE DRIP LINE, THE FENCE SHALL BE TEMPORARILY REMOVED AND REPLACED IMMEDIATELY FOLLOWING THE COMPLETION OF THE WORK.

